



# SUPER BRIGHT LEDS MCBRF-15ALC2 Single Color LED Controller with Wireless RF Remote User Manual

[Home](#) » [super bright leds](#) » SUPER BRIGHT LEDS MCBRF-15ALC2 Single Color LED Controller with Wireless RF Remote User Manual 

## Contents

- [1 SUPER BRIGHT LEDS MCBRF-15ALC2 Single Color LED Controller with Wireless RF Remote](#)
- [2 Parts Included](#)
- [3 Wireless Remote Functions](#)
- [4 SPECIFICATIONS](#)
- [5 Controller Installation](#)
- [6 Using the Wireless Remote](#)
- [7 Remote Pairing](#)
- [8 Documents / Resources](#)
  - [8.1 References](#)
- [9 Related Posts](#)



**SUPER BRIGHT LEDS MCBRF-15ALC2 Single Color LED Controller with Wireless RF Remote**



## Parts Included

- 1 – LED Controller
- 1 – Wireless Remote
- 1 – CR2025 Battery

## Wireless Remote Functions

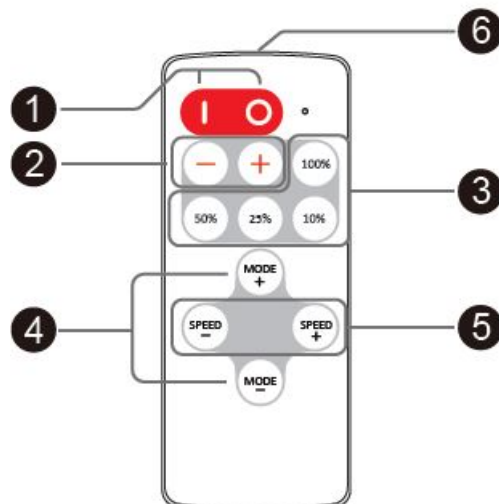

### 1. Turn On(I) / Standby(O)

Press 'I' button to turn on unit or press 'O' button to turn off.

Retains last setting between power off and power on.

### 2. BRIGHT(+)/BRIGHT(-) Dimming Level

Increases(+) or decreases(-) the brightness level of the light. Initiates Brightness Level Mode if Dynamic Mode

is currently active.

### 3. Brightness Shortcuts

Activates the brightness level indicated on the button label. These individual brightness levels are also accessible through the Bright(+)/Bright(-) buttons.

### 3. **Mode(+)/Mode(-) Dynamic Modes**

Dynamic modes feature a variety of brightness transitions and patterns, with 8 distinct modes. These buttons initiate Dynamic Mode and cycle through the modes in ascending or descending order.

### 4. **SPEED(+)/SPEED(-) Dynamic Modes Speed Level**

Increases(+) or decreases(-) the speed of the currently active dynamic mode. Initiates Dynamic Mode if Brightness Level Mode is currently active.

### 5. **Wireless Remote LED Indicator**

Flashes blue when remote is operating to indicate that the remote is functioning properly.

## SPECIFICATIONS

Model	MCBRF-15A
Dynamic Mode	8 Modes
PWM Grade	256 Levels
Dimming	10 levels
Speed Grade	10 Levels
Overload Protection	Yes
Overheat Protection	Yes
Working Voltage	5–24 VDC
Battery	3V CR2025
Remote Frequency	433.92 MHz
Remote Distance	Up to 15 meters
Working Temperature	-22°–176° F(-30°–80° C)
Rate Output Current	15 A
PWM Frequency	1 kHz
IP Rating (controller)	IP68

## Controller Installation



### 1. Power Supply Input

The controller/power supply operates at 5-24VDC. The red wire is positive(+) and the black wire is negative(-) as indicated on the controller housing. Make sure the power voltage matches the LED strip requirement. Incorrect voltage may damage the LED strip.

### 2. Output to LEDs

The red cable should be connected to LED positive and black cable to negative.

The peak output current is 15 amperes.

CAUTION! Do not short circuit or overload the LED outputs, this may lead to permanent damage!

### 3. LED Controller Status Indicator

A multi-color emitting LED located on the remote controller indicates current operating status or operating status changes as follows:

LED Controller Status Indicator						
Light Signal	Blue	Short single white flash	Long single white flash	Long single yellow flash	Red flash	Yellow flash
Indicates	normal function	mode change	Range limit has been reached when cycling through Dynamic Modes	Range limit has been reached when cycling through Tempo Speed Level or Brightness Level	Overload/short circuit has been detected, activating protection mode	Overheating has been detected, activating protection mode

## Using the Wireless Remote

Prepare the wireless remote for use by removing the battery insulator. The remote uses a CR2025 battery. Note: The wireless remote operates using radio frequency(RF). The remote controller's use is not restricted by normal obstructions such as walls, doors, etc. Do not install controller in metal enclosures.

### Remote Pairing

The included remote will already be paired to the controller. Up to 4 additional wireless remotes can be assigned to operate the LED controller. Additionally, each individual wireless remote can be assigned to an unlimited number of controllers.

#### Pairing:

1. Disconnect the power to the LED controller, wait 5 seconds, and reconnect.
2. Within 10 seconds of reconnecting the LED Controller, hold the "50%" and "10%" buttons simultaneously for about 3 seconds.
3. The LED indicator on the LED controller will flash white 3 times indicating the new wireless remote has been successfully assigned. This may be done for a total of 5 wireless remotes.

4400 Earth City Expy, St. Louis, MO 63045  
866-590-3533  
[superbrightleds.com](http://superbrightleds.com)

## Documents / Resources

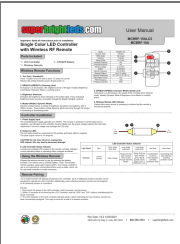
	<p><a href="#">SUPER BRIGHT LEDS MCBRF-15ALC2 Single Color LED Controller with Wireless RF Remote</a> [pdf] User Manual</p> <p>MCBRF-15ALC2, Single Color LED Controller with Wireless RF Remote, MCBRF-15ALC2 Single Color LED Controller with Wireless RF Remote, MCBRF-15A</p>
---	---

## References

-  [LED Lighting For Everything | Super Bright LEDs](#)