



# Super Bright LEDs EZD-RGBW3-WM Wireless LED RGBW 3-Zone Wall Switch User Manual

[Home](#) » [super bright leds](#) » Super Bright LEDs EZD-RGBW3-WM Wireless LED RGBW 3-Zone Wall Switch User Manual 

## Contents

- 1 Super Bright LEDs EZD-RGBW3-WM Wireless LED RGBW 3-Zone Wall Switch
- 2 Parts Included
- 3 Pairing Controller
- 4 Safety
- 5 Set-Up Instructions
- 6 Wall Switch Instructions
- 7 Connection Diagram
- 8 Multi-zone Diagram
- 9 Remote Functions
- 10 Documents / Resources
  - 10.1 References
- 11 Related Posts



**Super Bright LEDs EZD-RGBW3-WM Wireless LED RGBW 3-Zone Wall Switch**



## Parts Included

1. RGB 3-Zone LED Dimmer Wall Switch
2. Mounting Screws

## Pairing Controller

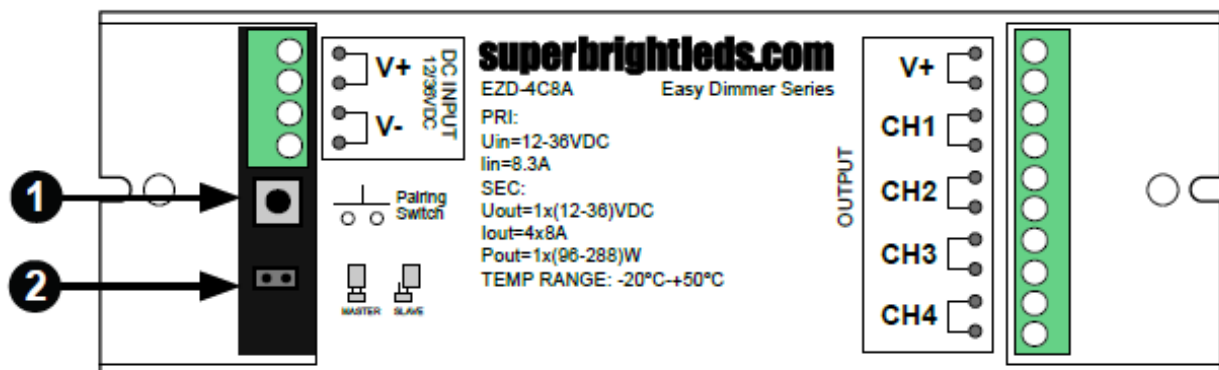

EZD-4C8A Controller		
Input Voltage	Current	Output Wattage
12~36 VDC	4 X 8A	384W(12V) 768W(24V) 1152W(36V)
EZD-RGBW3-WM Remote		
Operating Voltage		12~24 VDC
Operating Frequency		868 MHz
FCC ID#		2ACUQ2820

### 1. Pairing Switch

To Pair Wall Switch to Controller, push once and then push Wall switch. Lights will blink once to indicate linking.

To unpair Wall Switch(es), push and hold until lights blink twice.

### 2. Master/Slave Jumper

Set Jumper to Master for main Controller. Master emits synchronization signal to Slave Controllers. Set Jumper to Slave to receive a synchronization signal from Master Controller. Use Master for the first Controller in each zone. To achieve precise synchronization between Controllers in one zone, set additional Controllers to slave.

## Safety

- DO NOT install with power applied to the controller or switch.
- DO NOT expose the Wall Switch or Controller to moisture.

## Set-Up Instructions

### Remote

1. Follow illustrated steps below to connect Wall Switch to Power Supply. Connect GND terminal to negative and connect VIn to positive from power supply.

### Controller

1. Make sure power to the controller is disconnected.
2. Using a small flathead screwdriver, loosen the labeled terminal screws visible on the top of the controller.
3. Matching light strip wires with labeled slots on the Controller, insert wires and tighten terminal screws. Be sure wire conductor, not wire insulation, is secured in the terminal.
4. Turn power on and wait until light strip illuminates. If it does not come on, check light strips and wiring connections.

## Wall Switch Instructions

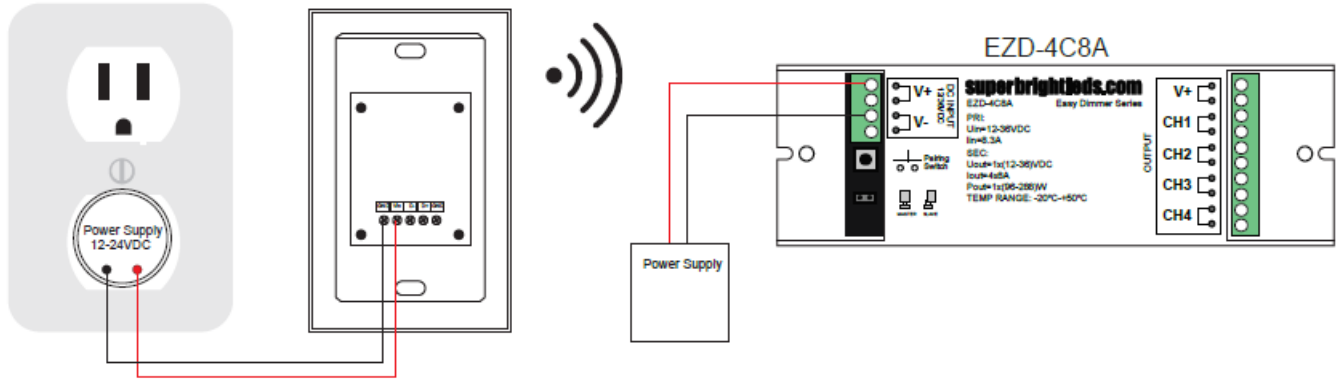

1. Release Wall Switch control panel from Back Plate by separating at the notch on the bottom of Wall Switch and pivoting away from locking tabs on top of Wall Switch.
2. Connect the wiring from the Wall Switch to the Power Supply as the diagram shown to the right. Optionally, connect wired DMX control signal to DMX controllers.
3. Fasten wall switch to existing switch box using supplied Screws.
4. Align locking tabs on top of Wall Switch Control Panel to Back Plate and pivot Control panel towards Back Plate being sure all locking tabs engage fully.

## Connection Diagram

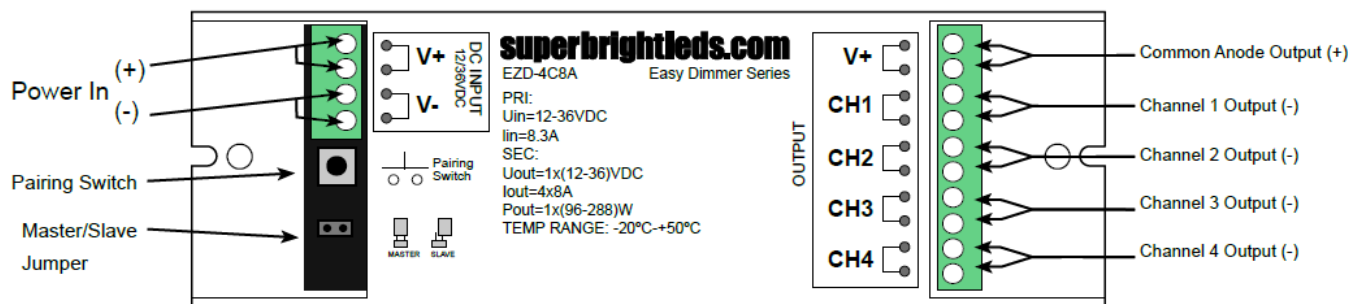

## Multi-zone Diagram

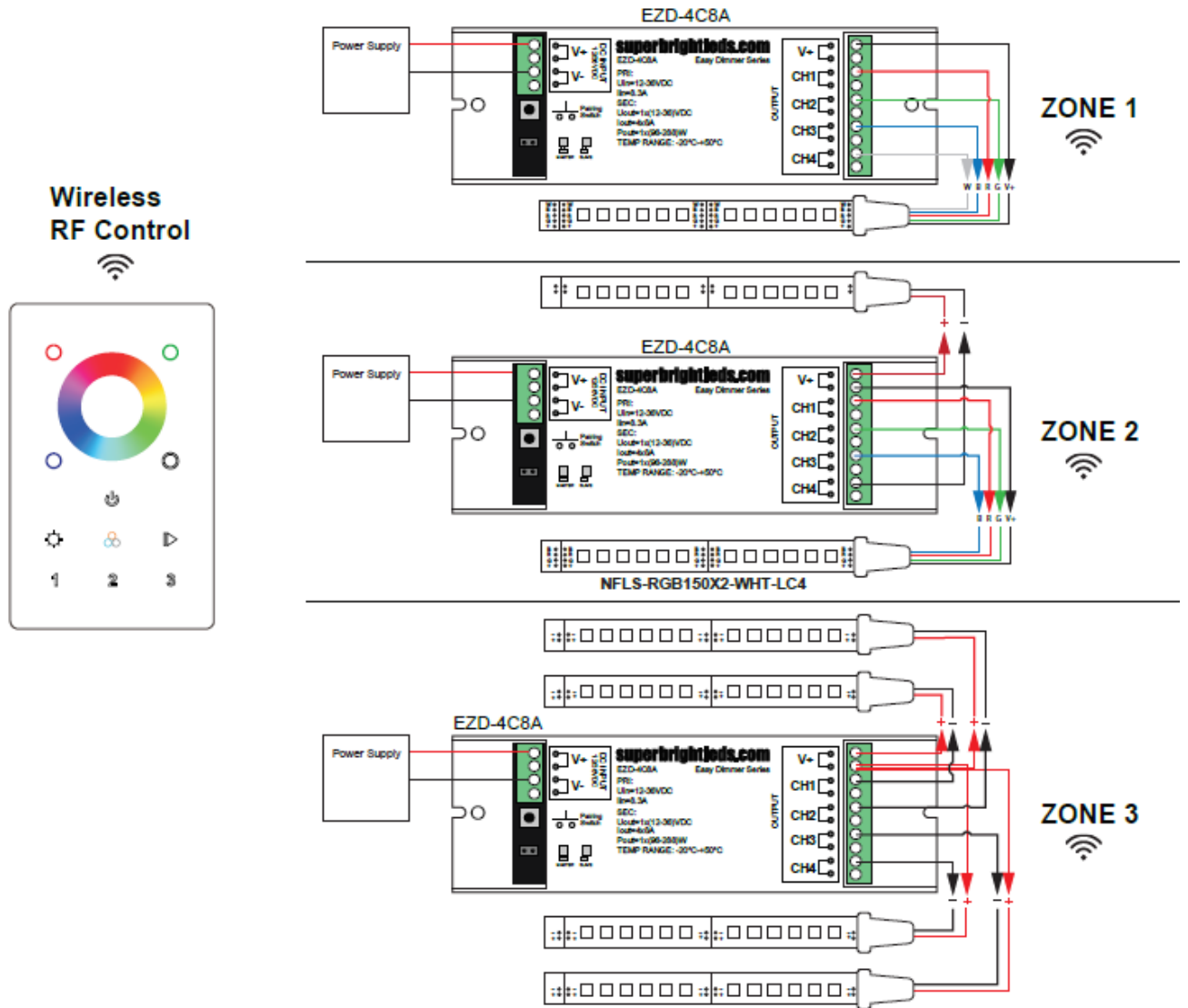

**Note:** Multi-zone control will only work with a wireless control setup.

## Remote Functions

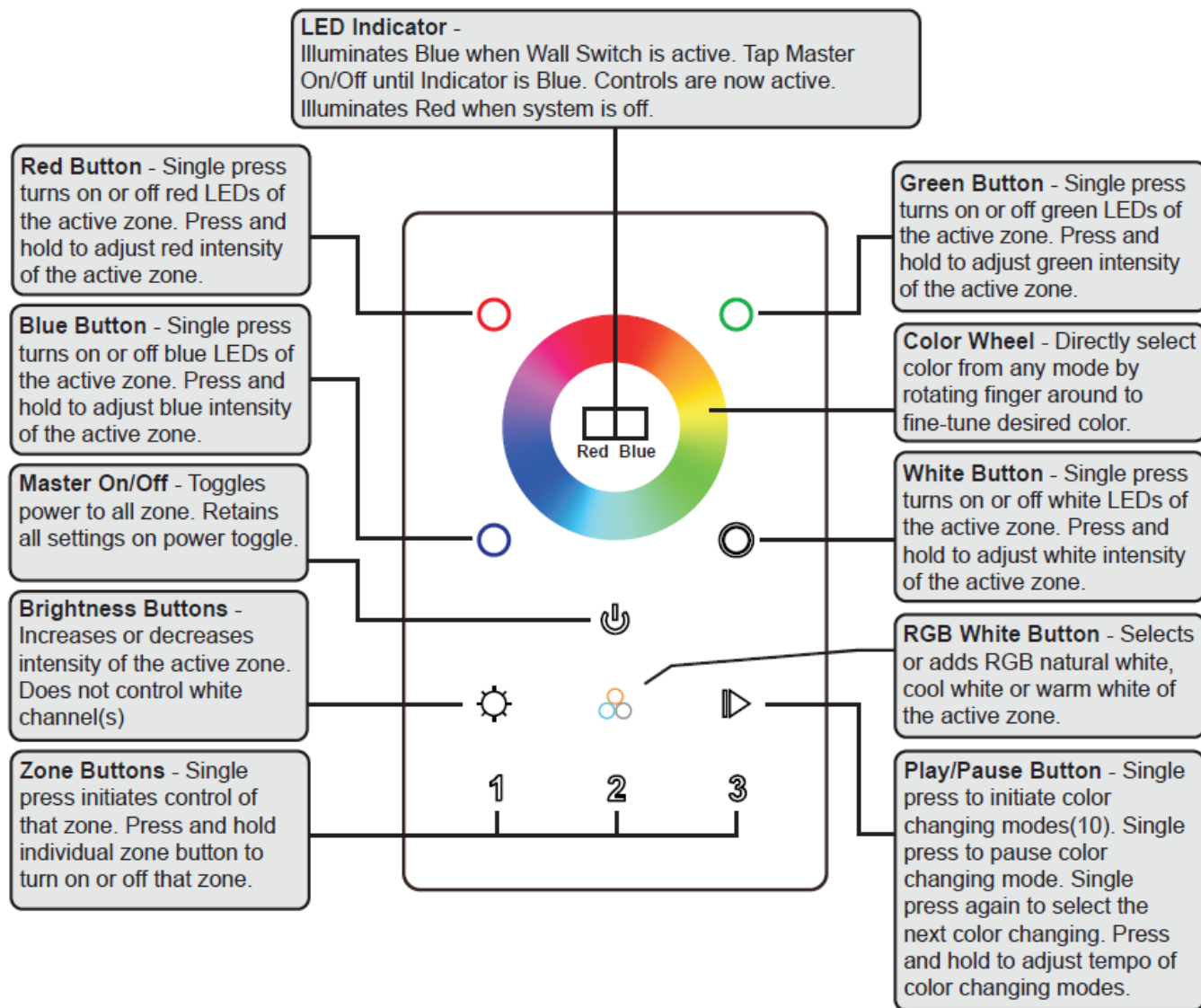

## Documents / Resources

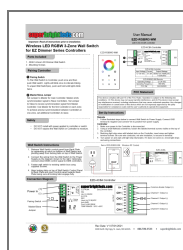

[Super Bright LEDs ESD-RGBW3-WM Wireless LED RGBW 3-Zone Wall Switch](#) [pdf] User Manual  
ESD-RGBW3-WM, Wireless LED RGBW 3-Zone Wall Switch

## References

- [LED Lighting For Everything | Super Bright LEDs](#)