

# SUPEASY Mesh Desk Organizer with File Holder Instruction Manual

[Home](#) » [SUPEASY](#) » SUPEASY Mesh Desk Organizer with File Holder Instruction Manual 

## Contents

- 1 SUPEASY Mesh Desk Organizer with File Holder
- 2 INSTALLATION INSTRUCTION
- 3 Fold Sides of Part A inwards
- 4 Documents / Resources
  - 4.1 References
- 5 Related Posts

## SUPEASY

### SUPEASY Mesh Desk Organizer with File Holder

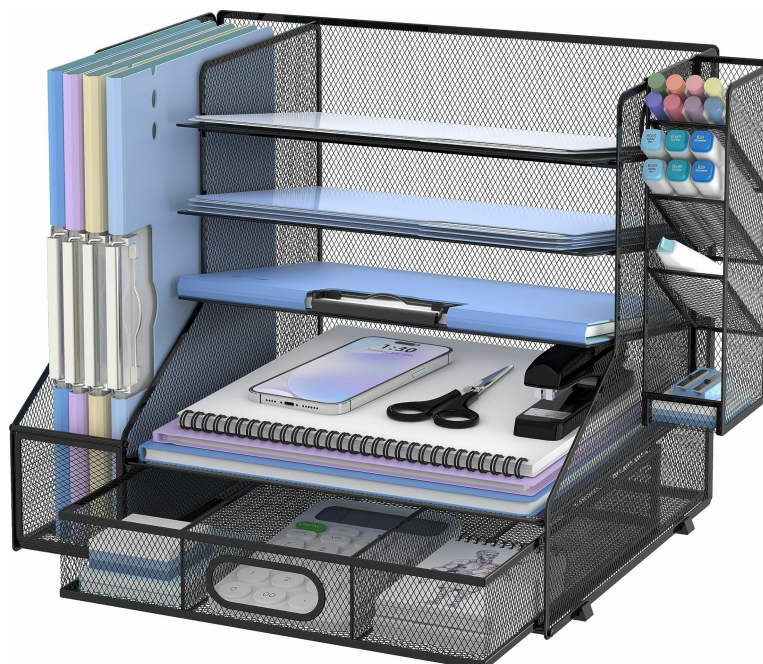

## INSTALLATION INSTRUCTION

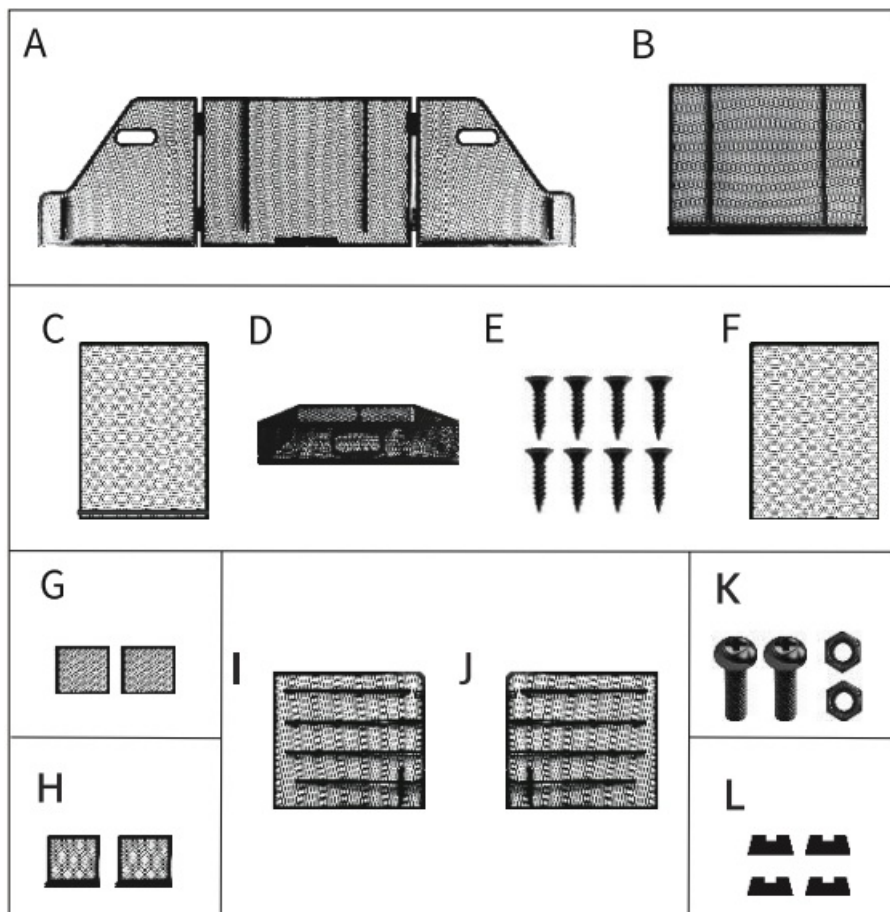

**Fold Sides of Part A inwards**

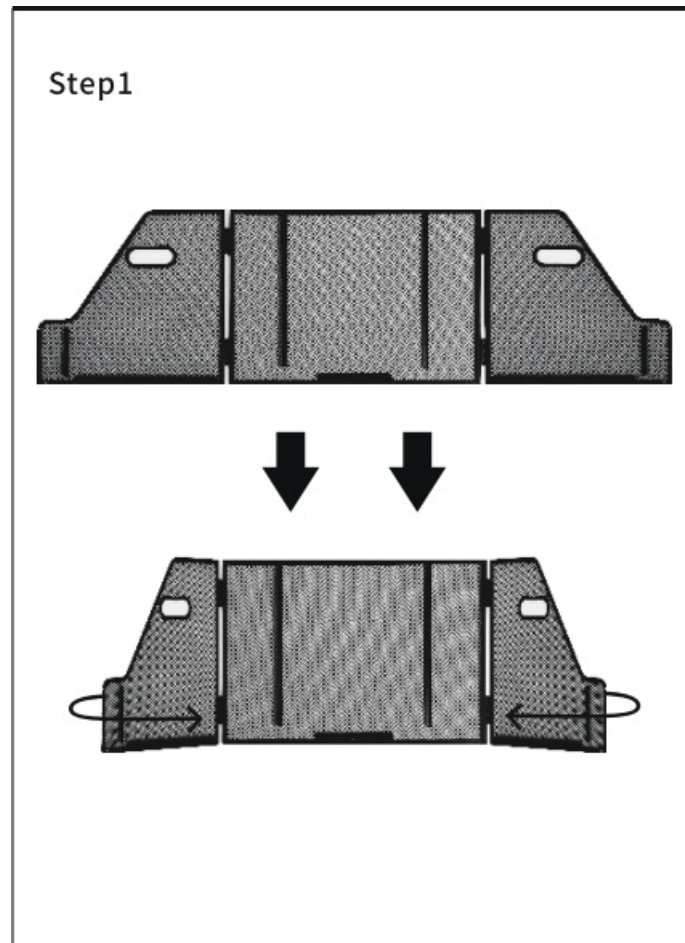

1. Insert B along A's side slots and then tighten screw E on both sides

2. Insert j along vertical slots and then tighten screw K on a side of J
3. Insert I along vertical slots and then tighten screw K on a side of I
4. Insert C as the picture showed and then tighten screw E on both sides

Step1

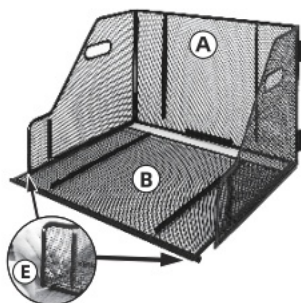

Step2

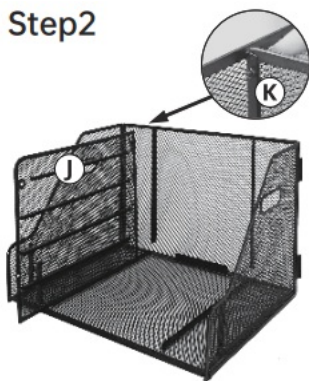

Step3

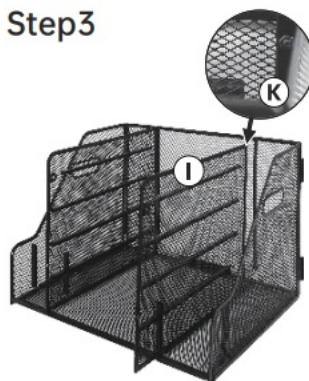

Step4

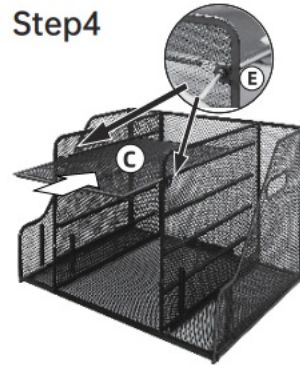

5. Insert Has the picture showed
6. Insert H as in step 6
7. Insert F and D as the picture showed
8. Insert G as the picture showed

Step5

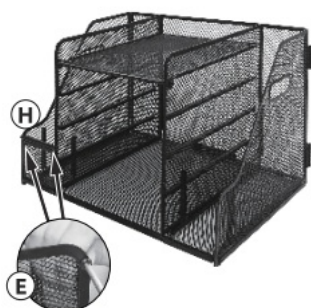

Step6

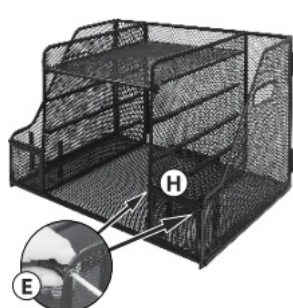

Step7

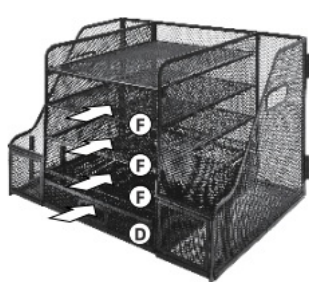

Step8

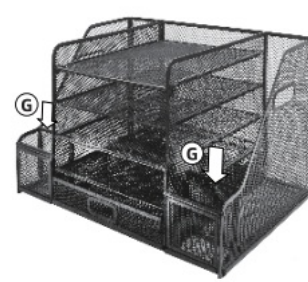

Any questions, please contact the email: [support@supeasy.vip](mailto:support@supeasy.vip).

## Documents / Resources

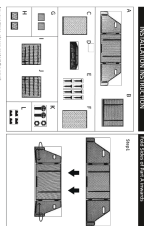
	<p><a href="#">SUPEASY Mesh Desk Organizer with File Holder</a> [pdf] Instruction Manual Mesh Desk Organizer with File Holder, Mesh Desk, Organizer with File Holder, File Holder</p>
---	---

## References

- [User Manual](#)