



## sunwaytek H511 Bluetooth Game Wireless Controller User Manual

[Home](#) » [sunwaytek](#) » sunwaytek H511 Bluetooth Game Wireless Controller User Manual 



Please visit [sunwaytek.com](https://www.sunwaytek.com) for updates and support.

Scan to view video guides on YouTube.



<https://www.youtube.com/channel/UCwHvc-IoES6-glPEsVmUgIA>

## Contents

### 1 Quick Start

#### 1.1 Platform Compatibility

#### 1.2 Pair & Link

#### 1.3 Charge the battery

#### 1.4 Keymapping Profiles

### 2 Connect to Switch

### 3 Connect to PC

#### 3.1 Option 1: Bluetooth (Xinput)

#### 3.2 Option 2: Bluetooth (Switch Pro Controller)

#### 3.3 Option 3: USB (Xbox 360 Controller)

### 4 Connect to Android

#### 4.1 Option 1: Android Gamepad

#### 4.2 Option 2: Switch Pro Controller

### 5 Connect to iOS/iPad OS









### 6 Connect to Mac

### 7 Documents / Resources

### 8 Related Posts

## Quick Start

### Platform Compatibility

		 <sup>1</sup>		 <sup>2</sup>	 <sup>3</sup>	
Wireless 	<input type="radio"/>	<input type="radio"/>	<input type="radio"/>	<input type="radio"/>	<input type="radio"/>	<input type="radio"/>
Wired  USB Type-C	<input type="radio"/>		<input type="radio"/>		<input type="radio"/>	
Motion Control	<input type="radio"/>		<input type="radio"/> <sup>4</sup>			

1. Including Linux and Raspberry Pi.

2. Starting with iOS 13, iPadOS 13, tvOS 13. No requirements on Mac OS.

3. Currently unavailable for TV.

4. Switch Pro Controller mode only.

## Pair & Link

**Pair** refers to the first time sync with the device. If wirelessly paired with another device thereafter, the stored info of the 1st device will be erased, new pairing has to be done when back to the 1st device.

**Link** refers to the reconnection to an ever-paired device, whose device info has been stored in the controller automatically.

- Pair methods listed here are typical of each platform.  
Read the following guides for more options.
- Fire devices may support all 4 pairing methods.

## Charge the battery

Charge via type C USB cable on DC power supplies (output Voltage 5V, current  $\geq 250\text{mA}$ ), including but not limited to:

- AC adapter
- Switch dock
- USB port of the computer
- others with USB electricity output, like power bank, etc.

The controller supports playing during charging. The 4 LED lights stay lit once full charged.

## Keymapping Profiles

ABXY caps are removable for reposition.

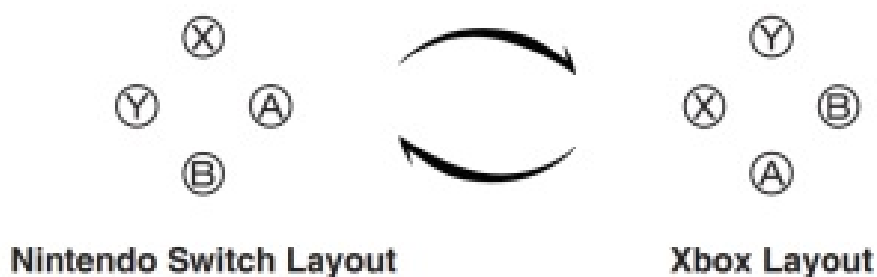

		WIRELESS	WIRE D
	<b>Operation</b>		
<b>P a i r *</b>	Press and hold for 2 sec		Plug-in via USB
<b>L i n k</b>	Press and hold for 1 sec		Unplugging
<b>D i s c o n n e c t</b>	<p>Option 1 – Force Sleep: press and hold Home button for 5 sec.</p> <p>Option 2 – Auto Sleep: leave the controller without operation in 5 min.</p> <p>Option 3 – Passive Sleep: Disconnect from the connected device side.</p>		



#### **WARNING: Battery Safety**

Do not connect to high voltage outlets.

Use only approved charger and cord.

Periodical charging is necessary when unused for a long.

Remove the battery if they are worn out and dispose of them properly.

#### **Connect to Switch**

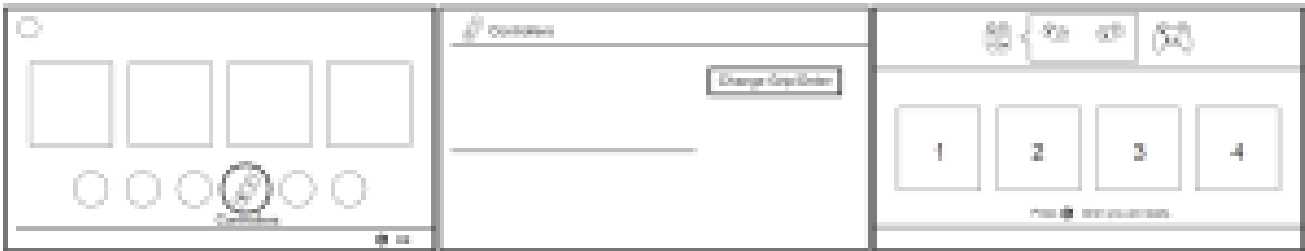

From the HOME screen, select “Controllers”, then “Chang Grip/Order”, enter the pairing screen, stay here.

- Operate by Joy-con, touch, or a paired controller. Ignore the instruction on the last screen.

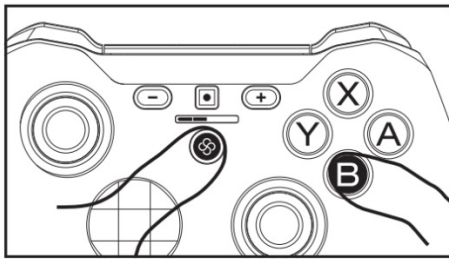

**1-2** Press and hold **L** + **B** until lights run.

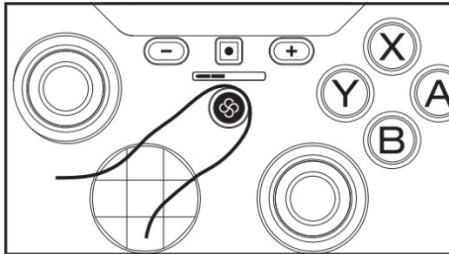

**2-1** When the console is on (in any screen), just press **L** to link.



**1-3 2-2** Once succeed, certain light(s) stays lit.

× Up to 8 controllers can be paired at the same time to a Nintendo Switch system.

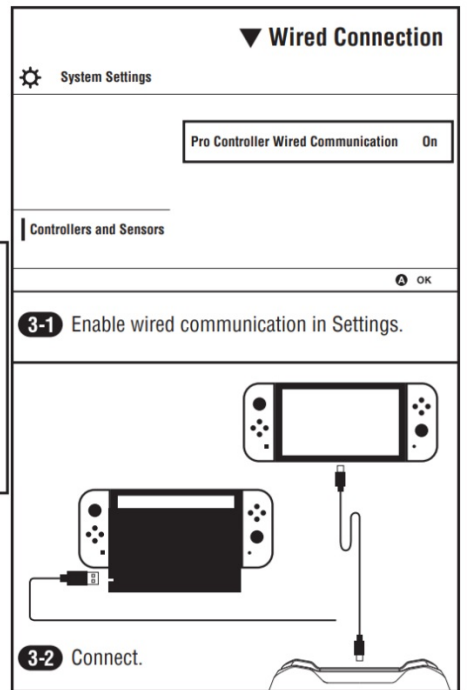

## Connect to PC

### Option 1: Bluetooth (Xinput)

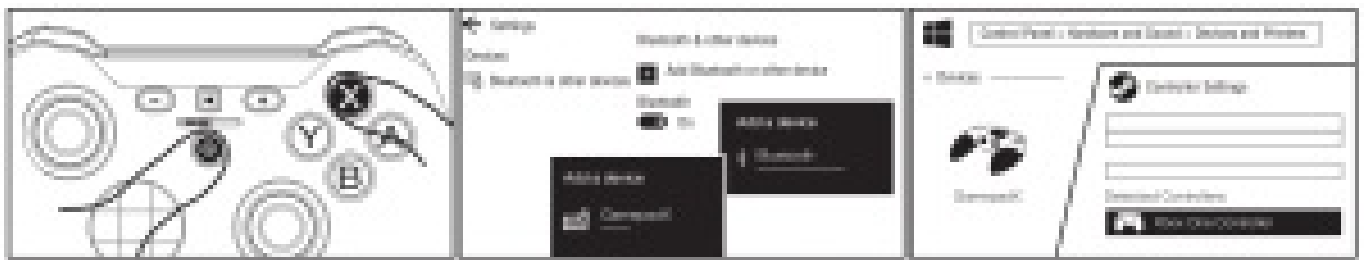

1. Press and hold **L** + **X** until lights run.
2. Turn on Bluetooth, add the device “GamepadX”.

Work as Bluetooth XINPUT device in Windows, and Xbox One Controller in Steam.

### Option 2: Bluetooth (Switch Pro Controller)



1. Press and hold **L** + **B** until lights run.
2. Turn on Bluetooth, add the device “Pro Controller”.

Work as Nintendo Switch Pro Controller in Steam.

Support motion control.

### Option 3: USB (Xbox 360 Controller)

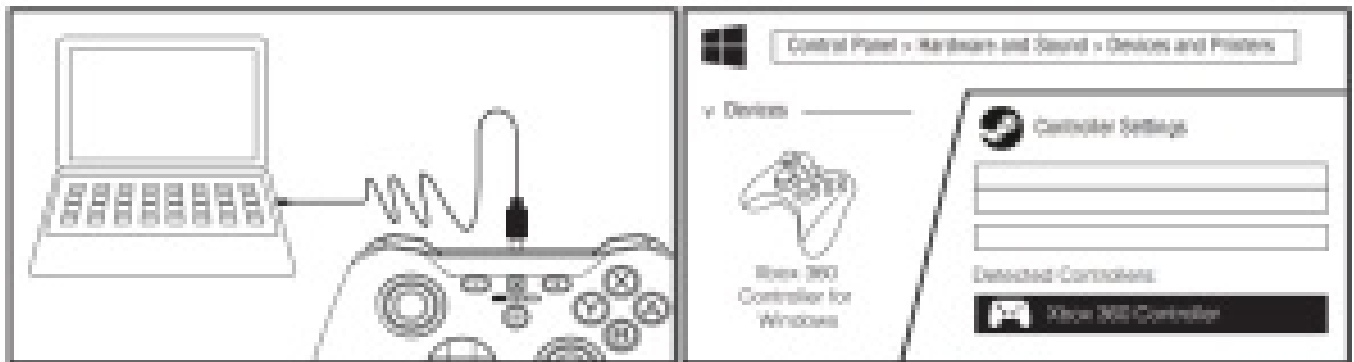

## Connect to Android

### Option 1: Android Gamepad



1. Turn on Bluetooth, click “Pair new device”.

2. Press and hold  + **A** until lights run.

3. Find the device “Gamepad” to pair.

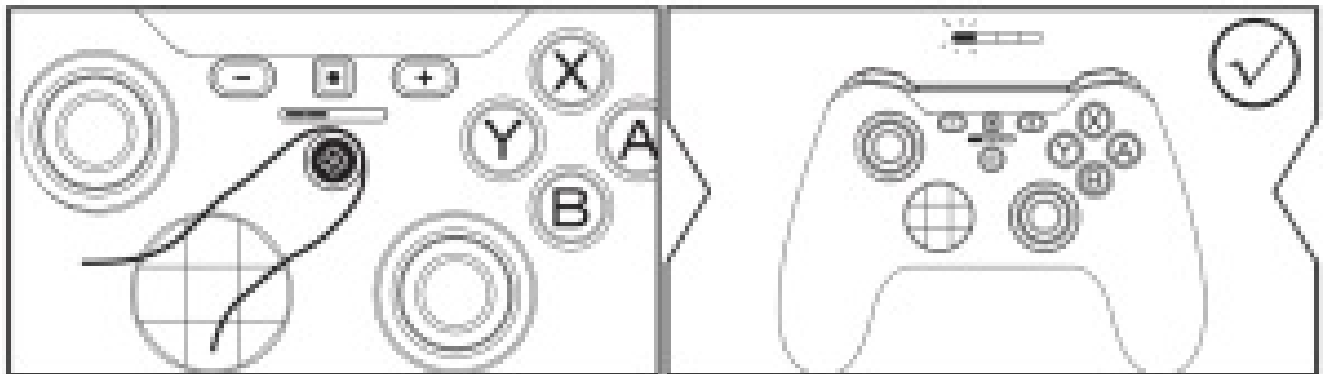



4. Just press  to link to the device ever paired (ensure Bluetooth is on).

5. Once succeed, light stays on.



### Option 2: Switch Pro Controller

Pairing method for Switch (see **Connect to Switch**) also applies to Android.  
The controller will be paired as Switch Pro Controller, working in supported games.

	Pair new device
	Available devices <b>Pro Controller</b>

## Connect to iOS/iPad OS





1. Press and hold  +  until lights run.
2. Turn on Bluetooth, connect the device "Xbox Wireless Controller". Succeed!

Just press  to link with the device ever paired (ensure Bluetooth is on).

## Connect to Mac





1. Press and hold  +  until lights run.
2. Turn on Bluetooth, connect the device "GamepadX". Succeed!

Just press to link with the device ever paired (ensure Bluetooth is on).

Ver. 1.12

Contents in these documents may change without notice.  
The names of actual companies and products mentioned herein may be the trademarks of their respective owners.  
© 2020 Sunwaytek Limited. All rights reserved.

## Documents / Resources

	<p><a href="#">sunwaytek H511 Bluetooth Game Wireless Controller</a> [pdf] User Manual</p> <p>H510, H511, H511 Bluetooth Game Wireless Controller, Bluetooth Game Wireless Controller, Wireless Controller, Controller</p>
	<p><a href="#">sunwaytek H511 Bluetooth Game Wireless Controller</a> [pdf] User Manual</p> <p>H510, H511, H511 Bluetooth Game Wireless Controller, Bluetooth Game Wireless Controller, Game Wireless Controller, Controller, Wireless Controller</p>