



SunveyTech SWD-M502630CS Digital Wireless Backup Camera System User Manual

[Home](#) » [Sunveytech](#) » SunveyTech SWD-M502630CS Digital Wireless Backup Camera System User Manual 

Contents

- [1 SunveyTech SWD-M502630CS Digital Wireless Backup Camera System](#)
- [2 Product Information](#)
- [3 Product Usage Instructions](#)
- [4 What's in the Box?](#)
- [5 Introduction](#)
- [6 Monitor Operation](#)
- [7 Camera Size](#)
- [8 Box Size](#)
- [9 Installation Diagram](#)
- [10 Connection mode of accessories](#)
- [11 Pairing the Camera and Monitor](#)
- [12 Specifications](#)
- [13 Troubleshooting](#)
- [14 FCC Warning Statement](#)
- [15 Documents / Resources](#)

Sunveytech

SunveyTech SWD-M502630CS Digital Wireless Backup Camera System



Product Information

- **Product Name:** SWD-M502630CS Camera and Monitor Mold
- **Package Contents:** The contents may vary based on the kit purchased. Please refer to the actual product for details.
- **Monitor Operation:** 12mm
- **Product Dimensions:** Camera Size – Not specified; Box Size – Not specified
- **Power Supply:** DC12V to 36V
- **Wireless Frequency:** 2.4 GHz
- **Wireless Range:** 500m (open area)
- **Delaying Time:** Not specified
- **Operating Temperature:** Not specified

Product Usage Instructions

Monitor and Camera Installation

- Choose a suitable location in your vehicle for the monitor that does not obstruct your view and complies with local laws for safe driving.
- Do not place the monitor in an area that might interfere with driving.
- Refer to the installation diagram provided in the user manual for proper installation of the monitor.
- For camera installation, refer to the camera placement diagram provided in the user manual for suitable installation position.

Connecting Accessories

- To connect the display to the bracket, use connection mode 1
- To connect the display to the ladder bracket, use connection mode 2.
- For waterproof joints, use connection mode 3 and ensure that they are docked according to the hole position.
- Please operate carefully during installation and removal to avoid damage.

Pairing the Camera and Monitor

- Ensure that the circuit is properly connected and powered before pairing.
- If pairing multiple cameras, switch to the corresponding channel.
- Refer to the user manual for detailed instructions on how to pair the camera and monitor.

What's in the Box?

NOTE The contents included may be different based on the kit you purchased. Please take the actual product as standard

1. 5inch Monitor
2. Camera
3. Sticker
4. Bracket
5. Car Charger
6. Power Cable
7. USB
8. Antenna and screws
9. Trapezoidal bracket



Introduction

Please read all of the installation instructions carefully before installing the product. Improper installation will void the manufacturer’s warranty.

Thank you very much for purchasing a Rear View Backup Camera System. With this manual, you will be able to properly install and operate the unit. The Backup Camera System is intended to be installed as a supplement aid to your standard rear view mirror that already exists in your vehicle. The Backup Camera System should not be used as a substitute for the standard rearview mirror or for any other mirror that exists in your vehicle. In some jurisdictions, it is unlawful for a person to drive a motor vehicle equipped with a TV viewer or screen located forward of the back of the driver’s seat or in any location that is visible, directly or indirectly, to the driver while operating the vehicle.

Monitor Operation



Product name	SWD-502630CS
 Key 1	Power key Switch on/off
 Key 2	① Confirm key ② Card insertion Start Pause key
 Key 3	① Enter menu Left selection ② reduce ③ Car ruler ④ In adjustment mode Position of the vehicle gauge
 Key 4	① Menu key ② Return key
 Key 5	① Enter menu Right Select ② plus ③ Short press to switch channels

Camera Size



Box Size

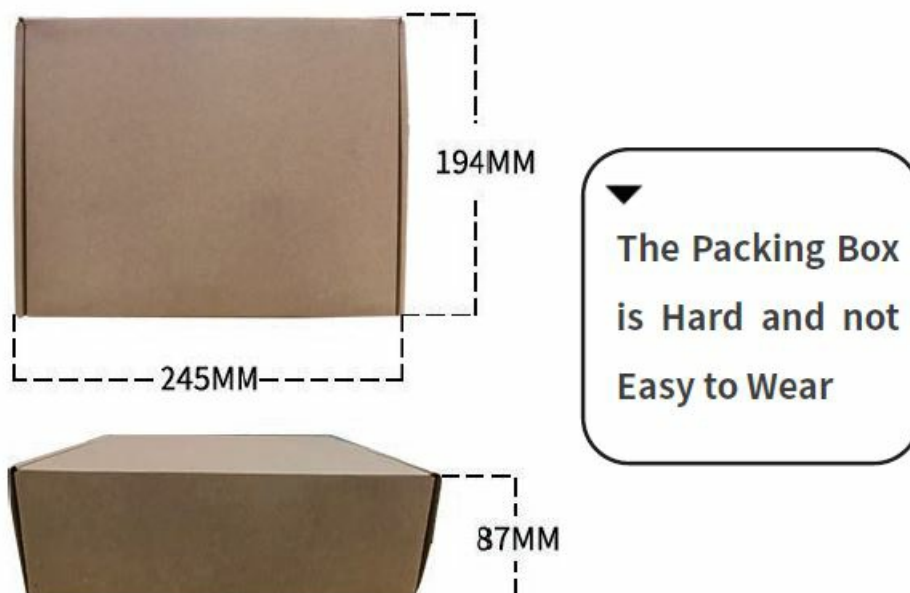

Installation Diagram

Monitor Installation

Choose a monitor location in your vehicle that does not block your view and complies with local laws for safe driving. Do not place in an area where it might interfere with driving.



Camera Placement Diagram

- Camera Installation Suitable Installation Position



Connection mode of accessories



The above is the correct connection mode. Please operate carefully during installation and removal to avoid damage

Pairing the Camera and Monitor

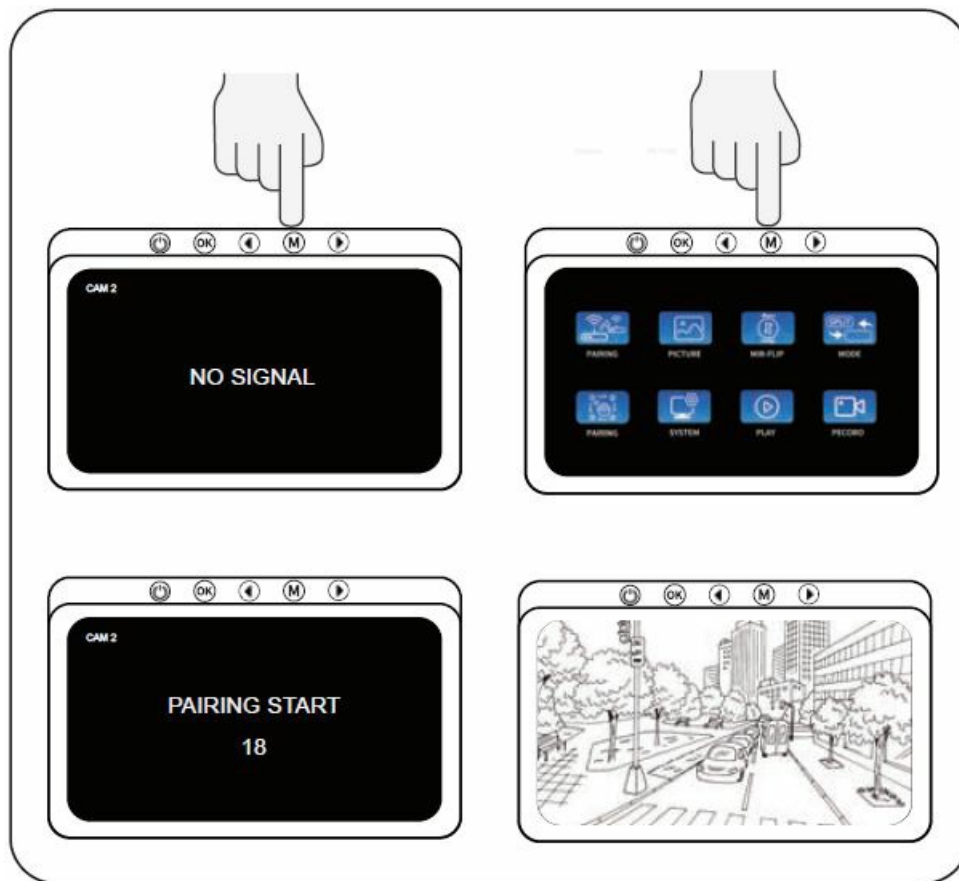

NOTE: when you need pairing, please confirm the circuit is properly connected and powered. If you need to pairing multiple cameras, please switch to the corresponding channel.

Specifications

Power Supply	DC12V to 36V
Wireless Frequency	2.4 GHz
Wireless Range	500m(open area)
Delaying Time	<200ms
Operating temperature	-20°C ~ 80°C

CAMERA

Image Sensor	1/3 inch
Waterproof Rating	IP 68
View Angle	100°[H] 130°[D]
Camera Pixel	1000TVL

MONITOR

LCD Size	5 inch IPS
Resolution	1280H) x 720(V)
Contrast	500:1
Brightness	500cd/
Response Time	25ms
Power Consumption	<500mA

Troubleshooting

Problem	Solution
Monitor Won't turn on	Check the cigarette lighter has 12V-36V DC Output Check the fuse in the Cigarette socket adapter
Camera and Monitor won't pair	Check if the camera is receiving power
	Make sure to follow the instructions to operate the Pairing
Weak Signal	Check if the camera and monitor antennas are installed
	Distance between camera and monitor is too great. Reduce distance between camera and monitor
	Large dense objects could be obscuring the signal. If possible, move the objects
	Interference from overhead power lines may be affecting the signal
	Try unpairing and pairing
Night Vision is poor	The night sensor on the camera may be dirty or obstructed
	Ensure the camera is installed at least 2 inches away from rear lights
Dark Picture	Check whether brightness and contrast are adjusted correctly

FCC Warning Statement

Changes or modifications not expressly approved by the party responsible for compliance could void the user's authority to operate the equipment. This equipment has been tested and found to comply with the limits for a Class B digital device, pursuant to Part 15 of the FCC Rules. These limits are designed to provide reasonable protection against harmful interference in a residential installation. This equipment generates uses and can radiate radio frequency energy and, if not installed and used in accordance with the instructions, may cause harmful interference to radio communications. However, there is no guarantee that interference will not occur in a particular installation. If this equipment does cause harmful interference to radio or television reception, which can be determined by turning the equipment off and on, the user is encouraged to try to correct the interference by one or more of the following measures:

- Reorient or relocate the receiving antenna.
- Increase the separation between the equipment and the receiver.
- Connect the equipment into an outlet on a circuit different from that to which the receiver is connected.
- Consult the dealer or an experienced radio/ TV technician for help.

This device complies with part 15 of the FCC Rules. Operation is subject to the following two conditions: (1) This device may not cause harmful interference, and (2) this device must accept any interference received, including interference that may cause undesired operation.

Documents / Resources

	<p>SunveyTech SWD-M502630CS Digital Wireless Backup Camera System [pdf] User Manual SWD-M502630CS Digital Wireless Backup Camera System, SWD-M502630CS, Digital Wireless Backup Camera System, Wireless Backup Camera System, Backup Camera System, Camera System</p>
---	---

[Manuals+.](#)