



ST-LS-WW-4P-SKP
SPOT LIGHT



SUNTHIN ST-LS-WW-4P-SKP Spot Light User Manual

[Home](#) » [SUNTHIN](#) » SUNTHIN ST-LS-WW-4P-SKP Spot Light User Manual 

Contents

- 1 [SUNTHIN ST-LS-WW-4P-SKP Spot Light](#)
- 2 [INTRODUCTION](#)
- 3 [SPECIFICATIONS](#)
- 4 [WHAT'S IN THE BOX](#)
- 5 [FEATURES](#)
- 6 [SETUP GUIDE](#)
- 7 [CARE & MAINTENANCE](#)
- 8 [TROUBLESHOOTING](#)
- 9 [PROS & CONS](#)
- 10 [WARRANTY](#)
- 11 [FREQUENTLY ASKED QUESTIONS](#)
- 12 [References](#)



SUNTHIN ST-LS-WW-4P-SKP Spot Light



INTRODUCTION

A premium outdoor lighting option, the SUNTHIN ST-LS-WW-4P-SKP Spot Light is made to improve your patio, garden, or landscape. This spot light, which uses LED technology, gives any outdoor area a warm, inviting atmosphere with its 2700K warm white illumination. The SUNTHIN Spot Light is powered by corded electricity and is designed to be weatherproof and durable, providing a steady and dependable illumination experience.

This energy-efficient light provides outstanding visibility with a brightness of 480 lumens, a 12-watt power rating, and a CRI of 80. It provides convenience and smart lighting adjustment using an app. This product, which retails for \$29.96, was initially introduced by SUNTHIN on October 10, 2020. It is an excellent investment for anyone wishing to improve their outdoor lighting system because it comes with a one-year manufacturer guarantee.

SPECIFICATIONS

Brand	SUNTHIN
Price	\$29.96
Power Source	Corded Electric
Control Method	App
Light Source Type	LED
Voltage	120 Volts
Wattage	12 Watts
Brightness	480 Lumen
Color Temperature	2700 Kelvin
Color Rendering Index (CRI)	80
Product Dimensions	46 x 1.7 x 8.6 inches
Weight	2.2 Pounds
Warranty Type	1 Year
Date First Available	October 10, 2020
Manufacturer	SUNTHIN

Low Voltage Landscape Spotlights



WHAT'S IN THE BOX

- Spot Light
- User Manual

FEATURES

- **LED Technology That Is Integrated:** Long-lasting illumination is provided by the integrated, premium LED chips, negating the need to change lightbulbs.
- **Warm White Glow:** This 2700K warm white light is ideal for ornamental lighting, gardens, and outdoor landscapes.
- **Lighting That Is Balanced and Free of Glare:** A better lens guarantees even illumination without severe glare or eye strain.
- **Energy-Efficient:** Each spotlight has a brightness of 480 lumens while using less power than conventional lighting.
- **Plug-and-Play Architecture:** Includes wires and a transformer, making installation quick and easy.
- **Adjustable Head:** With its 270° rotation, you can precisely position the lights to emphasize objects like flower beds, trees, walls, and flags.
- **Waterproof and Weather-Resistant (IP65 Rated):** Designed to endure rain, snow, frost, and sleet for all-season endurance.



- **Safe Low-Voltage Operation:** It is safe for houses, kids, and pets because it uses a low-voltage 120V system.
- **Wired for Stability:** These lights don't need sunlight to be bright, unlike solar-powered ones.
- **Modern & Slim Design:** Provides a sleek, contemporary appearance that complements driveways, walkways, and gardens.
- **Expandable and Connectable:** It has a waterproof twist connector that makes connections fast and safe.
- **Sturdy Construction:** Made from premium materials, this structure will withstand outdoor conditions for a long time.
- **Flexible Mounting Options:** Using the provided screws, it may be placed on walls, fences, and trees or staked into the ground.
- **App-Controlled Functionality:** For greater convenience when modifying lighting settings, this device is compatible with smart control apps.



SETUP GUIDE

- **Unpack the Kit:** Check that all four spotlights, the transformer, cables, connectors, and stakes are inside the packaging.
- **Choose an Installation Area:** Pick a spot that is clear of obstacles and has access to a power source.

Easy Installation

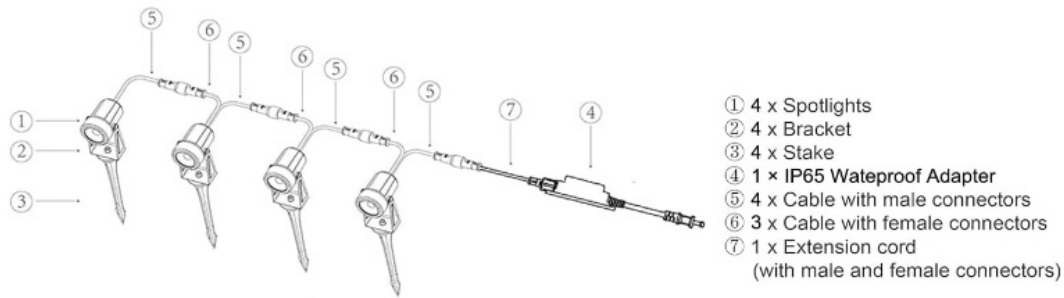
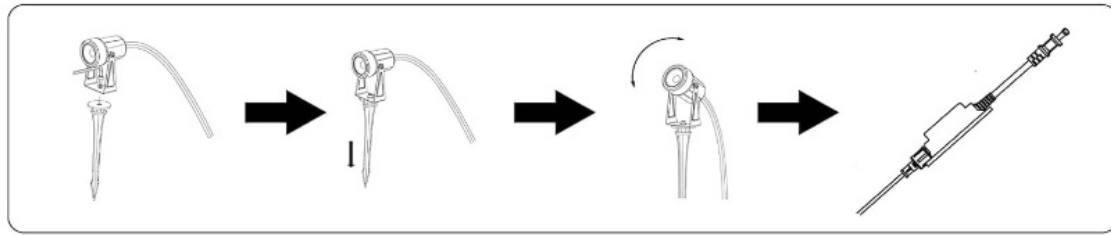

4 landscape spotlights must be connected in parallel

Transformer and Spot lights are IP65 waterproof for outdoor use.

- **Place the Spotlights:** Arrange each light so that your garden, walkways, or trees are as well-lit as possible.
- **Set Up the Stakes (For Ground Mounting):** To secure the spotlights, firmly drive the pegs into the earth.
- **Wall or Fence Mounting:** Mount the lights on walls, trees, or fences using the screws that come with the package.
- **Adjust the Angle:** To precisely direct light where it is needed, rotate the 270° adjustable head.
- **Connect the Lights:** Attach each spotlight to the main cable using the waterproof twist connectors.
- **Attach the Transformer:** Connect the transformer to a secure outdoor electrical outlet.
- **Secure the Wires:** To avoid trip hazards, keep cables buried a little or tucked along edges.
- **Turn on Power:** Check if the lights are working properly by turning on the low-voltage transformer.
- **Verify Even Lighting:** Adjust as necessary to guarantee adequate illumination and coverage.
- **Test Under Various Conditions:** Check how the lights work at night and make any necessary adjustments.
- **Use Smart Control:** Download and connect the app if the lights have one.
- **Verify Waterproof Seals:** To keep moisture out, make sure all connectors are securely sealed.
- **Savor Your Outdoor Ambiance:** The SUNTHIN spotlights have been placed, adding cozy lighting to your garden or yard.

CARE & MAINTENANCE

- **Clean the Lenses Regularly:** Maintain optimal brightness by removing dust, grime, and debris.
- **Periodically Check the Cables:** To avoid electrical problems, check the cables for wear or damage.
- **Secure Loose Fixtures:** Make sure the fixtures are stable and the screws are snug if they are mounted on walls.

- **Prevent Water Damage:** Verify that all waterproof connectors are correctly sealed.
- **Reposition After Storms:** Strong winds or rain might cause the lights to move.
- **Avoid Overloading the Transformer:** To keep the transformer from overheating, only connect the recommended number of lights.
- **Check for Dim Lighting:** If the lights seem faint, inspect for debris accumulation on the lens or ensure the transformer is operating correctly.
- **Use Weatherproof Outlet Covers:** Shield power sources from precipitation and severe weather.
- **Test Functionality Every Month:** Turn on all lights at night to make sure they are operating correctly.
- **Replace Defective Units Under Warranty:** Benefit from the manufacturer’s one-year replacement warranty.
- **Avoid Flood-Prone Areas:** Prolonged standing water exposure can impair performance.
- **Properly Secure Underground Wires:** To avoid damage, use protective tubing while burying wires.
- **Unplug During Extended Absences:** To prolong longevity, unplug the device if you will be gone for an extended amount of time.
- **Verify Smart App Connection:** If using app control, ensure it is properly connected for seamless operation.
- **Enjoy Long-Term Performance:** These LED spotlights will offer years of effective outdoor lighting if properly maintained.

TROUBLESHOOTING

Issue	Possible Cause	Solution
Light does not turn on	Power outlet issue	Check if the outlet is working and properly connected
Flickering light	Loose connection	Ensure the cord is securely plugged in
Dim light output	Dust accumulation	Clean the light cover and LED panel
App not connecting	Bluetooth/Wi-Fi issue	Restart the app and re-pair the device
Uneven lighting	Improper installation	Adjust the light’s positioning for better coverage
Light turns off unexpectedly	Power surge	Use a surge protector or check wiring
Not bright enough	Distance too far	Position the light closer to the target area
Overheating	Poor ventilation	Ensure the area around the light is well-ventilated
Short lifespan	Voltage fluctuations	Use a stable power source with the correct voltage
Water damage	Exposure to heavy rain	Ensure proper sealing and positioning

PROS & CONS

Pros	Cons
Energy-efficient LED lighting	Requires a corded power connection
Warm white illumination (2700K)	No color-changing feature
Smart app control for convenience	Not battery-powered
Weather-resistant and durable	Limited brightness adjustment
Easy installation and setup	May require additional extension cables

WARRANTY

The SUNTHIN ST-LS-WW-4P-SKP Spot Light comes with a **1-year manufacturer warranty**, covering defects in materials and workmanship. If any issues arise within the warranty period, customers can contact SUNTHIN for repairs, replacements, or refunds, depending on the issue.

FREQUENTLY ASKED QUESTIONS

Why is my SUNTHIN ST-LS-WW-4P-SKP Spot Light not turning on?

Ensure the light is properly plugged into a functional power outlet and check the app settings if using remote control features.

Why is the SUNTHIN ST-LS-WW-4P-SKP Spot Light flickering?

Flickering may indicate a loose power connection or voltage fluctuations. Try securing the plug and using a different outlet.

Why is my SUNTHIN ST-LS-WW-4P-SKP Spot Light dimmer than usual?

The brightness settings may have been adjusted in the app. Check the app control and restore it to full brightness.

Why does the SUNTHIN ST-LS-WW-4P-SKP Spot Light turn off unexpectedly?

This could be due to overheating or a power surge. Ensure the power source is stable and allow the unit to cool before turning it back on.

Why is my SUNTHIN ST-LS-WW-4P-SKP Spot Light unresponsive to the app?

Ensure your device is properly connected to the same network as the light and restart both the app and the light for troubleshooting.

What is the price of the SUNTHIN ST-LS-WW-4P-SKP Spot Light?

The SUNTHIN ST-LS-WW-4P-SKP Spot Light is priced at \$29.96.

What is the voltage requirement for the SUNTHIN ST-LS-WW-4P-SKP Spot Light?

The spot light operates on 120 volts.

How many watts does the SUNTHIN ST-LS-WW-4P-SKP Spot Light consume?

It has a wattage of 12 watts, making it energy-efficient.

References

- [User Manual](#)

[Manuals+](#), [Privacy Policy](#)

This website is an independent publication and is neither affiliated with nor endorsed by any of the trademark owners. The "Bluetooth®" word mark and logos are registered trademarks owned by Bluetooth SIG, Inc. The "Wi-Fi®" word mark and logos are registered trademarks owned by the Wi-Fi Alliance. Any use of these marks on this website does not imply any affiliation with or endorsement.