



SUNSKY TB-1718 Multi-Function Massager Instruction Manual

[Home](#) » [sunsky](#) » SUNSKY TB-1718 Multi-Function Massager Instruction Manual 

SUNSKY TB-1718 Multi-Function Massager



Contents

- 1 Safety Instructions:
- 2 Device Specifications:
- 3 Device Description:
- 4 Preparation Instructions:
 - 4.1 Install the batteries
 - 4.2 Disassemble Accessory Heads
 - 4.3 Intensity Level Adjustment
- 5 How to Use:
 - 5.1 Head Massage
 - 5.2 Facial Cleansing
- 6 Cleaning & Maintenance:
- 7 Storage:
- 8 Recycling:
- 9 Warranty & Support:
 - 9.1 Troubleshooting
 - 9.2 After-Sales Service
- 10 Documents / Resources
- 11 Related Posts

Safety Instructions:

To ensure proper and safe operation of this device, please read the instruction manual carefully and keep it for further reference.



WARNING

- The following persons should not use this device: pregnant women or while nursing; persons with allergies; persons with neurological or perceiving disabilities; persons who have had hair transplants; persons with open wounds, chapped or swollen skin on the area of use; persons with existing scalp diseases, such as hereditary dermatitis, seborrheic dermatitis, and eczema; persons with acute disease or malignant tumors; persons with a bleeding disorder, hemophilia, and other diseases; persons with hypertension, etc.
- Do not apply pressure on your skin or move the device too fast to prevent injuries.
- Do not overuse the device to avoid injury the scalp.
- Please verify the device before you start using it. Do not use if there is any damage.
- Immediately stop using the device and consult a doctor if you feel any discomfort on the head or body.
- Do not attempt to disassemble, repair or modify the device by yourself to avoid accidents.



CAUTION

- This device is not a toy, keep out of reach of children.
- Regularly clean the device and the accessories to extend its lifetime.
- Do not share the same device with others.
- If you do not intend to use the device for a long time, remove the batteries

Device Specifications:

- Name: Multi-Function Massager
- Model No.: TB-1718
- Power: 3V /2.4W
- Type of Battery: AA x 2 (Not Included)
- Executive Standard: Q/XMMJ1001-2015 Q/XMMJ1019-2016

Device Description:

- ① Scalp Massage Head
- ② Power/Intensity Button
- ③ Battery Cover Remove Point
- ④ Battery Cover
- ⑤ Facial Cleansing Brush Head
- ⑥ Soft Scalp Massage Head

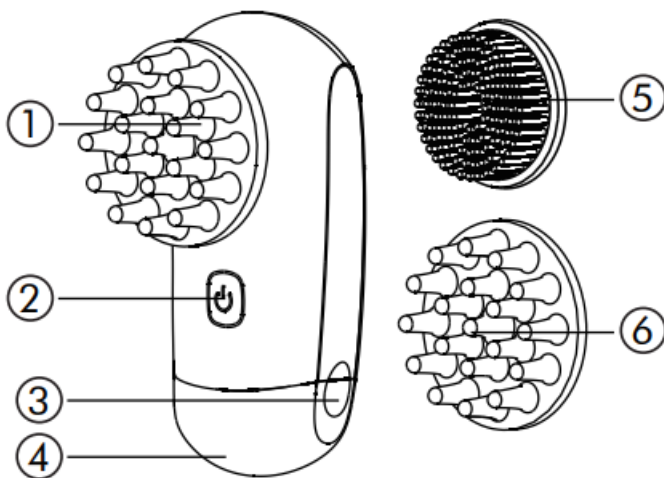

Picture 1

Preparation Instructions:

Install the batteries

- Hold the device with the back facing up and remove the battery cover. Insert two AA batteries according to the battery compartment + and – instructions (batteries are not included). **(Picture 2)**

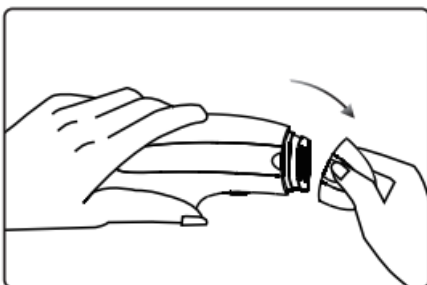

Picture 2

Disassemble Accessory Heads

- Attach the facial cleansing brush head or the scalp massage head to the device. Press it until it snaps in place with a 'click'. To remove the head, hold the device and pull the head to remove. **(Picture 3)**

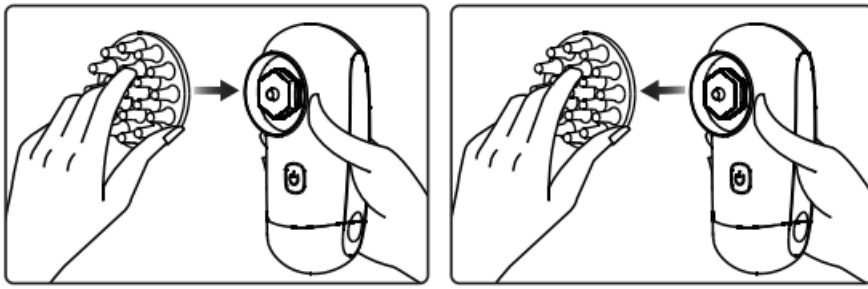

Picture 3

Intensity Level Adjustment

- Press the power/intensity button to turn on the device. Press and hold the power/intensity button to gradually increase the intensity level. To gradually decrease the intensity level, press and hold the power/speed button. Adjust the intensity level according to your needs.

How to Use:

To ensure the correct operation of this device, please read the instructions carefully before use.

Head Massage

1. Choose and install the preferred accessory head. Short press the power/intensity button to turn on the device.
2. Gently place the massage head on the scalp. According to your needs, press and hold the power/intensity button to adjust the intensity level. Slowly move the massage head to massage the scalp.
3. Using sequence and instructions:
 - Front Area of the Head: Gently press the massage head on the scalp, and slowly move it from the hairline to the crown of the head, repeat 2-3 times. (Picture 4)
 - Left & Right Side of the Head: Gently press the massage head on the scalp, and slowly move it from the hairline to the crown of the head, repeat 2-3 times. When using the device on the right side of the head, hold it with your right hand to massage. When using the device on the left side of the head, hold it with your left hand to massage. (Picture 5)
 - Back Area of the Head: Gently press the massage head on the scalp, and slowly move it from the crown of the head towards the nape, repeat 2-3 times. (Picture 6)
4. After use, short press the power/intensity button to turn off the device.



Picture 4



Picture 5

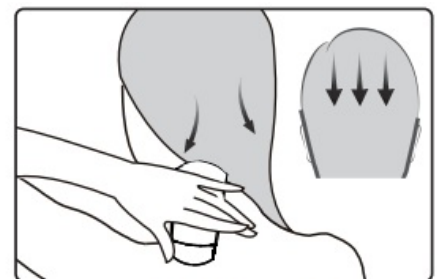

Picture 6

Facial Cleansing

1. Install the facial cleansing brush head and moisten the face with water.
2. Short press the power/intensity button to turn on the device, and adjust the intensity level according to your needs. Apply cleansing gel/cream to the palm of one hand, wet it with water, with the other hand hold the device and rub the brush on the cleansing gel/cream to form a foam.
3. Apply the foam to the face, and gently move the brush head in a circular motion from inside to outside of the face. Recommended cleaning area, order and using time: T-zone (forehead, nose area) 20s → left and right cheeks 15s each (total 30s) → chin 10s → neck 30s. (Picture 7)
4. After your cleansing routine is complete, turn off the device, rinse your face with water, and apply your daily skincare products.
5. After each use, wash the brush head with clean water and allow it to dry in a well-ventilated place. Wipe the device body with a clean slightly wet cloth

Cleaning & Maintenance:

1. Make sure the device is turned off before you start cleaning it.
2. Clean the device body with a clean slightly wet cloth and dry it. Do not immerse the device in water.
3. Wash accessory heads with water and allow it to dry in a well-ventilated place. Do not dry in direct sunlight.
4. Never use lubricants, detergents, polishing agents or air fresheners on this device.
5. When cleaning the accessory heads, do not use water that is higher than 40°C or corrosive liquids to clean.
6. It is recommended to replace the brush head every 3 months. Brush heads are only suitable for TOUCHBeauty's Multi-Function Massager.

Storage:

This device is battery-operated. Do not place or store the device for long periods under a hot or humid environment. If you do not intend to use the device for a long time, remove the batteries.

Recycling:

Batteries contain substances that may pollute the environment. When disposing of this device, do not put it in the general household waste. Please dispose of this device and batteries in an official recycling point to contribute to environmental protection.

Warranty & Support:

Troubleshooting

Problem	Possible Cause	Solution
Device does not work properly.	Batteries are running low or out of power.	Replace the batteries as instructed.
	Batteries are installed incorrectly.	Install the batteries correctly as instructed.
Excessive or abnormal noise.	Accessory head is installed incorrectly	Turn off the device and install the accessory head correctly as guided.
Other problems		Please consult your local dealer.
Note: If the device still does not work properly after using the above solutions, please stop using the device and contact your local dealer.		

After-Sales Service

Please visit our website www.touchbeauty.com or contact our customer service team customer@touchbeauty.com if you need to learn about our products or if you need any information. You can also contact an affiliate dealer in your country

MANUFACTURER: TOUCHBEAUTY BEAUTY & HEALTH (SHENZHEN) CO., LTD

ADDRESS: 601 & 602, Block F5, TCL International E-City, 1001 Zhongshanyuan Road, Shuguang Community, Xili Subdistrict, Nanshan District, Shenzhen, China.



Documents / Resources

	SUNSKY TB-1718 Multi-Function Massager [pdf] Instruction Manual TB-1718 Multi-Function Massager, TB-1718, Multi-Function Massager, Function Massager, Massager
---	---