



# Sunrise Connect Box 1 Device User Guide

[Home](#) » [Sunrise](#) » Sunrise Connect Box 1 Device User Guide 





## Contents

- [1 Quick Install Guide](#)
- [2 INSTALLATION](#)
- [3 Documents / Resources](#)
  - [3.1 References](#)
- [4 Related Posts](#)

## Quick Install Guide

### Content



<b>Connect Box Kabel A</b>	 A black cable with a grey and blue connector at one end.
<b>LAN-Kabel</b>	 A grey cable with RJ45 connectors at both ends.

**Netzteil**

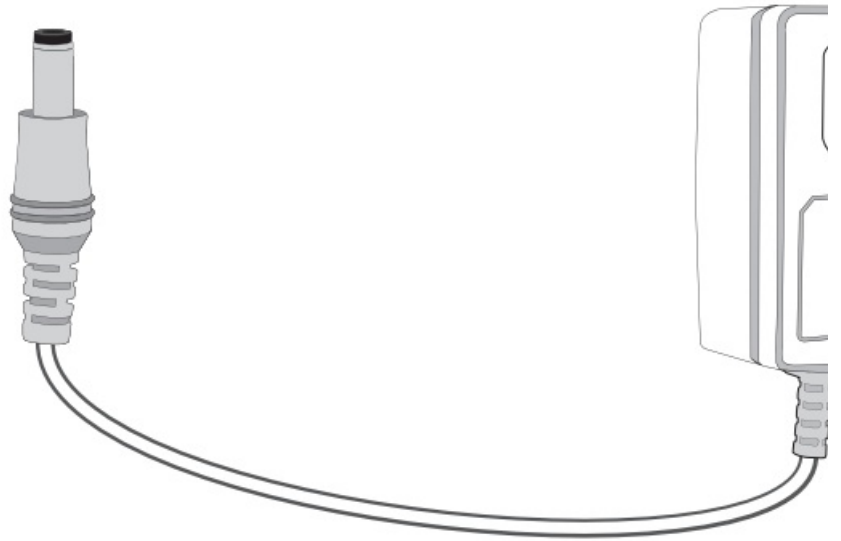

**Connect Box Kabel B**



**Connect Box 1**

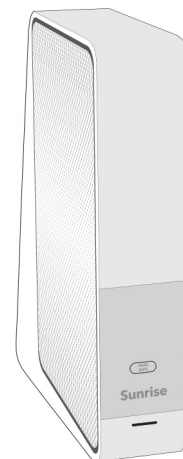



## Your new Connect Box 1!

Your extraordinary internet experience is only 4 steps away. Follow the steps on the next page to set up your Connect Box 1 and get all your devices connected. More info is available at: [sunrise.ch/cb1](https://sunrise.ch/cb1)



### Give your Connect Box 1 enough space

The Connect Box 1 is a free spirit and likes a lot of space. Always position it upright and make sure that the front is facing into the room because the signal comes from the front and top of the Connect Box 1. So don't hide your Connect Box 1 in a cupboard or behind your T V.

## INSTALLATION

1. Remove any pre-installed cables and adapters



Use only the new cables included in the delivery for installation.

2. Attach Connect Box cable A / B

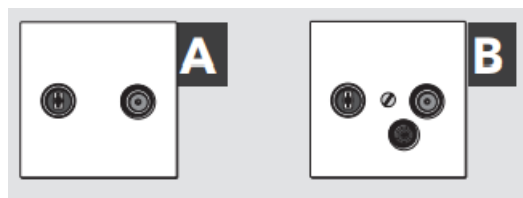

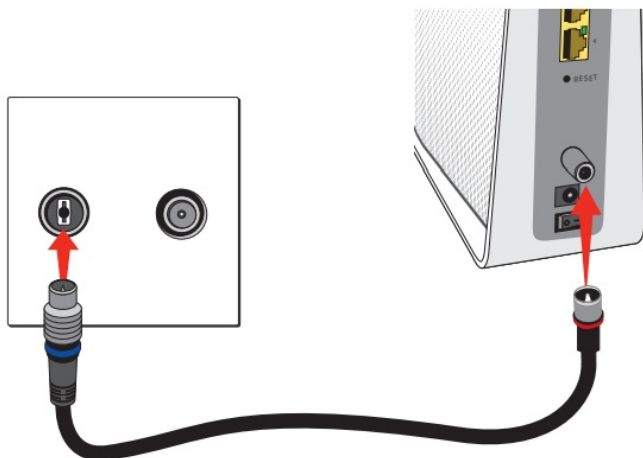
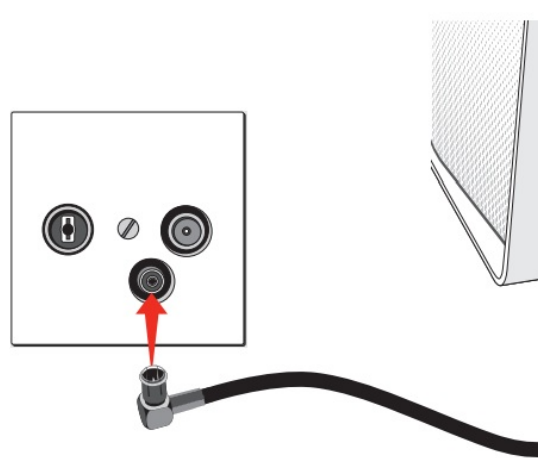
**OPTION A****OPTION B**

3. Plug in the power supply unit

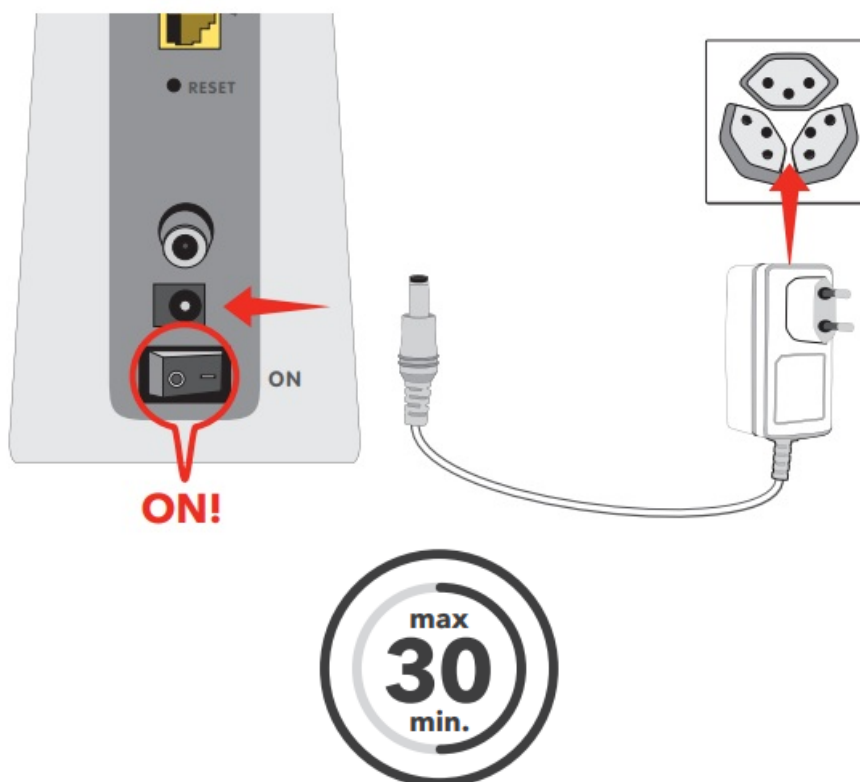

LED lights up white when OK

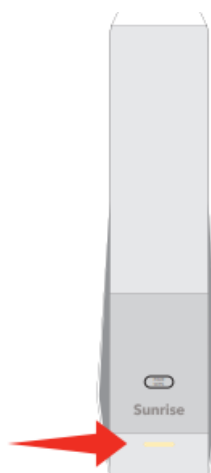

#### 4. Connect to the Internet

##### OPTION LAN

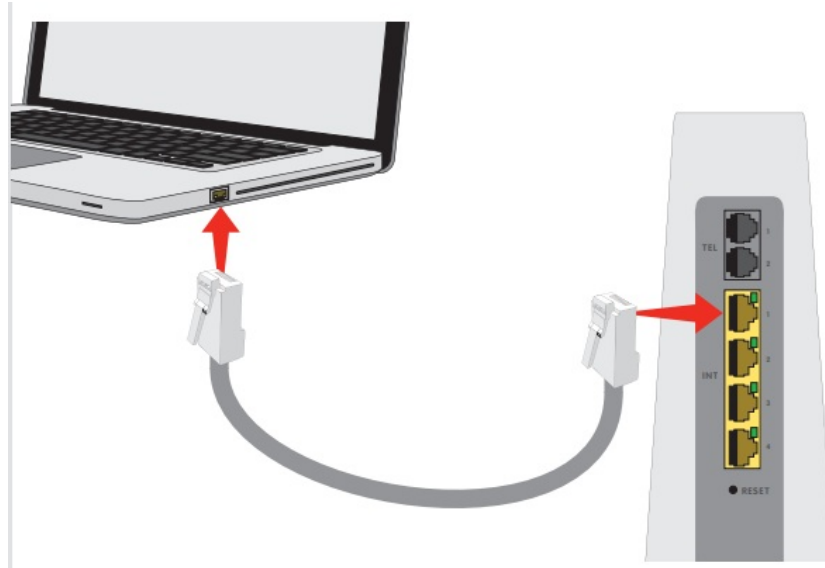

##### OPTION WIFI

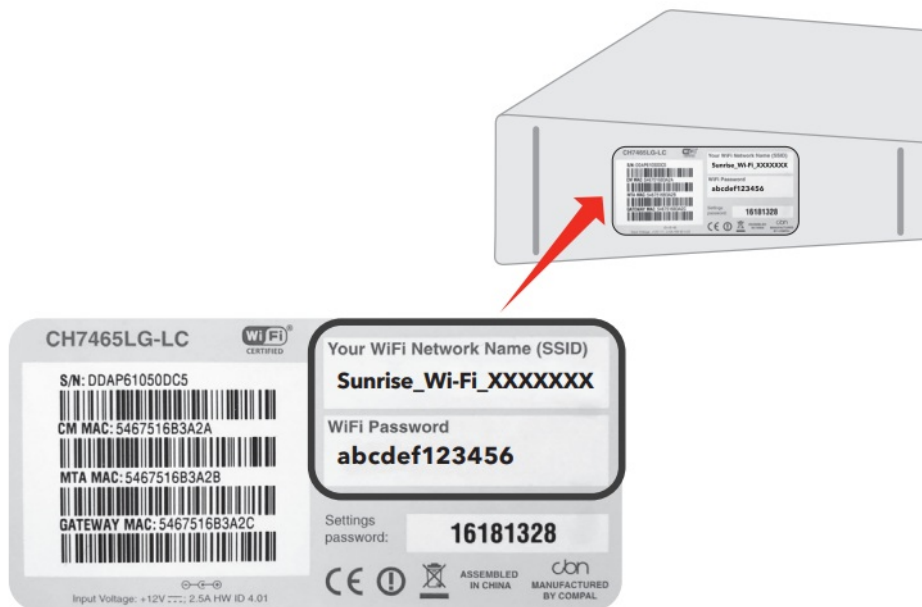

##### Underside of Connect Box 1



For a stable connection without interruptions, use the LAN cable for short distances.

#### 5. (Optional) Connect your phone right after receiving your activation confirmation (via email/SMS).



LED lights up green when OK

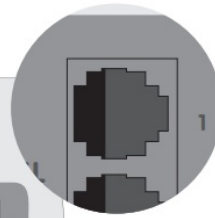
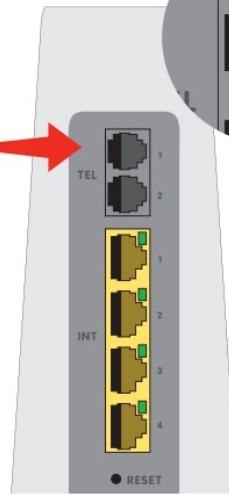

TEL 1

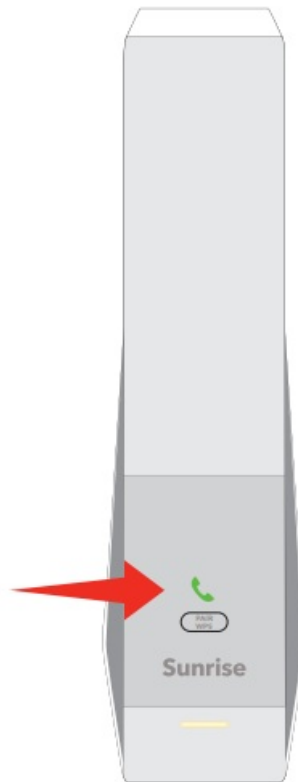

91001  
Sunrise\_1.0

## Documents / Resources



[Sunrise Connect Box 1 Device](#) [pdf] User Guide  
Connect Box 1, Device, Connect Box 1 Device

## References

- [!\[\]\(cd3e54d951a9fb854f48e4697cf550f9\_img.jpg\) Connect Box 1 – Setup & troubleshooting | Sunrise Help](#)
- [!\[\]\(cc729e263f29c0a76fbdc4cfe67fceb0\_img.jpg\) Sunrise help: FAQ, instructions, configuration, information about devices – Sunrise](#)

Manuals+.