



# DMX512 Dual Color Controller



## Sunricher DMX512 Dual Color Controller Instructions

[Home](#) » [SUNRICHER](#) » Sunricher DMX512 Dual Color Controller Instructions 

### Contents

- 1 Sunricher DMX512 Dual Color Controller
- 2 Product Information
- 3 Product Usage Instructions
- 4 Function introduction
- 5 DIMENSION
- 6 Product Data
- 7 FEATURES
- 8 Safety & Warnings
- 9 Installation
- 10 Wiring diagram
- 11 Set DMX Address
- 12 Documents / Resources
  - 12.1 References



Sunricher DMX512 Dual Color Controller



## Product Information

### Specifications:

- **Product Name:** Dual Color DMX512 Controller
- **Model Number:** 09.28BDU.04186
- **Dimensions:** 75x120x29.1mm
- **Total Zones:** 4
- **Power Supply:** 12-24VDC
- **Output Signal:** DMX512

## Product Usage Instructions

### Function Introduction:

Dual color & brightness slider, click to switch between 100% WW+0% CW and 0% WW+100% CW. Click to turn on/off at 100% brightness. Press and hold down to save color; click to recall the saved setting. Click to switch between dual color control or brightness control.

Total of 4 zones are available. Click to choose a zone; press and hold down to turn on/off the corresponding zone at 0% brightness.

### Wiring Diagram:

Refer to the wiring diagram provided in the manual for proper installation.

### Installation:

1. Connect the DC Input and DMX Output as per the wiring diagram.
2. Set the DMX address for controlling different zones as mentioned in the user manual.

### Connecting with Dual Color LED Strip:

Follow the wiring instructions to connect the controller with a dual-color LED strip.

## FAQs

- **How do I set the DMX address for controlling different zones?**

To set the DMX address, follow the instructions provided in the user manual. Assign specific addresses to DMX decoders for each zone – 001 for zone 1, 005 for zone 2, 009 for zone 3, and 013 for zone 4.

**Important:** Read All Instructions Before Installation.

## Function introduction

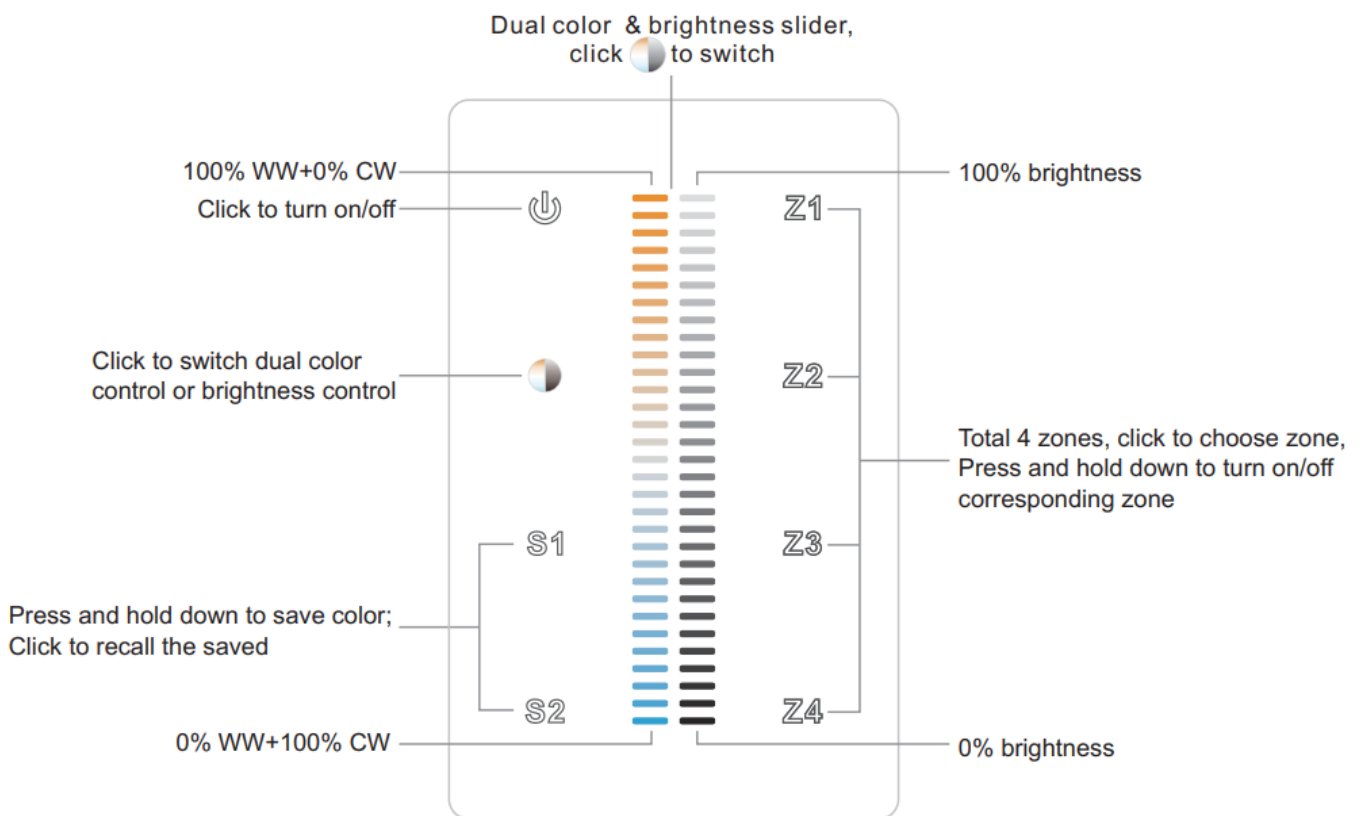

## DIMENSION

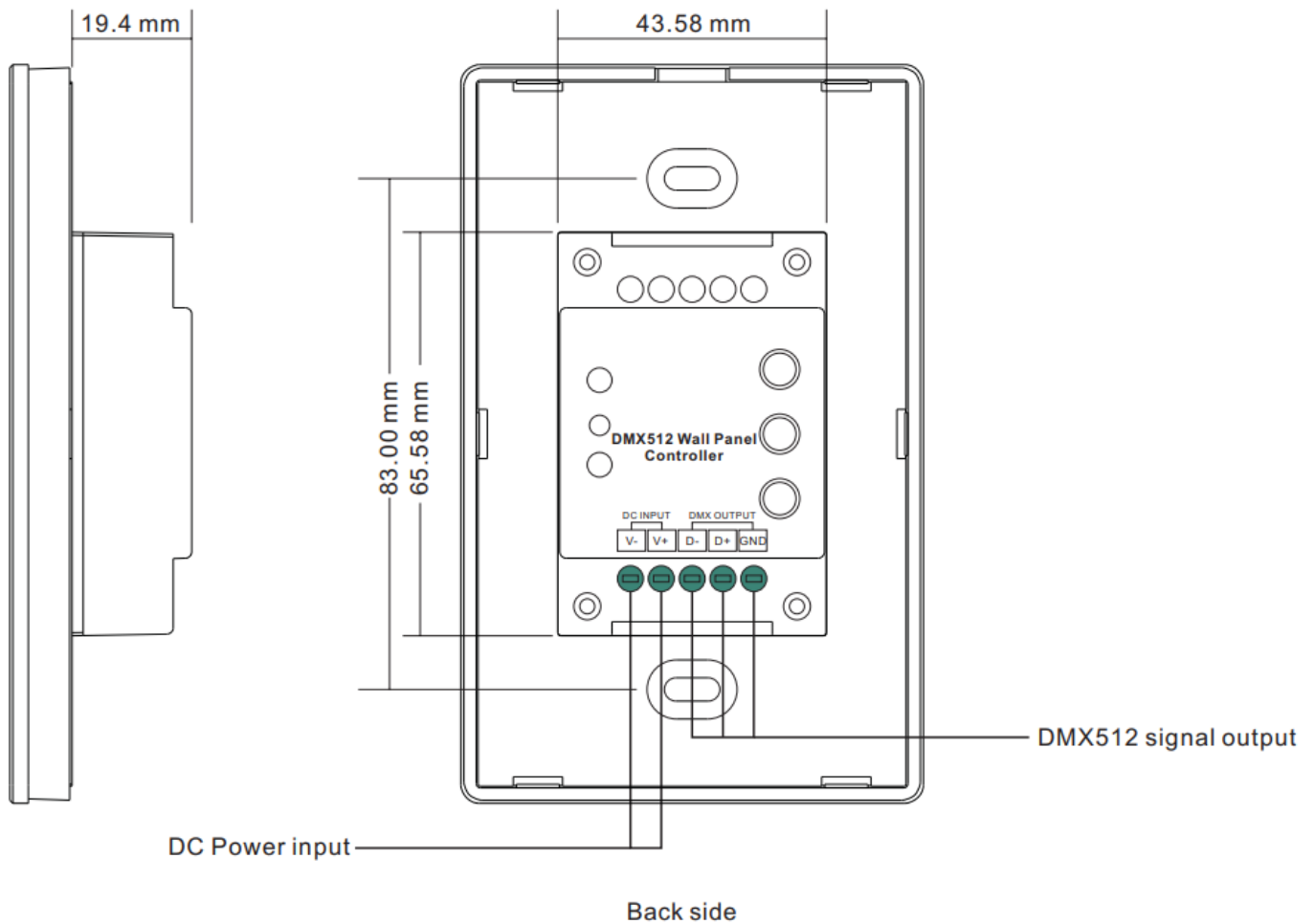

## Product Data

- **Output Signal:** DMX512 signal
- **Power Supply:** 12-24VDC
- **Power consumption:** < 20 mA
- **Operating temperature:** 0-40°C
- **Relative humidity:** 8% to 80%
- **Dimensions:** 75x120x29.1mm

## FEATURES

- Touch-sensitive
- Glass interface(white & black)
- Standard DMX512 Signal output
- Control CCT color
- Control 4 zones synchronously and separately
- Waterproof grade: IP20

## Safety & Warnings

- DO NOT install with power applied to the device.
- DO NOT expose the device to moisture.

**Installation**

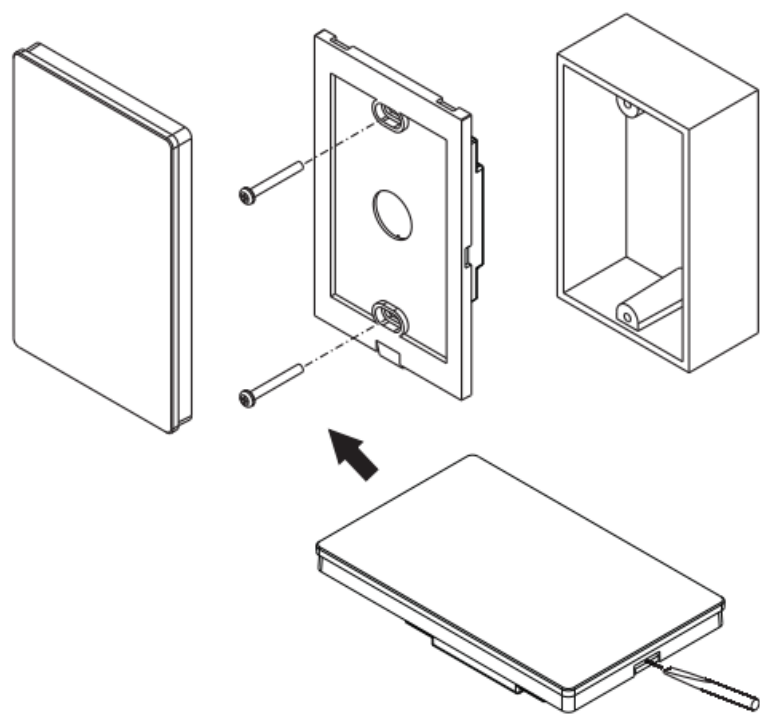

**Wiring diagram**

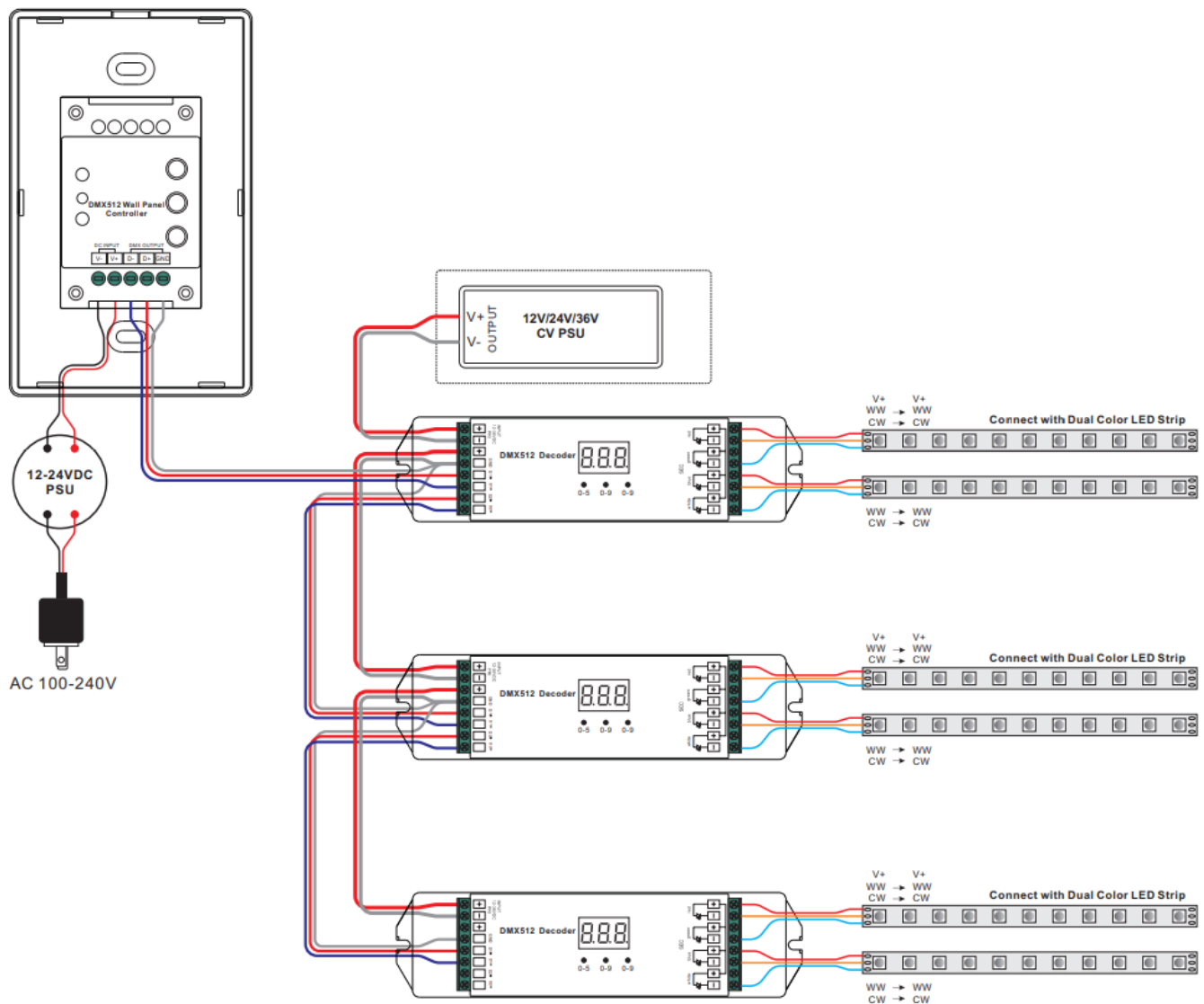

## Set DMX Address

- This DMX master controller controls 4 zones of DMX decoders by setting DMX decoders' address as follows:
  - DMX decoders with address 001 will be controlled by zone 1,
  - DMX decoders with address 005 will be controlled by zone 2,
  - DMX decoders with address 009 will be controlled by zone 3,
  - DMX decoders with address 013 will be controlled by zone 4.

## Documents / Resources

	<p><a href="#">Sunricher DMX512 Dual Color Controller</a> [pdf] Instructions          2830BDMXUS, 09.28BDU.04186, DMX512 Dual Color Controller, DMX512, Dual Color Controller, Color Controller, DMX512 Controller</p>
--	--

## References

- [User Manual](#)

This website is an independent publication and is neither affiliated with nor endorsed by any of the trademark owners. The "Bluetooth®" word mark and logos are registered trademarks owned by Bluetooth SIG, Inc. The "Wi-Fi®" word mark and logos are registered trademarks owned by the Wi-Fi Alliance. Any use of these marks on this website does not imply any affiliation with or endorsement.