



## sunmi V2 Wireless Data POS System User Guide

[Home](#) » [SUnmi](#) » sunmi V2 Wireless Data POS System User Guide 

# SUNMI

V2 Wireless Data POS System  
User Guide

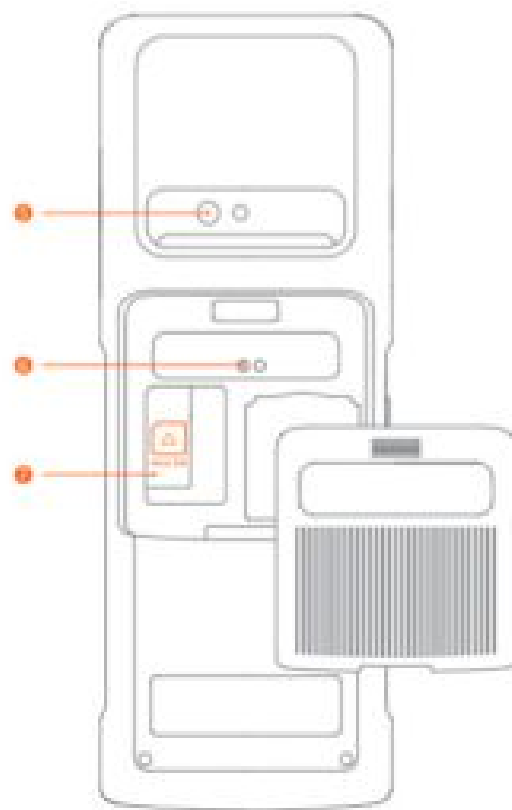
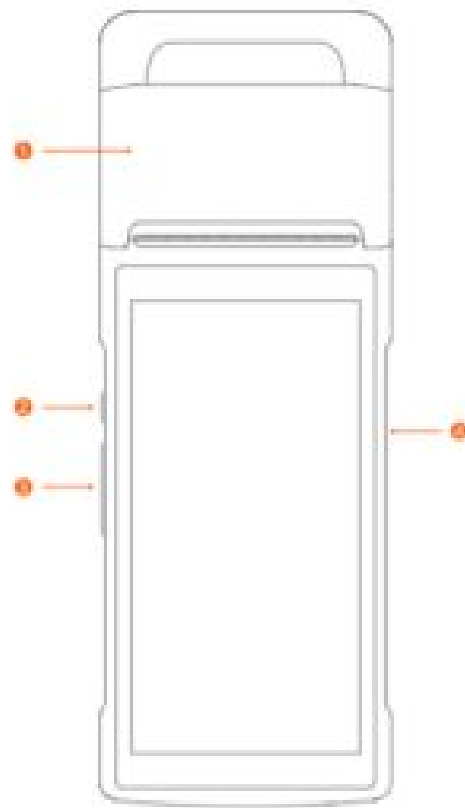

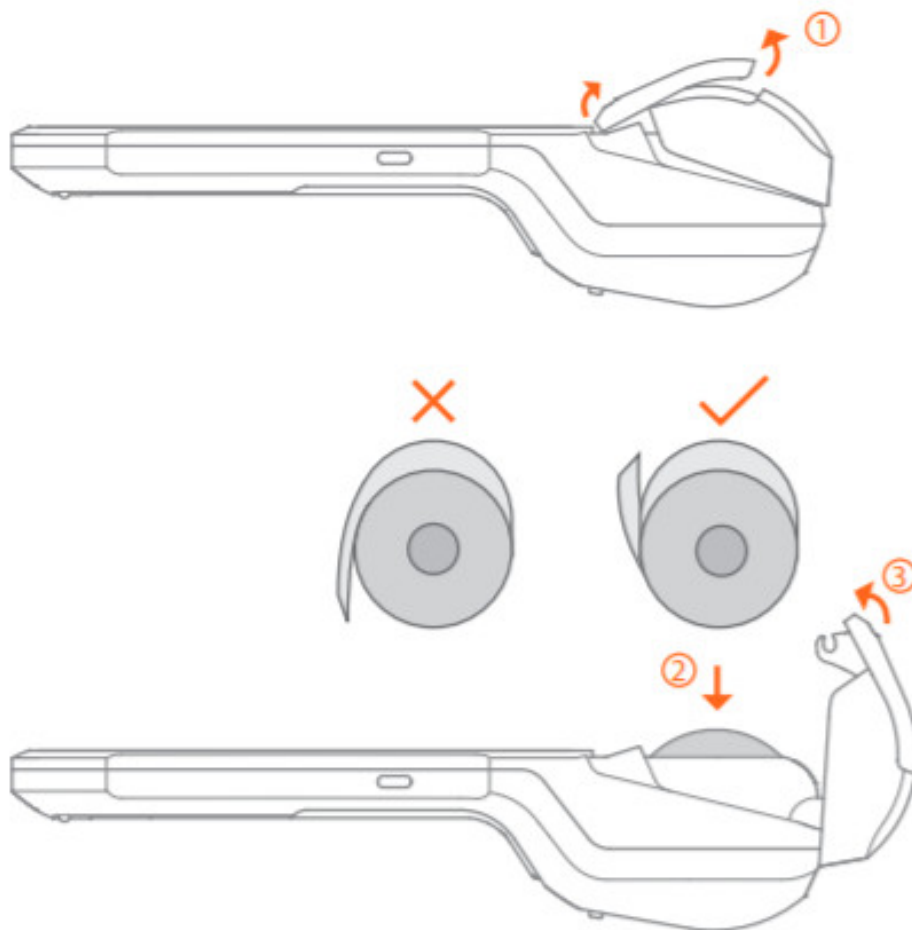

## Contents

- [1 Quick start](#)
- [2 Printing instructions](#)
  - [2.1 Safety Warning](#)
- [3 Significant Safety Instructions](#)
- [4 Suggestions](#)
- [5 Statements](#)
- [6 Disclaimer](#)
- [7 Technical features and characteristic](#)
- [8 Documents / Resources](#)
- [9 Related Posts](#)

## Quick start

### 1. Printer

For printing, sales slips in power-on mode.

### 2. Power button

Short press: wake up the screen, lock the screen.

Long press: long press for 2-3 seconds in power of mode to switch on the device.

Long press for 2-3 seconds in normal operation mode to select the power off or reboot.

Long press for 11 seconds when the system is frozen for automatic reboot.

### 3. Volume key

Volume adjustment.

#### 4. Type-C USB

For device recharging and developer debugging.

#### 5. Camera

For payment scanning and 1D/2D code quick scanning.

#### 6. Extended interface

Used to connect the base (this accessory needs to be purchased separately).

#### 7. SIM Card Slot

Note: To prevent system errors, please make sure the device is turned off when you insert or remove the SIM card.

### Printing instructions

This device supports 58mm thermal paper with the specifications of 57±0.5mm\*Ø50mm.

1. Please open the paper container with the uncovering handle. Please do not force open the paper container to avoid print headgear wear;
2. Feed the paper correctly into the paper container in the direction as shown, and pull some paper outside the cutter;
3. Close the cover of the paper container to finish printing paper feeding.

**Note:** If the printed paper is blank, please check whether the paper roll has been installed in the correct direction.  
Table for Names and Content Identification of Toxic and Hazardous Substances in this Product

Part Name	Toxic or Hazardous Substances and Elements									
	Pb	Hg	Cd	Cr(VI)	PBB	PBDE	DEEP	DBP	BBP	DIP
Circuit Board Component	X	0	0	0	0	0	0	0	0	0
Structural Component	0	0	0	0	0	0	0	0	0	0
Packaging Component	0	0	0	0	0	0	0	0	0	0

0 indicates that the content of the toxic and hazardous substance in all homogeneous materials of the component is below the limit specified in SJ/T 11363-2006.

× indicates that the content of the toxic and hazardous substance in at least one homogeneous material of the component exceeds the limit stipulated in SJ/T

11363-2006. However, for this reason, there is no mature and replaceable technology in the industry at present.

The products that have reached or exceeded environmental protection service life should be recycled and reused according to the Regulations on Control and Management of Electronic Information Products, and should not be discarded randomly.

### Notices

#### Safety Warning

Connect the AC plug to the AC socket corresponding to the marked input of the power adapter; To avoid injury, unauthorized persons shall not open the power adapter;

This is a Class A product. This product may cause radio interference in living environments.

In that case, the user may be required to take adequate measures against interference.

Battery replacement:

1. Explosion danger may arise if replaced with the wrong battery!
2. The replaced battery shall be disposed of by maintenance personnel, and please do not throw it into ours!

## **Significant Safety Instructions**

Do not install or use the device during lightning storms to avoid the potential risks of lightning shock;

Please turn off the power immediately if you notice an abnormal odor, heat or smoke;

The paper cutter is sharp, please do not touch it!

## **Suggestions**

- Do not use the terminal near water or moisture to prevent liquid from falling into the terminal;

Do not use the terminal in extremely cold or hot environments, such as near flames or lit cigarettes;

Do not drop, throw or bend the device;

Use the terminal in a clean and dust-free environment if possible to prevent small items from falling into the terminal;

Please do not use the terminal near medical equipment without permission.

## **Statements**

The Company does not assume responsibilities for the following actions:

Damages caused by use and maintenance without complying with the conditions specified in this guide;

The Company will not assume any responsibilities for the damages or problems caused by optional items or consumables (rather than the initial products or approved products of the Company). The customer is not entitled to change or modify the product without our consent. The product's operating system supports official system updates, but if you change the operating system into a third party ROM system or alter the system files by system cracking, it may cause system instability and security risks and threats.

## **Disclaimer**

As a result of product upgrading, some details in this document may not match the product, and the actual product shall govern. The Company reserves the right to interpretation of this document. The Company also reserves the right to alter this specification without prior notice.

## **CE certification information (SAR)**

This device was tested for typical body-worn operations with the back of the handset kept 5mm away. To maintain compliance with RF exposure requirements, use accessories that maintain a 5mm separation distance between the user's body and the back of the handset. The use of belt clips, holsters, and similar accessories should not contain metallic components in its assembly. The use of accessories that do not satisfy these requirements may not comply with RF exposure requirements and should be avoided.

If you are using a pacemaker, hearing aid, cochlear implant, or another device, please use the phone according to the doctor's advice.

## **PRODUCT SAFETY WARNINGS**

Use responsibly. Read all instructions and safety information before use to avoid injury. The limit operating ambient temperature of the equipment declared by the manufacturer is -15~55°C

## **Battery safety**

Charge battery only at ambient temperatures ranging from 40°C.

1. CAUTION: Danger of explosion if the battery is incorrectly replaced. Replace only with the same or equivalent type of battery recommended by the manufacturer. Dispose of used batteries according to the battery manufacturer's instructions.
2. CAUTION: RISK OF EXPLOSION IF BATTERY IS REPLACED BY AN INCORRECT TYPE.  
DISPOSE OF USED BATTERIES ACCORDING TO THE INSTRUCTIONS.
3. CAUTION: The battery charging temperature upper limit is 40°C.

#### Adapter safety

When charging, please place the device in an environment that has a normal room temperature and good ventilation. It is recommended to charge the device in an environment with a temperature that ranges from 0°C~40°C.

For altitude 2km below use only

#### Wi-Fi Safety

Turn Wi-Fi off in areas where Wi-Fi use is prohibited or when it may cause interference or danger, such as in airplanes while flying.

#### Declaration of Conformity



Hereby, Shanghai Sunmi Technology Co., Ltd. declares that the Wireless data POS System(Model No.:T5930) is in compliance with the essential requirements and other relevant provisions of RED 2014/53/EU.

CAUTION: The device is restricted to indoor use when operated in the European Community using frequency in 5150MHz~5250MHz to reduce the potential for interference.

5.8G SRD receiver category 1



BE	BG	CZ	DK
DE	EE	IE	EL
ES	FR	HR	IT
CY	LV	LT	LU
HU	MT	NL	AT
PL	PT	RO	SI
SK	FI	SE	SK

#### Technical features and characteristic

	Operation Frequency	Transmitted
GSM 900	880.0–915.0MHz(TX), 925.0–960.0MHz(RX)	32.5dBm
GSM 1800	1710.0–1785.0MHz (TX), 1805.0–1880.0 MHz (RX)	29.5dBm
WCDMA Band I	1920-1980MHz (TX), 2110-2170MHz (RX)	21dBm
WCDMA Band VIII	880-915MHz (TX), 925-960MHz (RX)	22.5dBm
LTE BAND 1	1920-1980MHz (TX), 2110-2170MHz (RX)	22.5dBm
LTE BAND 3	1710-1785 MHz (TX), 1805-1880MHz (RX)	23dBm
LTE BAND 7	2500-2570MHz(TX), 2620-2690MHz(RX)	23dBm
LTE BAND 8	880-915MHz(TX) , 925-960MHz(RX)	23dBm
LTE BAND 20	832-862MHz(TX),791-821MHz(RX)	22.5dBm
LTE BAND 38	2570-2620MHz (TX/RX)	21.5dBm
LTE BAND 40	2300-2400MHz (TX/RX)	22dBm
BT/BLE	2402MHz-2480MHz	7dBm
2.4G Wi-Fi	2412MHz-2472MHz	15dBm
5G Wi-Fi	5.15-5.35GHz	16.5dBm
5G Wi-Fi	5.725-5.850GHz	13.5dBm

**This device complies with Part 15 of the FCC Rules.**

**Operation is subject to the following two conditions:**

1. This device may not cause harmful interference.
2. This device must accept any interference received, including interference that may cause undesired operation.

#### **FCC ID: 2AH25V2**

**NOTE:** Changes or modifications not expressly approved by the party responsible for compliance could void the user's authority to operate the equipment.

**NOTE:** This equipment has been tested and found to comply with the limits for a Class B digital device, pursuant to Part 15 of the FCC Rules. These limits are designed to provide reasonable protection against harmful interference in a residential installation. This equipment generates uses and can radiate radio frequency energy and, if not installed and used in accordance with the instructions, may cause harmful interference to radio communications. However, there is no guarantee that interference will not occur in a particular installation.

If this equipment does cause harmful interference to radio or television reception, which can be determined by turning the equipment of and on, the user is encouraged to try to correct the interference by one or more of the following measures:

- Reorient or relocate the receiving antenna.
- Increase the separation between the equipment and receiver.
- Connect the equipment into an outlet on a circuit different from that to which the receiver is connected.
- Consult the dealer or an experienced radio/TV technician for help.

#### **Body-worn Operation**

This device was tested for typical body-worn operations. To comply With RF exposure requirements, a minimum

separation distance of 1.0cm must be maintained between the user's body and the handset, including the antenna.

Third-party belt-clips, holsters, and similar including the antenna. Third-party belt clips, holsters, and similar accessories used by this device should not contain any metallic components. Body-worn accessories that do not meet these requirements may not comply with RF exposure requirements and should be avoided.

#### **Specific Absorption Rate (SAR) information:**

This wireless data POS System meets the government's requirements for exposure to radio waves. The guidelines are based on standards that were developed by independent scientific organizations through periodic and thorough evaluation of scientific studies. The standards include a substantial safety margin designed to assure the safety of all persons regardless of age or health.

FCC RF Exposure Information and Statement. The SAR limit of the USA (FCC) is 1.6W/kg averaged over one gram of tissue.

Device types: T5930 has also been tested against this SAR limit. The highest SAR value reported under this standard during product certification when properly worn on the body is 1.042W/kg 10gSAR test distance 0mm limit 4W/kg and 0.983W/kg (1gSAR test distance 5mm limit 1.6W/kg). This device was tested for body-worn operations with the back of the handset kept 10mm and 5mm from the body. To maintain compliance with FCC RF exposure requirements, use accessories that maintain a 10mm and 5mm separation distance between the user's body and the back of the handset. The use of belt clips, holsters, and similar accessories should not contain metallic components in its assembly. The use of accessories that do not satisfy these requirements may not comply with FCC RF exposure requirements and should be avoided.

#### **Technical features and characteristic**

	Operation Frequency	Transmitted
GSM 850	824-849 MHz(Tx),869-894 MHz(Rx)	32 dBm
GSM 1900	1850-1910 MHz(Tx),1930-1990 MHz(Rx)	30 dBm
WCDMA BAND II	1850-1910 MHz(Tx),1930-1990 MHz(Rx)	23 dBm
WCDMA BAND IV	1710 -1755 MHz(Tx),2110 – 2155MHz(Rx)	23 dBm
WCDMA BAND V	824-849 MHz(Tx),869-894 MHz(Rx)	23.5 dBm
LTE BAND 2	1850-1910 MHz(Tx),1930-1990 MHz(Rx)	22.5 dBm
LTE BAND 4	1710-1755 MHz(Tx),2110-2155 MHz(Rx)	22.5 dBm
LTE BAND 7	2500-2570 MHz(Tx),2620-2690 MHz(Rx)	22.5 dBm
LTE BAND 17	704-716 MHz(Tx),734-746 MHz(Rx)	23 dBm
2.4G Wi-Fi	2412-2462 MHz	15 dBm
Bluetooth	2402-2480 MHz	6 dBm
BLE	2402-2480 MHz	6 dBm
5G Wi-Fi	5150-5250 MHz	17 dBm
5G Wi-Fi	5725-5850 MHz	16.5 dBm

#### **Manufacture**

Shanghai Sunmi Technology Co., Ltd.

Room 505, KIC Plaza, No.388 Song Hu Road, Yang Pu District, Shanghai, China

#### **Documents / Resources**





**[sunmi V2 Wireless Data POS System](#)** [pdf] User Guide  
V2, 2AH25V2, V2 Wireless Data POS System, V2, Wireless Data POS System

Manuals+.