



---

[Home](#) » [SUNCO](#) » **Sunco GD\_PW\_LV-BK-3000K Low Voltage Pathway Light User Manual** 

## **Contents** [ [hide](#) ]

- [1 Sunco GD\\_PW\\_LV-BK-3000K Low Voltage Pathway Light](#)
- [2 What's in the Box?](#)
- [3 Before You Start](#)
- [4 Product Size](#)
- [5 Installation Guide](#)
- [6 Common Troubleshooting](#)
- [7 Installation Issues](#)
- [8 Documents / Resources](#)
  - [8.1 References](#)

# Sunco

## Sunco GD\_PW\_LV-BK-3000K Low Voltage Pathway Light



## What's in the Box?



Let there be light!  
(literally)

## Pathway Light

- A x1 Pathway Light
- B x1 Ground Stake
- C x2 Low Voltage Wire Connectors

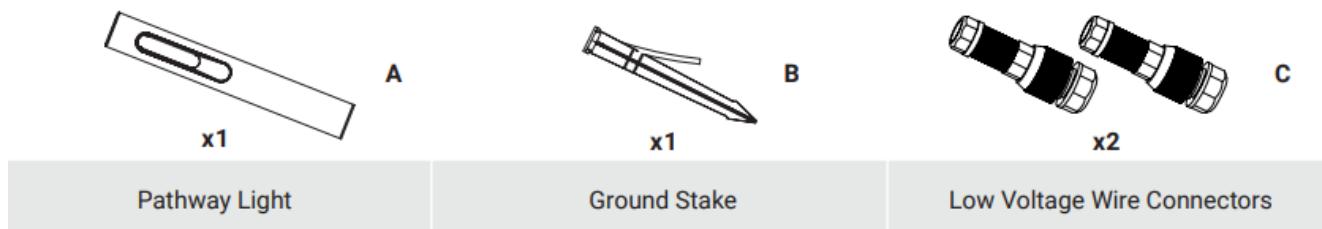

## Before You Start

### Safety Information

To reduce the risk of fire, electric shock, or physical injury:

- Suitable for outdoor, wet locations at temperatures ranging from -4°F to 113°F. Do not cover the fixture with thermally insulating material.
- Not intended for use with emergency fixtures.
- Not compatible with occupancy sensors connected via direct wiring.
- Not compatible with dimmers.
- Not compatible with timing devices connected via direct wiring.
- Only for use with low voltage landscape lighting power units with a maximum output rating of 12 to 24 V.
- Install the fixtures no less than 10 ft. from pools, spas, or fountains to minimize the risk of electrical shock.
- Always use UL-listed wire and wire connectors for connections.
- All electrical connections must be in accordance with local and National Electric Code (N.E.C.) standards.
- Please review installation manual carefully before proceeding. Consult a qualified electrician if you are unfamiliar with proper installation.

### Product Size

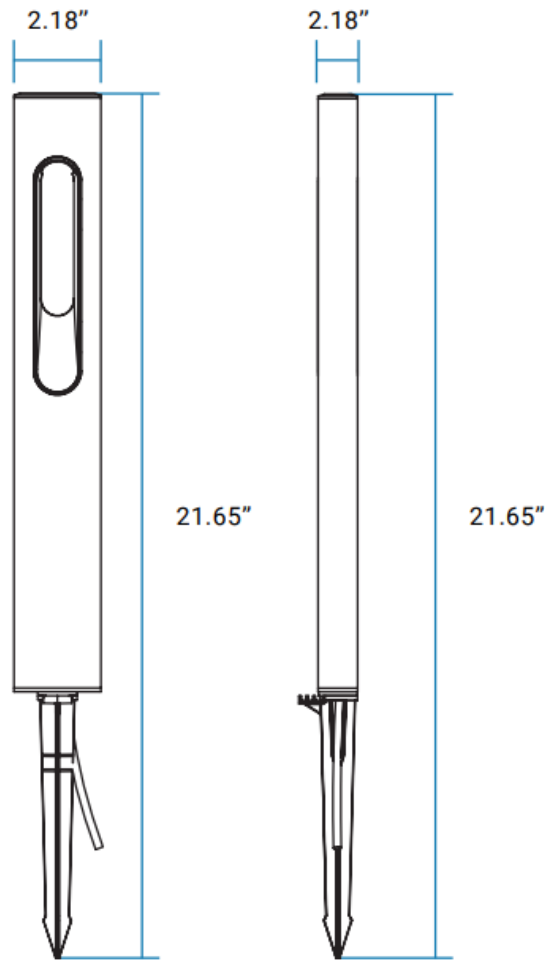

**Dimensions:** 2.18" x 21.65"

This device complies with Part 15 of the FCC rules. Operation is subject to the following two conditions:

1. This device may not cause harmful interference.
2. This device must accept any interference that may cause undesired operation. Please review all instructions carefully prior to installation.

**WARNING:** Cancer & Reproductive Harm [www.P65Warnings.ca.gov](http://www.P65Warnings.ca.gov)

## Installation Guide

### Step 1

1. Turn off the transformer before installation.
2. Remove the low voltage wire connectors (C) from the accessory kit.

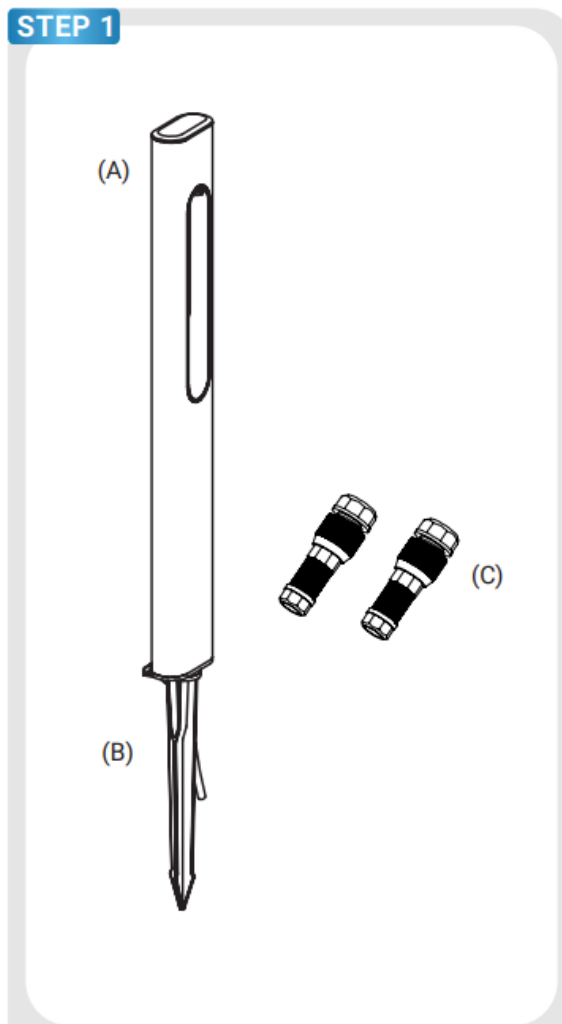

## Step 2

1. Twist off the smaller end cap from a low voltage wire connector (C), thread a luminaire wire through the smaller end cap into the wire connector.
2. Fit the luminaire wire into the low voltage wire connector (C), then twist the wire connector to secure the luminaire wire into place.
3. Repeat the previous step for the other luminaire wire.

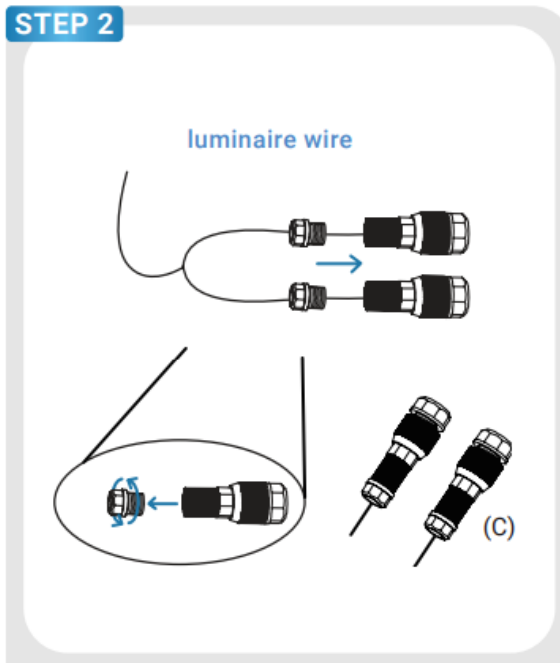

**Note:** Ensure the low voltage wire connectors (C) are properly connected by gently pulling on each connector.

### Step 3

1. Twist off the larger end cap from a low voltage wire connector (C), then place the wire between the cap and wire connector (C). Make sure the pin makes contact and punctures the supply wire.
2. Then, tighten the cap of the wire connector (C).
3. Repeat the previous step for the other supply wire.

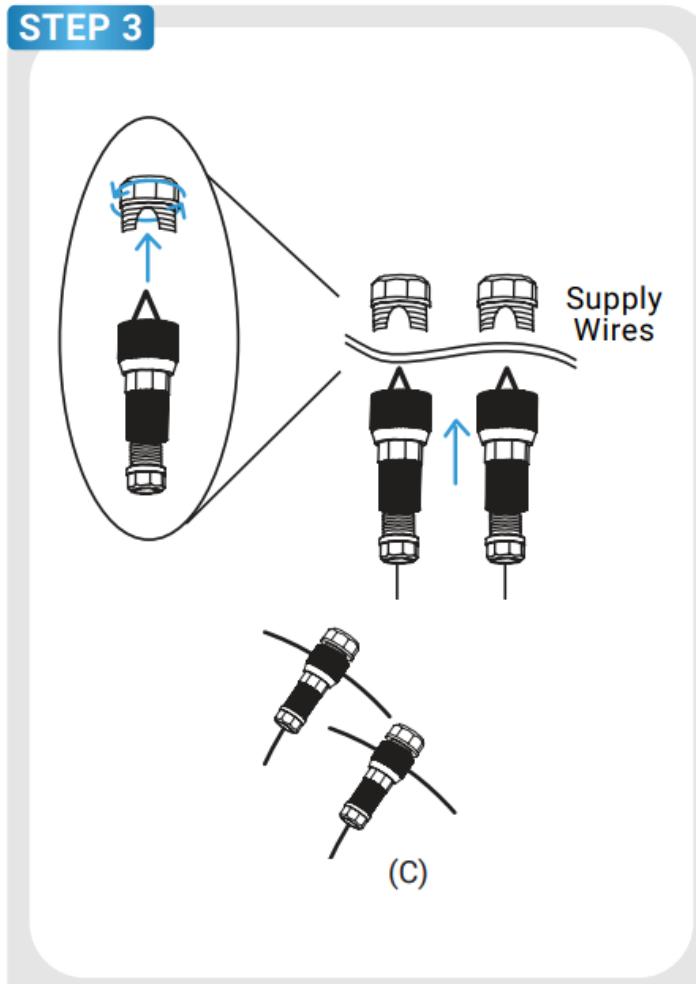

#### Step 4

1. Locate desired area to place pathway light.
2. Use a shovel to dig a hole. Soften the ground with water if needed.
3. Place the fixture into the ground using the tab with your foot and cover the luminaire with the surrounding dirt.
4. Turn on the transformer to test the light.

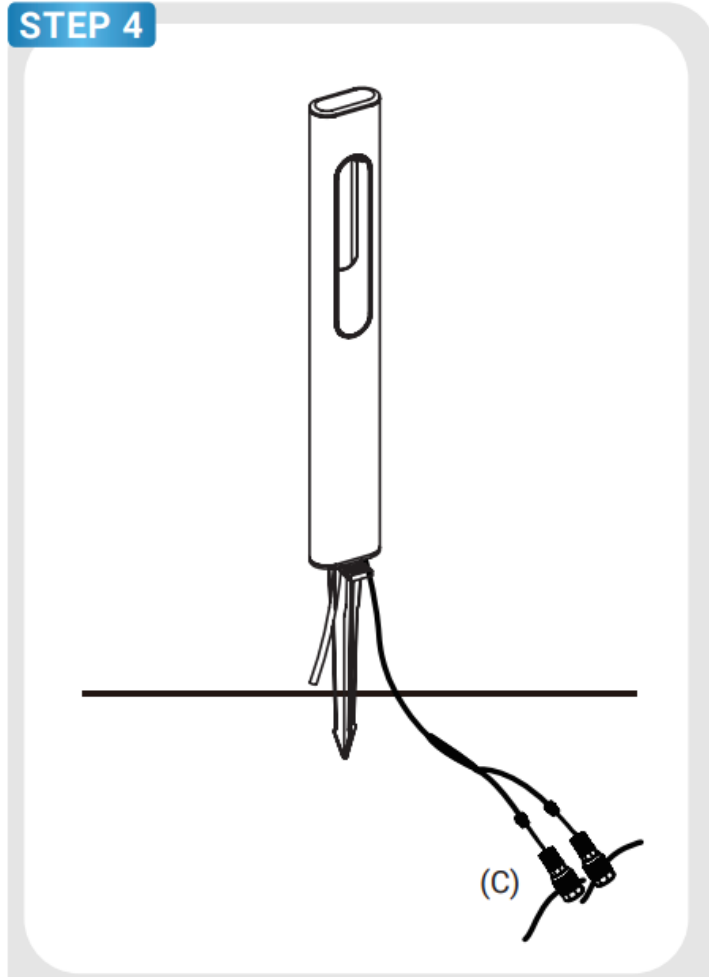
**STEP 4**

## Common Troubleshooting

### Specifications

<b>Voltage</b>	12 to 24 V	<b>Lifetime</b>	50,000 Hours
<b>Wattage</b>	4 W	<b>Lumens</b>	70 lm
<b>Beam Angle</b>	115°	<b>Moisture Rating</b>	Wet Rated
<b>CRI</b>	80+	<b>IP Rating</b>	IP65
<b>Material</b>	ALU	<b>Usage</b>	Outdoor
<b>Efficacy</b>	25 lm/W	<b>Warranty</b>	3 Years

We've got you covered! Our troubleshooting section is here to shed some light and provide you with easy-to-follow solutions for any problem. If you still need some assistance, feel free to contact us. Our team of lighting experts are happy to help



brighten your day.

## **Installation Issues**

### **Light isn't turning on.**

- Verify that the low voltage wire connectors are puncturing and making contact with the supply wire, ensuring a strong connection.

## **Turned On Issues**

### **Light isn't turning on when switch is on.**

- Verify that the low voltage wire connectors are puncturing and making contact with the supply wire, ensuring a strong connection.
- Check if the power connection is properly supplied to the luminaire.

## **Operation Issues**

### **Light is not turning on anymore.**

- Ensure that all luminaire connections are installed properly. Check for any loose wiring.

## **Location Issues**

### **Light isn't turning on in certain location.**

- Check for luminaire obstruction or damage from placed location.

Lighting made better.

- **Contact:** [support@sunco.com](mailto:support@sunco.com)
- [844-334-9938](tel:844-334-9938)

# Documents / Resources

	<p><a href="#">Sunco GD_PW_LV-BK-3000K Low Voltage Pathway Light [pdf]</a> User Manual</p> <p>GD_PW_LV-BK-3000K, GD_PW_LV-BK-3000K Low Voltage Pathway Light, Low Voltage Pathway Light, Voltage Pathway Light, Pathway Light</p>
---	---

## References

- [User Manual](#)

📁 SUNCO

💎 GD\_PW\_LV-BK-3000K, GD\_PW\_LV-BK-3000K Low Voltage Pathway Light, Low Voltage Pathway Light, Pathway Light, SUNCO, Voltage Pathway Light

---

## Leave a comment

Your email address will not be published. Required fields are marked \*

Comment \*

Name

Email

Website

☐ Save my name, email, and website in this browser for the next time I comment.

**Post Comment**

## Search:

e.g. whirlpool wrf535swhz

**Search**

[Manuals+](#) | [Upload](#) | [Deep Search](#) | [Privacy Policy](#) | [@manuals.plus](#) | [YouTube](#)

This website is an independent publication and is neither affiliated with nor endorsed by any of the trademark owners. The "Bluetooth®" word mark and logos are registered trademarks owned by Bluetooth SIG, Inc. The "Wi-Fi®" word mark and logos are registered trademarks owned by the Wi-Fi Alliance. Any use of these marks on this website does not imply any affiliation with or endorsement.