



[Home](#) » [SUNCO](#) » **Sunco CL_RD_DD-BK-2760K Outdoor Ceiling Light With Motion Sensor User Manual** 

Contents [[hide](#)]

- [1 Sunco CL_RD_DD-BK-2760K Outdoor Ceiling Light With Motion Sensor](#)
- [2 What's in the Box?](#)
- [3 Before You Start](#)
- [4 Installation Guide](#)
- [5 Product Details](#)
- [6 Specifications](#)
- [7 Common Troubleshooting](#)
- [8 Installation](#)
- [9 Light Distribution Angle](#)
- [10 Documents / Resources](#)
 - [10.1 References](#)
- [11 Related Posts](#)

Sunco

Sunco CL_RD_DD-BK-2760K Outdoor Ceiling Light With Motion Sensor



What's in the Box?

Ceiling Light

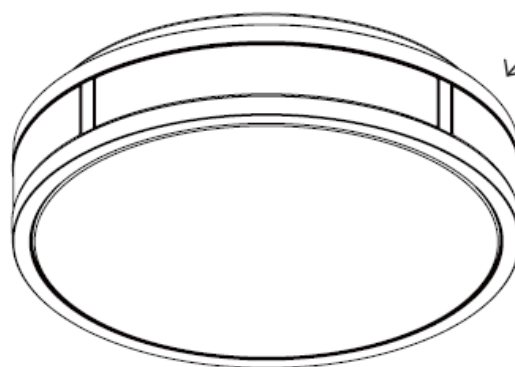

*Let there be light!
(literally)*



x3

Wire Nuts



x2

Mounting Screws

Get Your Gear

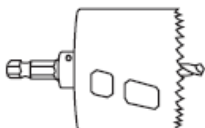

Hole Saw



Ladder



Wire Strippers

Before You Start

Safety Information

To reduce the risk of fire, electric shock, or physical injury:

- Turn off circuit breaker before installing this fixture.
- This product should be installed by a person familiar with the construction and operation of the product the hazards involved. Safety eyeglasses and gloves are recommended.
- Abide by related regional and local laws or regulations.
- Proper grounding is required to ensure safety.
- Do not alter, relocate, or remove wiring during installation.
- Do not make or alter any open holes in wiring enclosure or electrical components during installation.
- Check for shipping damage before installing. If the product is damaged, do not use it.
- Keep fixture away from corrosive substances.

This device complies with Part 15 of the FCC rules. Operation is subject to the following two conditions:

1. This device may not cause harmful interference.

- Suitable for damp locations at temperature ranging from – 4°F to 104°F. Not for use where directly exposed to water.
- Clean the fixture regularly to ensure proper operation. Do not clean with harsh solvents.
- Use safety precautions and abide by regional and local laws or regulations.
- This product is not compatible with 3rd party sensors.
- This product is not compatible with photo controls.
- This product is not compatible with occupancy sensors.
- This product is not compatible with timing devices.

WARNING:

Cancer & Reproductive Harm- www.P65Warnings.ca.gov

2. This device must accept any interference that may cause undesired operation. Please review all instructions carefully prior to installation.

Quickstart Guide

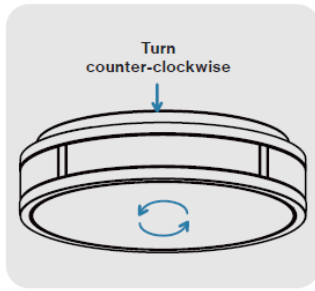

Step 1

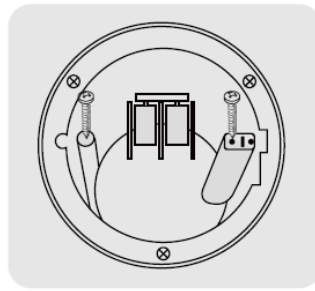

Step 2

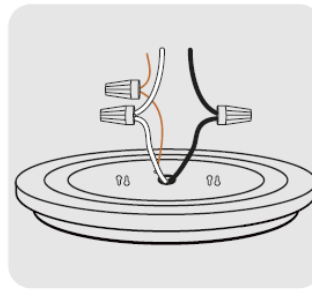

Step 3

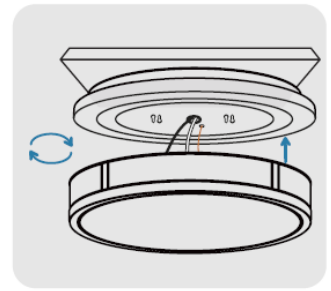

Step 4

1. Remove lens from luminaire base.
2. Install mounting screws to j-box.
3. Connect supply wires with luminaire wires.
4. Install lens by twisting fixture to lock luminaire.

Installation Guide

1. STEP 1

Turn off circuit breaker that provides power to the light.

2. STEP 2

Twist the sides of the white luminaire base counter clockwise to remove lens.

3. STEP 3

- For junction box installation, the slot distance should be approximately 2.63 – 3.41”.
- Install mounting screws (B) to junction box.

4.

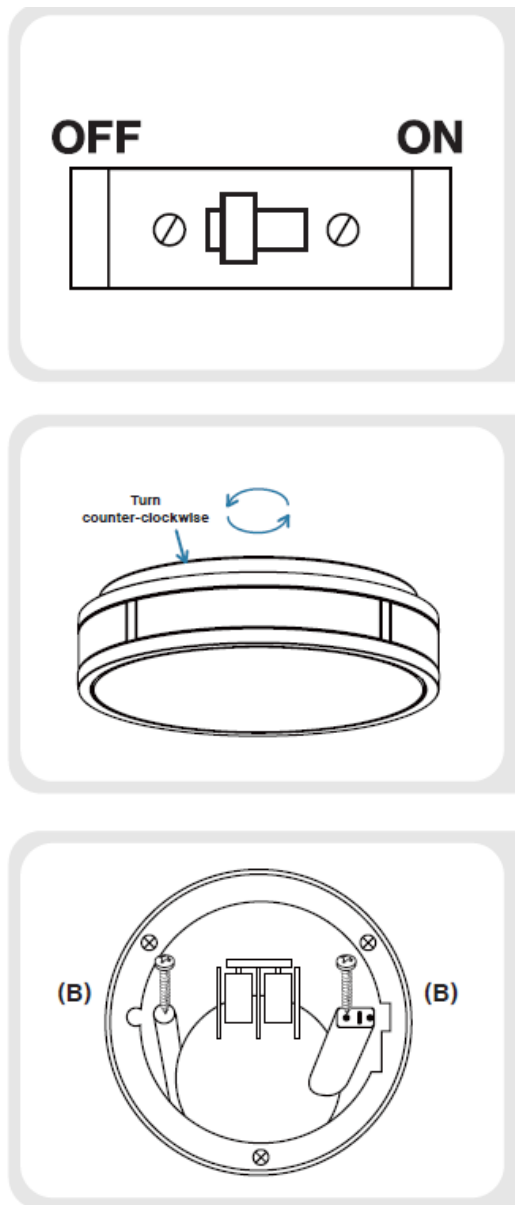

STEP 4

- Feed luminaire wires through junction box.
- Connect supply wires to luminaire wires with included wire nuts (A):
- Black to Black (Live)
- White to White (Neutral)
- Bare Copper to Bare Copper (Ground)
- Tuck all wires into junction box.

5. STEP 5

- Align keyhole slots of luminaire base to the mounting screws (B) on the junction box.
- Twist luminaire into place, then tighten mounting screws (B) to hang luminaire to ceiling.

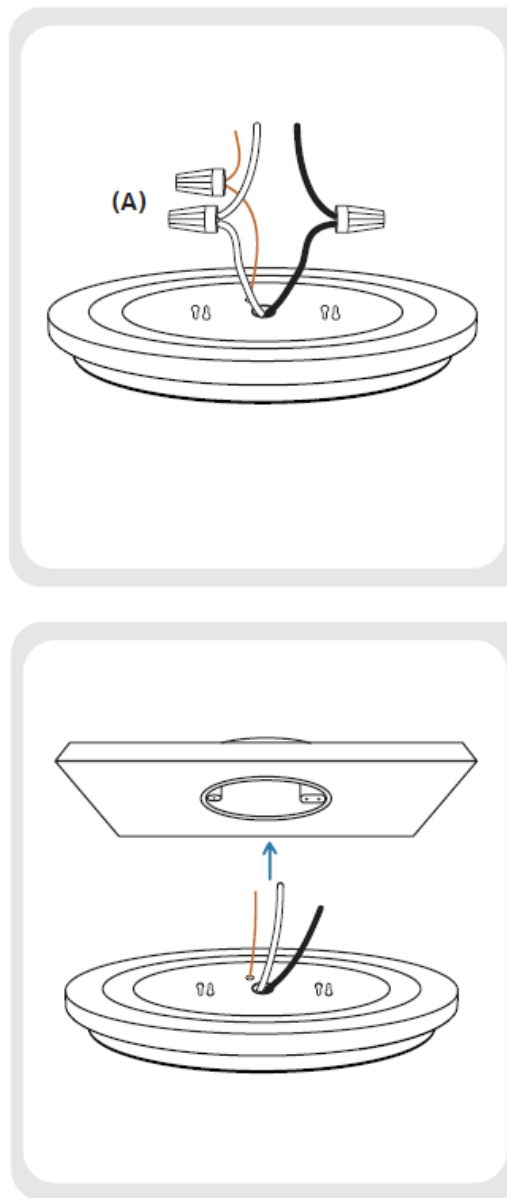

6. STEP 6

- Use the CCT switch on the luminaire base to select desired CCT.

7. STEP 7

- Install lens back to luminaire, then twist lens clockwise until it locks into place.
- For the motion sensor, the luminaire will turn on when motion is detected and daylight is not detected.

8. STEP 7

- Turn on circuit breaker to test light.

Test Mode

- To test for motion detection, toggle the light into factory test mode. Turn the luminaire off/on five times.
- The luminaire will flash three times when set to TEST mode.
- If motion is detected, the light will turn on, then turn off.

Note: To exit TEST mode, simply turn the light off and on again.

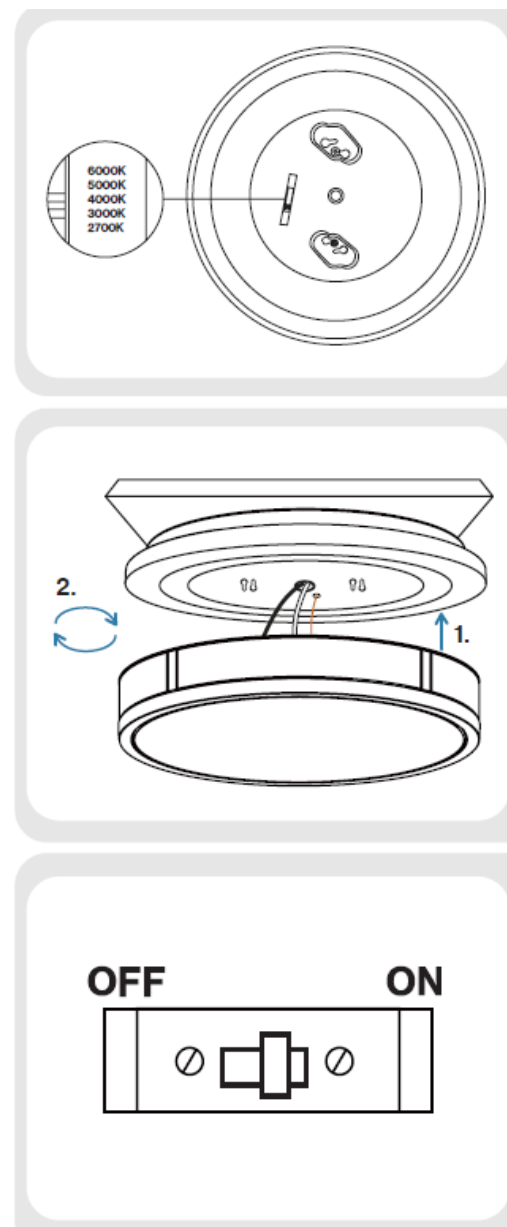

Product Details

Product Size

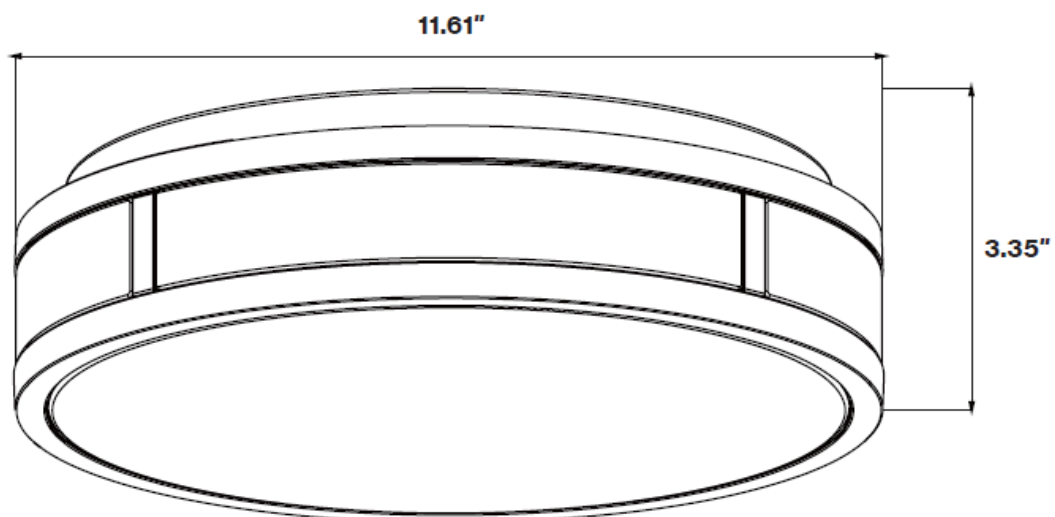

Specifications

Voltage	120 V	Average Lifetime	35,000 Hours
Wattage	20 W	Lumen	1500 lm
Efficacy	75 lm/W	Operating Temperature	-4 °F to 104 °F
Beam Angle	120°	Moisture Rating	Damp Rated
Weight	0.89 lbs	CRI	80+
Housing Material	Plastic + Metal	Usage	Indoor
Dimmable	Non-Dimmable	Warranty	5 Years

Common Troubleshooting

Feeling in the dark about an issue with your product? No worries! Our troubleshooting section is here to shed some light and provide you with easy-to-follow solutions for any problem.

If you still need some assistance, please feel free to contact us with any questions. Our team of lighting experts are happy to help brighten your day.

Installation

- Light isn't turning on. Double check if fixture is properly connected and circuit breaker hasn't been tripped.
- Light unexpectedly fails. For further assistance, reach out to customer support.

Flickering

Light is flickering when turning on.	Check that fixture wiring connections are secure.
Light flickering with other lights on the same circuit.	Check that the lights on the same circuit are not overloading the circuit.
Light flickering when turned on.	Verify fixture compatibility and that it is grounded.
Light flickering when dimmed.	Fixture is not dimmable.

Buzzing

- Fixture buzzing with power outages. Verify light is connected to surge protector securely.

- Fixture buzzing with appliances or electronic devices. Look for nearby interferences that can cause buzzing. Such as televisions, radios, computers, etc.
- Fixture buzzing when dimmed. Fixture is not dimmable.

Light Distribution Angle

•

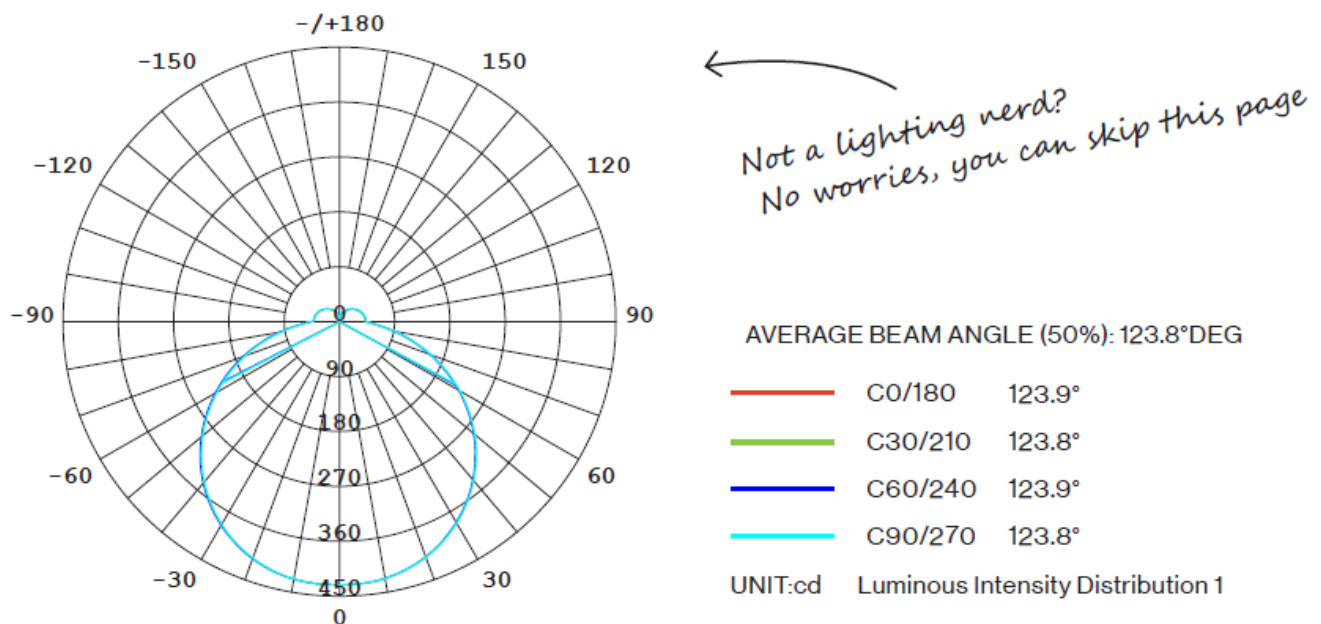

Lighting distribution angle refers to the spread of light emitted from a light source. It is an important factor to consider when selecting a fixture or bulb, as it affects the way it will illuminate an area. There are two main types of lighting distribution angles:

A symmetric lighting distribution emits light evenly in all directions, creating a cone-shaped pattern that provides a pool of light. This type of lighting is ideal for general lighting and illuminating large areas. Common applications for symmetric lighting include general area illumination, security lighting, and perimeter lighting. Symmetric lighting is also used to a certain degree in up-lighting.

- An asymmetric lighting distribution angle, also known as beam angle, creates a pattern that focuses light in a specific direction. This type of lighting is ideal for task lighting as it reduces glare and light spill in other areas. Common applications include task lighting in spaces such as landscape settings, retail stores, museums, and much more.
- It is important to note that the lighting distribution angle can also be affected by other factors such as the reflector design of the light source, the type of lens used, and the distance between the light source and the surface being illuminated.

Lighting made better.

support@sunco.com [844-334-9938](tel:844-334-9938)

Documents / Resources

	<p>Sunco CL_RD_DD-BK-2760K Outdoor Ceiling Light With Motion Sensor [pdf] User Manual</p> <p>CL_RD_DD-BK-2760K, CL_RD_DD-BK-2760K Outdoor Ceiling Light With Motion Sensor, CL_RD_DD-BK-2760K, Outdoor Ceiling Light With Motion Sensor, Ceiling Light With Motion Sensor, Motion Sensor, Sensor</p>
---	--

References

- [P65Warnings.ca.gov](https://www.p65warnings.ca.gov)
- [User Manual](#)

Related Posts



[Solar Motion Sensor Light TG-TY07301 User Guide](#)

Solar Motion Sensor Light TG-TY07301



[VONT 6 Packs Motion Sensor Light User Manual](#)

VONT 6 Packs Motion Sensor Light Sophisticated, high-quality sensors ensure this efficient light only activates in the dark...



[Tailcas SKU1903199 Solar Security Light Outdoor Motion Sensor Instruction Manual](#)

SKU1903199 Solar Security Light Outdoor Motion Sensor



[Zhongshan XY-CEI-24W LED Motion Sensor Ceiling Light Owner's Manual](#)

XY-CEI-24W LED Motion Sensor Ceiling Light Product

Information Specifications Compliance: FCC radiation

exposure limits Environment: Uncontrolled Minimum Distance:...

■ SUNCO

◆ Ceiling Light with Motion Sensor, CL_RD_DD-BK-2760K, CL_RD_DD-BK-2760K Outdoor Ceiling Light With Motion Sensor, Motion Sensor, Outdoor Ceiling Light With Motion Sensor, Sensor, SUNCO

—Previous Post

**[Sunco DL_G56-BK-2750K 6 Inch Black Trim LED Retrofit Gimbal
Downlight Owner's Manual](#)**

Next Post—

**[Sunco PN24_BT_50SW-4060K 2×4 Integrated Emergency Battery Panel
Owner's Manual](#)**

Leave a comment

Your email address will not be published. Required fields are marked *

Comment *

Name

Email

Website

☐ Save my name, email, and website in this browser for the next time I comment.

Post Comment

Search:

e.g. whirlpool wrf535swhz

Search

[Manuals+](#) | [Upload](#) | [Deep Search](#) | [Privacy Policy](#) | [@manuals.plus](#) | [YouTube](#)

This website is an independent publication and is neither affiliated with nor endorsed by any of the trademark owners. The "Bluetooth®" word mark and logos are registered trademarks owned by Bluetooth SIG, Inc. The "Wi-Fi®" word mark and logos are registered trademarks owned by the Wi-Fi Alliance. Any use of these marks on this website does not imply any affiliation with or endorsement.