

SUN GLOW W1 2C Remotes Stealth Automation Remotes



SUN GLOW W1 2C Remotes Stealth Automation Remotes User Manual

[Home](#) » [SUN GLOW](#) » SUN GLOW W1 2C Remotes Stealth Automation Remotes User Manual 

Contents

- 1 SUN GLOW W1 2C Remotes Stealth Automation Remotes
- 2 Specifications
- 3 Product Information:
- 4 Usage Instructions
- 5 FAQ
- 6 Product Info
- 7 Buttons
- 8 Models & Parameters
- 9 Instructions
- 10 Documents / Resources
 - 10.1 References



SUN GLOW W1 2C Remotes Stealth Automation Remotes



Specifications

- **Product:** Stealth Automation Remotes
- **Channels:** 16
- **Controller Types:** Wall-Mounted LCD Remote, Hand-held LCD Remote

Product Information:

- The Stealth Automation Remotes are sophisticated 16-channel controllers available in both wall-mounted and hand-held LCD remote versions.
- These remotes provide users with convenient control over various automation systems.

Usage Instructions

Wall-Mounted 16-channel LCD Remote Controller

- Mount the remote on a suitable wall location for easy access.
- Short press the buttons to control individual channels.
- Channel 0 acts as a group control for all channels.
- Follow the on-screen prompts to include or exclude channels from the group.

Hand-held 16-channel LCD Remote Controller

- Hold the remote comfortably in your hand. Use the buttons to adjust settings for different channels.
- Similar to the wall-mounted remote, Channel 0 serves as a group control for all channels.

- Utilize the LCD screen for clear visibility of channel statuses.

FAQ

- **Q:** What should I do if the remote control distance is reduced or less sensitive?
- **A:** Check whether the battery needs replacement. Low battery voltage can affect the remote's performance.
- **Q:** How do I dispose of used batteries from the remote?
- **A:** Please follow local garbage classification and recycling policies for proper disposal of used batteries.

Product Info

- Hand-held 16-channel LCD Remote Controller

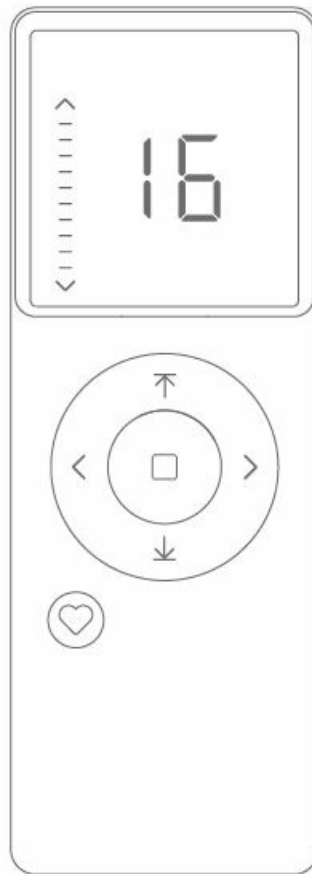

- Wall-Mounted 16-channel LCD Remote Controller

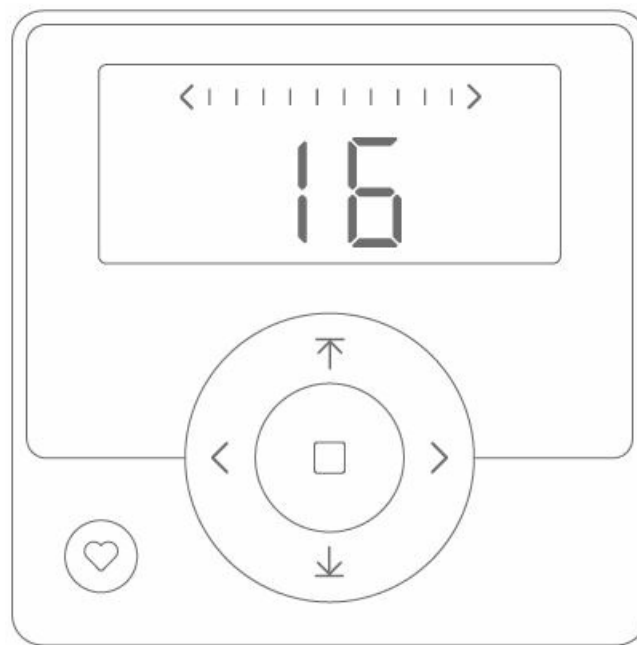

Buttons

FRONT

- Hand-held 16-channel LCD Remote Controller

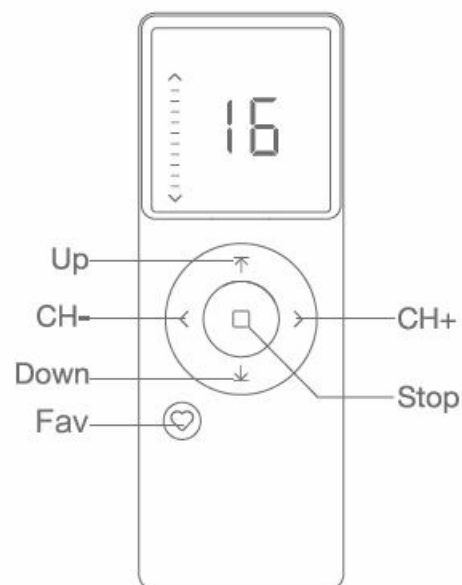

- Wall-Mounted 16-channel LCD Remote Controller

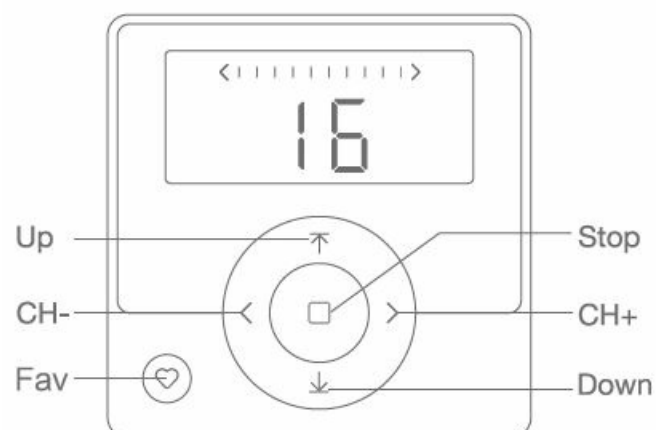

BACK

- Hand-held 16-channel LCD Remote Controller

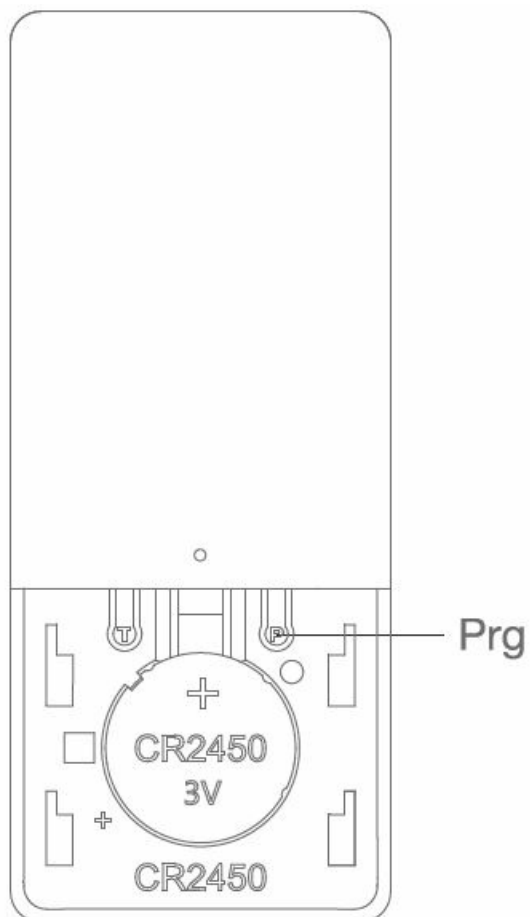

- Wall-Mounted 16-channel LCD Remote Controller

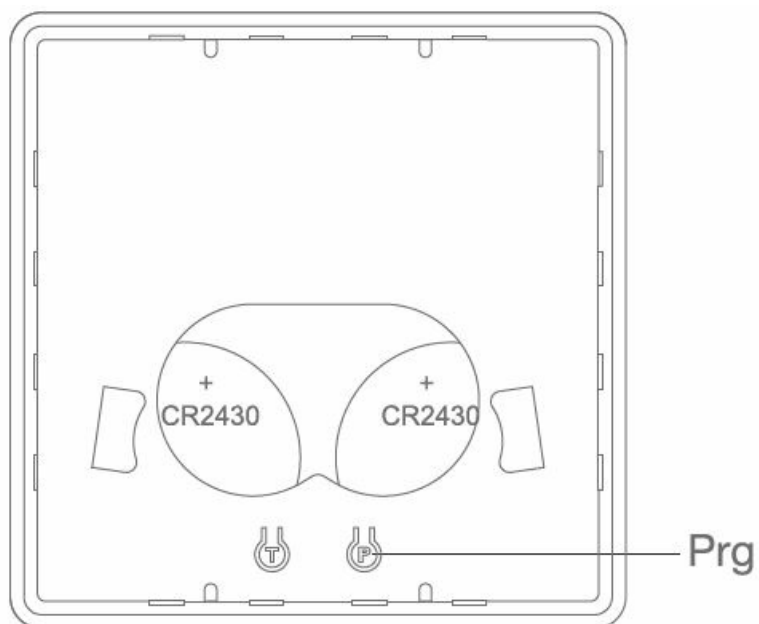

Models & Parameters

Models & Parameters (more info please refer to the nameplate)

Electrical Specification	Standard	
Battery Type	Hand-held:CR2450*3V*1	Wall-mounted: CR2430*3V*2
Working Temperature	-10℃-50℃	
Radio Frequency	433.92M ± 100KHz	
Transmit Distance	>=30m indoor	

Caution!

1. The remote controller should not be exposed to moisture or impact, so as not to affect its life.
2. During use, when the remote control distance is significantly shorter or less sensitive, please check whether the battery needs to be replaced.
3. When the battery voltage is too low, the LCD screen will show a low voltage prompt, prompting to replace the battery. 
4. Please properly dispose of used batteries according to the local garbage classification and recycling policy.

Instructions

Channels & Groups Toggling

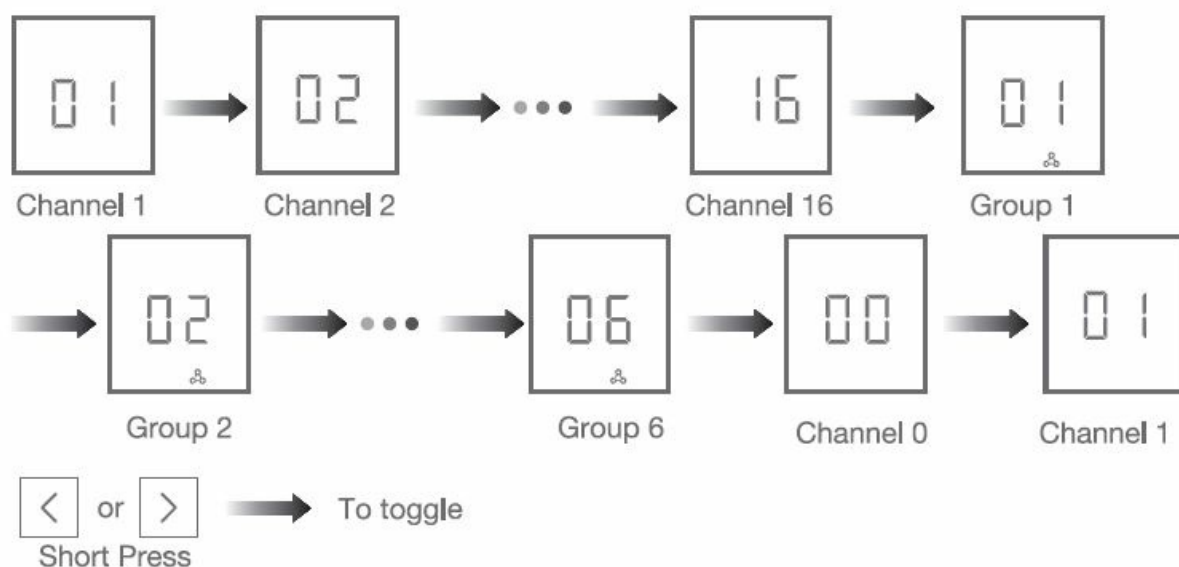

Note: Channel 0 is the group control for all the channels.

Number of Channels Setting



Note: Max&Min number is 16&1 when it's set under channels 1-16.

Number of Groups Setting



Note: Max&Min number is 6&0 when it's set under channel 0.

Channel in Group Setting

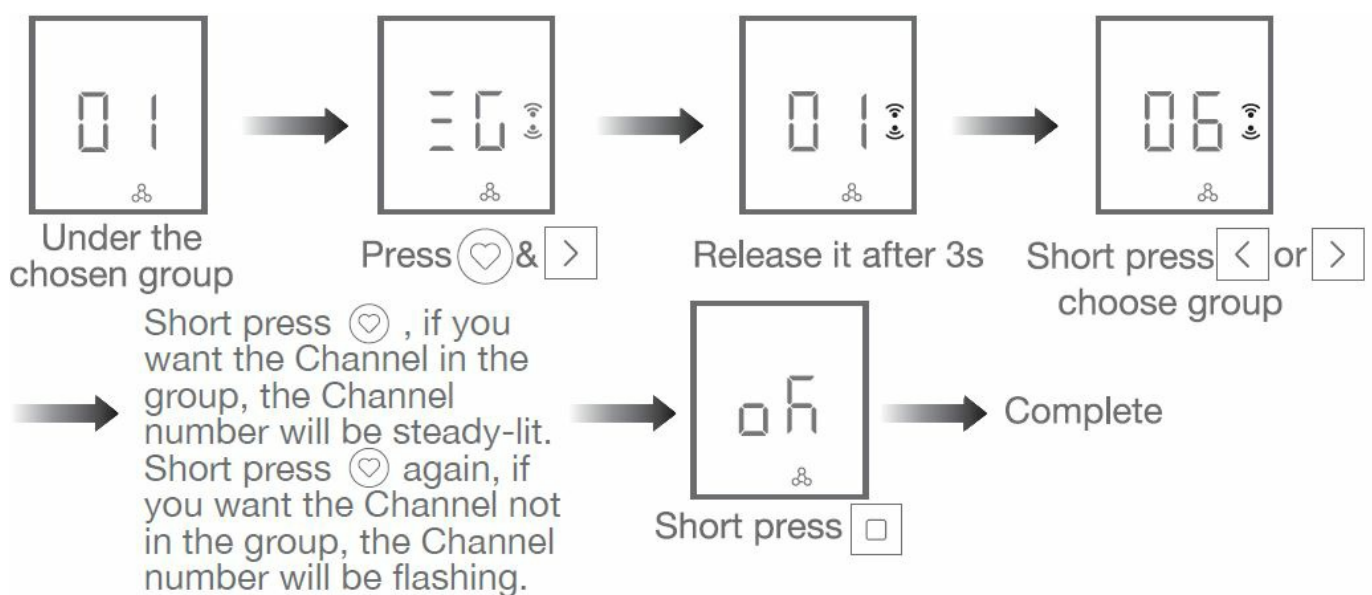

Note: Channel in groups setting is under GROUP 1-6.

Check the Channels in Groups

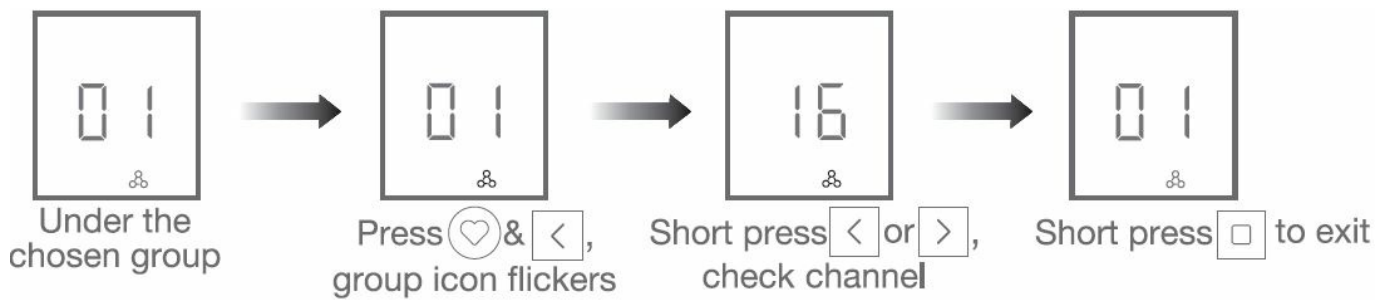

Note: LCD will show "EC" if there is no detailed channel.

Prohibit Dual-key Operation

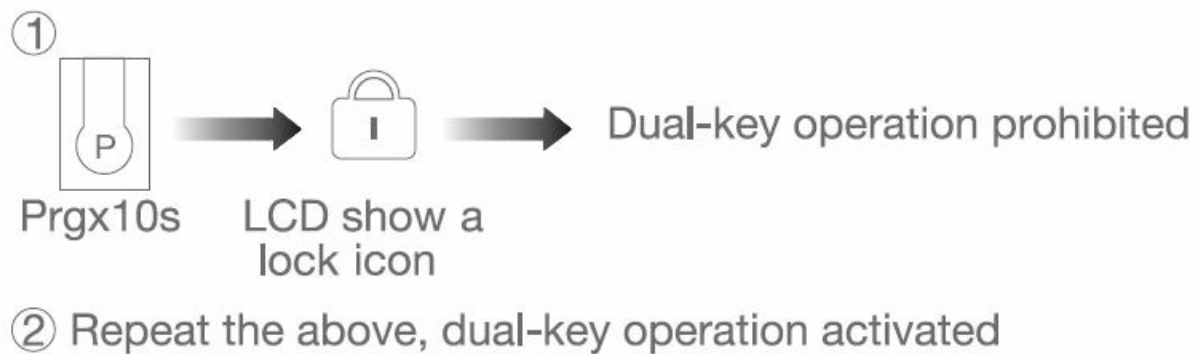

Note: When dual-key operation is prohibited, these programming setting functions are not allowed, such as limits setting.

Position Percent Setting

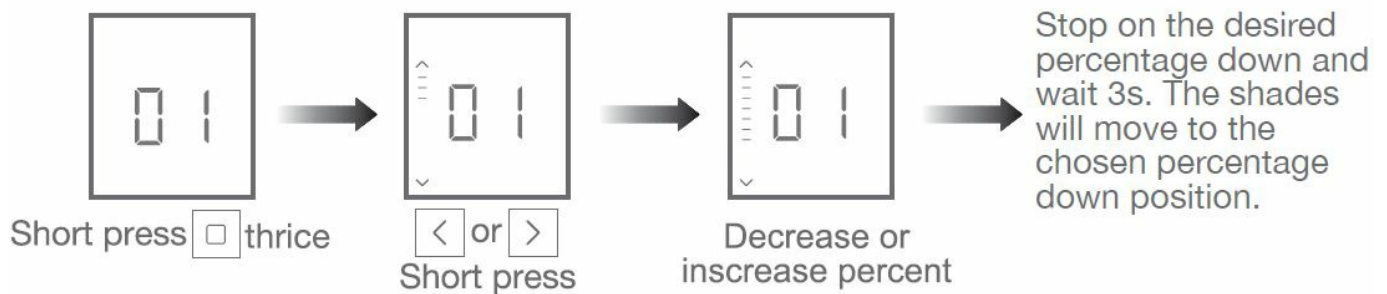

Note: All the shades under same group will run to same position after percent setting.

For other operations, please refer to the motor operation instruction

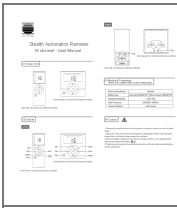

[SUN GLOW W1 2C Remotes Stealth Automation Remotes](#) [pdf] User Manual
W1 2C Remotes Stealth Automation Remotes, W1 2C, Remotes Stealth Automation Remotes, Stealth Automation Remotes, Automation Remotes

References

- [User Manual](#)

Manuals+, Privacy Policy

This website is an independent publication and is neither affiliated with nor endorsed by any of the trademark owners. The "Bluetooth®" word mark and logos are registered trademarks owned by Bluetooth SIG, Inc. The "Wi-Fi®" word mark and logos are registered trademarks owned by the Wi-Fi Alliance. Any use of these marks on this website does not imply any affiliation with or endorsement.