

Summer Infant Pop 'N Jump with Canopy



Summer Infant Pop 'N Jump with Canopy Owner's Manual

[Home](#) » [Summer](#) » Summer Infant Pop 'N Jump with Canopy Owner's Manual 

Contents

- [1 Summer Infant Pop 'N Jump with Canopy](#)
- [2 Product Information](#)
- [3 Product Usage Instructions](#)
- [4 Care and Maintenance](#)
- [5 Description](#)
- [6 Assemble the Wagon](#)
- [7 Handle Usage](#)
- [8 Handle Storage](#)
- [9 Fold the Wagon](#)
- [10 Documents / Resources](#)
 - [10.1 References](#)

summer™

Summer Infant Pop 'N Jump with Canopy



Product Specifications:

- Weight Capacity: 50 lbs. (22.7kg)
- Dimensions: 43 in. (109cm)

Product Information

The Pop 'N Ride™ is a versatile and convenient ride-on product designed for children. It comes with a sturdy frame, comfortable seat pad, front and rear wheels for smooth movement, a canopy for sun protection, and a cup holder for added convenience.

Product Usage Instructions

Assembly:

1. Inspect the product for damaged hardware, loose joints, or missing parts before assembly.
2. Refer to the parts list description to ensure all components are included.
3. Follow the assembly instructions provided in the user manual carefully.

Safety Guidelines:

Always use the safety harness to prevent falling or sliding out while using the Pop 'N Ride™. Ensure that the wheels are locked securely to avoid accidents.

Maintenance:

Regularly check and tighten any loose screws or joints. Keep the product clean and free of debris for optimal performance.

FAQ:

- Q: What should I do if any parts are missing or broken?

A: Do not use the product if any parts are missing or broken. Contact customer support for assistance in obtaining replacement parts.

Please read the following instructions carefully. Keep this instruction manual for future reference. No tools are required. Keep small parts away from children. For technical support, contact us at 1-401-671-6551 or www.summerinfant.com/contact.

WARNING

- Read and follow all warnings and instructions. Failure to do so could result in serious injury or death.
- Adult assembly is required. Exercise care when unpacking and assembling products.
- Maximum weight and height of child: 50 lbs. (22.7 kg), 43 in. (109cm) per seat.
- NEVER leave child unattended. • Avoid serious injury from falling or sliding out. ALWAYS use a safety harness.
- When making adjustments to the product ALWAYS ENSURE that all parts of a child's body are clear of any moving parts of the product.
- Care must be taken when folding and unfolding the product to prevent finger entrapment.
- DO NOT carry additional children, goods or accessories in or on this product except as recommended in the manufacturer's instructions.
- DO NOT hang items on the handlebar or place them on the canopy, as they can tip the product over and injure a child.
- DO NOT OVERLOAD STORAGE BAG. MAXIMUM 2.3 lbs. (1 kg).
- This product may become unstable if a parcel bag, other than the one recommended is used.
- DO NOT overload the cup holder. The MAXIMUM weight for the cup holder is 1lb. (0.45 kg). Excessive weight may cause the product to tip over.
- DO NOT place hot liquids in the cup holder. Spills can burn your child.
- Do not carry or roll the stroller on stairs or escalators with a child in it.
- Do not use the stroller if any part is lost or damaged.
- DO NOT allow the child to stand while the product is in motion.
- To avoid accidental rolling, always lock the brakes when the product is not being used.

Care and Maintenance

- Clean minor stains on fabric with cold water and mild soap.
- Clean plastic and metal surfaces with a soft damp cloth. Air dry. Do not use abrasive cleaners or solvents. Do not use bleach.

- Check seat pad harness and crotch straps weekly to ensure they are properly secured to frame.

Description

1	(1)	Frame
2	(1)	Seat Pad
3	(2)	Front Wheel
4	(2)	Rear Wheel
5	(1)	Canopy
6	(1)	Cup Holder

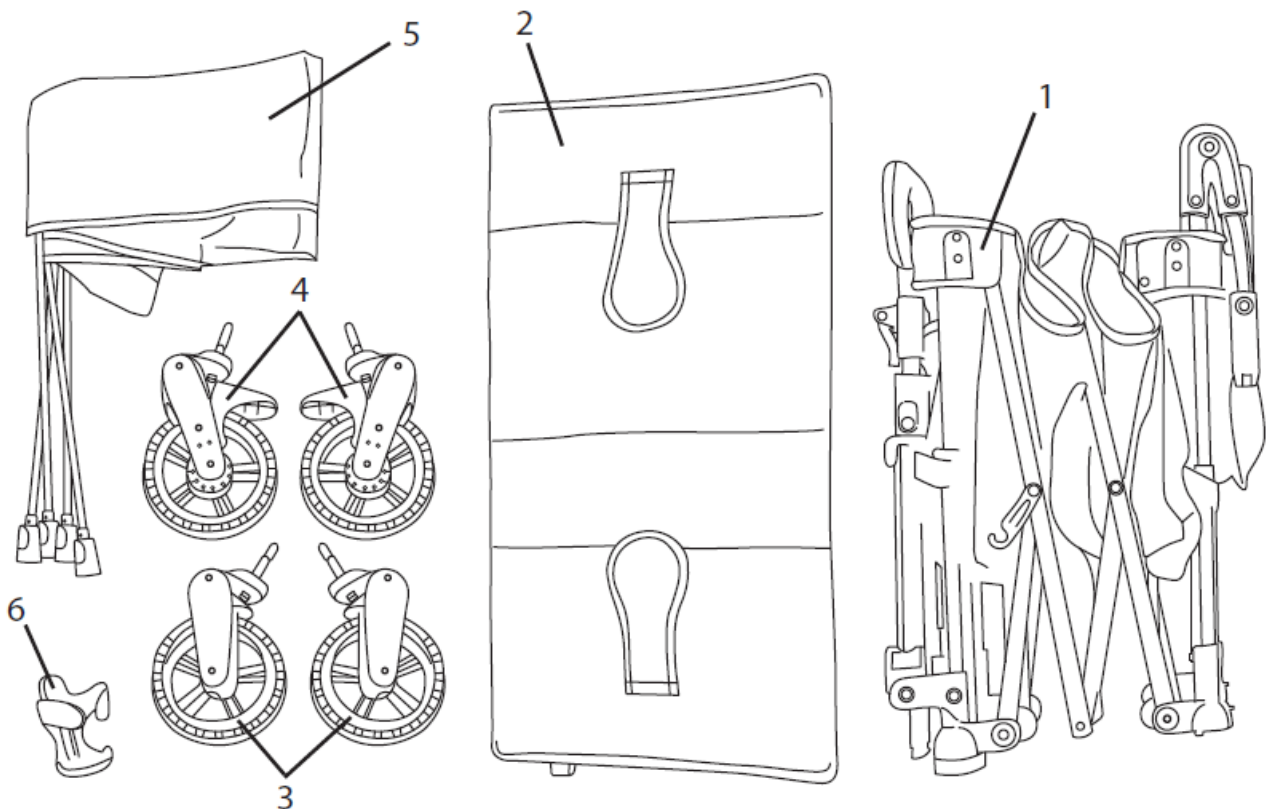

IMPORTANT!

Before assembly, inspect this product for damaged hardware, loose joints or missing parts. Never use if any parts are missing or broken.

Assemble the Wagon

1

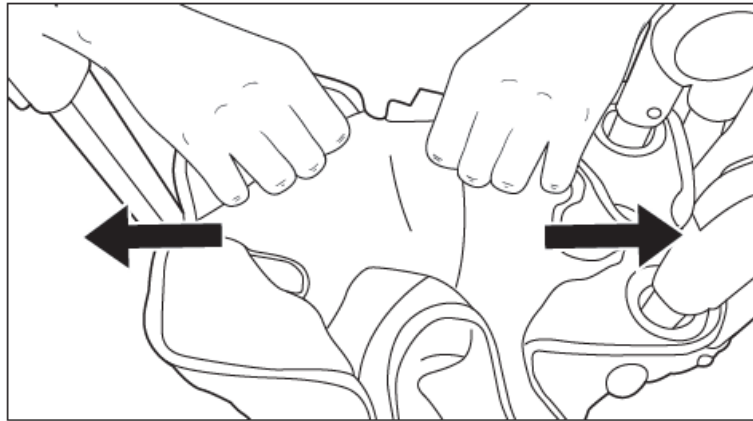
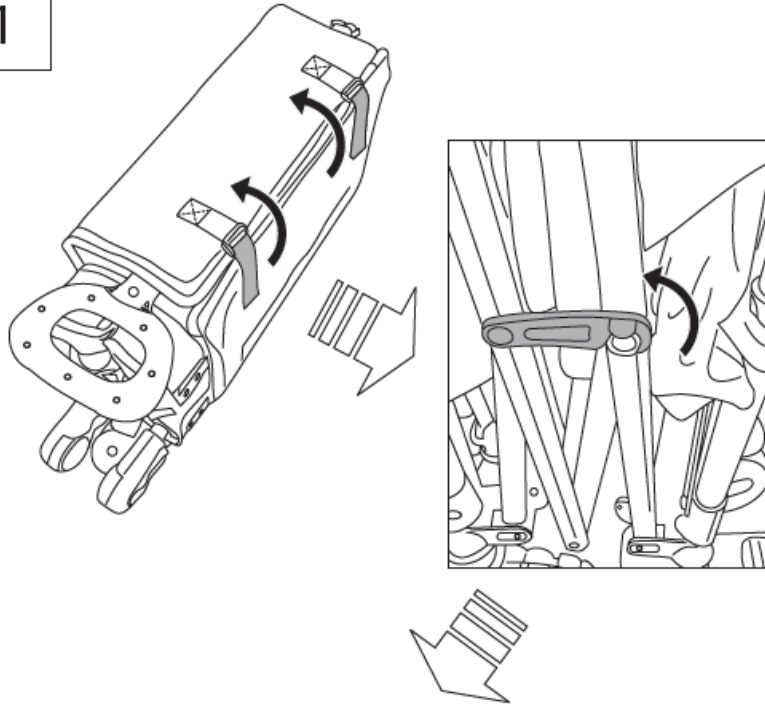

2

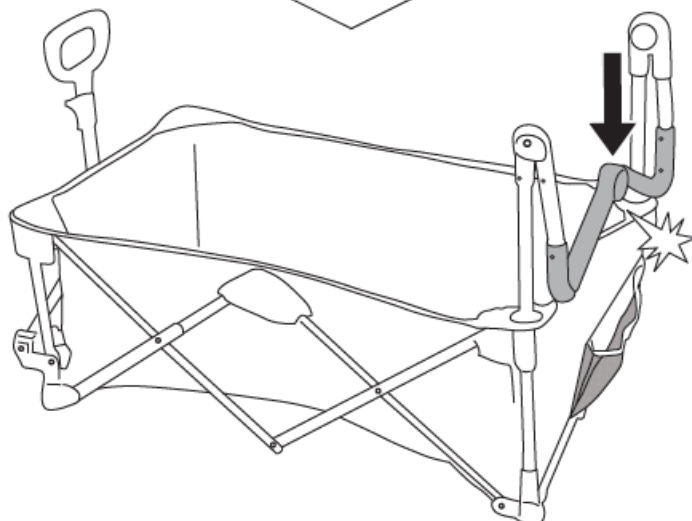
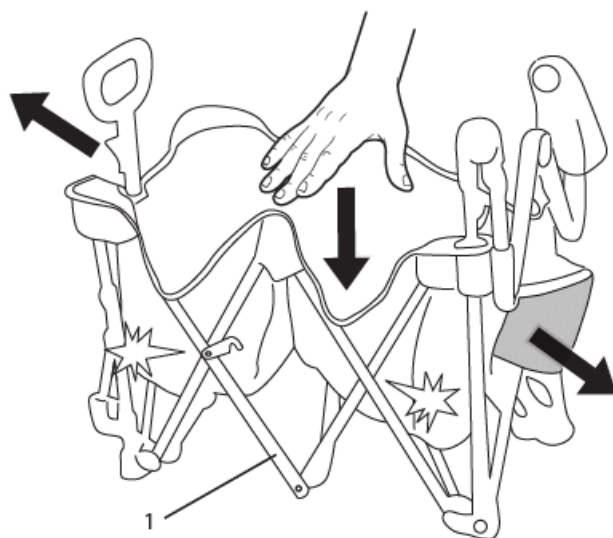

3

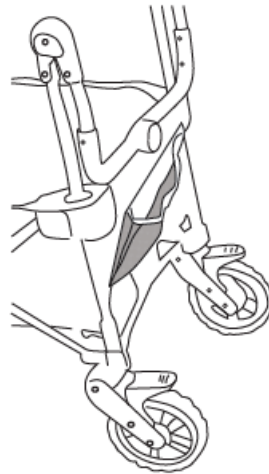
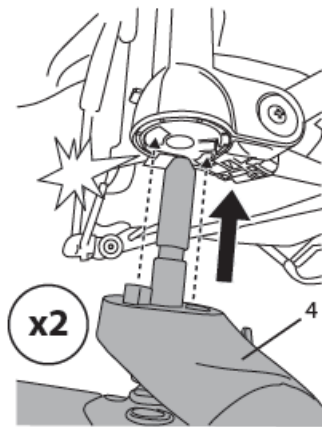
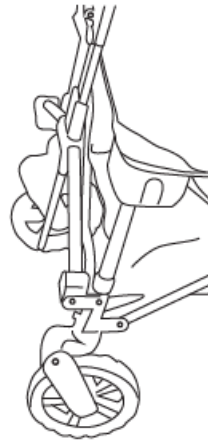
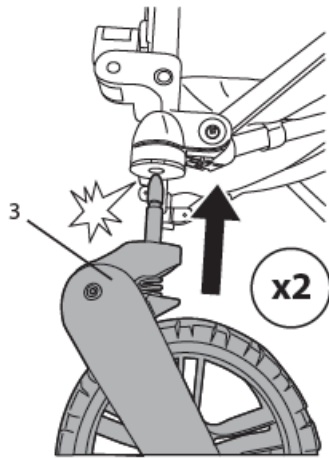

4

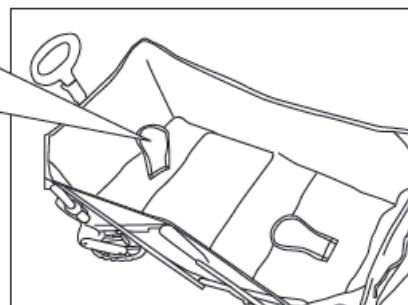
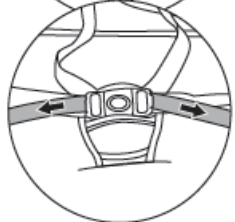
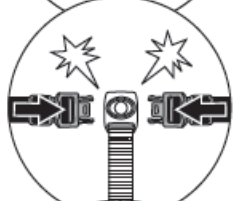
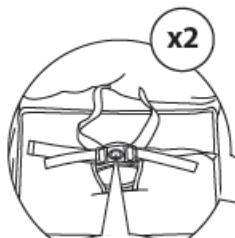
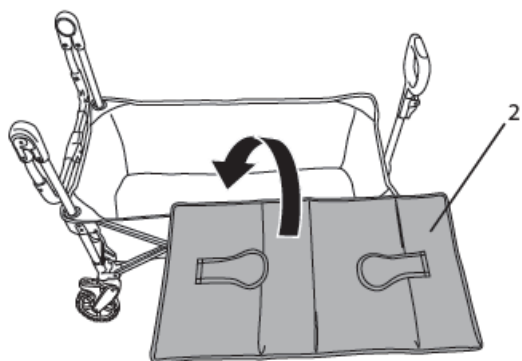

Tighten
Apretar
Serrer



Loosen
Relajarse
Desserrer

5

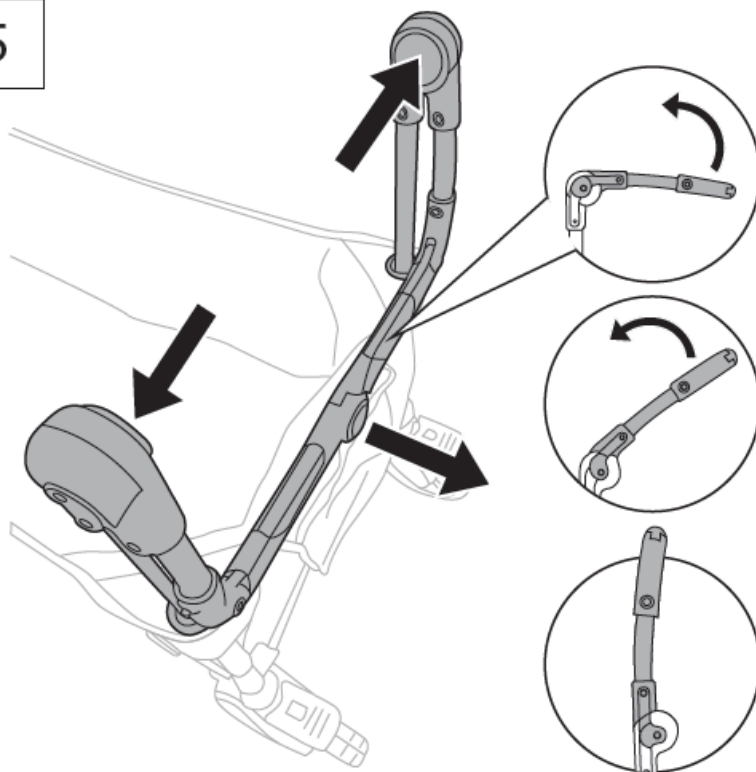

6

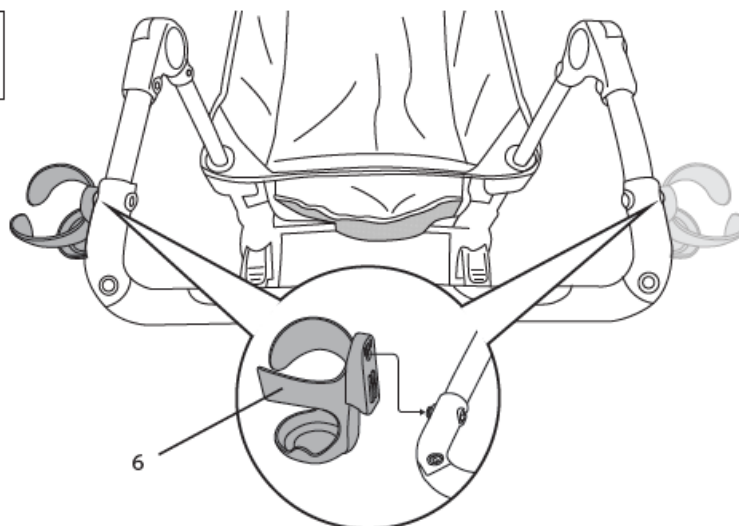

7

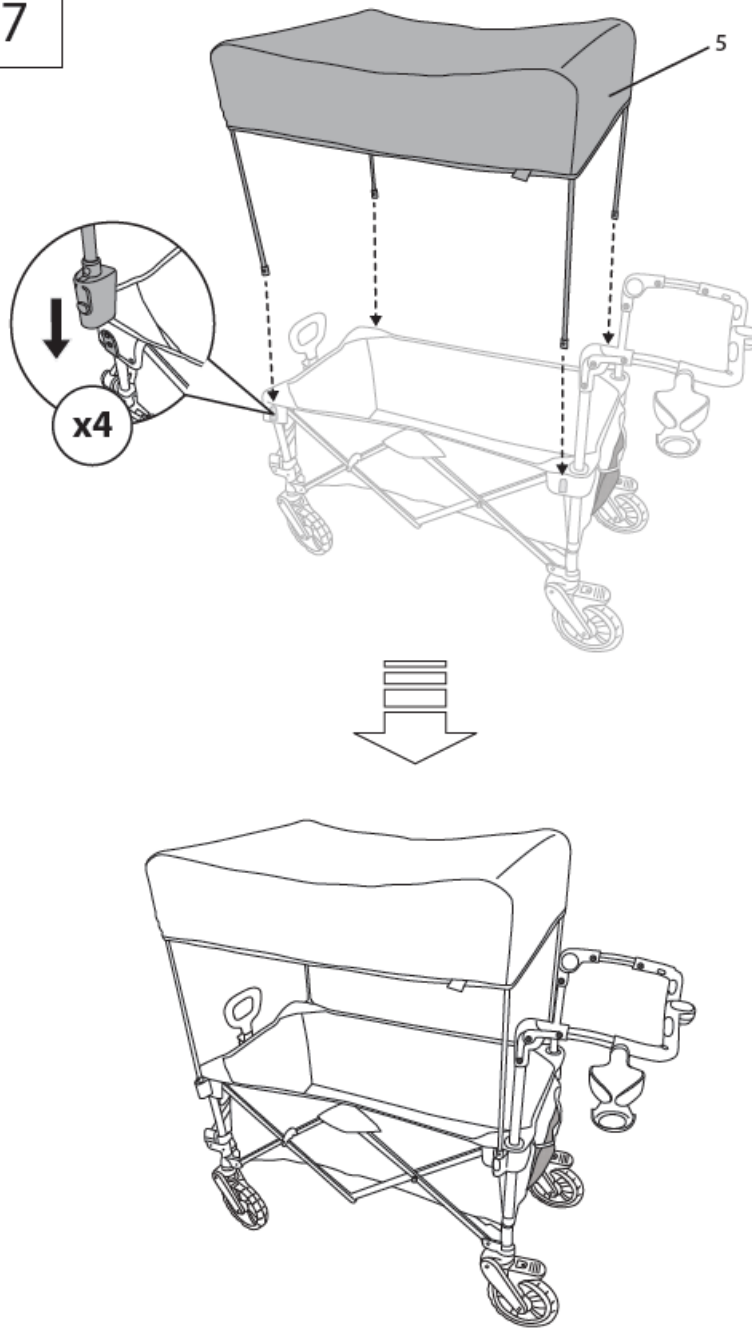

Avoid serious injury from falling or sliding out. ALWAYS use safety harness.

Handle Usage

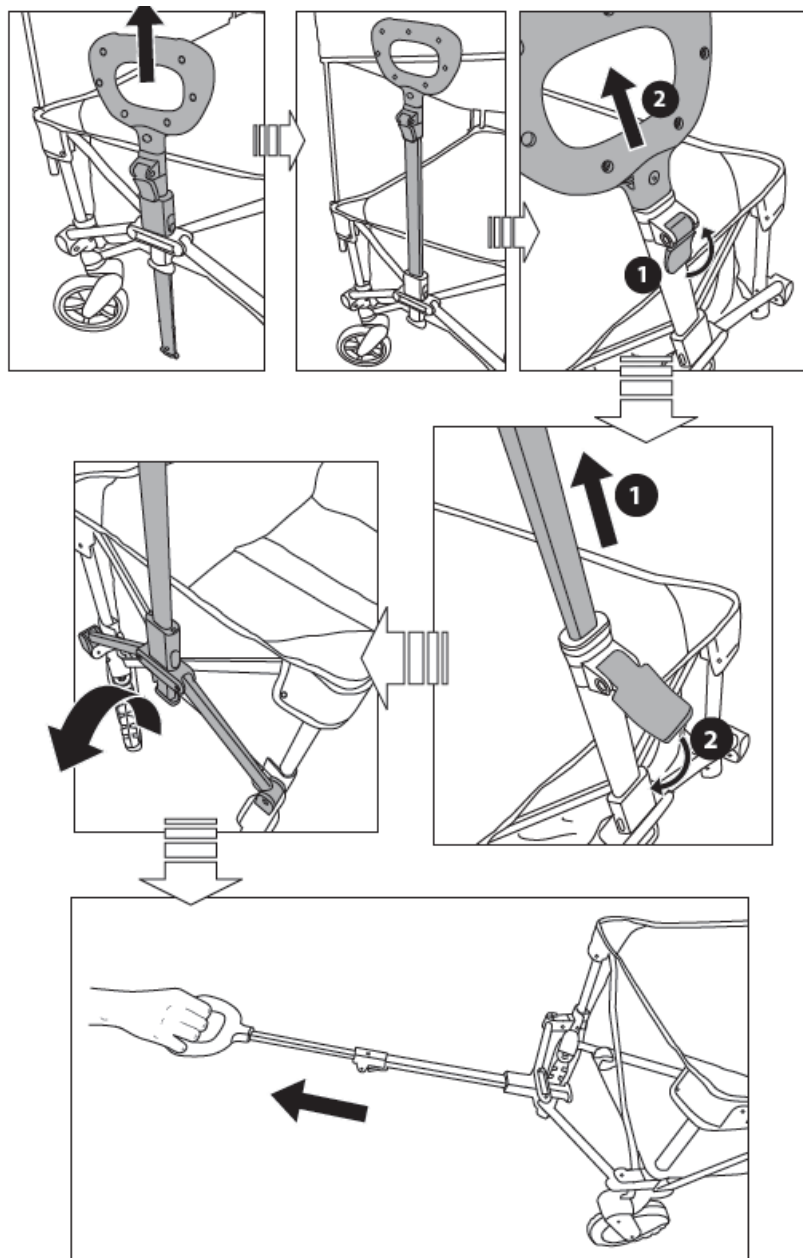

Handle Storage

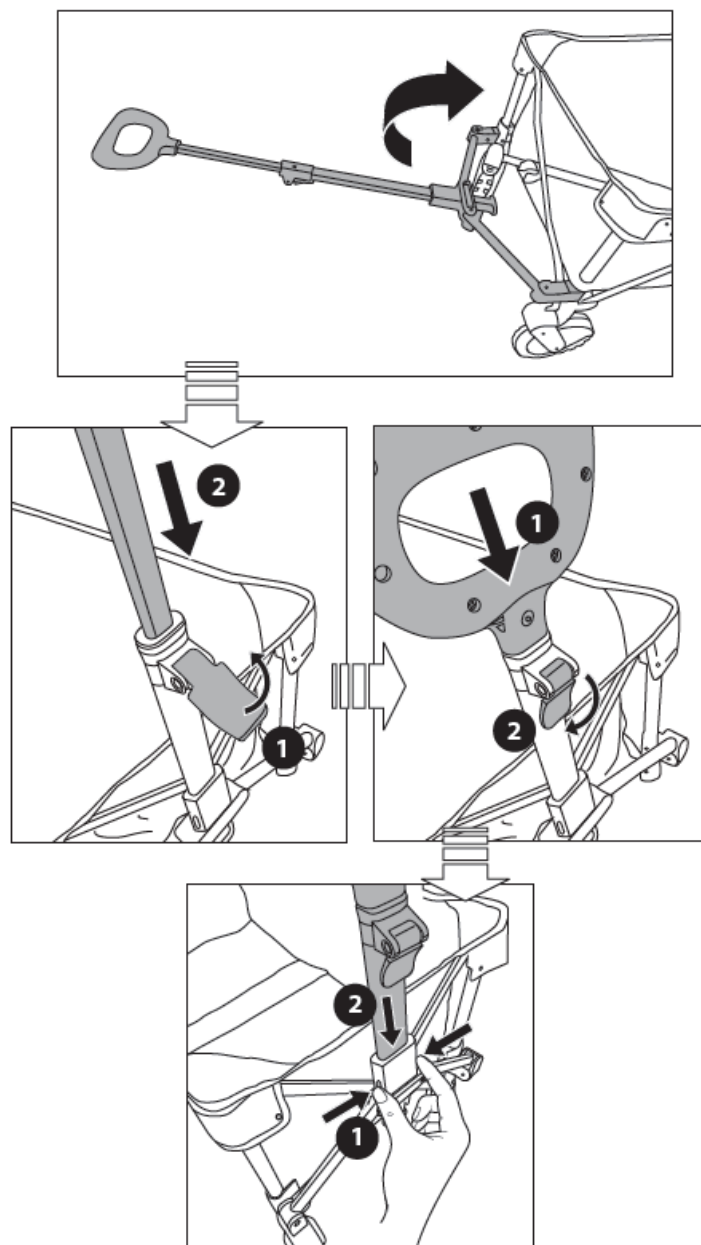

Locking the Wheels

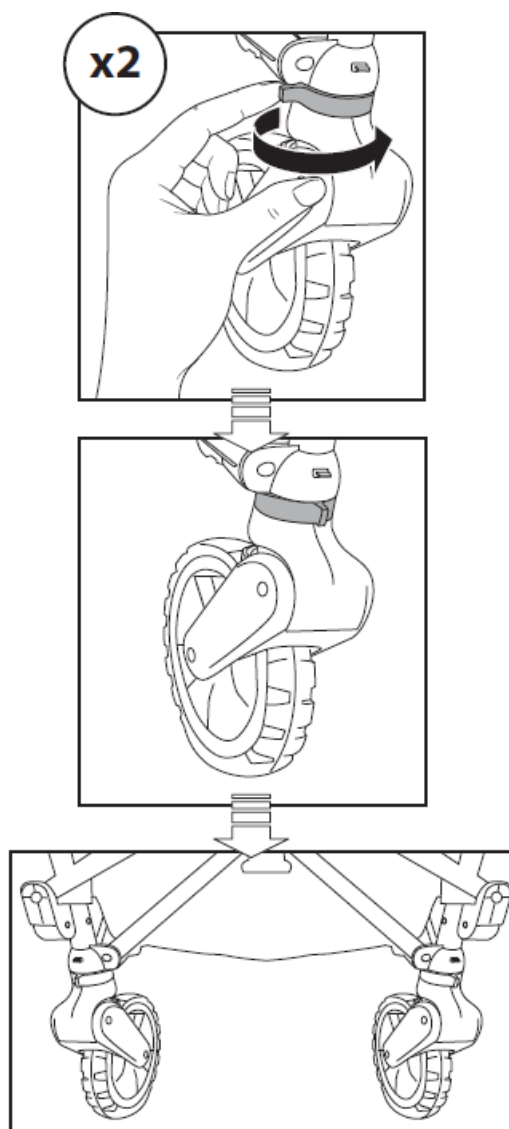

Locking the Brakes

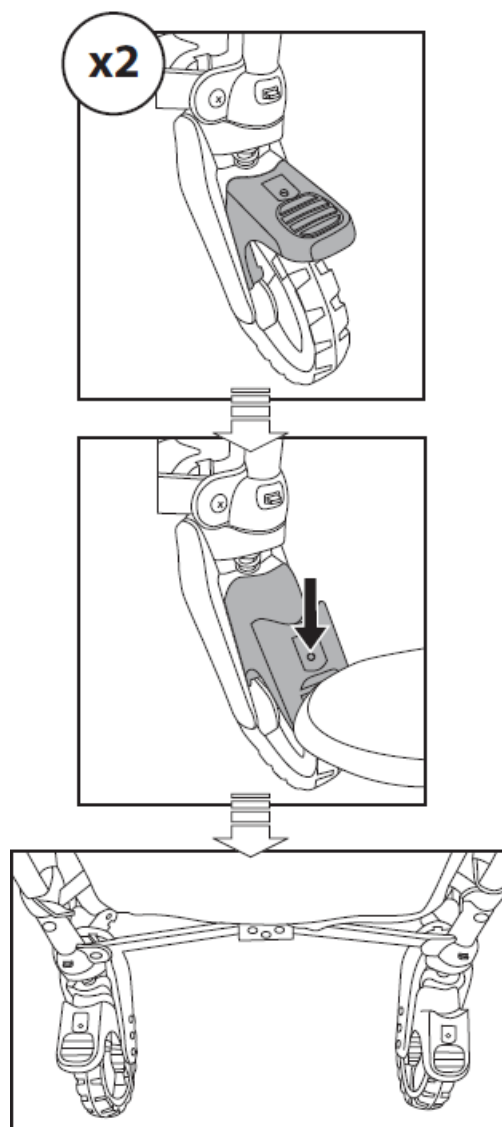

Unlocking the Wheels

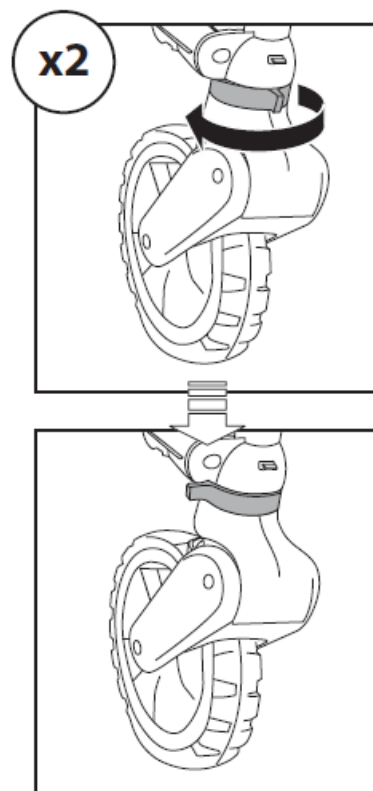

Unlocking the Brakes

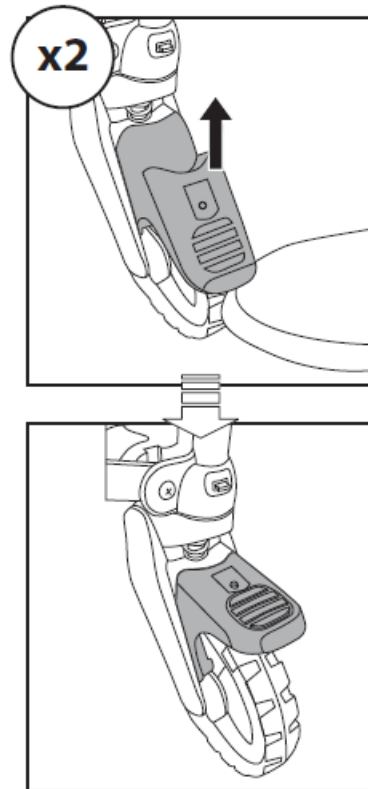

Remove the Wheels

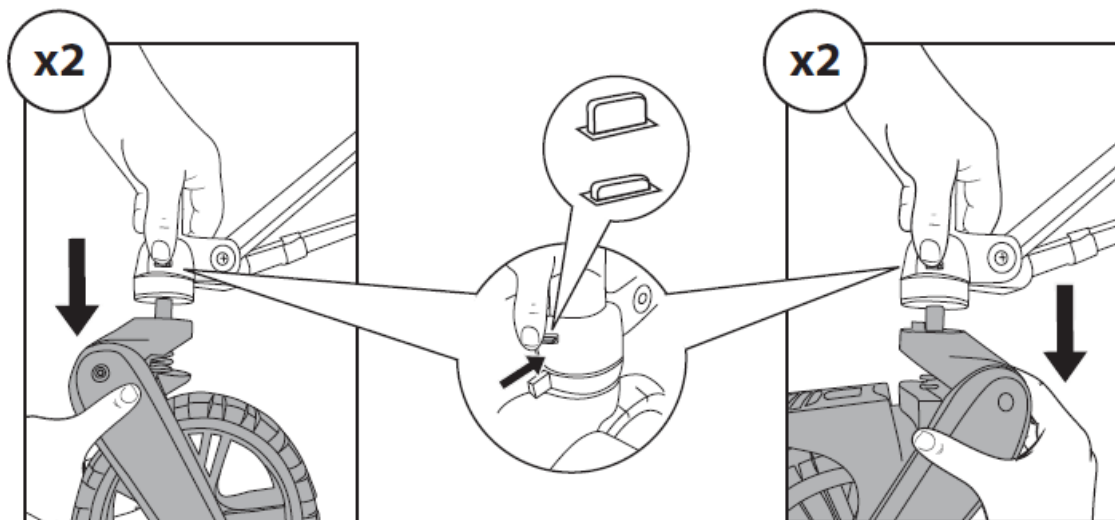

Fold the Wagon

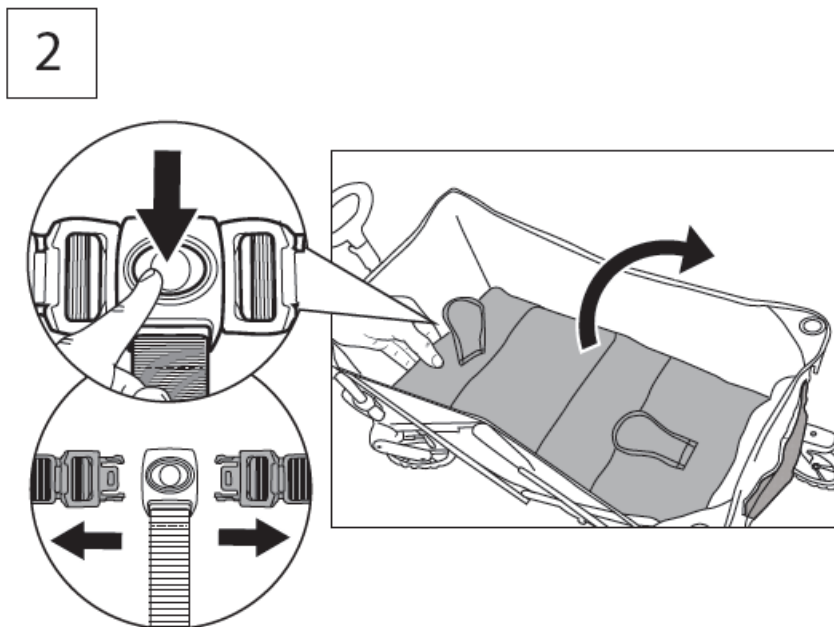
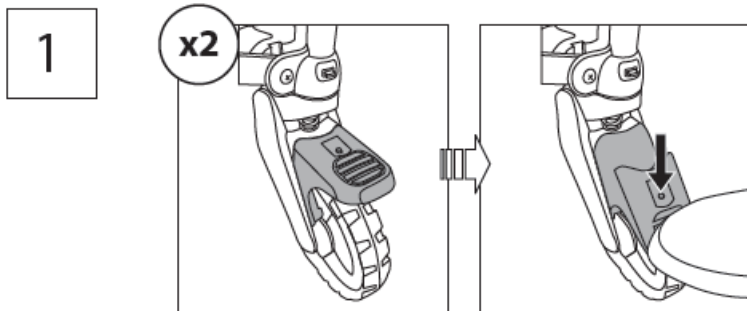

2

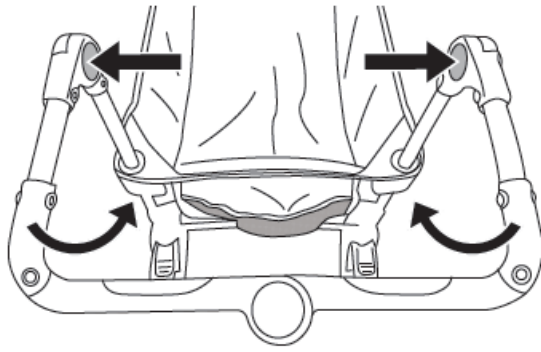

3

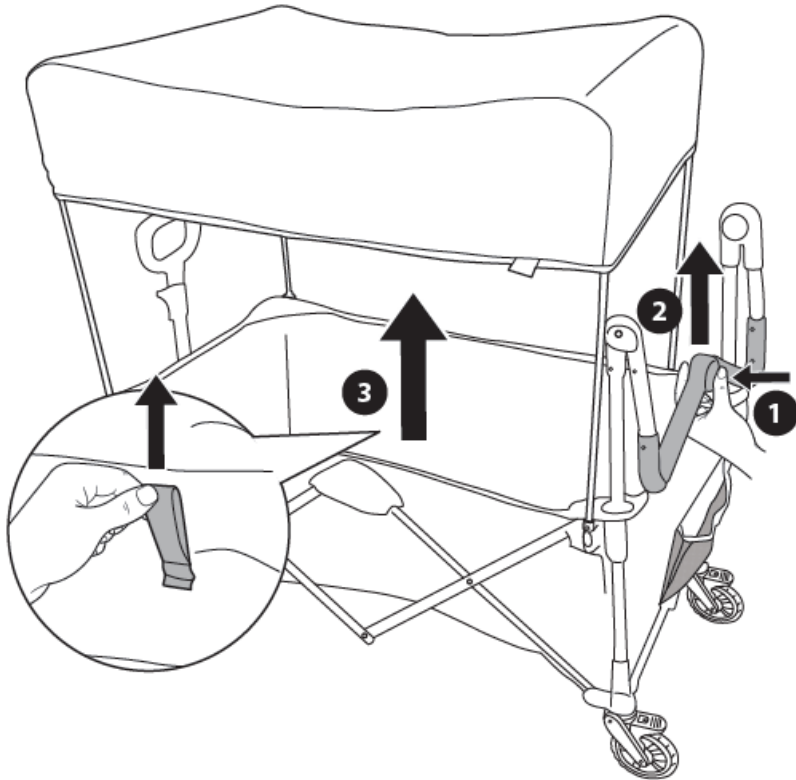

4

Documents / Resources

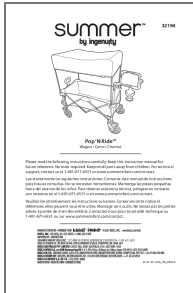

[Summer Infant Pop 'N Jump with Canopy](#) [pdf] Owner's Manual
 Infant Pop N Jump with Canopy, Infant, Pop N Jump with Canopy, Jump with Canopy

References

-  [Kids2 Contact Us – Kids2, LLC](#)
- [User Manual](#)

Manuals+, Privacy Policy

This website is an independent publication and is neither affiliated with nor endorsed by any of the trademark owners. The "Bluetooth®" word mark and logos are registered trademarks owned by Bluetooth SIG, Inc. The "Wi-Fi®" word mark and logos are registered trademarks owned by the Wi-Fi Alliance. Any use of these marks on this website does not imply any affiliation with or endorsement.