

summer™  
**3Dquickclose  
CS Plus  
Compact  
Fold  
Stroller**



# Summer 3Dquickclose CS Plus Compact Fold Stroller Instruction Manual

[Home](#) » [Summer](#) » Summer 3Dquickclose CS Plus Compact Fold Stroller Instruction Manual 

## Contents

- [1 Summer 3Dquickclose CS Plus Compact Fold Stroller](#)
- [2 Product Usage Instructions](#)
- [3 Components](#)
- [4 Features](#)
- [5 Assembly Instructions](#)
- [6 Locking/Unlocking 5 Point Safety Harness](#)
- [7 Tightening and Loosening](#)
- [8 Adjusting Shoulder Harness Position](#)
- [9 attaching a car seat](#)
- [10 Care and Maintenance](#)
- [11 Frequently Asked Questions](#)
- [12 Documents / Resources](#)
  - [12.1 References](#)

summer™

Summer 3Dquickclose CS Plus Compact Fold Stroller



### Specifications:

- **Model:** 3D-pac CS+ compact fold stroller
- **Components:** Stroller Frame with Seat, Front Wheels (2), Rear Wheels (2), Bumper Bar, Cup Holder, Cell Phone Holder
- **Replacement Parts:** Front wheels (32723-24), Rear wheels (32723-22), Cup holder (21790-25), Cell phone holder (32453-03), Bumper bar (31900-05)
- **Features:** Canopy with extension, Harness pads, Child/bottle cup holder, Adjustable leg rest, Front wheel locks, Storage pocket, Cell phone holder, Seat recline clip, Dual action fold release, Rear wheel brake pedal

### Product Usage Instructions

#### Assembly Instructions:

1. First, slide the upper handle button then squeeze the lower handle release button.
2. Quickly pull up the stroller by the handle bars until it clicks into fully open position. Stroller will lock into open position.
3. Align front wheels and rear wheels and push into frame. Ensure they are securely attached and front wheels turn freely.
4. Snap bumper bar into position.
5. Line up slot on the back of the cup holder with a mounting post and push down. Line up slot on cell phone holder with a mounting post and push down.
6. Extend canopy forward. Optional: Pull down the canopy visor to extend the canopy.

Locking/Unlocking 5 Point Safety Harness:

Press to lock, click to unlock.

**Tightening and Loosening the 5-Point Safety Harness:**  
Slide to tighten, slide to loosen.

### **Adjusting Shoulder Harness Position:**

1. Unclip harness clips.
2. Remove harness pads.
3. Slide shoulder harness out of slot and adjust to desired position.

### **Locking & Unlocking Front Wheels:**

Rotate lever to lock or unlock front swivel wheels.

### **Rear Brake:**

Press foot pedal down to lock both rear wheels. Press foot pedal forward to unlock the rear wheels.

### **Adjusting the Seat Recline:**

Pinch seat recline clip on the back of the stroller and slide along webbing to adjust the seat recline.

**WARNING** Read and follow all warnings and instructions. Failure to do so could result in serious injury or death.

- Maximum weight and height of child: 50 lbs. (22.7 kg), 43 in. (109cm)
- NEVER leave child unattended.
- Avoid serious injury from falling or sliding out. ALWAYS use safety harness.
- When making adjustments to the product ALWAYS ENSURE that all parts of a child's body are clear of any moving parts of the product.
- Care must be taken when folding and unfolding the product to prevent finger entrapment.
- DO NOT carry additional children, goods or accessories in or on this product except as recommended in the manufacturer's instructions.
- TO AVOID INJURY TO YOUR CHILD, DO NOT USE STORAGE BASKET AS A CHILD CARRIER.
- DO NOT hang items on handle bar or place them on the canopy, as they can tip stroller over and injure child.
- DO NOT OVERLOAD STORAGE BASKET. MAXIMUM 10 lbs. (4.5 kg).
- This product may become unstable if a parcel bag, other than the one recommended is used.
- DO NOT overload the storage pocket, cell phone holder or cup holder.  
MAXIMUM weight for the cell phone and cup holder is 1lb. (0.45 kg). MAXIMUM weight of storage pocket and child cup holder is 1/2 lb. (0.23 kg). Excessive weight may cause stroller to become unstable or tip over.
- DO NOT place hot liquids in the cup holder. Spills can burn your child.
- Do not carry or roll stroller on stairs or escalators with child in it.
- Do not use the stroller if any part is lost or damaged.
- NEVER install Infant Car Seat without fastening it securely to the stroller with provided car seat straps.
- NEVER lift the stroller by infant carrier handle.
- USE ONLY WITH Summer™ Affirm™ 335, Graco® SnugRide® Click Connect™ 35, Graco® SnugRide® SnugLock® 35, Chicco® Keyfit® 30, Chicco® Fit2® and Baby Trend® Secure Snap Gear® 35 Infant Car Seats. Other car seats or carriers are not designed to fit this stroller frame and may result in serious injury or death. NEVER use them as they have not been safety tested.

- Car seat must be in rear facing position only.

## Components

**IMPORTANT!** Before assembly, inspect this product for damaged hardware, loose joints or missing parts. Never use if any parts are missing or broken.

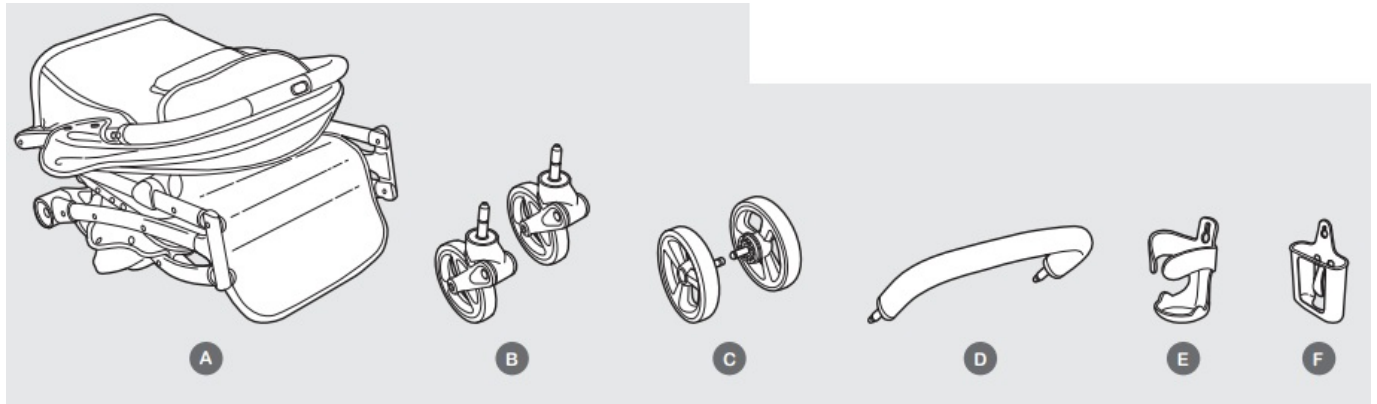

- **A** Stroller Frame with Seat
- **B** Front Wheels (2)
- **C** Rear Wheels (2)
- **D** Bumper Bar
- **E** Cup Holder
- **F** Cell Phone Holder

### 3D-pac CS+ stroller replacement parts:

front wheels	32723-24	cell phone holder	32453-03
rear wheels	32723-22	bumper bar	31900-05
cup holder	21790-25	car seat strap set	32453-04

## Features

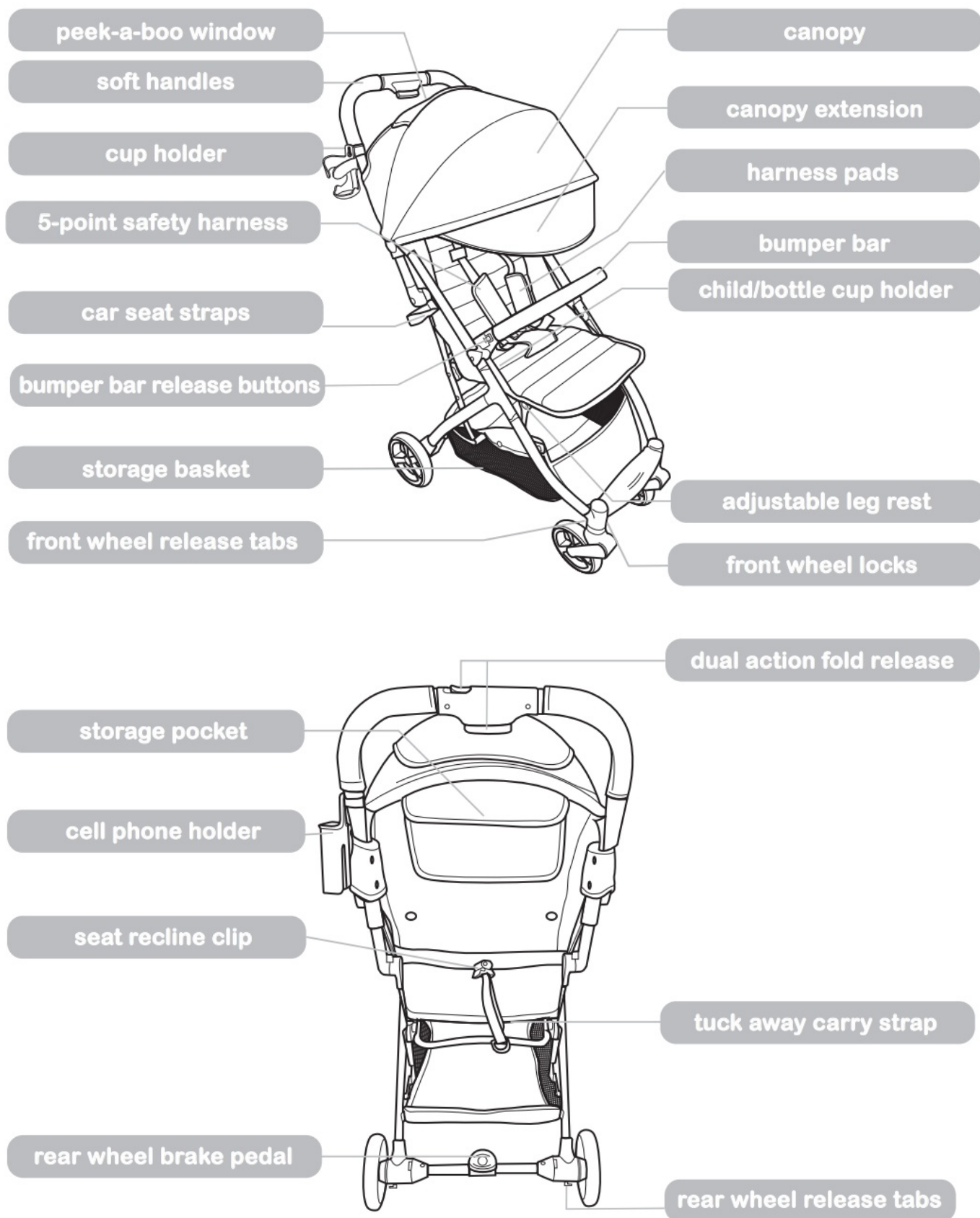

## Assembly Instructions

1. First, slide the upper handle button then squeeze the lower handle release button.
2. Quickly pull up stroller by the handle bars until it clicks into fully open position. Stroller will lock into open position.

**!** **NOTE:** When opening the stroller, ensure that your child, or other children, are at a safe distance.

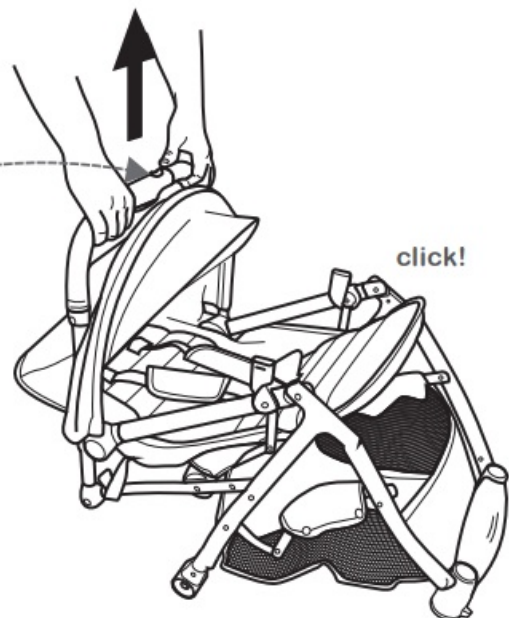
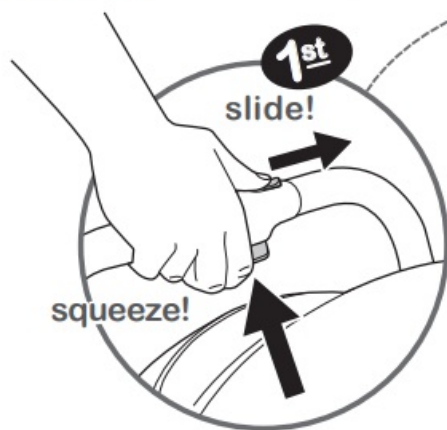

3. Align front wheels and rear wheels and push into frame.

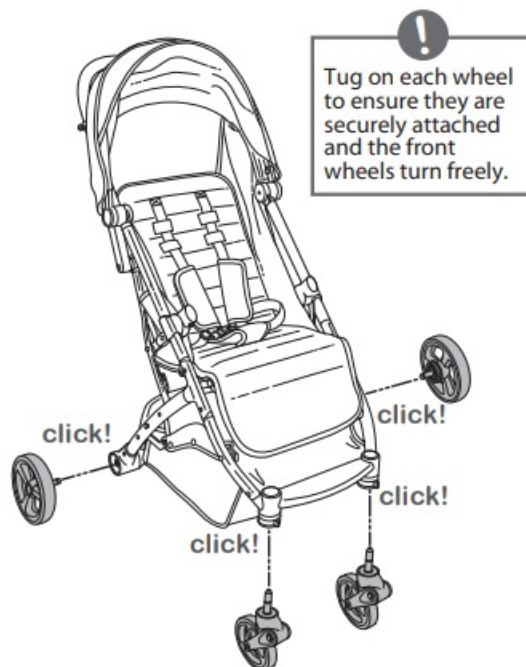

4. Snap bumper bar into position.

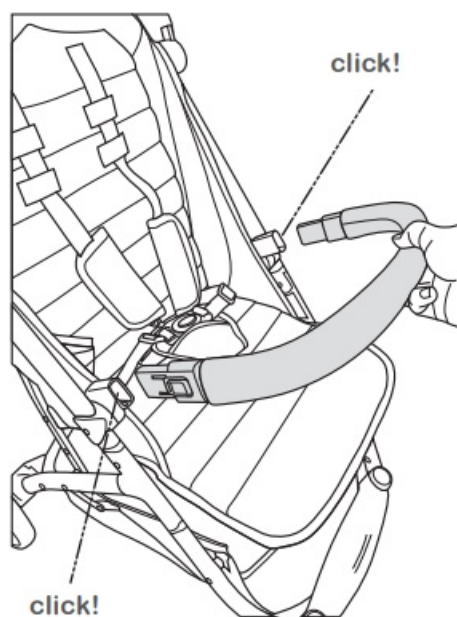

5. Line up slot on the back of the cup holder with a mounting post and push down. Line up slot on cell phone



holder with a mounting post and push down.

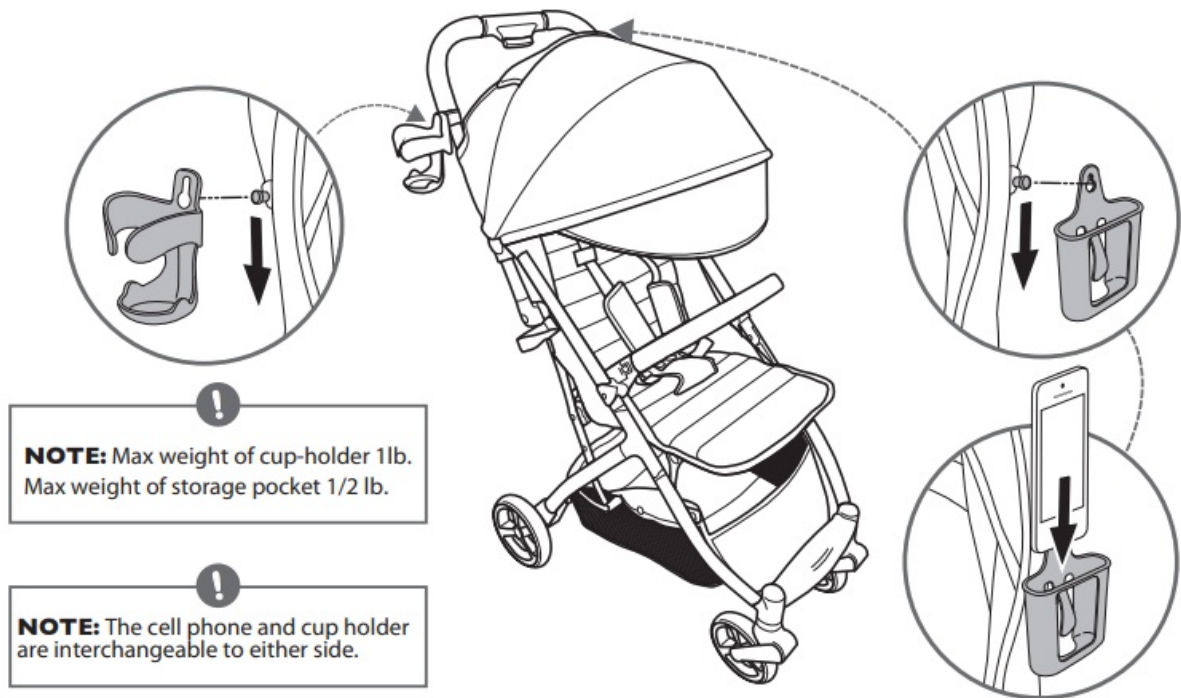

6. Extend canopy forward. Optional: Canopy visor is tucked beneath the canopy. Pull it down to extend the canopy.

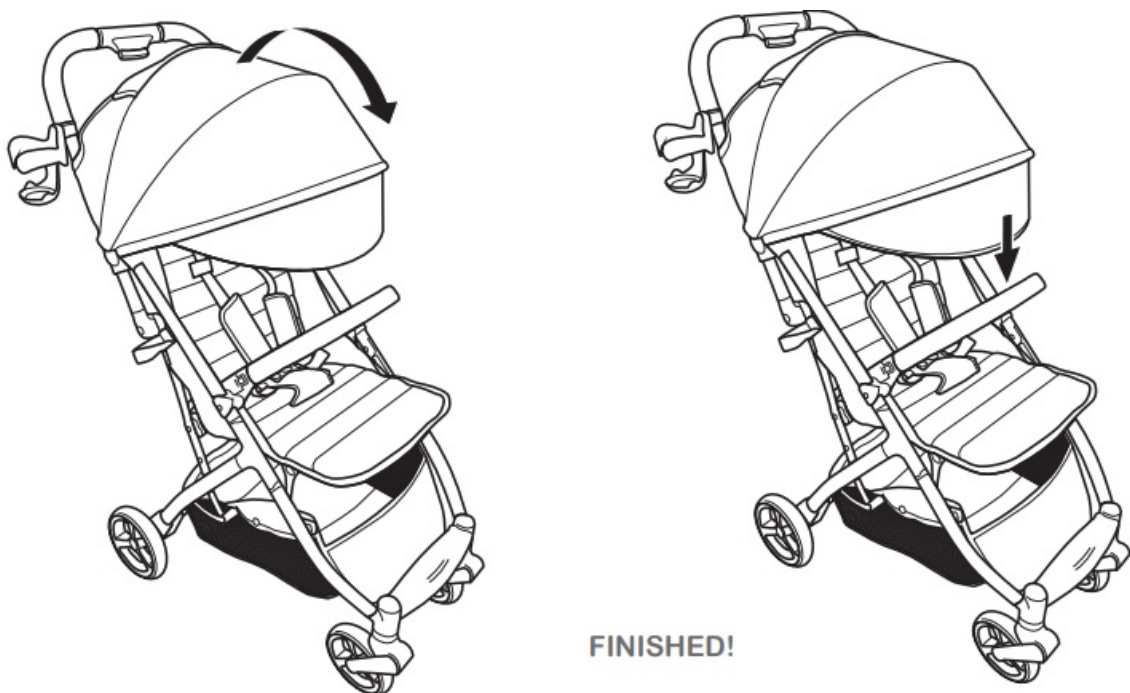

## Locking/Unlocking 5 Point Safety Harness

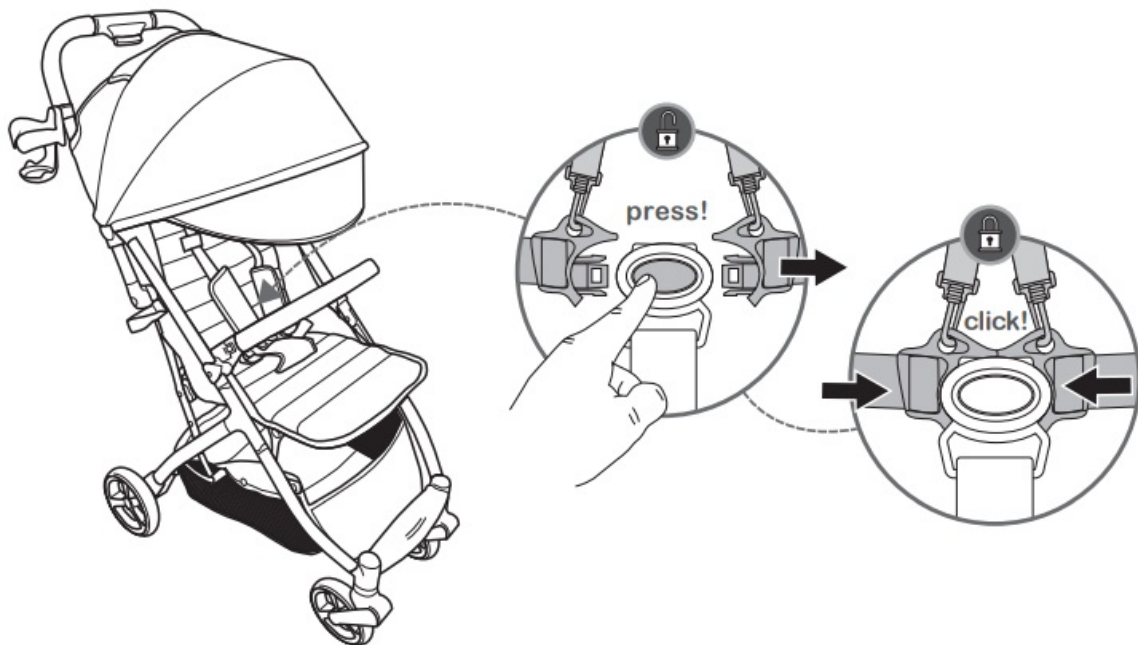

## Tightening and Loosening

tightening and loosening the 5-point safety harness

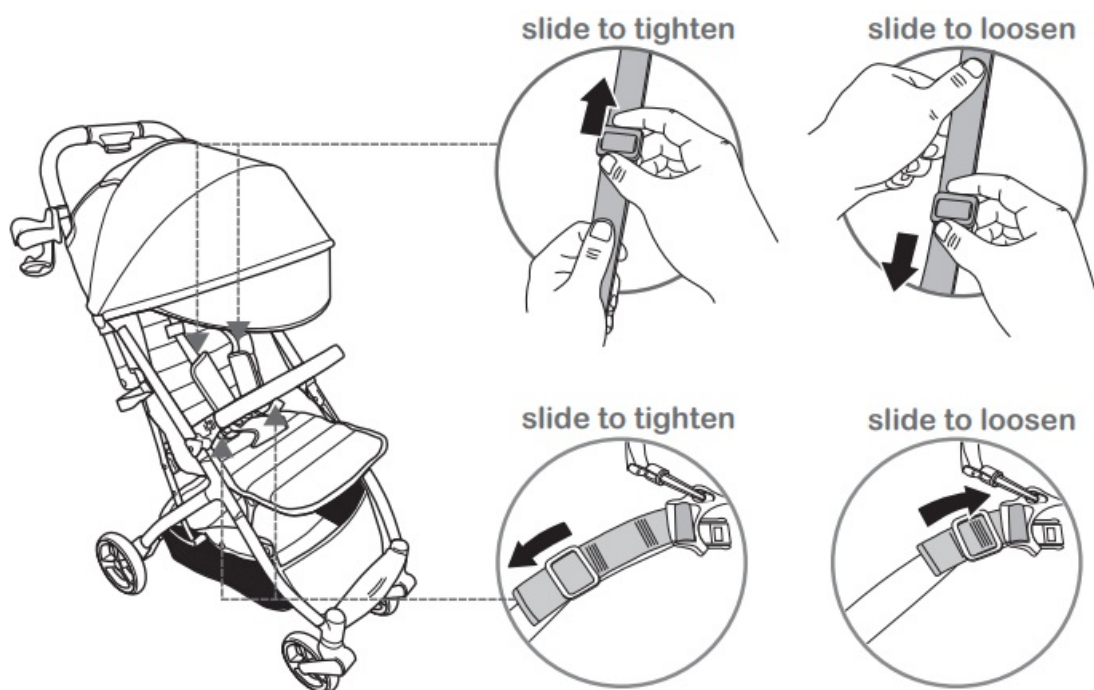

## Adjusting Shoulder Harness Position

1st, unclip harness clips. 2nd, remove harness pads. 3rd, slide shoulder harness out of slot. Adjust harness position as shown below and reinstall harness pads.



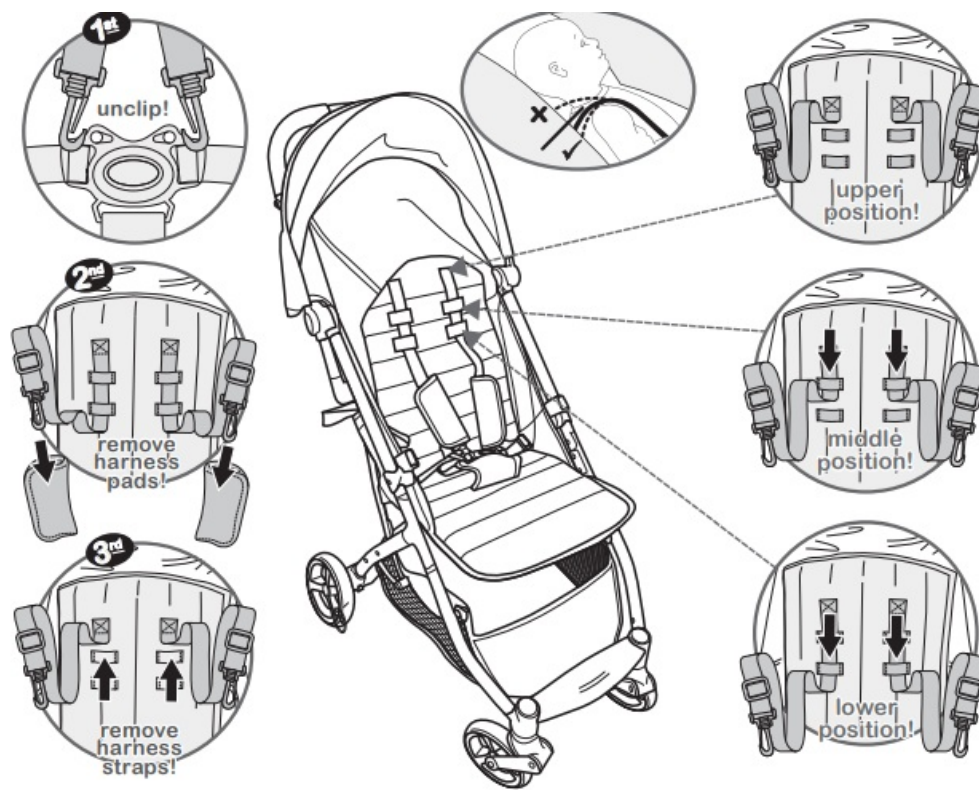

### locking & unlocking the front wheels

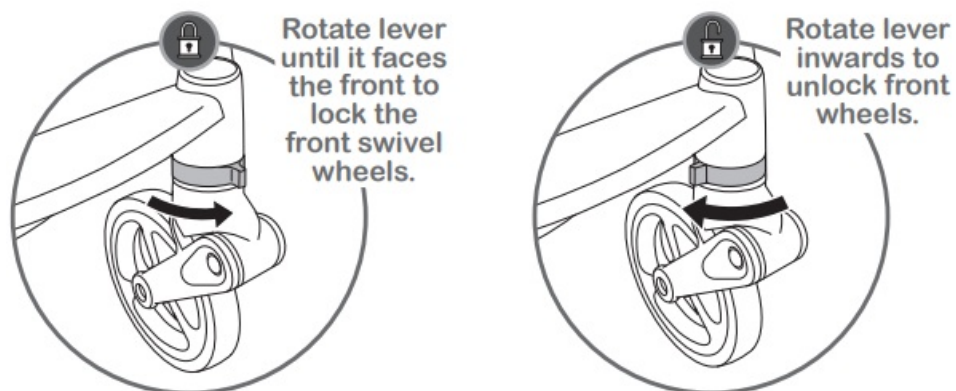

### rear brake

Press the foot pedal down to lock both rear wheels. Press the foot pedal forward to unlock the rear wheels.

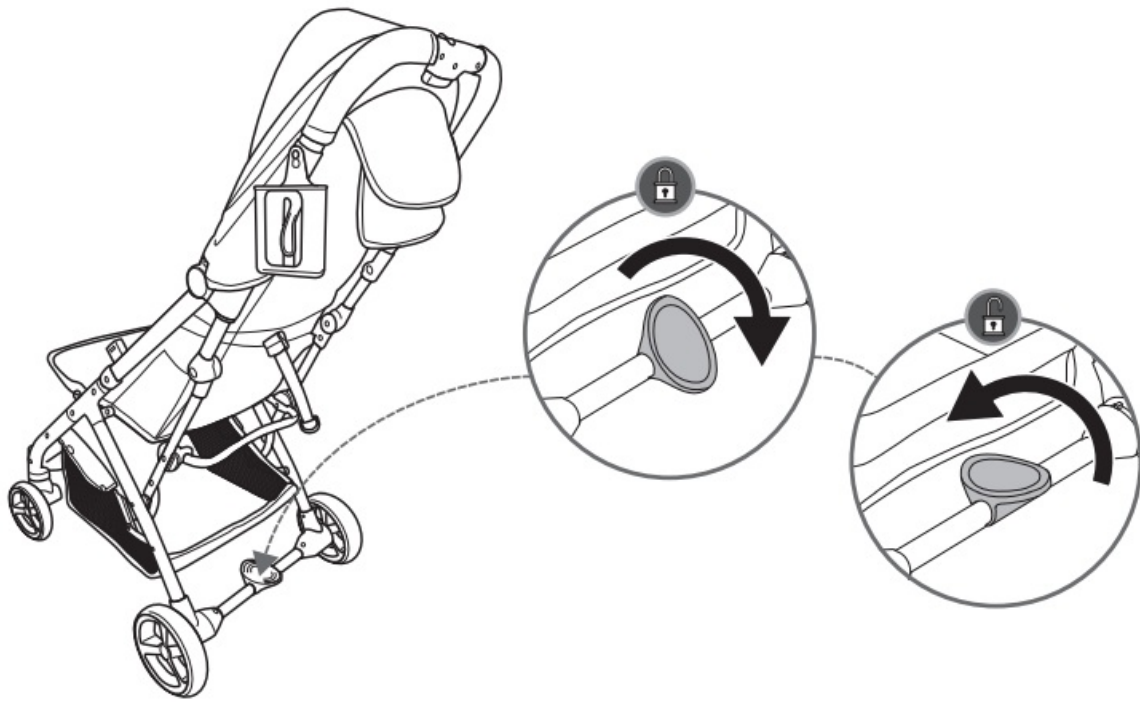

### **adjusting the seat recline**

Pinch seat recline clip on back of stroller and slide recline clip along webbing to adjust the seat recline.

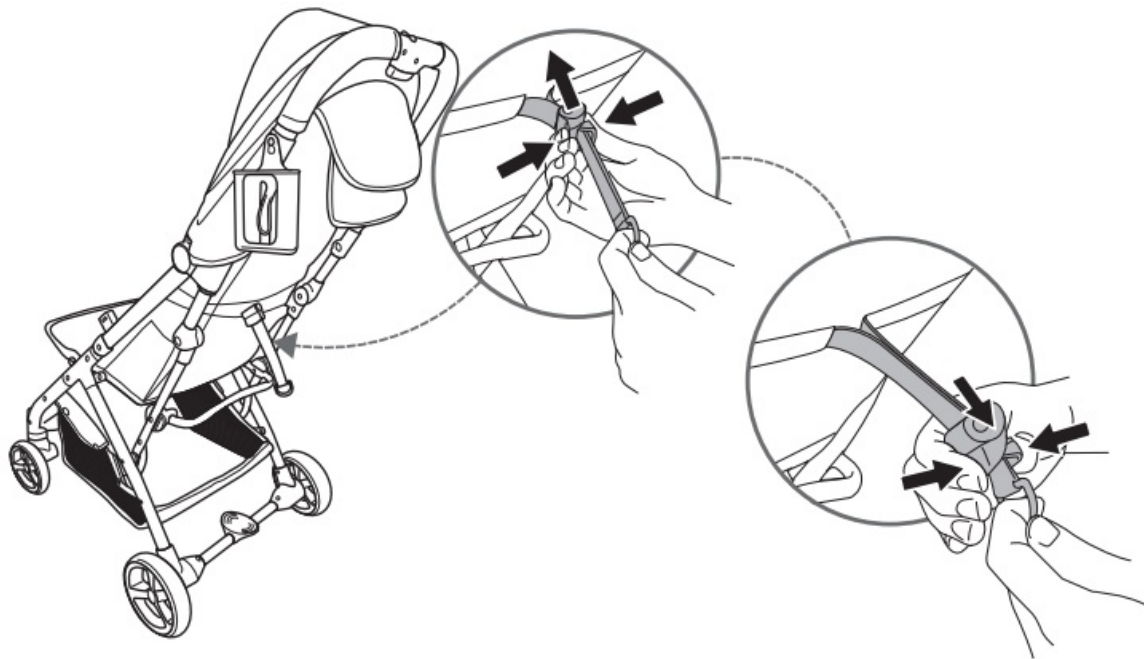

### **adjusting the leg rest**

Raise leg rest up until it locks into desired position. Press the buttons on the side of the leg rest and rotate leg rest down to lower positions.

**raise leg rest up!**

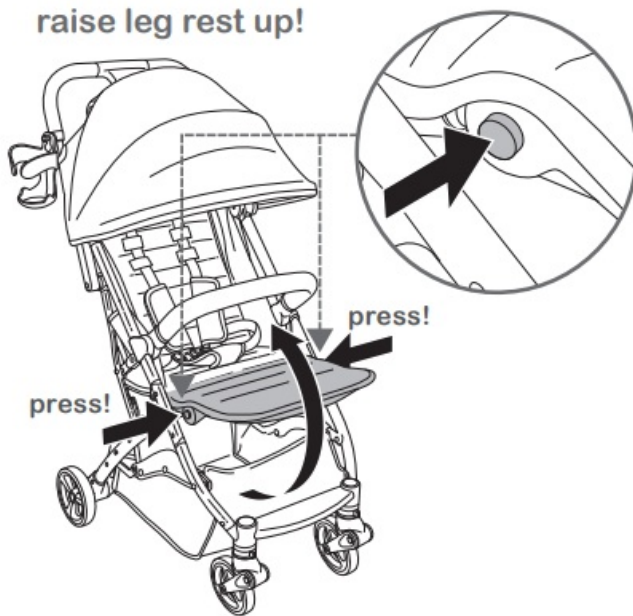

**fold leg rest down!**

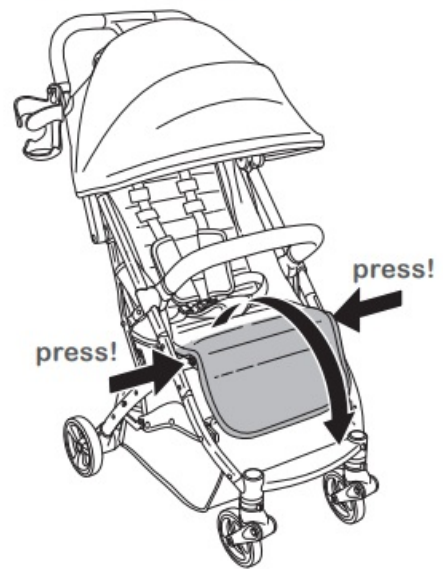

**child bottle/cup holder:**

Slide baby bottle or sippy cup into side holder.

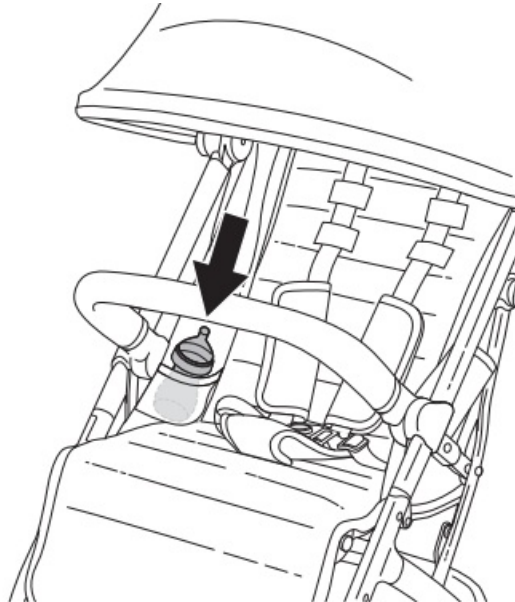

**peek-a-boo window:**

Flip up peek-a-boo window on top of the canopy.

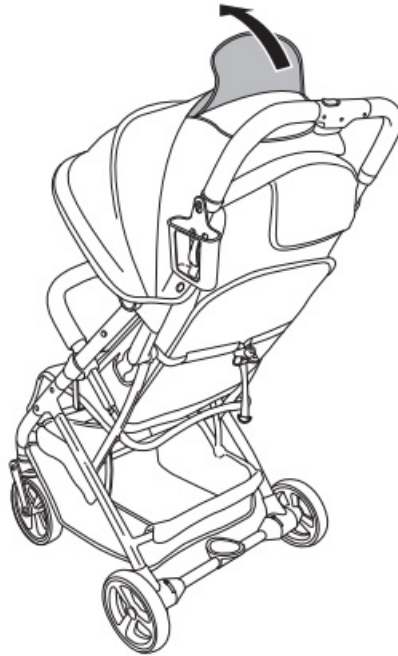

### **folding the stroller**

1. Flip canopy extension in storage position prior to folding the canopy.



2. First, slide the upper handle button then squeeze the lower handle release button, stroller will quickly close as shown.

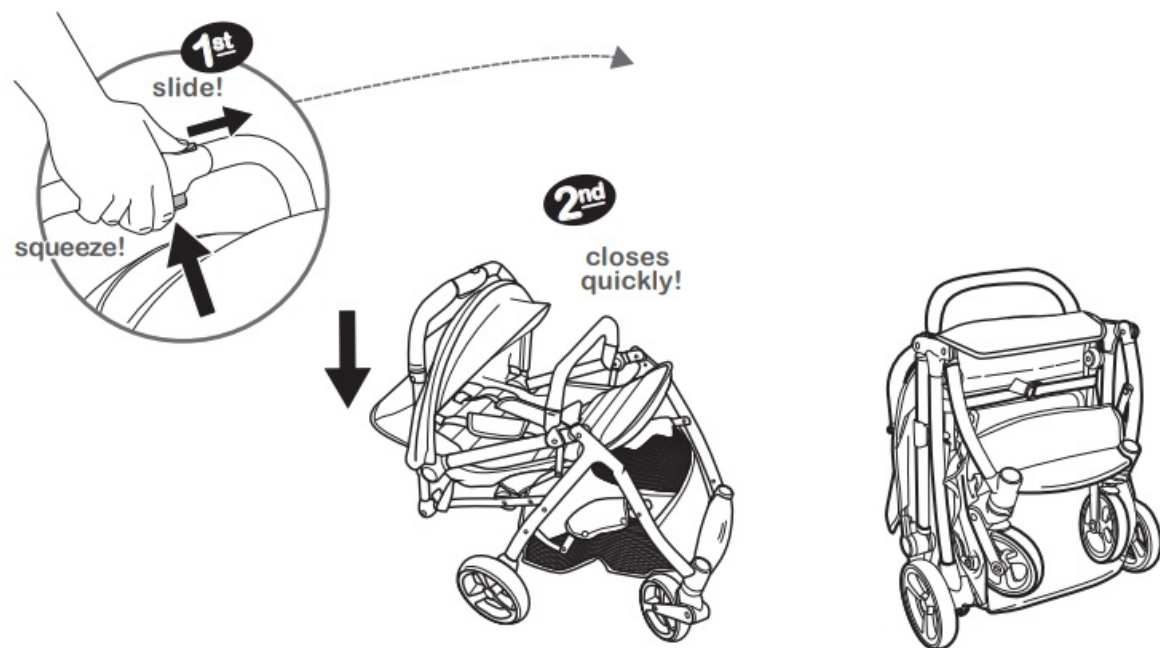

3. Carry strap is stored in the pocket underneath the leg rest.



#### **WARNING**

**STRANGULATION HAZARD:** Children have strangled when straps have wrapped around their neck. Keep this stroller carrier strap out of children's reach. When not in use, tuck strap into storage pocket beneath seat.

#### **removing the bumper bar:**

Press the buttons beneath the bumper bar knuckles to remove.



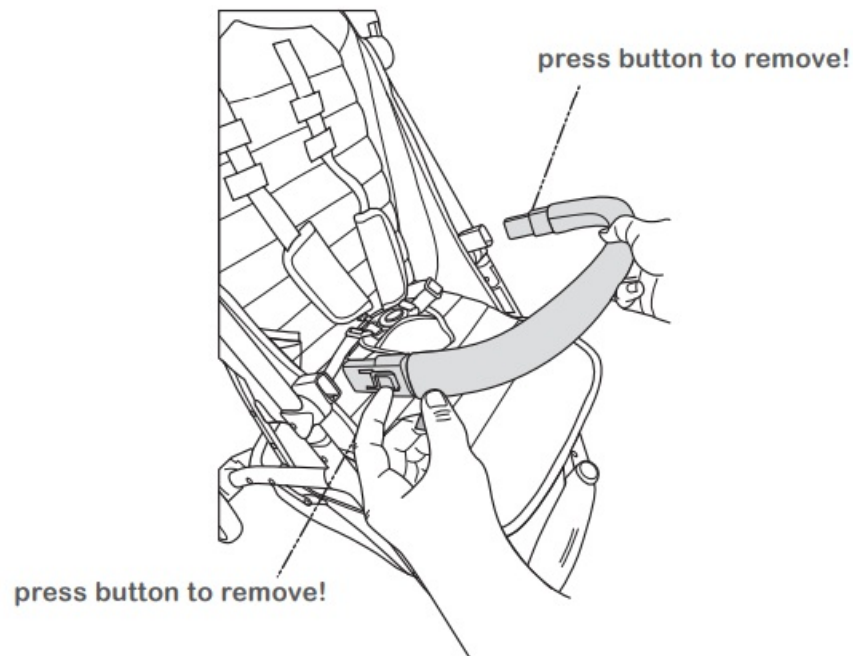

### removing the wheels:

Each wheel has a release tab. Pull the release tabs out to remove wheels from frame.

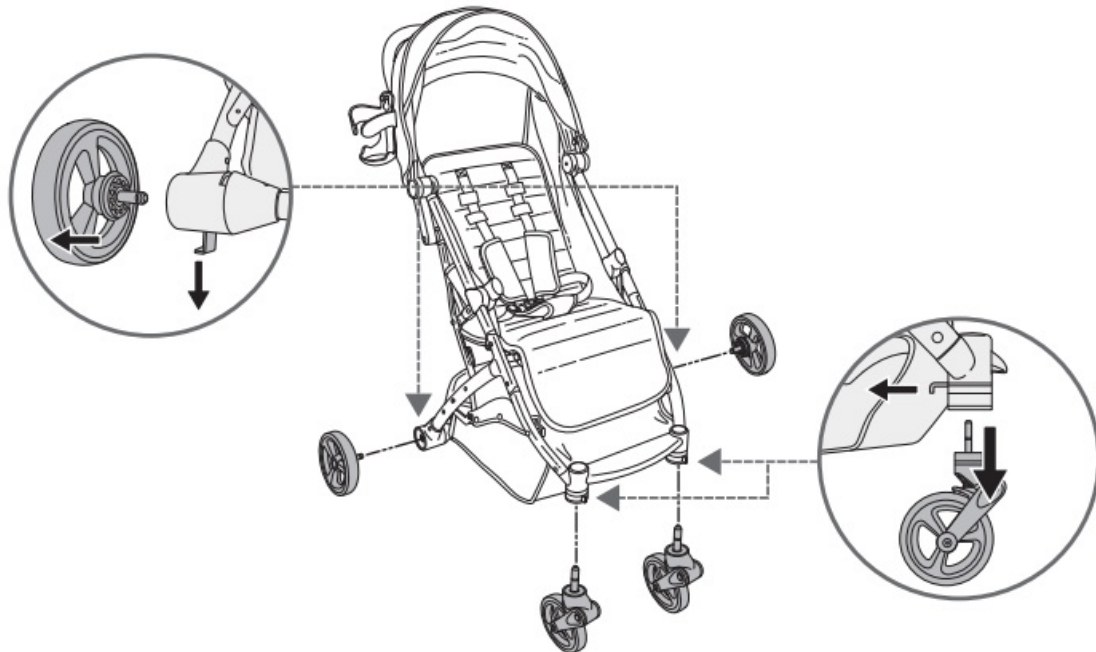

### attaching a car seat

Use this section to attach car seat models:

Summer™ Affirm™ 335, Graco® SnugRide® Click Connect™ 35, Graco® SnugRide® SnugLock® 35, Chicco® Keyfit® 30, Chicco® Fit2® and Baby Trend® Secure Snap Gear® 35

**WARNING: IMPORTANT! KEEP FOR FUTURE REFERENCE!**

- NEVER install Infant Car Seat without fastening it securely to the stroller with the provided car seat straps.  
Car seat must be in rear facing position only.
- NEVER lift the stroller by infant carrier handle.

Use only with Summer™ Affirm™ 335, Graco® SnugRide® Click Connect™ 35, Graco® SnugRide® SnugLock® 35, Chicco® Keyfit® 30, Chicco® Fit2® and Baby Trend® Secure Snap Gear® 35 infant car seats. Other car seats or carriers are not designed to fit this stroller frame and may result in serious injury or death. NEVER use them as they have not been safety tested.

1. Remove bumper bar

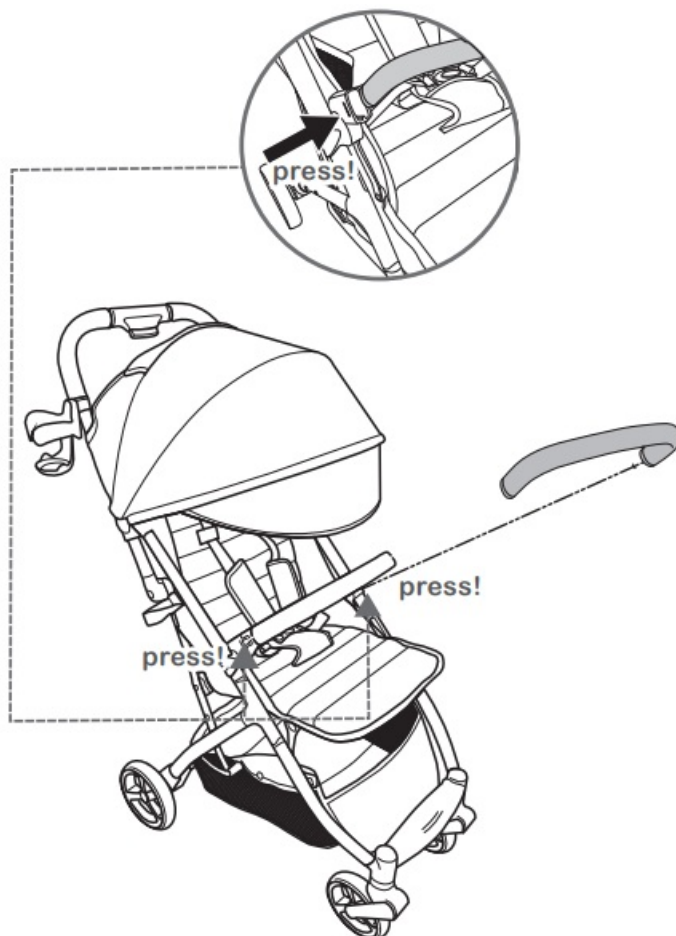

2. Fold canopy back.



3. Make sure seat is fully reclined.

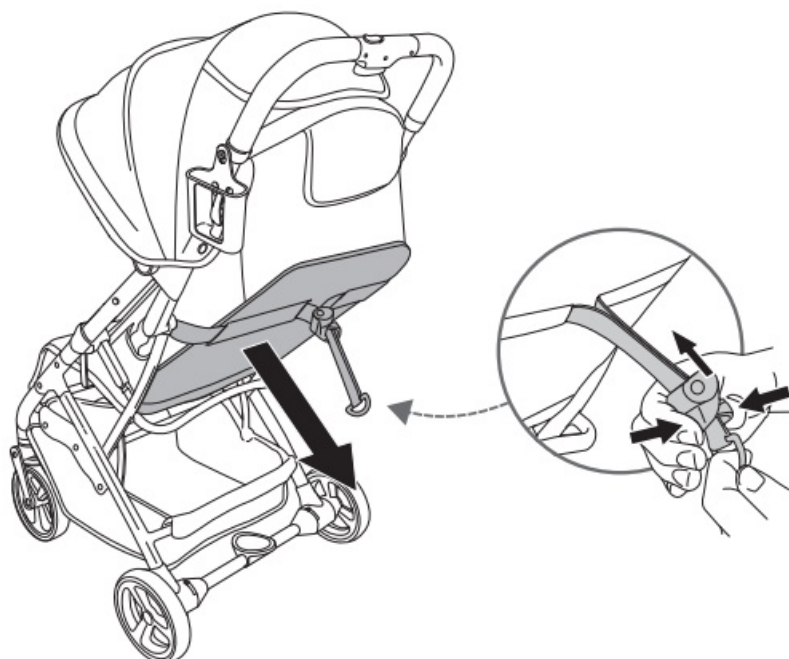

4. Place the car seat into stroller in the rear facing position so that it is in full contact with both the stroller seating surface and seat back. Rotate the leg rest up until it is in the horizontal position.

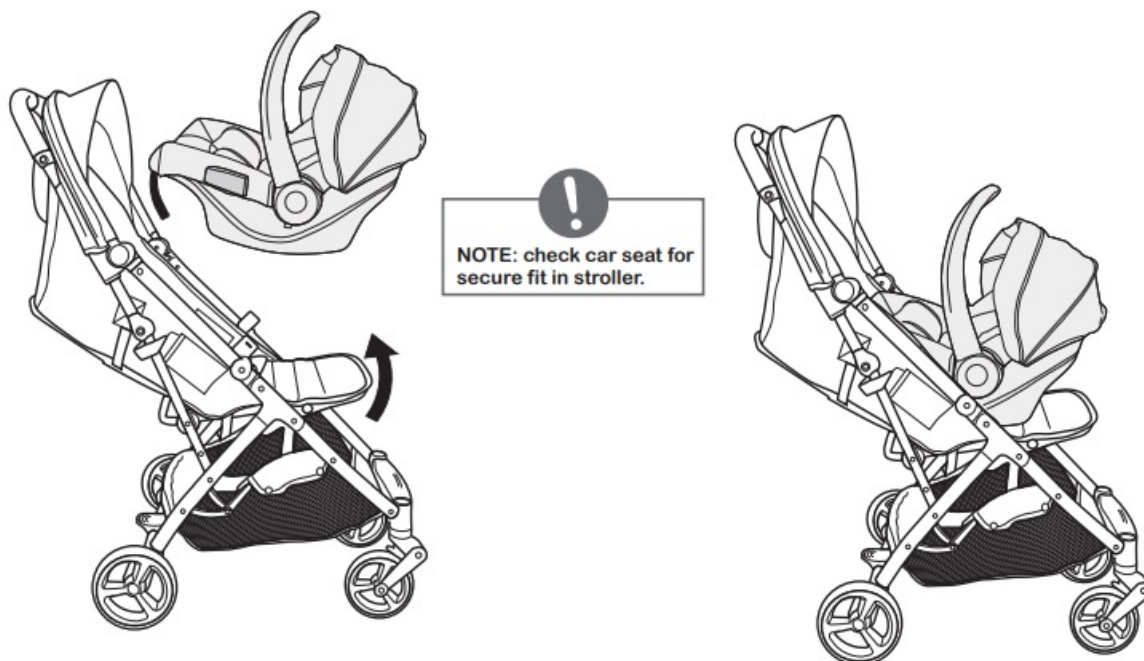

5. Place the two car seat straps, attached to the stroller rails, into the Vehicle Belt Hooks and across the car seat and lock the buckle. Slide the padded buckle guard over the buckle.

Place the two car seat straps, attached to the stroller rails, into the Vehicle Belt Hooks and across the car seat and lock the buckle. Slide the padded buckle guard over the buckle.

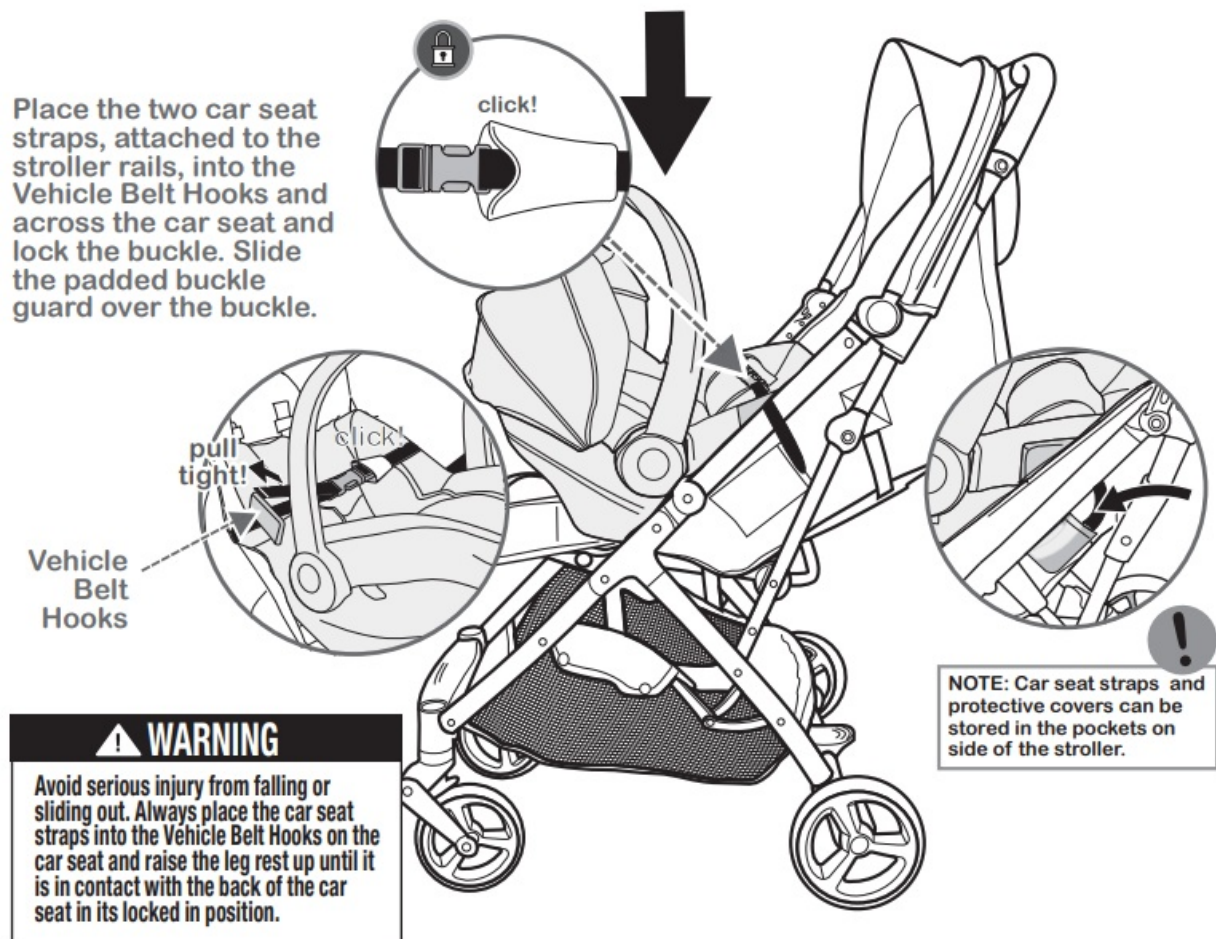

#### WARNING

Avoid serious injury from falling or sliding out. Always place the car seat straps into the Vehicle Belt Hooks on the car seat and raise the leg rest up until it is in contact with the back of the car seat in its locked in position.

**NOTE:** Car seat straps and protective covers can be stored in the pockets on side of the stroller.

#### Care and Maintenance

- Clean minor stains on fabric with cold water and mild soap.
- Clean plastic and metal surfaces with a soft damp cloth. Air dry. Do not use abrasive cleaners or solvents. Do not use bleach.
- Check seat pad harness and crotch straps weekly to ensure they are properly secured to frame.

MANUFACTURED FOR • ©2024 KIDS2, LLC [www.kids2.com/help](http://www.kids2.com/help)  
KIDS2, LLC ATLANTA, GA USA 30305 • 1-[800-230-8190](tel:800-230-8190)

#### IMPORTED BY

- KIDS2 CANADA CO. PO BOX 54059, RPA LAWRENCE PLAZA, TORONTO, ON. M6A 3B7
- KIDS2 AUSTRALIA PTY LIMITED CASTLE HILL, NSW AUSTRALIA 2154 • (02) 9894-1855
- KIDS2 JAPAN K.K. c/o ARK Outsourcing KK 4-3-5-704, Ebisu, Shibuya-ku, Tokyo, Japan 150-0013 • (03) 5322-6081
- KIDS2 UK LTD. GROUND FLOOR, SUITE A1A, BREAKSPEAR PARK, BREAKSPEAR WAY, HEMEL HEMPSTEAD, HP2 4TZ • +44 01582 816 080
- KIDS2 EUROPE BV 5 KEIZERS, KEIZERSGRACHT 287, 1016 ED AMSTERDAM, NETHERLANDS • +31 20

2410934

- KIDS2 US MÉXICO S.A. DE C.V. • (55) 5292-8488

MADE IN CHINA

Please retain information for future reference.

Colors and styles may vary.

MADE IN CHINA.

Please read the following instructions carefully.

Keep this instruction manual for future reference.

No tools required.

For technical support, contact us at 1-[401-671-6551](tel:401-671-6551) or [www.summerbyingenuity.com](http://www.summerbyingenuity.com)

Keep small parts away from children.

## Frequently Asked Questions

**Q: Can I interchange the cell phone holder and cup holder?**

**A:** Yes, the cell phone holder and cup holder are interchangeable to either side of the stroller.

**Q: How do I adjust the leg rest on the stroller?**

**A:** The leg rest is adjustable. Please refer to the product manual for specific instructions on adjusting the leg rest.

## Documents / Resources

	<p><a href="#">Summer 3Dquickclose CS Plus Compact Fold Stroller</a> [pdf] Instruction Manual 3Dquickclose CS Plus Compact Fold Stroller, 3Dquickclose, CS Plus Compact Fold Stroller, Compact Fold Stroller, Fold Stroller</p>
---	---

## References

- [Summer by Ingenuity – Kids2, LLC](#)
- [User Manual](#)

[Manuals+](#), [Privacy Policy](#)

This website is an independent publication and is neither affiliated with nor endorsed by any of the trademark owners. The "Bluetooth®" word mark and logos are registered trademarks owned by Bluetooth SIG, Inc. The "Wi-Fi®" word mark and logos are registered trademarks owned by the Wi-Fi Alliance. Any use of these marks on this website does not imply any affiliation with or endorsement.