



summer 3D Quickclose CS+ Compact Fold Stroller Instruction Manual

[Home](#) » [Summer](#) » summer 3D Quickclose CS+ Compact Fold Stroller Instruction Manual 





3D quickcloseTM CS⁺

compact fold stroller

INSTRUCTION MANUAL

Please read the following instructions carefully.
Keep this instruction manual for future reference.

No tools are required.

For technical support, contact us at 1-401-671-6551
or www.summerinfant.com/contact

Keep small parts away from children.



WARNING Adult assembly required. Exercise care when unpacking and assembling products.



WARNING

Read and follow all warnings and instructions. Failure to do so could result in serious injury or death.

- Maximum weight and height of child: 50 lbs. (22.7 kg), 43 in. (109cm)
- NEVER leave the child unattended.
- Avoid serious injury from falling or sliding out. ALWAYS use a safety harness.
- When making adjustments to the product ALWAYS ENSURE that all parts of a child's body are clear of any moving parts of the product.
- Care must be taken when folding and unfolding the product to prevent finger entrapment.
- DO NOT carry additional children, goods, or accessories in or on this product except as recommended in the manufacturer's instructions.
- TO AVOID INJURY TO YOUR CHILD, DO NOT USE A STORAGE BASKET AS A CHILD CARRIER.
- DO NOT hang items on the handlebar or place them on the canopy, as they can tip the stroller over and injure a child.
- DO NOT OVERLOAD THE STORAGE BASKET. MAXIMUM 25 lbs. (11.3 kg).
- This product may become unstable if a parcel bag, other than the one recommended is used.
- DO NOT overload the storage pocket, cell phone holder, or cup holder. MAXIMUM weight for the cell phone and cup holder is 1lb. (0.45 kg). MAXIMUM weight of storage pocket and child cup holder is 1/2 lb. (0.23 kg). Excessive weight may cause the stroller to become unstable or tip over.
- DO NOT place hot liquids in the cupholder. Spills can burn your child.
- Do not carry or roll a stroller on stairs or escalators with a child in it.
- Do not use the stroller if any part is lost or damaged.
- NEVER install Infant Car Seat without fastening it securely to the stroller with provided car seat straps.
- NEVER lift the stroller by infant carrier handle.
- USE ONLY WITH Summer™ Affirm™ 335, Graco® SnugRide® Click Connect™ 35, Graco® SnugRide® SnugLock® 35, Chicco® Keyfit® 30, Chicco® Fit2® and Baby Trend® Secure Snap Gear® 35 Infant Car Seats. Other car seats or carriers are not designed to fit this stroller frame and may result in serious injury or death. NEVER use them as they have not been safety tested.
- The car seat must be in a rear-facing position only.

components:

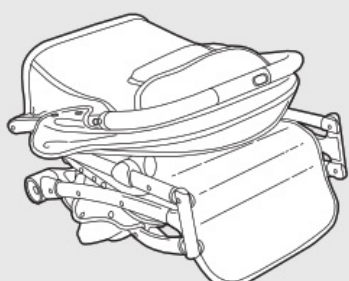

A



B

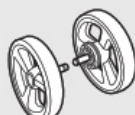

C



D



E



F



IMPORTANT! Before assembly, inspect this product for damaged hardware, loose joints or missing parts. Never use if any parts are missing or broken.

A Stroller Frame with Seat

D Bumper Bar

B Front Wheels (2)

E Cup Holder

C Rear Wheels (2)

F Cell Phone Holder

3D-pac CS+ stroller replacement parts:

front wheels	32723-24	cell phone holder	32453-03
rear wheels	32723-22	bumper bar	31900-05
cup holder	21790-25	car seat strap set	32453-04

features:

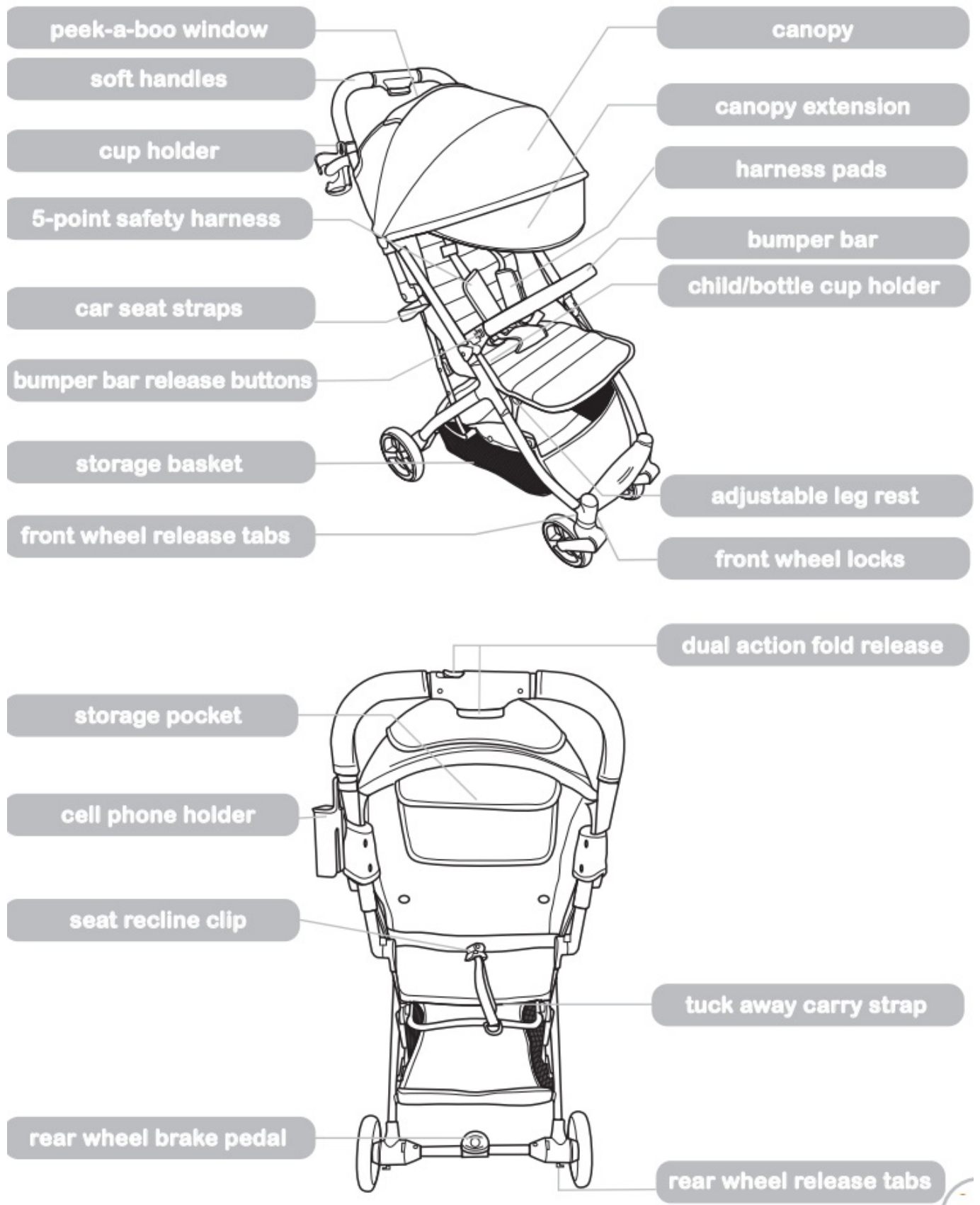

Contents

[1 assembly instructions:](#)

[2 Documents /
Resources](#)

[2.1 References](#)

[3 Related Posts](#)

assembly instructions:

1. First, slide the upper handle button then squeeze the lower handle release button.
2. Quickly pull up the stroller by the handlebars until it clicks into the fully open position. The stroller will lock into the open position.



NOTE: When opening the stroller, ensure that your child, or other children, are at a safe distance.

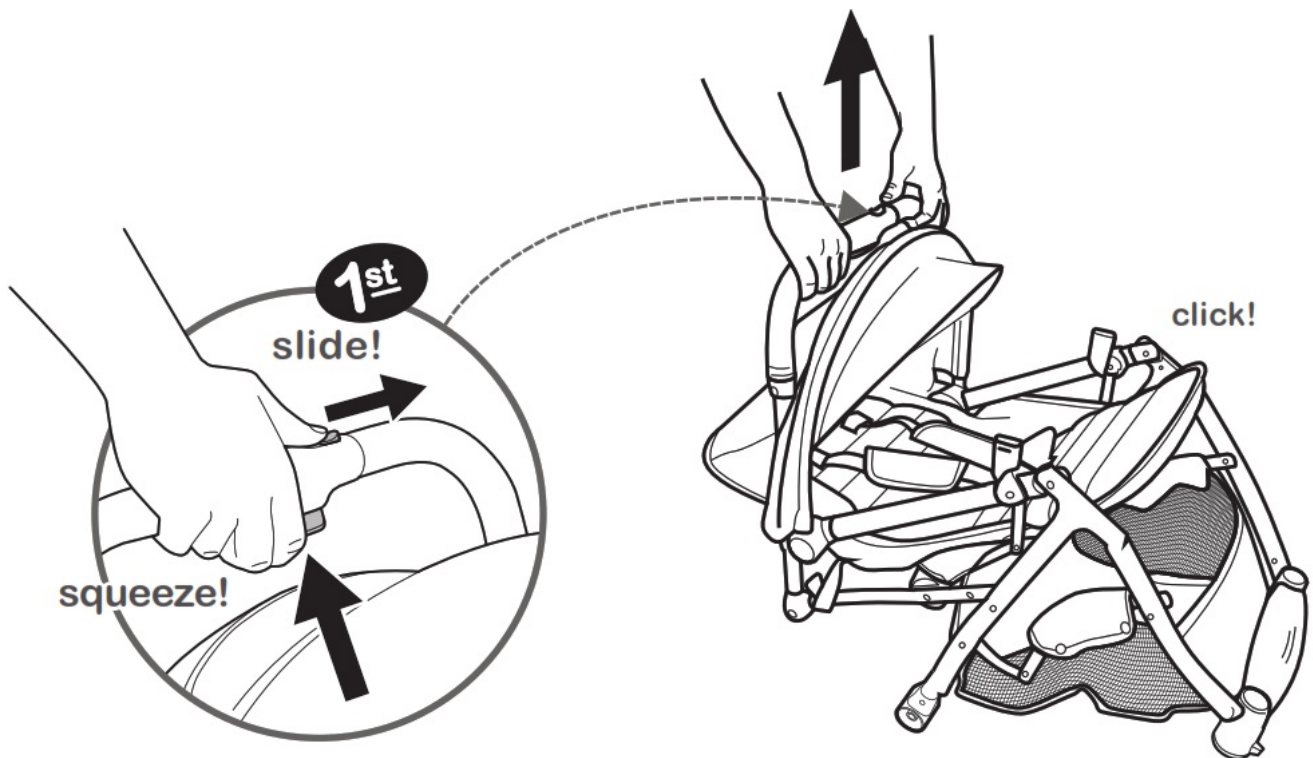

3. Align front wheels and rear wheels and push them into the frame.

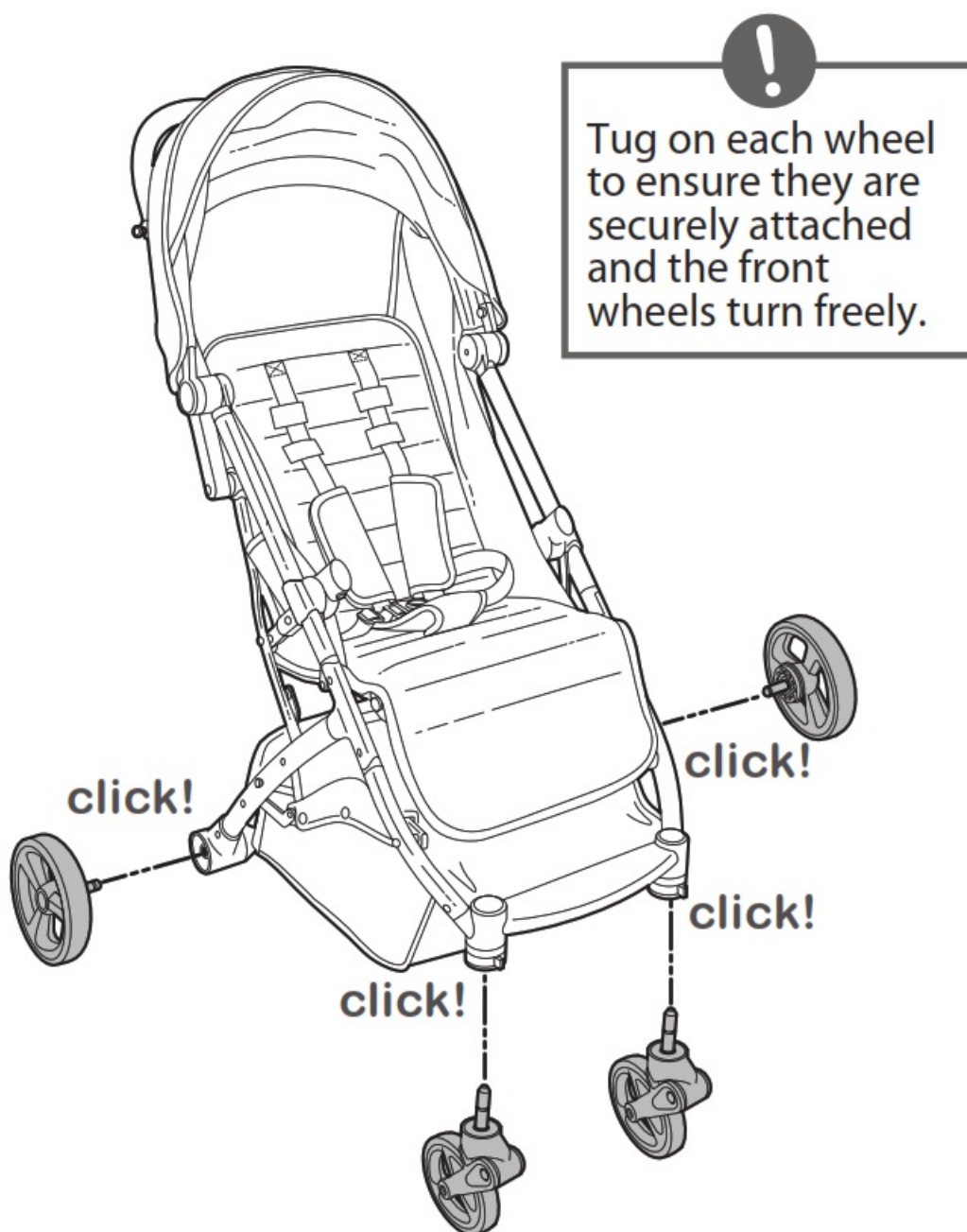

4. Snap bumper bar into position.

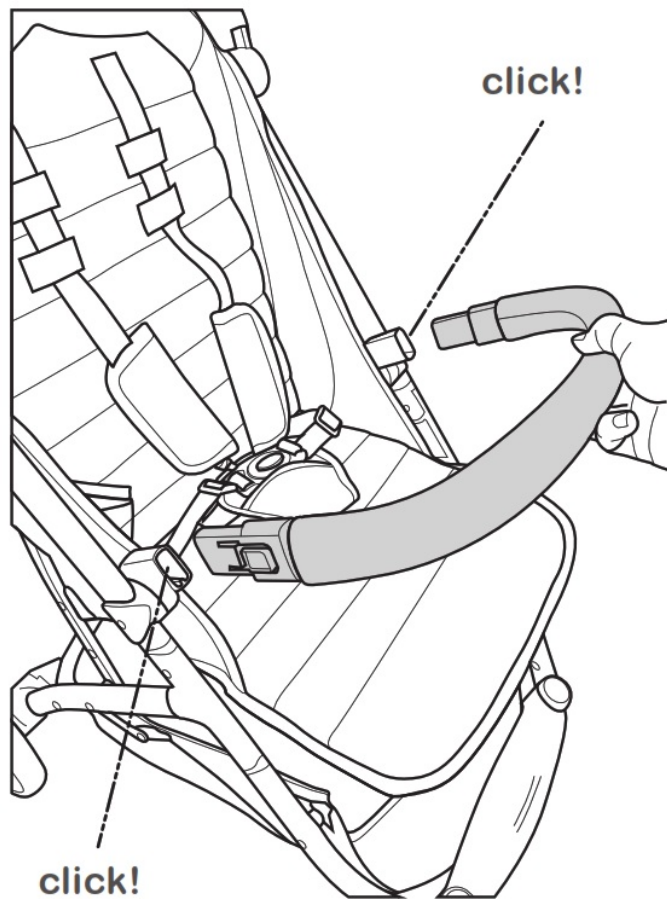

5. Line up a slot on the back of the cup holder with a mounting post and push down. Line up a slot on the cell phone holder with a mounting post and push down.

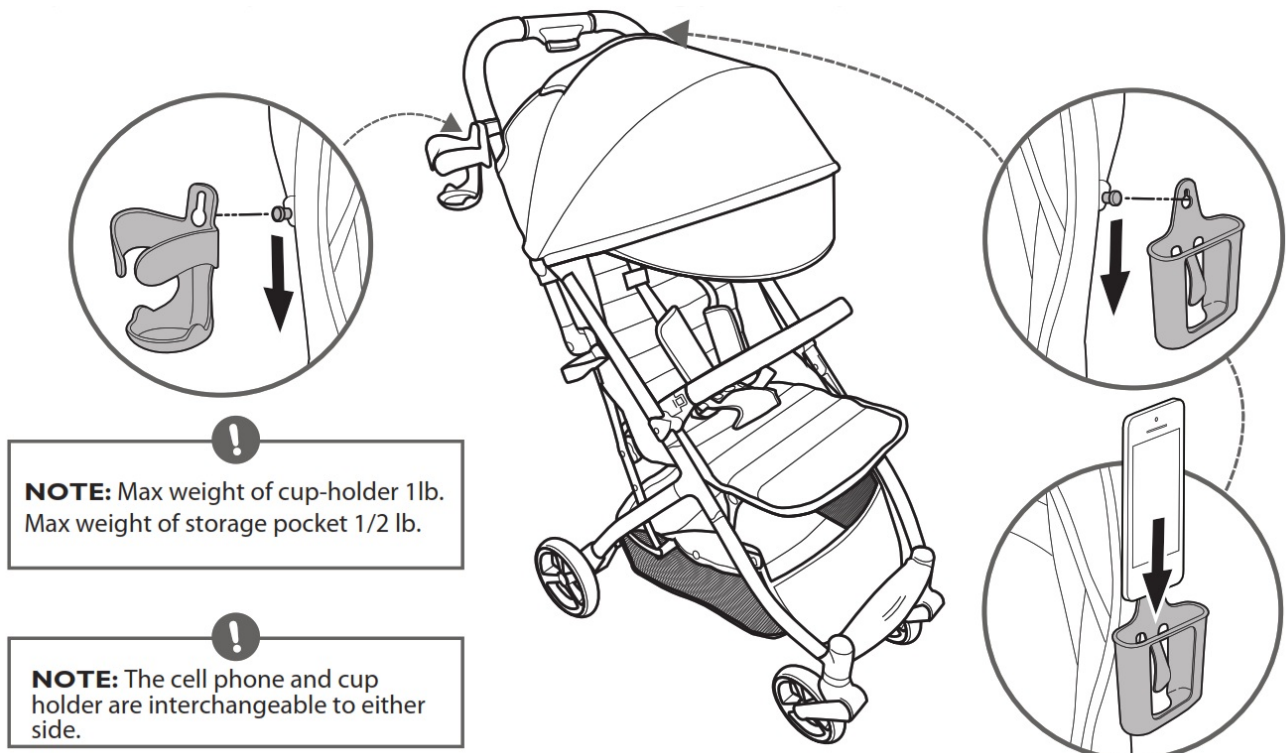

6. Extend canopy forward. Optional: Canopy visor is tucked beneath the canopy. Pull it down to extend the canopy.



FINISHED!

locking/unlocking 5 point safety harness:

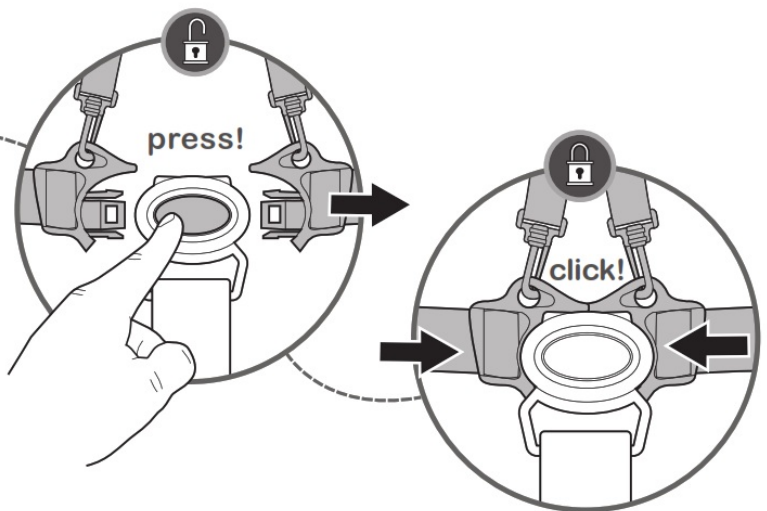

tightening and loosening the 5-point safety harness:

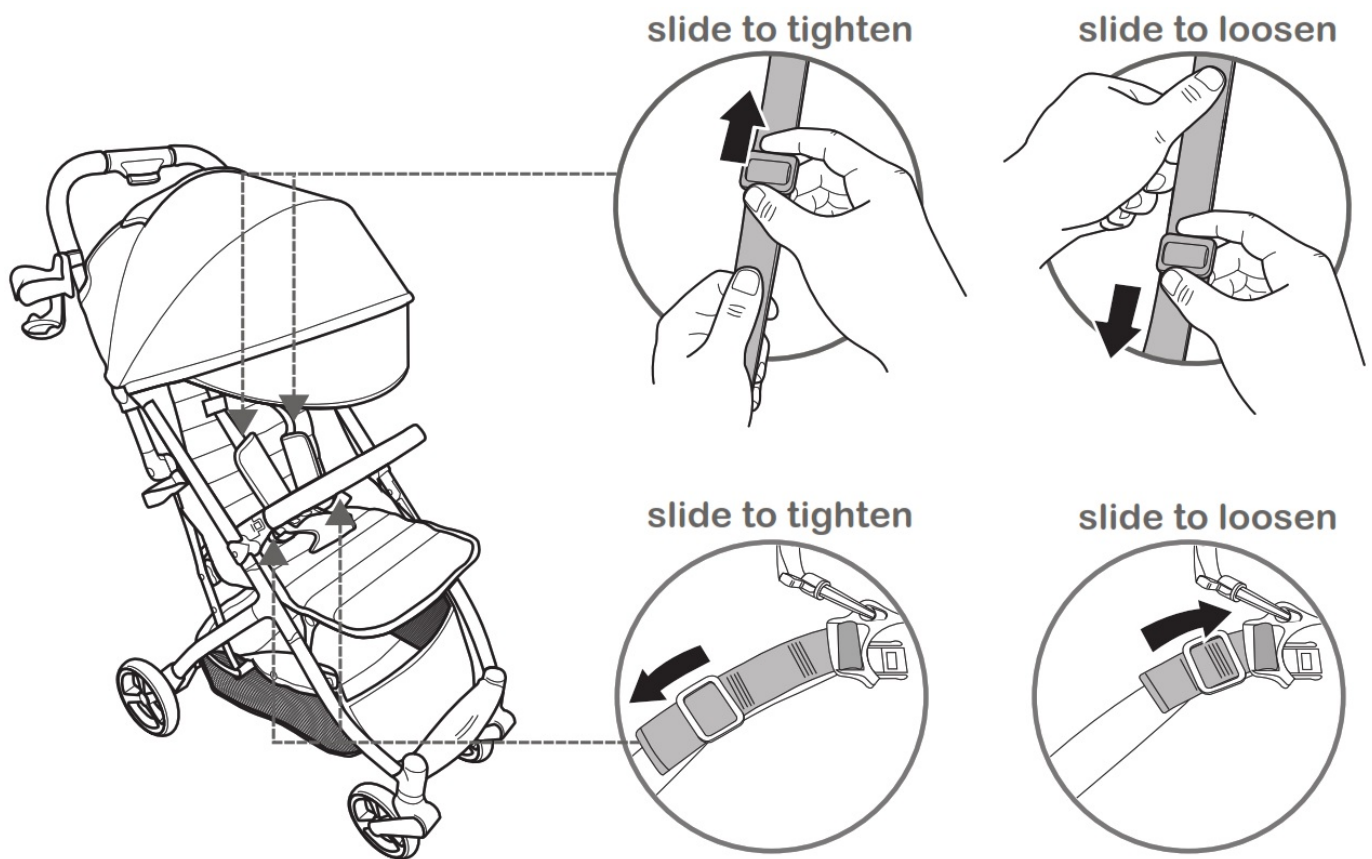

adjusting shoulder harness position:

1st, unclip harness clips. 2nd, remove harness pads. 3rd, slide shoulder harness out of the slot. Adjust harness position as shown below and reinstall harness pads.

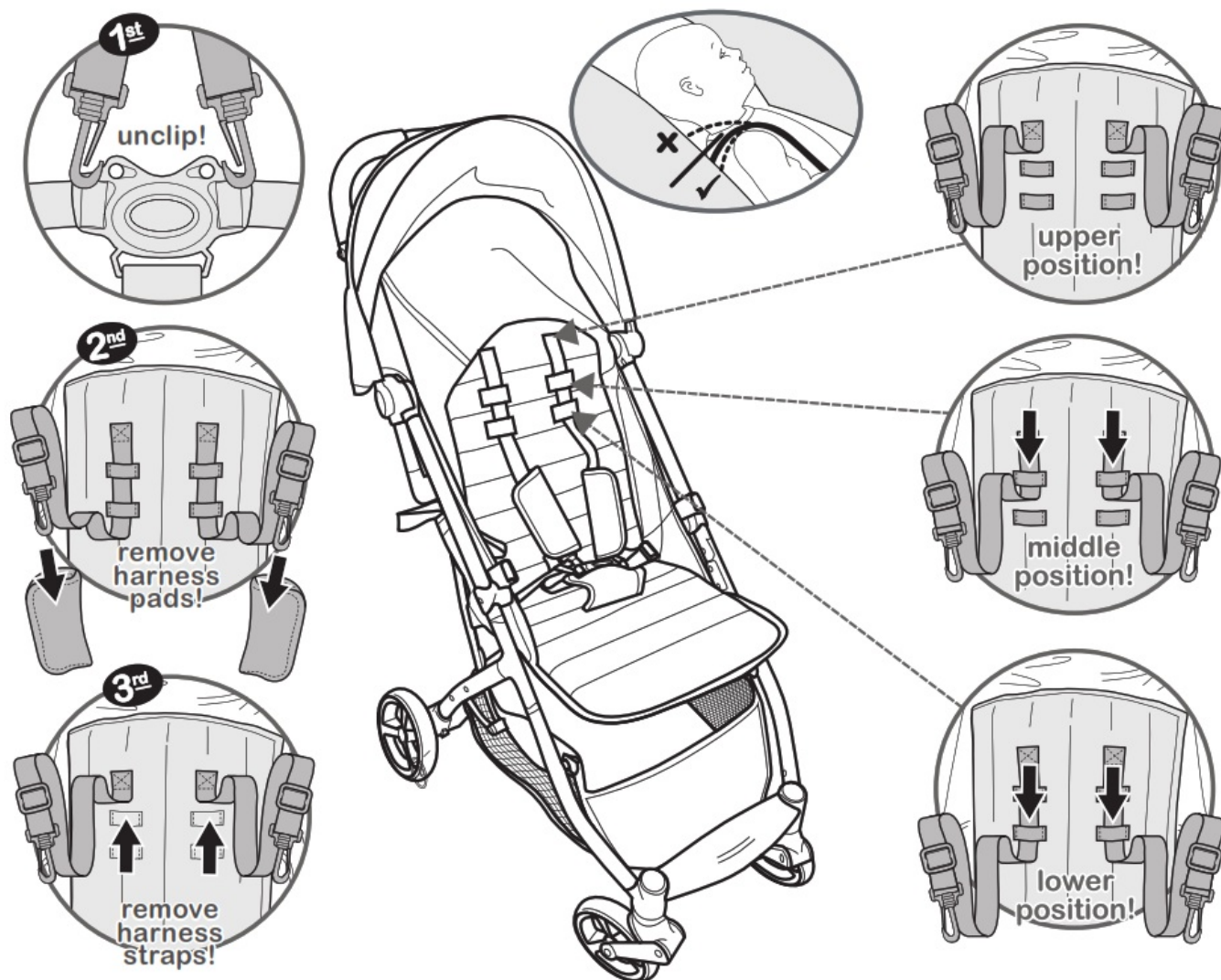

locking & unlocking the front wheels:

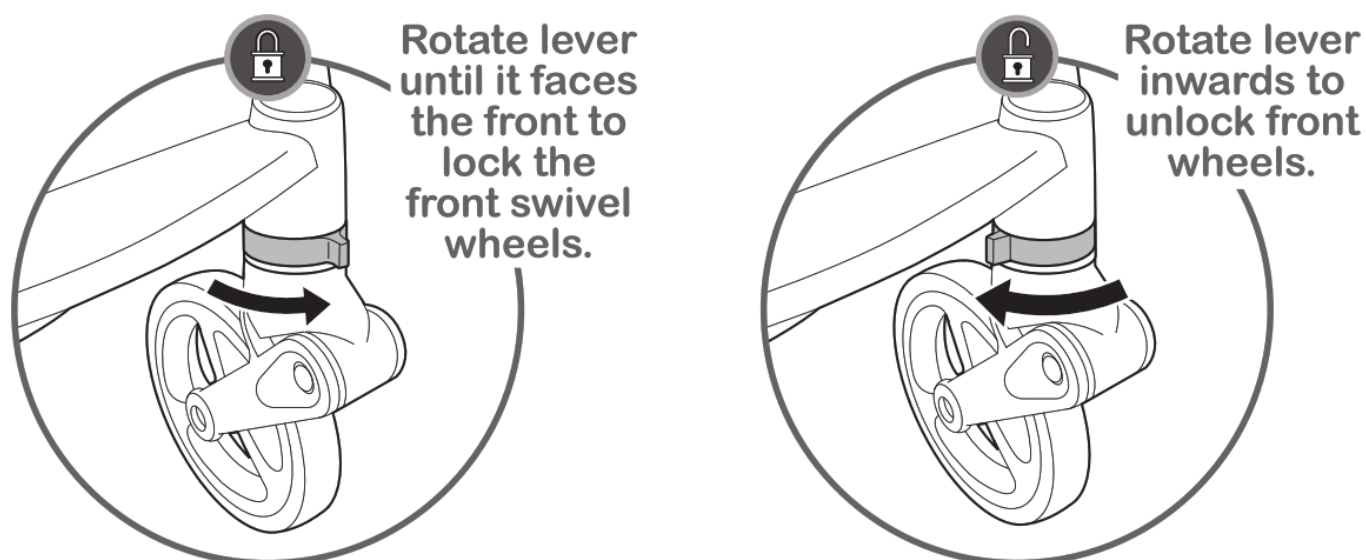

rear brake:

Press the foot pedal down to lock both rear wheels. Press the foot pedal forward to unlock the rear wheels.

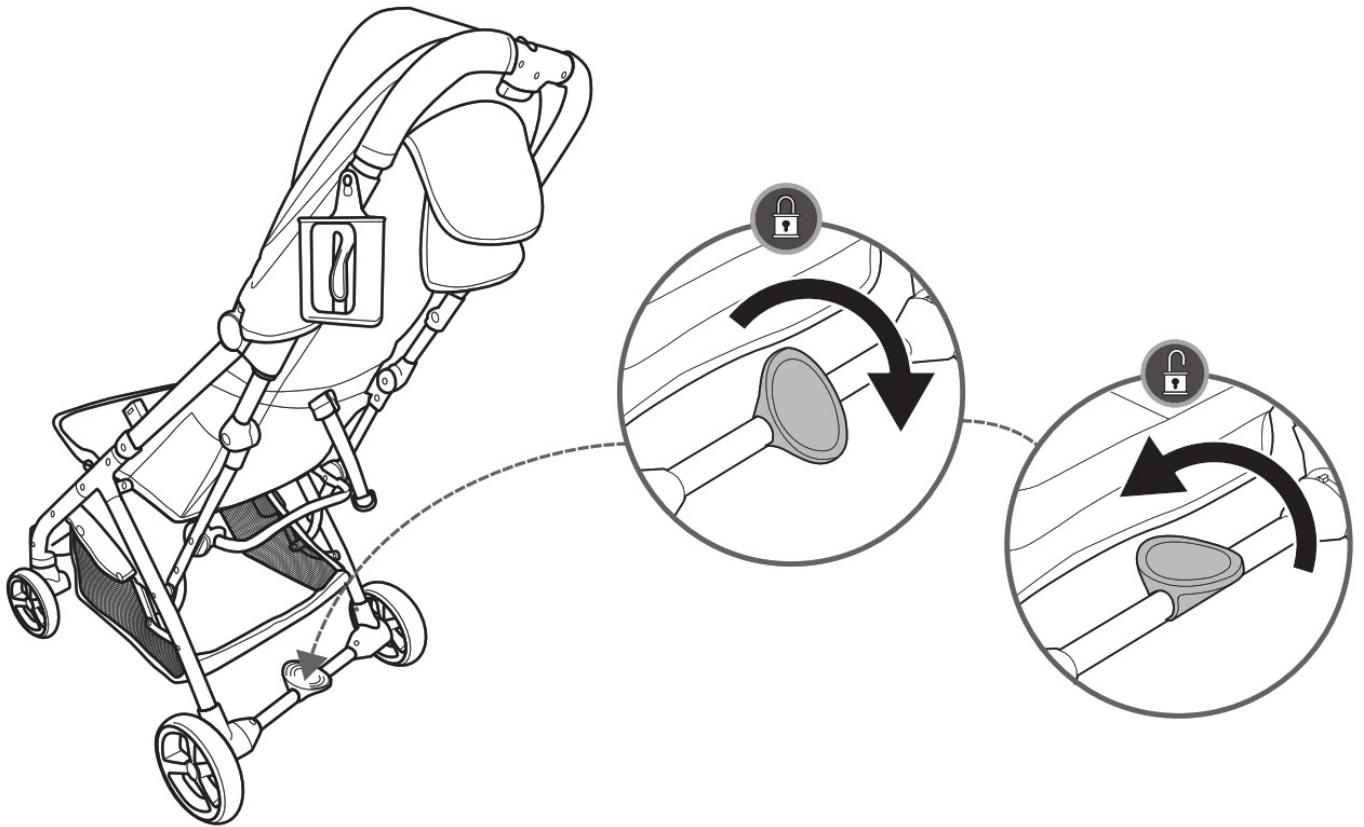

adjusting the seat recline:

Pinch seat recline clip on the back of stroller and slide recline clip along webbing to adjust the seat recline.

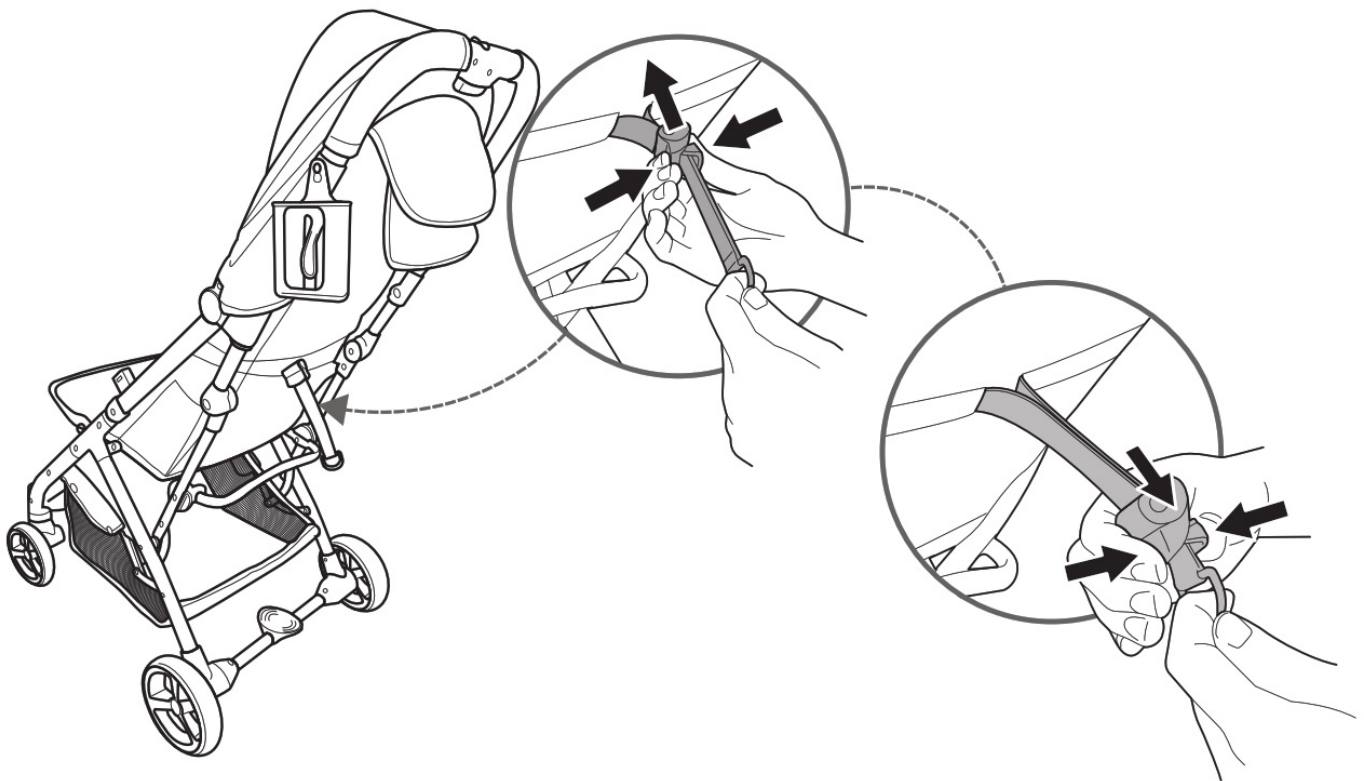

adjusting the leg rest:

Raise leg rest up until it locks into the desired position. Press the buttons on the side of the leg rest and rotate the leg rest down to lower positions.

raise leg rest up!

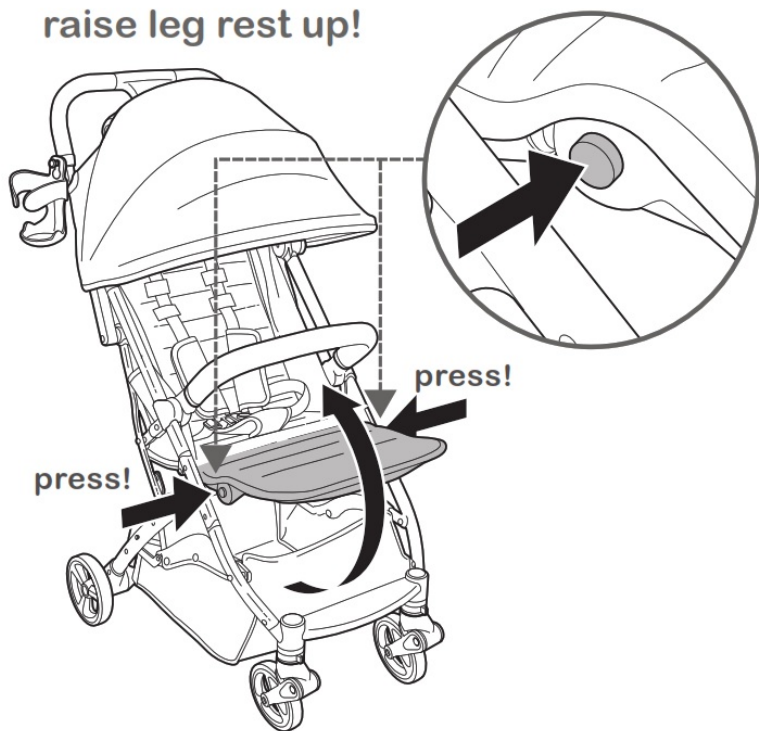

fold leg rest down!

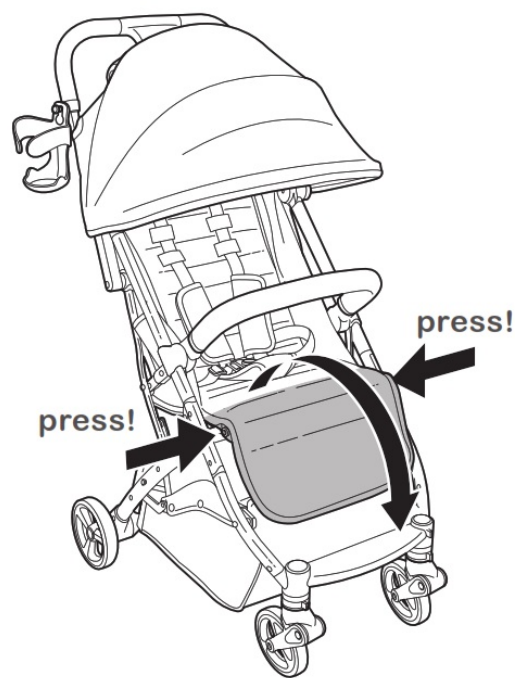

child bottle/cup holder:
Slide baby bottle or sippy cup into side holder.

peek-a-b
Flip-up p

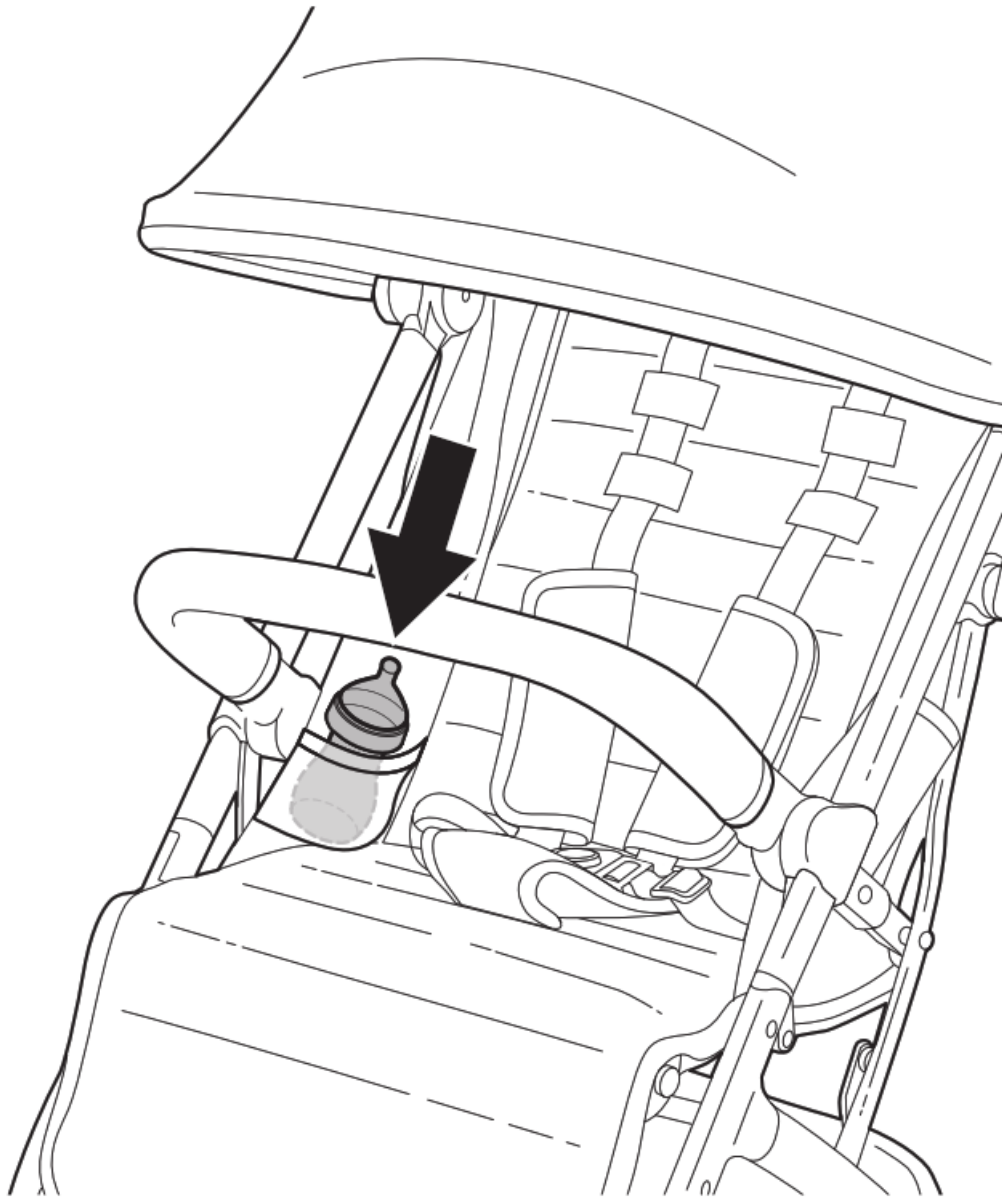

folding the stroller:

1. Flip canopy extension in storage position prior to folding the canopy.



2. First, slide the upper handle button then squeeze the lower handle release button, stroller will quickly close as shown.

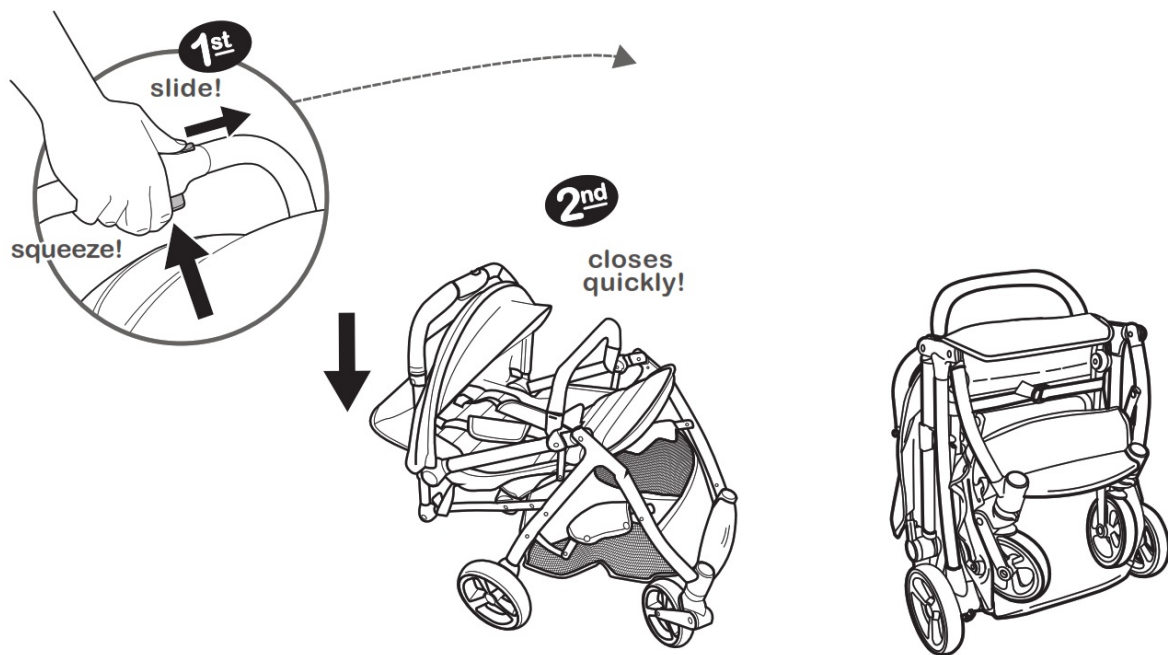

folding the stroller (continued):

3. The carry strap is stored in the pocket underneath the leg rest.



removing the bumper bar:

Press the buttons beneath the bumper bar knuckles to remove.

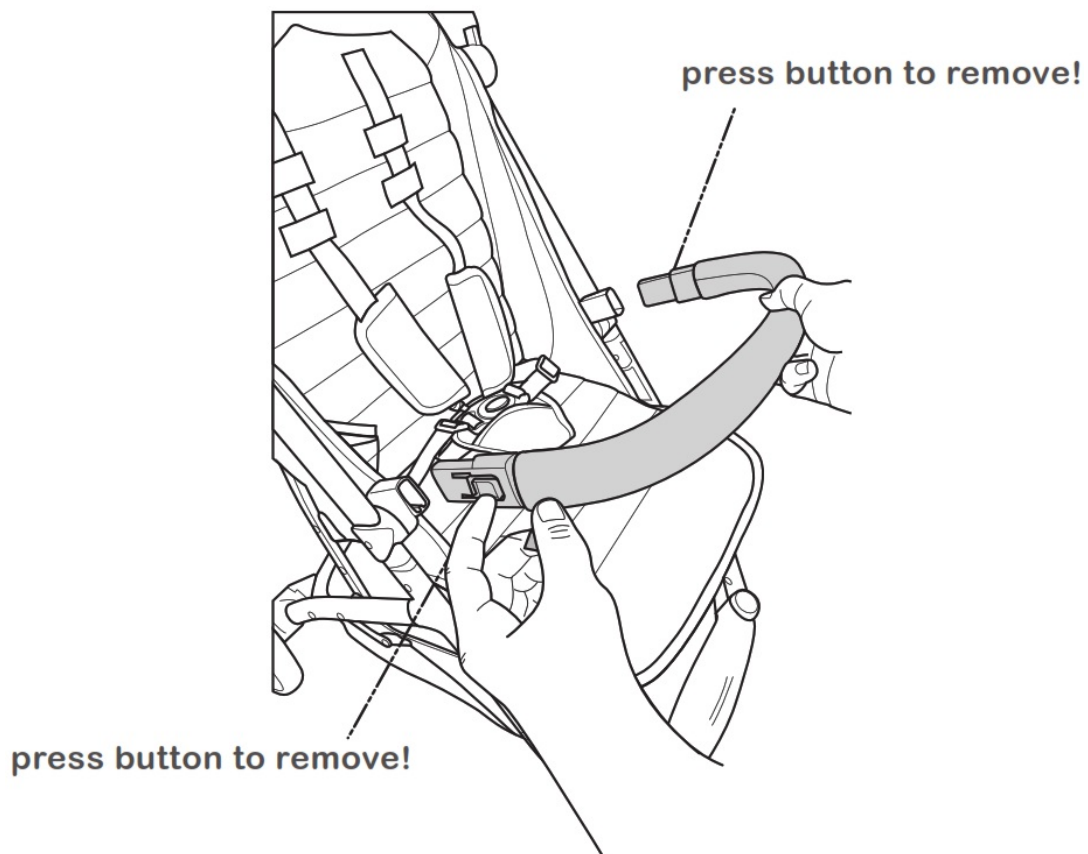

removing the wheels:

Each wheel has a release tab. Pull the release tabs out to remove wheels from the frame.

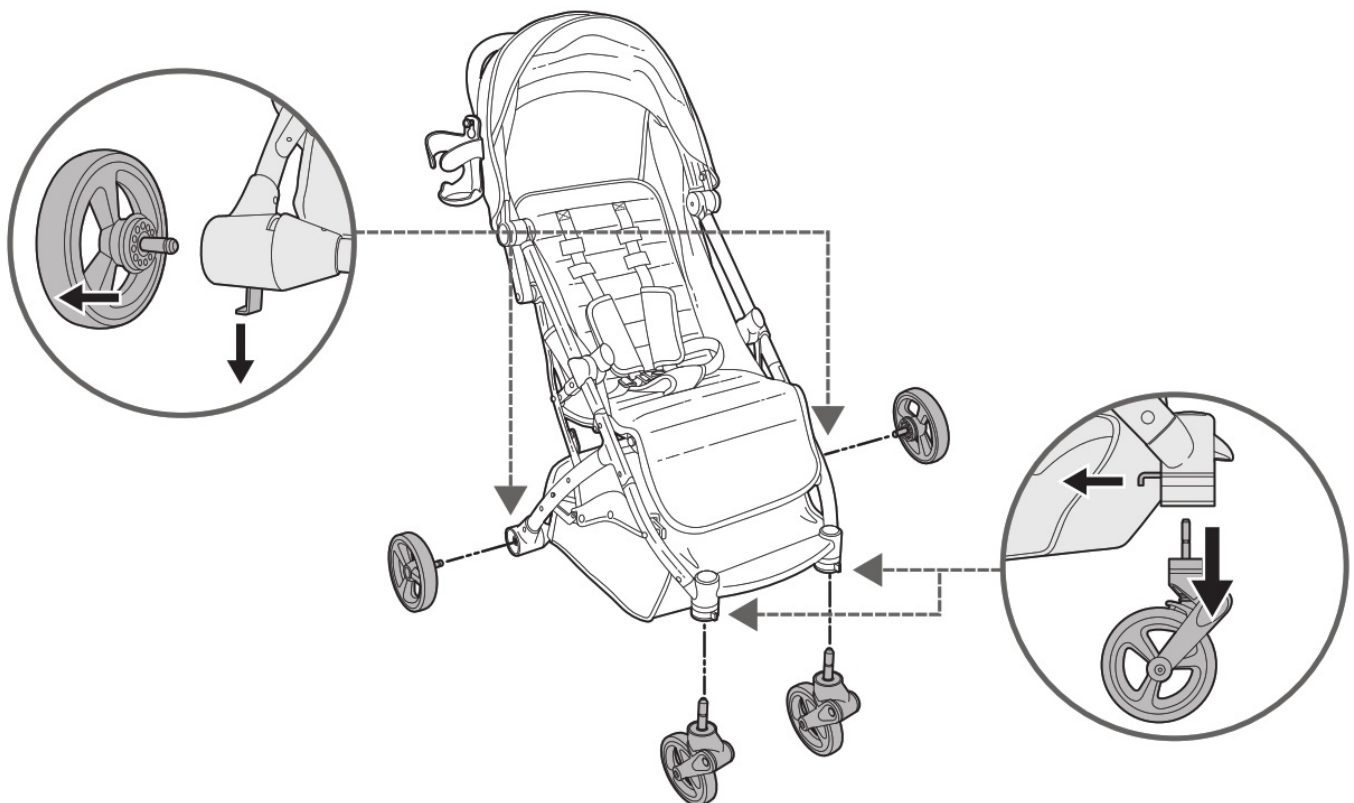

attaching a car seat:

Use this section to attach car seat models:

Summer™ Affirm™ 335, Graco® SnugRide® Click Connect™ 35, Graco® SnugRide® SnugLock® 35, Chicco® Keyfit® 30, Chicco® Fit2® and Baby Trend® Secure Snap Gear® 35



WARNING: IMPORTANT! KEEP FOR FUTURE REFERENCE!

- NEVER install Infant Car Seat without fastening it securely to the stroller with the provided car seat straps. The car seat must be in a rear-facing position only.
- NEVER lift the stroller by infant carrier handle.
- Use only with Summer™ Affirm™ 335, Graco ® SnugRide ® Click Connect ™ 35, Graco ® SnugRide ® SnugLock ® 35, Chicco ® Keyfit ® 30, Chicco ® Fit2 ®, and Baby Trend ® Secure Snap Gear ® 35 infant car seats. Other car seats or carriers are not designed to fit this stroller frame and may result in serious injury or death. NEVER use them as they have not been safety tested.

1. Remove bumper bar

2. Fold canopy back.

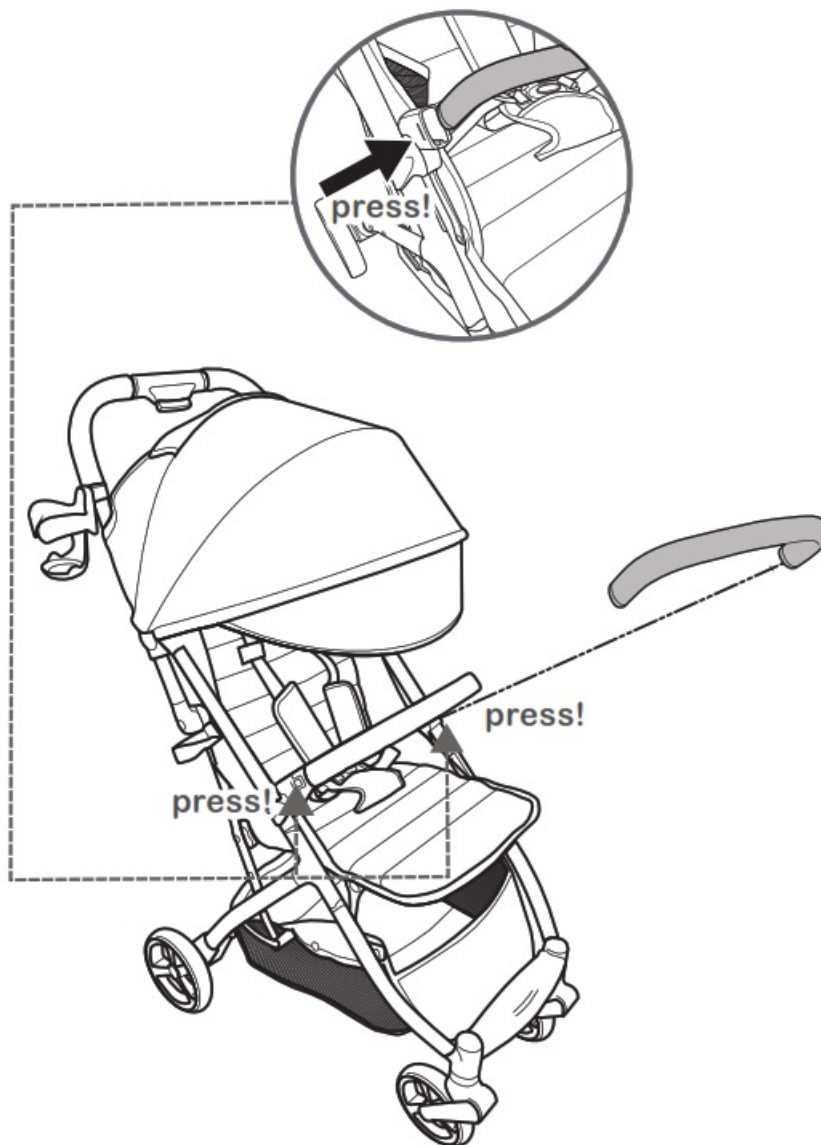

attaching a car seat:

3. Make sure the seat is fully reclined.

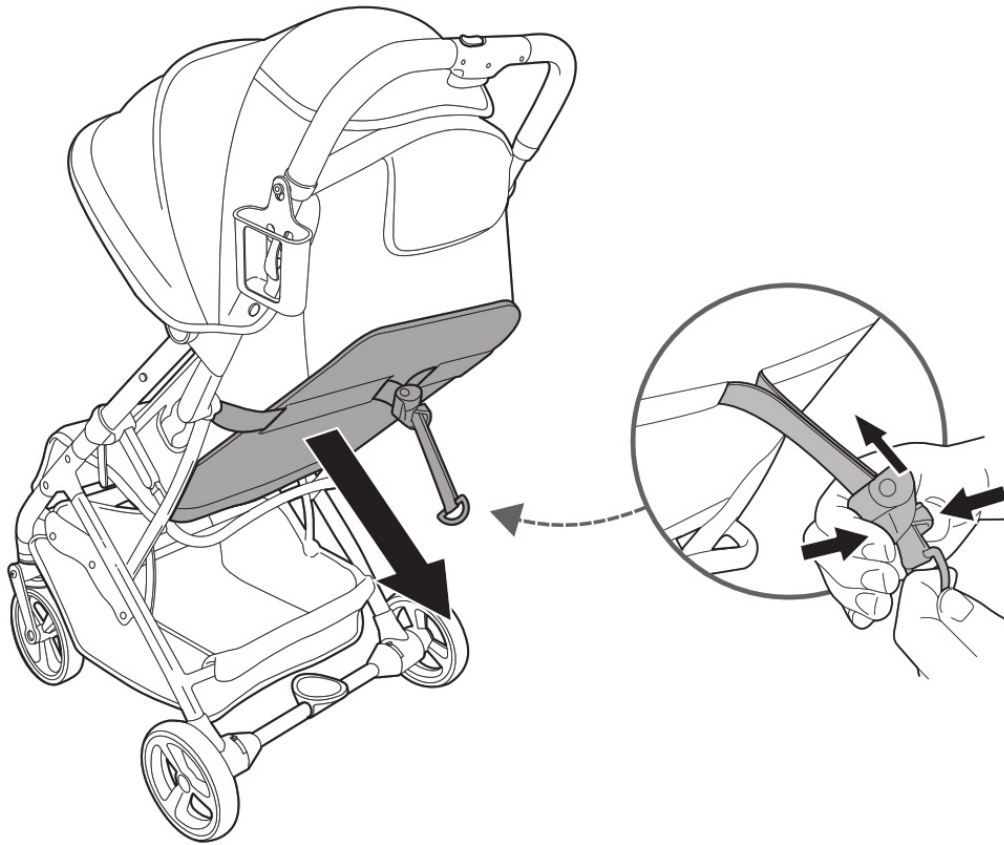

4. Place the car seat into the stroller in the rear-facing position so that it is in full contact with both the stroller seating surface and seatback. Rotate the leg rest up until it is in the horizontal position.

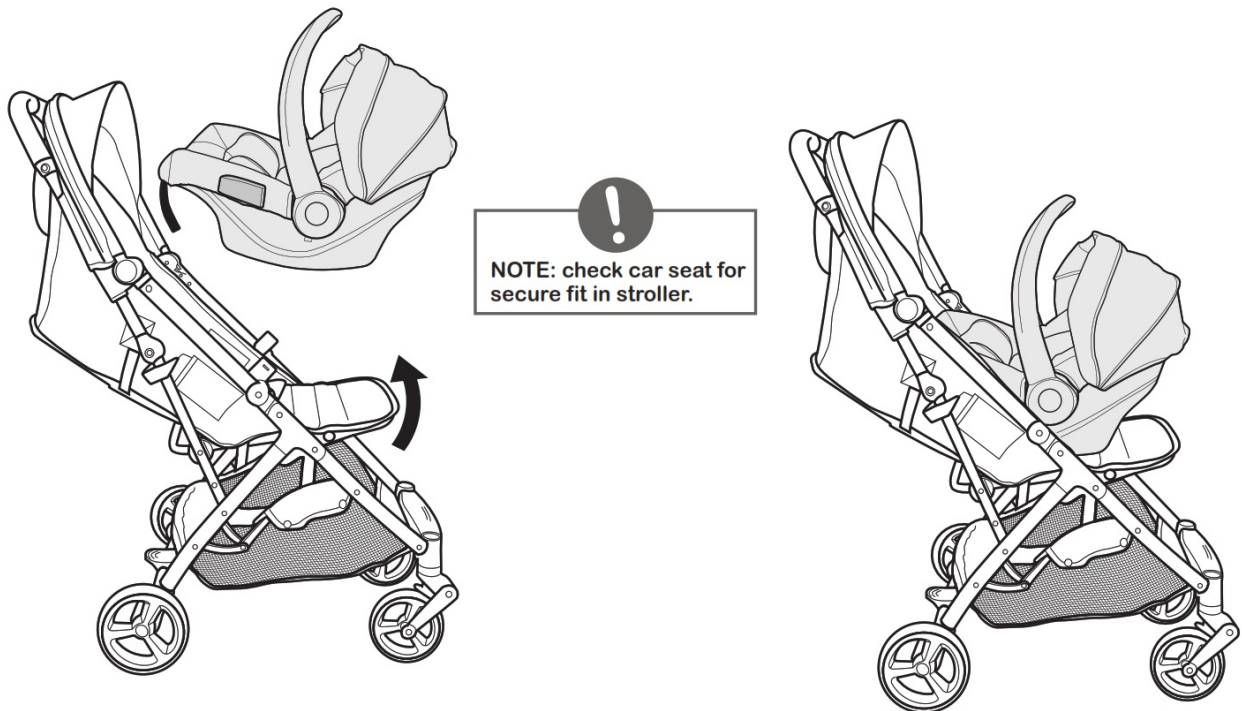

attaching a car seat:

5. Place the two-car seat straps, attached to the stroller rails, into the Vehicle Belt Hooks across the car seat and lock the buckle. Slide the padded buckle guard over the buckle.

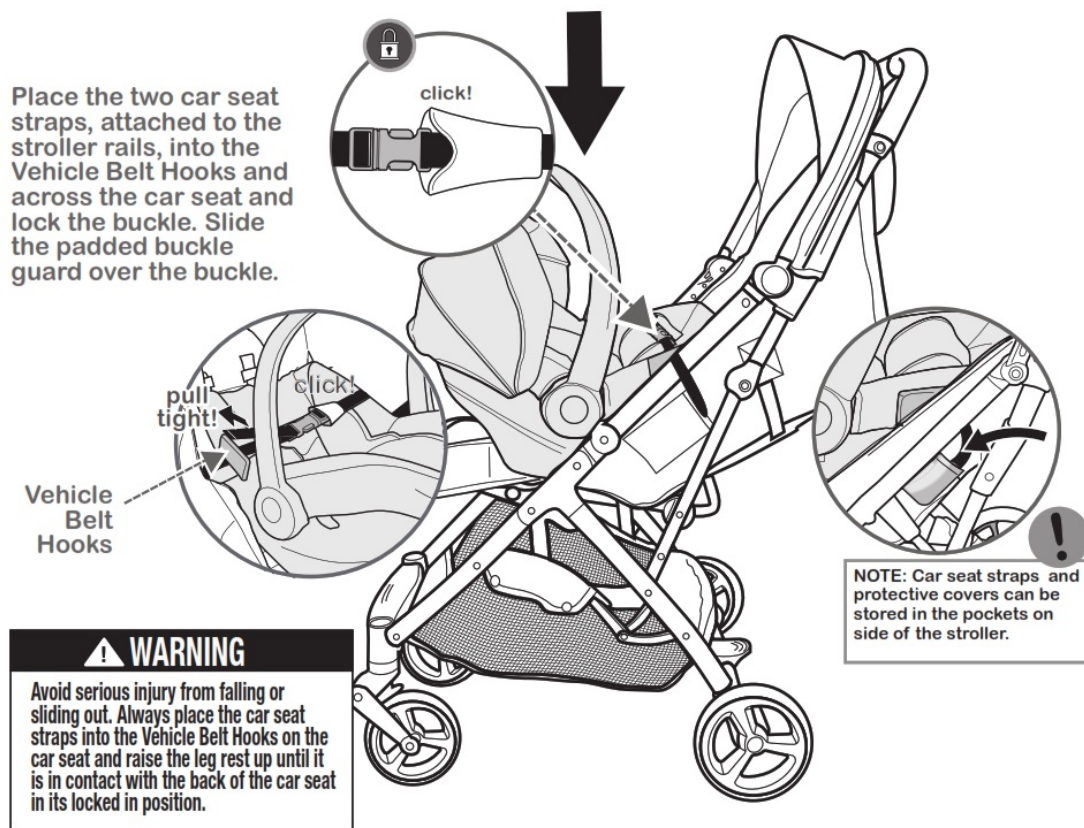

care and maintenance

- Clean minor stains on fabric with cold water and mild soap.
- Clean plastic and metal surfaces with a soft damp cloth. Air dry. Do not use abrasive cleaners or solvents. Do not use bleach.
- Check seat pad harness and crotch straps weekly to ensure they are properly secured to frame.

Summer Infant stands behind all of its products. If you are not completely satisfied or have any questions, please contact our Consumer Relations Team at

1-401-671-6551 or www.summerinfant.com/contact

Summer Infant (USA), Inc.
1275 Park East Drive
Woonsocket, RI 02895 USA
1-401-671-6551
© 2021 Summer Infant (USA), Inc.
Colors and styles may vary.
MADE IN CHINA.
D00000000911 8/21

Documents / Resources

 <p>summer</p> <p>3D Quickclose CS+ INSTRUCTION MANUAL</p>	<p>summer 3D Quickclose CS+ Compact Fold Stroller [pdf] Instruction Manual 3D Quickclose CS Compact Fold Stroller</p>
---	---

References

- [Summer Infant - Baby Products](#)