



SUBSONIC SA5655 Controller Charging Station Instruction Manual

[Home](#) » [SUBSONIC](#) » SUBSONIC SA5655 Controller Charging Station Instruction Manual 

Contents

- [1 SUBSONIC SA5655 Controller Charging Station](#)
- [2 CONTENT](#)
- [3 DESCRIPTION](#)
- [4 ASSEMBLY](#)
- [5 INTRODUCTION](#)
- [6 FEATURES](#)
- [7 INSTALLATION](#)
- [8 OPERATING MODE](#)
- [9 TECHNICAL PARAMETERS](#)
- [10 SAFETY INSTRUCTIONS](#)
- [11 CONTACT AND SUPPORT](#)
- [12 ENVIRONNEMENTAL SAFETY](#)
- [13 CHARGER & STAND](#)
- [14 Documents / Resources](#)
 - [14.1 References](#)
- [15 Related Posts](#)



SUBSONIC SA5655 Controller Charging Station



CONTENT

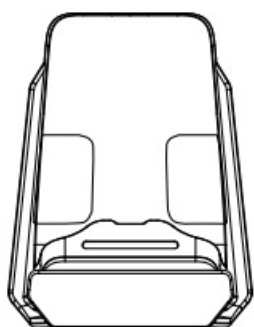

Charger



PS5 hanger

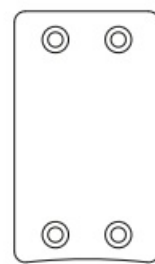

Wall-mount plate



Screws X4



Wall plug X4

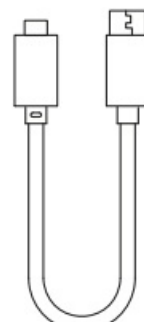

USB Cable

DESCRIPTION

1. Charging port
2. Charging LED indicator
3. Power input
4. Retractable headset stand

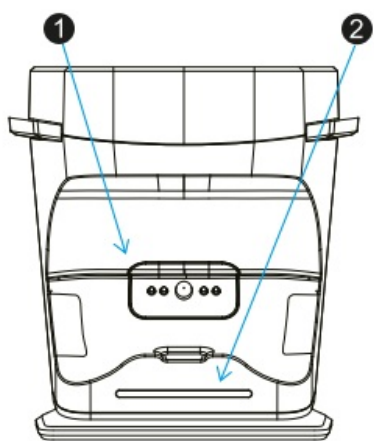

Top

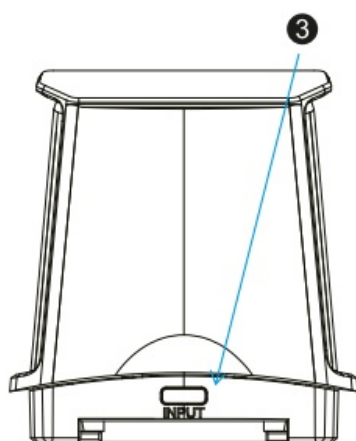

Bottom

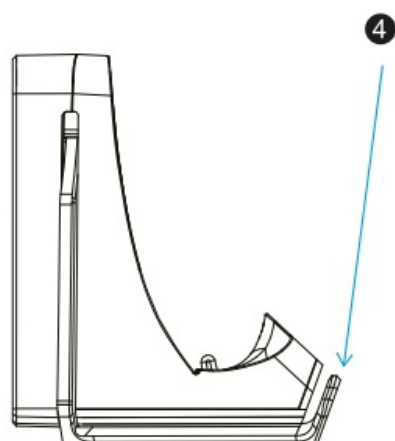

Side

ASSEMBLY

TO PSS

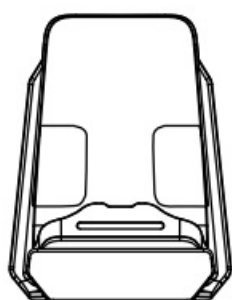

1

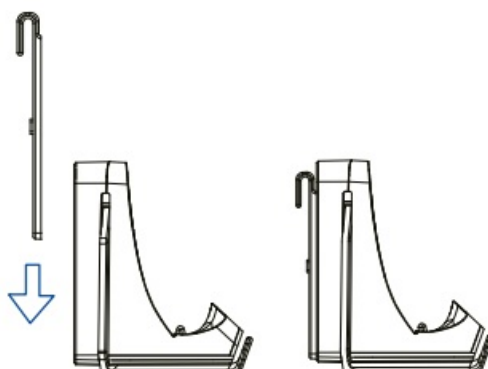
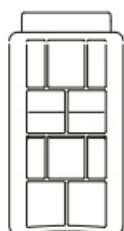

2

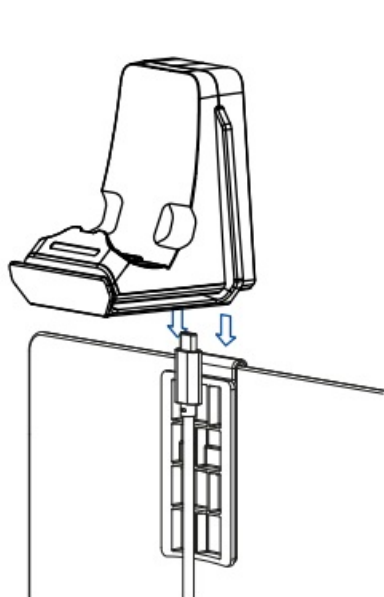

3

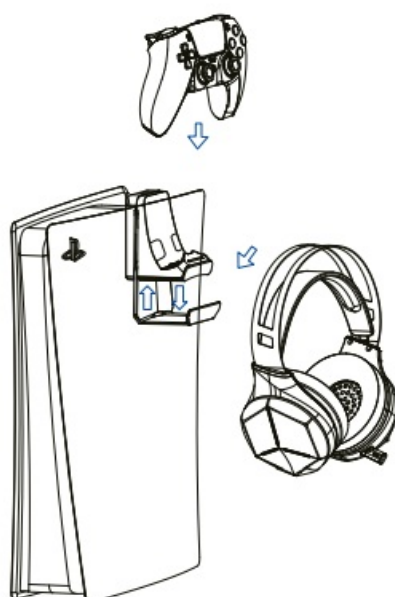

4

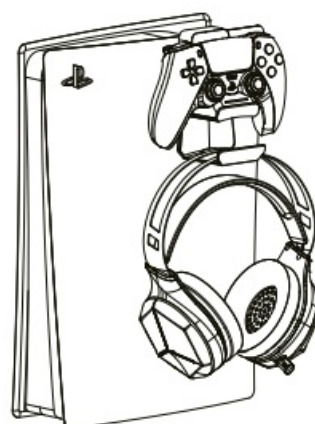

5

TO THE WALL

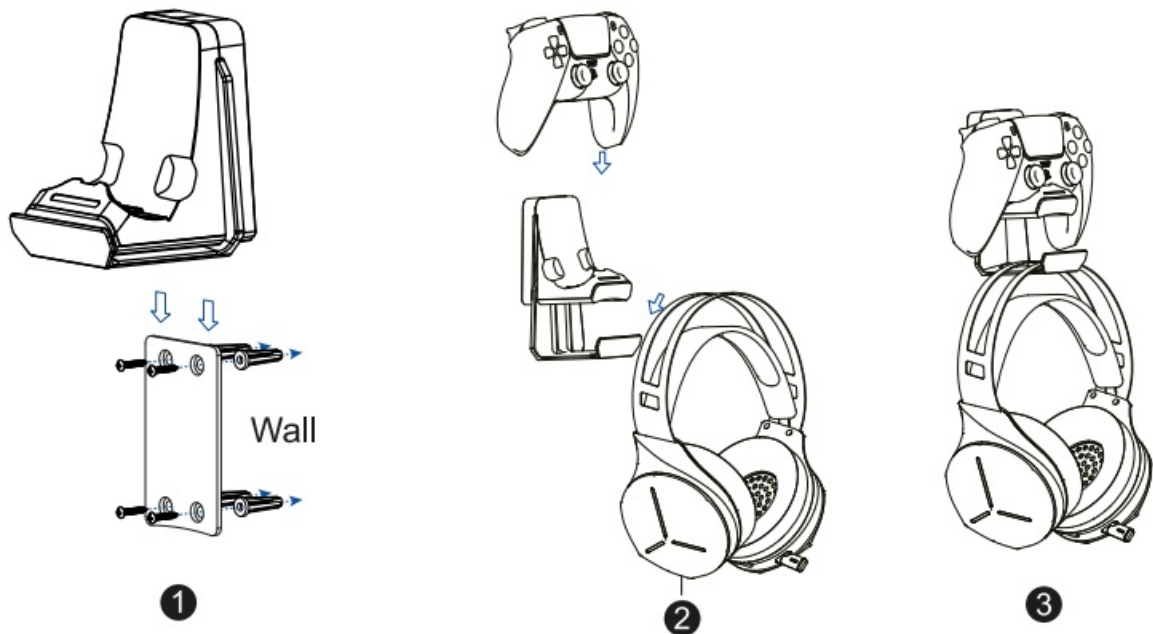

INTRODUCTION

Thank you for purchasing the CHARGER & STAND.

Please read this document carefully before using this product. Please keep this document for future reference.

FEATURES

- PSS controller charger, compatible with DualSense and DualSense Edge
- Retractable gaming headset holder
- 2 mounting systems: on the PSS or PSS Slim console or on the wall, mounting kit included
- LED charging indicator
- Charging cable included

INSTALLATION

See diagrams.

On PSS: use the hook to attach the charger to the edge of the PSS or PSS Slim. On the wall: use the wall plugs and screws supplied to fix the charger to the wall.

OPERATING MODE

- Connect the charger to one of the console's USB ports or to an external SV, minimum 1A mains charger.
- Place your controller on the charger, and charging will take place by contact.
- LED charging indicator:
 - If the controller is not on the charger, the indicator is off.
 - When the controller is charging, the indicator light is red.
 - When the controller is charging, the indicator light is blue.

IMPORTANT

If you plug the charger into a USB port on the console, charging only works when it's on or in standby mode, not when it's completely off.

If the indicator light flashes, it means the power supply is faulty. Be sure to use the supplied charging cable. Use the charger only from one of the console's USB ports or from a SV mains charger with a minimum power of 1 A.

TECHNICAL PARAMETERS

- Operating voltage: DC 5V, 1 A
- USB2.0
- USB-A to USB-C cable, 100 cm
- Charging by contactors

SAFETY INSTRUCTIONS

- Do not use the product near water. It shall not be exposed to dripping or splashing and should be kept away from direct contact with liquids.
- For an external cleaning, use a soft, clean and dry cloth only.
- Do not store your product in a dusty or dirty location. The charger parts and electrical components can be damaged.
- Do not store the product in areas where it may be exposed to high temperatures. High temperatures can deform or melt certain plastic parts.
- Do not store the product in areas where it may be exposed to low temperatures. When the charger returns to its normal temperature, humidity can form inside it and damage the electronic circuits.
- Do not attempt to open the product. If the dock or the cable are damaged, do not use it.
- Do not use the product outdoors.
- Never leave the product plugged in when not in use or when left unattended.
- Unplug the product during lightning storms.
- Use of this product by children should only be allowed with the full supervision of a parent or legal guardian.

CONTACT AND SUPPORT

The Subsonic team is at your service and happy to provide you with any additional information on the CHARGER & STAND or other Subsonic products.

contact@subsonic.com

ENVIRONNEMENTAL SAFETY

In order to protect the environment, electric and electronic equipment should not be disposed of in household trash. Please dispose of this equipment at your nearest recycling center.



CHARGER & STAND

CONTACT & SUPPORT

SUBSONIC

314, allée des noisetiers
69760 Limonest – France
contact@subsonic.com
www.subsonic.com

SUBSONIC.

WWW.SUBSONIC.COM

Documents / Resources

<p>CHARGER & STAND</p> <p>Instructions manual Manuel d'utilisation Manual de instrucciones Gebruiksaanwijzing Benutzerhandbuch Manual de utilizare Instrucciones per l'usuari</p> 	<p>SUBSONIC SA5655 Controller Charging Station [pdf] Instruction Manual SA5655 Controller Charging Station, SA5655, Controller Charging Station, Charging Station</p>
--	---

References

- [User Manual](#)

Manuals+, Privacy Policy

This website is an independent publication and is neither affiliated with nor endorsed by any of the trademark owners. The "Bluetooth®" word mark and logos are registered trademarks owned by Bluetooth SIG, Inc. The "Wi-Fi®" word mark and logos are registered trademarks owned by the Wi-Fi Alliance. Any use of these marks on this website does not imply any affiliation with or endorsement.