



Subsonic SA5633 Wireless Led Controller Instruction Manual

[Home](#) » [SUBSONIC](#) » Subsonic SA5633 Wireless Led Controller Instruction Manual 



WIRELESS LED
CONTROLLER

Contents

- 1 SA5633 Wireless Led Controller
- 2 Before the first use
- 3 Features
- 4 Charging
- 5 Connecting the controller to Switch
- 6 Economy mode
- 7 Programming the RGB LEDs
- 8 Adjusting the vibration effect
- 9 Turbo function
- 10 eSport M1 & M2 buttons
- 11 Troubleshooting
- 12 Precautions for use
- 13 Contact and support
- 14 Respect for the environment
- 15 WIRELESS LED CONTROLLER
- 16 Documents / Resources
 - 16.1 References

SA5633 Wireless Led Controller



WWW.SUBSONIC.COM

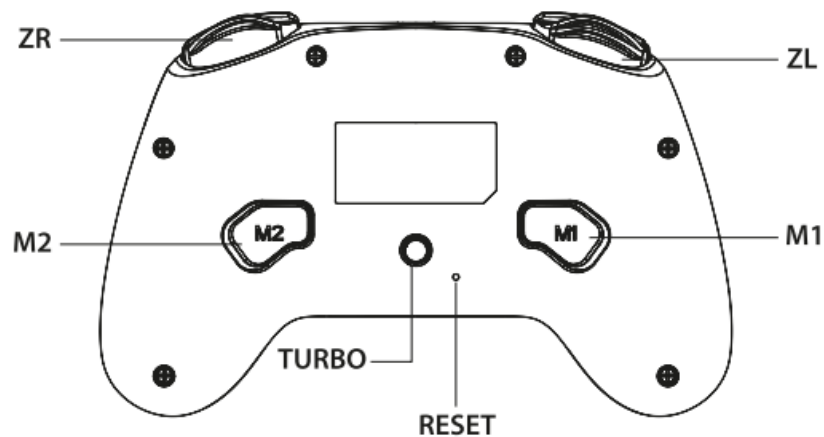
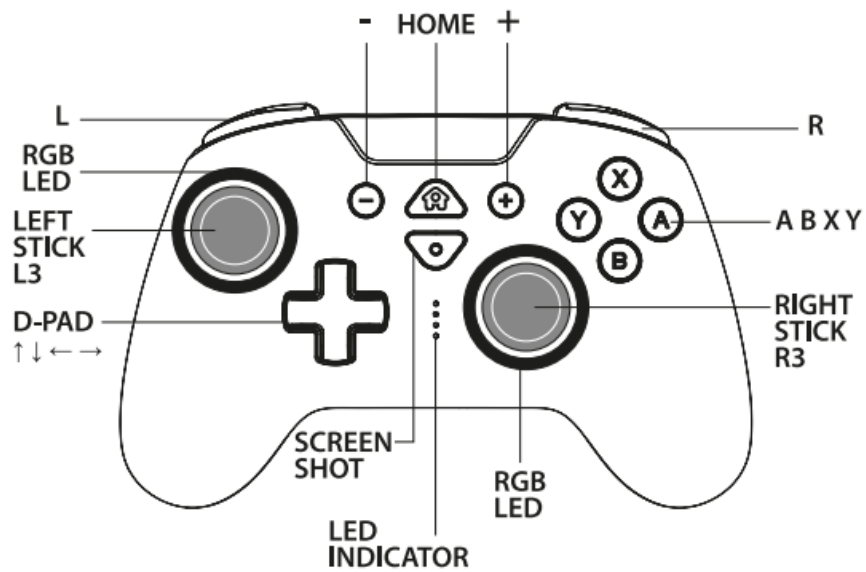

Before the first use

Thank you for purchasing the WIRELESS LED CONTROLLER, Before using it, please read this manual carefully. Please keep it for future reference.

Features

- The WIRELESS LED CONTROLLER is compatible with Switch

- Programmable RGB LED
- Motion sensors (accelerometer, gyroscope), vibration
- Additional programmable eSport M1 and M2 buttons on the back of the controller, turbo function
- Built-in rechargeable battery (charging cable included)
- Can be used with 100% of games compatible with the Switch Pro controller

Working voltage: DC 3.7V

Working current: 25mA-150mA

Built-in Lithium battery: 600mAh

Input charging voltage: Type-C input 5V

Bluetooth version: 2.1+EDR

Transmission distance: 10 M

Battery life: approx 10 hours

Charging

Before connecting for the first time, fully charge the controller's battery.

To charge the battery, connect the controller to a USB port using the supplied USB cable. The LEDs will flash slowly while charging and turn off when the charge is complete.

Do not charge your controller for more than 4 hours.

When the battery level is low, the LED indicator will flash quickly.

Connecting the controller to Switch

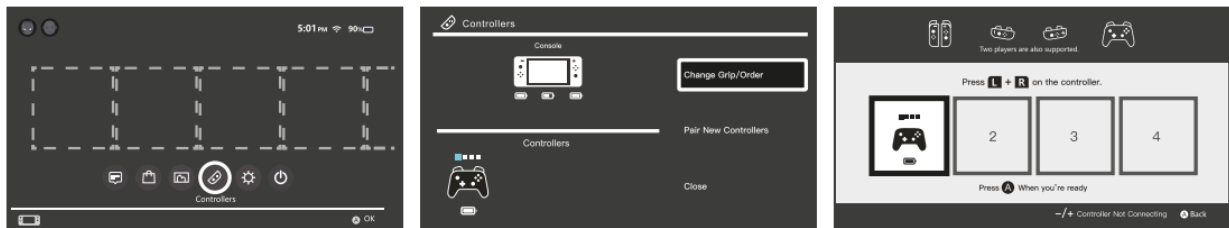

1. Switch on your console:
2. Go to the Controllers menu.
3. Then go to "Change Grip/Order"
4. Long press the Home button of the controller for 5 seconds to turn it on. The LEDs will run and flash quickly, the controller is in the pairing mode.
5. When the controller appears on screen, the pairing is complete. On the controller, the LEDs will stop flashing and only the LED indicating the player will remain lit.

For further information regarding the use of the controller, please refer to the instruction manual of your Nintendo SWITCH.

NOTE: Once the controller has been installed, the wireless controller is identified by the console. Just press the Home button to reconnect to the console.

You can also use the controller in wired mode by connecting it to the console using the USB cable provided.

Economy mode

In order to preserve the battery life, the controller automatically shuts off after 5 minutes of inactivity. Press the Home button to reactivate.

Programming the RGB LEDs

When the controller is on, the default light mode is rainbow. You can change the light mode:

- Fixed colours: press Turbo & D-Pad left — to change to fixed colours mode. Press Turbo & D-Pad right — to switch colour.
- Breathing fixed colours: press Turbo & D-Pad left — to change to breathing fixed colours mode
- You can also change RGB LEDs brightness by pressing Turbo during 2 seconds. The cycle will do 0%, 25%, 50%, 75%, 100% (default is 75%).

Adjusting the vibration effect

When the controller is on, press simultaneously and hold L & 7L & R & ZR to adjust the vibration level from Medium to Strong to Weak (default is Medium).

Turbo function

IMPORTANT: the turbo function is not available in all games, only some can support it. You can affect a turbo or auto function to the keys: A/B/X/Y/L/R/ZL/ZR.

- Turbos for the first time, press one of the keys listed above & Turbo simultaneously.
- The key has now the turbo function, so everytime you press it it will repeat quickly.
- Automatic: for the second time, press one of the keys listed above & Turbo simultaneously. The key has now the auto function, press it once and the action will repeat endlessly.
- Clear the turbo functions or the third time, press one of the keys listed above & Turbo simultaneously. The key is now reset to original.

eSport M1 & M2 buttons

You can affect to the keys L/R/ZL/ZR to M1 or M2 buttons. By default, M1 is mapped to ZL and M2 is mapped to ZR.

1. Press and hold the M key, then press the + key. The light indicator flashes.
2. Then press the key that you would like to affect and press again M to save the setting.
Example: to map A on M1, press and hold M1, then press +. The light indicator flashes. Then press A, then M1 again and M1 is now mapped to A.
To clear the mapping and come back to default, press and hold M1 & M2 & - simultaneously.

Troubleshooting

If you are unable to connect the controller to the console, press the RESET button located in a small hole on the back of the controller with a paper clip. This will reset the controller.

If the controller does not work properly, go to www.subsonic.com to update the controller driver.

Precautions for use

- Do not use the controller for any purpose other than those described in this document.

- To avoid electrical shock, store and use the controller in a dry place, away from moisture and direct sunlight.
- Exposure to high temperatures may damage the body or internal electronics of the unit
- Do not disassemble.
- Stop using the controller immediately if you experience fatigue, discomfort or pain. If these effects persist, consult your doctor.
- Take regular breaks during play.
- Do not allow small children to play with the controller. This product is not intended for children under the age of 3.

Contact and support

The Subsonic team is at your disposal for any further information concerning the WIRELESS LED CONTROLLER or other products in our range of peripherals. contact@subsonic.com

Respect for the environment

To protect the environment, electrical and electronic equipment must not be disposed of with household waste. Please return them to a collection point for recycling.

UE Declaration of conformity to the Radio Equipment Directive

Hereby, SUBSONIC S.A.S. declares that the product WIRELESS LED CONTROLLER

– Brand: Subsonic

– Model: SAS633, SAS633-1, SAS633-2, 5A5633-3

– EAN codes: 3701221702502, 3701221702519, 3701221702526 is in compliance with the essential requirements and other relevant provisions of Directive 2014/53/UE. For details, please contact SUBSONIC, 314 allée des noisetiers, 69760 LIMONEST, France.



WWW.SUBSONIC.COM

In case of malfunction, visit www.subsonic.com.

WIRELESS LED CONTROLLER

CONTACT & SUPPORT

contact@subsonic.com

www.subsonic.com



WWW.SUBSONIC.COM

Documents / Resources

	<p>Subsonic SA5633 Wireless Led Controller [pdf] Instruction Manual SA5633 Wireless Led Controller, SA5633, Wireless Led Controller, Led Controller, Controller</p>
---	---

References

- [User Manual](#)

[Manuals+.](#) [Privacy Policy](#)

This website is an independent publication and is neither affiliated with nor endorsed by any of the trademark owners. The "Bluetooth®" word mark and logos are registered trademarks owned by Bluetooth SIG, Inc. The "Wi-Fi®" word mark and logos are registered trademarks owned by the Wi-Fi Alliance. Any use of these marks on this website does not imply any affiliation with or endorsement.