



STIMULIGHT MULTI-SPECTRUM LED Light Radiating Device User Guide

[Home](#) » [STIMULIGHT](#) » STIMULIGHT MULTI-SPECTRUM LED Light Radiating Device User Guide 

Contents

- [1 USER GUIDE](#)
- [2 LIMITED WARRANTY](#)
- [3 DISCLAIMER](#)
- [4 Documents / Resources](#)
- [5 Related Posts](#)



USER GUIDE

STIMULIGHT IS A MULTI-SPECTRUM LED LIGHT RADIATING DEVICE. USED FOR THERAPEUTIC TREATMENTS BY DELIVERING SPECIFICALLY CHOSEN LIGHT WAVELENGTHS. THREE USER SELECTABLE MODES PENETRATE AND ABSORB DEEP INTO SKIN, MUSCLE AND BONE TISSUES PROVIDING EXTENDED PAIN RELIEF AND BENEFICIAL METABOLIC EFFECTS.

STIMULIGHT IS FOR THE RELAXATION OF MUSCLES AND EXTENDED RELIEF OF MUSCLE SPASM; MINOR MUSCLE AND JOINT ACHES, PAIN AND STIFFNESS ASSOCIATED WITH ARTHRITIS, INCREASED LOCAL BLOOD CIRCULATION AND OPTIMAL CELL PERFORMANCE.

KIT INCLUDES: STIMULIGHT UNIT, ELASTIC VELCRO® STRAP, RECHARGEABLE BATTERY PACK, USB TO MICRO USB POWER CABLE, AND USER GUIDE.

1. PLUG THE USB CABLE INTO BOTH THE STIMULIGHT AND THE BATTERY PACK. THE UNIT WILL BEEP AND THE MULTICOLOR LED WILL FLASH BRIEFLY. STIMULIGHT IS READY TO USE.
2. PRESS THE ON/OFF PUSH BUTTON TO SELECT ONE OF THE THREE OPERATING MODES AS INDICATED BY COLOR OF THE MODE LED.

3. PLACE THE STIMULIGHT LED ARRAYS WINDOW OVER THE TARGET AREA AND SECURE WITH THE VELCRO® SUPPORT STRAP. **THE UNIT MUST BE PLACED DIRECTLY AGAINST THE SKIN** (NOT OVER OR THROUGH ANY CLOTHING).

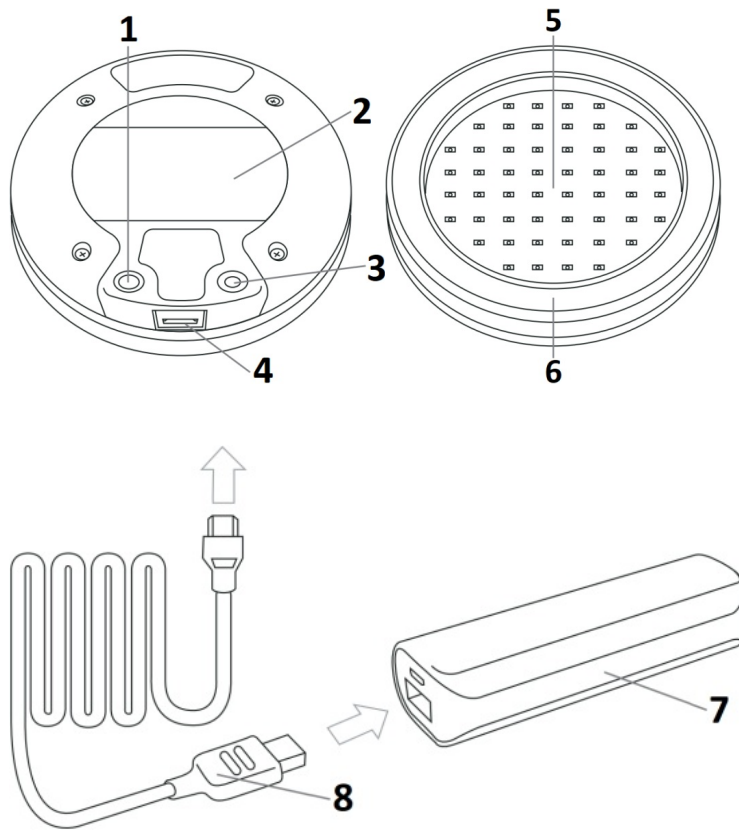

1. ON-OFF BUTTON
2. VELCRO® ATTACHMENT PAD
3. MODE LED
4. POWER JACK
5. LED LIGHT ARRAY WINDOW
6. SOFT CONTACT RING
7. BATTERY PACK
8. USB CABLE

HEAT



RED MODE
ACHES & PAINS RADIANT HEAT

DUAL



GREEN MODE
COMBINED HEAT & COOL LIGHT THERAPY

COOL



BLUE MODE
PROMOTES HEALING & REDUCED INFLAMMATION

4. THE UNIT WILL TURN OFF AUTOMATICALLY AFTER 30 MINS. THE DEVICE MAY BE USED MULTIPLE TIMES PER DAY AND APPLIED TO MULTIPLE TREATMENT AREAS (30 MINUTES FOR EACH). IF LESS HEAT IS DESIRED DURING TREATMENT SELECT THE DUAL (GREEN) MODE.
5. PRESSTHE ON-OFF BUTTONTOTURN OFF UNIT. UNPLUG IF THE UNIT IS NOT GOING TO BE USED FOR AN EXTENDED PERIOD.

WARNINGS

1. The Stimulight® Therapy System is an electronic device. To avoid electrical shock:
 - Do not submerge the unit under water.
 - Wipe clean only using a damp cloth and only when unplugged.
 - Do not plug in or use device with wet hands.
 - Do not use the unit on wet skin.
 - Do not use if cord or plug appears to be damaged.
 - Do not use the unit if dropped, damaged, left outdoors, or dropped into water.
 - Do not pull, lift, or carry the unit by the USB cable.
 - Do not use the USB cable as a handle, allow it to become pinched, or let it come in contact with sharp edges or corners.
 - Do not use on or near hot surfaces.
2. Do not operate the unit in areas where flammable or combustible products or vapors may be present. Explosion or fire may occur.
3. Do not allow children to use unattended - this is not a toy.
4. The unit is not to be used by disabled, sleeping or unconscious persons.
5. Do not use on an open wound. Increases in circulation may cause increased bleeding.
6. Do not use over thyroid gland if the user has been diagnosed with or suspects thyroid problems. No clinical data is available to support use for patients with thyroid gland problems.
7. Do not use this unit with liniments, salves or ointments that contain heat producing ingredients as a skin burn could result.

CAUTIONS

1. Consult your doctor prior to using, especially if you:
 - are pregnant.
 - are taking drugs known to cause sensitivity of skin to light.
 - have any suspicious or cancerous lesions.
 - recently had a steroid injection or use topical steroids.
2. If Individuals using aspirin, ibuprofen and other similar drugs for pain or individuals with skin conditions experience a mild “flare up” of their symptoms, they should stop Stimulight® therapy.
3. Read all instructions and safety precautions before using the Stimulight®.
4. Do not use on infants.
5. If you experience discomfort or have a concern about its use, stop use immediately and contact your doctor.
6. Intended for indoor use.
7. Use only with power sources approved for USB devices.
8. Do not exceed 30 minutes of use in one therapy session over the same skin area.
9. Turn off the light therapy before unplugging the unit. Unplug from power source and remove when not in use.
10. Only recharge the portable battery pack via the micro USB port using any 5V (1A or greater) USB wall adapter.

LIMITED WARRANTY

Hickok Waekon warrants that this product (Stimulight®) will be free from defects in materials and workmanship for 90 days from the date of purchase by the original owner and is not assignable or transferable to another party. The product must be used in a manner as presented in this user guide and only with the provided rechargeable battery pack power supply. What to Do if I Need Warranty Service? To initiate warranty service, please contact Customer Service at 1-800-541-8060 to receive an RMA (Return Merchandise Authorization) and further instructions. Proof of original purchase is required to be eligible for warranty.

DISCLAIMER

This product is not intended to diagnose, cure or prevent disease. Hickok Waekon makes no claims, representations or warranties regarding the ability of this product to cure any physical, skin, or mental conditions. A qualified health professional should be consulted with regard to any condition requiring medical attention.

Go to www.firsttherapy.com for Specs, FAQ's and more!

HICKOK WAEKON

02491-121 Rev A

©2021 HickokWaekon. All rights reserved.

Documents / Resources

	STIMULIGHT MULTI-SPECTRUM LED Light Radiating Device [pdf] User Guide MULTI-SPECTRUM, LED Light Radiating Device
---	---

