

STIHL RE Series Rotating Roller Brush Instruction Manual

STIHL



Contents

- 1 Instruction Manual
- 2 Introduction
- 3 User Information
 - 3.1 Main Parts
 - 3.2 Intended Use
 - 3.3 Personal Protective Equipment
 - 3.4 Safety Precautions
 - 3.5 Before Operation
 - 3.6 Combinations
 - 3.7 Installing the Rotating Roller Brush
 - 3.8 Connecting the Rotating Roller Brush
 - 3.9 Using the Rotating Roller Brush
 - 3.10 Preparing for Transportation or Storage
 - 3.11 Transporting the Rotating Roller Brush
 - 3.12 Storing the Rotating Roller Brush
 - 3.13 Cleaning the Rotating Roller Brush
 - 3.14 Replacing the Brush Rollers
 - 3.15 Specifications
- 4 Documents / Resources
 - 4.1 References
- 5 Related Posts



© ANDREAS STIHL AG & Co. KG 2023

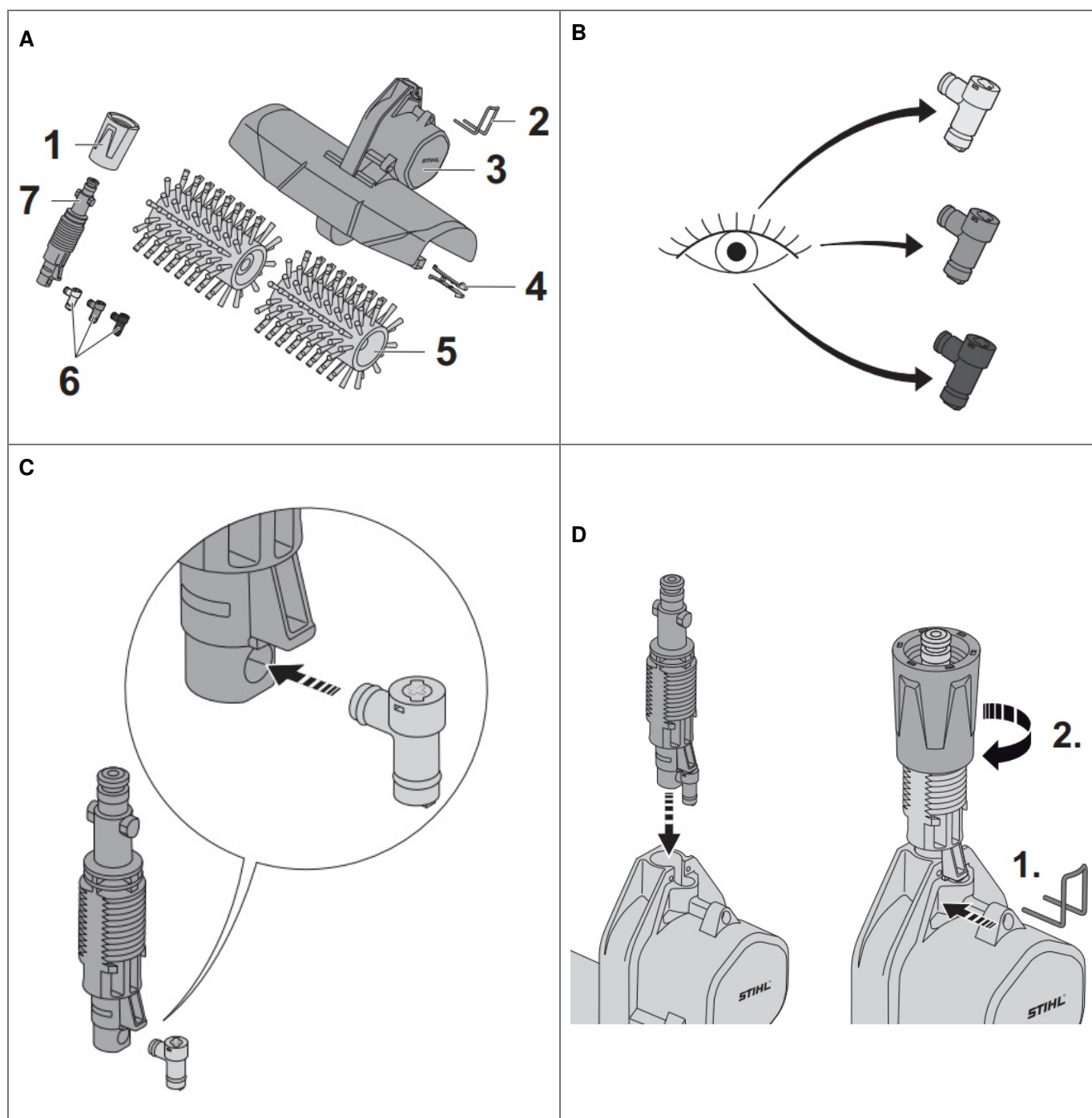

E

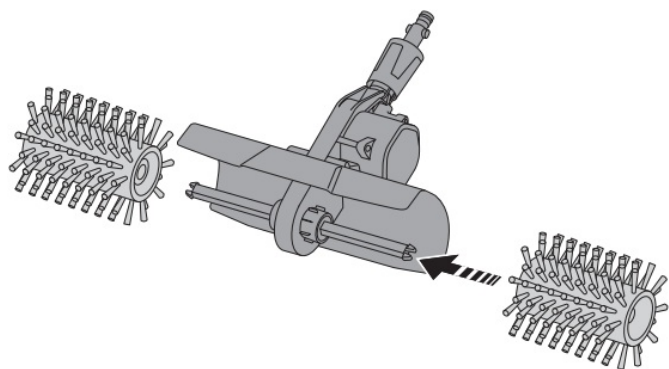

F

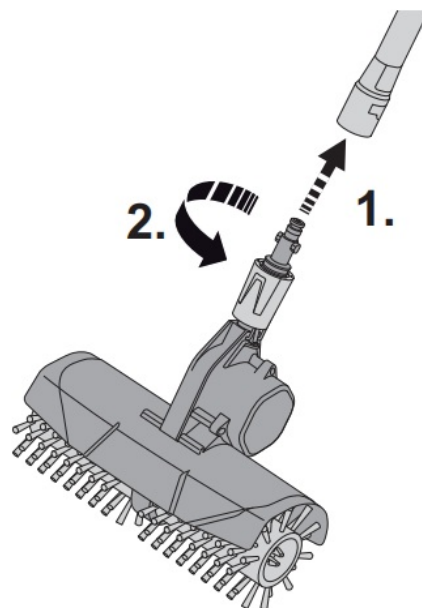

0000103044_001

G

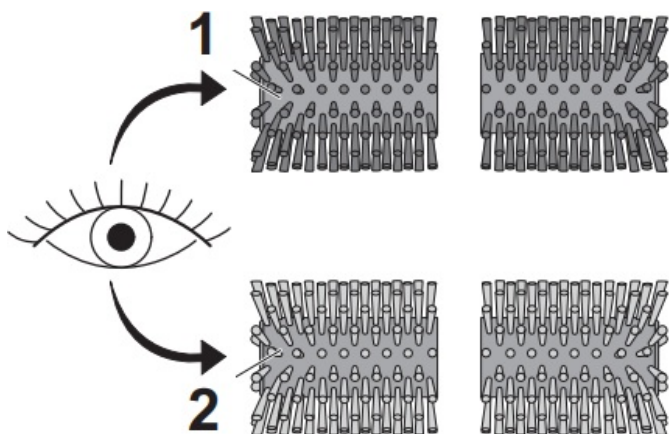

H



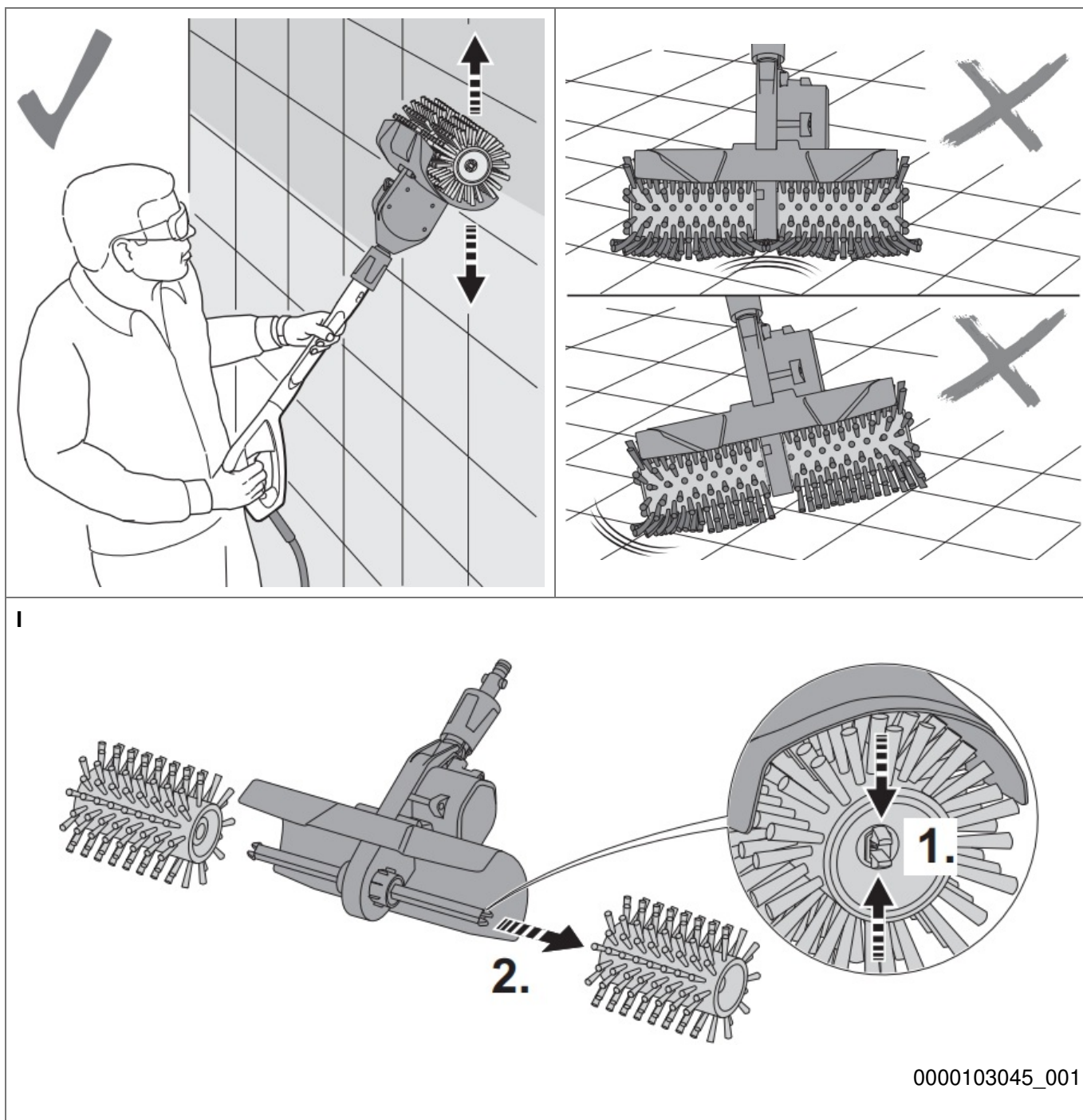

Introduction

Thank you for your purchase. The information contained in this manual will help you receive maximum performance and satisfaction from your STIHL product.

SAVE THIS MANUAL!



It is important that you read and observe the following information and warnings. Improper installation or operation can cause personal injury.



Read this instruction manual, the instruction manual of the pressure washer and the instruction manual of the detergent thoroughly before use and periodically thereafter.

For further information, or if you do not understand any of the instructions in this manual, please contact your authorized STIHL servicing dealer.

SAVE THESE INSTRUCTIONS!

User Information

Main Parts



- 1) Union nut
- 2) Bow
- 3) Rotating roller brush housing
- 4) Clip
- 5) Brush rollers
- 6) Nozzles
- 7) Bayonet style connector

Intended Use

The rotating roller brush is designed to clean flat exterior surfaces. The rotating roller brush can also be used to clean vertical surfaces such as walls. Not suitable for cleaning surfaces that may be scratched by nylon bristles.

Use the rotating roller brush only as described in this manual. Do not use it for other purposes, since misuse may result in personal injury or property damage.

For use only with STIHL RE series pressure washers.

Personal Protective Equipment



- Loss of control and severe injuries may result if hair, clothing or apparel are drawn into the brush rollers or otherwise become entangled in the components of the rotating roller brush. To reduce the risk of severe personal injury:
 - Wear sturdy and snug-fitting clothing that also allows complete freedom of movement.
 - Avoid loose-fitting jackets, scarves, neckties, flared or cuffed pants, jewelry and any other apparel that could be drawn into the brush rollers.
 - Secure hair above shoulder level before starting work.
- To reduce the risk of eye injury while working with the rotating roller brush:
 - Always wear goggles that are impact-rated and marked as complying with ANSI Z87 “+” (US), EN 166 (Europe) or your national standard. Wearers of prescription (Rx) eyewear should wear goggles that can be worn over prescription lenses without disrupting either the prescription eyewear or the proper fit of the goggles..
- Good footing is very important. To help maintain a secure footing and reduce the risk of injury while working:
 - Wear substantial footwear with non-slip soles. Do not wear sandals, flip-flops, open-toed or similar footwear.

Safety Precautions



- To reduce the risk of severe injury, never use the rotating roller brush on persons or animals. Keep bystanders,

especially children, and pets away during operation.

- Never use your rotating roller brush if it is modified, damaged, improperly adjusted or maintained, or not completely and securely assembled. Before starting work, ensure that fittings and couplings are properly installed and secure and that all components are in good working order. Never exceed the maximum operating pressure or temperature,  3.15.
- If you experience unusual vibration in the rotating roller brush during operation, shut off the pressure washer immediately and have the accessory inspected by an authorized STIHL servicing dealer before further use.
- To reduce the risk of loss of control and personal injury, never operate the pressure washer with the spray gun trigger wired in the open position. Never modify the pressure washer controls or the rotating roller brush in any way.
- For use only with STIHL RE series pressure washers. Use with other pressure washer models could increase the risk of personal injury or property damage.

NOTICE

- To reduce the risk of damage to the surface being cleaned, start cleaning with a lower pressure setting and increase pressure as needed. Keep the rotating roller brush in motion during work. If possible, start work at an inconspicuous area and confirm that the surface is not damaged before continuing to other areas.
- To reduce the risk of damage, do not allow the rotating roller brush to be used or stored in freezing temperatures. Store indoors in a dry, secure place that cannot be accessed by children or other unauthorized users.

Before Operation

WARNING

- Misuse or unauthorized use may result in personal injury and property damage.
 - Use the rotating roller brush only as described in this instruction manual and the instruction manual for your pressure washer.
- Using a rotating roller brush that is modified, damaged, improperly adjusted or maintained, can lead to a malfunction and increase the risk of serious personal injury or death.
 - Never operate a rotating roller brush that is modified, damaged, or improperly maintained.
 - Always check your rotating roller brush for proper condition and operation before starting work.
 - Never attempt to modify or override the safety devices in any way.
 - If your rotating roller brush or any part is damaged or does not function properly, take it to your authorized STIHL servicing dealer. Do not use the rotating roller brush until the problem has been corrected.
- To help reduce the risk of serious personal injury or death from unintentional starting:
 - Switch off the pressure washer, relieve system pressure, lock the spray gun trigger and disconnect the pressure washer from the power supply before assembling, inspecting, cleaning, maintaining or servicing the rotating roller brush.
 - Always switch off the pressure washer, relieve system pressure and lock the spray gun trigger before attempting to remove the rotating roller brush.

Combinations

Depending on the pressure washer used, choose an appropriate nozzle to achieve optimum cleaning performance,

 **B:**

White nozzle



- RE 80, 80 X
- RE 90, 90 PLUS
- RE 91
- RE 100, 100 PLUS CONTROL
- RE 105 X
- RE110, 110 PLUS
- RE 120, 120 PLUS
- RE 125, 125 X
- RE 130 PLUS
- RE 140 PLUS
- RE 145 (127V)

Grey nozzle



- REA 60 PLUS
- REA 100 PLUS

Black nozzle



- RE 145 (220V, 220V bis 230V)
- RE 150, 150 PLUS
- RE 170, 170 PLUS

For USA only

Grey nozzle



- REA 60 PLUS
- REA 100 PLUS
- RE 80 (120V)
- RE 90 (120V), 90 PLUS (120V)
- RE 100 PLUS CONTROL (120V)
- RE 110 PLUS (120V)

NOTICE

- Running the rotating roller brush with a wrong nozzle can result in permanent damage of the pressure washer. Always choose the appropriate nozzle for the pressure washer that is used.

Installing the Rotating Roller Brush

 **WARNING**

- If the rotating roller brush is not secure, it can fall out of the spray attachment during operation, which may lead to injury. Before starting work, always confirm that the rotating roller brush is fixed securely in the quick-connect coupling.

To insert the nozzle,  **C:**

- Align the flat surfaces of the nozzle and the bayonet style connector.
- Insert the appropriate nozzle into the bayonet style connector.

To assemble the bayonet style connector,  **D**:

- Insert the bayonet style connector into the rotating roller brush housing.
- Insert the bow to fix the bayonet style connector.
- Screw the union nut down as far as stop and tighten by hand. The bayonet style connector and bow are fixed.

To mount the brush rollers,  **E**:

- Align the flat surfaces of the brush rollers and the shaft.
- Slide the brush rollers onto the shaft.

Connecting the Rotating Roller Brush

To connect the rotating roller brush,  **F**:

- Push the rotating roller brush as far as it will go into the spray attachment.
- Once inserted, turn the rotating roller brush clockwise until it engages.
- If the rotating roller brush is difficult to insert into the spray attachment, apply a food-safe fitting grease to the sealing surface on the spray attachment.

To remove the rotating roller brush:

- Press the rotating roller brush against the spray attachment.
- Turn the rotating roller brush counter-clockwise and pull out of the spray attachment.

Using the Rotating Roller Brush

The rotating roller brush is designed for two-handed operation.

- Depending on the application, choose the appropriate brush rollers to achieve optimum cleaning performance,



- Hard brush rollers (1) to remove dirt from surfaces resistant to scratches, e.g. wood deck, tiles or facades.
- Soft brush rollers (2) to remove dirt from potentially sensitive surfaces, e.g. solar panels, windows or painted and plastic surfaces (accessory).

To clean horizontal surfaces,  **H**:

- Attach the rotating roller brush to the spray lance.
- Move the rotating roller brush evenly over the surface with light pressure.

To maintain proper control, always hold the rotating roller brush at the spray lance while cleaning.

Keep the rotating roller brush in motion whenever the spray gun trigger is activated.

To increase the cleaning performance, the roller brush can also be mounted the other way round (rotated by 180°).

The brush rollers then rotate in the other direction.

To clean vertical surfaces,  **H**:

- Attach the rotating roller brush to the spray gun, without the spray lance.
- Move the rotating roller brush evenly over the surface with light pressure.

To maintain proper control, always hold the rotating roller brush at the spray gun while cleaning.

Keep the rotating roller brush in motion whenever the spray gun trigger is activated.

When working above shoulder height, mount the roller brush the other way round (rotated by 180°). The brush rollers then rotate in the other direction and make the work easier.

Preparing for Transportation or Storage

To prepare the rotating roller brush for transportation or storage:

- Disconnect the spray attachment and let the rest of the water run out of the rotating roller brush.
- Clean the rotating roller brush.

Transporting the Rotating Roller Brush

- When transporting the rotating roller brush in a vehicle, secure and position the it to prevent turnover, impact and damage.

Storing the Rotating Roller Brush

To store the rotating roller brush:

- Clean the rotating roller brush.
- Secure and position the rotating roller brush to prevent turnover, impact and damage.
- Store the rotating roller brush indoors in a dry and secure location, out of the reach of children and other unauthorized persons.
- Ensure that bristles are not bent or deformed during storage.

NOTICE

- Freezing temperatures can damage components of the rotating roller brush. STIHL recommends storing the rotating roller brush indoors in a dry room where it is protected from freezing temperatures. Make sure all water is eliminated from the rotating roller brush before storing.

Cleaning the Rotating Roller Brush

To clean the rotating roller brush:

- Clean the rotating roller brush with a damp cloth.

To clean the roller brushes:

- Flush the bristles with clean water to remove any remaining dirt, sand or other debris from the bristles.
- Test the rotating roller brush at an inconspicuous area on the surface being cleaned, and check, that the surface will be not damaged.

To clean the nozzle:

- Shut off the pressure washer and squeeze the spray gun trigger to relieve system pressure.
- Lock the spray gun trigger.
- Disconnect the spray attachment from the rotating roller brush.
- Remove the bayonet style connector with the inserted nozzle.
- Flush the bayonet style connector and nozzle with clean water and use the cleaning pin from your pressure washer to remove any remaining debris from the orifice.

NOTICE

- Dirt, sand or other debris in the bristles of the roller brushes can damage the surface of the object being cleaned. Keep bristles clean to help prevent scratches and other property damage.
- Nozzle orifices are extremely small and may become clogged with foreign material, such as dirt. Clean the nozzle immediately if they become partially clogged.

Replacing the Brush Rollers

To replace the brush rollers,  1:

- Squeeze the clip.
- Pull the brush rollers off the shaft.
- Mount the new brush rollers to the rotating roller brush.

Specifications

- Weight: 2.7 lbs. (1.2 kg)
- Height: 13.4 in. (340 mm)
- Maximum Pressure: 2610 psi (18 MPa / 180 bar)
- Maximum water temperature: 104 °F (40 °C)

0457-367-0067-A. VA1.L23.



Instruction Manual

www.stihlusa.com



0457-367-0067-A

Documents / Resources

	<p>STIHL RE Series Rotating Roller Brush [pdf] Instruction Manual</p> <p>RE Series Rotating Roller Brush, Rotating Roller Brush, Roller Brush, Brush</p>
---	--

References

- [STIHL â€œ The Number One Selling Brand of Chainsaws | STIHL USA](#)
- [STIHL â€œ The Number One Selling Brand of Chainsaws | STIHL USA](#)
- [User Manual](#)

[Manuals+](#), [Privacy Policy](#)

This website is an independent publication and is neither affiliated with nor endorsed by any of the trademark owners. The "Bluetooth®" word mark and logos are registered trademarks owned by Bluetooth SIG, Inc. The "Wi-Fi®" word mark and logos are registered trademarks owned by the Wi-Fi Alliance. Any use of these marks on this website does not imply any affiliation with or endorsement.