



steinel HF 360-2 DALI-2 Input Device Installation Guide

[Home](#) » [STEINEL](#) » steinel HF 360-2 DALI-2 Input Device Installation Guide 



HF 360-2 DALI-2 Input Device
Hallway DALI-2 Input Device

Follow written instructions!

3.1

HF 360-2 DALI-2 IPD UP

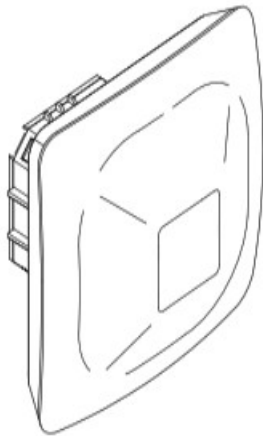

3.2

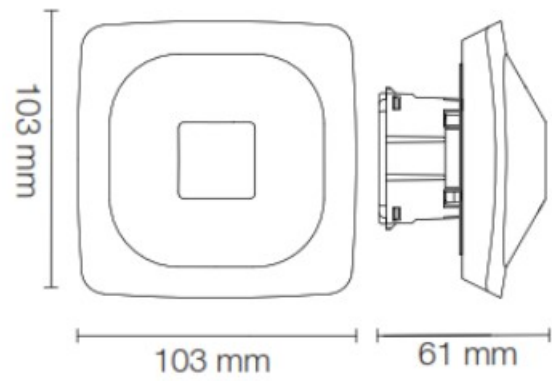

3.3

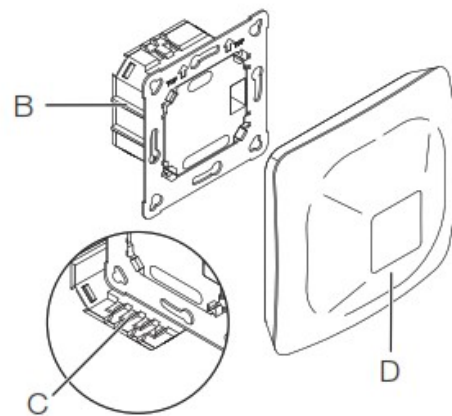

3.4 **HF 360-2 DALI-2 IPD AP**

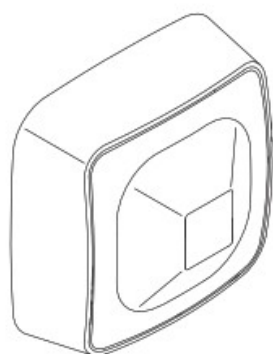

3.7 **Hallway DALI-2 IPD UP**

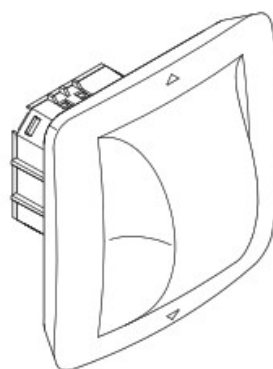

3.5

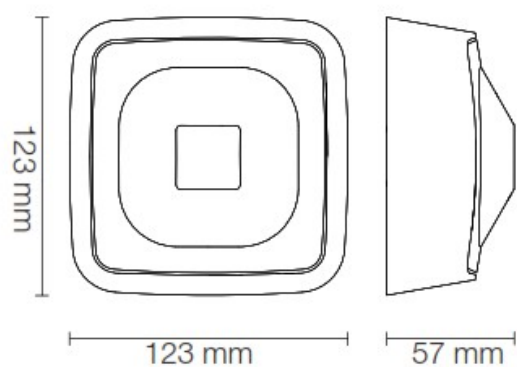

3.8

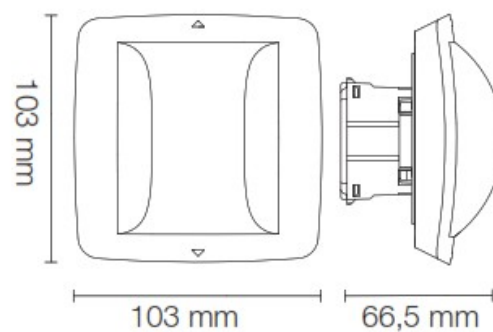

3.6

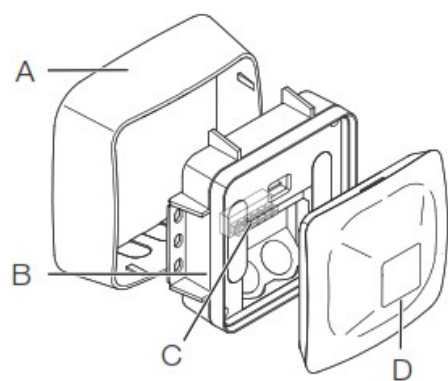

3.9

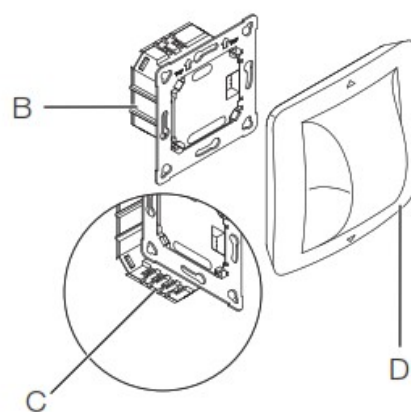

3.10 **Hallway DALI-2 IPD AP**

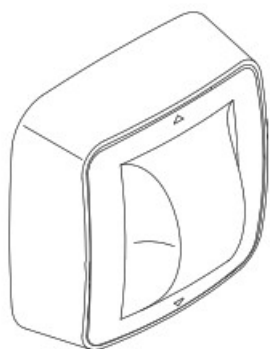

3.13 **HF 360-2 DALI-2 IPD**

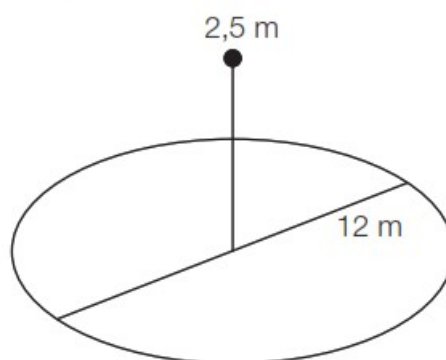

3.11

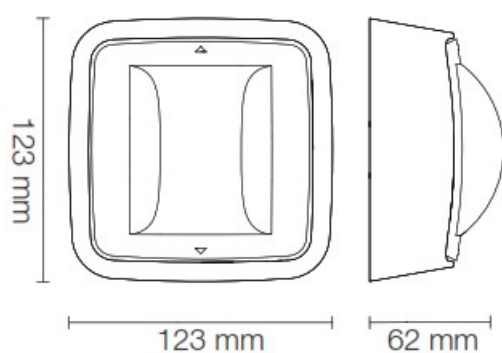

3.14 **Hallway DALI-2 IPD**

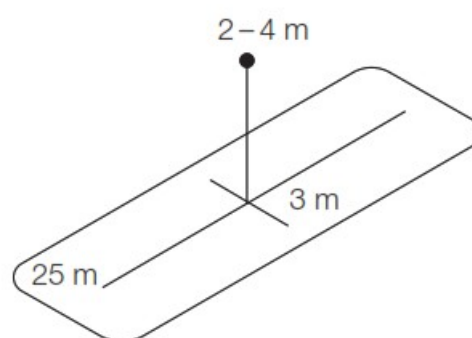

3.12

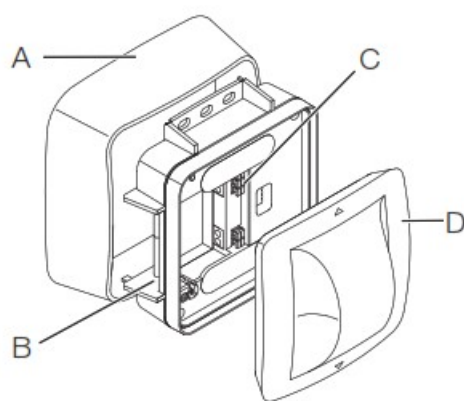

4.1

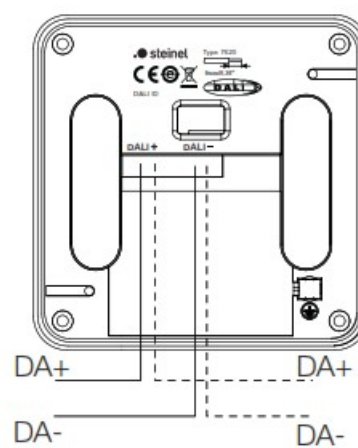
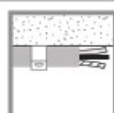

4.2

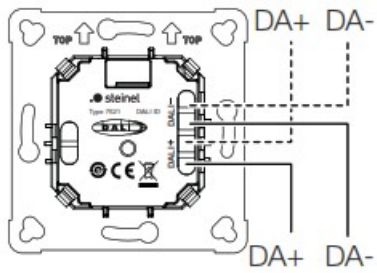

5.2

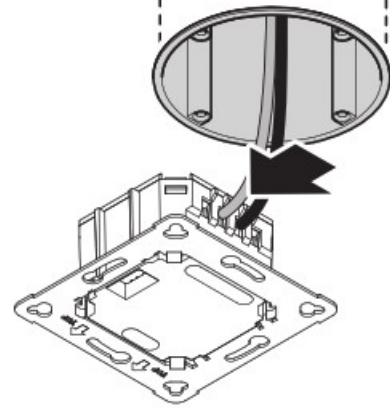

5.3

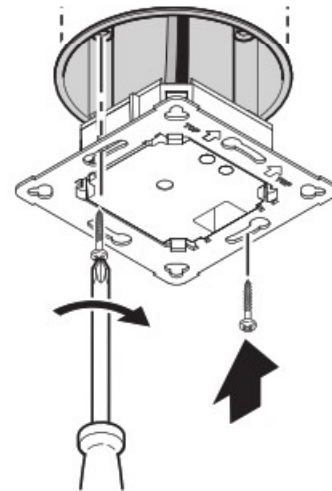

5.4

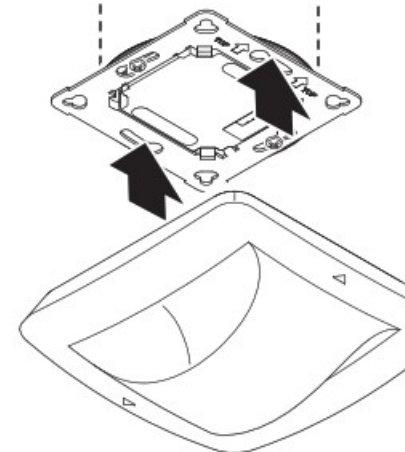

5.1

Hallway DALI-2 IPD

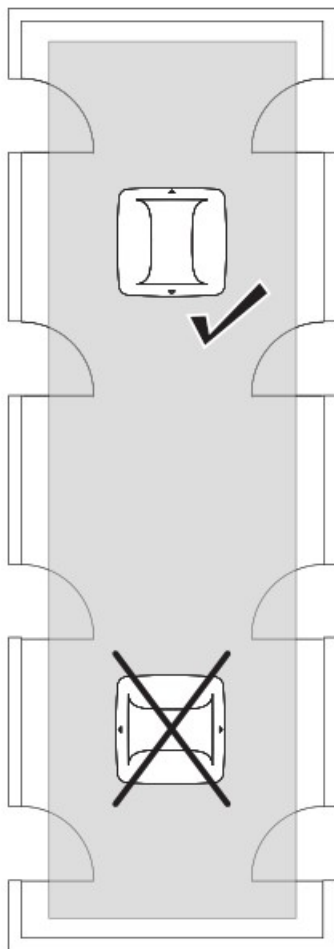

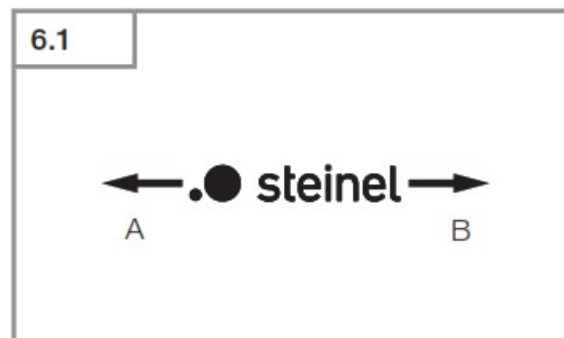
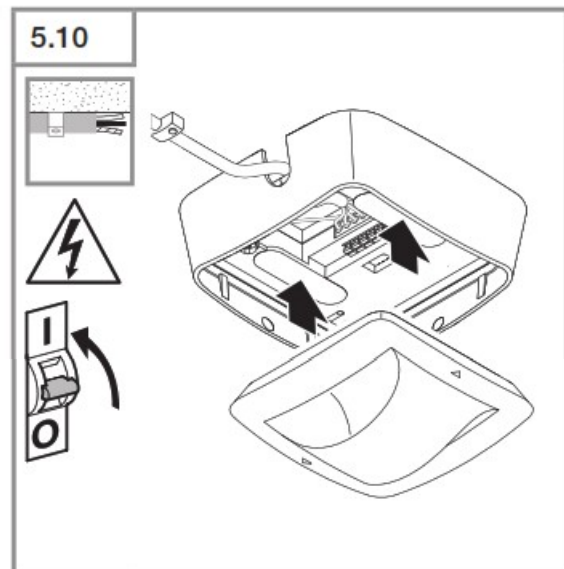
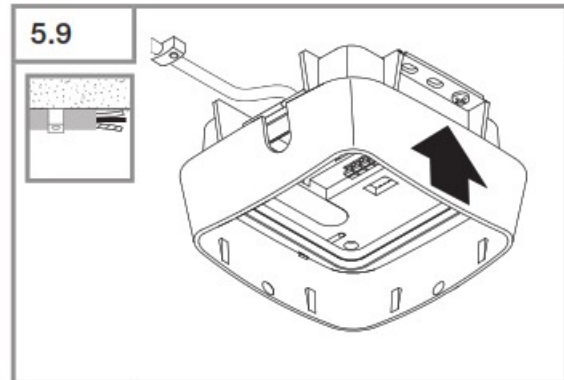
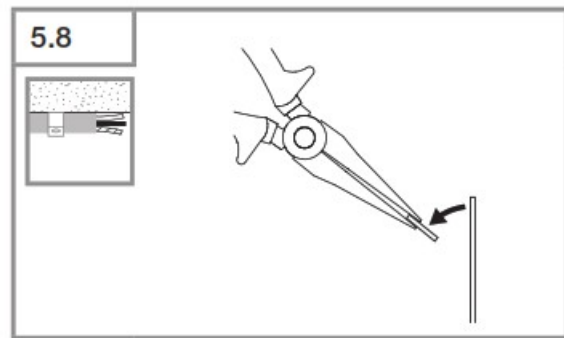
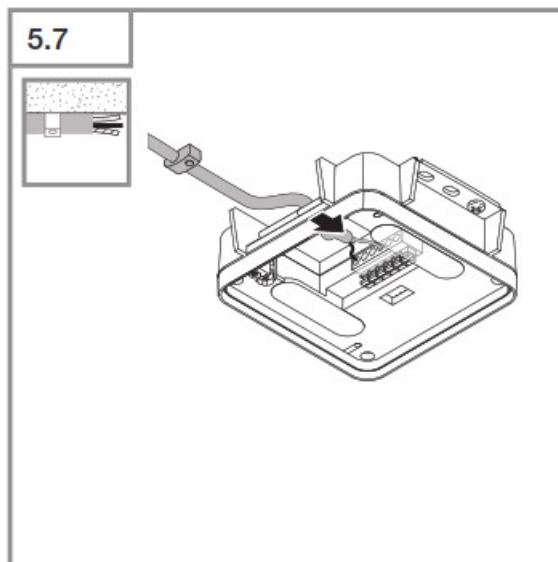
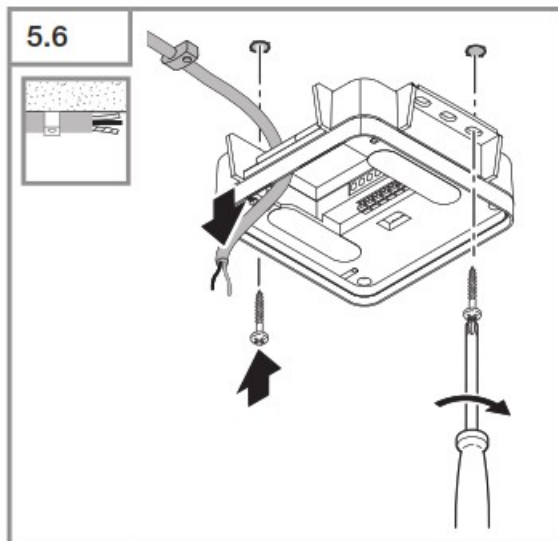
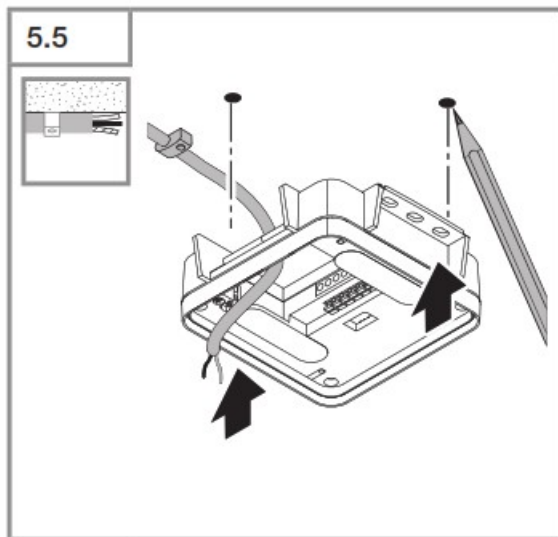



Contents

- 1 About this document
- 2 General safety precautions
- 3 HF 360-2 DALI-2 IPD /Hallway DALI-2 IPD
- 4 Electrical connection
- 5 Installation
- 6 Function and settings
- 7 Maintenance and care
- 8 Troubleshooting
- 9 Disposal
- 10 Conformity
- 11 Manufacturer's Warranty
- 12 Documents / Resources
 - 12.1 References
- 13 Related Posts

About this document

- Please read carefully and keep in a safe place.
- Under copyright.
Reproduction either in whole or in part only with our consent.
- Subject to change in the interest of technical progress.

Symbols

	Hazard warning!
	Reference to other information in the document.

General safety precautions



Disconnect the power supply before attempting any work on the sensor!

- During installation, the electric power cable being connected must not be live. Therefore, switch off the power first and use a voltage tester to make sure the wiring is off-circuit.
- Installing the sensor involves work on the mains power supply. This work must therefore be carried out professionally in accordance with national wiring regulations and electrical operating conditions.
- Only use genuine replacement parts
- Repairs may only be made by specialist workshops. 3.

HF 360-2 DALI-2 IPD /Hallway DALI-2 IPD

Proper use

- Sensor for ceiling mounting indoors.
- Connection to the DALI bus system.

The HF 360-2 DALI-2 IPD sensor also detects movements through thin walls. This makes it ideal for WC facilities with toilet cubicles, changing rooms, stairwells, multistorey car parks and kitchens. The reach and sensitivity of the sensor can be set via the DALI BUS.

The Hallway DALI-2 IPD Sensor is a highfrequencies sensor with a perfect detection zone for corridors. The reach and sensitivity can be set via the DALI BUS.

UP: concealed version

AP: surface-mounted version

Package contents (Fig. 3.1, Fig. 3.4, Fig. 3.7, Fig. 3.10)

Product dimensions (Fig. 3.2, Fig. 3.5, Fig. 3.8, Fig. 3.11)

Product components (Fig. 3.3, Fig. 3.6, Fig. 3.9, Fig. 3.12)

A Surface-mounting adapter

B Load module

C Connecting terminal

D Sensor module

HF 360-2 DALI-2 IPD detection zone

DALI-2 IPD (Fig. 3.13)

HF 360-2 DALI-2 IPD detection zone

DALI-2 IPD (Fig. 3.14)

Technical specifications

- HF 360-2 dimensions (H × W × D):
Concealed installation (UP): 103 × 103 × 61 mm
Surface-mounted installation (AP): 123 × 123 × 57 mm
- Hallway dimensions (H × W × D):
Concealed installation (UP): 103 × 103 × 66.5 mm
Surface-mounted installation (AP): 123 × 123 × 62 mm
- Mounting height: 2 – 4 m
- Angle of coverage: 360°
- HF 360-2 reach: Ø 12 m
- Hallway reach: 25 × 3 m
- Sensor values: Light measurement, Temperature: 0 – 40 °C, Relative humidity: 0 – 100 %
- Temperature range: 0 °C to +40 °C
- IP rating: IP20
- Bluetooth frequency: 2.4 – 2.48 GHz
- Bluetooth transmission power: 5 dBm / 3 mW
- HF 360-2 / Hallway frequency: 5,8 GHz
- Transmission power: 3 dBm / 2 mW
Power consumption via DALI (12 – 22.5 V DC, no SELV):
- Max. current consumption in accordance with IEC 62386-101:: HF 360-2: 84 mA / 42 devices Hallway: 84 mA / 42 devices
- Typical current consumption at an input voltage of 16 V in regular operation *: HF 360-2: 21 mA / 11 devices

Hallway: 25 mA / 13 devices

- Max. current consumption at an input voltage of 10 V in regular operation *: HF 360-2: 38 mA / 19 devices

Hallway: 46 mA / 23 devices

* These values will not be exceeded in regular operation and can be used as the basis for planning.

Electrical connection

DA+ = Connection to the DALI BUS (brown)

DA- = Connection to the DALI BUS (blue)

Surface-mounted connection (Fig. 4.1)

Concealed connection (Fig. 4.2)

Installation

- Check all components for damage.
- Do not use the product if it is damaged.
- Select an appropriate mounting location, taking the reach and motion detection into consideration. (Fig. 3.13, Fig. 3.14)
- Aim sensor in appropriate direction. Hallway DALI-2 IPD. (Fig. 5.1) Mounting procedure
- Switch off power supply. (Fig. 4.1, Fig. 4.2) Concealed mounting
- Make connection. (Fig. 5.2, 4.2)
- Firmly screw load module into mounting box. (Fig. 5.3)
- Fit magnetic sensor module on frame. (Fig. 5.4)
- Switch ON power supply. (Fig. 5.4)
- Make settings. "6. Function and settings"

Surface mounting

- Mark drill holes and drill. (Fig. 5.5)
- Screw load module into place. (Fig. 5.6)
- Make connection. (Fig. 5.7, Fig. 4.1)
- Break out the mounting tab. (Fig. 5.8)
- Fit surface-mounting adapter. (Fig. 5.9)
- Fit magnetic sensor module. (Fig 5.10)
- Switch ON power supply. (Fig. 5.10)
- Make settings. "6. Function and settings"

Function and settings

The sensor is put into operation in accordance with the applicable DALI 2 standard. All functions and commands of the DALI standard IEC 62386 Part 101, Part 103, Part 303 and Part 304 are available.

- The motion detection values and light levels measured by the sensor can be requested from the DALI Application Controller.
- Automatic or time-based cyclical transmission can also be selected.

You will find detailed information in the interface description on the Internet at: www.steinell.de

LED function

Initialization: LED flashes blue
Normal mode: LED OFF
Error: LED lights up red
Programming mode:
LED lights up turquoise
Test mode, movement:
LED permanently lights up green
Test mode, no movement:
LED permanently lights up red
Identification via DALI:
LED flashes magenta

Setting Hallway detection DALI-2 IPD

The reach and sensitivity can be set separately for both directions. The Steinell logo on the sensor serves as a reference here (Fig. 6.1).

Example: A

The reach shown by "S" in the interface description points to the direction in which the S in the Steinell logo points.

B

The reach shown by "L" in the interface description points to the direction in which the L in the Steinell logo points. You will find detailed information in the interface description on the Internet at: www.steinell.de

Maintenance and care



Hazard from electrical power! Contact between water and live parts can result in electrical shock, burns or death.

- Only clean tool in a dry state.

Risk of damage to property!

Using the wrong detergent can damage the light.

- Clean unit with a moist cloth without detergent.

Troubleshooting

Light does not switch ON.

- No supply voltage.
 - Check supply voltage.
- No presence detection.
 - Ensure unobstructed sensor vision.
 - Check detection zone.

Lights do not switch OFF.

- Objects moving in the detection zone.
 - Check detection zone.

Sensor switches OFF despite persons being present.

- Reach set too low.
 - Change reach.

Light switches ON despite no persons being present.

- Movement within adjacent rooms and floor levels.
- Change reach
- Reduce sensitivity

Sensor randomly restarting

- Interference between Wifi and Bluetooth of third party devices, e.g. Wifi routers.
- Change to a different network setting in the sensor configuration page.
 - “6. Function and settings”

Disposal



Electrical and electronic equipment, accessories and packaging must be recycled in an environmentally compatible manner.

Do not dispose of electrical and electronic equipment as domestic waste!

EU countries only

Under the current European Directive on Waste Electrical and Electronic Equipment and its implementation in national law, electrical and electronic equipment no longer suitable for use must be collected separately and recycled in an environmentally compatible manner.

Conformity

STEINEL GmbH hereby declares that the HF 360-2 DALI-2 IPD / Hallway DALI-2 IPD radio equipment type conforms to Directive 2014/53/EU. The full wording of the EU Declaration of Conformity is available for downloading from the following Internet address: www.steinell.de

Manufacturer's Warranty

Manufacturer's warranty of STEINEL GmbH, Diesel strasse 80-84, DE-33442 Herzebrock-Clarholz, Germany All STEINEL products meet the highest quality standards. For this reason, we, the manufacturer, are pleased to provide you, the customer, with a warranty under the following terms and conditions: The warranty covers the absence of deficiencies which are proven to be the result of a material defect or fault in manufacturing and which are reported to us immediately after detection and within the warranty period. The warranty shall cover all

Our warranty cover for consumers

The provisions below apply to consumers. A consumer is any natural person who, on entering into the purchase transaction, neither acts in exercising their commercial nor their self-employed activity.

You can opt for warranty cover in the form of repair or replacement which will be provided free of charge (if applicable, in the form of a successor model of the same or higher quality) or in the form of a credit note.

In the case of sensors, floodlights, outdoor and indoor lights, the warranty period for the STEINEL Professional product you have purchased is 5 years in each case from the date on which the product was purchased.

We shall bear the shipping costs but not the transport risks involved in return shipment. Our warranty cover for entrepreneurs The provisions below apply to entrepreneurs. Entrepreneur is a natural or legal person or partnership with legal personality who or which, on entering into the purchase transaction, acts in exercising their or its commercial or self-employed activity.

We have the option of providing warranty cover by rectifying deficiencies free of charge, replacing a product free of charge (if applicable, in the form of a successor model of the same or higher quality) or by issuing a credit note. In the case of sensors, floodlights, outdoor and indoor lights, the warranty period for the STEINEL Professional product you have purchased is 5 years in each case from the date on which the product was purchased.

Within the scope of warranty cover, we shall not bear your expenses accruing from subsequent fulfillment nor shall we bear your expenses for removing the defective product and installing a replacement product.

Statutory rights accruing from defects, gratuitousness The warranty cover described here shall be applicable in addition to the statutory rights of warranty – including special consumer protection provisions – and shall not restrict or replace them. Exercising your statutory rights in the event of defects is gratuitous.

Exemptions from the warranty

All replaceable lamps are expressly excluded from this warranty. In addition to this, the warranty shall not cover:

- any wear resulting from use or any other natural wear of product parts or any deficiencies in the STEINEL Professional product that are attributable to wear caused by use or other natural wear,
- any improper or non-intended use of the product or any failure to observe the operating instructions,
- any unauthorized additions, alterations or other modifications to the product or any deficiencies attributable to the use of accessory,
- supplementary or replacement parts which are not genuine STEINEL parts,
- any maintenance or care of products that is not carried out in accordance with the operating instructions,
- any attachment or installation that is not in accordance with STEINEL's installation instructions,
- any damage or loss occurring in transit.

Application of German law

The warranty shall be governed by German law excluding the United Nations Convention concerning the International Sale of Goods (CISG).

Making claims

If you wish to make a warranty claim, please send your product complete and carriage paid with the original receipt of purchase, which must show the date of purchase and product designation, either to your retailer or directly to us at STEINEL (UK) Ltd. – 25 Manasty Road, Axis Park, Orton Southgate, GB- Peterborough Cambs PE2 6UP United Kingdom.

For this reason, we recommend that you keep your receipt of purchase in a safe place until the warranty period expires.

5 YEAR
MANUFACTURER'S
WARRANTY

STEINEL GmbH
Dieselstraße 80-84
33442 Herzebrock-Clarholz
Tel: +49/5245/448-188
www.steinel.de



Contact

www.steinel.de/contact



Documents / Resources

   <small>HF 360-2 DALI-2 Input Device Helfung DALI-2 Input Device</small>	<p>steinel HF 360-2 DALI-2 Input Device [pdf] Installation Guide HF 360-2 DALI-2 Input Device, HF 360-2 DALI-2, Input Device, Device</p>
--	--

References

- [Steinel Group | STEINEL](#)

- [International | STEINEL](#)
- [User Manual](#)

[Manuals+](#), [Privacy Policy](#)