





STEGO LED 122 Varioline Lamp with Socket User Manual

[Home](#) » [STEGO](#) » STEGO LED 122 Varioline Lamp with Socket User Manual 





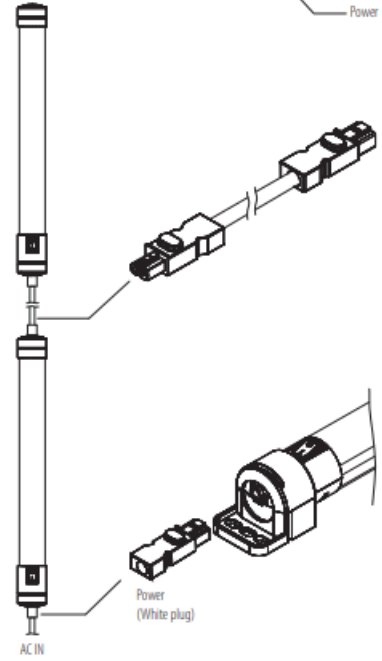
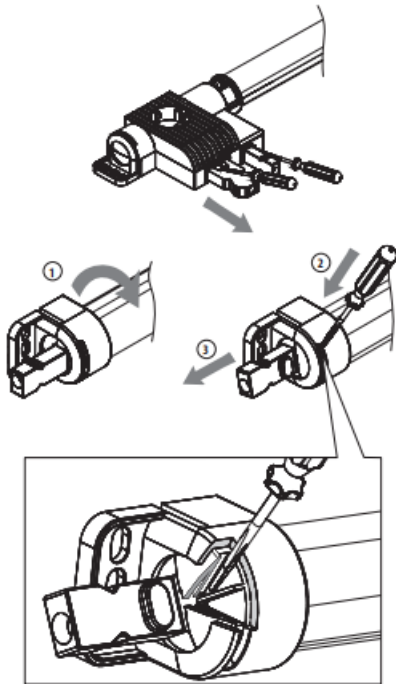
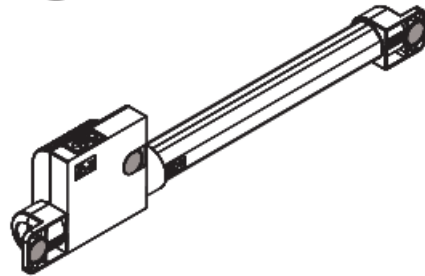
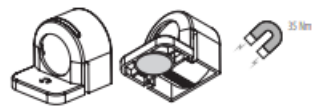
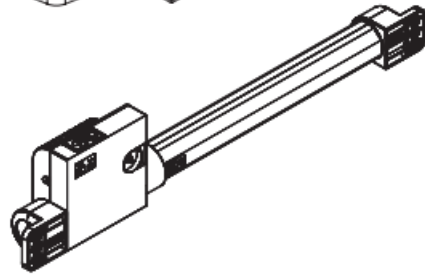
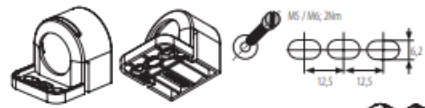
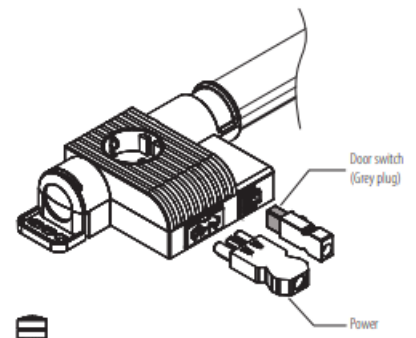
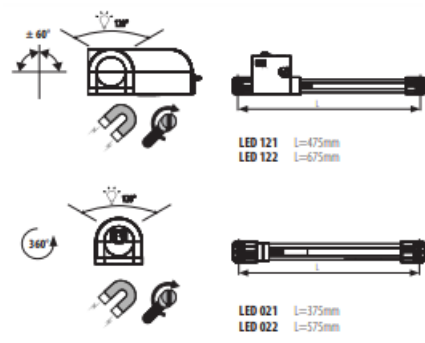

	<div data-bbox="298 1167 513 1254"> WARNING</div> <div data-bbox="298 1285 1469 1352">There is a risk of personal injury and equipment damage if the connection values are not observed or polarity is incorrect!</div>
---	---

- Contents
- 1 [ACCESSOIRES](#)
 - 2 [Safety considerations](#)
 - 3 [Documents / Resources](#)
 - 4 [Related Posts](#)

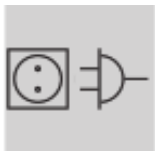
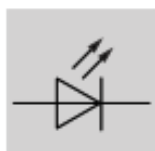
ACCESSOIRES



	LED 021 / 022 AC 100V – 240V [min. AC 90V, max. AC 265V] LED 121 / 122 AC 220V – 240V, 50/60Hz; AC 120V 50/60Hz
	LED 021 / 121 30xLED, 120°, 6500K, 1080Lm, 60.000h LED 022 / 122 48xLED, 120°, 6500K, 1730Lm, 60.000h
	max. 90%rH
	-30 ... +40°C (-22 ... +104°F)
	LED 021 0.2kg LED 121 0.3kg LED 022 0.3kg LED 122 0.4kg

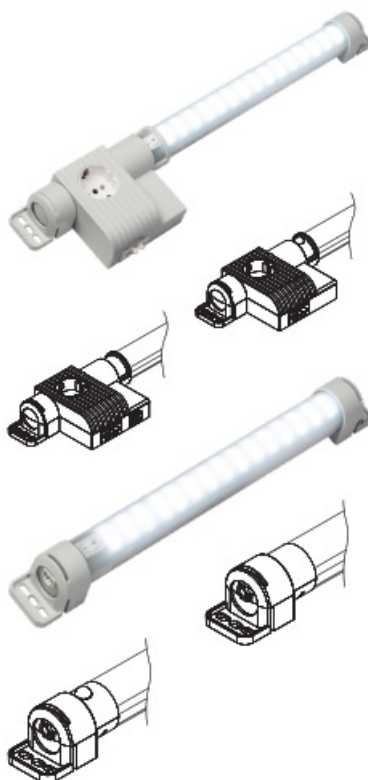

USAGE

The lamp is used for illumination in stationary, closed electric cabinets DIN EN 61439-1/DIN EN 61439-2.

Safety considerations

- Installation must only be performed by qualified electrical technicians in observation of the respective national power-supply guidelines (IEC 60364).
- The lamps with magnet fixing must be checked to ensure that the holding power of the magnet is adequate for the respective application with the connection cable.
- The lamp must be mounted stationary.
- With magnet fixing, the lamp can be flexibly mounted in the electric cabinet.
- The technical specifications on the type plate must be strictly observed!
- No changes or modifications must be made to the device.
- In case of apparent damage or malfunction, the device may not be repaired or put into operation. (Dispose of device.)
- The light source cannot be replaced.
- The lamp must not be used as a hand lamp.
- The lamp must not be used for household lighting

Commissioning the lamp with a motion detector

The test run is activated by disconnecting from the mains and then reconnecting. The lamp flashes briefly twice and then switches off again. Upon reactivation of the motion detector, the lamp switches on for 5 seconds and then switches off again; the lamp is ready for operation.

Notice

The manufacturer accepts no liability in the case of failure to observe this brief instruction, improper use, and changes or damage to the device.

Type LED 021 / 121 / 022 / 122
Zum späteren Gebrauch aufbewahren.
Store for use at a later date.

STEGO Elektrotechnik GmbH – Kolpingstrasse 21 – 74523 Schwaebisch Hall Germany
www.stego.de

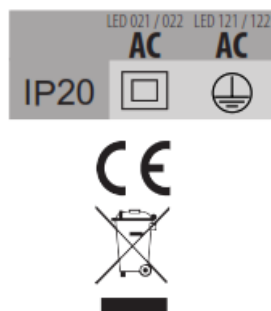

Documents / Resources

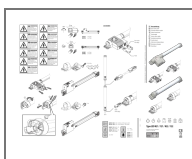

[STEGO LED 122 Varioline Lamp with Socket](#) [pdf] User Manual
LED 021, LED 121, LED 022, LED 122, Varioline Lamp with Socket, LED 122 Varioline Lamp with Socket, Lamp with Socket