

StarTech DA-4L Quad Monitor Stand Instruction Manual

[Home](#) » [StarTech](#) » StarTech DA-4L Quad Monitor Stand Instruction Manual 

Contents

- [1 StarTech DA-4L Quad Monitor Stand](#)
- [2 Product Information](#)
- [3 INSTALLATION INSTRUCTION](#)
- [4 Safety Caution](#)
- [5 Before Starting Assembly](#)
- [6 Hardware Included](#)
- [7 Manage tools and cables](#)
- [8 Set the desired angle of the monitors](#)
- [9 Product dimensions](#)
- [10 Documents / Resources](#)
 - [10.1 References](#)
- [11 Related Posts](#)



StarTech DA-4L Quad Monitor Stand



Product Information

Specifications

- Max Weight Capacity: 17.6 lbs (8 kg)
- VESA Compatibility: 75x75mm, 100x100mm

Product Usage Instructions

Step 1: Clamp Installation

For desk plates with a thickness of 10-51mm:

1. Secure the pole assembly (02A) with the preassembled screw (06).
2. Adjust the clamp height to fit your desk plate. Secure the stand to the desktop by tightening the clamp.
3. Do not tighten the screws excessively to avoid damaging your monitor.

For desk plates with a thickness of 51-80mm:

1. Secure the pole assembly (02A) with the preassembled screws (05A).
2. Adjust the clamp height to fit your desk plate. Secure the stand to the desktop by tightening the clamp.
3. Do not tighten the screws excessively to avoid damaging your monitor.

Step 2: Grommet Base Installation

For desk plates with a thickness of 10-40mm:

1. Secure the pole assembly (02A) with the preassembled screws (05A).
2. Attach the round plate (01C) to the lower pole (02B) by using the screws (06).

For desk plates with a thickness of 10-60mm:

1. Secure the pole assembly (02A) with the preassembled screws (05A).
2. Attach the round plate (01C) to the lower pole (02B) by using the screws (06).

Step 3: Attach the VESA plates to the monitors

(a) For Flat Back:

1. Assemble the upper pole (0022AA) and the lower pole (0022BB) together.
2. Secure the L plate (0011BB) to the lower pole (0022BB) with the preassembled screws.
3. Secure the clamp bracket to the L plate with the screws (06).

(b) For Recessed / Curved Back:

1. Assemble the upper pole (0022AA) and the lower pole (0022BB) together.
2. Disassemble the clamp bracket. The marked parts a and b will be used in the next step.
3. Assemble the round plate (0011CC) to the lower pole (02B) after making knob bolt b through the long plate aa, desk hole, and the bottom of the pole assembly sequentially.

Step 4: Assemble the Stand

Assemble the monitor arms (033) and the pole together.

Step 5: Attach the Monitors to the Stand

Hang the monitor onto the arm, then use the safety screws L / cap nuts MM-CD to secure the monitors.

Step 6: Tilting Adjustment

Fasten the bolt with a 5mm Allen key (0057CC). Attach the cable clips (007AA and 007BB) to the stand.

FAQ

Q: What is the maximum weight capacity of this product?

A: The maximum weight capacity is 17.6 lbs (8 kg).

Q: What are the VESA compatibility options for this product?

A: This product is compatible with VESA sizes 75x75mm and 100x100mm.

Q: How should I tighten the screws during installation?

A: Do not tighten the screws excessively to avoid damaging your monitor.

Q: What should I do if I have missing or damaged parts?

A: If you have any parts shortage or damage, please contact us for assistance.

INSTALLATION INSTRUCTION

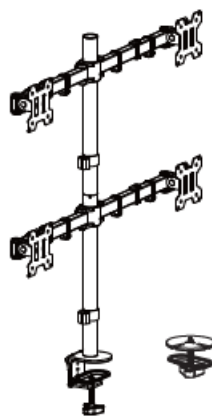

Safety Caution

Please read this instruction carefully before installation. If you do not understand these instructions or have doubts about the safety of the installation, assembly or use of this product, please contact us.

WARNING: This product contains small items that could be a choking hazard if swallowed.

KEEP AWAY FROM CHILDREN UNDER 3 YEARS OLD. ADULT SUPERVISION IS REQUIRED.

Before Starting Assembly

When attaching brackets to the flat screen, be careful not to over tighten screws and be sure that screws do not bottom out in the mounting holes. Before starting assembly, verify all parts are included and undamaged. For parts shortage or damage, please contact us.

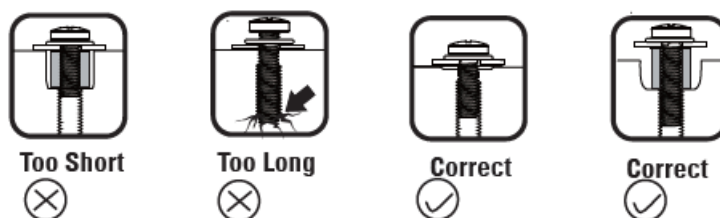

Do not tighten the screws excessively or your monitor might be damaged.

Hardware Included

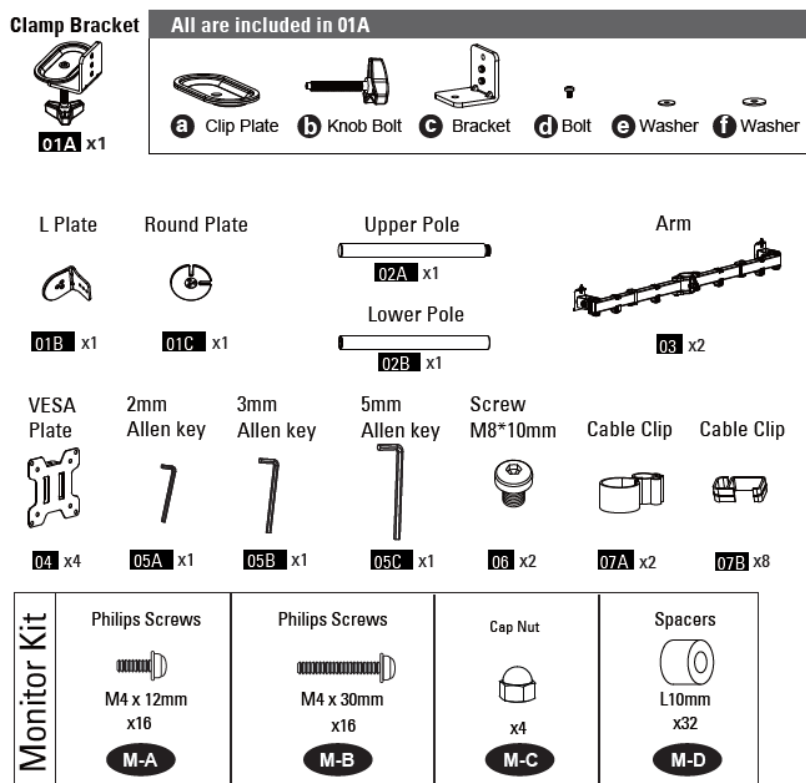

Step 1A Clamp Installation

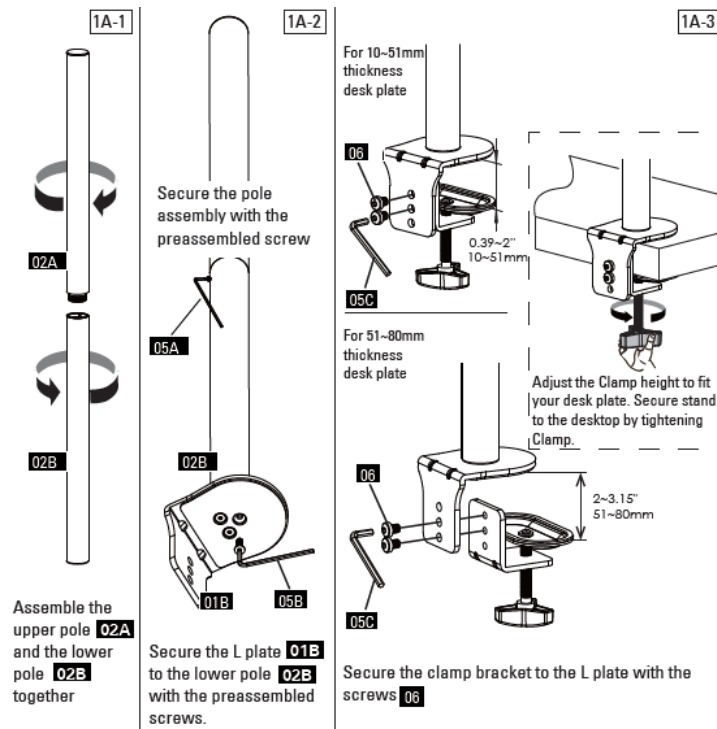

Step 1B Grommet Base Installation

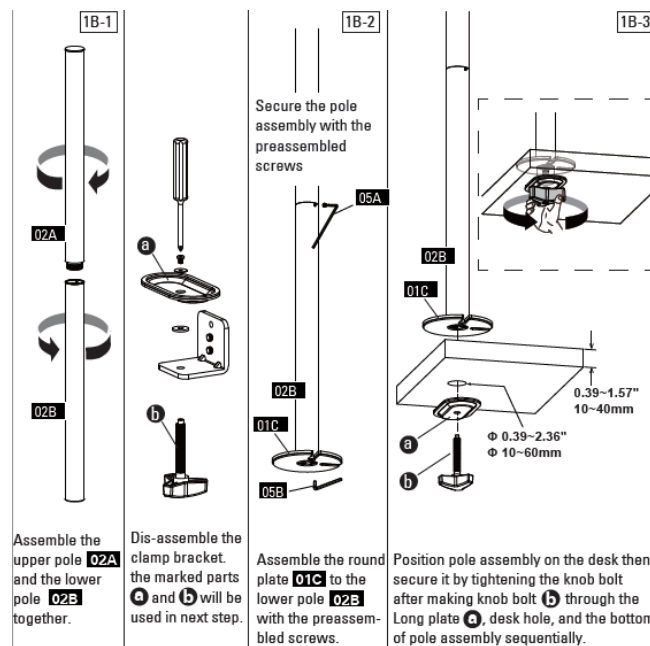

Step 2 Attach the VESA plates to the monitors

(a) For Flat Back

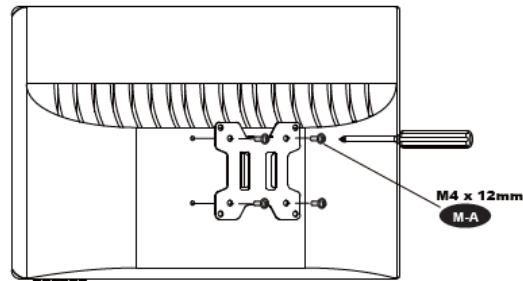

(b) For Recessed / Curved Back

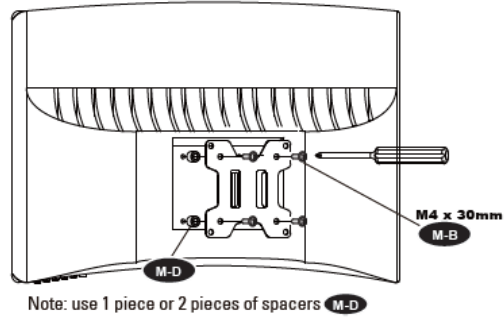

Step 3 Assemble the stand

Assemble the monitor arms 0303

Assemble the monitor arms 03 and the pole together.

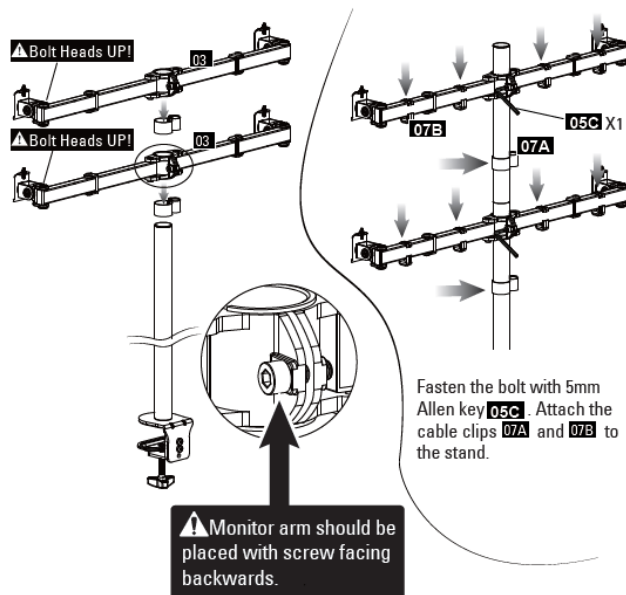

Step 4 Attach the monitors to the stand

Hang the monitor onto the arm then using the safety screws L / cap nuts M-D to M-C secure the monitors.

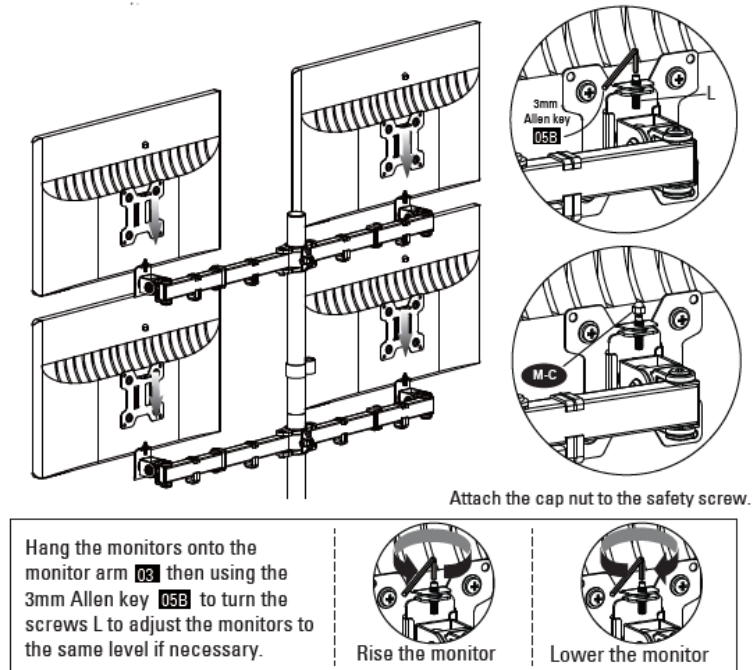

WARNING Hang 2 monitors onto the same arm at the same time to prevent the stand falling

Step 5 Tilting Adjustment

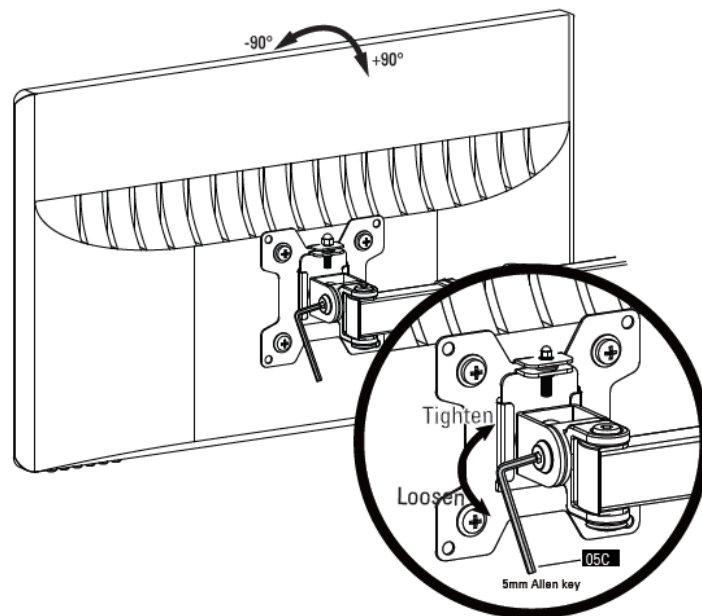

Loosen tilting bolts, pull monitor to your desired angle, then fasten tilting bolts with the 5mm Allen key.

Step 6 Switch screen horizontally and vertically

If needed, the monitor can be rotated ± 90 degrees for switching screen between horizontally and vertically for turn the monitors directly

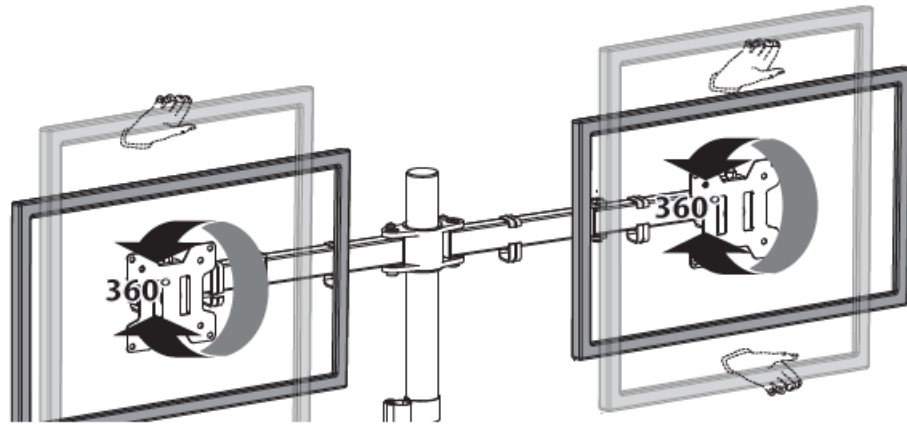

Manage tools and cables

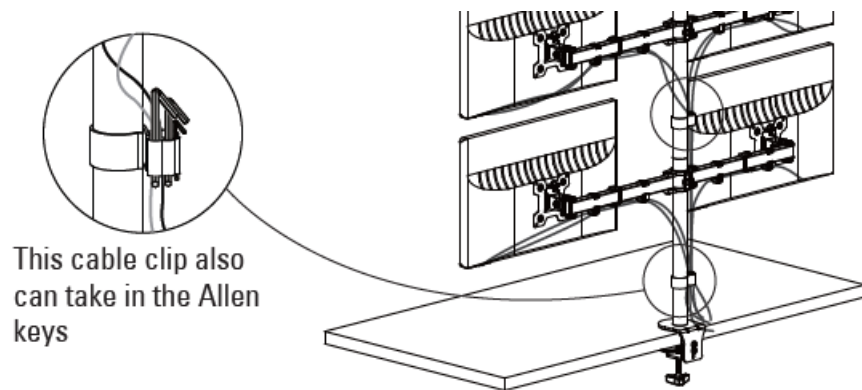

Set the desired angle of the monitors

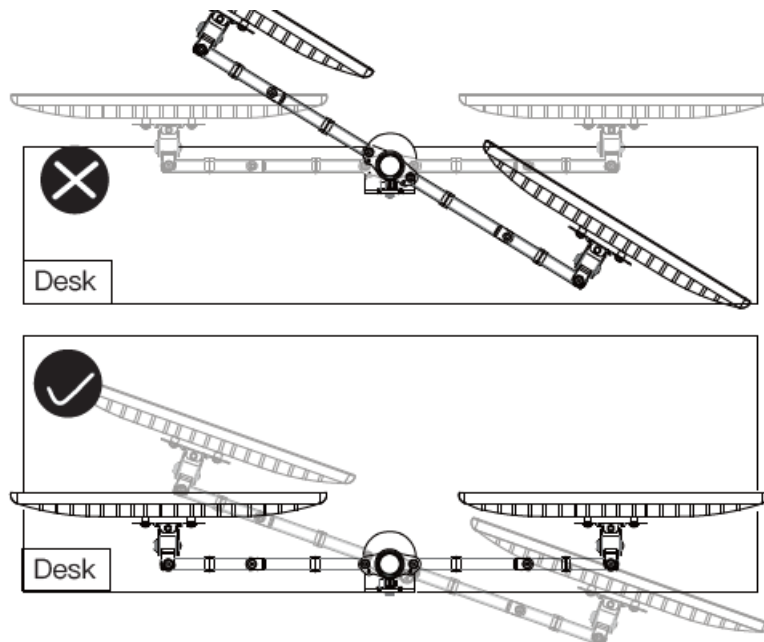

Product dimensions

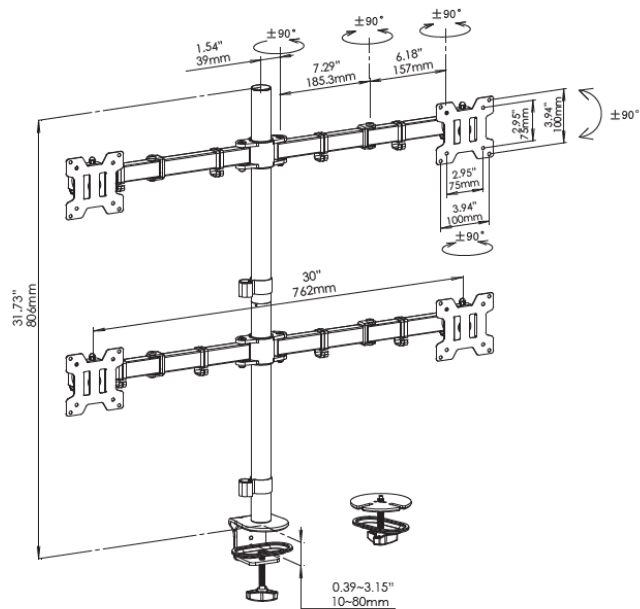

Documents / Resources

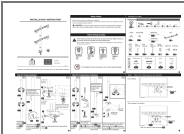

[StarTech DA-4L Quad Monitor Stand](#) [pdf] Instruction Manual

DA-4L Quad Monitor Stand, DA-4L, Quad Monitor Stand, Monitor Stand, Stand

References

- [User Manual](#)