



StarTech com ADJ-TABLET-STAND-W Universal Tablet Desk Stand User Guide

[Home](#) » [StarTech.com](#) » StarTech com ADJ-TABLET-STAND-W Universal Tablet Desk Stand User Guide 

StarTech com ADJ-TABLET-STAND-W Universal Tablet Desk Stand User Guide



Contents

- [1 Product Diagram \(ADJ-TABLET-STAND-W\)](#)
- [2 Package Contents](#)
- [3 Operation](#)
- [4 Warranty Information](#)
- [5 Support](#)
- [6 Documents / Resources](#)
 - [6.1 References](#)
- [7 Related Posts](#)

Product Diagram (ADJ-TABLET-STAND-W)

Front View

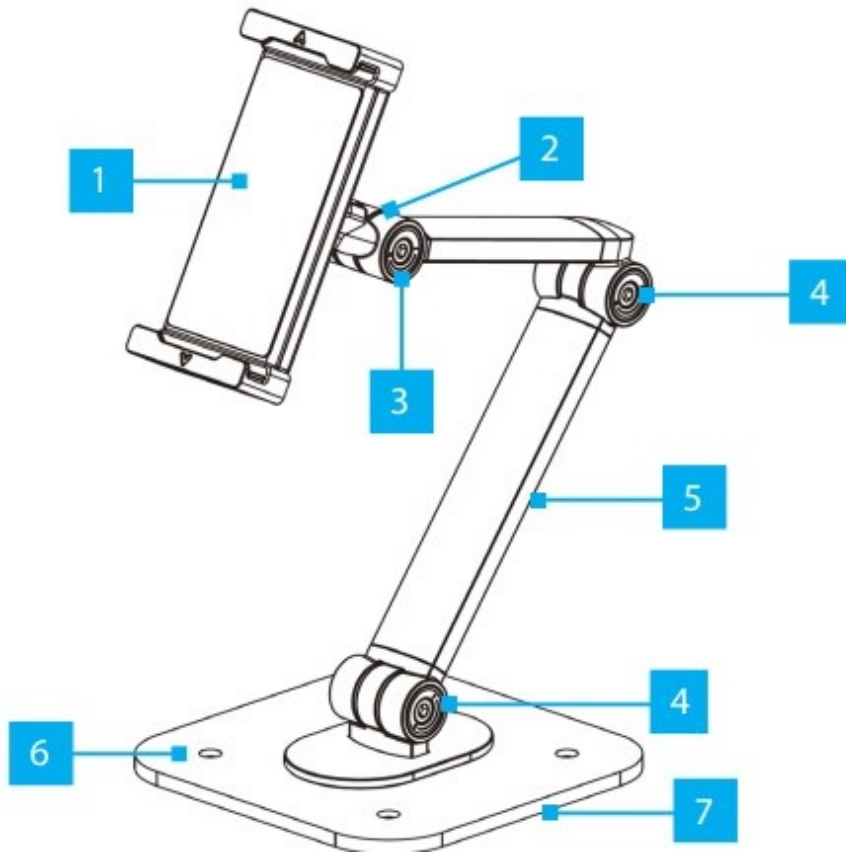

Product may vary from image

Component		Function
1	Clamp	<ul style="list-style-type: none"> For up to 12.9 in Tablets. Holders on either side support the Tablet in place Width range from 5 to 8 in (12.8 to 22.4 cm) Maximum thickness 0.4 in (1.1 cm) Allow to rotate 360°, up and down, and side to side
2	Rotation Adjustment Knob	<ul style="list-style-type: none"> Varies the Rotation resistance of the Clamp or fixes it on a specific position
3	Clamp Tilt Adjustment Screw	<ul style="list-style-type: none"> Adjust the Resistance of the Tilt Angle of the Clamp
4	Support Arm Tilt Adjustment Screws	<ul style="list-style-type: none"> Adjust the Resistance of the Tilt Angle of the Upper and Lower sections of the Support Arm
5	Support Arm	<ul style="list-style-type: none"> Supports the weight of the Tablet and provides Height and Tilt Adjustment
6	Mounting Holes	<ul style="list-style-type: none"> Allow to fix the Tablet Stand on a permanent location
7	Base	<ul style="list-style-type: none"> Supports the Assembly in place. Foam Pads at the bottom protect the desk or table surface

Package Contents

- Tablet Stand x 1
- 4.2×19 mm Wood Screws x 4
- 3 mm Hex Key x 1
- 5 mm Hex Key x 1
- Quick-Start Guide x 1

Requirements

For the latest manuals, product information, technical specifications, and declarations of conformance, please visit: www.startech.com/ADJ-TABLET-STAND-W

- Phillips head screwdriver

Operation

WARNINGS

Do not exceed the weight capacity of this product. Overloading this product might result in injury or property damage. This product can support the following weight: up to 2.2 lb (1 kg).

When adjusting the tilt or height of this product, ensure that the mounted equipment is properly secured and the weight is fully supported. Failure to follow these guidelines may result in property damage and/or personal injury.

When not fixed to a surface, always use two hands to ensure a controlled movement when adjusting the height or tilt angle of this product to prevent tipping it over.

Is recommended to remove any protective case from the Tablet to fit properly on the Holders.

1. Slide the Holders outwards to make enough room to mount the Tablet Vertically on the Clamp. If the Tablet is Small enough, it can be mounted Horizontally too.
2. Insert one side of the Tablet on one of the Holders. Keep Supporting the weight of the Tablet .
3. Slide Inwards the remaining Holder to secure the Table in place. **Figure 1.**

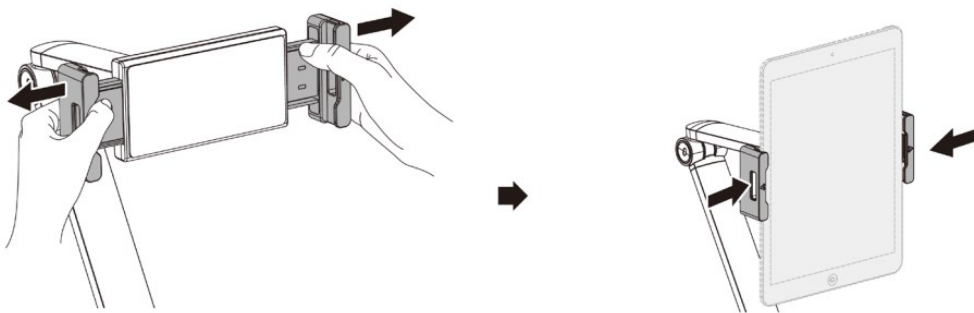

Figure 1

Adjust the Rotation Resistance of the Clamp

1. Rotate Clockwise to Tighten the Resistance Knob at the back of the Clamp. The right resistance allows the Clamp to rotate 360°, up and down, and side to side while keeping its position when the Tablet is in use.

Adjust the Tension of the Clamp Tilt

1. Use the 5 mm Hex Key and rotate Clockwise to Increase the Resistance. The right Resistance allows the Clamp to rotate up and down while keeping its position when the Tablet is in use.

Adjust the Tension of the Support Arm Tilt

1. Use the 5 mm Hex Key to tune one or two of the Support Arm Tilt Adjustment Screws. Rotate Clockwise to Increase the Resistance

Attach the Tablet Stand to a Desk

May need pilot holes before mounting the Tablet Stand.

The supplied Wood Screws may not be suitable if they are longer than the thickness of the mounting surface.

1. Insert the 4.2×19 mm Wood Screws (x 4) onto the Mounting Holes (x 4) on the Base.
2. Use a Phillips Head Screwdriver to fasten the 4.2×19 mm Wood Screws to the Desk or Table.

(Optional) Secure the Support Arm onto the Base

1. If the Screws at the bottom of the Base come loose, use the 3 mm Hex Key to Tighten them. Rotate Clockwise to Tighten.

Use of Trademarks, Registered Trademarks, and other Protected Names and Symbols

This manual may make reference to trademarks, registered trademarks, and other protected names and/or symbols of third-party companies not related in any way to StarTech.com. Where they occur these references are for illustrative purposes only and do not represent an endorsement of a product or service by StarTech. com, or an endorsement of the product(s) to which this manual applies by the third party company in question. StarTech.com hereby acknowledges that all trademarks, registered trademarks, service marks, and other protected names and/or symbols contained in this manual and related documents are the property of their respective holders.

Warranty Information

This product is backed by a 5-year warranty. For further information on product warranty terms and conditions, please refer to www.startech.com/warranty

Limitation of Liability

In no event shall the liability of StarTech.com Ltd. and StarTech.com USA LLP (or their officers, directors, employees or agents) for any damages (whether direct or indirect, special, punitive, incidental, consequential, or otherwise), loss of profits, loss of business, or any pecuniary loss, arising out of or related to the use of the product exceed the actual price paid for the product. Some states do not allow the exclusion or limitation of incidental or consequential damages. If such laws apply, the limitations or exclusions contained in this statement may not apply to you.

Safety Measures

- Read the entire manual and ensure the instructions are fully understood before assembling and/or using this product.

Support

StarTech.com Ltd.

45 Artisans Crescent
London, Ontario
N5V 5E9
Canada

StarTech.com LLP

4490 South Hamilton Road
Groveport, Ohio
43125
U.S.A.

[StarTech.com](#) Ltd.

Unit B, Pinnacle 15
Gowerton Road
Brackmills, Northampton
NN4 7BW
United Kingdom

[StarTech.com](#) Ltd.

Siriusdreef 17-27
2132 WT Hoofddorp
The Netherlands

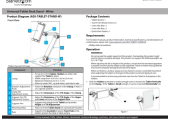

Documents / Resources

	<p>StarTech.com ADJ-TABLET-STAND-W Universal Tablet Desk Stand [pdf] User Guide ADJ-TABLET-STAND-W Universal Tablet Desk Stand, ADJ-TABLET-STAND-W, Universal Table t Desk Stand, Tablet Desk Stand, Desk Stand, Stand</p>
---	---

References

- [StarTech.com | IT Pro's Trusted Source for Connectivity Accessories](#)
- [Adjustable Tablet Stand, Articulating - Tablet Mounts | StarTech.com](#)
- [StarTech.com Support](#)
- [StarTech.com Warranty Policy](#)

Manuals+.