

# STARLINK Masonry Routing Kit Installation Guide

[Home](#) » [Starlink](#) » STARLINK Masonry Routing Kit Installation Guide 

## Contents

- [1 STARLINK Masonry Routing Kit](#)
- [2 INSTALLATION CONDITIONS](#)
- [3 SETUP](#)
- [4 Box Contents](#)
- [5 Install Instructions](#)
- [6 Documents / Resources](#)
  - [6.1 References](#)
- [7 Related Posts](#)

# STARLINK

**STARLINK Masonry Routing Kit**

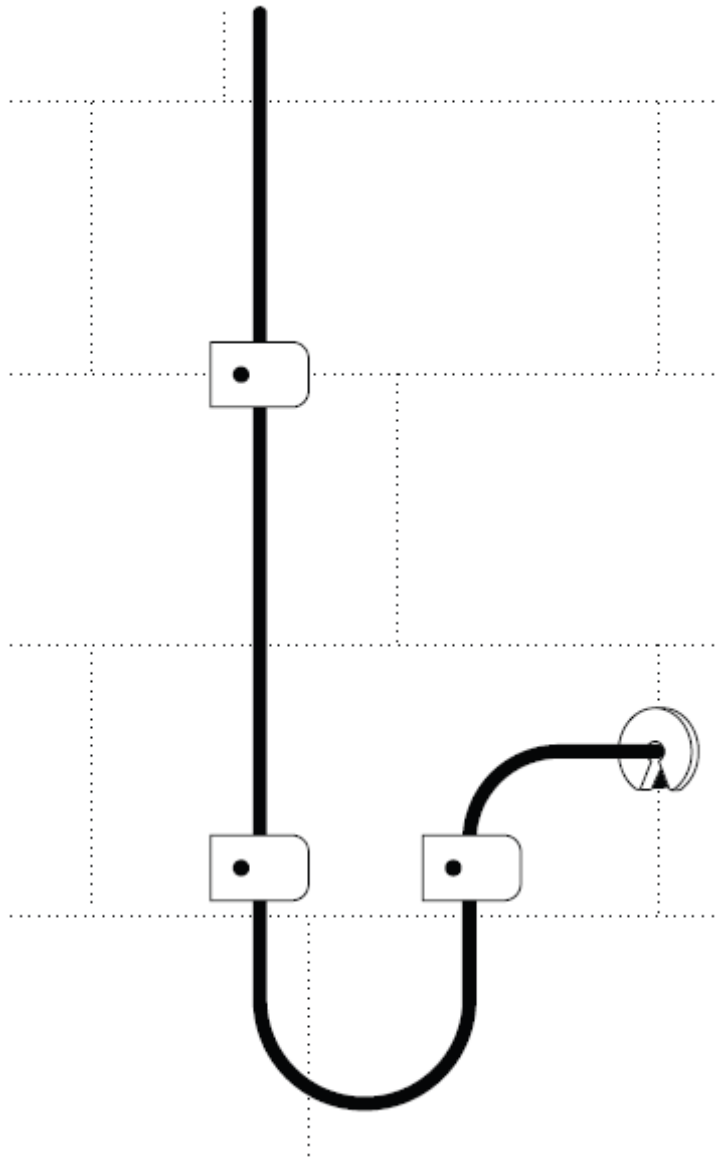

If you are uncomfortable with any part of the installation process, do not attempt – contact a professional to install your Starlink. Starlink is not responsible for injury or damage caused to property due to the installation process. Please be aware that inclement weather (e.g., heavy rain, snow, or wind) can affect your satellite internet connection, potentially leading to slower speeds or a rare outage.

The Starlink will detect and melt snow that falls directly on it; however, accumulating snow around the Starlink may block the field of view. We recommend installing Starlink in a location that avoids snow build-up and other obstructions from blocking the field of view.

If your Starlink App displays a “Motors Stuck” alert, your Starlink may be mounted in a way that it cannot reach its optimal angle to connect with the satellites. We advise mounting your Starlink within 35 degrees of vertical.

Mounting your Starlink in a horizontal position (e.g., on the side of your chimney), will not allow it to operate.

## INSTALLATION CONDITIONS

**WARNING!** The power supply and router are restricted to indoor use only.

**WARNING!** Mounts are not designed for high winds or hurricane/tornado wind loads. Tethering should be used in all cases to prevent failure in an unexpected wind event.

## SAFETY NOTICES

**WARNING!** To reduce the risk of injury, electric shock, or fire, follow basic safety precautions, including:

- Make sure the product's power is disconnected before accessing, moving, or installing the Starlink (aka "Dishy McFlatface"). Starlink contains moving parts when powered on
- Plug the power cord into an AC outlet that is easily accessible at all times. If the power cord has a 3-pin attachment, plug the cord into a grounded (earthed) 3-pin outlet.
- Only use the AC adapter and power cord provided with the system or purchased from SpaceX.
- Do not operate this product with a damaged power cord set. If the power cord is damaged, replace before using this product.
- During operation, do not allow the AC adapter to contact skin or a soft surface, such as carpet/rug or clothing. The product and the AC adapter comply with the user- accessible surface temperature limits defined by applicable safety standards.
- Avoid using this product during an electrical storm. There is a remote risk of electric shock from lightning.
- Do not operate this product if you notice crackling, hissing, popping sounds, a strong odor, or smoke coming from any parts of the system. Turn off the system, disconnect from power source, and contact Starlink technical support for assistance.
- **WARNING!** To avoid injury to persons and damage to property when drilling, take caution and follow basic safety procedures, including:
  - Wear appropriate eye, hand, and face protection.
  - Avoid studs, electrical wiring, and water lines when drilling. Drilling into any of these can lead to fire, shock, injury, or death.
  - Drill at a slight downward angle from the home interior to the home exterior and thoroughly apply sealant. Improper drilling and sealing may lead to water and/or bug intrusion and/or damage.

## Lightning Protection

If Starlink is used in a lightning-prone area, an external lightning protection system (lightning rod, ground rod, surge protector, etc.) may reduce product susceptibility to lightning. For added protection during a lightning storm, or when it is left unattended and unused for long periods of time, unplug the product from the wall AC outlet and disconnect the antenna cable. This may prevent damage to the product from lightning and power line surges.

**The warranty does not cover damage due to:**

- Lightning, electrical surges, fires, floods, hail, windstorms, earthquakes, meteors, solar storms, dinosaurs or other forces of Nature.
- Accident, misuse, abuse or alterations.
- Improper or neglected maintenance.

For more safety, regulatory, labeling, and disposal information, refer to the Regulatory Notices in the main internet kit.

The information contained herein is subject to change without notice. SpaceX shall not be liable for technical or editorial errors or omissions contained herein.

## SETUP



1. Download the Starlink app on your phone.
2. Before installation, use the “Check for Obstructions” tool in the app to identify the best location for uninterrupted service.
3. Setup your Starlink.
4. After connecting, confirm your setup location is obstruction-free by reviewing the data coming from your Starlink.
5. Additional app features: customize settings, receive updates, troubleshoot issues, and contact Support.

## **Box Contents**

- Spade Bit
- Ethernet Cable Routing Tool
- 1" Drill Bit
- 1/4" Drill Bit

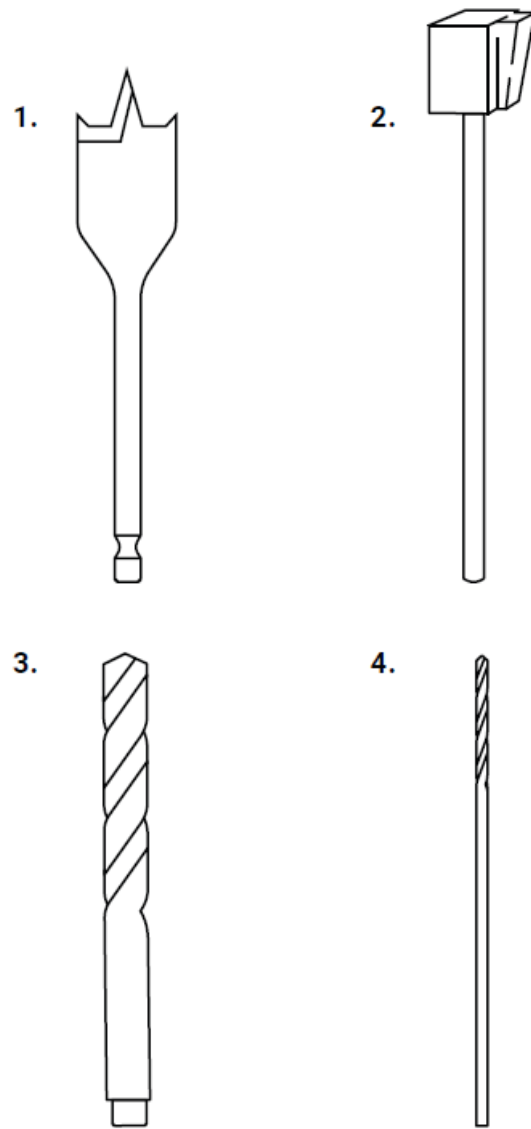

- Silicone Sealant
- Anchors (x5)
- Grommets (X2)
- Cable Clips (x5)

5.

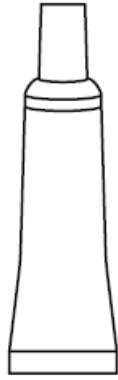

6.



7.



8.

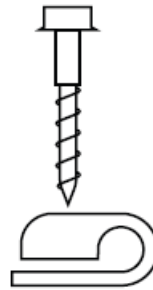

#### **Additional Items Needed**

- Hammer
- Phillips Head Drill Bit
- Hammer Drill
- Stud/Electrical Finder\*

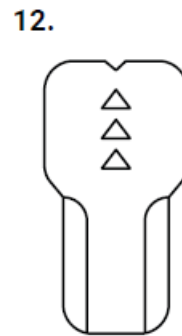
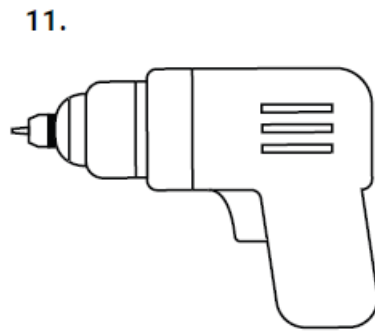
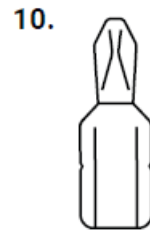
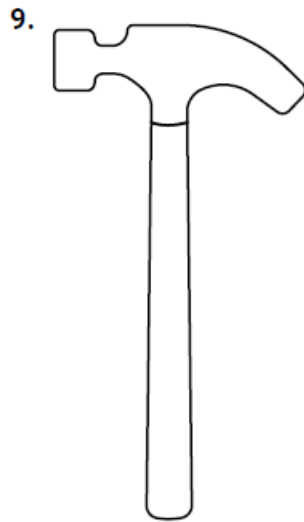

- Goggles, Gloves, & Mask

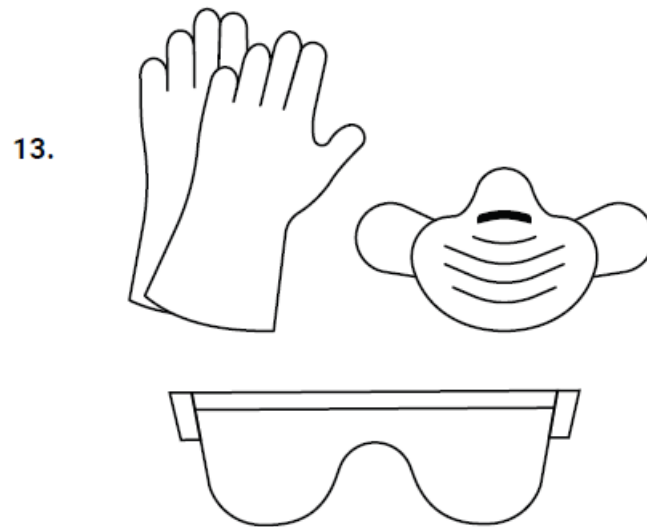

## Install Instructions

Do not drill through studs, pipes or electrical wiring. Before you drill, consider using an electrical / stud finder to avoid pipework and wires. Avoid drilling near power outlets and light switches.

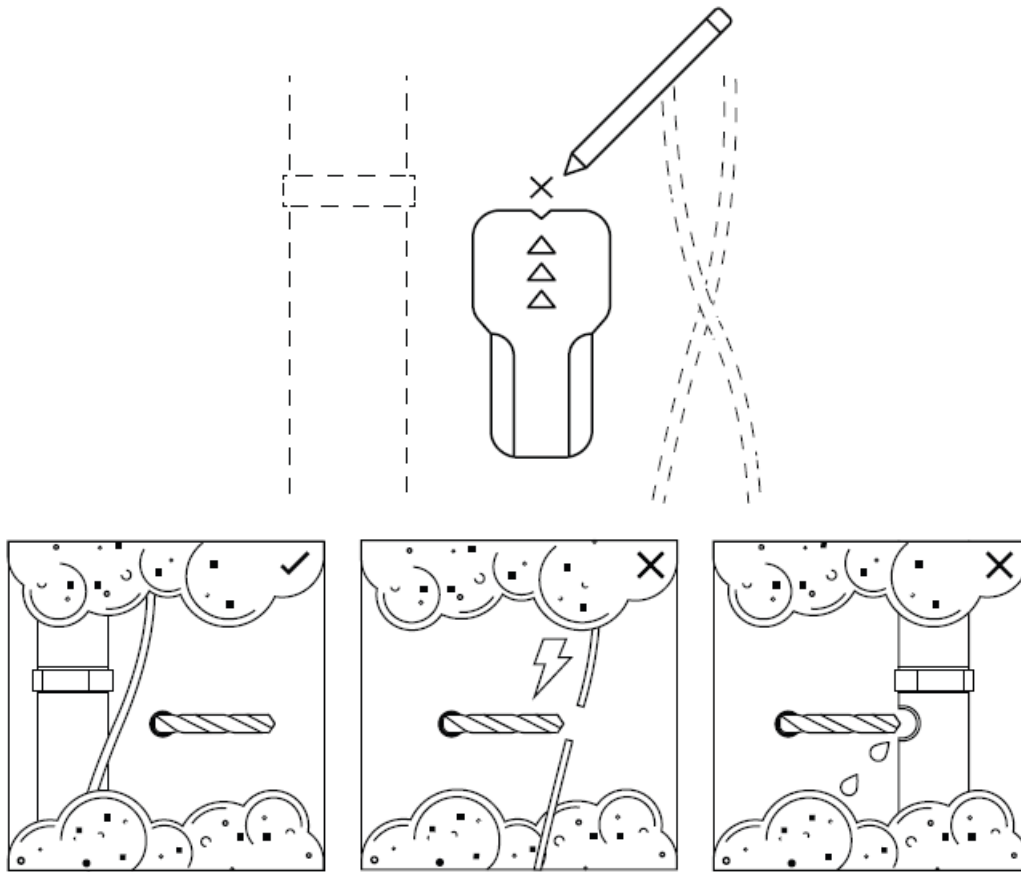

1. Set drill to Hammer Mode /Low Power to start.
2. Use provided 1/4" masonry drill bit to drill starter hole at a slight upward angle from the outside all the way through the inside of the structure.
3. Once the bit penetrates through masonry surface, switch to Rotary Mode and reduce power/speed.



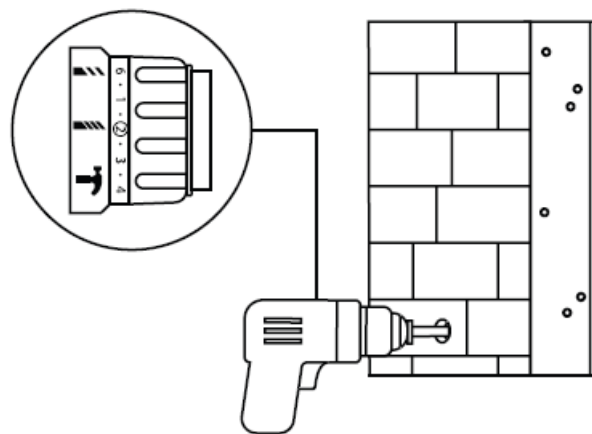
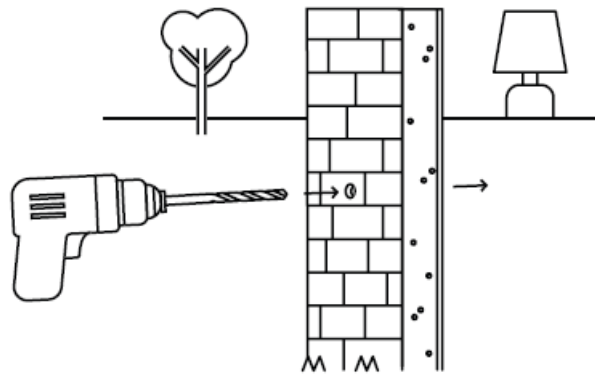
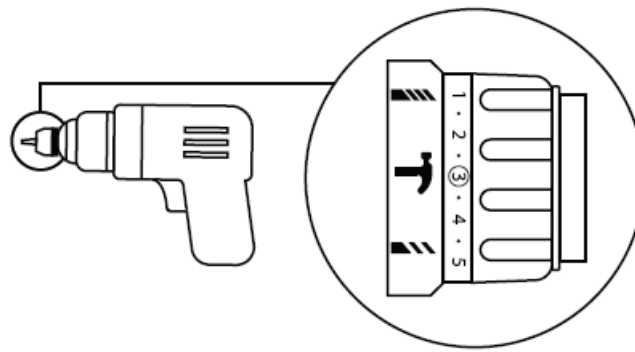

4. Switch the drill back to Hammer Mode and use the 1" drill bit to drill through the masonry.
5. If the interior is drywall, switch to Rotary Mode and use the spade bit to drill through the drywall. If the interior is masonry, continue using the 1" masonry bit in Hammer Mode to drill through the interior wall.

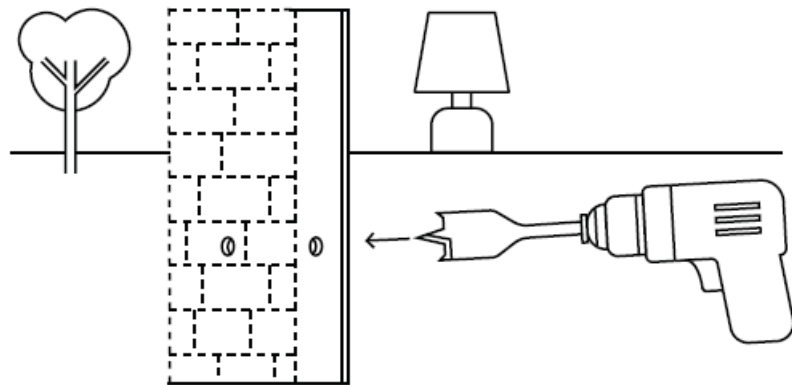
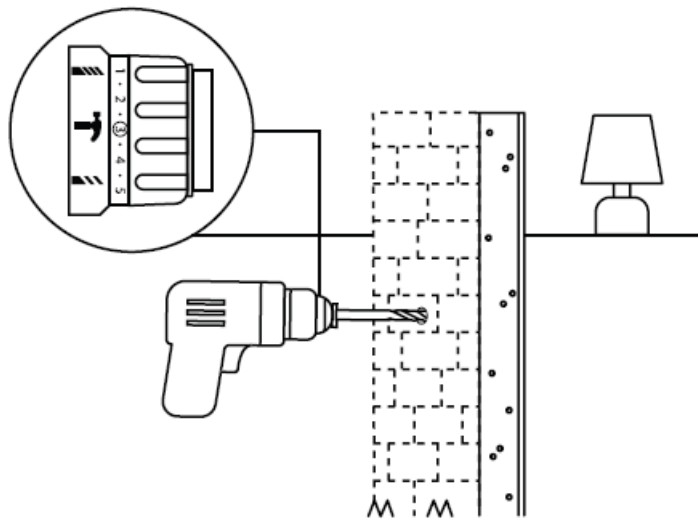

6. Clear out insulation with the available drill bits to ensure a clear path between the exterior and interior walls for cable routing.

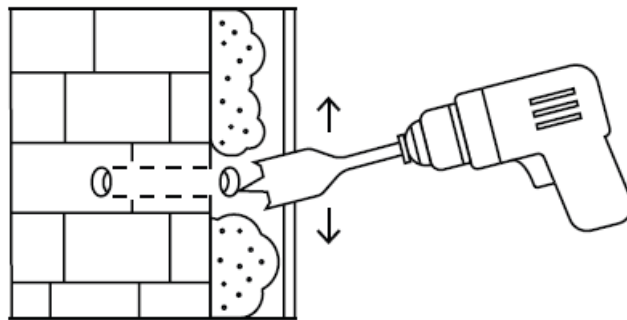

7. Use the ethernet cable routing tool to funnel your Starlink cable from outside to inside.

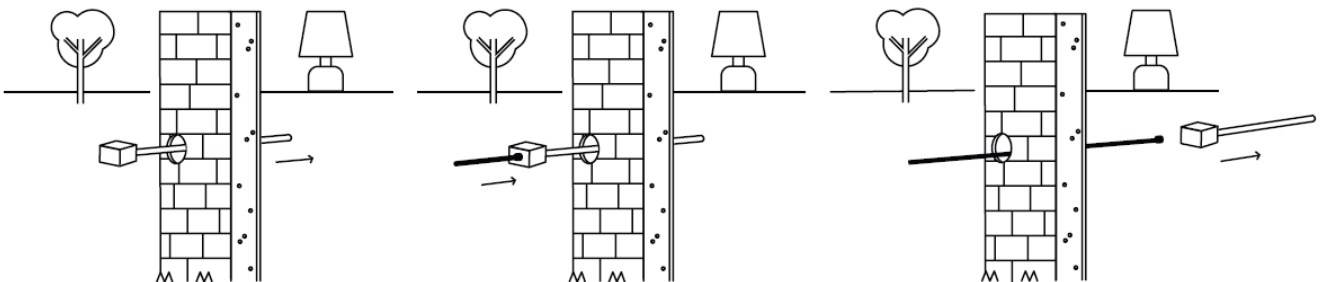

8. Use the provided  $\frac{1}{4}$ " masonry drill bit in Hammer Mode to drill three 1" deep holes into your wall at indicated locations for plastic anchors. Hammer plastic anchors into the wall.

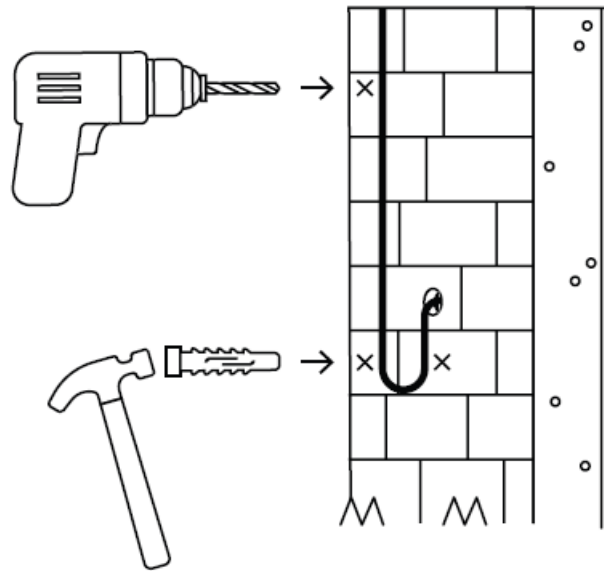

9. Install the provided grommets on both the exterior and interior wall.

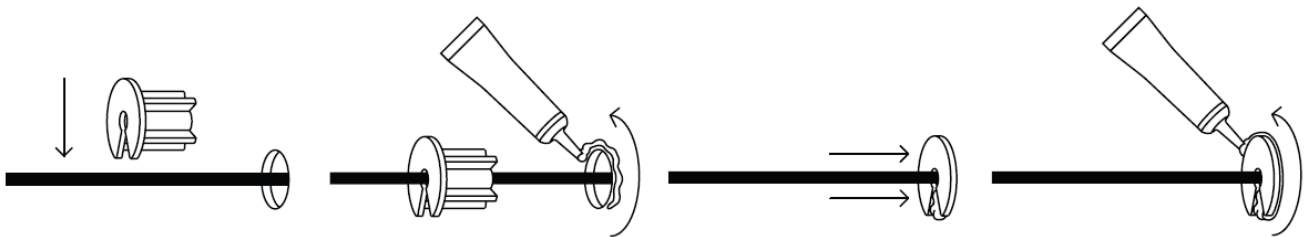

10. Use the cable clips as shown to secure your cable and avoid water damage. Place cable clip over wire. Align cable clip with screw over wall anchors. Screw cable clip into anchors.

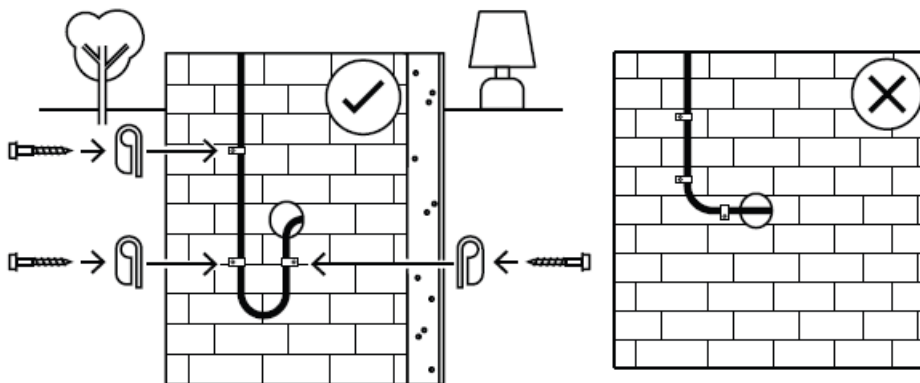

Starlink Masonry Routing Kit

starlink.com

©2021. Space Exploration Technologies Corp.

01475663-004/B

## Documents / Resources

	<p><a href="#">STARLINK Masonry Routing Kit</a> [pdf] Installation Guide Masonry Routing Kit, 211014</p>
-------------------------------------------------------------------------------------	--------------------------------------------------------------------------------------------------------------

## References

-  [Starlink](#)

Manuals+.