



starlab S7166-0010 ErgoOne Fast Pipette Controller User Manual

[Home](#) » [starlab](#) » starlab S7166-0010 ErgoOne Fast Pipette Controller User Manual 

starlab S7166-0010 ErgoOne Fast Pipette Controller



Contents

- 1 Removing the discharge protector
- 2 Battery status display
 - 2.1 Ready for operation:
 - 2.2 Charge battery:
- 3 Empty battery
- 4 Speed control
- 5 Documents / Resources
- 6 Related Posts

Removing the discharge protector

Prior to first usage please proceed as follows:

1. Slide the battery compartment lid open.

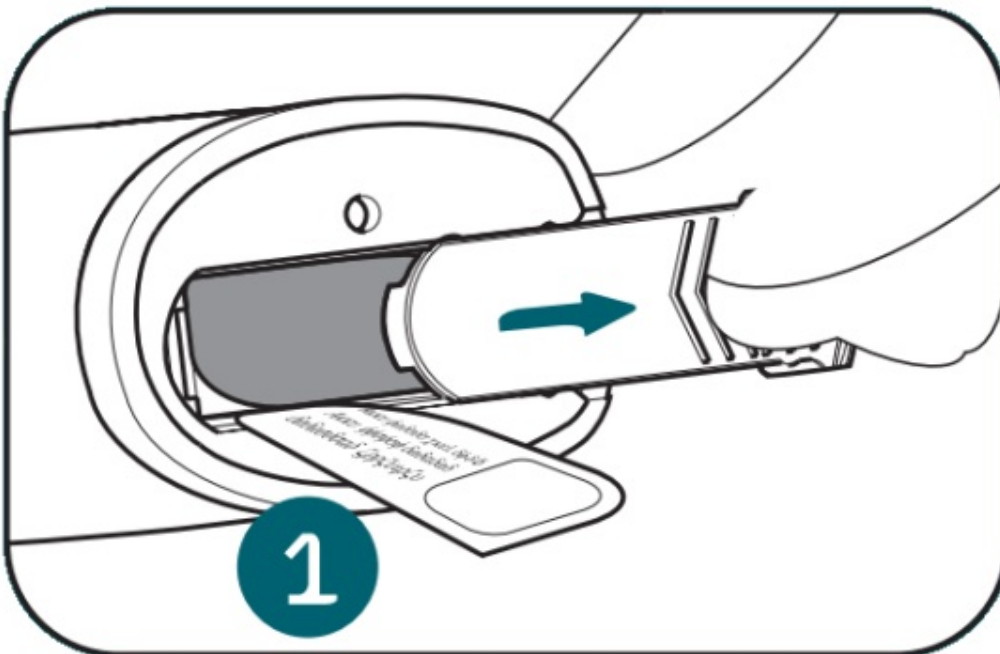

2. Remove the battery and discharge protection.

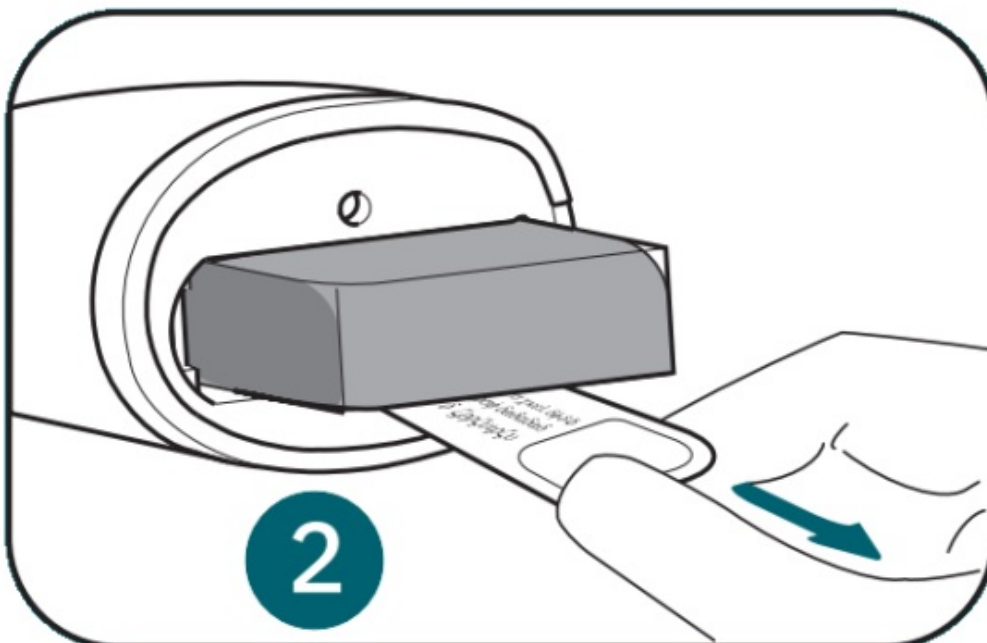

3. Install the battery and close the battery compartment lid.

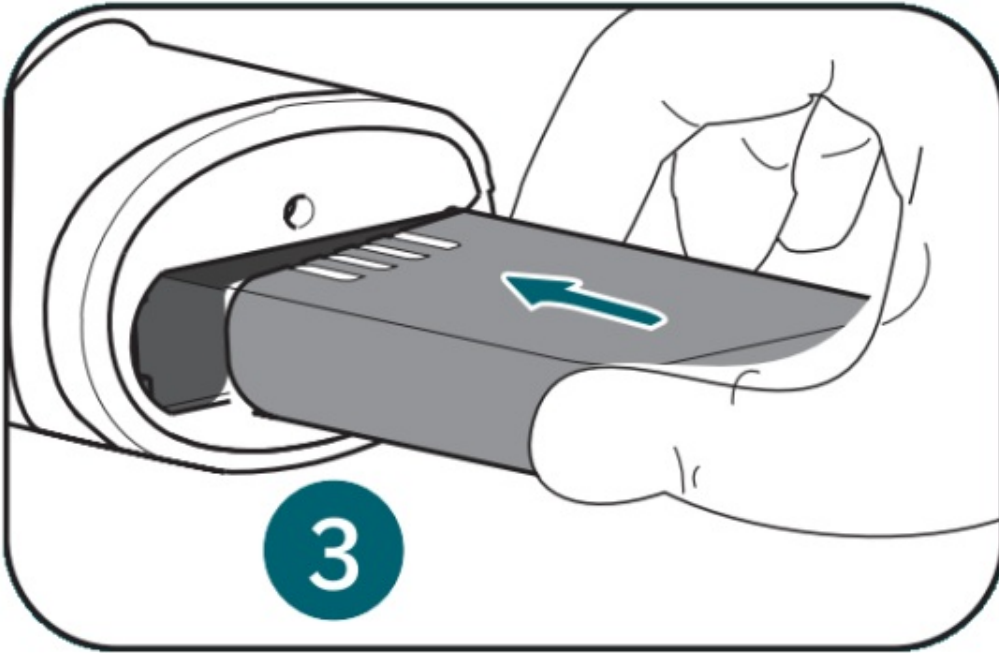

Battery status display

Ready for operation:

1. **Solid green light:**

The rechargeable battery is fully charged.

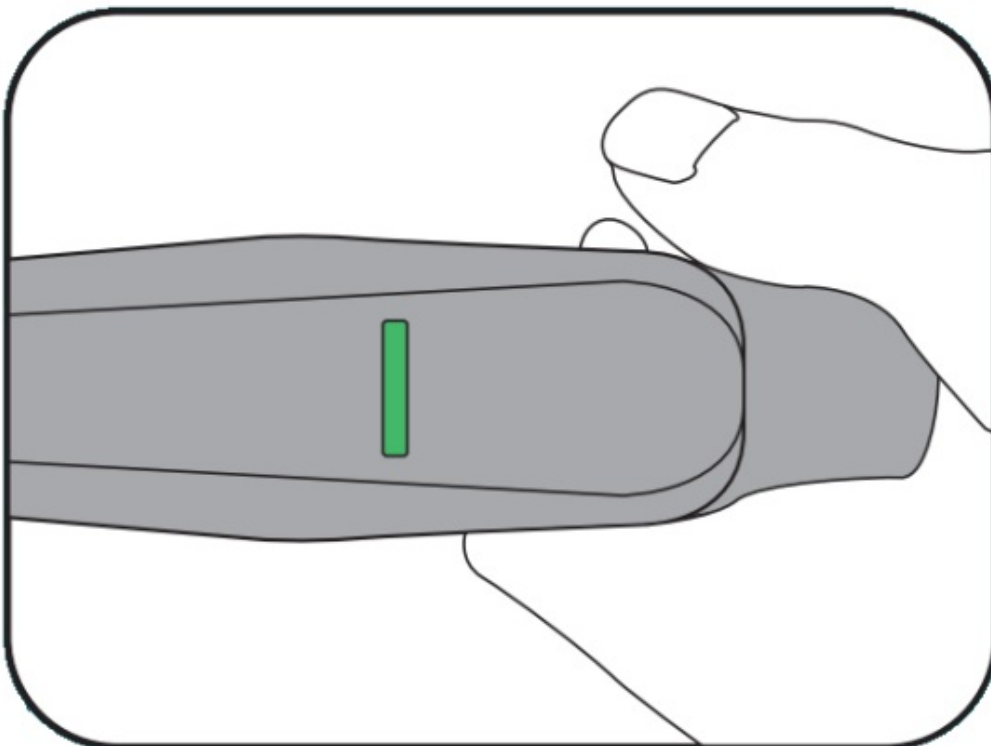

2. **Solid yellow light:**

The rechargeable battery is half-charged.

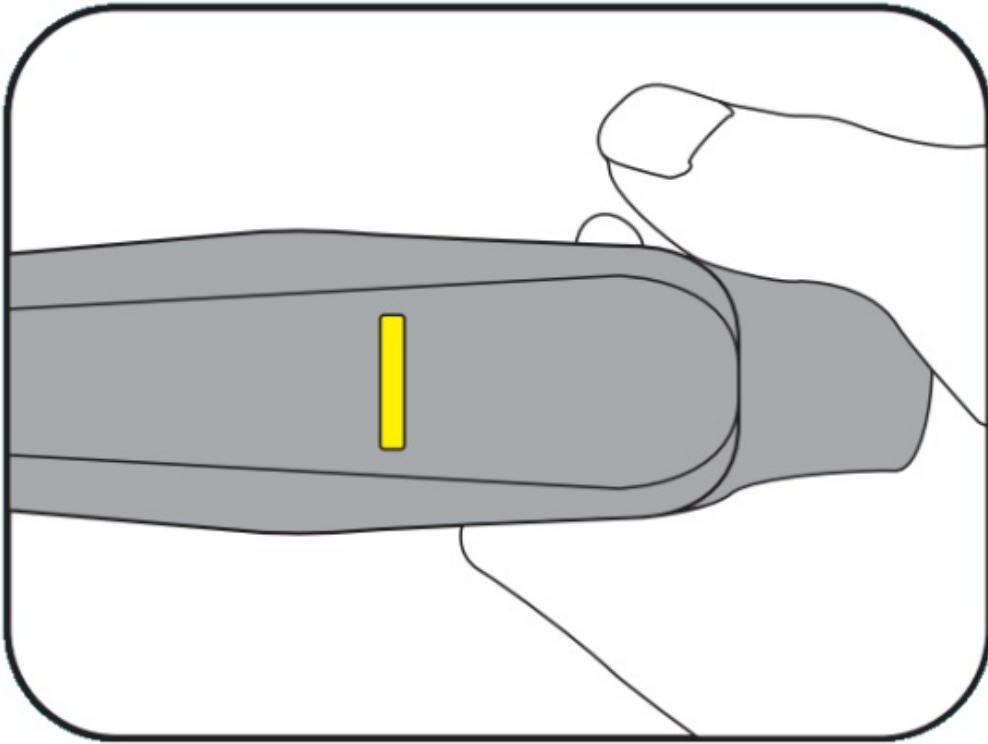

3. Solid red light:

The rechargeable battery is almost empty.

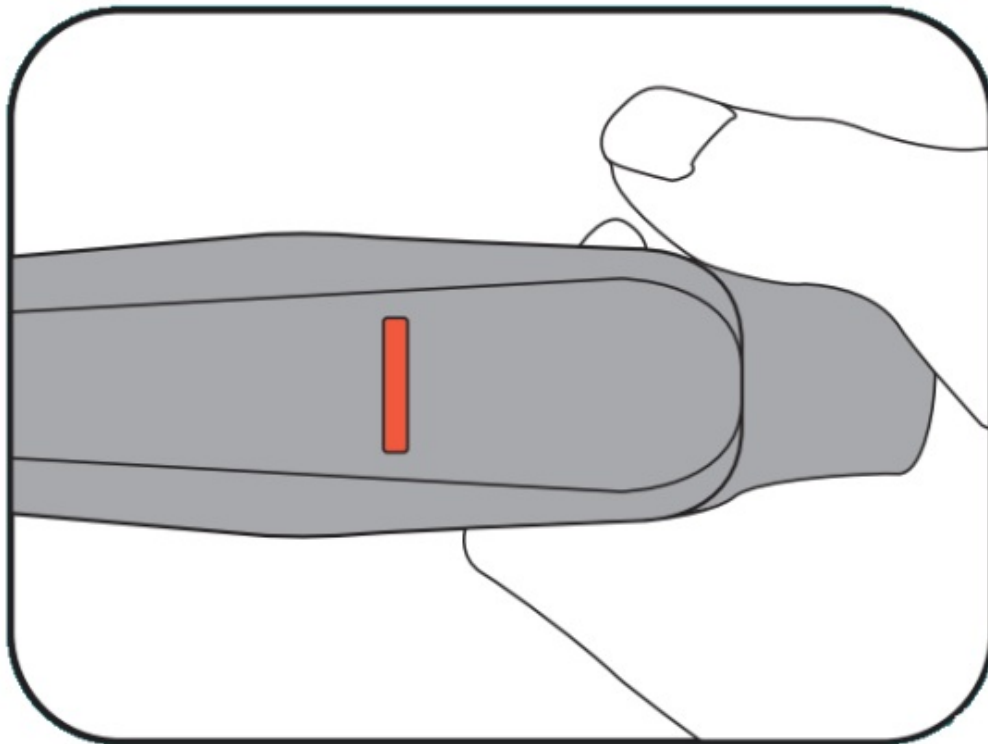

Charge battery:

- **Flashing red light:**

The rechargeable battery is <5% charged.

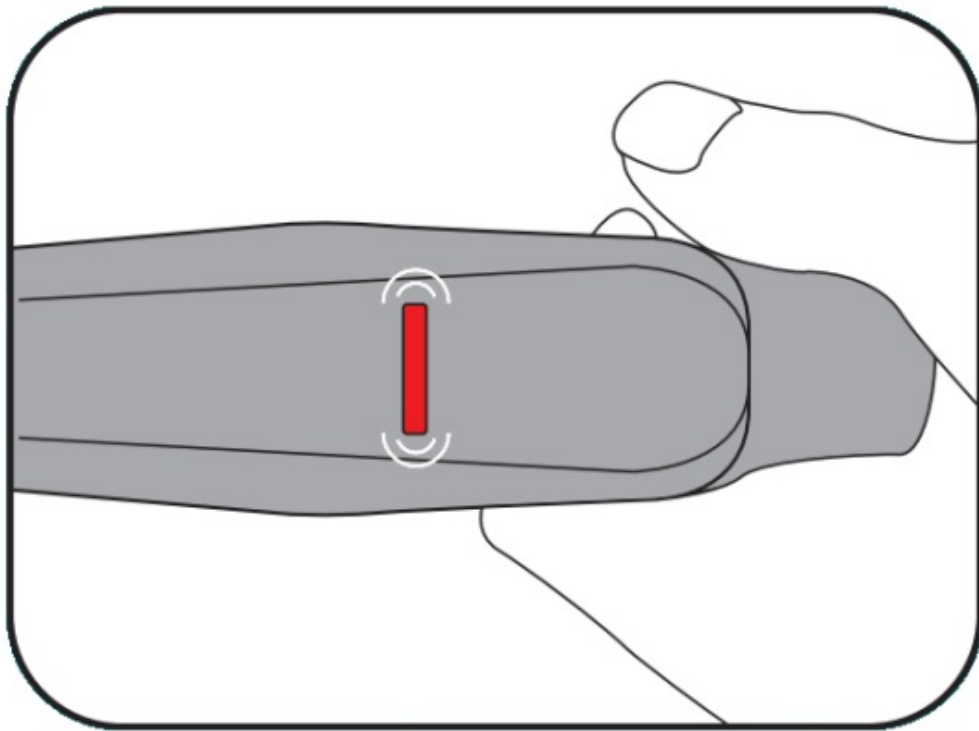

- **Flashing yellow light:**

The rechargeable battery is 5-60% charged.

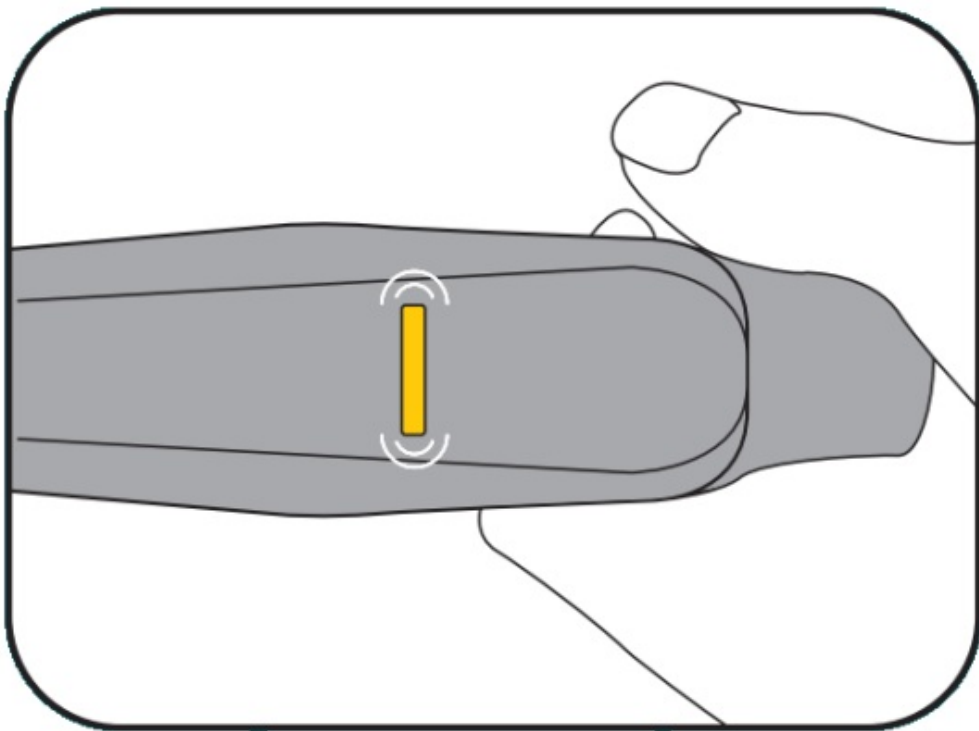

- **Flashing green light:**

The rechargeable battery is 60-99% charged.

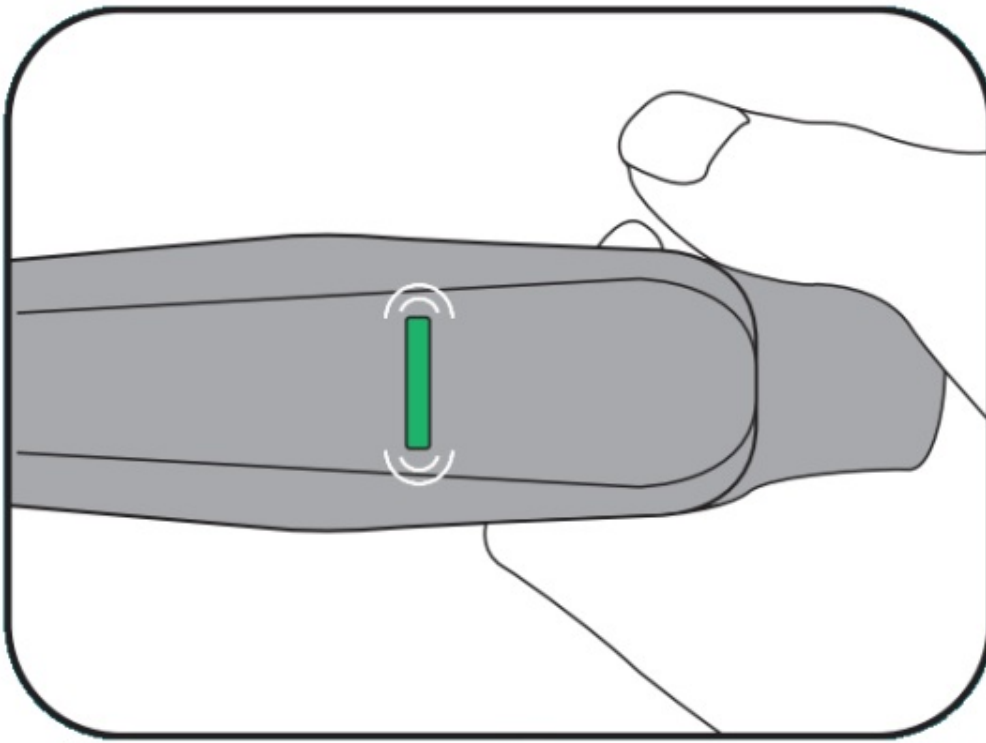

Empty battery

- **Flashing red light:**

The rechargeable battery needs to be charged.

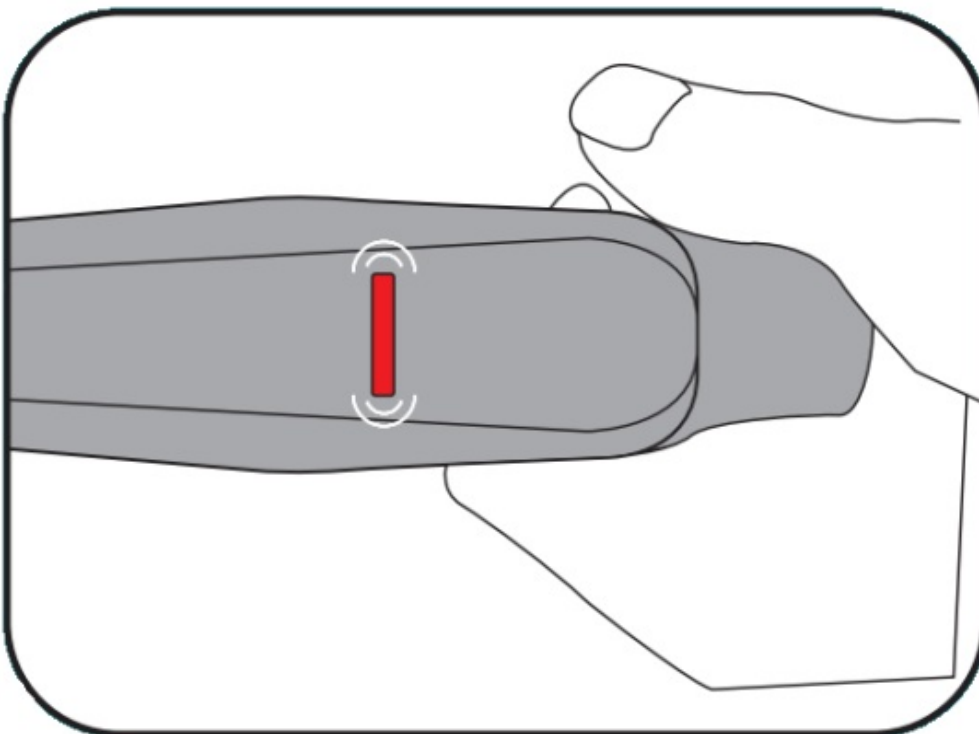

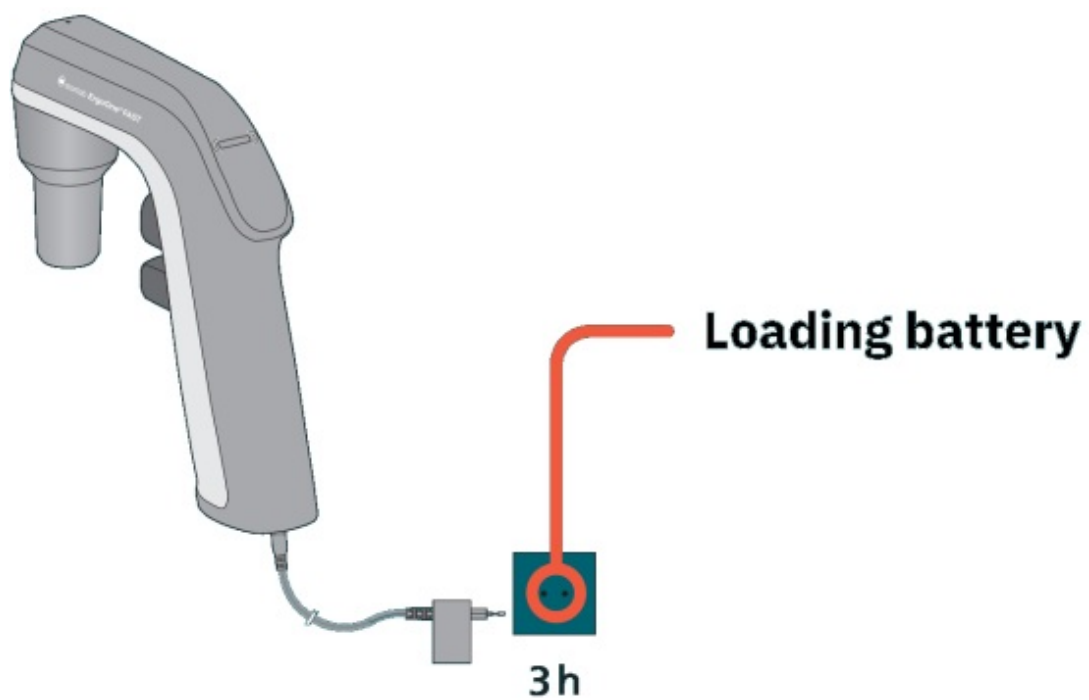

Speed control

The liquid aspiration speed is regulated continuously by controlling the pressure on the control buttons, i.e. how far in the button is pressed.

Slow aspiration

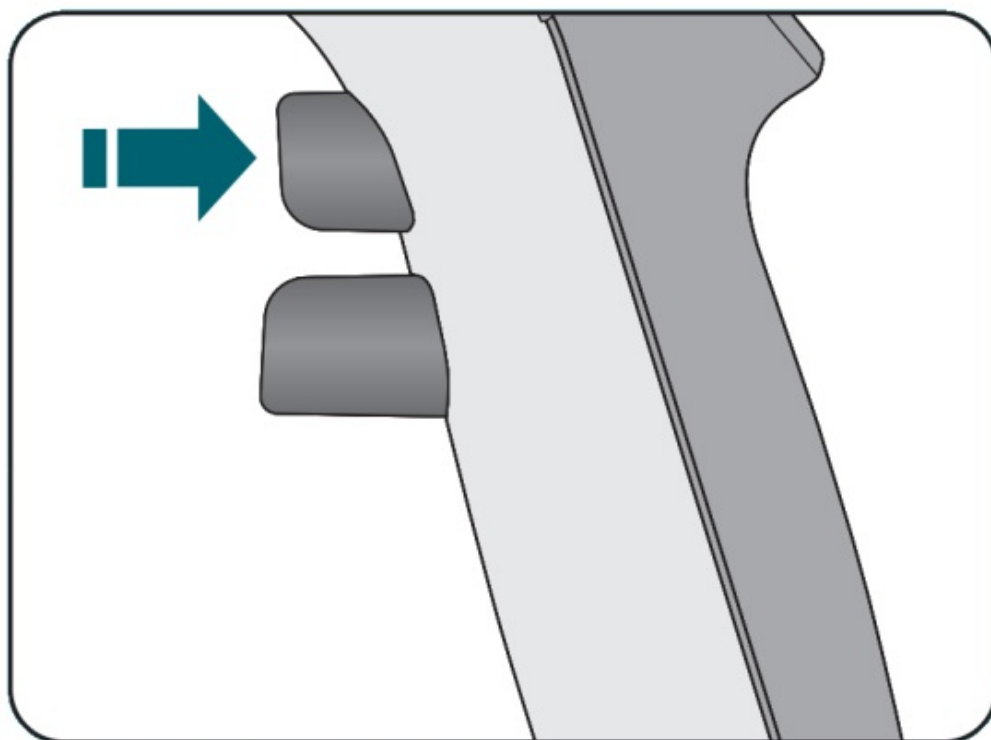

To slowly aspirate or dispense liquid, press the corresponding control button lightly.

Quickly aspirating

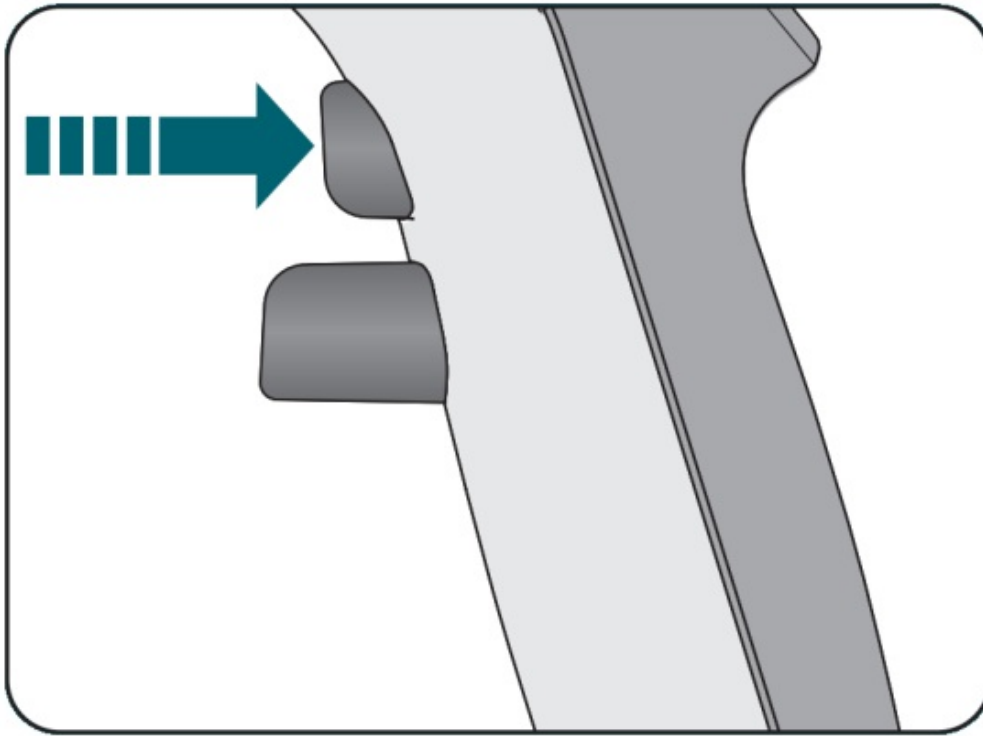

To quickly aspirate or dispense liquid, press the corresponding control button firmly.

Passionate for science.



Documents / Resources

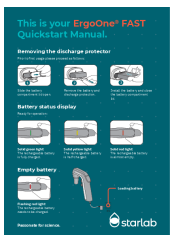

[starlab S7166-0010 ErgoOne Fast Pipette Controller](#) [pdf] User Manual
S7166-0010, ErgoOne Fast Pipette Controller