

Contents [[hide](#)][1 Starkey Audio Key 3 App Audio Link XT User Guide](#)[2 Pairing](#)[3 Documents / Resources](#)[3.1 References](#)

Starkey Audio Key 3 App Audio Link XT User Guide



Prior to pairing, each MED-EL device and hearing aid must be programmed by their respective software. Do not install the My Starkey app until after the devices have been paired in the AudioKey 3 app. If the My Starkey app is already installed on the patient's device, uninstall it and reinstall after successfully pairing with the MED-EL device.

Pairing

Please refer to www.medel.com/support for information on pairing MED-EL devices to the smartphone and the AudioKey 3 app. Hearing aid pairing should be completed after the hearing aid has been programmed in the Pro Fit software. Ensure that Pro Fit is

closed prior to pairing with any Apple device. The Apple device must be iOS 16.0 or higher

1. Select **Settings > Accessibility > Hearing Devices**.
2. Ensure Bluetooth® setting is on.
3. Power off, then power on the hearing aid to place in pairing mode.
4. Select the hearing aid when it appears on the screen.
5. When prompted, select **Pair**.
6. Ensure it says “**Connected**” after the hearing aid name.

MED-EL AudioKey 3 App Pairing

1. Select **Connectivity Options**.
2. Under **Hearing aids** select the applicable bimodal configuration.
3. Review the **Important Information**. Tap **Next** to continue.
4. Review the provided instructions for the hearing aid and MED-EL device.

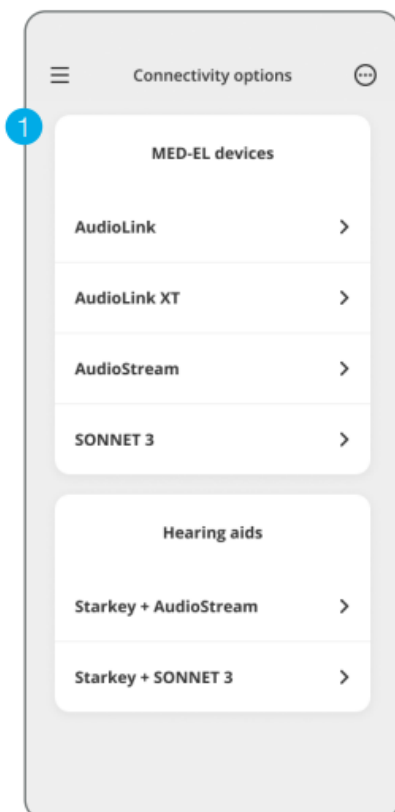

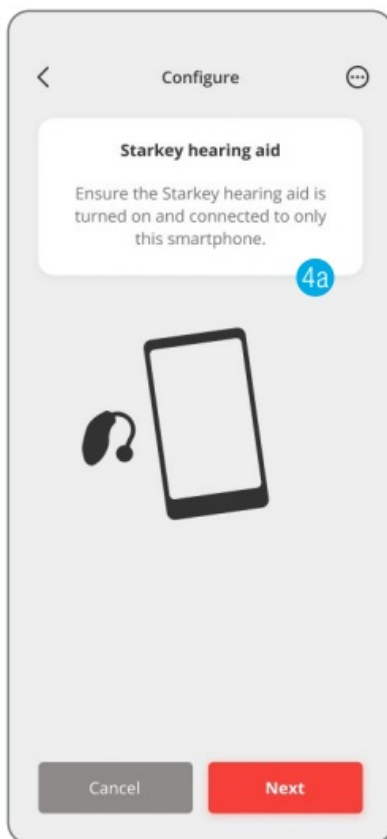
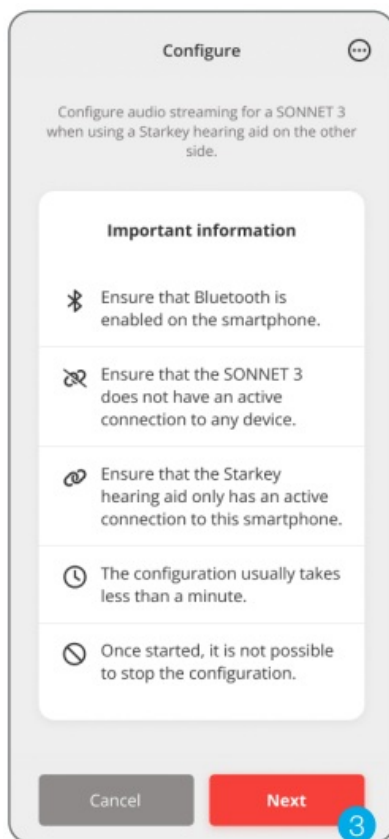

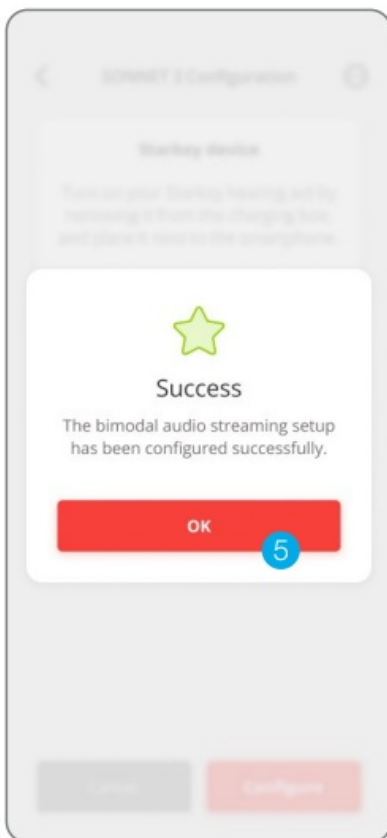
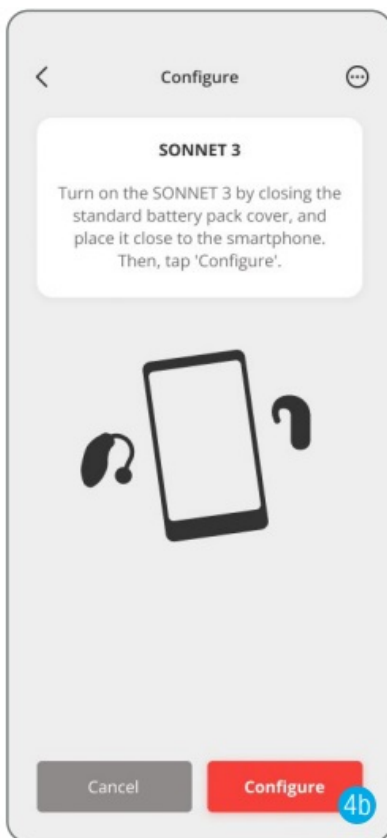

Tap **Configure** to start the configuration process.

5. A prompt will notify the user the bimodal audio streaming setup has been configured successfully. Select OK

Pairing (Continued)

Bimodal pairing with the AudioLink XT

1. Power off, then power on the hearing aid to place in pairing mode.
2. Place the hearing aid close to the AudioLink XT.
3. Power on the AudioLink XT by pressing the main button for approximately 2 seconds.
Only the status light should be active.
4. Place the AudioLink XT in pairing mode by pressing the telecoil and microphone buttons at the same time for approximately 2 seconds. The connection symbols will flash.
5. Once the hearing aid has been found, the connection symbol of the corresponding side turns on permanently while the other side double-flashes continuously.
6. Repeat steps with your audio processor. When the audio processor is found, AudioLink XT will also illuminate the second connection symbol permanently before it leaves pairing mode

MED-EL and AudioKey are trademarks of MED-EL Elektromedizinische Geräte Ges.m.b.H. The Bluetooth® word mark and logos are registered trademarks owned by Bluetooth SIG, Inc. Apple is a trademark of Apple, Inc. registered in the U.S. and other countries and regions.

Starkey logo and Pro Fit are trademarks of Starkey Laboratories, Inc. ©2025 Starkey Laboratories, Inc. All Rights Reserved 6/25 FLYR4372-01-EN-ST



Documents / Resources

	<p>Starkey Audio Key 3 App Audio Link XT [pdf] User Guide</p> <p>Audio Key 3 App Audio Link XT, App Audio Link XT, Audio Link XT</p>
---	--

References

- [User Manual](#)

🔑 App Audio Link XT, Audio Key 3 App Audio Link XT, Audio Link XT,

📁 Starkey Starkey

Leave a comment

Your email address will not be published. Required fields are marked *

Comment *

Name

Email

Website

☐ Save my name, email, and website in this browser for the next time I comment.

Post Comment

Search:

e.g. whirlpool wrf535swhz

Search

[Manuals+](#) | [Upload](#) | [Deep Search](#) | [Privacy Policy](#) | [@manuals.plus](#) | [YouTube](#)

This website is an independent publication and is neither affiliated with nor endorsed by any of the trademark owners. The "Bluetooth®" word mark and logos

are registered trademarks owned by Bluetooth SIG, Inc. The "Wi-Fi®" word mark and logos are registered trademarks owned by the Wi-Fi Alliance. Any use of these marks on this website does not imply any affiliation with or endorsement.