



stando Bag Hook Instruction Manual

[Home](#) » [stando](#) » stando Bag Hook Instruction Manual 

stando.

Bag Hook Instruction Manual

Contents

- [1 Bag Hook](#)
- [2 Documents / Resources](#)
 - [2.1 References](#)
- [3 Related Posts](#)

Bag Hook

Mounting Option 1: Hand Controller Holes

Fixing: Timber Screw

Using two timber screws, position the Bag Hook on the opposite side of your hand controller. Use a Phillips Head Screw Driver to tighten in place.

Alternatively you can mount this with your hand controller by mounting the hand controller over this and using the same 2 screws.

Mounting Option 2: Side Bracket

Fixing: Machine Screw

Remove either front, centre or rear side bracket machine screw installed on your desk.

Position where required and re-insert the screw.

You're now ready to hang your bag, headphone or crack open a cold drink!

If you wish to mount elsewhere, simply use an electric drill and drive 2 timber screws into the desk in your desired position.

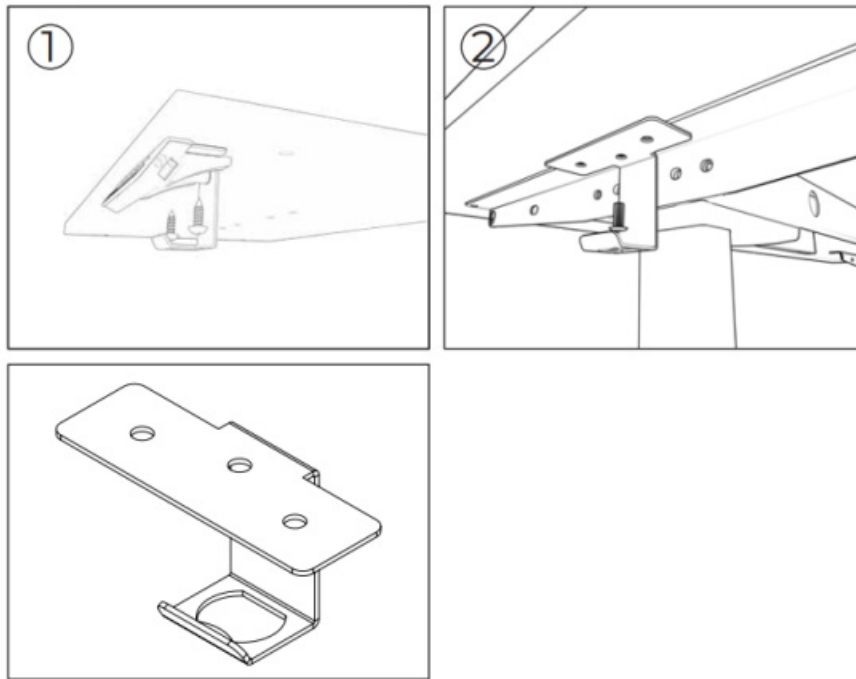

sales@stando.com.au

Phone: 07 3520 7273

www.stando.com.au

Documents / Resources

	<p>stando Bag Hook [pdf] Instruction Manual Bag Hook, Bag, Hook</p>
--	-----------------------------------------------------------------------------------------

References

- [S Ergonomic Office Furniture Australia | Stando.](#)
- [User Manual](#)

Manuals+. Privacy Policy

This website is an independent publication and is neither affiliated with nor endorsed by any of the trademark owners. The "Bluetooth®" word mark and logos are registered trademarks owned by Bluetooth SIG, Inc. The "Wi-Fi®" word mark and logos are registered trademarks owned by the Wi-Fi Alliance. Any use of these marks on this website does not imply any affiliation with or endorsement.