

STAHL 133084 Ex i Junction Boxes Installation Guide

[Home](#) » [STAHL](#) » STAHL 133084 Ex i Junction Boxes Installation Guide 

Contents

- [1 STAHL 133084 Ex i Junction Boxes](#)
- [2 Technical Data](#)
- [3 Accessories](#)
- [4 Documents / Resources](#)
 - [4.1 References](#)
- [5 Related Posts](#)



STAHL 133084 Ex i Junction Boxes

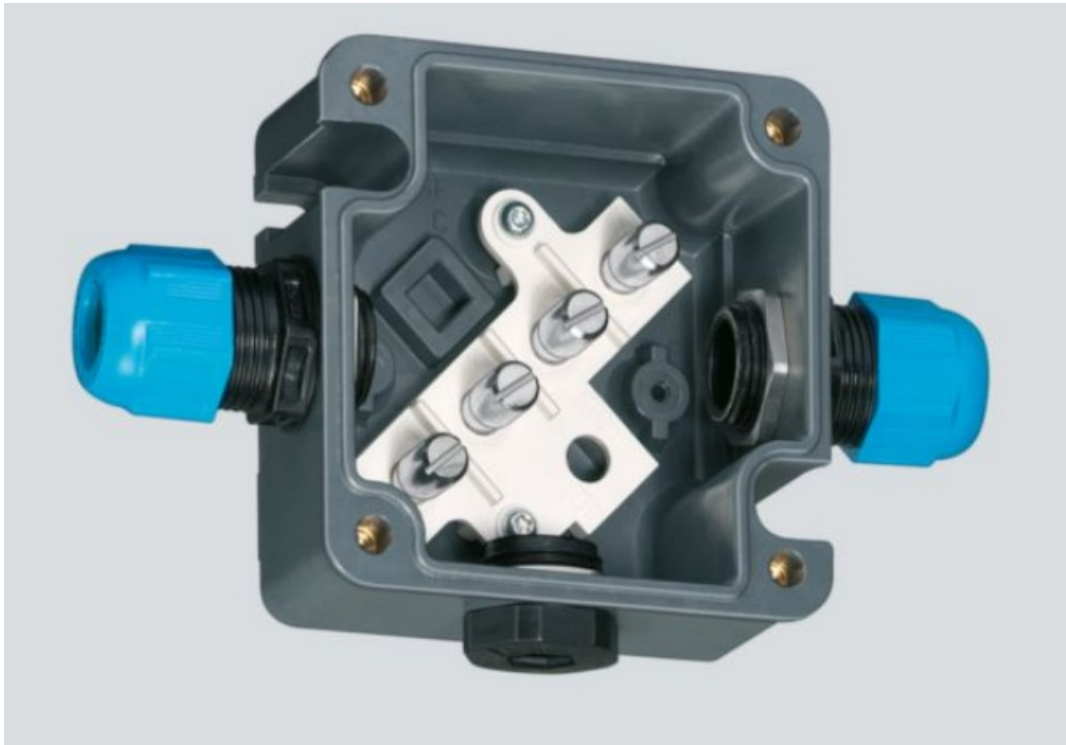

- Resistant Ex e enclosure, universally usable as connection or junction boxes and/ or to safeguard electric distributors up to 6.3 A
- IP66 degree of protection
- With mantle terminals or with a combination of mantle terminals and miniature fuses (optional)

WebCode 8118A

R. STAHL Series 8118 junction boxes are equipped with 4, 5 or 8 mantle terminals depending on their design size. As an option, miniature fuses can still be installed in addition. Junction boxes are therefore also suitable for safeguarding. The robust enclosure made from glass fibre reinforced polyester resin can be equipped with plastic or metal cable glands.

Technical Data

Explosion Protection	
Scope of validity	European Union (ATEX) IECEx
Application range (zones)	1 2 21 22
IECEX gas certificate	IECEX PTB 06.0026
IECEX gas explosion protection	Ex ia ib IIC T6 Gb
IECEX dust certificate	IECEX PTB 06.0026
IECEX dust explosion protection	Ex tb IIIC T80 °C Db
ATEX gas certificate	PTB 99 ATEX 3103
ATEX gas explosion protection	E II 2 G Ex ia ib IIC T6 Gb
ATEX dust certificate	PTB 99 ATEX 3103
ATEX dust explosion protection	E II 2 D Ex tb IIIC T80 °C Db
Certificates	ATEX (PTB), Brazil (ULB), China (NEPSI), EAC (ENDCE), IECEx (PTB)
Ship approval	BVIS
Explosion protection note	For product label, see scope of validity.
Electrical Data	
Permissible rated operational current with 5 loaded terminals	for conductor cross-section 1.5 mm ² : 13 A for conductor cross-section 2.5 mm ² : 18 A for conductor cross-section 4 mm ² : 24 A
Permissible rated operational current with 4 loaded terminals	for conductor cross-section 1.5 mm ² : 15 A for conductor cross-section 2.5 mm ² : 19 A for conductor cross-section 4 mm ² : 25 A
Permissible rated operational current with ≤ 3 loaded terminals	for conductor cross-section 1.5 mm ² : 16 A for conductor cross-section 2.5 mm ² : 20 A for conductor cross-section 4 mm ² : 25 A
Ambient Conditions	
Ambient temperature	-40 °C ... +75 °C (T6)

Ambient Conditions	
Ambient temperature	-40°F ... +167°F (T6)
Mechanical Data	
IP degree of protection (IEC 60529)	IP66
Enclosure material	Polyester resin, Glass fibre reinforced

Enclosure colour	Dark grey
Flammability according to	IEC/EN 60695 UL 94 ASTM D635
Silicone-free	No
Connection cross-section	4 mm ²
Permissible number of conductors per clamping unit, solid	mantle terminal M7 x 0.75 conductor cross-section 1.5 mm ² : number of conductors min. 2, max. 4 conductor cross-section 2.5 mm ² : number of conductors min. 2, max. 2
Permissible number of conductors per clamping unit, finely stranded prepared, core end sleeve crimped	mantle terminal M7 x 0.75 conductor cross-section 1.5 mm ² : number of conductors min. 2, max. 3 conductor cross-section 2.5 mm ² : number of conductors min. 2, max. 2
Permissible number of conductors per clamping unit, finely stranded unprepared	mantle terminal M7 x 0.75 conductor cross-section 1.5 mm ² : number of conductors min. 2, max. 3 conductor cross-section 2.5 mm ² : number of conductors min. 2, max. 2
Permissible number of conductors per clamping unit note	All conductors of a terminal must have identical cross sections and identical material.
Cover	Screw-on cover
Cover fixing type	M4 stainless steel screws, With captive screws
Width	85 mm
Width, inches	3.35 in
Height	85 mm
Height, inches	3.35 in
Depth	55 mm
Depth, inches	2.17 in
Packaging unit	1
Weight	0.28 kg
Weight	0.62 lb
Mounting / Installation	
Tightening torque of cover screw 1	1.4 Nm
Cover screw 1 tightening torque lbf in	12.4 lbf in
Components	

Entry 1	2 x 8161/8-M20-1304 (Provided separately)
Entry 1 type	Polyamide cable gland, blue
Entry 1	M20 x 1.5
Entry 1 terminal area	4 – 13 mm
Entry 1 clamping range, inch	0.16 – 0.51 in
Metal entry possible 1	No
Entry 2	1 x 8290/3-M20 (Provided separately)
Entry 2 type	Polyamide stopping plug
Entry 2	M20 x 1.5

Components

- **Metal entry possible 2** No
- **Entries installation options/ side** Size 1: 3x M20 (A+B+D)
- **Type of terminals 1** 4 x Mantle terminal 4 mm²

Technical Drawings – Subject to Alterations

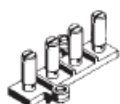

4 terminals

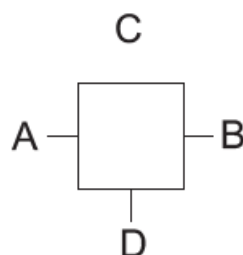

"—" = marking installation possibilities

Dimensional Drawings (All Dimensions in mm [inches]) – Subject to Alterations

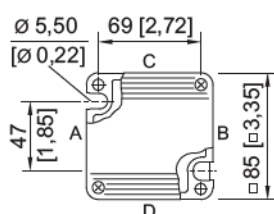
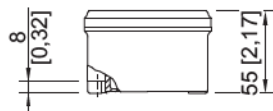

8118/1.
enclosure size 1

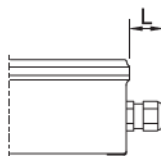

Length L

protrusion length for cable glands, Series 8161

in case of M20: 25 ... 31 [0.98 ... 1.22]

in case of M25: 27 ... 33 [1.06 ... 1.3]

in case of M32: 32 ... 39 [1.26 ... 1.54]

protrusion length for cable glands with strain relief,
Series HSK-K-MZ

in case of M25: 41 [1,61]

Accessories



Cable gland made of plastic

	8161/8-M20-1304, Ex i Plastic, M20 x 1.5, cable outer diameter 4 to 13 mm Lot size 50 pieces	239164
---	---	--------

Stopping plug

	8290/3-M20 Plastic, M20 x 1.5 Lot size 100 pieces	285773
---	--	--------

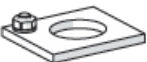
Brass plate with thread

	8118 size 1, plate 37 x 30 mm [1.46 x 1.18"] 1 x M20 x 1.5 with M4 PE connection (left) for installation in enclosure size 1, size 2 and size 3	168913
	8118 size 1, plate 37 x 30 mm [1.46 x 1.18"] 1 x M20 x 1.5 with M4 PE connection (right) for installation in enclosure size 1, size 2 and size 3	168914

We reserve the right to make alterations to the technical data, dimensions, weights, designs and products available without notice. The illustrations cannot be considered binding.



2022-11-25 R. STAHL Schaltgeräte GmbH | Am Bahnhof 30 | 74638 WALDENBURG

Tel. +49 7942 943 1700 | +49 7942 943 1777 | Email: sales.de@r-stahl.com | r-stahl.com

Documents / Resources

	STAHL 133084 Ex i Junction Boxes [pdf] Installation Guide 133084 Ex i Junction Boxes, 133084, Ex i Junction Boxes, Junction Boxes, Boxes
---	---

References

-  [R. STAHL | Explosion Hazard Systems | Industrial Explosion Protection](#)
-  [You will find a little bit of Stahl chemistry everywhere](#)

Manuals+.