

Stadler Form

**Jasmine aroma
diffuser**



Stadler Form Jasmine aroma diffuser Instruction Manual

[Home](#) » [Stadler Form](#) » Stadler Form Jasmine aroma diffuser Instruction Manual 

Contents

- [1 Stadler Form Jasmine aroma diffuser](#)
- [2 FAQ](#)
- [3 Product Information](#)
- [4 Description of the appliance](#)
- [5 Mode](#)
- [6 Important safety instructions](#)
- [7 Setting up / operation](#)
- [8 Cleaning](#)
- [9 Repairs](#)
- [10 Specifications](#)
- [11 Documents / Resources](#)
 - [11.1 References](#)

Stadler Form

Stadler Form Jasmine aroma diffuser

**Specifications:**

- Rated voltage: 12 V
- Power output: 7.2 W
- Dimensions: 130 x 90 x 130 mm (width x height x depth)
- Weight: 0.4 kg
- Tank capacity: 100 ml
- Sound level: < 26 dB(A)
- Complies with EU regulations: CE / WEEE / RoHS / EAC

Product Usage Instructions**Description of the Appliance:**

The appliance consists of the following main components:

1. Mist outlet/lid
2. Base/water container
3. Maximum mark
4. Ultrasonic membrane
5. On/off switch
6. Switch for interval mode
7. Status LED light
8. Interval LED light
9. Connection for network adapter
10. Network adapter
11. Air outlet opening (Caution: no water may enter this opening!)

Setting up / Operation:

1. Place Jasmine on a flat surface at the desired location.
2. Connect the network adapter to the appliance.
3. Fill the water container with water and add a few drops of your preferred essential oil.
4. Turn on the appliance using the on/off switch.

Cleaning and Maintenance:

If you wish to change the fragrance, empty Jasmine completely, clean the water container with a damp cloth, refill it with water, and add new drops of essential oil following the instructions.

FAQ

- **Q: How do I change the fragrance in Jasmine?**

- A: To change the fragrance, empty Jasmine completely, clean the water container with a damp cloth, refill it with water, and add new drops of essential oil following the instructions.

- **Q: What should I do if water enters the air outlet opening?**

- A: Ensure no water enters the air outlet opening as it may damage the appliance. If water enters accidentally, turn off the appliance immediately and allow it to dry thoroughly before using it again.

Product Information

Congratulations! You have just purchased the exceptional JASMINE aroma diffuser. It will bring you a great deal of pleasure and improve the ambient air for you. As with all domestic electrical appliances, particular care is needed with this model also, in order to avoid injury, fire damage or damage to the appliance. Please study these operating instructions carefully before using the appliance for the first time and follow the safety advice on the appliance itself.

Description of the appliance

The appliance consists of the following main components:

1. Mist outlet / lid
2. Base/water container
3. Maximum mark
4. Ultrasonic membrane
5. On/off switch
6. Switch for interval mode
7. Status LED light
8. Interval LED light
9. Connection for network adapter
10. Network adapter
11. Air outlet opening (Caution: no water may enter this opening!)

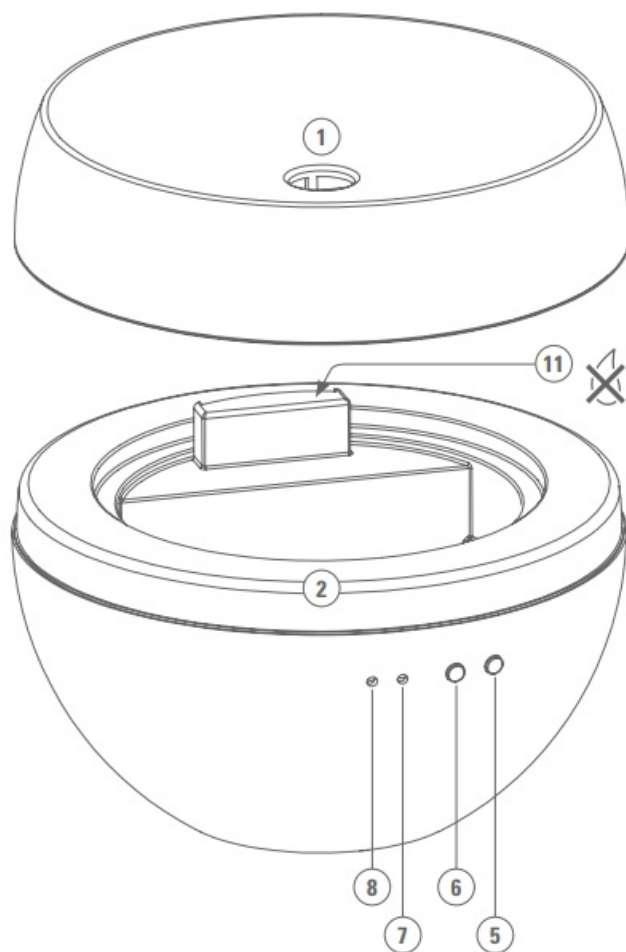

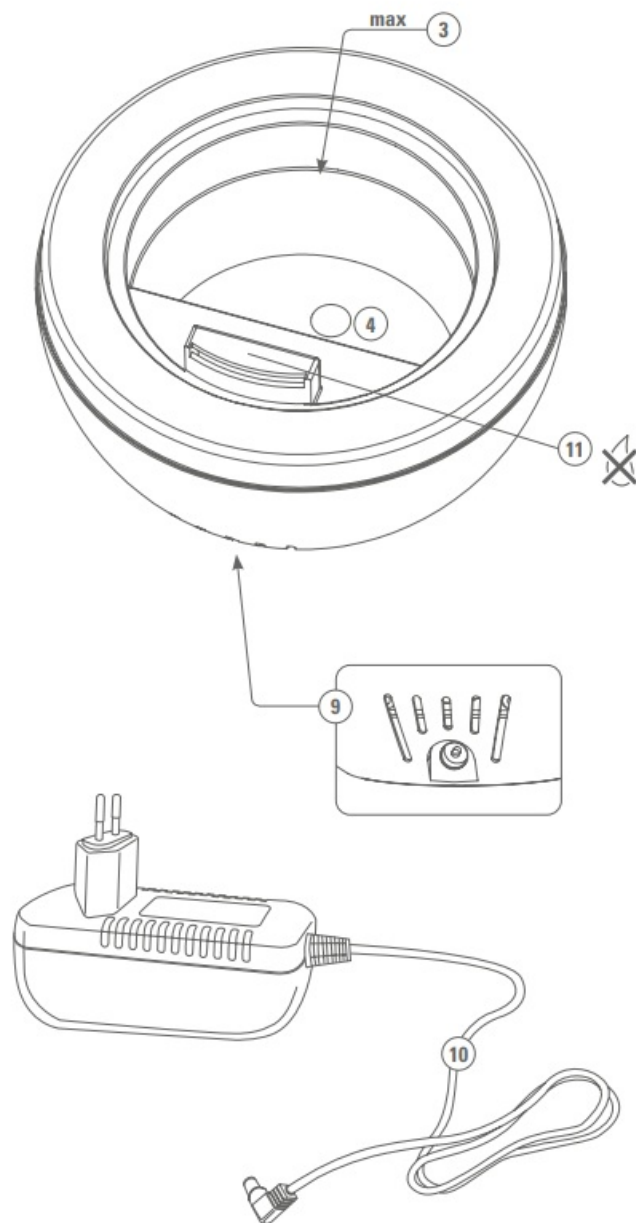

Mode

Continuous mode



Interval mode



Important safety instructions

Please read through the operating instructions carefully before you use the appliance for the first time and keep them safely for later reference; if necessary pass them on to the next owner.

- tadler Form refuses all liability for loss or damage that arises as a result of failure to follow these operating instructions.
- The appliance is only to be used in the home for the purposes described in these instructions. Unauthorized use and technical modifications to the appliance can lead to danger to life and health.
- This appliance can be used by children aged from 8 years and above and persons with reduced physical, sensory or mental capabilities or lack of experience and knowledge if they have been given supervision or instruction concerning use of the appliance in a safe way and understand the hazards involved. Children shall not play with the appliance. Cleaning and user maintenance shall not be made by children without supervision.
- Only connect the cable to the alternating current. Observe the voltage information given on the appliance.
- Do not use damaged extension cords.
- Do not run the power cord over sharp edges and make sure that it does not get trapped.
- Do not pull the plug from the socket with wet hands or by holding on to the power cord.
- Do not use the appliance in immediate vicinity of a bathtub, a shower or a swimming pool (observe a minimum distance of 3 m). Place the appliance such that a person in the bathtub cannot touch the appliance.
- Do not place the appliance near a heat source. Do not subject the power cord to direct heat (such as a heated hotplate, open flames, hot iron sole plates or heaters for example). Protect power cords from oil.
- See to it that the appliance is properly positioned to ensure a high stability during its operation and make sure that no one can trip over the power cord.
- The appliance is not splash-proof.
- For indoor use only.
- Do not store the appliance outdoors.
- Store the appliance in a dry place inaccessible to children (pack the appliance).
- If the power cord is damaged, it must be replaced by the manufacturer or a repair shop authorized by the manufacturer or by similarly qualified persons in order to avoid a hazard.
- Never leave water in the water container when the appliance is not in use.
- Clean the water container every 3 days
- Prior to any maintenance, cleaning and after each use, switch off the appliance and unplug the mains cable from the socket.
- Repairs to electrical appliances must only be carried out by a qualified electrical technician.

Setting up / operation

1. Place Jasmine at the desired location on a flat surface. Connect the network adapter (10) to the device and plug the adapter into a suitable socket.
2. Remove the lid (1) to fill with water and fragrance.
3. Fill the water container (2) up to the maximum mark (MAX) with water. No water may enter the air outlet opening (11). This will damage the appliance and will void any claim to the warranty. Important: please do not carry Jasmine around whilst it is filled with water. The water could run into the electronics.
4. Add 2–3 drops of your favourite liquid fragrance directly into the water. It is not necessary to mix them as the ultrasonic membrane (4) does this for you. If the fragrance is not intensely enough, you can increase the number of drops.
5. Close the lid (1) again.
6. Then start operating Jasmine by pressing the on/off switch (5). After doing this the white LED at the front will come on. If this does not happen, check whether there is sufficient water in the device or if the adapter is connected to the electricity supply.
7. The interval mode makes it possible for you to operate the diffuser for a whole day (approx. 24 hours), without needing to re-fill it. Press the key for the interval mode (6), the white LED will then come on. Jasmine will now diffuse fragrance into the room for 10 minutes. The appliance will then switch off for 20 minutes. This mode means it is possible to diffuse the fragrances in pleasantly small doses into the air. The advantage: You don't become accustomed to the fragrances and can therefore still smell them all the time. The appliance switches off automatically when the water container is empty.
8. If you would like to top the water up, switch the device off and pull the network plug out. Remove the lid and fill the water up to the maximum mark.

Note: If you would like to change the fragrance, empty Jasmine completely and clean the water container with a damp cloth. Fill Jasmine once again and pour the drops into the device following the instructions.

Cleaning

Before maintenance and after every use, switch the device off and pull the network adapter out of the socket. Before you clean Jasmine, the network adapter must be unplugged. Careful: Never immerse the device in water (danger of short circuit).

- To clean the outside, rub with a damp cloth and then dry thoroughly.
- Internal cleaning: You can clean the ultrasonic membrane with a conventional household descaler. If there are lime deposits, we recommend that you use Stadler Form Cleaner & Descaler (www.stadlerform.com/accessories). Alternatively, you can use a household descaling agent or vinegar. Please do not try to scratch off deposits from the membrane with a hard object. For stubborn deposits, we recommend that you descale the device several times in a row. After the descaling rinse the water container and then dry thoroughly.
- No water may enter the air outlet opening (11). This will damage the appliance and will void any claim to the warranty.

Repairs

- Repairs to electrical appliances must only be carried out by a qualified electrical technician. If improper repairs are carried out, the warranty lapses and all liability is refused.

- Never operate the appliance if the adaptor or plug is damaged, after it has malfunctioned, if it has been dropped or has been damaged in any other way (cracks/breaks in the casing).
- Do not push any object into the appliance.
- If the appliance is beyond repair, make it unusable immediately by cutting through the cable and hand it in at the collection point provided for the purpose.
- In the event of a repair, the following points must be observed before the appliance is shipped or taken to the dealer: completely empty the water in the appliance (water tray or water tank), and allow the appliance to dry completely. Appliances containing residual water may be damaged during transport, invalidating the warranty.

Disposal

The European directive 2012 / 19 / CE on Waste Electrical and Electronic Equipment (WEEE), requires that old household electrical appliances must not be disposed in the normal unsorted municipal waste stream. Old appliances must be collected separately in order to optimize the recovery and recycling of the materials they contain and reduce the impact on human health and the environment. The crossed-out “wheeled bin” symbol on the product reminds you of your obligation, that when you dispose of the appliance it must be separately collected. Consumers should contact their local authority or retailer for information concerning the correct disposal of their old appliance

Specifications

- Rated voltage 12 V
- Power output 7.2 W
- Dimensions 130 x 90 x 130 mm (width x height x depth)
- Weight 0.4 kg
- Tank capacity 100 ml
- Sound level < 26 dB(A)
- Complies with EU
- regulations CE / WEEE / RoHS / EAC

All rights for any technical modifications are reserved

Thanks to all people involved in this project: Del Xu for his organization, John Ye for the development, engineering and CAD work, Claudia Fagagnini for the photos, Fabian Zimmerli for the beautiful design, Matti Walker for the graphic work.

- www.stadlerform.com/newsletter

MANUFACTURER

Stadler Form Aktiengesellschaft

- Chamerstrasse 174
- 6300 Zug, Switzerland
- Phone +41 41 720 48 48
- DISTRIBUTION EU

Stadler Form Germany GmbH

- Alt-Heerdt 104
- 40549 Düsseldorf, Germany
- Phone +49 211 97531-640

www.stadlerform.com

Documents / Resources

 <p>The image shows a white, spherical aroma diffuser with a small circular base. It is labeled 'Jasmine' and 'Stadler Form'. There is also a small 'Eco Design' logo.</p>	<p>Stadler Form Jasmine aroma diffuser [pdf] Instruction Manual</p> <p>11, Jasmine aroma diffuser, Jasmine aroma diffuser, aroma diffuser, diffuser</p>
---	---

References

- § [Air purifier accessories to buy online - Stadler Form](#)
- § [Luftreiniger Zubehör online kaufen - Stadler Form](#)
- § [Stadler Form ensures optimal indoor climate](#)
- § [Stadler Form ensures optimal indoor climate](#)
- § [Contact us | Stadler Form](#)
- § [Newsletter subscription | Stadler Form](#)
- § [Stadler Form Review Products | Stadler Form](#)
- [Официальный интернет магазин Stadler Form](#)
- [User Manual](#)

Manuals+, Privacy Policy

This website is an independent publication and is neither affiliated with nor endorsed by any of the trademark owners. The "Bluetooth®" word mark and logos are registered trademarks owned by Bluetooth SIG, Inc. The "Wi-Fi®" word mark and logos are registered trademarks owned by the Wi-Fi Alliance. Any use of these marks on this website does not imply any affiliation with or endorsement.