



SSK SC211 Type C All In One Adapter User Manual

[Home](#) » [SSK](#) » **SSK SC211 Type C All In One Adapter User Manual**

SSK SC211 Type C All In One Adapter User Manual



Contents

- 1 Description
- 2 Product interface diagram
- 3 Connection diagram
- 4 Product Specifications
- 5 Frequently Asked Question and Notes
- 6 Documents / Resources
 - 6.1 References
- 7 Related Posts

Description

Thank you for choosing SSK brand products. In order to ensure a good use effect and experience , please read this manual carefully before using the product

Product interface diagram

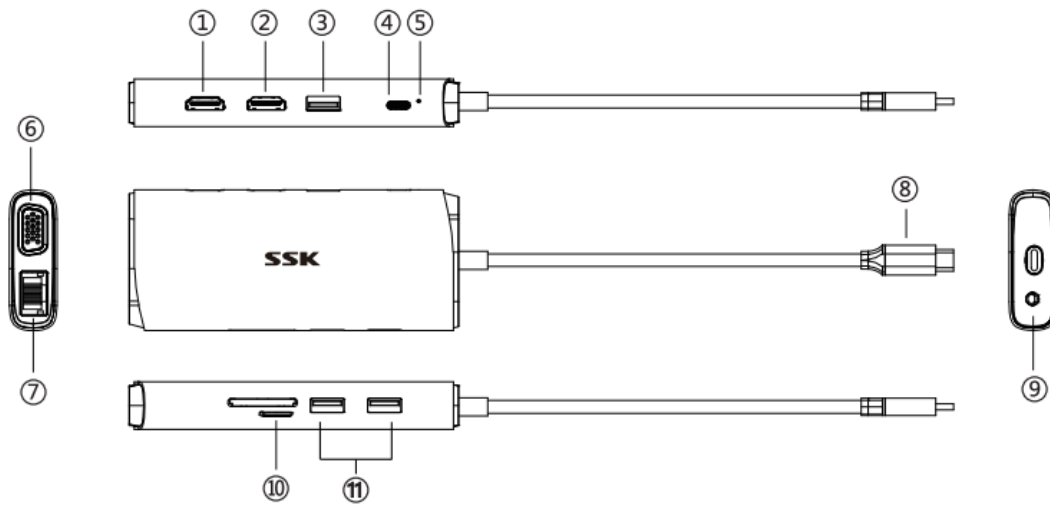

1. HDMI1 video interface
2. HDMI2 video interface
3. USB2.0 wireless keyboard and mouse interface
4. Type-C PD charging port
5. LED status indicator (lights on after connecting to PD power supply)
6. VGA interface
7. RJ45 network port
8. Type-C cable
9. 3.5mm audio port
10. TF/SD card
11. 2xUSB3.0-A interface

Connection diagram

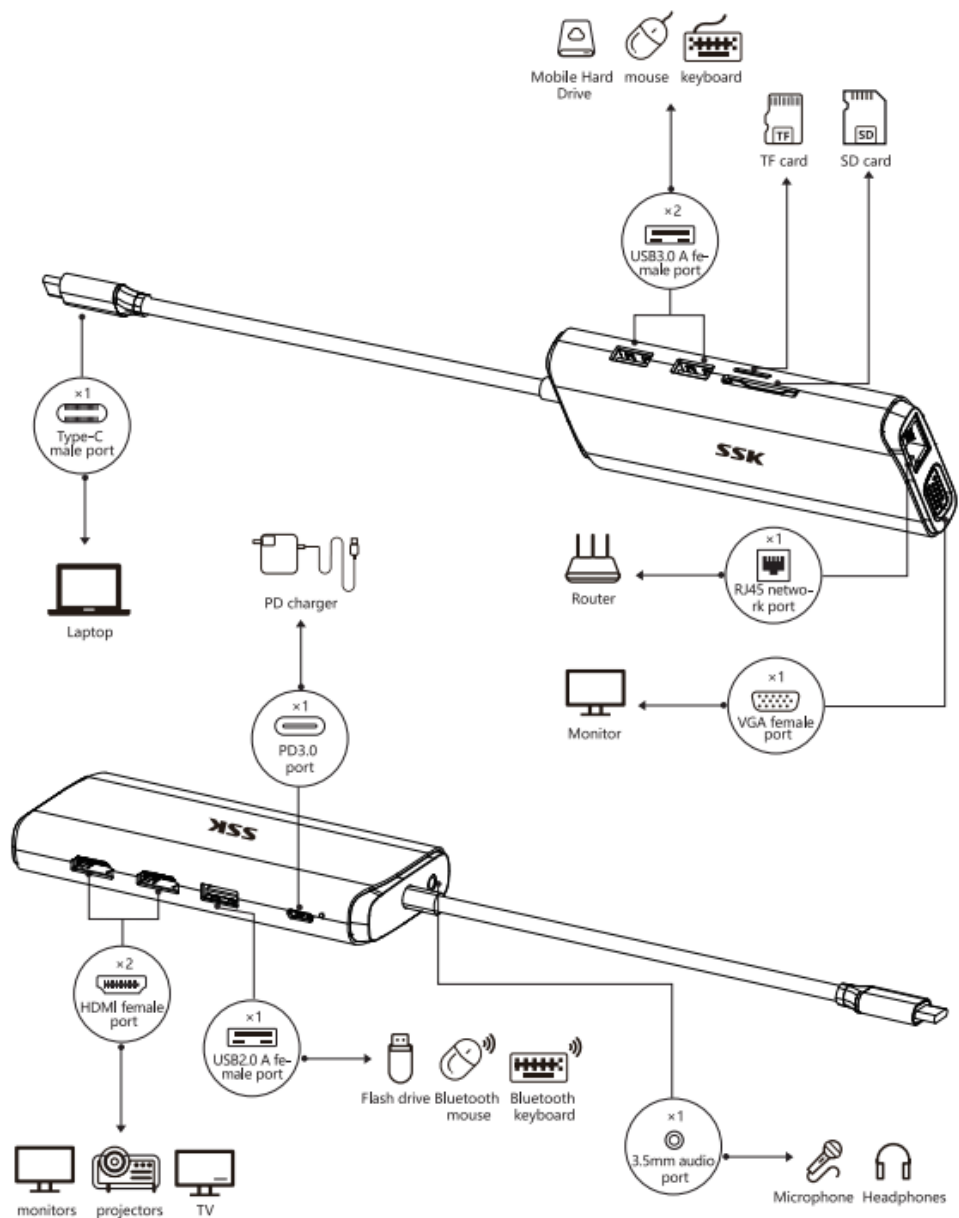

Product Specifications



Input	Type-C
Output	2xUSB3.0-A; 1 x USB2.0-A; 1 type-C PD; 1 avgas;2xHDMI; 1xSD/TF; 1xR145 (1000Mbps); 1 x 3.5mm Audio;
Data interface	2x USB3.0-A Read and write speed up to 5Gbps (about 450MB per second), backward compatible with USB2.0/1.1 1 x USB2.0-A dedicated interface for Bluetooth device>This interface also supports USB2.0 data transmission
HDMI interface 1	support up to 4K60Hz resolution, support HDCP
HDMI interface 2	supports up to 4K30Hz resolution, supports HDCP
VGA interface	supports up to 1080P60Hz resolution
RJ45 network port	supports Gigabit Ethernet and is backward compatible with 10/100M network
SD/TF card slot	support SD3.0, SDTF card can be used at the same time, support hot plug
3.5mm audio interface	supports sound output and microphone input
Charging interface	Type-C interface, support PD3.0 charging protocol
Supported systems	Windows, MacOS, Android, Linux
Size(L*W*H)	124.2*52.8*18mm
Cable length	18cm/0.6ft
Weight	about 145.6g

Frequently Asked Question and Notes

1. The Type-C interface near the end of the Type-C cable only supports PD charging, has no data function, and cannot provide external power output.
2. HDMI1, HDMI2, VGA interfaces can be used at the same time, the product video output supports MST split screen mode, and multiple display devices can be connected at the same time to display different pictures (this function is only for Windows).
3. Limited by device performance and interface, when multiple display devices are connected at the same time, the display device may not reach its maximum resolution and refresh rate.
4. Please use the original charger of the computer/tablet device for charging. If you need to use another charger to charge, please ensure that the charger supports the PD charging protocol and the charging power meets the minimum requirements of the device.
5. When there are many external large-capacity mobile hard disks and other devices, please connect the devices one by one to avoid powering on too many devices at the same time and causing insufficient load.



Documents / Resources

 <small>Type-C All-in-One Adapter Product Manual SC211</small> 	SSK SC211 Type C All In One Adapter [pdf] User Manual SC211 Type C All In One Adapter, SC211, Type C All In One Adapter, All In One Adapter, Adapter
--	---

References

- [User Manual](#)

[Manuals+](#), [Privacy Policy](#)

This website is an independent publication and is neither affiliated with nor endorsed by any of the trademark owners. The "Bluetooth®" word mark and logos are registered trademarks owned by Bluetooth SIG, Inc. The "Wi-Fi®" word mark and logos are registered trademarks owned by the Wi-Fi Alliance. Any use of these marks on this website does not imply any affiliation with or endorsement.