



Square SWJ1-01 Terminal Fits Terminal Power Adapter Instruction Manual

[Home](#) » [Square](#) » Square SWJ1-01 Terminal Fits Terminal Power Adapter Instruction Manual 



Square Terminal
Getting started



Contents

- 1 SWJ1-01 Terminal Fits Terminal Power Adapter
- 2 SQUARE TERMINAL
- 3 WHAT'S IN THE BOX
- 4 CHARGING YOUR SQUARE TERMINAL
- 5 LOADING RECEIPT PAPER
- 6 TAKING PAYMENTS
- 7 GET POINT-OF-SALE SOFTWARE THAT FITS YOUR BUSINESS
- 8 HELP AND SUPPORT
- 9 HARDWARE PROTECTION
- 10 GUARANTEE COVERAGE
- 11 LIMITED PRODUCT GUARANTEE AGAINST DEFECTS – UNITED KINGDOM
- 12 GUARANTEE COVERAGE
- 13 SPECIFIC PRECAUTIONS FOR EMC
- 14 ACCESSORY SAFETY
- 15 DISPOSAL OF WASTE BATTERIES AND ELECTRICAL AND ELECTRONIC EQUIPMENT
- 16 REGULATORY INFORMATION
- 17 Documents / Resources
 - 17.1 References

SWJ1-01 Terminal Fits Terminal Power Adapter

THANKS FOR CHOOSING TO SELL WITH SQUARE TERMINAL

Start by pushing the power button located on the lower-left side of Terminal until the Square logo appears on the screen. Follow the steps on-screen to connect to the internet, and then sign in or sign up for an account. To keep your device updated, leave it powered on and plugged in overnight. Square Terminal receives automatic updates at 03:00 but you can change this time in settings if needed. Activate this product in the UK or Ireland, then continue to use it only in the country where you first activated your device.

For more information on setting up and getting the most from Terminal, visit square.com/go/uk-terminal-guide from the UK, or square.com/go/ie-terminal-guide from Ireland.

SQUARE TERMINAL

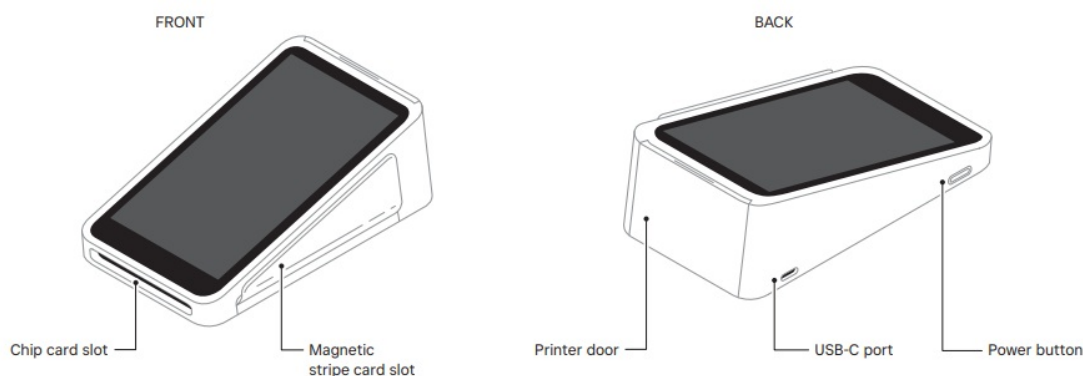

WHAT'S IN THE BOX



Square Terminal



Power adapter



Power adapter cable



Receipt paper roll

CHARGING YOUR SQUARE TERMINAL

Terminal has a rechargeable battery so it doesn't always need to be plugged into a power outlet. When the battery is running low, simply charge it up.

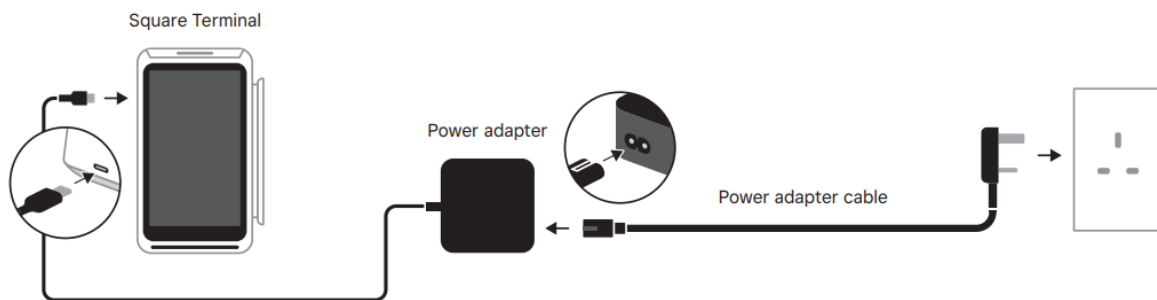

Plug in accessories and connect to the internet via Ethernet with Hub for Square Terminal. To learn more or buy Hub, visit square.com/go/uk-terminal-guide from the UK, or square.com/go/ie-terminal-guide from Ireland.

LOADING RECEIPT PAPER

Position and align the paper receipt roll exactly as shown in step 2. When tearing off a receipt, tear down toward the screen.

1. Open the printer door located just above the screen.

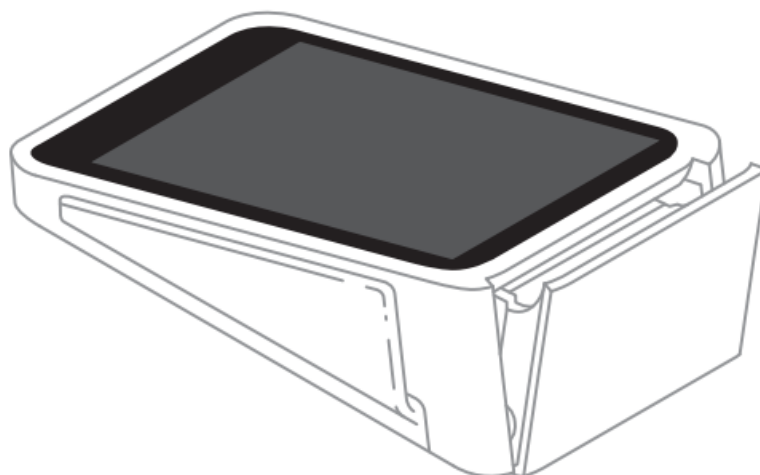

2. Unroll a few centimetres of paper on a new paper receipt roll. Put the roll in the printer as shown above.

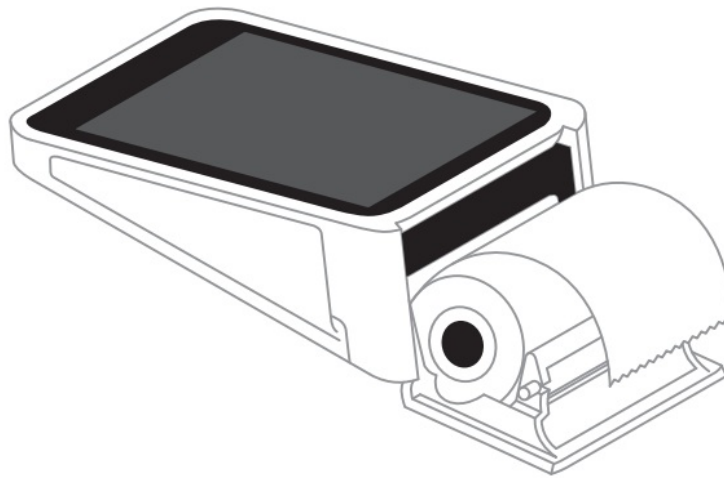

3. Align the paper with the feed slots, and then close the printer door. Tear off the excess paper.

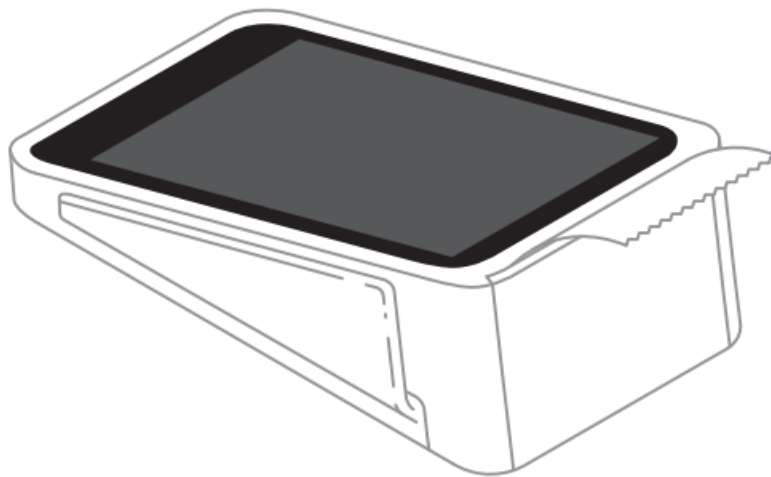

To view compatible receipt paper and to reorder, go to square.com/go/uk-terminal-paper from the UK, or square.com/go/ie-terminal-paper from Ireland.

TAKING PAYMENTS

Terminal lets you accept all major chip and PIN and contactless cards. Mobile payments such as Apple Pay and Google Pay are also accepted. To take a payment, ring up the sale and tap Charge.

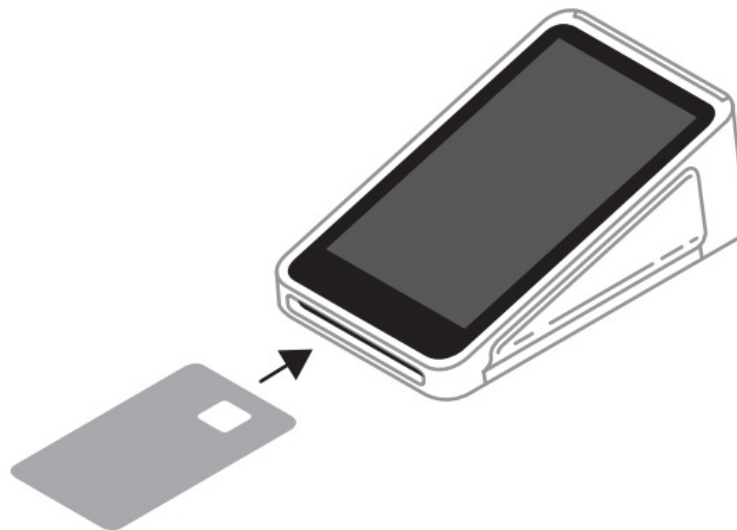

Chip and PIN

Insert the chip and PIN card into the slot with the chip facing up.

**Contactless**

Hold the card or mobile device close to the screen until you hear a beep.

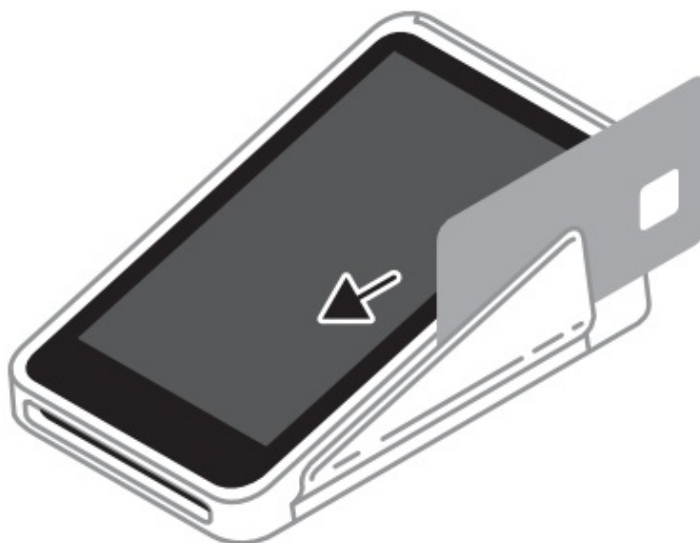
**Magstripe-only**

Accept non-contactless cards without a chip by swiping the card on the side slot with the stripe facing Terminal. Turn on offline payments to keep taking payments, even if your Wi-Fi is down. Just reconnect to the internet within 24 hours to upload any offline transactions.

GET POINT-OF-SALE SOFTWARE THAT FITS YOUR BUSINESS

Whether you run a restaurant, sell retail goods, book appointments or just need a versatile POS for whatever comes next, there's a point-of-sale solution to support you and your business needs. Compare options and sign up at square.com.

Square Point of Sale

Free, easy to use and customisable for every business (even ones that do a little of everything), this POS software lets you sell in person, online or wherever your customers are.

Square for Restaurants

An all-in-one POS for front- and back-of-house operations that keeps your orders and your team organised.

Square for Retail

A POS designed to help retail stores sell in-store and online seamlessly, with built-in tools for advanced inventory management, sales and staffing.

Square Appointments

An appointment-scheduling POS built to save you time and help you stay in control, with an intuitive and seamless customer booking experience.

HELP AND SUPPORT

Read our FAQs, learn more about compatible hardware and get troubleshooting support at square.com/go/uk-

[terminal-guide](#) from the UK, or square.com/go/ie-terminal-guide from Ireland.

HARDWARE PROTECTION

Your Square hardware comes with a limited twoyear warranty.

To find warranty information, go to square.com/guarantee.

FREE 30-DAY RETURNS

Square guarantees a 30-day, risk-free return policy for all purchases made from square.com/hardware. Visit square.com/returns to process your return. After a return is complete, a refund will be credited back to you.

LIMITED PRODUCT GUARANTEE AGAINST DEFECTS – REPUBLIC OF IRELAND

Squareup International Limited (“Square”) guarantees this product against any defect in manufacture or workmanship or failure of the product to comply with the specifications set out in the instruction manual (“Defect”) for a period of two (2) years from the date of delivery. If the original consumer purchaser (or his/her assignee) finds this product to have a Defect within two (2) years from the original date of delivery, Square will replace the product at no cost. The limited guarantee shall be void if the Defect in the product has arisen through use other than as set out in the instruction manual. If you are acting as a consumer under applicable legislation, then this limited guarantee is in addition to (and does not affect) any of your statutory or consumer rights and remedies, including those under the Sale of Goods Act 1893 (as amended).

GUARANTEE COVERAGE

The rights in this limited guarantee may be assigned to another person without prejudice, including but not limited to the time restriction of two (2) years for customers in the Republic of Ireland from the date of delivery set out in the first paragraph of this limited product guarantee. See square.com/ie/guarantee for more information.

This limited guarantee does not apply if the product: has been subjected to alteration, modification/adaptation, abuse, misuse or otherwise used other than as set out in the instruction manual; or has been combined with any hardware or software that was not manufactured by Square or a member of its corporate group, not intended for use with the product or otherwise not included in its original packaging. For service, support or guarantee assistance in this circumstance, you are advised to contact the manufacturer of the relevant third-party hardware or software supplier directly (and not Square).

To contact Square in the Republic of Ireland, please visit square.com/go/ie/help or call 1800 904 878 to be connected to customer support. The limited guarantee applies exclusively to residents of the Republic of Ireland and is issued by Square, whose registered office is located at 70 Sir John Rogerson’s Quay, Dublin 2, D02 R296, Ireland.

LIMITED PRODUCT GUARANTEE AGAINST DEFECTS – UNITED KINGDOM

Squareup (UK) Limited (“Square”) guarantees this product against any defect in manufacture or workmanship or failure of the product to comply with the specifications set out in the instruction manual (“Defect”) for a period of two (2) years from the date of delivery. If the original consumer purchaser (or his/her assignee) finds this product to have a Defect within two (2) years from the original date of delivery, Square will replace the product at no cost. The limited guarantee shall be void if the Defect in the product has arisen through use other than as set out in the instruction manual. If you are acting as a consumer under applicable legislation, then this limited guarantee is in addition to (and does not affect) any of your statutory or consumer rights and remedies, including those under the Consumer Rights Act 2015.

GUARANTEE COVERAGE

The rights in this limited guarantee may be assigned to another person without prejudice, including but not limited to the time restriction of two (2) years for customers in the UK from the date of delivery set out in the first paragraph of this limited product guarantee. See square.com/uk/guarantee for more information.

This limited guarantee does not apply if the product: has been subjected to alteration, modification/adaptation, abuse, misuse or otherwise used other than as set out in the instruction manual; or has been combined with any

hardware or software that was not manufactured by Square or a member of its corporate group, not intended for use with the product or otherwise not included in its original packaging. For service, support or guarantee assistance in this circumstance, you are advised to contact the manufacturer of the relevant third-party hardware or software supplier directly (and not Square).

To contact Square in the UK, please visit square.com/uk/help or call 0800 098 8014. The limited guarantee applies exclusively to residents of the UK and is issued by Square, whose registered office is located at 6th Floor, One London Wall, London EC2Y 5EB.

COMPLIANCE WITH 2014/53/EU RADIO EQUIPMENT DIRECTIVE (RED)

In accordance with Article 10.8 of the RED, the following table provides information of the frequency bands used and the maximum radio frequency transmit power of Square Terminal for sale in the EU.

Frequency	Max. Transmit Power
2402-2480MHz (BLE)	5.4dBm+/-1dBm
2402-2480MHz (BT)	9.6dBm+/-1dBm
2412-2472MHz	19.69dBm+/-1dBm
5180-5320MHz	21.84dBm+/-1dBm
5500-5700MHz	21.95dBm+/-1dBm
5745-5825MHz	12.99dBm+/-1dBm
13.56MHz	0.29dBuA/m+/-1dBuA/m

SPECIFIC PRECAUTIONS FOR EMC

- Square equipment is compliant with Class B of EN 55032 and is suitable in a residential or commercial environment.
- Square products are tested to the requirements of EN 55032 (emissions) and EN 55035 (immunity). There are no special precautions which must be taken in order to comply with the requirements of Directive 2014/30/EU (EMC Directive) essential requirements in Section 1 of Annex I.
- In addition, Square products are further tested to ensure spurious emissions are within the specified limits, as well as meeting the requirements for adaptivity, which mitigates against problems caused by co-location with other wireless products.
- This Square product is not subject to the requirements in Section 2 of Annex I of Directive 2014/30/EU for fixed installations.

POWER ADAPTER SAFETY

- Do not drop or cause an impact to the power adapter.
- If the power cable is damaged (for example, the cord is exposed or broken) or the plug loosens, stop using it immediately. Continued use may lead to electric shocks, short circuits or fire.
- Do not touch the power adapter with wet hands. Doing so may lead to malfunctions, short circuits or electric shocks.

ACCESSORY SAFETY

- Using an unapproved or incompatible power adapter or cord may cause fire, explosion or other hazards.
- Choose only accessories approved for use with this model by the device manufacturer. The use of any other types of accessories may void the warranty, may violate local laws and regulations and may be dangerous. Please contact your retailer for information on approved accessories.

SOFTWARE UPDATES

Software updates can be released by Square to fix bugs or enhance functions after the product has been released. Updated software versions released will not affect the continued compliance with the applicable rules. Radio frequency parameters are not accessible to the end user and can not be changed by the user.

DISPOSAL OF WASTE BATTERIES AND ELECTRICAL AND ELECTRONIC EQUIPMENT

This symbol on the product or its batteries or its packaging means that this product and its batteries must not be disposed of with your household waste. Instead it is your responsibility to hand this over to an applicable collection point for the recycling of batteries and electrical and electronic equipment.

The separate collection and recycling will help conserve natural resources and prevent potential negative consequences for human health and the environment due to the possible presence of hazardous substances in batteries and electrical and electronic equipment, which could be caused by inappropriate disposal.

Disposal regulations vary by region. Dispose of old batteries and equipment in compliance with your local regulations.

For more information on where to deliver your batteries and electrical and electronic waste, please contact your local city/ municipality office, your household waste disposal service or the shop where you purchased this product. For the nearest recycling collection point in the UK, please visit square.com/go/uk-recycling.

In Ireland, please visit square.com/go/ie-recycling.

COMPLIANCE

Hereby, Block, Inc. declares that the radio equipment type SPD2-01-A is in compliance with Directive 2014/53/EU.

The Full text of the EU declaration of conformity is available at the following internet address:

squareup.com/ie/en/legal/general/dc.

In all EU member states, operation of 5180-5240MHz is restricted to indoor use only.

COMMISSION REGULATION (EU) 2019/1782

OF 1 OCTOBER 2019

Laying down ecodesign requirements for external power supplies pursuant to Directive 2009/125/EC of the European Parliament and of the Council.

Manufacturer's name and commercial registration number and address:

Squareup (UK) Limited.

6th Floor, One London Wall, London, EC2Y 5EB

CRO Entity#: 09023549

VAT ID#: 233237041

Squareup International Ltd.

70 Sir John Rogerson's Quay, Dublin 2, D02 R296, Ireland.

CRO Entity#: 583287

VAT ID#: IE 3426675NH

REGULATORY INFORMATION

You can view regulatory information for Square Terminal by going to Settings > Hardware > General > About Square Terminal > Regulatory.

Model identifier	SWJ1-01
Input voltage	100-240 V
Input AC frequency	50/60 Hz
Output voltage	5.0/9.0/15.0/20.0 VDC
Output current	3.0/3.0/3.0/2.25 A
Output power	15.0/27.0/45.0/45.0 W
Average active efficiency	84.91%
Efficiency at low load (10%)	79.58%
No-load power consumption	0.054 W



Square and the Square logo are trademarks of Block, Inc.
© 2023 Block, Inc., 1955 Broadway, Ste. 600, Oakland, CA 94612. Squareup Pte. Ltd.,
8 Marina Boulevard #05-02, Marina Bay Financial Centre, Singapore (018981).
M-LIT-0306-01

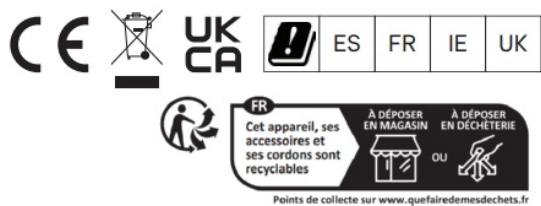

Documents / Resources

	Square SWJ1-01 Terminal Fits Terminal Power Adapter [pdf] Instruction Manual SWJ1-01 Terminal Fits Terminal Power Adapter, SWJ1-01, Terminal Fits Terminal Power Adapter, Fits Terminal Power Adapter, Terminal Power Adapter, Power Adapter, Adapter
--	--

References

- [Centro de ayuda de Square - ES](#)
- [Devoluciones y cambios en garantía](#)
- [Hardware Policies and Limited Warranty](#)
- [Empezar a utilizar Square Terminal | Centro de ayuda de Square - ES](#)
- [Papel de impresora para Square Terminal \(20 rollos\) | Tienda de Square](#)
- [Centre d'assistance Square - FR](#)
- [Hardware Policies and Limited Warranty](#)
- [Démarrer avec Square Terminal | Centre d'assistance Square - FR](#)

- [!\[\]\(694fcb4611893e9db5249daba48abfc1_img.jpg\) Papier pour imprimante thermique Square \(20 rouleaux\) | Magasin Square](#)
- [!\[\]\(8ec8d5dc48934930a762fecf6ecbe179_img.jpg\) Comment recycler votre Square Reader ? | Centre d'assistance Square - FR](#)
- [!\[\]\(c34a15e67573dae8fbb88f4cbfb0f2e9_img.jpg\) Garantie limitée et retours de matériel Square | Centre d'assistance Square - FR](#)
- [!\[\]\(41f06fdeabb4e5a71d06fe8f32a46127_img.jpg\) Recycle Your Square Reader | Square Support Centre - IE](#)
- [!\[\]\(18eb66208e65404cce5042d73cf0a851_img.jpg\) Get Started with Square Terminal | Square Support Centre - IE](#)
- [!\[\]\(14a9d4de9e6699d41b68e8807e2d5f76_img.jpg\) Square Terminal Printer Paper – 20 rolls | Square Shop](#)
- [!\[\]\(415790129e00c225ba52b81c8addfb14_img.jpg\) How to Recycle Your Square Reader | Square Support Centre - GB](#)
- [!\[\]\(fa8e43d6f5da9cf596808674ced6c198_img.jpg\) Get Started with Square Terminal | Square Support Centre - GB](#)
- [!\[\]\(2b564e327fe9708ac2f9320a9ae84c76_img.jpg\) Square Terminal Printer Paper \(20 Rolls\) | Square Shop](#)
- [!\[\]\(484cd33a03c33977d2fcf6bb9cc02435_img.jpg\) Hardware Policies and Limited Warranty](#)
- [!\[\]\(c885083f23ac65632c3cf77b16f7a193_img.jpg\) Square Hardware Limited Warranty and Returns | Square Support Center - US](#)
- [!\[\]\(20f0f5805f0a60636883bdd13c58dc31_img.jpg\) Hardware Policies and Limited Warranty](#)
- [!\[\]\(90f7aa1b3da6a942e186a7e3fdaaf44b_img.jpg\) Square Support Centre - GB](#)
- [!\[\]\(b2b96e5d9b571004907039c0a8a75b54_img.jpg\) General Terms of Service](#)
- [!\[\]\(6285cf242551105b2a630c622e0c55ae_img.jpg\) General Terms of Service](#)
- [User Manual](#)

Manuals+ Privacy Policy

This website is an independent publication and is neither affiliated with nor endorsed by any of the trademark owners. The "Bluetooth®" word mark and logos are registered trademarks owned by Bluetooth SIG, Inc. The "Wi-Fi®" word mark and logos are registered trademarks owned by the Wi-Fi Alliance. Any use of these marks on this website does not imply any affiliation with or endorsement.