



Square Terminal Card Reader for Accepting Contactless User Guide

[Home](#) » [Square Terminal](#) » Square Terminal Card Reader for Accepting Contactless User Guide 



Square Terminal

Getting Started

Contents

- 1 Card Reader for Accepting Contactless
- 2 SQUARE TERMINAL
- 3 What's in the box
- 4 Charging your Terminal
- 5 Loading paper receipt roll
- 6 Taking payments
- 7 POWER ADAPTER SAFETY
- 8 ACCESSORY SAFETY
- 9 SOFTWARE UPDATES
- 10 GUARANTEE COVERAGE
- 11 HELP AND SUPPORT
- 12 FREE 30-DAY RETURNS
- 13 HARDWARE WARRANTY
- 14 Documents / Resources
 - 14.1 References
- 15 Related Posts

Card Reader for Accepting Contactless

Thanks for choosing to sell with Square Terminal

Start by pushing the power button located on the lower-left side of Terminal until the Square logo appears on the screen. Follow the steps onscreen to connect to the internet, and then sign up for a new Square account or sign in to your existing account. Activate this product in the UK or Ireland, then continue to use it only in the country

where you first powered it on.

For more information on setting up and getting the most from Terminal, visit square.com/go/uk-terminal-guide from the UK, or square.com/go/ie-terminal-guide from Ireland.

SQUARE TERMINAL

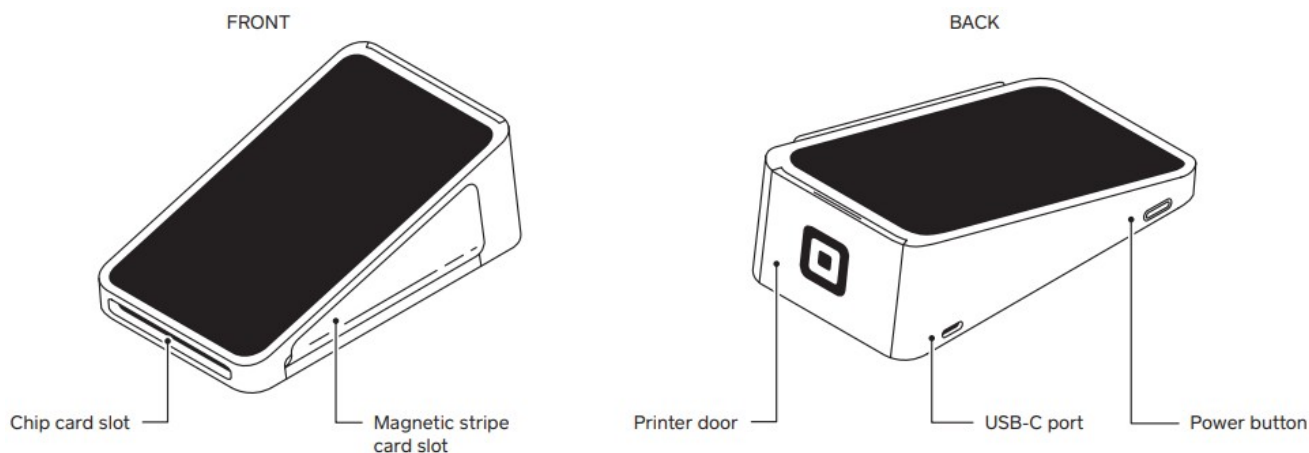

What's in the box



Square Terminal



Power adapter



Power adapter cable



Paper receipt roll

Charging your Terminal

Terminal has a rechargeable battery so it doesn't always need to be plugged into a power outlet. When the battery is running low, simply charge it up.

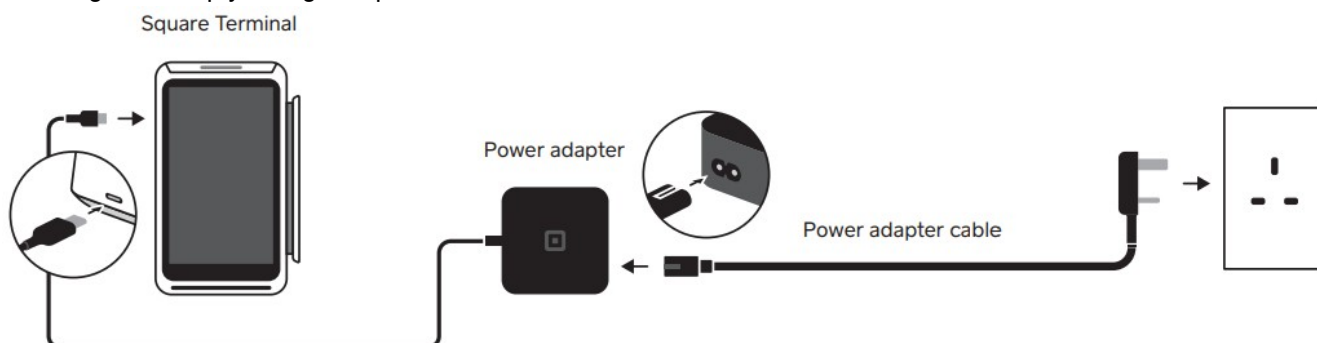

Plug in accessories and connect to the internet via Ethernet with Hub for Square Terminal. To learn more or buy Hub, visit square.com/go/uk-terminal-guide from the UK, or square.com/go/ie-terminal-guide from Ireland.

Loading paper receipt roll

Position and align the paper receipt roll exactly as shown in step 2. When tearing off a receipt, tear down toward the screen.

1. Open the printer door located just above the screen.

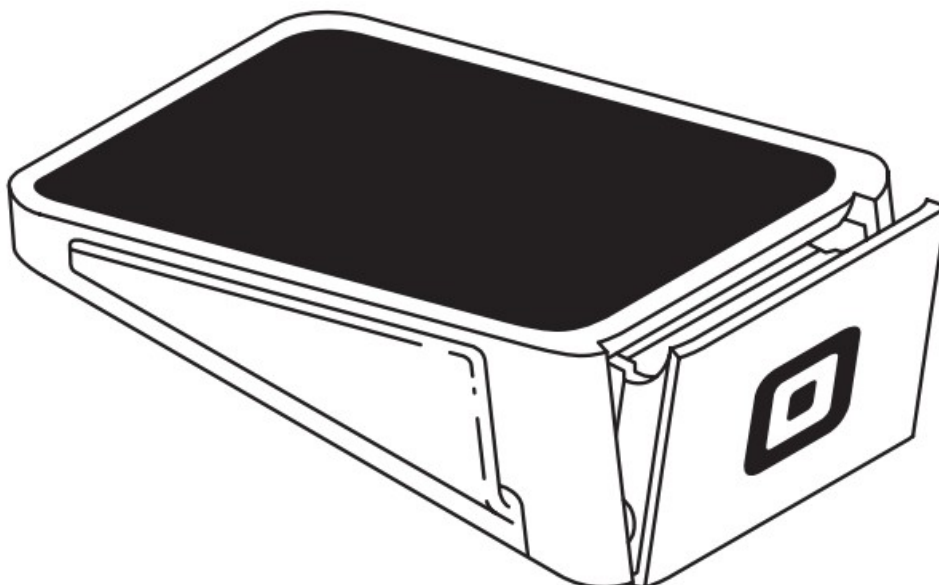

2. Unroll a few centimetres of paper on a new paper receipt roll. Put the roll in the printer as shown above.

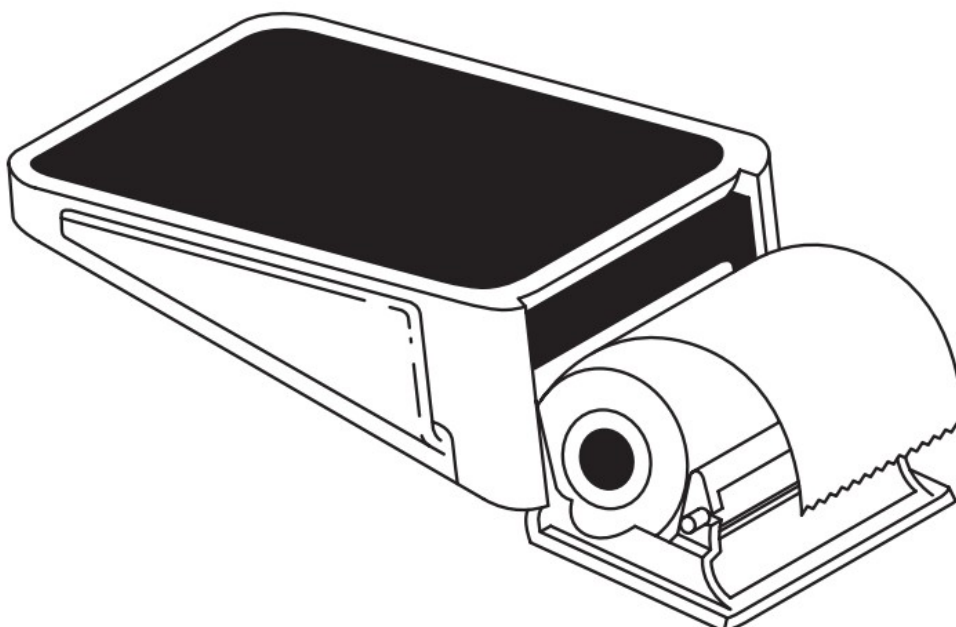

3. Align the paper with the feed slots, then close the printer door. Tear off the excess paper.

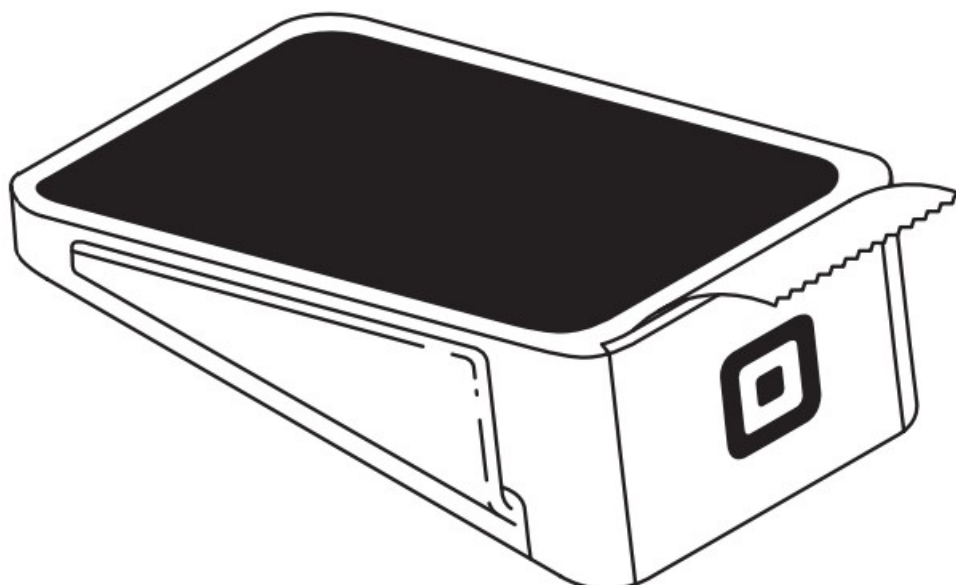

To view compatible receipt paper and to reorder, go to square.com/go/uk-terminal-paper from the UK, or square.com/go/ie-terminal-paper from Ireland.

Taking payments

Terminal lets you accept all major chip and PIN and contactless cards. Mobile payments such as Apple Pay and Google Pay are also accepted. To take a payment, ring up the sale and tap Charge.

Chip and PIN

Insert the chip and PIN card into the slot with the chip facing up.

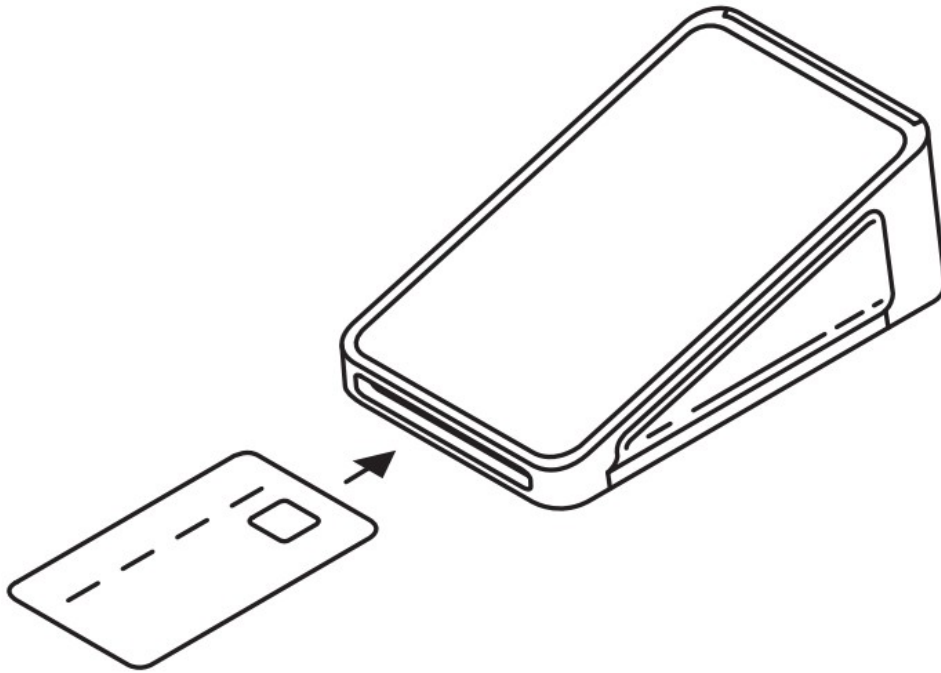

Contactless

Hold the card or mobile device close to the screen until you hear a beep.

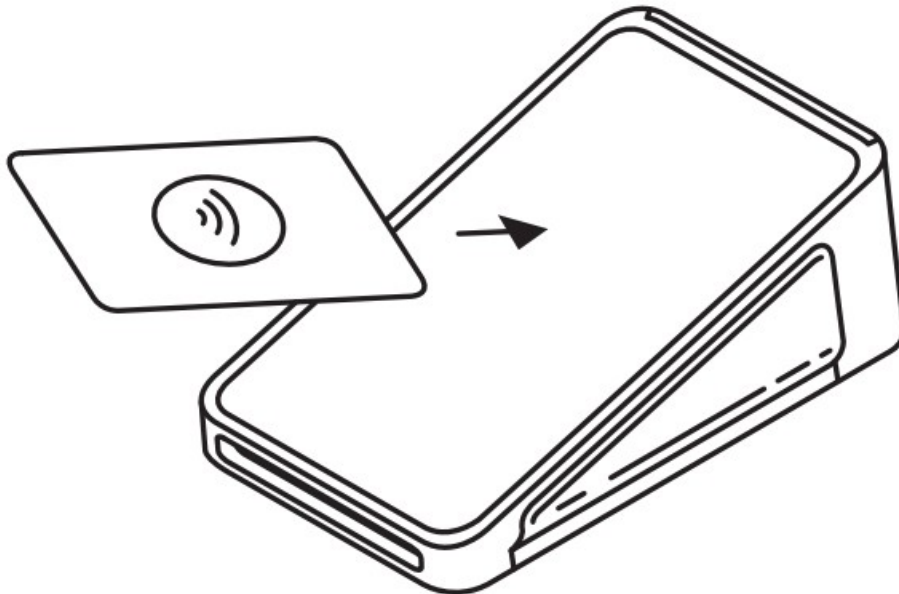

Magstripe-only

Accept non-contactless cards without a chip by swiping the card on the side slot with the stripe facing Terminal.

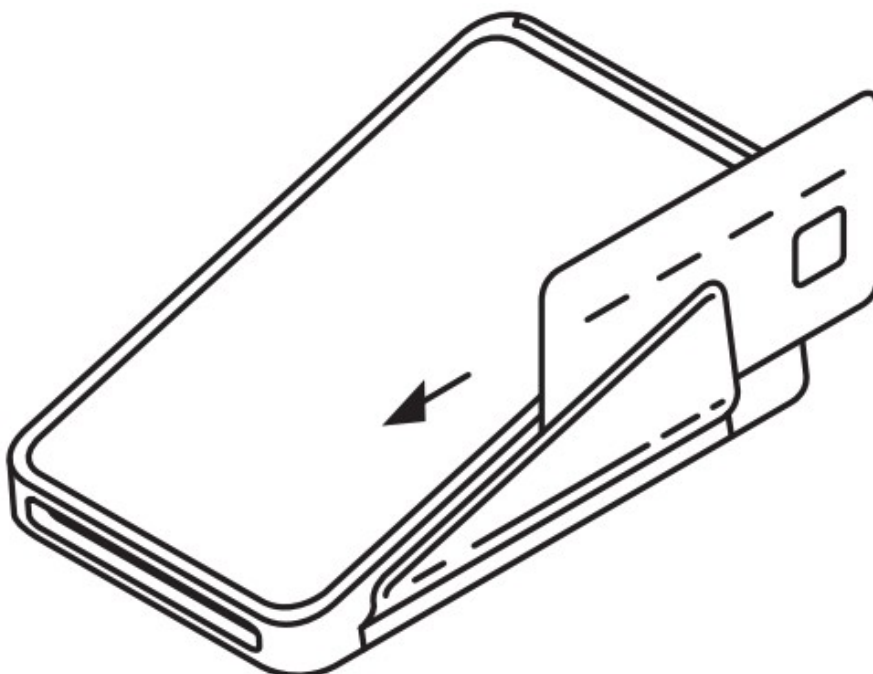

To learn more about taking payments, go to square.com/go/uk-terminal-guide from the UK, or square.com/go/ie-terminal-guide from Ireland.

COMPLIANCE WITH 2014/53/EU RADIO EQUIPMENT DIRECTIVE (RED)

Square wireless products comply with the requirements of Article 10(2) as they can operate in at least one Member State as examined. In accordance with Article 10(10), in cases of restrictions on putting into service, information available on the packaging shall allow the identification of the Member States or the geographical area within a Member State where restrictions on putting into service or requirements for authorization of use exist. In accordance with Article 10.8(a) of the RED, the following table provides information of the frequency bands used and the maximum radio frequency transmit power of Square Terminal for sale in the EU.

Frequency	Max. Transmit Power
2402-2480MHz (BLE)	5.4dBm+/-1dBm
2402-2480MHz (BT)	9.6dBm+/-1dBm
2412-2472MHz	19.69dBm+/-1dBm
5180-5320MHz	21.84dBm+/-1dBm
550-5700MHz	21.95dBm+/-1dBm
5745-5825MHz	12.99dBm+/-1dBm
13.56MHz	0.29dBuA/m+/-1dBuA/m

SPECIFIC PRECAUTIONS FOR EMC

1) Square equipment is compliant with Class B of EN 55032 and is suitable in a residential or commercial environment. 2) Square products are tested to the requirements of EN 55032 (emissions) and EN 55024 (immunity). There are no special precautions which must be taken in order to comply with the requirements of Directive 2014/30/EU (EMC Directive) essential requirements in Section 1 of Annex I. 3) In addition, Square products are further tested to ensure spurious emissions are within the specified limits, as well as meeting the requirements for adaptivity, which mitigates against problems caused by co-location with other wireless products. 4) This Square product is not subject to the requirements in Section 2 of Annex I of Directive 2014/30/EU for fixed installations.

POWER ADAPTER SAFETY

- Do not drop or cause an impact to the power adapter.

- If the power cable is damaged (for example, the cord is exposed or broken) or the plug loosens, stop using it immediately. Continued use may lead to electric shocks, short circuits or fire.
- Do not touch the power adapter with wet hands. Doing so may lead to malfunctions, short circuits or electric shocks.

ACCESSORY SAFETY

- Using an unapproved or incompatible power adapter or cord may cause fire, explosion or other hazards.
- Choose only accessories approved for use with this model by the device manufacturer. The use of any other types of accessories may void the warranty, may violate local laws and regulations and may be dangerous. Please contact your retailer for information on approved accessories.

SOFTWARE UPDATES

Software updates can be released by Square to fix bugs or enhance functions after the product has been released. Updated software versions released will not affect the continued compliance with the applicable rules. Radio frequency parameters are not accessible to the end user and can not be changed by the user.

DISPOSAL OF WASTE BATTERIES AND ELECTRICAL AND ELECTRONIC EQUIPMENT

This symbol on the product or its batteries or its packaging means that this product and its batteries must not be disposed of with your household waste. Instead it is your responsibility to hand this over to an applicable collection point for the recycling of batteries and electrical and electronic equipment.

The separate collection and recycling will help conserve natural resources and prevent potential negative consequences for human health and the environment due to the possible presence of hazardous substances in batteries and electrical and electronic equipment, which could be caused by inappropriate disposal. Disposal regulations vary by region. Dispose of old batteries and equipment in compliance with your local regulations.

For more information on where to deliver your batteries and electrical and electronic waste, please contact your local city/municipality office, your household waste disposal service or the shop where you purchased this product. For the nearest recycling collection point in the UK, please visit square.com/go/uk-recycling. In Ireland, please visit square.com/go/ie-recycling.

COMPLIANCE

For the current EU Declaration of Conformity and additional regulatory compliance information, visit square.com/go/ie/legal/dc. In all EU member states, operation of 5180-5240MHz is restricted to indoor use only.

COMMISSION REGULATION (EU) 2019/1782 OF 1 OCTOBER 2019

Model identifier	SWD4-01
Input voltage	230.22v
Input AC frequency	50Hz
Output voltage	4.98VDC
Output current	300mA
Output power	1.49w
Average active efficiency	83.46%
Efficiency at low load (10%)	68.35%
No-load power consumption	0.42W

Laying down ecodesign requirements for external power supplies pursuant to Directive 2009/125/EC of the European Parliament and of the Council.

Manufacturer's name and commercial registration number and address:

Squareup (UK) Limited.
6th Floor, One London Wall,
London, EC2Y 5EB
CRO Entity#: 09023549
VAT ID#: 233237041

Squareup International Ltd.

70 Sir John Rogerson's Quay, Dublin 2, D02 R296, Ireland.
CRO Entity#: 583287
VAT ID#: IE 3426675NH

REGULATORY INFORMATION

You can view regulatory information for Square Terminal by going to Settings > General > About Terminal > Regulatory.

LIMITED PRODUCT GUARANTEE AGAINST DEFECTS – REPUBLIC OF IRELAND

Squareup International Limited ("Square") guarantees this product against any defect in manufacture or workmanship or failure of the product to comply with the specifications set out in the instruction manual ("Defect") for a period of two (2) years from the date of delivery. If the original consumer purchaser (or his/ her assignee) finds this product to have a Defect within two (2) years from the original date of delivery, Square will replace the product at no cost. The limited guarantee shall be void if the Defect in the product has arisen through use other than as set out in the instruction manual. If you are acting as a consumer under applicable legislation, then this limited guarantee is in addition to (and does not affect) any of your statutory or consumer rights and remedies, including those under the Sale of Goods Act 1893 (as amended).

GUARANTEE COVERAGE

The rights in this limited guarantee may be assigned to another person without prejudice, including but not limited to the time restriction of two (2) years for customers in the Republic of Ireland from the date of delivery set out in the first paragraph of this limited product guarantee. See square.com/ie/guarantee for more information.

This limited guarantee does not apply if the product: has been subjected to alteration, modification/adaptation, abuse, misuse or otherwise used other than as set out in the instruction manual; or has been combined with any hardware or software that was not manufactured by Square or a member of its corporate group, not intended for use with the product or otherwise not included in its original packaging. For service, support or guarantee assistance in this circumstance, you are advised to contact the manufacturer of the relevant third-party hardware or software supplier directly (and not Square).

To contact Square in the Republic of Ireland, please visit square.com/go/ie/help or visit squareup.com/help/ie/en/contact to be connected to customer support. The limited guarantee applies exclusively to residents of the Republic of Ireland and is issued by Square, whose registered office is located at 70 Sir John Rogerson's Quay, Dublin 2, D02 R296, Ireland.



LIMITED PRODUCT GUARANTEE AGAINST DEFECTS – UK

Squareup (UK) Limited ("Square") guarantees this product against any defect in manufacture or workmanship or failure of the product to comply with the specifications set out in the instruction manual ("Defect") for a period of one (1) year from the date of delivery. If the original consumer purchaser (or his/ her assignee) finds this product to have a Defect within one (1) year from the original date of delivery, Square will replace the product at no cost. The limited guarantee shall be void if the Defect in the product has arisen through use other than as set out in the instruction manual. If you are acting as a consumer under applicable legislation, then this limited guarantee is in addition to (and does not affect) any of your statutory or consumer rights and remedies, including those under the Consumer Rights Act 2015.

GUARANTEE COVERAGE

The rights in this limited guarantee may be assigned to another person without prejudice, including but not limited to the time restriction of one (1) year for customers in the UK from the date of delivery set out in the first paragraph of this limited product guarantee. See square.com/uk/guarantee for more information.

This limited guarantee does not apply if the product: has been subjected to alteration, modification/adaptation, abuse, misuse or otherwise used other than as set out in the instruction manual; or has been combined with any hardware or software that was not manufactured by Square or a member of its corporate group, not intended for use with the product or otherwise not included in its original packaging. For service, support or guarantee assistance in this circumstance, you are advised to contact the manufacturer of the relevant third-party hardware

or software supplier directly (and not Square).

To contact Square in the UK, please visit square.com/uk/help or call 0800 098 8014. The limited guarantee applies exclusively to residents of the UK and is issued by Square, whose registered office is located at 6th Floor, One London Wall, London EC2Y 5EB.

HELP AND SUPPORT

Read our FAQ, learn more about compatible accessories and get troubleshooting support at square.com/go/uk-terminal-guide from the UK, or square.com/go/ie-terminal-guide from Ireland.

FREE 30-DAY RETURNS

Square offers a 30-day, risk-free return policy for all purchases made from square.com/uk/shop or square.com/ie/shop. Simply go to square.com/uk/returns from the UK, or square.com/go/ie/returns from Ireland, so we can make things right. After a return is complete, a refund will be credited back to you.

HARDWARE WARRANTY

If something goes wrong with your hardware, you're covered under a limited guarantee. Simply go to square.com/uk/returns in the United Kingdom, or square.com/go/ie/returns in Ireland, so we can make things right. You will be asked to:

1. Complete a guarantee-based claim for your defective product, which includes providing a payment card number. Square will then send you a replacement product and provide a prepaid shipping label to return the defective product.
2. Return the defective product (together with all accessories, cords, cables, parts and documentation included in the original packaging) to Square using the prepaid return label within fourteen (14) days of receiving your replacement product. In the event that you fail to return the defective product, Square will charge the full cost of the replacement product to the payment card provided or to your Square Account (if there is a balance).

© 2021 Square, Inc., 1455 Market St., Ste. 600, San Francisco, CA 94103. © 2021 Squareup (UK) Limited, 6th Floor, One London Wall, London, EC2Y 5EB. © 2021 Squareup International Ltd., 70 Sir John Rogerson's Quay, Dublin 2, D02 R296, Ireland. © 2021 Squareup Pte. Ltd., 8 Marina Boulevard #05-02, Marina Bay Financial Centre, Singapore (018981). Square, the Square logo and Square Terminal are trademarks of Square, Inc. M-LIT-0244-01



Square Terminal

Documents / Resources

	Square Terminal Card Reader for Accepting Contactless [pdf] User Guide Card Reader for Accepting Contactless, Reader for Accepting Contactless, Accepting Contactless, Contactless
---	---

References

-  [Recycle Your Square Reader | Square Support Centre - IE](#)

- [📄 Get Started with Square Terminal | Square Support Centre - IE](#)
- [📄 Square Terminal Printer Paper – 20 rolls | Square Shop](#)
- [📄 Square Support Centre - IE](#)
- [📄 General Terms of Service](#)
- [📄 Square Hardware Limited Warranty | Square Support Centre - IE](#)
- [📄 How to Recycle Your Square Reader | Square Support Centre - GB](#)
- [📄 Get Started with Square Terminal | Square Support Centre - GB](#)
- [📄 Square Terminal Printer Paper \(20 Rolls\) | Square Shop](#)
- [📄 POS Machine & Devices | Square Hardware](#)
- [📄 Hardware Policies and Limited Warranty](#)
- [📄 Square Support Centre - GB](#)
- [📄 Square Hardware Limited Warranty and Returns | Square Support Center - US](#)
- [📄 Point of Sale Hardware | POS Machines | Square](#)
- [📄 Square Support Centre - IE](#)
- [User Manual](#)

Manuals+ Privacy Policy

This website is an independent publication and is neither affiliated with nor endorsed by any of the trademark owners. The "Bluetooth®" word mark and logos are registered trademarks owned by Bluetooth SIG, Inc. The "Wi-Fi®" word mark and logos are registered trademarks owned by the Wi-Fi Alliance. Any use of these marks on this website does not imply any affiliation with or endorsement.