



Spotify Rhein Z1-Plus Server Introduced User Manual

[Home](#) » [Spotify](#) » Spotify Rhein Z1-Plus Server Introduced User Manual 

Spotify Rhein Z1-Plus Server Introduced



Contents

- [1 How to use Spotify Connect on Z1?](#)
- [2 Documents / Resources](#)
- [3 Related Posts](#)

How to use Spotify Connect on Z1?



Step 1: Install Spotify Connect in Z1 and setup audio selector of Z1 First of all, you will need to have “VitOS Manager” app installed in an iOS or Android device. And make sure the mobile device is connected to the same network that Z1 resides in. Power on the Z1 and open “VitOS Manager” app to discover your Z1. Below figure shows the discover page of “VitOS Manager” app.

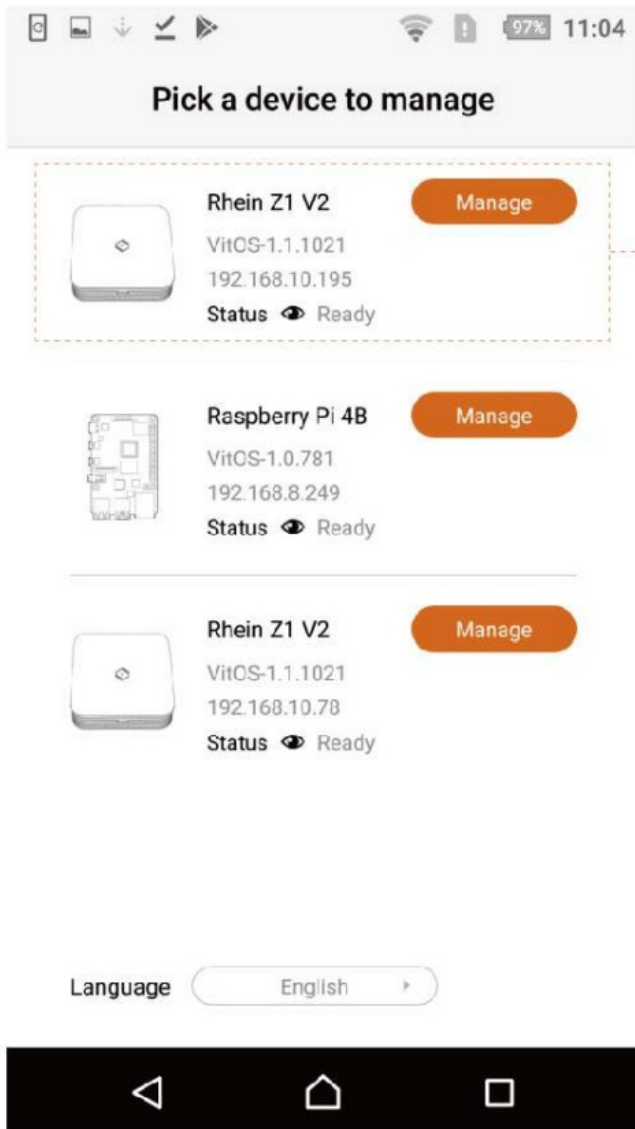

Find the Z1 and click on "Manage" to enter the main page of this Z1.

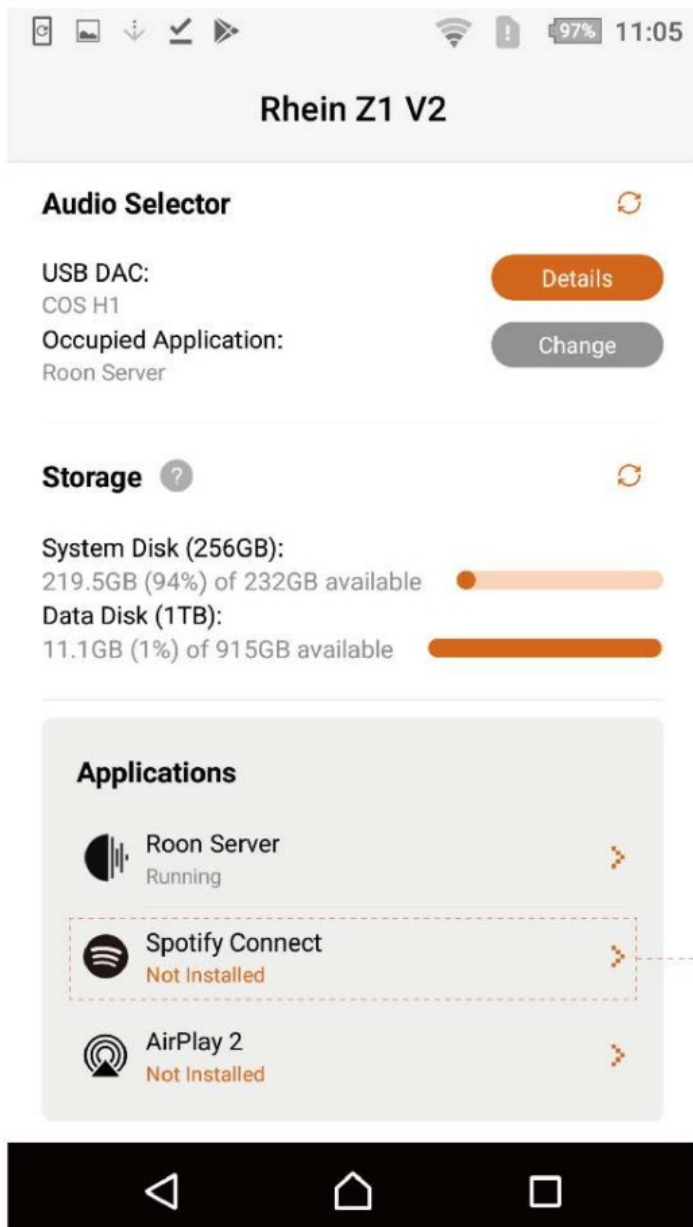

Check the status of "Spotify Connect" in the "Applications" block. If the status is "Not Installed", you will need to install "Spotify Connect" to this Z1. Click the ">" near the Spotify Connect to enter the "Spotify Connect" page.

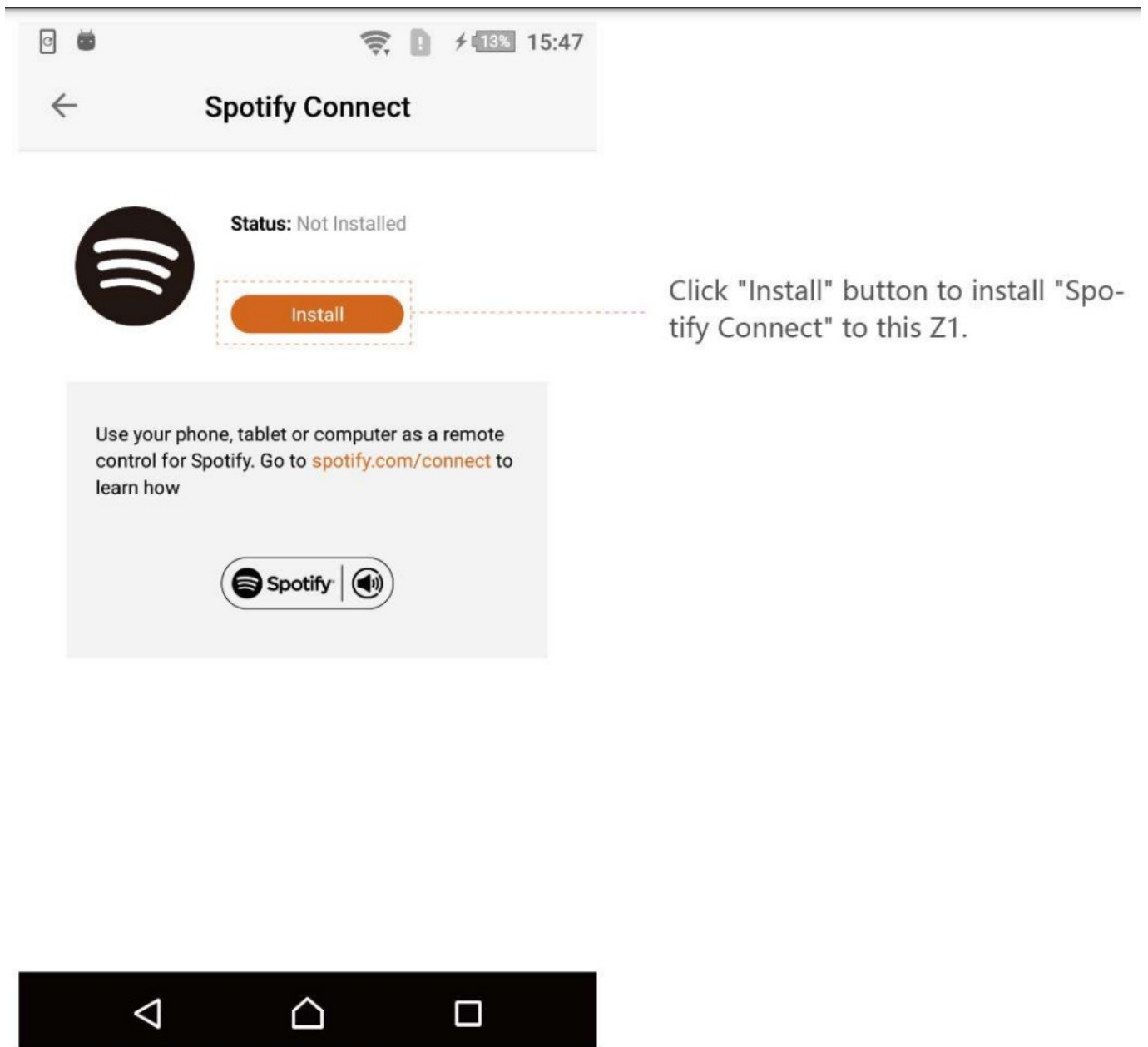

Wait until the installation process to be done and the “Spotify Connect” page will show the running status of Spotify Connect is “Running”, which means “Spotify Connect” feature is running. Below figures show the “Spotify Connect” page and the main page.

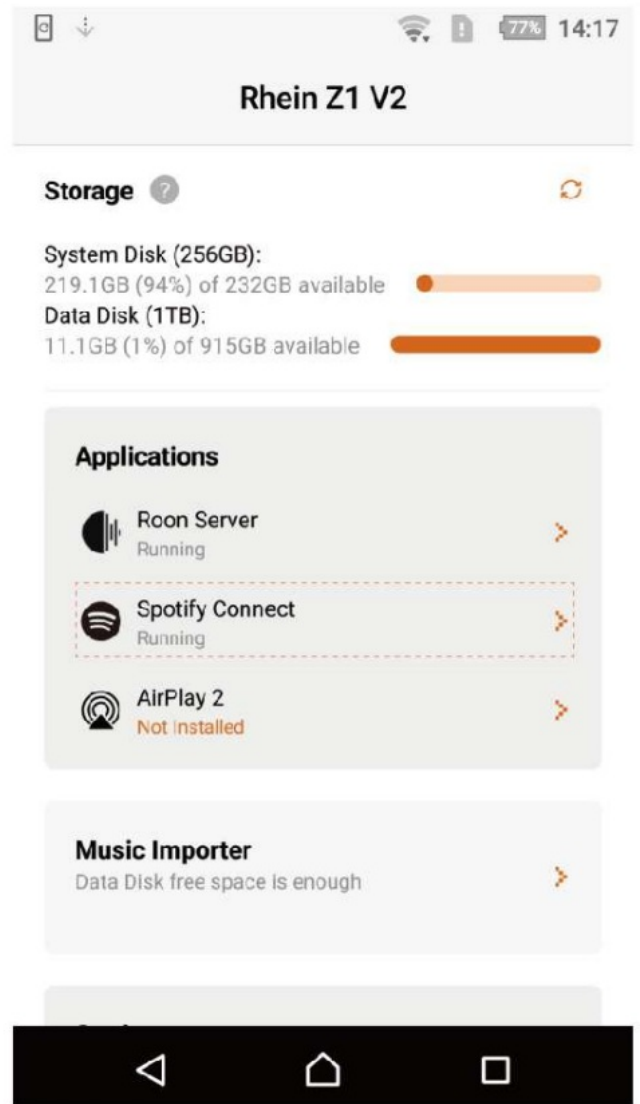
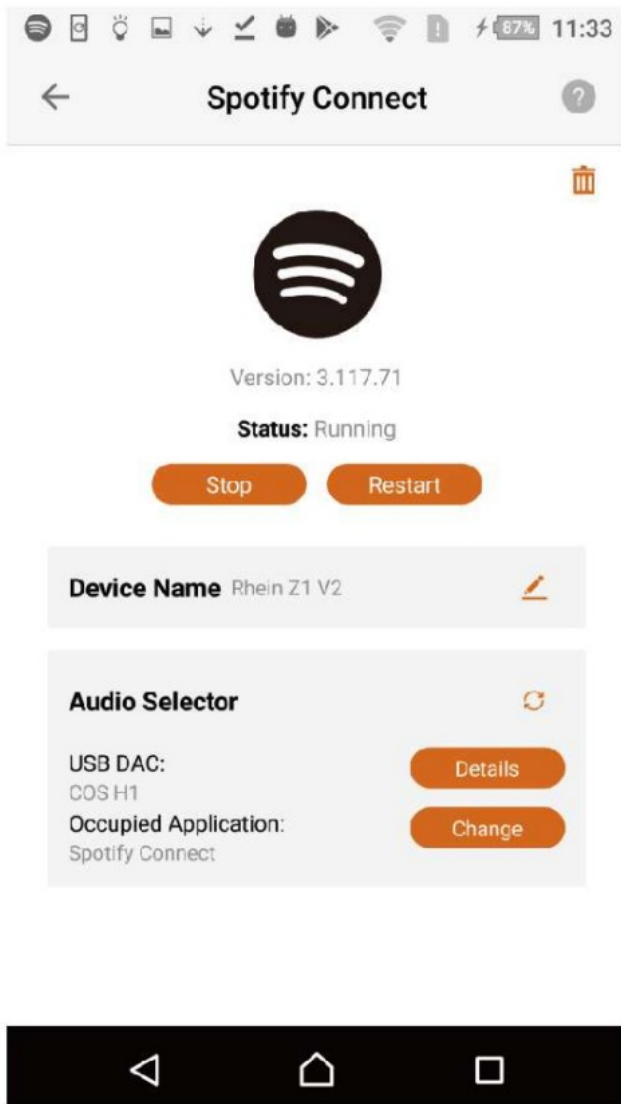

Please remember to use “Audio Selector” and click on “Change” button to change the “Occupied Application” to be “Spotify Connect”. So that the USB DAC, that connected to Z1, is used by “Spotify Connect”.

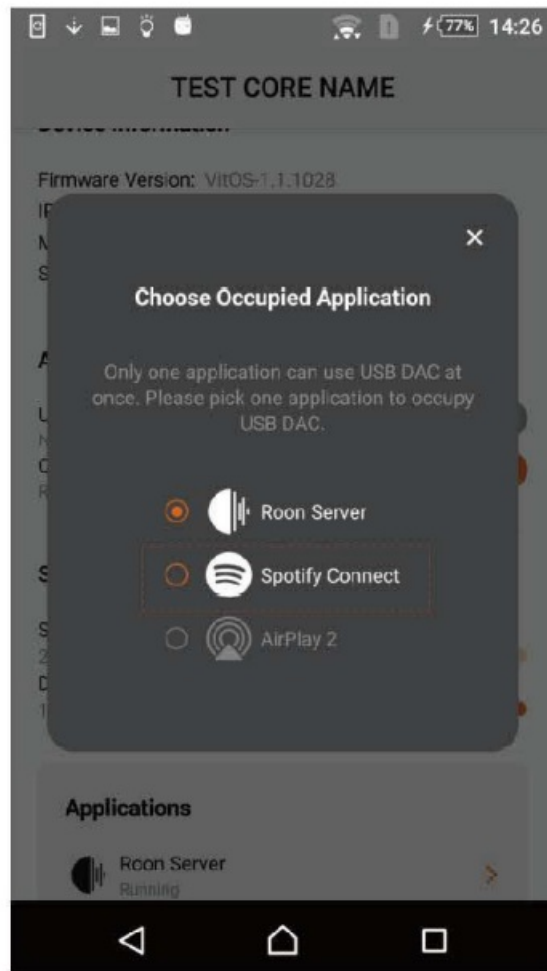

Step 2: Use Spotify app to control Z1 to play Spotify music.

Use your phone, tablet or computer as a remote control for Spotify.



Go to spotify.com/connect to learn how

The Spotift Software is subject to third party licenses found here: <https://www.spotify.com/connect/third-party-licenses> (<https://www.spotify.com/connect/third-party-licenses>).



Documents / Resources

| | |
|--|--|
| | <p>Spotify Rhein Z1-Plus Server Introduced [pdf] User Manual</p> <p>Rhein Z1-Plus Server Introduced, Rhein Z1, Plus Server Introduced, Server Introduced, Introduced</p> |
|--|--|

