

Spider Farmer

USER MANUAL

Mixed-Flow Inline Fan

Creating the Perfect Environment for Your Plants



Contents [[hide](#)]

- [1 SPECIFICATION OF INLINE FAN](#)
- [2 INLINE FAN WITH SPEED CONTROLLER](#)
- [3 INLINE FAN WITH GGS CONTROLLER KITS](#)
- [4 SPIDER FARMER GGS CONTROLLER](#)
- [5 HOW TO USE WITH SPIDER FARMER POWER STRIP KITS](#)
- [6 PACKAGE INCLUDES](#)
- [7 SAFETY PRECAUTIONS](#)
- [8 WARRANTY](#)
- [9 Documents / Resources](#)
 - [9.1 References](#)

SPECIFICATION OF INLINE FAN

4 Inch/100 mm

Duct Size	4-Inch	Power Usage	27W±5%
Fan Airflow	205 CFM	Fan Speed	3000 RPM
Noise Level	26.8 dBA	Frequency	50/60HZ
Input Voltage	AC 100-240V	Operating Temperature	– 20°C-60°C(-4°F-140°F)

6 Inch/150 mm

Duct Size	6-Inch	Power Usage	62W±5%
Fan Airflow	402 CFM	Fan Speed	3000 RPM
Noise Level	32 dBA	Frequency	50/60H Z
Input Voltage	AC 100-240V	Operating Temperature	– 20°C-60°C(-4°F-140°F)

8 Inch/200 mm

Duct Size	8-Inch	Power Usage	180W±5%
Fan Airflow	807 CFM	Fan Speed	3250 RPM
Noise Level	39 dBA	Frequency	50/60H Z
Input Voltage AC 100-240V		Operating Temperature	_20°C-60°C(-4°F-140°F)

12 Inch/300 mm

Duct Size	12-Inch	Power Usage	250W±5%
Fan Airflow	1604 CFM	Fan Speed	2350 RPM
Noise Level	62 dBA	Frequency	50/60HZ
Input Voltage	AC 100-240V	Operating Temperature	-20°C-60°C(-4°F-140°F)

INLINE FAN WITH SPEED CONTROLLER

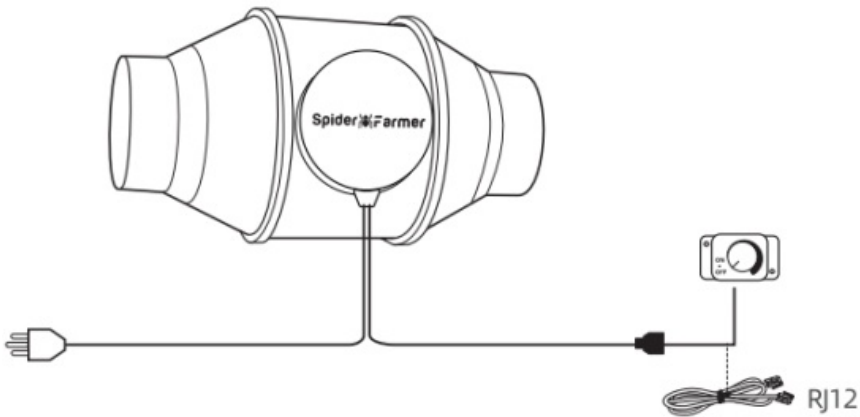

OPERATING INSTRUCTIONS

With Speed Controller	1. Use the speed controller to adjust the fan’s airflow. Turn clockwise to increase the airflow, and turn counterclockwise to decrease it.
	2. Turn the knob and listen for a sound to turn the fan ON or OFF.
With GGS Controller Kits or Power Strip Kits	1. Use the RJ12 cable connect to the GGS Controller, then use the controller to set the fan’s operating time and airflow.
	2. Use the RJ12 cable or power cord connect to the Power Strip. Then you can control the inline fan through Spider Farmer APP.

INLINE FAN WITH GGS CONTROLLER KITS

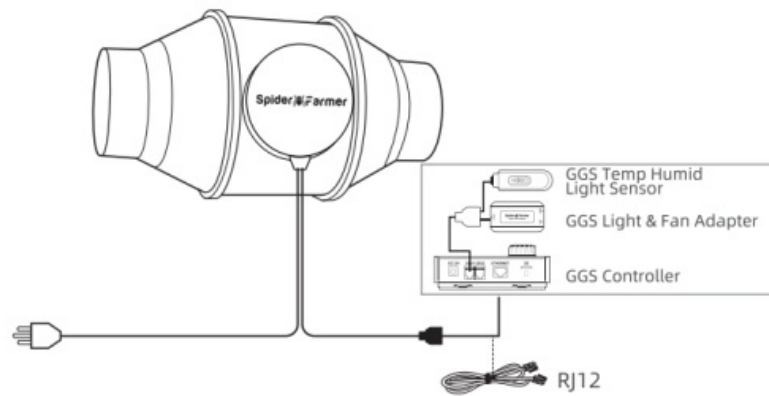

NOTE:

The GGS Light & Fan Adapter is designed for use with LED grow lights and clip fans. One RJ12 cable includes a waterproof cap, specifically designed for the GGS Temp & Humidity Sensor.

SPIDER FARMER GGS CONTROLLER



- Use the RJ12 cable to connect to the DEV1 or DEV2 port on the GGS Controller, then select Blower (inline fan) in the interface.
- Use 1 to navigate through the interface. Rotate to scroll or move. Press to confirm selections.
- Press 2 to return directly to the home screen.
- Press 3 to return to the previous screen or menu.

OPERATING INSTRUCTIONS

Manual Mode	Manually Adjust Fan Speed (0%~100%). 0% turns it off.
Time Period Mode	Set the fan's start time and end time.
	Set the fan's operating speed and standby speed.

Temperature First Mode	Automatically adjust fan operation based on temperature priority.
Humidity First Mode	Automatically adjust fan operation based on humidity priority.
Standby Speed	Enable standby speed, set the fan speed after the end time.



HOW TO USE WITH SPIDER FARMER POWER STRIP KITS

If you own a Spider Farmer Power Strip Kits, you can connect the inline fan using either the RJ12 cable or the power cord. Once connected, control the fan through the Spider Farmer App.

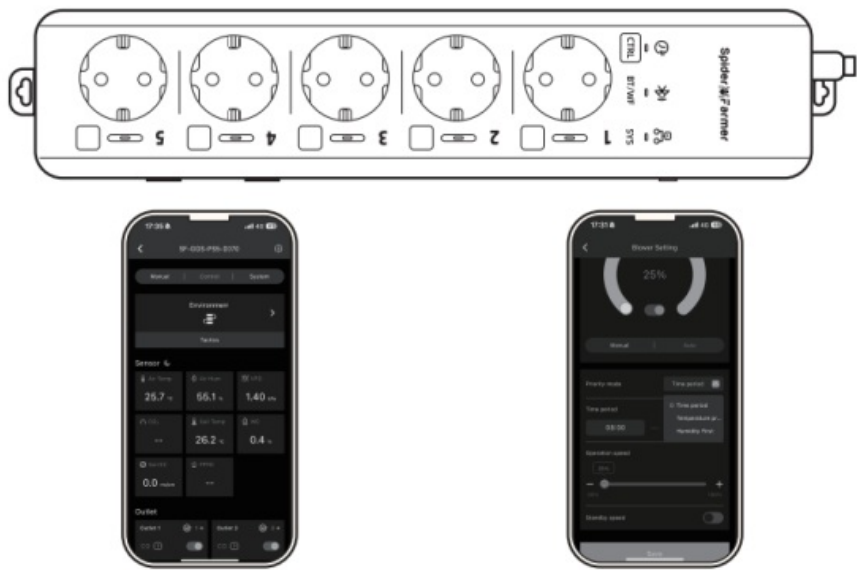
Find the Device-Click ‘Blower’ (inline fan)–Click ‘Auto’ to set the fan–3 Modes Available

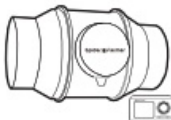

PACKAGE INCLUDES

				
Model	SF-4/6Inlinefan	SF-4/6Inlinefan-CP	SF-4/6filterkit	SF-filterkits4/6-CP
Inline Fan	1	1	1	1

Controller	Speed Controller	GGG Controller	Speed Controller	GGG Controller
Carbon Filter	0	0	1	1
RJ12 Cable	0	4	0	4
Strap	2	2	4	4
Ducting	0	0	1	1
Clamp	0	0	3	3
Vent Cover	0	0	2	2
Timer	0	0	1	0
Thermo-hygrometer	0	0	1	0

SAFETY PRECAUTIONS

- Operating temperature range: -20°C to 60°C (-4°F to 140°F).
- Environmental humidity range: 10%-98% RH (can withstand up to 45°C for 24 hours).
- Keep the fan away from children, especially the blades, electrical parts, and packaging materials.
- Improper use will void the manufacturer's warranty.

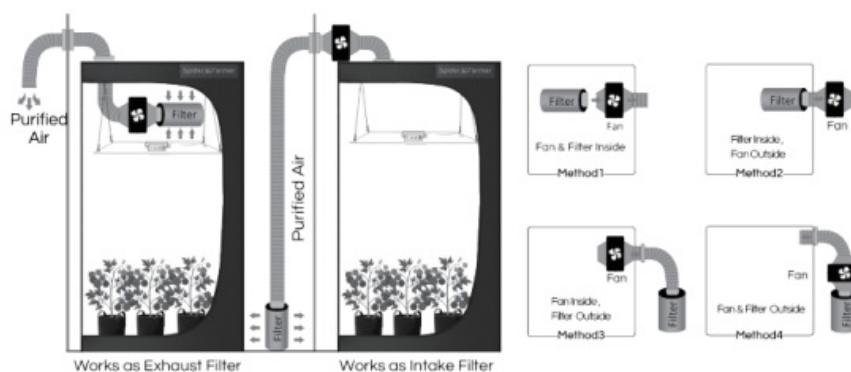

WARRANTY

Spider Farmer offers a warranty in the United States, Canada, the United Kingdom, the European Union, and Australia.

30-Day Return Policy

Returns or exchanges are accepted within 30 days of delivery if the product is in its original condition, including all original packaging, accessories, and gifts. For returns not due to quality issues, customers are responsible for return shipping costs.

2-Year Warranty

First Year:

Free repair, replacement, and shipping are provided for any quality issues.

Second Year:

Free replacement parts are provided, but customers are responsible for the shipping costs of the parts.

Important Notice

Unauthorized repairs, modifications, or improper use will void the warranty.

SPIDER FARMER APP



Android

<http://qrcode.android.spider-farmer.cn>



IOS

<http://qrcode.ios.spider-farmer.cn>

YOUR RELIABLE INDOOR GROW PARTNER

Follow Us on Social Media

Email: support@spider-farmer.com

info@spider-farmer.com



Documents / Resources

	Spider Farmer SF-4 Mixed Flow Inline Fan [pdf] User Manual SF-4 Mixed Flow Inline Fan, SF-4, Mixed Flow Inline Fan, Flow Inline Fan, Inline Fan, Fan
---	---

References

- [User Manual](#)

Spider Farmer

fan, Flow Inline Fan, Inline Fan, Mixed Flow Inline Fan, SF-4, SF-4 Mixed Flow Inline Fan, Spider Farmer

Leave a comment

Your email address will not be published. Required fields are marked *

Comment *

Name

Email

Website

☐ Save my name, email, and website in this browser for the next time I comment.

Post Comment

Search:

e.g. whirlpool wrf535swhz

Search

[Manuals+](#) | [Upload](#) | [Deep Search](#) | [Privacy Policy](#) | [@manuals.plus](#) | [YouTube](#)

This website is an independent publication and is neither affiliated with nor endorsed by any of the trademark owners. The "Bluetooth®" word mark and logos are registered trademarks owned by Bluetooth SIG, Inc. The "Wi-Fi®" word mark and logos are registered trademarks owned by the Wi-Fi Alliance. Any use of these marks on this website does not imply any affiliation with or endorsement.