



[Home](#) » [SPECTRUM](#) » **Spectrum MAX2V1X WiFi 6E Wall Mounted Router User Guide** 

Contents [[hide](#)]

- [1 Spectrum MAX2V1X WiFi 6E Wall Mounted Router](#)
- [2 Product Usage Instructions](#)
- [3 Advanced WiFi](#)
- [4 Spectrum WiFi 6E Wall-Mounted Router with Advanced WiFi](#)
- [5 Spectrum WiFi 6E with Advanced WiFi](#)
- [6 Technical Specs](#)
- [7 Federal Communications Commission Interference Statement](#)
- [8 Frequently Asked Questions](#)
- [9 Documents / Resources](#)
 - [9.1 References](#)



Spectrum MAX2V1X WiFi 6E Wall Mounted Router



Specifications:

- **Product Name:** Spectrum WiFi 6E Wall-Mounted Router
- **Advanced WiFi:** Yes
- **Compatibility:** iPhone and Android
- **Power Source:** Power supply or Power over Ethernet (PoE)
- **Security:** Personalized network name and password

Product Usage Instructions

Get Started with My Spectrum App:

To manage your internet, network security, and settings:

1. Scan the QR code with your smartphone camera or visit spectrum.net/getappnow.
2. Download the My Spectrum App on your iPhone or Android device.
3. Sign in with your Spectrum username and password. If you don't have one, create a username on Spectrum.net.

Personalize Your WiFi Network:

To secure your home network:

1. Create a unique network name and password with letters and numbers.
2. Change your network name and password using the My Spectrum App or on Spectrum.net.

Router Status Lights:

The front panel light indicates the router's status:

- Off: Device is off
- Blue Flashing: Booting up
- Blue Easing: Connecting to the Internet
- Blue Solid: Connected to the Internet
- Red Easing: Connectivity issues
- Red Solid: Critical issues

Back and Side Panel Features:

The router's back and side panel includes:

- Lock screw for security
- Power & Factory reset button for power cycling and resetting
- Ethernet (LAN) ports for local area network connection
- Internet (WAN) port for wide area network connection
- Power plug for power connection

Advanced WiFi

Your Spectrum WiFi 6E wall-mounted router delivers Advanced WiFi. You can conveniently manage your internet, network security and personalization settings in the My Spectrum App.

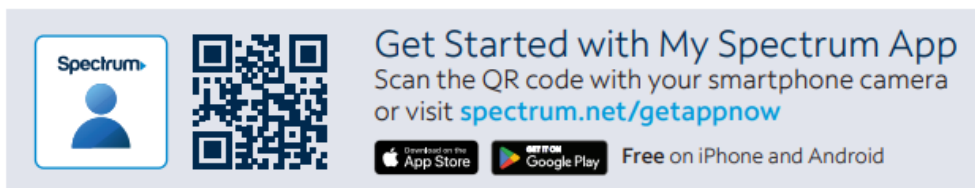

spectrum.net/getappnow

After downloading, sign in with your Spectrum username and password.

Don't have a Spectrum username? [Spectrum.net](https://spectrum.net) and select Create a Username.

With Advanced WiFi, you can:

- Set up a Spectrum WiFi Profile to access Spectrum Out-of-Home WiFi access points.
- Customize your WiFi network name (SSID) and password.
- View and manage devices connected to your WiFi network.
- Troubleshoot your equipment and fix service-related issues.
- Add, remove, pause or resume WiFi access for a device or group of devices on your network.
- Get port forwarding support for improved gaming performance.
- Turn off/turn on UPnP support.

- Ability to configure the DNS server address.
- Have peace of mind with a secure WiFi network featuring Spectrum Security Shield.
- Use both wireless and Ethernet connectivity.
- Add or remove up to 5 WiFi Pods per router.
- Browse your current plans, add services, upgrade your service and view current offers.

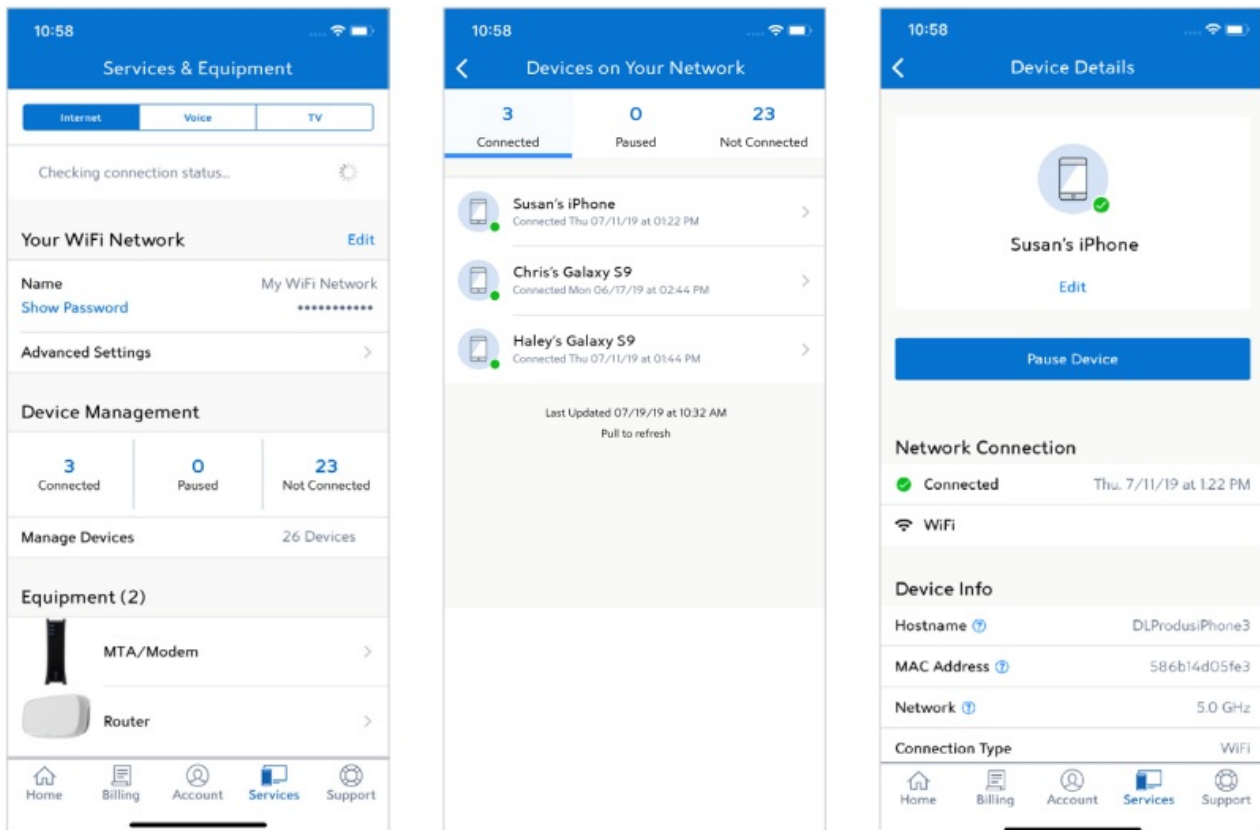

Personalize Your WiFi Network Name and Password

To secure your home network, you must create a unique network name and a password containing letters and numbers. You can change your network name and password in the My Spectrum App or on Spectrum.net

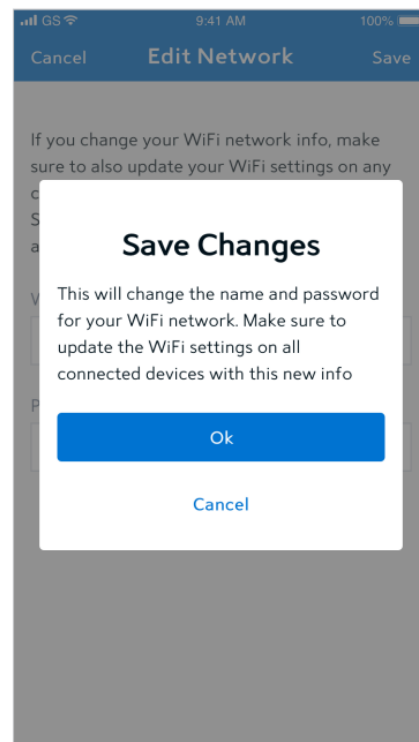
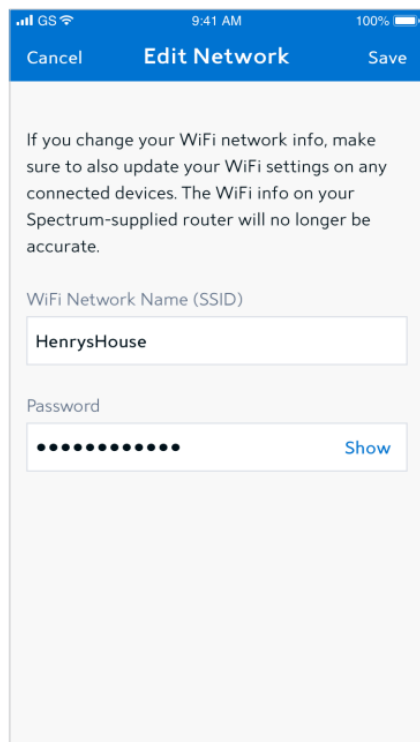
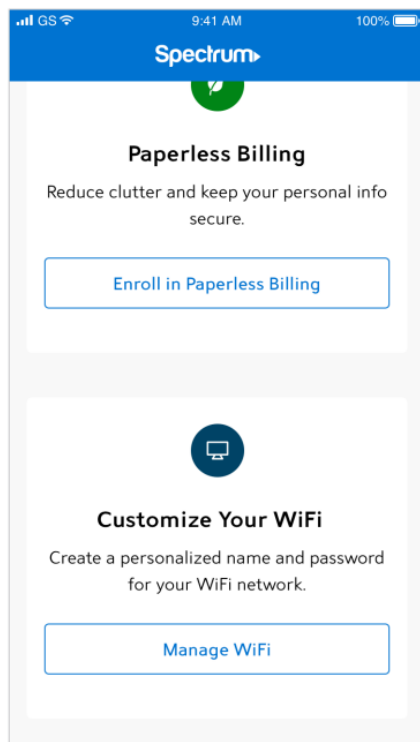

Spectrum WiFi 6E Wall-Mounted Router with Advanced WiFi

The front panel has a light that indicates the router's status while starting up your home network.

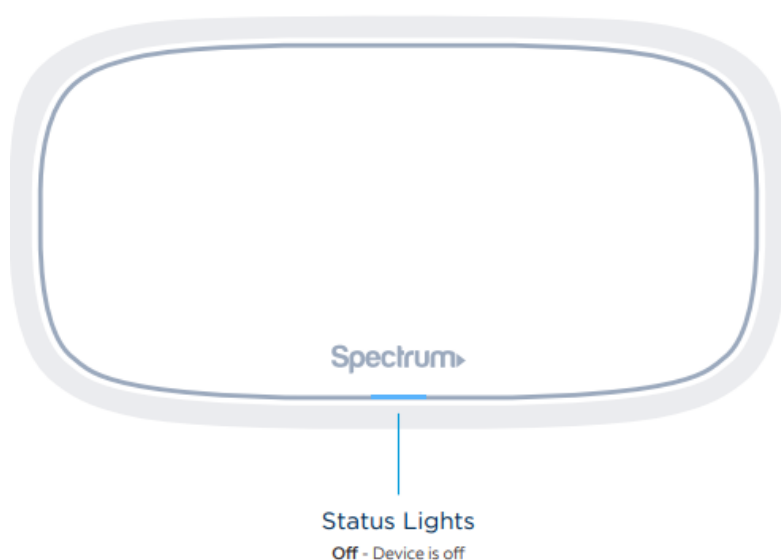

- **Blue** Flashing with 1000ms interval (500 ms on, 500 ms off) – Booting up
- **Blue** Easing with 5s interval – Connecting to the Internet
- **Blue** Solid – Connected to the Internet
- **Red** Easing with 5s interval – Connectivity issues (no internet connection OR)
- **Red** and **Blue** cycle easing with 2.5s interval – Updating firmware (or any scenario where device must not be restarted)
- **Red** Solid – Critical issues (hardware or otherwise)

- **Red** and **White** thermal panic mode – Critical issues (hardware or otherwise)

Spectrum WiFi 6E Wall-Mounted Router with Advanced WiFi

The router's back and side panel features:

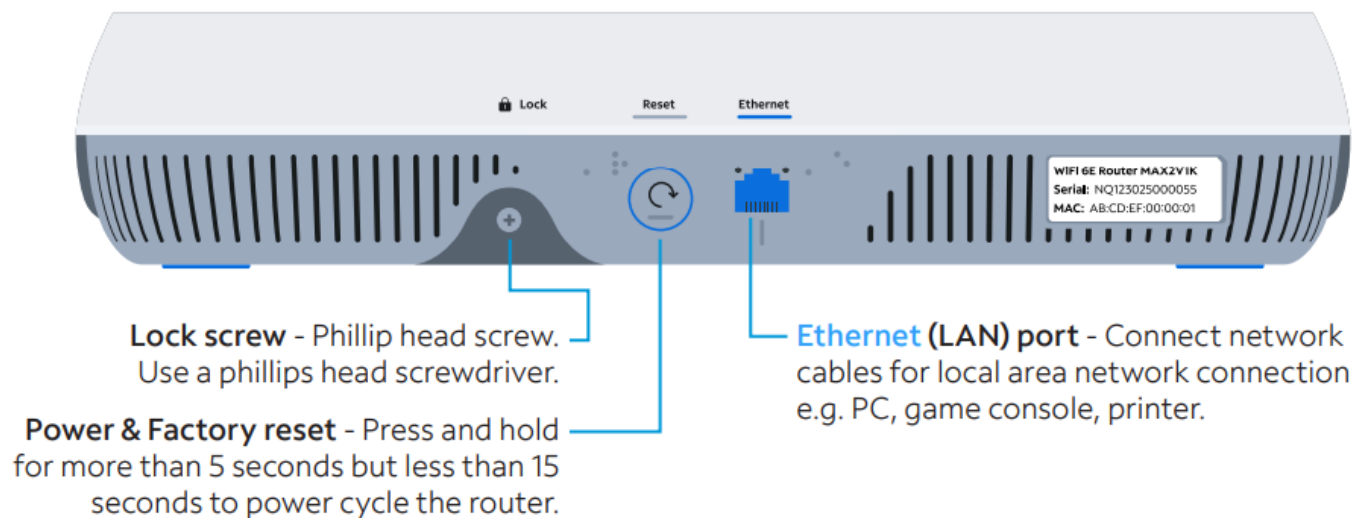

Press and hold for more than 15 seconds to reset router to factory default settings.

Warning: Your personalized configurations will be removed.

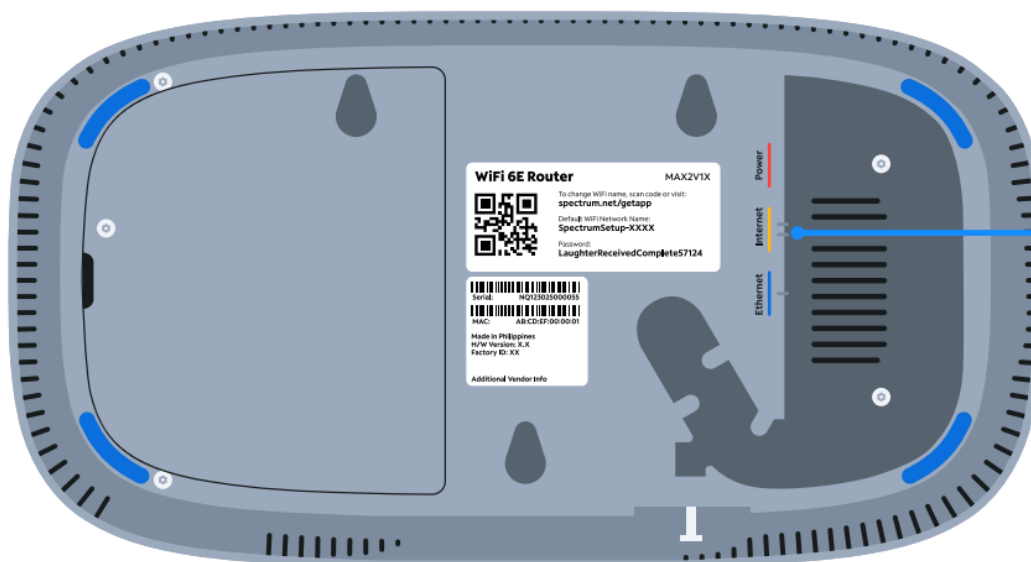
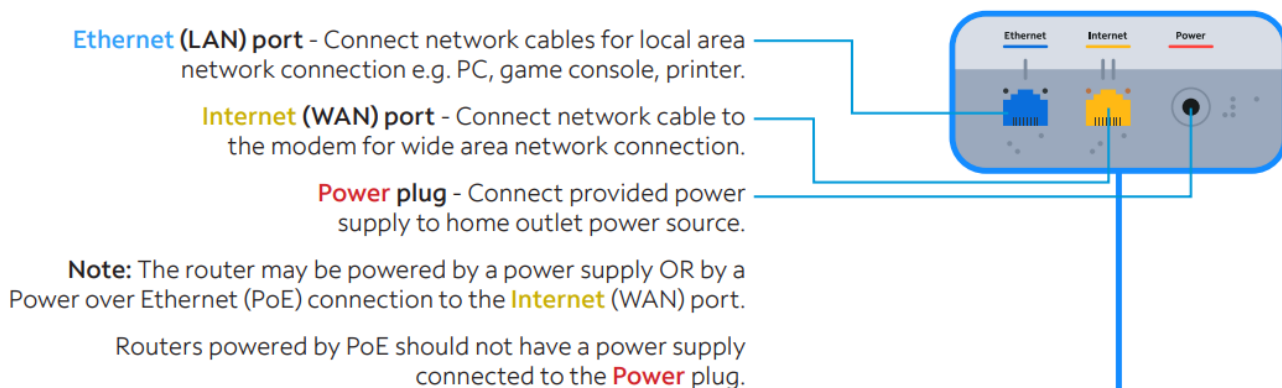

The router's back and side panel tactile and Braille markers:

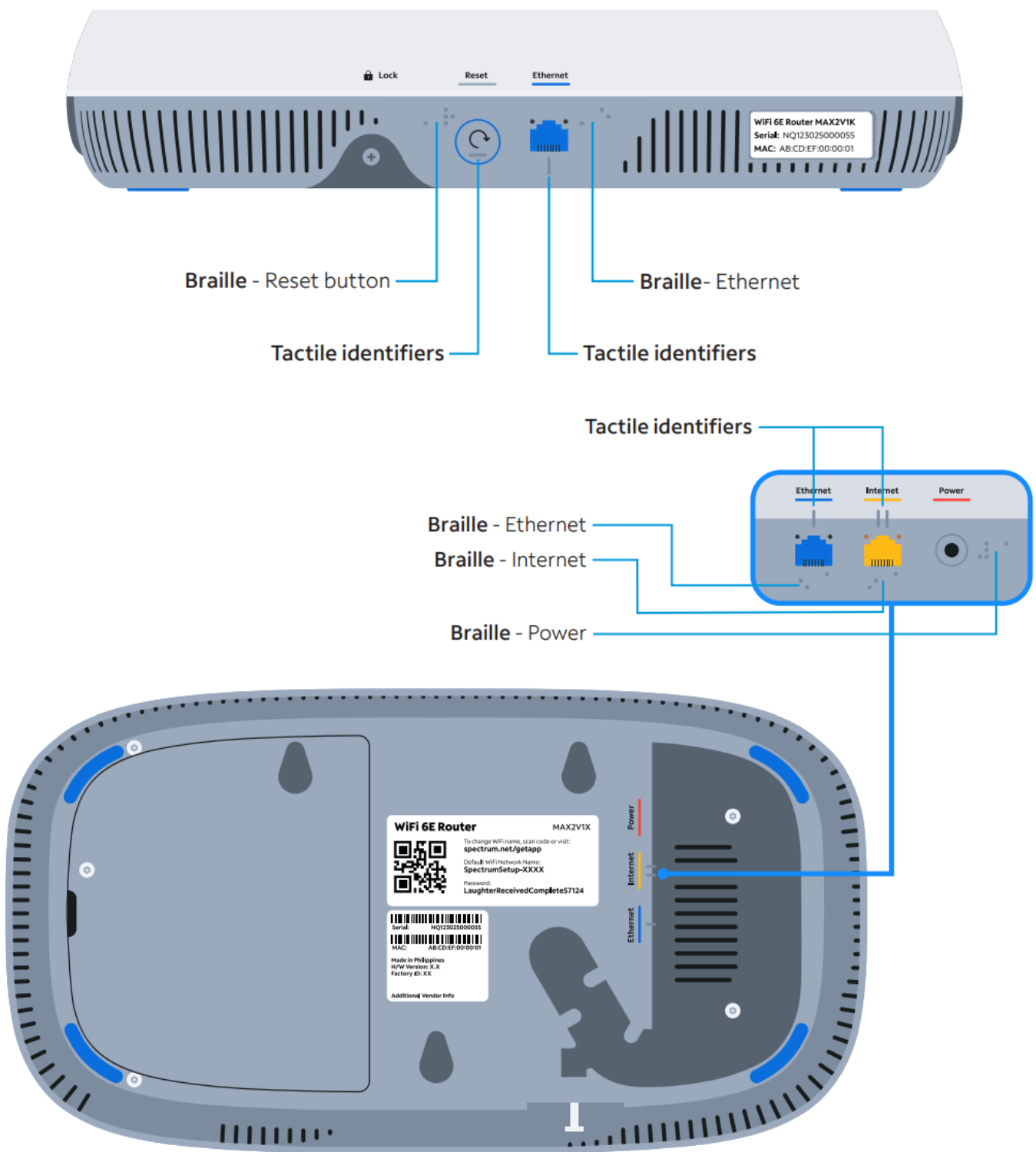

Spectrum WiFi 6E with Advanced WiFi

The router's label callouts:

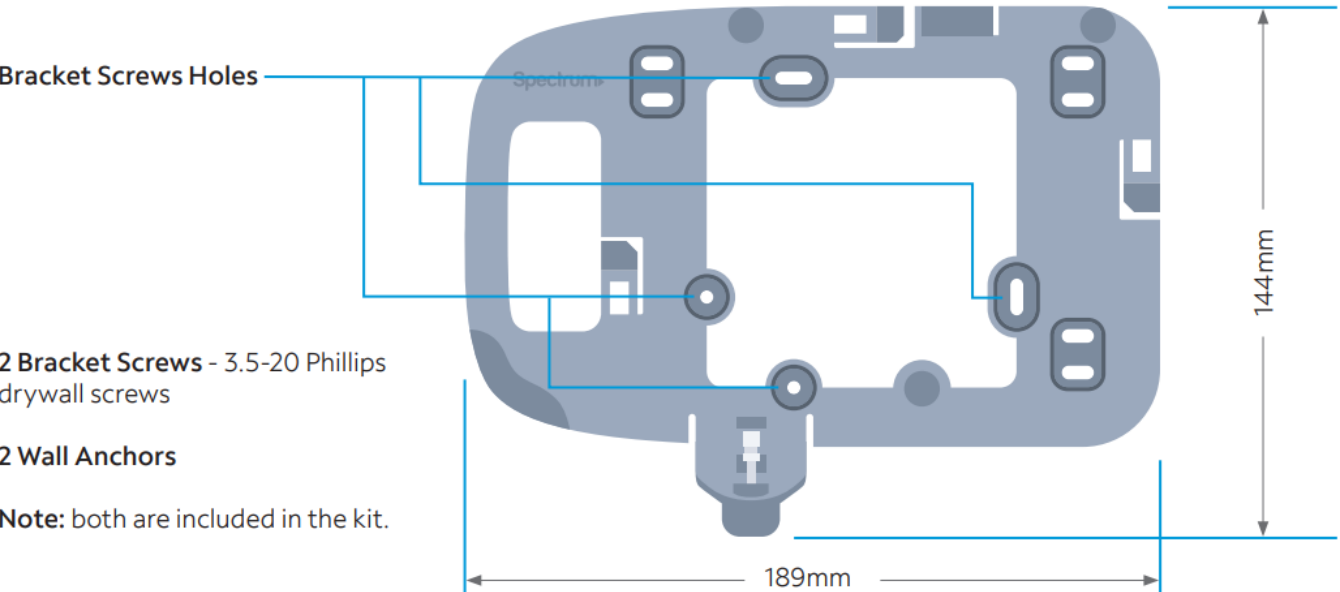
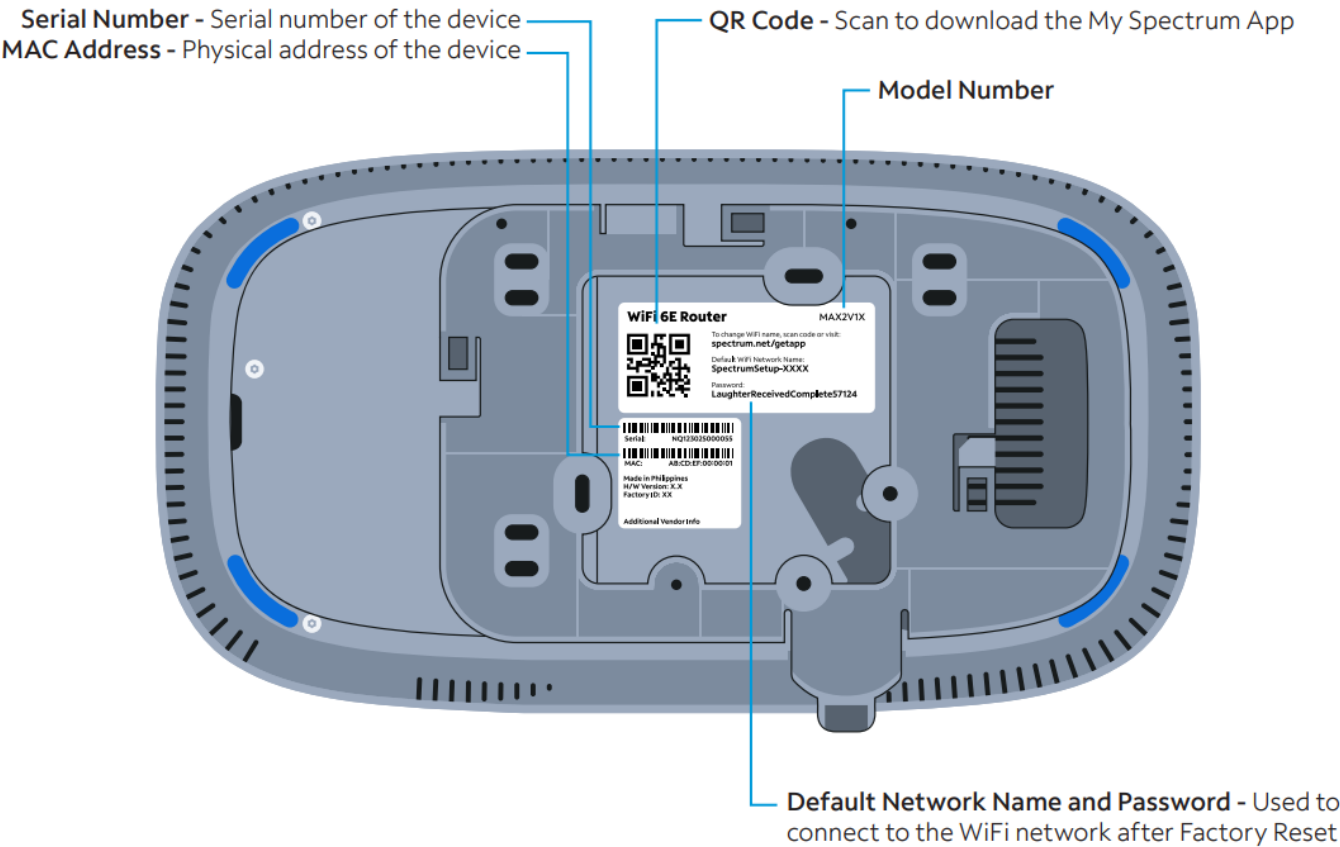

Technical Specs

Spectrum WiFi 6E Wall-Mounted Router Technical Specs

Features	Benefits
----------	----------

<p>IEEE 802.11a/b/g, WiFi 4 (802.11n), WiFi 5 (802.11ac), & WiFi 6E (802.11ax-2020) support</p> <p>Concurrent 2.4 GHz, 5 GHz, and 6 GHz frequency band support</p>	<ul style="list-style-type: none"> • Supports existing client devices in the home and all newer devices using higher frequencies, including the latest WiFi 6E capable devices. • Provides flexibility in range for WiFi signal to cover the home. • Future capability upgrade to support AFC (Automated Frequency Coordination) which enables the WiFi 6E router to potentially increase the power of the 6 GHz radio from LPI (Low Power Indoor) default mode to SP (Standard Power) mode. Enables the 6 GHz band to have almost the same level of reach as the 5 GHz band.
<p>2.4 GHz WiFi Radio – 802.11ax 4x4:4</p> <p>Active Antenna</p> <p>5 GHz WiFi Radio – 802.11ax 4x4:4</p> <p>Active Antenna</p> <p>6 GHz WiFi Radio – 802.11ax 4x4:4</p> <p>Passive Antenna</p>	<ul style="list-style-type: none"> • More data per packet transition provides higher throughput and increased range improving experience, especially in client dense environments. • Delivers higher data rates and bandwidth for the 2.4 GHz and 5 GHz frequency bands as well as support for almost 1,200 MHz of the 6 GHz frequency band. • Unified SSID enables intelligent client steering – optimizes client device connectivity to best frequency band, channel, and access point. • Prevents client devices from “sticking” to a specific non-optimized band as the client moves around or if the channel becomes congested due to external interference.

WiFi Channel Bandwidths	<ul style="list-style-type: none"> • 2.4 GHz – 20 / 40 MHz • 5 GHz – 20 / 40 / 80 / 160 MHz (includes lower 45 MHz of U-NII-4 band) • 6 GHz – 20 / 40 / 80 / 160 MHz (excludes first 160 MHz of 1,200 MHz)
802.11ax-2020 WiFi 6E chipsets with higher processing power	<p>Supports consistent performance where there is a higher density of WiFi devices connecting to the network.</p> <p>Powerful chips encode/decode signals, allowing better network and device management.</p>
Latest industry-standard WiFi security (WPA3 Personal, WPA2 Personal)	<p>Supports WPA3 Transitional. This enables support for both the WPA3 Personal (2022 version) standard, which is the highest security standard available to date, as well as the older WPA2 Personal (2004) standard to protect devices on the WiFi network.</p> <p>Note: Only 6 GHz band supports WPA3 Personal, WPA2 Personal is supported on 2.4 GHz and 5 GHz bands .</p>
Two 2.5 MultiGig LAN ports	<p>Connect stationary computers, game consoles, printers, media sources and other devices on the private network for high-speed service. These two Ethernet PHYs support the following standards:</p> <ul style="list-style-type: none"> • IEEE 802.3bz 2.5GBASE-T, 2.5G NBASE-T spec, IEEE 802.3ab 1000BASE-T, IEEE 802.3u 100BASE-TX

One 10 MultiGig WAN port	<p>Connect to Internet port of Cable Modem, Spectrum eMTA or Spectrum ONU. This Ethernet PHY supports the following standards:</p> <ul style="list-style-type: none"> • IEEE 802.3an 10GBASE-T, IEEE 802.3bz 5GBASE-T / 2.5GBASE-T, 5G / 2.5G NBASE-T spec, IEEE 802.3ab 1000BASE-T, IEEE 802.3u 100BASE-TX
More Specifications	<ul style="list-style-type: none"> • Integrated fan provides optimum temperature regulation with ultra-quiet operation (under 30dBA) even under the most demanding loads. • IPv4 and IPv6, DHCP, DSCP tag support, Wi-Fi® Easy Connect, Connectivity with Spectrum WiFi Pods, Spectrum Mobile Speed Boost • Primary Power Source: 802.3bt Type 3 60W-capable PoE++ Injector: 48VDC/1.25A • Alternative Power Source: Spectrum PSU2 36W: 12VDC/3A • Dimensions: 11.5" x 6.2" x 2.28"

Need Help or Have Questions?

We're here for you. To learn more about your services or get support, visit spectrum.net/support or call us at (833)798-0166.

Federal Communications Commission Interference Statement

This device complies with Part 15 of the FCC Rules. Operation is subject to the following two conditions: (1) This device may not cause harmful interference, and (2) this device must accept any interference received, including interference that may cause undesired operation.

This equipment has been tested and found to comply with the limits for a Class B digital device, pursuant to Part 15 of the FCC Rules. These limits are designed to provide reasonable protection against harmful interference in a residential installation. This equipment generates, uses and can radiate radio frequency energy and, if not installed and used in accordance with the instructions, may cause harmful interference to radio communications. However, there is no guarantee that interference will not occur in a particular installation. If this equipment does cause harmful interference to radio or television reception, which can be determined by turning the equipment off and on, the user is encouraged to try to correct the interference by one of the following measures:

- Reorient or relocate the receiving antenna.
- Increase the separation between the equipment and receiver.
- Connect the equipment into an outlet on a circuit different from that to which the receiver is connected.
- Consult the dealer or an experienced radio/TV technician for help.

FCC Caution: Any changes or modifications not expressly approved by the party responsible for compliance could void the user's authority to operate this equipment. This transmitter must not be co-located or operating in conjunction with any other antenna or transmitter.

This device meets all the other requirements specified in Part 15E, Section 15.407 of the FCC Rules.

Radiation Exposure Statement:

This equipment complies with FCC radiation exposure limits set forth for an uncontrolled environment. This equipment should be installed and operated with minimum distance 20cm between the radiator & your body.

Note: The country code selection is for non-US model only and is not available to all US model. Per FCC regulation, all WiFi product marketed in US must be fixed to US operation channels only.

FCC regulations restrict the operation of this device to indoor use only.

- The operation of this device is prohibited on oil platforms, cars, trains, boats, and aircraft, except that operation of this device is permitted in large aircraft while flying above 10,000 feet.
- Operation of transmitters in the 5.925-7.125 GHz band is prohibited for control of or communications with unmanned aircraft systems.

© 2023 Charter Communications, all rights reserved.

Frequently Asked Questions

How do I reset the router to factory default settings?

Press and hold the Power & Factory reset button for more than 15 seconds. Note that personalized configurations will be removed.

What should I do if the router status light shows red solid?

A red solid light indicates critical issues. Please contact customer support for assistance.

Documents / Resources

 <small>Spectrum WiFi 6E Wall Mounted Router</small> <small>Spectrum</small>	Spectrum MAX2V1X WiFi 6E Wall Mounted Router [pdf] User Guide MAX2V1X WiFi 6E Wall Mounted Router, MAX2V1X, WiFi 6E Wall Mounted Router, Wall Mounted Router, Mounted Router
---	---

References

- [User Manual](#)

■ SPECTRUM

🔍 MAX2V1X, MAX2V1X WiFi 6E Wall Mounted Router, Mounted Router, spectrum, Wall Mounted Router, WiFi 6E Wall Mounted Router

Leave a comment

Your email address will not be published. Required fields are marked *

Comment *

Name

Email

Website

☐ Save my name, email, and website in this browser for the next time I comment.

Post Comment

Search:

e.g. whirlpool wrf535swhz

Search

[Manuals+](#) | [Upload](#) | [Deep Search](#) | [Privacy Policy](#) | [@manuals.plus](#) | [YouTube](#)

This website is an independent publication and is neither affiliated with nor endorsed by any of the trademark owners. The "Bluetooth®" word mark and logos are registered trademarks owned by Bluetooth SIG, Inc. The "Wi-Fi®" word mark and logos are registered trademarks owned by the Wi-Fi Alliance. Any use of these marks on this website does not imply any affiliation with or endorsement.