



## speco technologies V5B2 Security Dome Camera User Manual

[Home](#) » [speco technologies](#) » speco technologies V5B2 Security Dome Camera User Manual 

speco technologies V5B2 Security Dome Camera



## Contents

- [1 Thank you!](#)
- [2 Warnings](#)
- [3 Introduction](#)
- [4 Installation](#)
  - [4.1 Mounting for V5B2/V5B2M](#)
  - [4.2 Mounting for Dome Camera](#)
  - [4.3 Mounting for V5T2/V5T2M](#)
- [5 Specifications](#)
- [6 Federal Communications Commission \(FCC\) Statements](#)
- [7 FCC Responsible Party](#)
- [8 Documents / Resources](#)
  - [8.1 References](#)
- [9 Related Posts](#)

## Thank you!

Thank you for purchasing our product. Speco Technologies is constantly developing and improving products. We reserve the right to modify product design and specifications without notice and without incurring any obligation.

## Warnings

- If the product does not work properly, please contact the dealer or where the product was purchased. Speco Technologies is not responsible for any problems caused by improper operation or repair.
- Do not expose the unit to heavy stress, violent vibration or long-term exposure to water and humidity during

transportation, storage, and/or installation.

- Do not install near sources of heat.
- Only install the product in environments inside the specification operating temperature and humidity range.
- Do not install the camera near power lines, radar equipment or other electromagnetic radiation.
- Do not block any ventilation openings if any.
- Use all the weatherproofing hardware requirement to minimize weather intrusion.

## Introduction

This camera series is the latest technology and advanced circuit design, which features high definition and sensitivity, low noise and distortion and supports HD video transmission with the common coaxial cable, ensuring the requirement of the HD monitoring in the traditional surveillance system.

- High Resolution

Adopt high performance sensor, providing high definition and clear image.

- High Transmission Performance

Real-time transmission with high speed and long distance.

- DNR

Reduce noise from brightness and color signal.

- OSD

Access the camera settings which can be clearly displayed through the main menu.

- White Balance

Adjust the color temperature according to the environment automatically.

- ICR Auto Switch

The filter will filter infrared light during the daytime and change to normal at night to ensure a high sensitivity and clear image.

- AGC

Adjust the gain of amplifier, enabling the camera to output the standard video signal in different lighting condition.

- Wide Dynamic Range (WDR)

When there are both very bright and very dark areas simultaneously in the field of view, this function will balance the brightness level and provide clear images.

- Backlight Compensation (BLC)

When the back of the captured object is too much bright, you can set BLC for the captured object to make it clearer.

## Cables

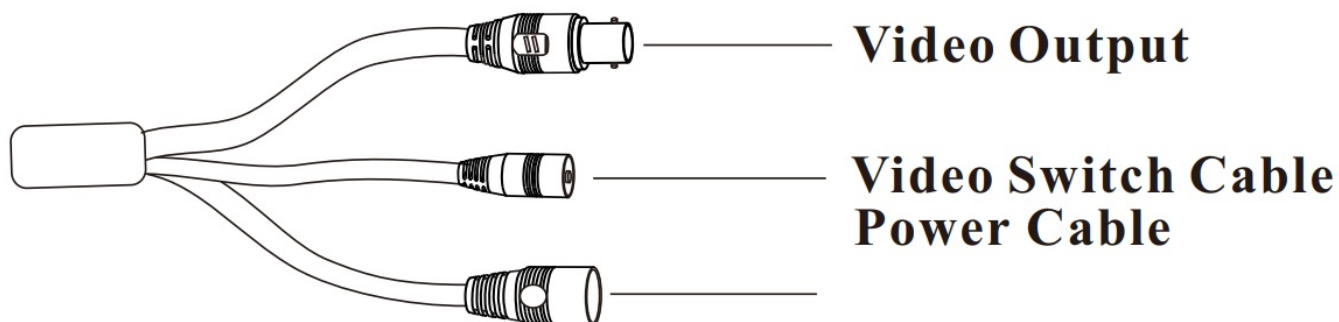

Video Switch: Four video output modes can be optional–AHD, TVI, CVI and CVBS (a) remove the cover of the video switch cable; (b) hold and press the button in the video switch cable for 5 seconds to switch the current video output.

## Installation

Before you start, please make sure that the wall or ceiling is strong enough to withstand three times the weight of the camera. Please install and use the camera in the dry environment.

You'd better install back the lens cover or lower dome less than 4 hours after removing it.

The mounting types of cameras are only for reference.

### Mounting for V5B2/V5B2M

1. Drill the screw holes and the cable hole on the wall according to the drill template.

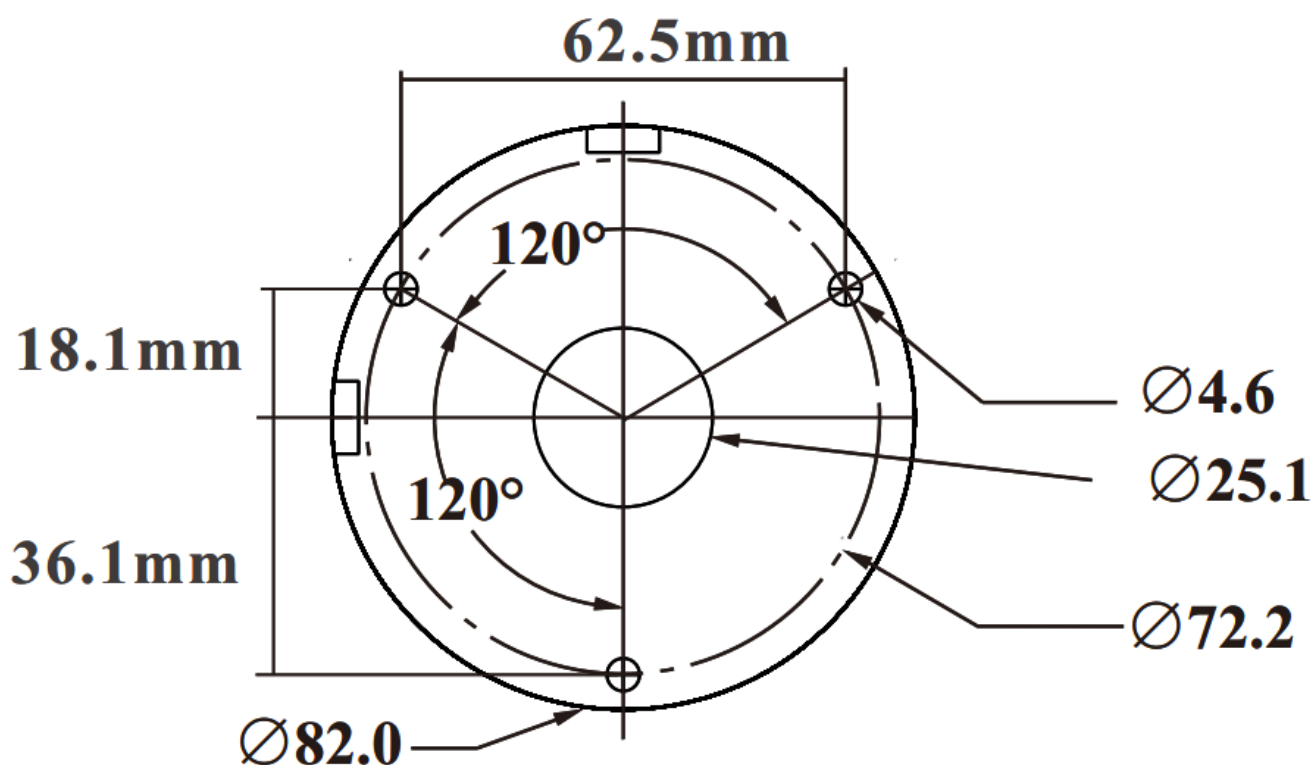

2. Route and connect the cables .
3. Secure the mounting base with camera to the wall with screws as shown below.

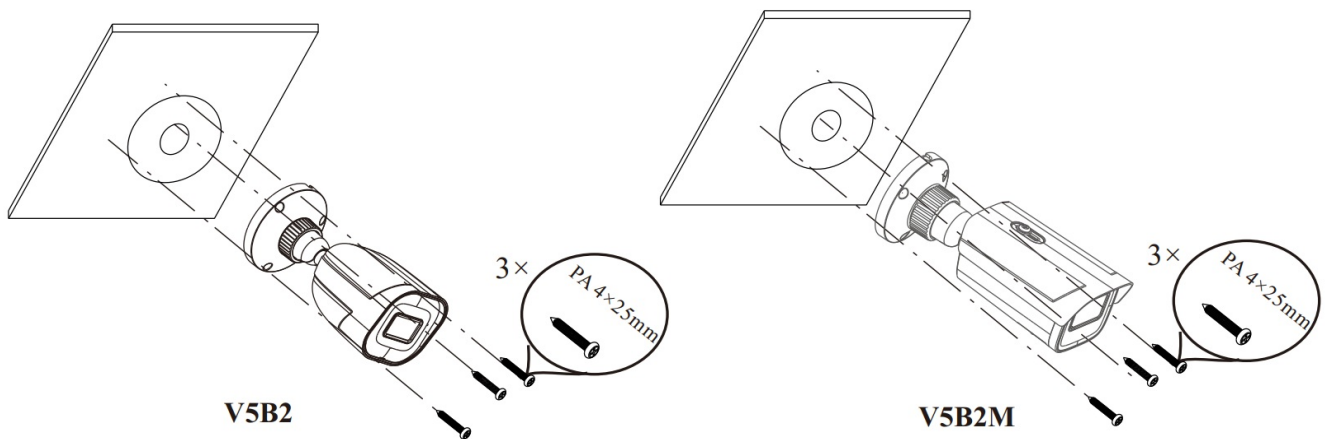

4. Bracket adjustment. Before adjustment, preview the image of the camera on a monitor and then loosen the fixed ring to adjust the view angle of the camera. Tighten the fixed ring after the adjustment.

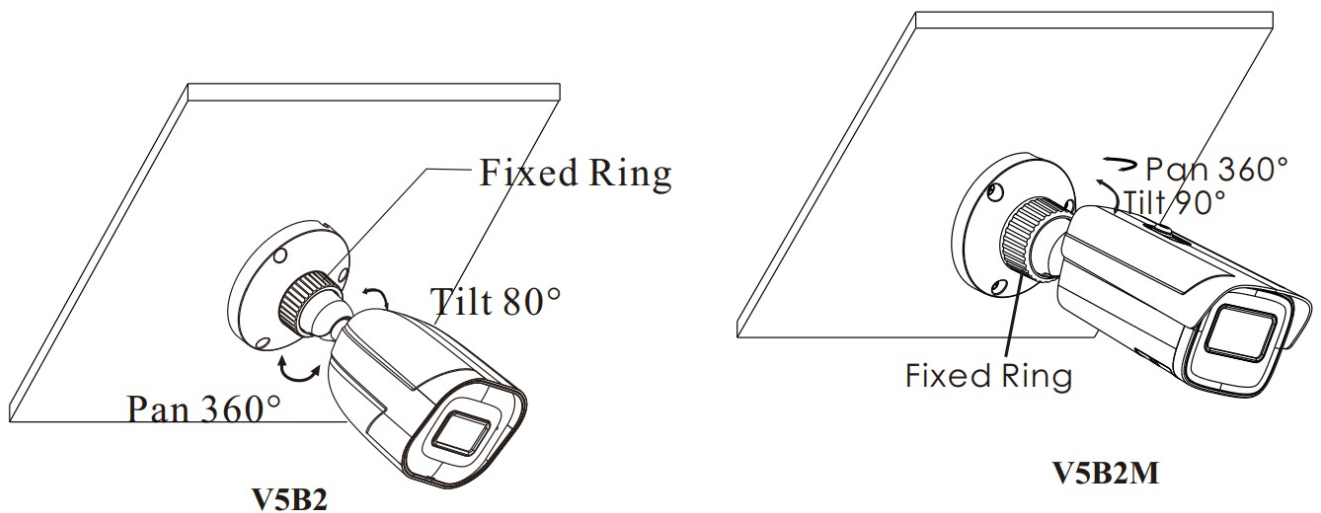

#### Mounting for Dome Camera

#### Mounting for V5D2/V5D2M

1. Attach the drill template to the place where you want to fix the camera and then drill the screw holes and the cable hole on the wall according to the drill template.

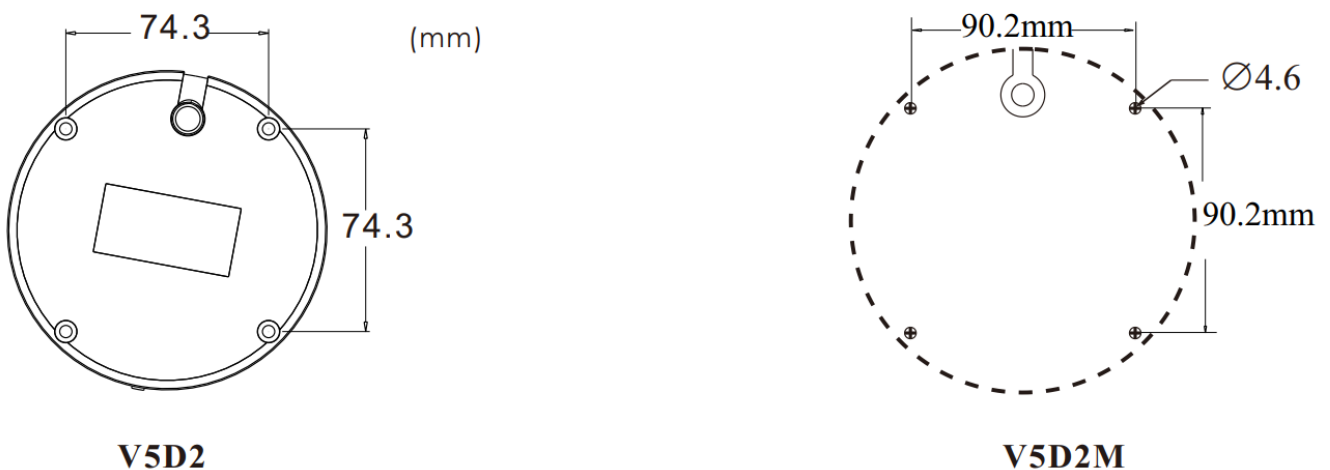

2. Align the gap of the trim ring with the microphone by turning the trim ring with fingers. Then remove the trim ring from the gap of the camera.
3. Loosen the screws to open the lower dome. Then route and connect the cables.

4. Secure the camera to the wall with screws provided as shown below.

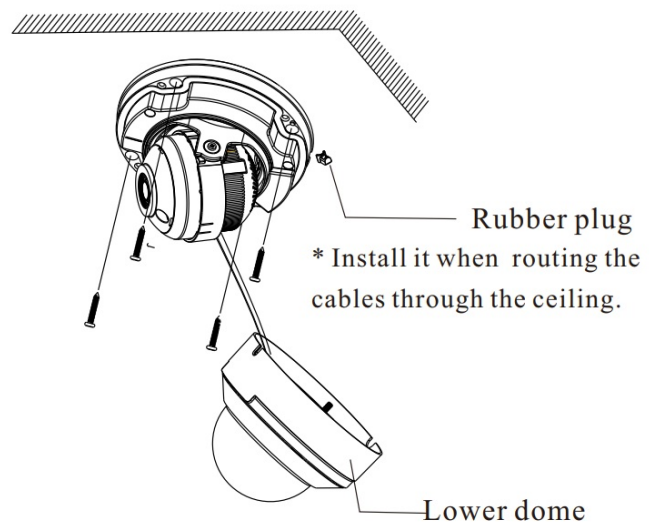
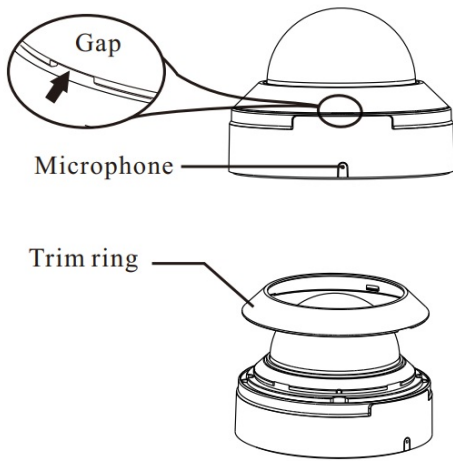

5. Three-axis adjustment. Before adjustment, preview the image of the camera on a monitor and then adjust the camera according to the figure below to get an optimum angle.

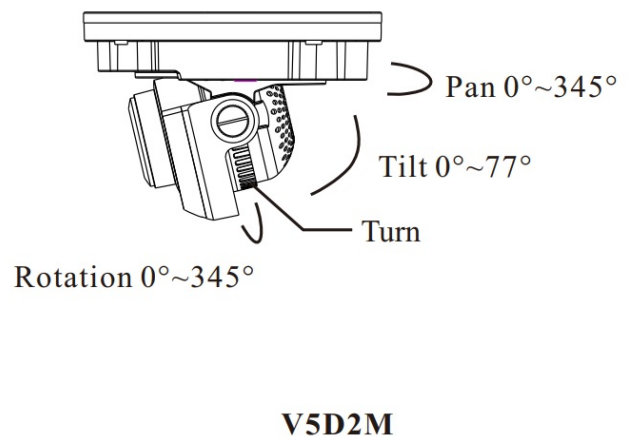
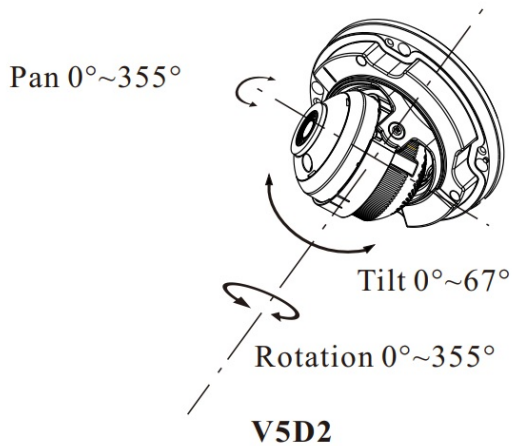

6. Install the lower dome back to the camera and fix it with screws. Then put the trim ring onto the lower dome and then rotate it clockwise until it is locked. Finally, remove the protection film softly.

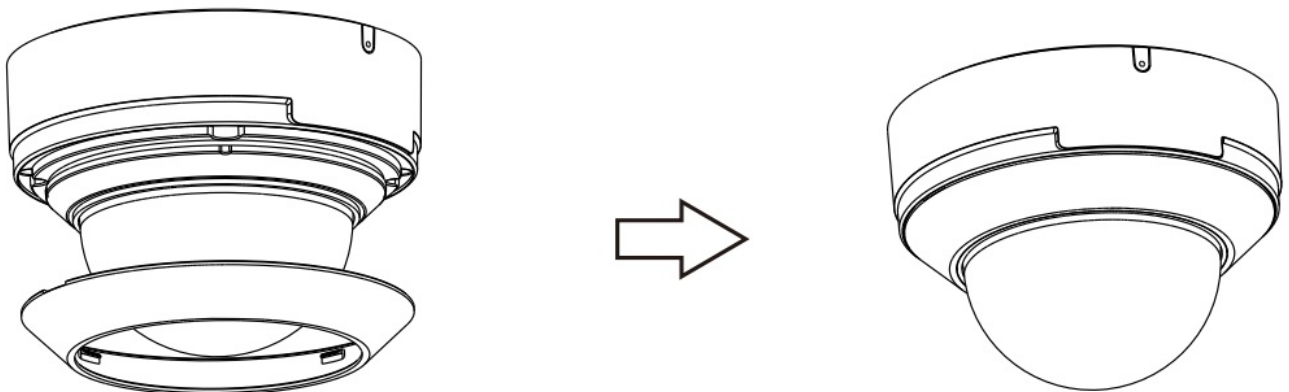

#### Mounting for V5T2/V5T2M

1. Drill the screw holes and the cable hole on the wall according to the drill template .

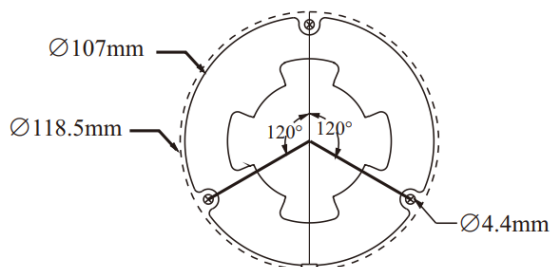

**V5T2**

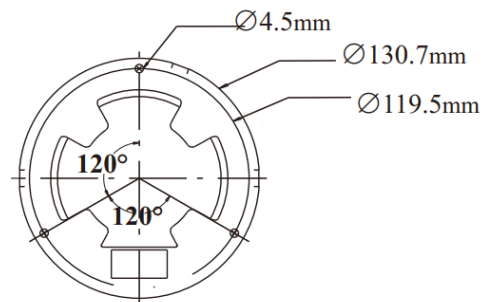

**V5T2M**

2. Loosen the fixed screw to disassemble the camera.

3. Route and connect the cables. Then secure the mounting base to the ceiling or wall with the screws provided.

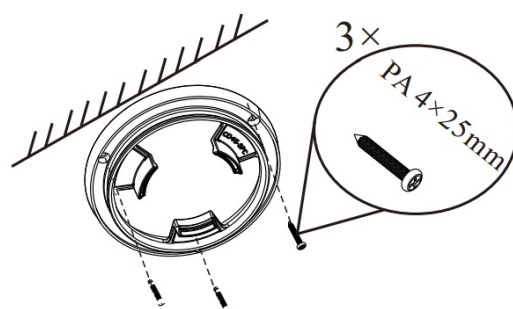
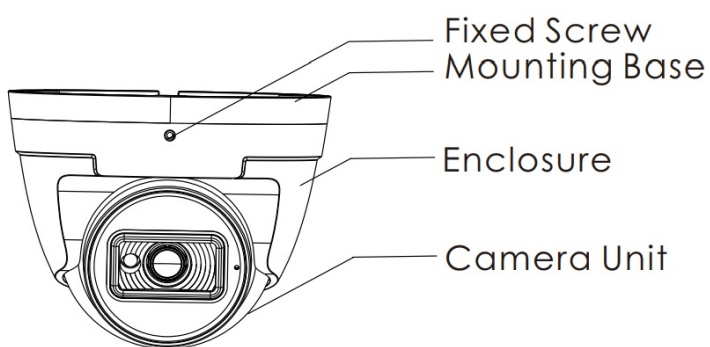

4. Install the camera unit and enclosure to the mounting base and then adjust the dome to obtain an optimum view angle. Finally, secure the camera with the fixed screw.

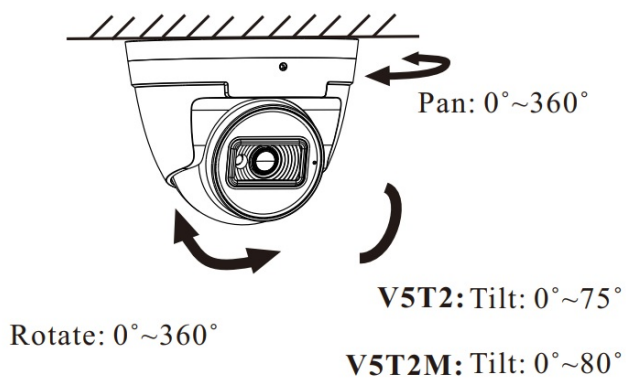
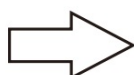
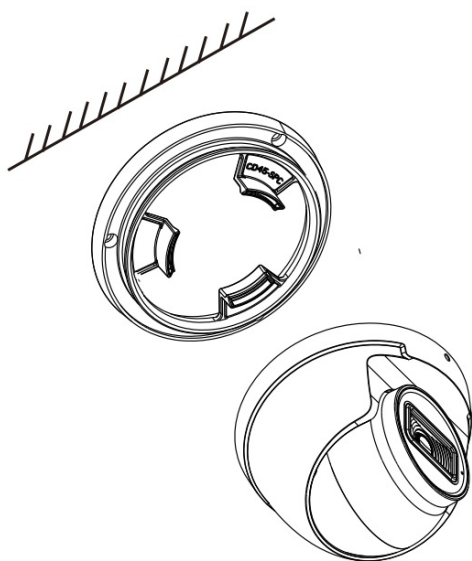

## Specifications

Models	V5B2	V5B2M	V5D2
Specifications			
Camera			

Image Sensor	1/2.7" CMOS		
Resolution	5MP		
Image size	2560×1936		
Video Output	AHD/TVI/CVI/CVBS (*camera comes defaulted to HD-TVI)		
Image System	PAL/NTSC		
Electronic Shutter	Auto; 1/50s~1/100000s(PAL);1/60s~1/100000s (NTSC)		
IR Distance (feet)	65.6~98.4	98.4~164.0	65.6~98.4
Frame Rate	20fps		
Min. Illumination	Color:0.01lux@F1.2, AGC ON; B/W: 0lux with IR		
Lens	2.8mm	2.8~12mm (motorized)	2.8mm
Lens Mount	M12	D14	M12
S/N Ratio	≥ 52dB(AGC OFF)		
Ingress Protection	IP67	IP67	IP67&IK10
Functions			
Function Control	OSD (UTC control)		
Day &Night	ICR		
DWDR	Yes		
Digital NR	Yes		
AGC	Yes		
Auto White Balance	Yes		
Defog	No		
BLC	Yes		
LSC	Yes		



Mirror	Yes		
Sharpness	Yes		
Smart IR	Yes		
Image Setting	Yes		
Defect Correction	Auto		
Others			
Power Supply	DC12V (± 10%)		
Power Consumption	IR OFF: < 1W; IR ON : < 4W	IR OFF: < 1W; IR ON : < 6W	IR OFF: < 1W; IR ON : < 4W
Working Environment	-22 °F ~ 122 °F, 10 % ~ 90 %(relative humidity)		
Dimensions (inch)	6.74×3.27×3.26	8.66×3.39×3.38	Φ4.72 × 3.45

Models	V5D2M	V5T2	V5T2M
Specifications			
Camera			
Image Sensor	1/2.7" CMOS		
Resolution	5MP		
Image size	2560×1936		
Video Output	AHD/TVI/CVI/CVBS (*camera comes defaulted to HD-TVI)		
Image System	PAL/NTSC		
Electronic Shutter	Auto; 1/50s~1/100000s(PAL);1/60s~1/100000s (NTSC)		
IR Distance (feet)	98.4~164.0	65.6~98.4	98.4~164.0
Frame Rate	20fps		
Min. Illumination	Color:0.01lux@F1.2, AGC ON; B/W: 0lux with IR		

Lens	2.8~12mm (motorized)	2.8mm	2.8~12mm (motorized)
Lens Mount	D14	M12	D14
S/N Ratio	≥ 52dB(AGC OFF)		
Ingress Protection	IP67&IK10	IP67	IP67
Functions			
Function Control	OSD (UTC control)		
Day &Night	ICR		
DWDR	Yes		
Digital NR	Yes		
AGC	Yes		
Auto White Balance	Yes		
Defog	No		
BLC	Yes		
LSC	Yes		
Mirror	Yes		
Sharpness	Yes		
Smart IR	Yes		
Image Setting	Yes		
Defect Correction	Auto		
Others			
Power Supply	DC12V (± 10%)		
Power Consumption	IR OFF: < 1W; IR ON : < 6W	IR OFF: < 1W; IR ON : < 4W	IR OFF: < 1W; IR ON : < 6W
Working Environment	-22 °F ~ 122 °F, 10 % ~ 90 %(relative humidity)		

Dimensions (inch)	Φ5.61 × 3.95	Φ4.67 × 3.69	Φ4.21 × 5.16
-------------------	--------------	--------------	--------------

**Model:** V5B2/V5B2M/V5D2/V5D2M/V5T2/V5T2M

**Federal Communications Commission (FCC) Statements**

This device complies with Part 15 of the FCC Rules. Operation is subject to the following two conditions: (1) This device may not cause harmful interference, and (2) This device must accept any interference received, including interference that may cause undesired operation.

**FCC Responsible Party**

Speco Technologies  
200 New Highway  
Amityville, NY 11701  
[www.specotech.com](http://www.specotech.com)



**Documents / Resources**

	<p><a href="#">speco technologies V5B2 Security Dome Camera</a> [pdf] User Manual V5B2, V5T2, V5D2, V5B2M, V5D2M, V5T2M, V5B2 Security Dome Camera, Security Dome Camera, Dome Camera, Camera</p>
---	---

**References**

- [speco Home | Speco Technologies](#)