

speco technologies O4LT1 4 Megapixel IP Advanced Analytics
Turret Camera



speco technologies O4LT1 4 Megapixel IP Advanced Analytics Turret Camera User Guide

[Home](#) » [speco technologies](#) » speco technologies O4LT1 4 Megapixel IP Advanced Analytics Turret Camera User Guide 

Contents

- [1 speco technologies O4LT1 4 Megapixel IP Advanced Analytics Turret Camera](#)
- [2 Product Usage Instructions](#)
- [3 Important Safeguards and Warning](#)
- [4 Package](#)
- [5 Overview](#)
 - [5.1 Connecting Network Cable](#)
- [6 Installation](#)
- [7 Web Operation and Login](#)
- [8 Documents / Resources](#)
 - [8.1 References](#)



speco technologies O4LT1 4 Megapixel IP Advanced Analytics Turret Camera



Specifications:

- **Camera Type:** Network Camera
- **Power Supply:** 12VDC Class 2 power supply or PoE
- **Features:** CMOS sensor, Microphone, Micro SD card slot
- **Connectors:** Ethernet, Audio input, Power
- **Additional Components:** Junction box, Screw anchors, Drill Template, Rubber o-rings, Screwdriver

Product Usage Instructions

Electrical Safety:

Ensure all installation and operation adhere to local electrical safety codes. Use a certified 12VDC power supply or PoE switch. Ground the product to reduce electric shock risk.

Operation and Maintenance:

Before maintenance, shut down and unplug the device. Avoid touching the CMOS sensor optic component. Clean lens dust with a blower and use a dry cloth for the device.

Installation:

Ensure the wall/ceiling can support camera weight. Open the mounting base and junction box covers. Attach the junction box drill template, install it on the wall using provided screws.

SD Card Installation:

Disassemble the camera by loosening the set screw. Insert the SD card and reassemble the camera ensuring the cover is fixed evenly with screws.

Connecting Network Cable:

1. Loosen nut from the main element.
2. Run network cable through elements and crimp RJ45 connector.
3. Connect cable to water-proof connector and tighten nut and cover.

FAQ:

Q: Can I install the camera outdoors?

A: Yes, it is recommended to use the water-proof connector for outdoor installations.

Q: What should I do if a component is missing in the package?

A: Before installation, ensure all components are included.

Contact Speco customer service if anything is broken or missing.

Welcome

Thank you for purchasing this network camera!

This owner's manual is designed to be a reference tool for your system.

Please read this manual carefully before operating the unit and retain it for future reference. Should you require any technical assistance, contact Speco Technologies Tech Support at 1-[800-645-5516](tel:800-645-5516)

Important Safeguards and Warning

Electrical safety

All installation and operation here should conform to local electrical safety codes. Use a certified/listed 12VDC Class 2 power supply or adequate PoE switch.

Please note: The product must be grounded to reduce the risk of electric shock. Improper handling and/or installation could run the risk of fire or electrical shock.

Environment

Do not expose the unit to heavy stress, violent vibration or long-term exposure to water and humidity during transportation, storage, and/or installation.

Do not install near sources of heat.

Only install the product in environments inside the specification operating temperature and humidity range.

Do not install the camera near power lines, radar equipment or other electromagnetic radiation.

Do not block any ventilation openings if any.

Use all the weatherproofing hardware requirement to minimize weather intrusion.

Operation and Daily Maintenance

Please shut down the device and then unplug the power cable before you begin any maintenance work.

Do not touch the CMOS sensor optic component. You can use a blower to clean the dust on the lens surface.

Always use the dry soft cloth to clean the device. If there is too much dust, use a cloth dampened with a small quantity of neutral detergent. Finally use the dry cloth to clean the device.

Please use a professional optical cleaning method to clean the enclosure. Improper enclosure cleaning (such as using cloth) may result in poor IR functionality and/or IR reflection. The grounding holes of the product are recommended to be grounded to further enhance the reliability of the camera.

The lens is an optical device, please don't touch or wipe cover surface directly during installation and use, please refer to the following methods if dirt is found:

Stained with dirt: Use oil-free soft brush or hair dryer to remove it gently.

Stained with grease or fingerprint: Use oil-free cotton cloth or paper soaked with alcohol or detergent to wipe from the lens center outward. Change the cloth and wipe several times if it is not clean enough.

Warning

This camera should be installed by qualified personnel only.

All the examination and repair work should be done by qualified personnel.

Any unauthorized changes or modifications could void the warranty.

Statement

This guide is for reference only.

Product, manuals and specifications may be modified without prior notice. Speco Technologies reserves the right to modify these without notice and without incurring any obligation.

Speco Technologies is not liable for any loss caused by improper operation.

Note:

Before installation, check the package and make sure that all components are included. Contact your rep or Speco customer service department immediately if something is broken or missing in the package.

Package

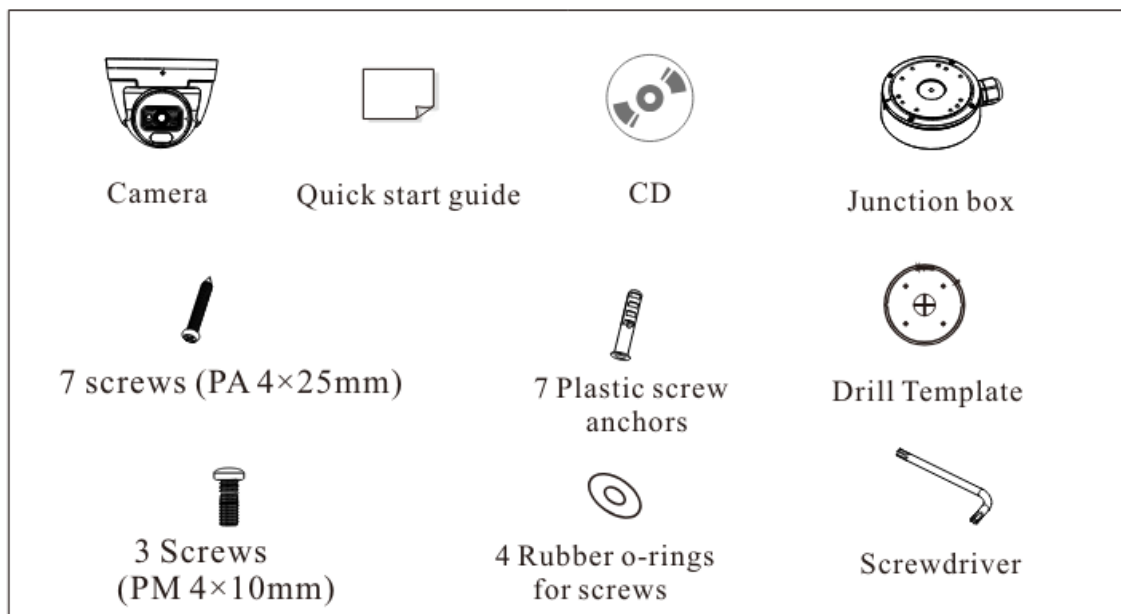

Overview

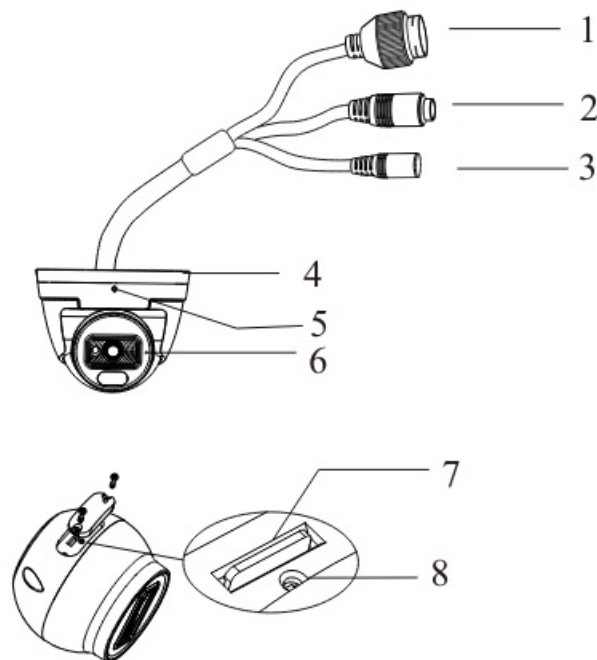

1. Ethernet connector
2. Audio input connector
3. Power connector
4. Mounting base
5. Fixed screw
6. Microphone
7. Micro SD card slot
8. Reset

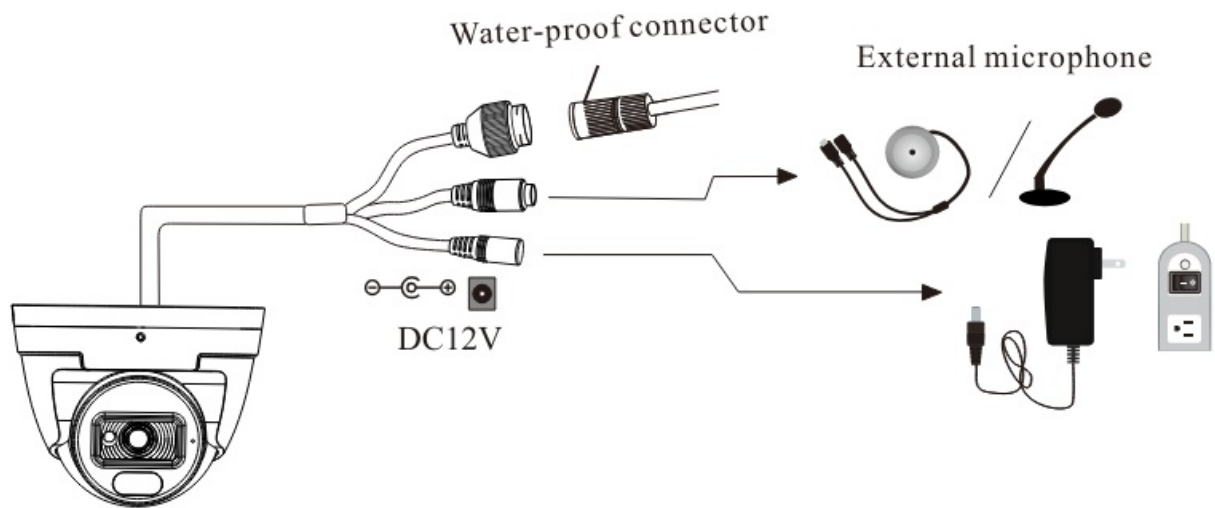

It is recommended to install the water-proof connector for outdoor installations.

Connecting Network Cable

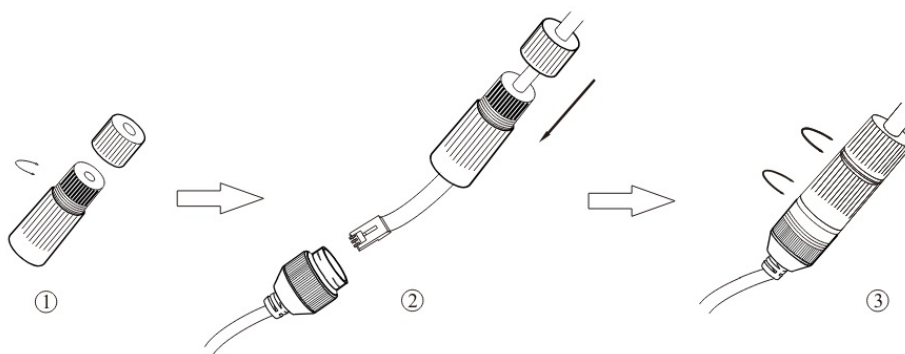

1. Loosen the nut from the main element.
2. Run the network cable (without RJ 45 connector) through both elements. Then crimp the cable with RJ 45 connector.
3. Connect the cable to the water-proof connector. Then tighten the nut and the main cover.

Installation

Before you start, please make sure that the wall or ceiling is strong enough to withstand three times the weight of the camera and the junction box.

1. Open the mounting base and the upper cover of the junction box.

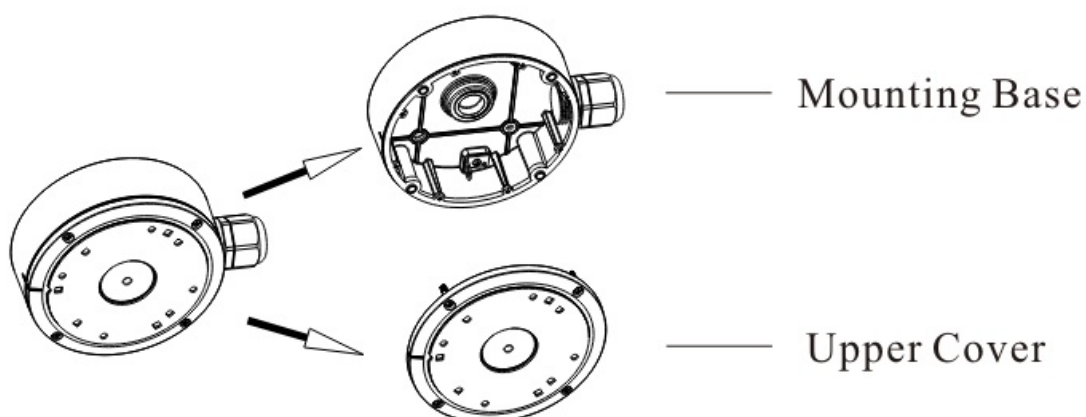

2. Attach the drill template of the junction box to the place where you want to install the junction box and then drill the screw hole and cable hole on the wall according to the drill template.
3. Install junction box onto the wall by using the screws provided.

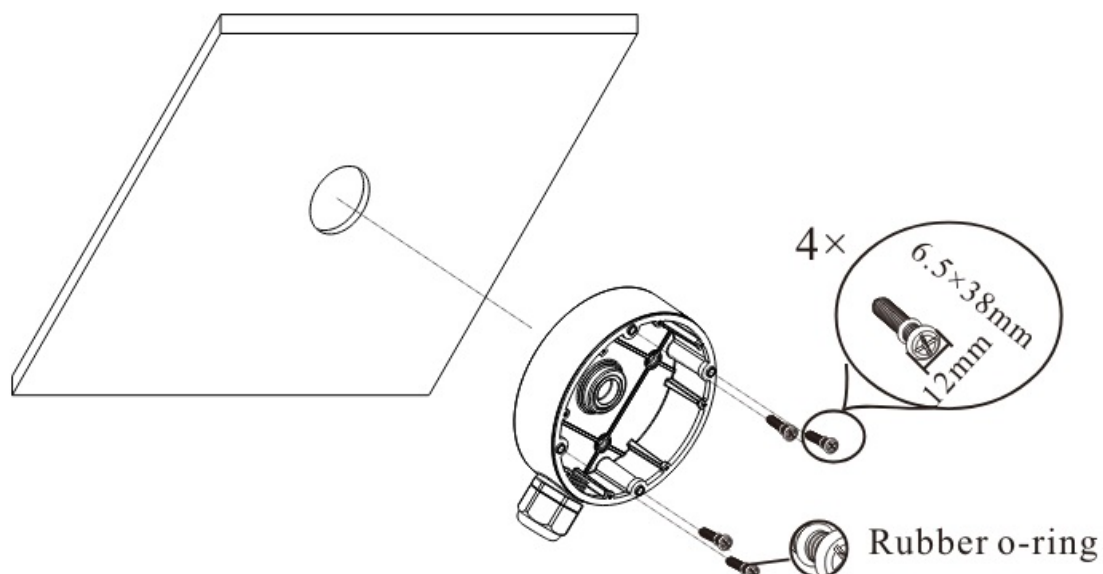

4. Loosen the set screw to disassemble the camera. Then remove the cover from the camera unit to insert the SD card. After that, install the cover back to the camera unit and fix it firmly with the screws.
- (Note that the cover should not be installed unevenly.)

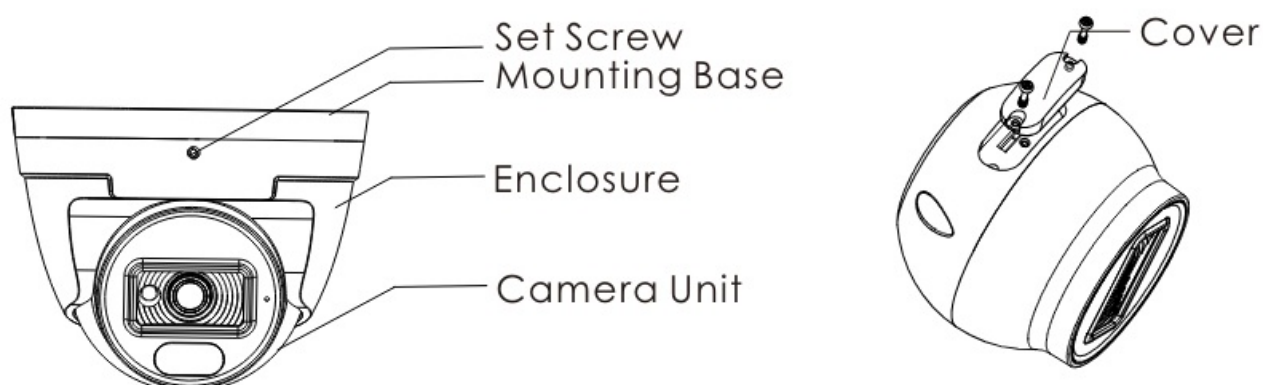

5. Fasten the mounting base of the camera onto the junction box.

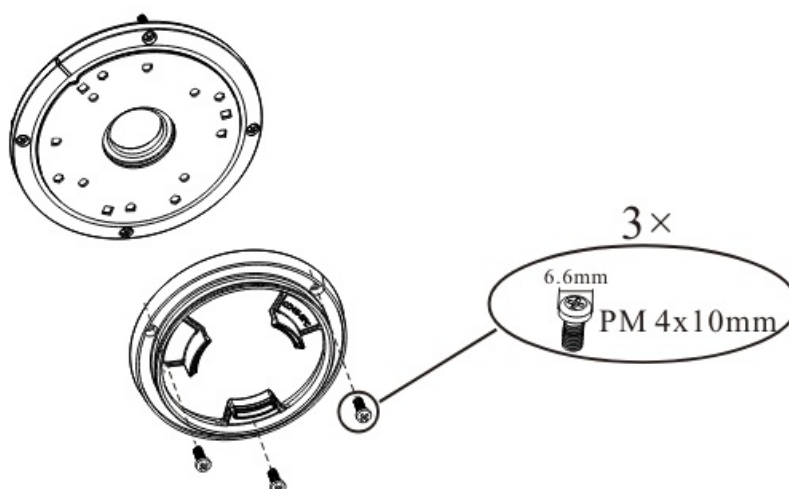

6. Route the cables through the cable hole and connect the cables. Then reinstall the upper cover onto the junction box and mount the camera unit and enclosure to the mounting base.

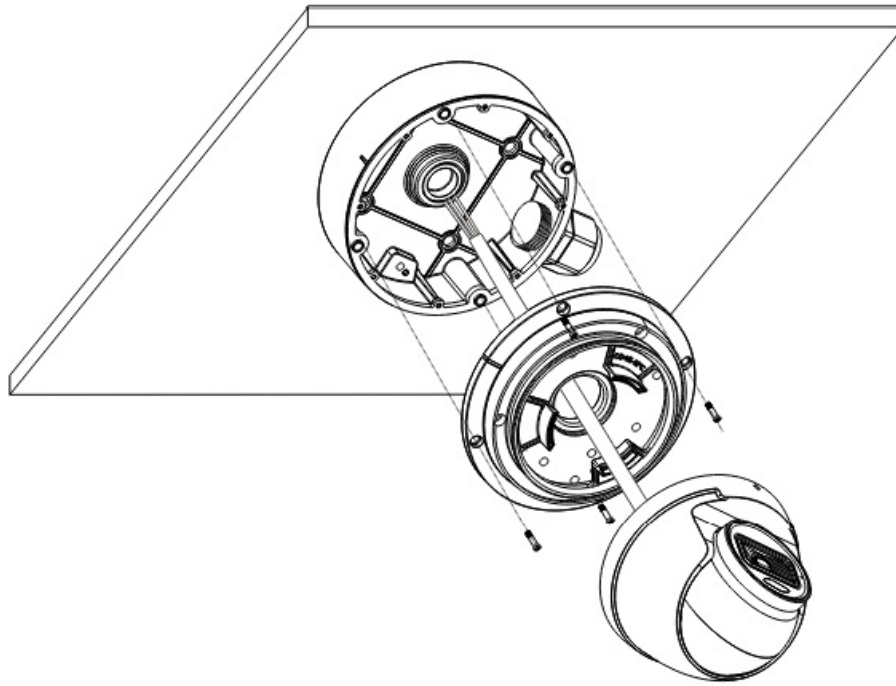

7. Adjust the camera to obtain an optimum angle. Before adjustment, preview the image of the camera on a monitor. After that, tighten the set screw to finish the installation.

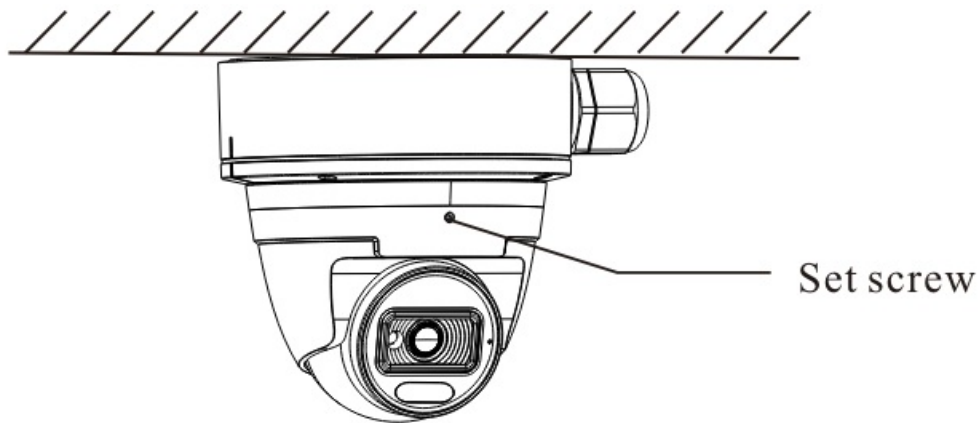

Web Operation and Login

IP Scanner can search for the device on the local network.

Operation

1. Make sure that the camera and the PC are connected to the same local network. The camera is set to DHCP by default.
2. Install IP Scanner from the CD and run it after installation. Or download from <https://www.specotech.com/ip-scanner/>

SecureGuard IP Scanner						
Refresh	Open Web Page	Login...	IP	Restart	Factory Default	Information
About						
Status	Model Name	Name	IP Address	MAC Address	Wireless IP Address	Zero Config IP
Online		O4LT1	192.168.17.251	5C:F2:07:34:68:9A	n/a	n/a

3. In the device list, you can view the IP address, model number, and MAC address of each device. Select the applicable device and double click to open up the web viewer. You can also manually enter the IP address in the address bar of the web browser.

speco technologies

Username

Password

Login

Cancel

The login interface is shown above. Default user name is admin and password is 1234. After logging in, follow directions to install applicable plugins if prompted.

Documents / Resources

	speco technologies O4LT1 4 Megapixel IP Advanced Analytics Turret Camera [pdf] User Guide O4LT1 4 Megapixel IP Advanced Analytics Turret Camera, O4LT1, 4 Megapixel IP Advanced Analytics Turret Camera, IP Advanced Analytics Turret Camera, Advanced Analytics Turret Camera, Analytics Turret Camera, Turret Camera
---	---

References

- [User Manual](#)

Manuals+. Privacy Policy

This website is an independent publication and is neither affiliated with nor endorsed by any of the trademark owners. The "Bluetooth®" word mark and logos are registered trademarks owned by Bluetooth SIG, Inc. The "Wi-Fi®" word mark and logos are registered trademarks owned by the Wi-Fi Alliance. Any use of these marks on this website does not imply any affiliation with or endorsement.