

Specflux
WS2812 RGB PC
LED STRIP LIGHT



Specflux WS2812 RGB PC LED Strip Light Instruction Manual

[Home](#) » [Specflux](#) » Specflux WS2812 RGB PC LED Strip Light Instruction Manual 

Contents

- 1 [Specflux WS2812 RGB PC LED Strip Light](#)
- 2 [INTRODUCTION](#)
- 3 [SPECIFICATIONS](#)
- 4 [WHAT'S IN THE BOX](#)
- 5 [FEATURES](#)
- 6 [SETUP GUIDE](#)
- 7 [CARE & MAINTENANCE](#)
- 8 [TROUBLESHOOTING](#)
- 9 [PROS & CONS](#)
- 10 [WARRANTY](#)
- 11 [FREQUENTLY ASKED QUESTIONS](#)
- 12 [VIDEO – PRODUCT OVERVIEW](#)
- 13 [References](#)



Specflux WS2812 RGB PC LED Strip Light



INTRODUCTION

For gamers and PC enthusiasts who want to add colorful, adjustable illumination to their setup, the Speclux WS2812 RGB PC LED Strip Light is a great option. This LED strip, which costs \$24.49, has 28 premium RGB lights that run efficiently on DC volts. It is made to work with motherboards that have a 3-pin 5V header and is compatible with Gigabyte RGB Fusion, ASUS Aura SYNC, and MSI Mystic Light Sync. Users may create beautiful lighting effects with ease thanks to the remote control and Bluetooth connectivity. This long-lasting LED strip has a lifespan of 100,000 hours. It is lightweight and simple to install, with dimensions of 7.17 x 7.13 x 1.34 inches and a weight of only 6.38 ounces. This LED strip, which is made by Speclux and has been on the market since July 31, 2021, is a premium option for people seeking dramatic and captivating lighting effects.

SPECIFICATIONS

Brand	Speclux
Price	\$24.49
Power Source	DC
Light Color	RGB
Controller Type	Remote Control
Connectivity Protocol	Bluetooth
Number of Light Sources	28
Voltage	5 Volts
Wattage	2 Watts
Control Method	Remote
Maximum Compatible Wattage	2 Watts
Specific Uses	NEON PC Addressable RGB digital LED strips, compatible with Gigabyte RGB Fusion, ASUS Aura, ASROCK RGB LED (3-Pin 5V header: +5V, DATA, N/A, GND or VDD, DATA, GND)
Special Features	Dimmable, Compatible with ASUS Aura SYNC, Gigabyte RGB Fusion, MSI Mystic Light Sync Motherboard 5V 3-Pin addressable LED headers
Average Life	100,000 Hours
Package Dimensions	7.17 x 7.13 x 1.34 inches
Weight	6.38 ounces
Item Model Number	WS2812
Date First Available	July 31, 2021
Manufacturer	Speclux
Country of Origin	China

WHAT'S IN THE BOX

- RGB PC LED Strip Light
- Manual



FEATURES

- **For motherboard-controlled lighting effects:** Addressable RGB control is compatible with 5V 3-pin connectors.

Addressable RGB Sync Control



Designed for PC's Motherboard with 5V 3-PIN Addressable Header

For 5V 3-PIN header

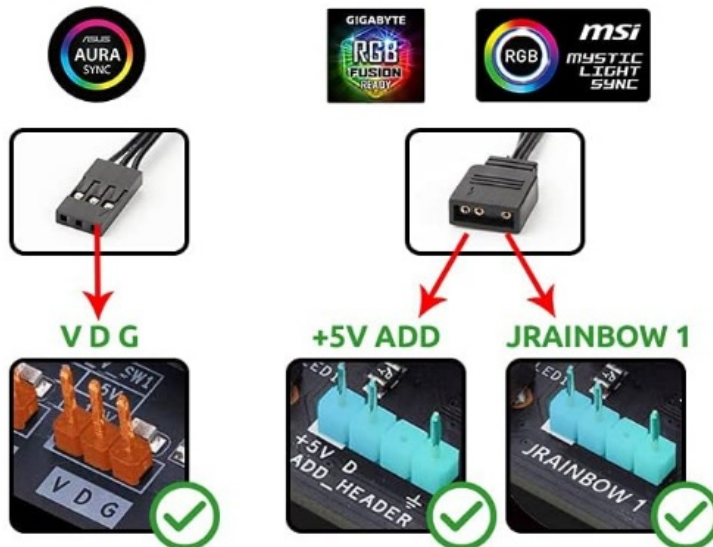

Not for 12V
4-PIN header
(damage the
led strip)



- **Broad Compatibility:** Compatible with ASRock RGB LED, MSI Mystic Light, ASUS Aura Sync, and Gigabyte RGB Fusion.
- **Cool Do-It-Yourself Effects:** Enables personalized color schemes and animations for a distinctive PC configuration.
- **Neon Lighting Design:** Unlike conventional LED strips, it provides a bright, even glow.
- **28 High-Brightness LEDs:** Two 15.7-inch strips of LEDs produce bright, vibrant lighting.
- **Twelve strong magnetic mounts** are included for safe installation inside PC cases.
- **Adaptable Installation Options:** For imaginative lighting arrangements, it can be installed in various orientations.
- **Bluetooth Control Capability:** Enables Bluetooth-based control using apps that are compatible.
- **Functionality of Remote Control:** Use a remote to change the colors, effects, and brightness.
- **Dimmable Feature:** Modify the brightness settings to accommodate various game configurations or moods.
- **Energy-efficient:** Uses less electricity because it only uses 2 watts.
- **Long-lasting and waterproof:** Silicone is sealed (IP65 rated) to guard against dust and short circuits.
- **Extended Lifespan:** Made to endure up to 100,000 hours.
- **Small and Lightweight:** Measuring just 6.38 ounces, it is simple to handle and install.
- **Universal DC Power Source:** With a 5V connection, this can be used with a variety of power configurations.

The Connecting Way

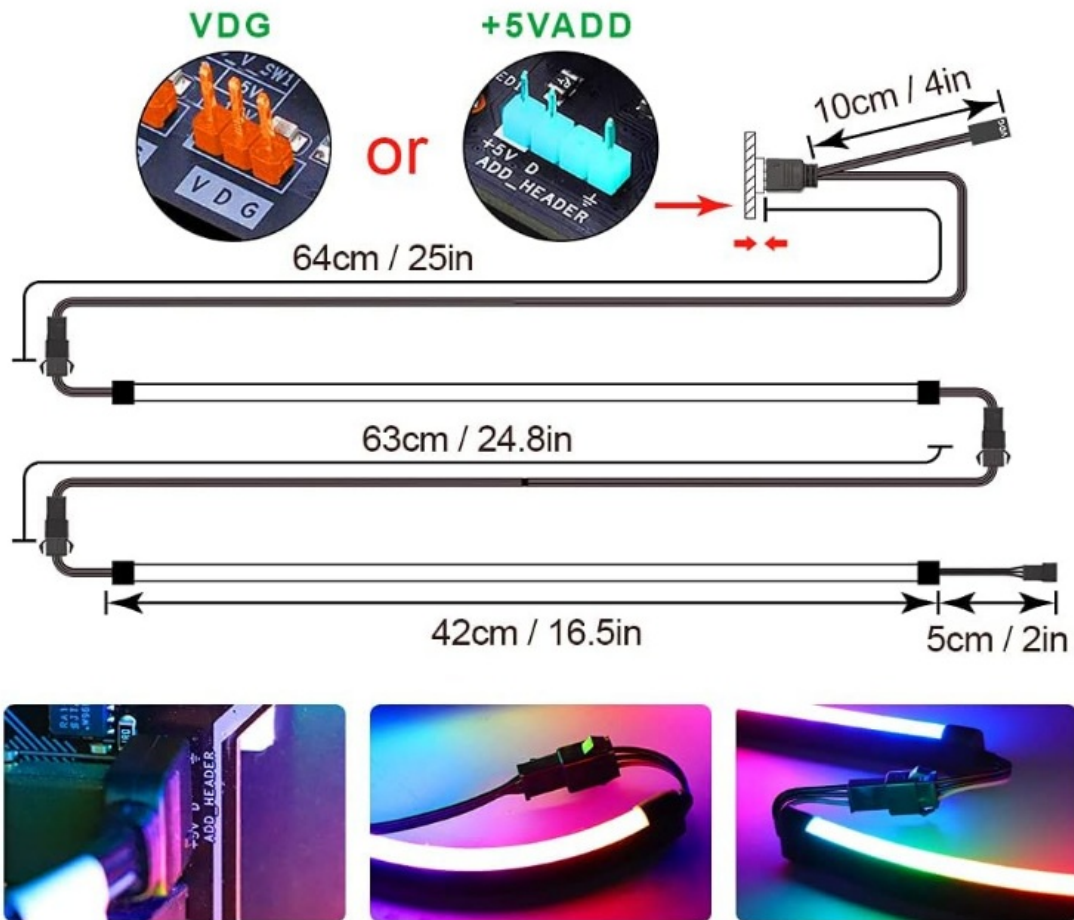

SETUP GUIDE

- **Check Motherboard Compatibility:** Make sure your motherboard has a 5V 3-pin addressable RGB header.
- **Examine the Contents and Packaging:** Ensure all parts—such as wires, LED strips, and magnetic brackets—are present.
- **Clean Installation Surface:** To guarantee proper adherence and avoid dust interference, clean the mounting area.
- **Select Mounting Location:** For the best illumination effect, choose the best location inside the PC casing.
- **Use Magnetic Brackets:** For simple adjustments, fasten the strips with the 12 magnetic brackets included.
- **Connect to the 5V 3-Pin Header:** To avoid connection issues, ensure the +5V, DATA, and GND pins are all in proper alignment.

The Connecting Way

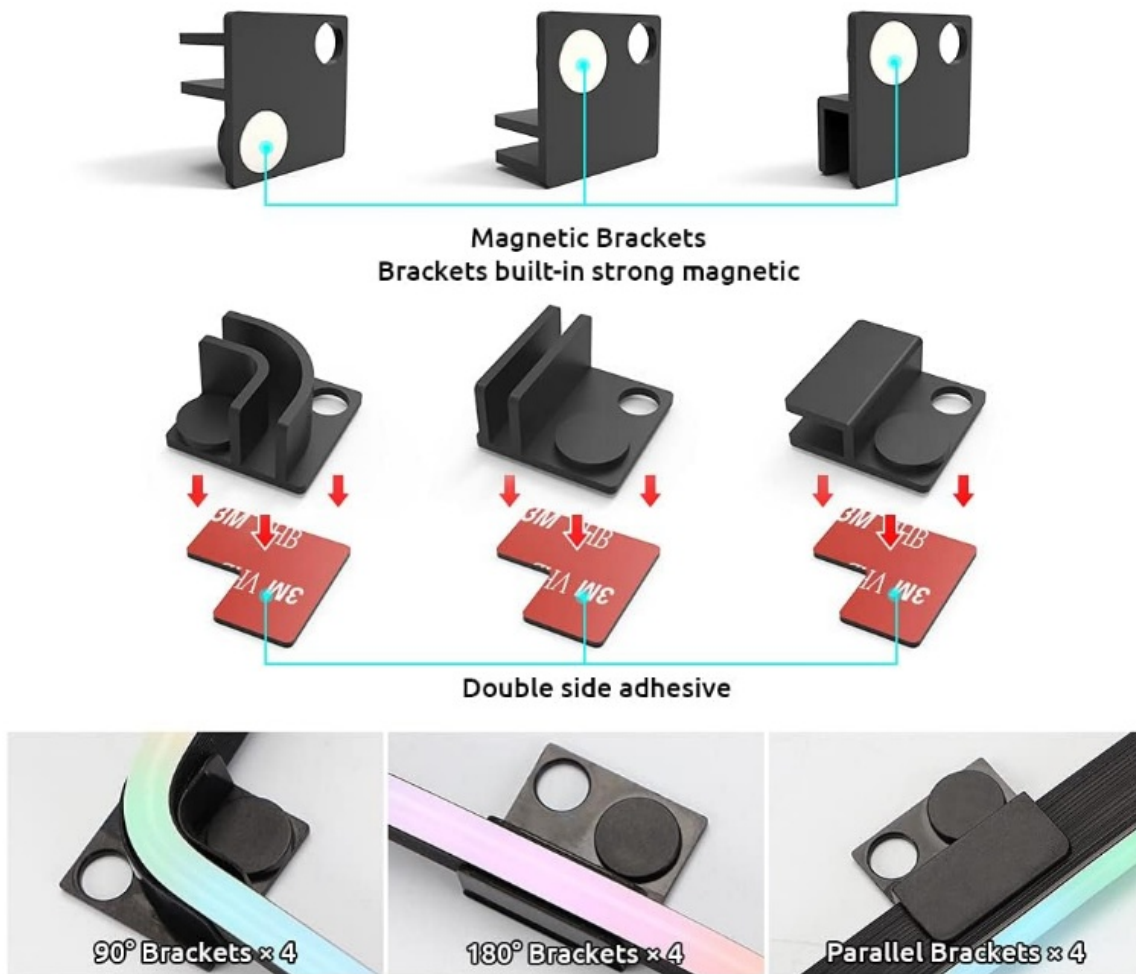

- **Use Only 5V RGB Headers:** Avoid 12V headers, as they can damage the LED strips.
- **Route Cables Properly:** Handle cables carefully to prevent interference with other components or airflow.
- **Use a Remote Control:** Use the included remote to adjust the brightness and hues.
- **Turn On RGB Program:** Install and activate MSI Mystic Light, ASUS Aura Sync, or Gigabyte RGB Fusion for synchronization.
- **Customize Lighting Effects:** Use motherboard software to change patterns, brightness, and animations.
- **Test the Lighting Before Finalizing Setup:** Turn it on and check the results before sealing the PC case.
- **Ascertain the Correct Voltage Supply:** Use a steady 5V DC power source to prevent oscillations.
- **Sync with Other RGB Components:** For a unified appearance, match effects with RGB fans, keyboards, and other accessories.
- **Reposition as Needed:** Move the strips if illumination appears uneven for better visual effects.

CARE & MAINTENANCE

- **Keep Dust-Free:** Wipe down the LED strips regularly with a gentle cloth to maintain brightness.
- **Steer Clear of Excessive Bending:** Overbending can shorten the lifespan of internal circuits.
- **Periodically Check Connections:** Ensure all cables are firmly in place for reliable operation.
- **Monitor Heat Levels:** Keep the strips away from high-temperature components like CPUs and GPUs.
- **Use the Right Power Supply:** Always connect to a 5V power source to prevent voltage overruns that can damage LEDs.

- **Avoid Water Exposure:** Although IP65 waterproof, keeping the strips dry extends their lifespan.
- **Adjust Brightness as Needed:** Constantly running at maximum brightness may shorten the lifespan.
- **Avoid Repeated Removal:** Peeling and reapplying adhesive strips frequently can weaken their grip.
- **Secure Extra Cables:** Use zip ties or clips to organize excess wiring and avoid accidental disconnections.
- **Turn Off When Not in Use:** This reduces wear and tear, extending the lifespan of the LEDs.
- **Verify RGB Software Updates:** Keep firmware and software up to date for optimal compatibility.
- **Don't Force Connections:** Gently plug in the 3-pin header to prevent motherboard port damage.
- **Test After PC Upgrades:** If upgrading components, ensure the lighting setup remains intact.
- **Use Extra Strips With Caution:** Overloading with multiple LED strips can cause voltage dips.
- **Store Unused Strips Properly:** Keep them in a dry, dust-free location to maintain performance.

TROUBLESHOOTING

Issue	Possible Cause	Solution
LED strip not lighting up	Loose or incorrect connection	Ensure 3-pin 5V header is properly connected
Flickering or inconsistent colors	Power supply issue	Use a stable 5V power source
Remote not working	Weak or dead battery	Replace the remote battery
Some LEDs are not lighting	Damaged LED segment	Contact customer support for replacement
RGB colors are incorrect	Incorrect motherboard settings	Adjust settings in RGB software
Adhesive strip not sticking	Dirty or uneven surface	Clean the surface before applying
Bluetooth connection issues	Signal interference	Reconnect and reset Bluetooth settings
Lighting effect lag	Software issue	Update RGB control software
Strips overheat	Poor ventilation	Ensure proper airflow in the case
Short lifespan	Excessive power load	Avoid overloading power connections

PROS & CONS

Pros	Cons
Compatible with major motherboard RGB software (ASUS Aura, MSI Mystic Light, Gigabyte RGB Fusion)	Requires a 3-pin 5V header, incompatible with 4-pin 12V headers
High 100,000-hour lifespan ensures longevity	May require additional cable management for a clean setup
Dimmable and fully customizable with multiple lighting effects	Remote control range can be limited in some setups
Easy installation with flexible design	Adhesive backing may weaken over time
Bluetooth connectivity for wireless control	Not suitable for non-RGB compatible motherboards

WARRANTY

The Speclux WS2812 RGB PC LED Strip Light comes with a **one-year limited warranty** covering manufacturing defects and performance issues. Warranty claims require proof of purchase and do not cover accidental damage, improper installation, or modifications.

FREQUENTLY ASKED QUESTIONS

Why is my Speclux WS2812 RGB PC LED Strip not lighting up?

Ensure the 3-pin 5V RGB header is correctly connected and that your motherboard supports addressable RGB lighting. Check the power source and connections.

Why is my Speclux WS2812 RGB PC LED Strip displaying incorrect colors?

This could be due to an incorrect data signal. Try adjusting the RGB software settings or reconnecting the LED strip to the 5V header.

Why is my Speclux WS2812 RGB PC LED Strip flickering?

Flickering may occur due to unstable power delivery. Ensure the power connection is secure and that your motherboard provides a stable 5V power output.

Why is my Speclux WS2812 RGB PC LED Strip not responding to the remote control?

Make sure the remote battery is working and that there are no obstructions between the remote and the LED strip receiver.

Why is my Speclux WS2812 RGB PC LED Strip not syncing with my motherboard software?

Ensure that your motherboard supports 3-pin 5V addressable RGB headers and that you have installed the latest RGB control software such as ASUS Aura Sync, MSI Mystic Light, or Gigabyte RGB Fusion.

What are the package dimensions of the Speclux WS2812 RGB PC LED Strip?

The Speclux WS2812 package dimensions are 7.17 x 7.13 x 1.34 inches, with a total weight of 6.38 ounces.

What is the lifespan of the Speclux WS2812 RGB PC LED Strip?

The Speclux WS2812 has an impressive average life of 100,000 hours, ensuring long-term use.

How is the Speclux WS2812 RGB PC LED Strip controlled?

The Speclux WS2812 can be controlled via Bluetooth connectivity, a remote control, or motherboard software when connected to a 3-pin 5V addressable RGB header.

VIDEO – PRODUCT OVERVIEW



<https://manuals.plus/wp-content/uploads/2025/03/Speclux-WS2812-RGB-PC-LED-Strip-Light-Instruction-Manual.mp4>

- [User Manual](#)

[Manuals+.](#) [Privacy Policy](#)

This website is an independent publication and is neither affiliated with nor endorsed by any of the trademark owners. The "Bluetooth®" word mark and logos are registered trademarks owned by Bluetooth SIG, Inc. The "Wi-Fi®" word mark and logos are registered trademarks owned by the Wi-Fi Alliance. Any use of these marks on this website does not imply any affiliation with or endorsement.