

# Special Pie M1A2 Shot Timer User Guide

### Contents

- 1 User Guider of M1A2 Series Shot Timer
  - 1.1 1. Product Model & Application & Packing List
  - 1.2 2. Quick Start
    - 1.2.1 3.1 How to power on/off
    - 1.2.2 3.2 How to use Setting Mode
    - 1.2.3 3.3 How to use shortcut key on the timer.
    - 1.2.4 3.5 How to charge to the shot timer.
  - 1.3 3. Timer Diagram
    - 1.3.1 Icon Explanation
  - 1.4 4. Fixing Way
  - 1.5 5. How to fix the belt clip to the timer.
  - 1.6 7. How to set eco mode and language
  - 1.7 8. How to set Bluetooth connection to PractiScore APP
  - 1.8 9. Warranty
  - 1.9 FCC Statement
- 2 Documents / Resources
  - 2.1 References
- 3 Related Posts

## User Guider of M1A2 Series Shot Timer

### 1. Product Model & Application & Packing List

Model	Product Name	Application	Features	Packing List
M1A2-F	Standard Firearm Shot Timer	Firearm Shooting	/	1*Shot Timer; 1*USB Cable; 1*User Guider.
M1A2-FW	Wireless Firearm Shot Timer	Firearm Shooting	Supporting wireless connection to Wireless LED display	

### 2. Quick Start

#### 3.1 How to power on/off

Hold down “Power” Button for 5 seconds to power on/off.



### 3.2 How to use Setting Mode

#### a. Set the timing mode

Hold down “power” button to enter set menu–Mode–Firearm/Stop Watch/Countdown



#### b. Set the “Delay Mode” of Starting Timing

There are 3 kinds of delay modes, Instant, Random(3-5secs), and Fixed(customized time, max.to 10secs.)

**Setting Way:** under non-timing status, hold down “power” button to enter setting menu–Delay, then hold down the mode you need to choose.



1. Hold down the power button to enter setting

#### c. How to set the Par Mode

**Setting Way:** under non-timing status, hold down “Power” button to enter setting menu–Par, to set the time and cycles and then go back to the home page.

**Start Way:** under non-timing status, hold down “+” button to start/close Par Mode.



1. Hold down power button to set time/cycles
2. Hold down “+” button to start/close par mode

### 3.3 How to use shortcut key on the timer.

#### a. How to set the sensitivity of fire shooting timing.

Under non-timing status, hold down “lock” button for 2secs to enter setting interface, quick press “speaker” button to adjust beep tone/volume, and quick press “+” “-“button to adjust sensitivity level of sound picking. ( Sensitivity can be also adjusted in the firearm mode in setting menu )

**Sensitivity Level:** Level 1 to Level 8, Level 8 is the most sensitive, level 1 is the least sensitive



1. Hold down this shortcut button to enter beep tone and sensitivity setting

#### b. How to adjust beep tone/volume

Hold down “Lock” button to enter sensitivity & volume adjusting interface, quick press “Speaker” button to adjust, there are 3 classes for the volume in total.



### c. How to start countdown mode.

Hold down “-” button for 3secs to start countdown mode.(Max. to 600secs)



### d. How to start/close Par Mode.

Hold down “+” button to start/close Par mode.



1. Hold down “+” button to start/close par mode

### e. How to review history data/scores

- Under non-timing status, quick press “Power” button to review shot time and split time of every shot.



1. Quick press “Power” button to review shot time and split time of every shot

- Hold down “Speaker” button 2secs to check/delete group shooter’s score, quick press “Start” button to check the shooters/group scores you want, quick press “Power” button to check the current shooter/group’s shots time/scores of each shooter.



**Hold down “speaker” button to check group shooting score.**

- Hold down “Speaker” button 2secs first and then quick press ” Power”/”Start” button to exit the group data checking interface.



**Hold down “Speaker” button for 2secs first and then quick press ” Power” / ” Start” button to exit the group data checking interface.**

### 3.5 How to charge to the shot timer.

Please use power adapter of DC5V or power bank to charge to the timer, red indicator led means charging, blue led means fully charged. The whole charging time is 1.5hrs , please stop charge to the timer after that.

**Note:** The timer screen may be upside down when its battery is low. Please turn off the timer and charge to it in

time.



1. USB Charging Port
2. Charging Indicator

### 3. Timer Diagram



1. Power on /timer stop/review(Red lit)
2. This icon indicates that Bluetooth is activated
3. Battery Status
4. Mode: Firearm
5. Time interval between two shots
6. Hold down to start/close par mode RFID/Volume/Sensitivity+ –
7. Hold down to start countdown timer
8. Charging status LED (Red =Charging, Blue=Fully Charged)
9. USB charging port
10. Hold down to check/delete group scores
11. Hold down for shortcut menu to adjust sensitivity and beep tone
12. Solid “S” changes to flashing “T” indicating the timer is running
13. Total number of shots recorded
14. Start signal delay (Instant/Random /Fixed/Custom)

15. Mic
16. Start(Green lit)

#### Icon Explanation

##### Icons used on timer display

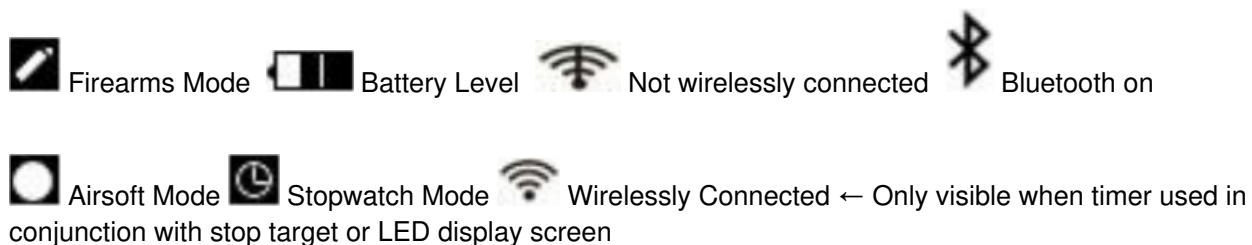

##### Icons used on menu display

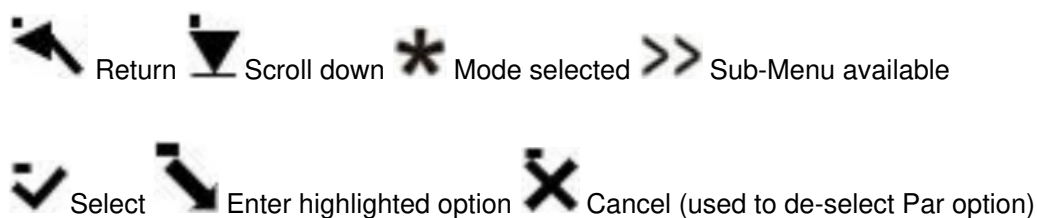

##### Action required to activate icon

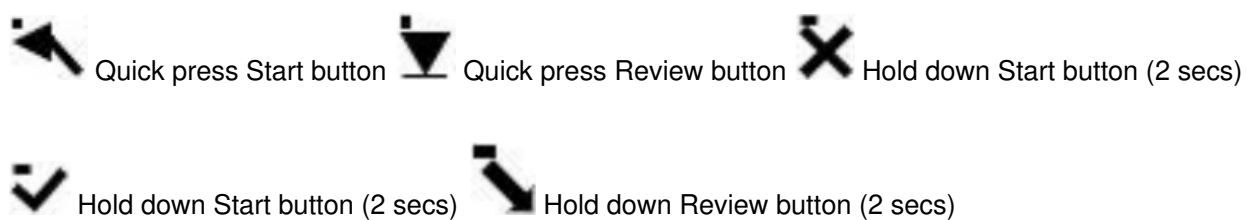

#### 4. Fixing Way

Hang it with a sling or fix it on the belt with the clip.



Fix the belt clip with these two screw holes

1. Hanging hook

5. How to fix the belt clip to the timer.



7. How to set eco mode and language

**Eco mode Setting:** Under non-timing status, hold down “Power” button to enter setting menu–System–Eco Mode, then quick press “Power” button to switch to “Customized” option, and hold down “Start” button to choose it, then back to the homepage.



**Language Setting:** Under non-timing status, hold down “Power” button to enter setting menu–System–Language, quick press to switch language option you need and hold down “Start” button to choose it, then back to the homepage.



## 8. How to set Bluetooth connection to PractiScore APP

- **The default setting of Bluetooth is on**, it can enable timer be used with the PractiScore APP. (Currently, the timer is only compatible with PractiScore of Android OS, not for iOS/iPhone) Every timer's Bluetooth owns a special code, which shows in the setting menu– System– Bluetooth.



- **Connection Way:** Download PractiScore APP in your Android phone/pad, then run it to input shooter and stage info first, then choose enter score–stage–shooter, then click the right top 3 dots, choose timer, and the screen will have popup showing the timer's Bluetooth codes, please choose the timer you are using, then they will get connected successfully.
- After that, you can choose to start timing by hold down the “Start” button on the timer, or hold down the red clock icon. Quick press the “Power” button if you want to stop timing.

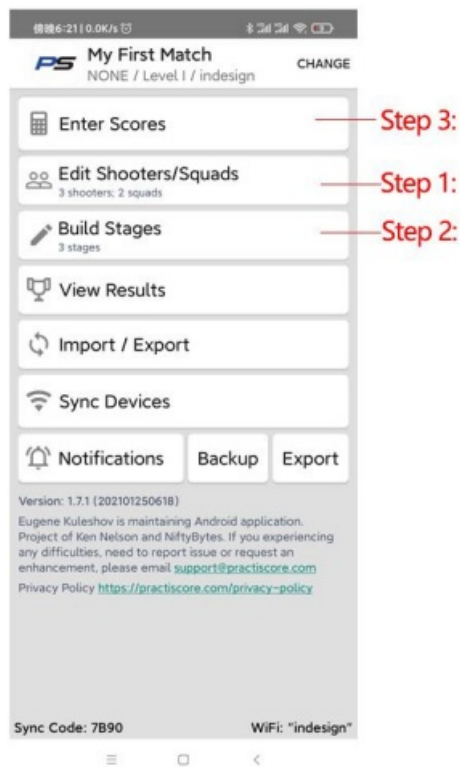

- Step 1: Input shooter info
- Step 2: Input stage info
- Step 3: Choose Enter Scores

### Input Shooter Info

← Edit Shooter 2021-01-27 18:04  
My First Match

Last Name:

First Name:

Member#:  Regio

Email:

Squad:

Division:

Class:

Team:

Category:  
☐ Junior ☐ Senior ☐ Lady

Checkins:  
☐ Checked in ☐ Paid ☐ Staff

Reg#:

☐ DQed ☐ Walk-in

Sync Code: 7B90      WiFi: "indesign"

### Input Stage Info

← Add Stage  
My First Match

Stage Name:

Scoring Type:

Targets:

☒ No Shoots ☒ Classic Targets

Poppers/Plates:

Steel NPMs:

Strings:

☐ Classifier Stage

Squad Rotation:

Briefing:

Walkthrough:  minutes

Minimum Rounds: 0      Maximum Points: 0

Sync Code: 7B90      WiFi: "indesign"

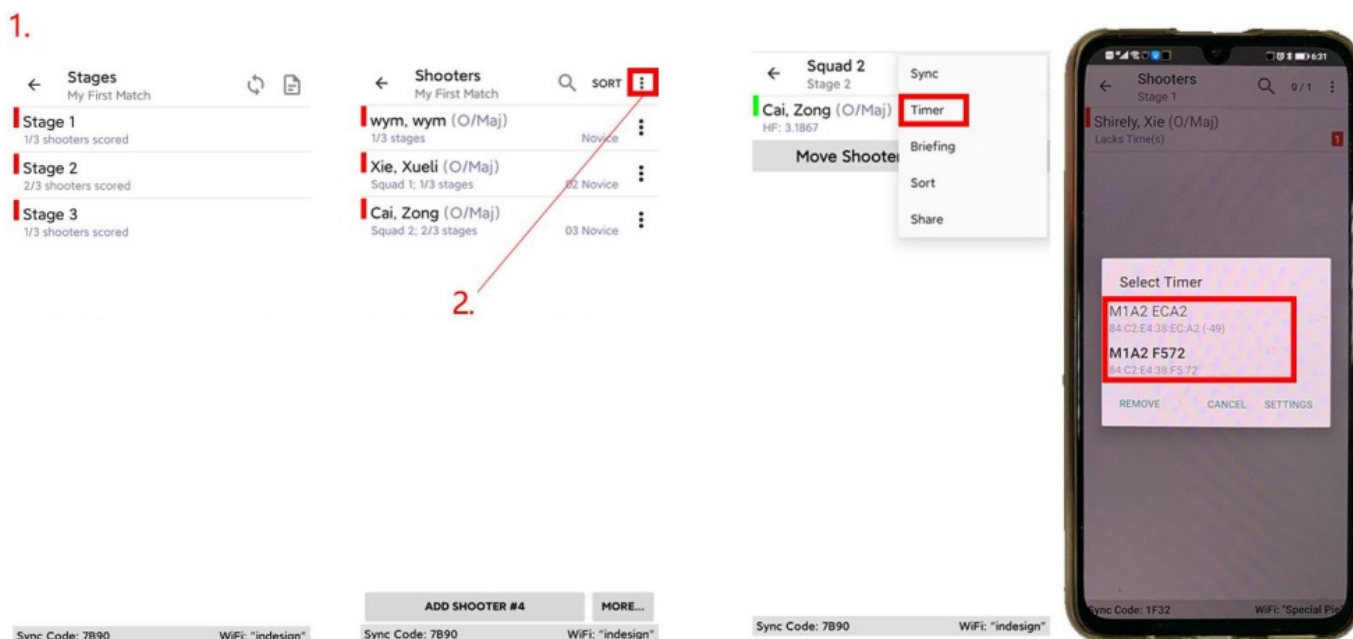

1. Choose Enter Scores—Stages—Shooters
2. Then choose the top right 3 dots to click timer

## 9. Warranty

Special Pie offers 12 months free warranty for this product. Proper charges are needed if its malfunction is man-made.

## FCC Statement

This device complies with part 15 of the FCC rules. Operation is subject to the following two conditions: (1) this device may not cause harmful interference, and (2) this device must accept any interference received, including interference that may cause undesired operation.

Changes or modifications not expressly approved by the party responsible for compliance could void the user's authority to operate the equipment.

NOTE: This equipment has been tested and found to comply with the limits for a Class B digital device, pursuant to part 15 of the FCC Rules. These limits are designed to provide reasonable protection against harmful interference in a residential installation. This equipment generates uses and can radiate radio frequency energy and, if not installed and used in accordance with the instructions, may cause harmful interference to radio communications. However, there is no guarantee that interference will not occur in a particular installation. If this equipment does cause harmful interference to radio or television reception, which can be determined by turning the equipment off and on, the user is encouraged to try to correct the interference by one or more of the following measures:

- Reorient or relocate the receiving antenna.
- Increase the separation between the equipment and receiver.
- Connect the equipment into an outlet on a circuit different from that to which the receiver is connected.
- Consult the dealer or an experienced radio/TV technician for help.

The device has been evaluated to meet general RF exposure requirement. The device can be used in portable exposure condition without restriction.

\_\_\_\_\_

