



[Home](#) » [Spec5](#) » **spec5 SpecFive Ranger Long Range Communication Devices User Guide** 

Contents [[hide](#)]

- [1 spec5 SpecFive Ranger Long Range Communication Devices](#)
- [2 Button/Switch Configuration:](#)
- [3 Reset Button](#)
- [4 Screen Messages:](#)
- [5 Charging the Device:](#)
- [6 Connecting to the Device via the Meshtastic Mobile App:](#)
- [7 Update your device:](#)
- [8 Other Resources:](#)
- [9 Documents / Resources](#)
 - [9.1 References](#)
- [10 Related Posts](#)

spec5 SpecFive Ranger Long Range Communication Devices



USER GUIDE

Thank you for ordering your Spec Five Ranger from SpecFive. Here are the instructions to get you connected to your new device and join the mesh.

Button/Switch Configuration:

Power Switch:

- Power on:
 - Toggle oriented away from antenna
- Power off:
 - Toggle oriented towards antenna

Trackball:

- Scrolls through screens
- Note: Press and hold for three seconds while flipping the power switch on to enter DFU mode

Reset Button

- Single short press with device powered on:
 - Reboots device
- Keyboard:
 - Begin typing to draft a message
 - Press Entetro send a message

Shortcuts:

Shortcut	Function
alt&B	Toggle keyboard backlight on/off.
alt&C	Toggle modifier function. Fn displayed on screen.
alt&C+M	Disable/Enable notifications.
alt&C+Q	Quit/Cancel (message, canned message, etc.)
alt&C+T	Tab Key (select channel/dm recipient)
alt&C+1	Decrease screen brightness.
alt&C+0	Increase screen brightness.
alt&C+G	Toggle GPS
alt&C+	Send network ping.

Screen Messages:

“Fn” Displayed on the screen



- GPS is enabled but location has not been found:



- GPS is disabled:

B 4.06V 91% LongF
29m ChUtil 0%
GPS is disabled



- Selector for message recipient activated

To: >Broadcast<@LongFast



Charging the Device:

Charging icon should appear in the upper left corner of the screen, shown below, to indicate that the device is powered via usb:



Connecting to the Device via the Meshtastic Mobile App:

1. Download the Meshtastic App from the Apple App Store or Google Play Store



2. Ensure your phone has bluetooth enabled
3. Power on the device
4. Connect your new device

Android

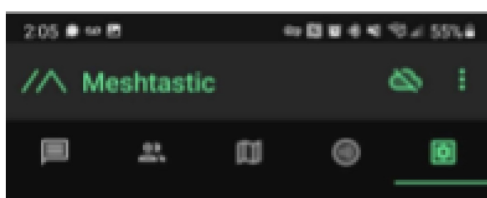

Apple

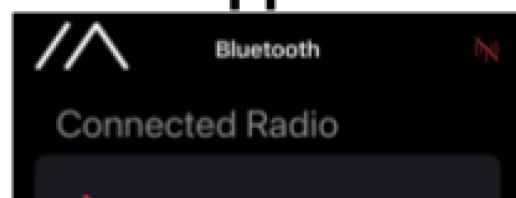

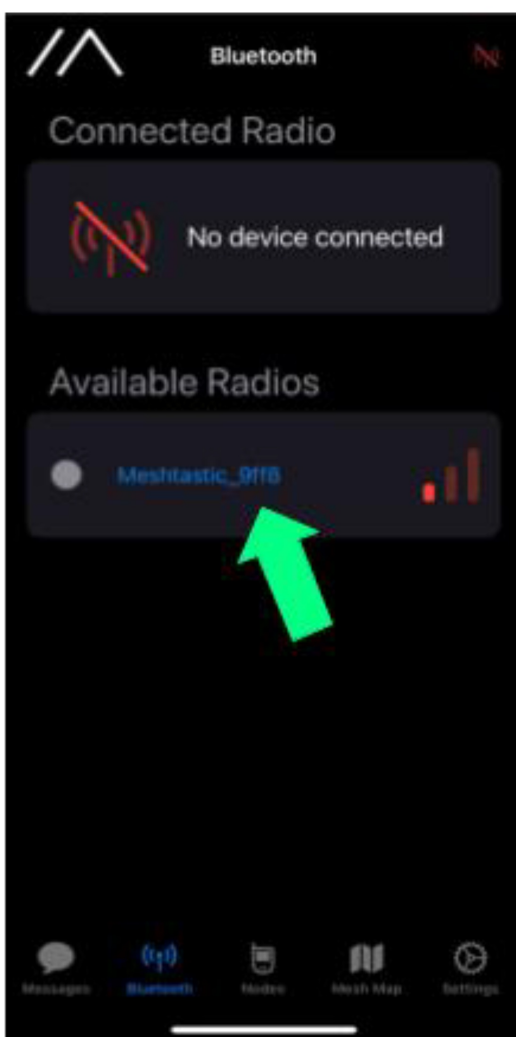
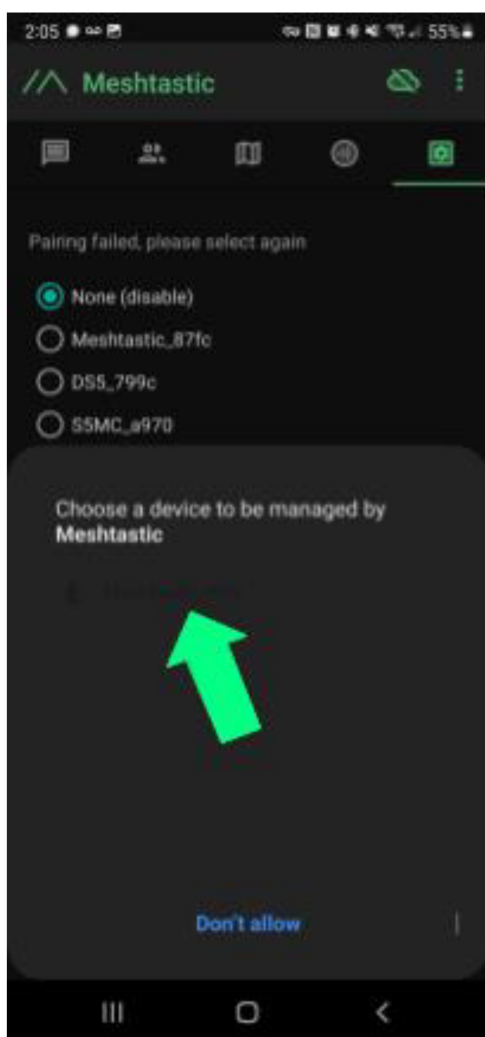
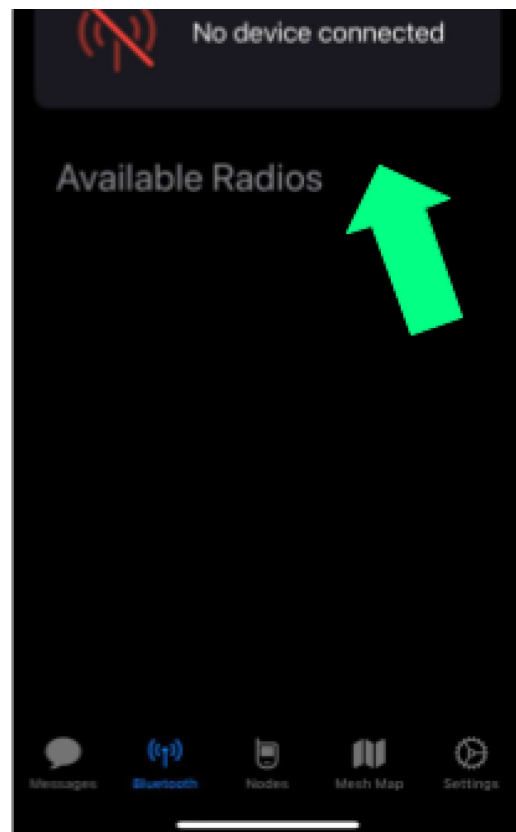
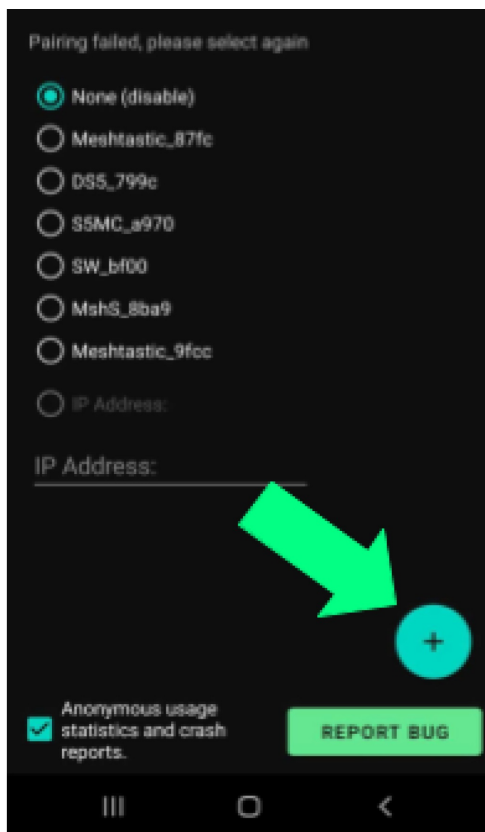

5. Enter the device's pin that is displayed on its screen

Update your device:



1. Plug the device into a desktop with power off
2. Enter DFU Mode (See Button Configuration section)
3. Head to <https://flasher.meshtastic.org/>
4. Select “T-Deck” under the devices drop-down
5. Select your desired firmware and update the device

Other Resources:

- For more information on radio configuration settings, visit <https://meshtastic.org/docs/configuration/>
- For more information about our products, visit specfive.com

2024. SpccFivc LLC All Rir,ht Rcscrvccl c;pr,r.fivr, r.nrn

Documents / Resources



[spec5 SpecFive Ranger Long Range Communication Devices \[pdf\]](#) User Guide
SpecFive Ranger Long Range Communication Devices, Ranger Long Range Communication Devices, Range Communication Devices, Communication Devices, Devices

References

- [User Manual](#)

Related Posts



[RETEKESSTT122 Wireless Tour Guide System Long Range Communication User Manual](#)

FAQ Here are some of the Rooms: frequently asked questions WHAT IS A TOUR GUIDE SYSTEM? A tour...



[muRata LB2DK High Frequency Devices And Communication Module Owner's Manual](#)

LBUA2ZZ2DK User Manual for FCC LB2DK High Frequency Devices And Communication Module FCC ID:VPYLB2DK • Warning; CFR §15.521(a)...



[Farpointe Data WRR-22 Ranger Long Range Receiver User Guide](#)

Farpointe Data WRR-22 Ranger Long-Range Receiver Ranger Long-Range Access Control Solution Product Information The Ranger is a long-range...

[HOSE MONSTER Range Extender Communication Bridge for Smart Monster Pressure Sensors User Manual](#)

HOSE MONSTER Range Extender Communication Bridge for Smart Monster Pressure



Sensors Long-range communication bridge for Smart Monster pressure...

■ Spec5

◆ Communication Devices, devices, Range Communication Devices, Ranger Long Range Communication Devices, Spec5, SpecFive Ranger Long Range Communication Devices

Leave a comment

Your email address will not be published. Required fields are marked *

Comment *

Name

Email

Website

☐ Save my name, email, and website in this browser for the next time I comment.

Post Comment

Search:

Search

This website is an independent publication and is neither affiliated with nor endorsed by any of the trademark owners. The "Bluetooth®" word mark and logos are registered trademarks owned by Bluetooth SIG, Inc. The "Wi-Fi®" word mark and logos are registered trademarks owned by the Wi-Fi Alliance. Any use of these marks on this website does not imply any affiliation with or endorsement.