



# SPEAR AND JACKSON CSP3 Smoothing Plane User Manual

[Home](#) » [SPEAR AND JACKSON](#) » SPEAR AND JACKSON CSP3 Smoothing Plane User Manual 

## Contents

- [1 SPEAR AND JACKSON CSP3 Smoothing Plane](#)
- [2 Blade Sharpening](#)
- [3 Quick Tips](#)
- [4 For Best Results](#)
- [5 Product Care](#)
- [6 Documents / Resources](#)
  - [6.1 References](#)



## SPEAR AND JACKSON CSP3 Smoothing Plane



## Blade Sharpening

- For best results, the blade (sometimes otherwise referred to as ‘the cutter’, or the iron) on this product requires sharpening prior to use.
- This requires removing the blade by turning the brass thumbscrew anti-clockwise on the iron cap (sometimes otherwise referred to as the “lever cap”) (fig 1).
- Unscrew the cap iron screw until loose and remove the cap iron from the blade (fig 2).
- This product is supplied with a blade ground angle of 25° and should be honed to 30° (fig 3).
- Use thin machine oil to lubricate a flat oil stone and place the 25° bevel flat on the stone, raising the blade 5° to the 30° honing angle.
- Using a figure of eight movement to distribute wear evenly, sharpen the blade.
- Once a burr has formed at the edge of the blade, turn it over and re-position the cutter to sit flat against the oil stone with the bevel facing up. Gently sharpen to remove the burr.
- Ensuring the cap iron is parallel to the blade, re-attach the cap iron to the blade and tighten the cap iron screw (fig 4).
- Place the re-assembled blade into the body of the plane and secure the lever back into position.

### Quick Tips

- The brass adjusting nut can be used to alter the depth of cut.
- When planing softwood, set the cap iron 2mm back from the cutting edge.
- When planing hardwood, set the cap iron as close as possible to the cutting edge.

### For Best Results

- Keep shaving thickness to a minimum.
- Ensure that the plane base is maintained in line with the workpiece.
- At the start of the stroke, apply pressure to the top of the plane. Adjust this pressure to the heel of the plane towards the end of the stroke.
- At the end of each cutting stroke, lift the plane from the workpiece before the next stroke.
- This product should be used to plane in the direction of the wood grain. When planing end grain, work from edge to middle.
- Candie wax can be used for ease of movement if required; simply rub the wax into the base of the plane.

### Product Care

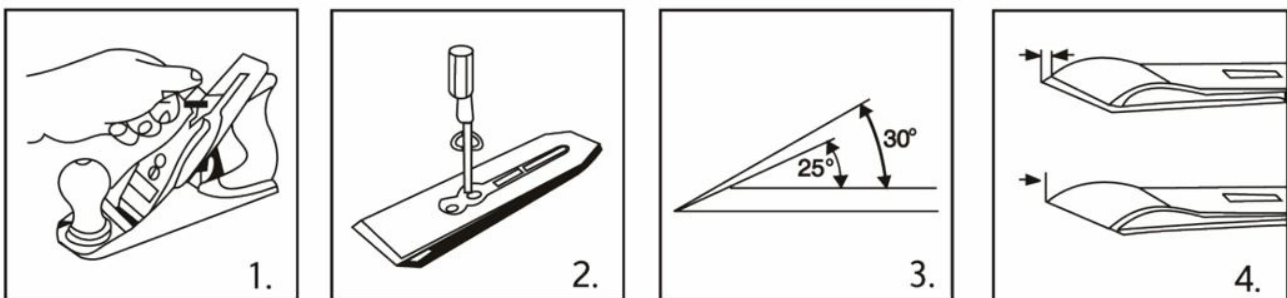

- Keep the blade sharp, and oil metal parts when not in use.
- Do not use other metal objects to clear shavings from the plane.

- When not in use, lay the plane on its side to protect the blade.

## Documents / Resources



[SPEAR AND JACKSON CSP3 Smoothing Plane](#) [pdf] User Manual  
CSP3, CSP4, CJP5, CSP3 Smoothing Plane, CSP3, Smoothing Plane, Plane

## References

-  [Spear and Jackson | Garden & Hand Tools](#)