



SPEAR AND JACKSON CSP3 Carpenters Smoothing Plane Instructions

[Home](#) » [SPEAR AND JACKSON](#) » SPEAR AND JACKSON CSP3 Carpenters Smoothing Plane Instructions 

Contents

- [1 SPEAR AND JACKSON CSP3 Carpenters Smoothing Plane](#)
- [2 Product Information](#)
- [3 Product Usage Instructions](#)
- [4 Blade Sharpening](#)
- [5 Quick Tips](#)
- [6 For Best Results](#)
- [7 Product Care](#)
- [8 Documents / Resources](#)
 - [8.1 References](#)



SPEAR AND JACKSON CSP3 Carpenters Smoothing Plane



Product Information

The product referred to in these user instructions is the CSP3, CSP4, and CJP5. These products are designed for blade sharpening purposes.

Product Usage Instructions

Blade Sharpening:

1. Ensure the product is unplugged and turned off before starting the blade sharpening process.
2. Place the blade to be sharpened securely in the product's designated slot.
3. Turn on the product and follow the specific instructions provided for the CSP3, CSP4, or CJP5 model.
4. Slowly move the blade back and forth along the sharpening surface, applying gentle pressure.
5. Continue this motion until the desired sharpness is achieved.
6. Turn off the product and carefully remove the sharpened blade.

Quick Tips:

- Always read and follow the specific instructions provided for your model (CSP3, CSP4, or CJP5).
- Ensure the product is properly maintained and cleaned after each use to prolong its lifespan.
- Wear appropriate protective gear, such as gloves and safety goggles, during the blade sharpening process.
- Keep the product out of reach of children and pets.

For Best Results:

- Use only blades that are suitable for sharpening with this product.
- Follow a consistent angle and motion while sharpening to achieve even results.
- Regularly inspect the product for any signs of damage or wear that may affect its performance.

Product Care:

For detailed information on how to care for your CSP3, CSP4, or CJP5 product, refer to the product care section in the user manual or visit our website www.spear-and-jackson.com.

User instructions for ref: CSP3, CSP4 and CJP5

Blade Sharpening

- For best results, the blade (sometimes otherwise referred to as 'the cutter', or 'the iron') on this product requires sharpening prior to use.
- This requires removing the blade by raising the lever on the iron cap (sometimes otherwise referred to as the 'lever cap') (fig 1).
- Unscrew the cap iron screw until loose and remove the cap iron from the blade (fig 2).
- This product is supplied with a blade ground angle of 25° and should be honed to 30° (fig 3).
- Use thin machine oil to lubricate a flat oil stone and place the 25° bevel flat on the stone, raising the blade 5° to the 30° honing angle.
- Using a figure of eight movement to distribute wear evenly, sharpen the blade.

- Once a burr has formed at the edge of the blade, turn it over and re-position the cutter to sit flat against the oil stone with the bevel facing up. Gently sharpen to remove the burr.
- Ensuring the cap iron is parallel to the blade, re-attach the cap iron to the blade and tighten the cap iron screw (fig 4).
- Place the re-assembled blade into the body of the plane and secure the lever back into position.

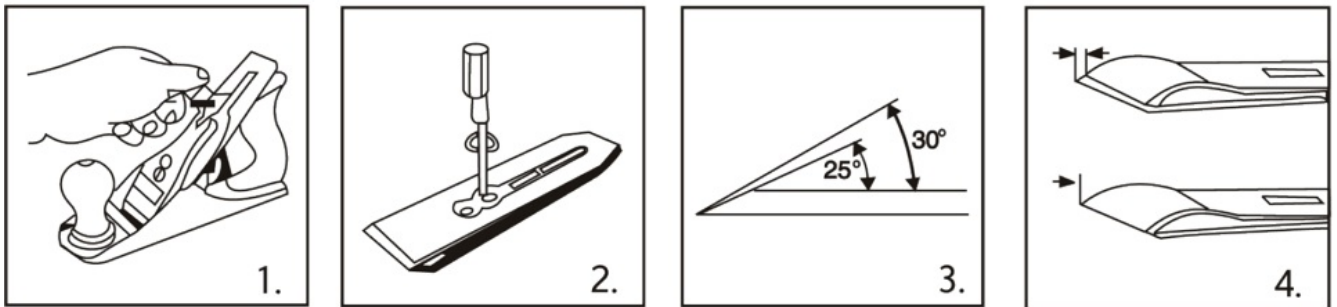

Quick Tips

- The brass adjusting nut can be used to alter the depth of cut.
- When planing softwood, set the cap iron 2mm back from the cutting edge.
- When planing hardwood, set the cap iron as close as possible to the cutting edge.

For Best Results

- Keep shaving thickness to a minimum.
- Ensure that the plane base is maintained in line with the workpiece.
- At the start of the stroke, apply pressure to the top of the plane. Adjust this pressure to the heel of the plane towards the end of the stroke.
- At the end of each cutting stroke, lift the plane from the workpiece before the next stroke.
- This product should be used to plane in the direction of the wood grain. When planing end grain, work from edge to middle.
- Candle wax can be used for ease of movement if required; simply rub the wax into the base of the plane.

Product Care

- Keep the blade sharp, and oil metal parts when not in use.
- Do not use other metal objects to clear shavings from the plane.
- When not in use, lay the plane on its side to protect the blade.

www.spear-and-jackson.com

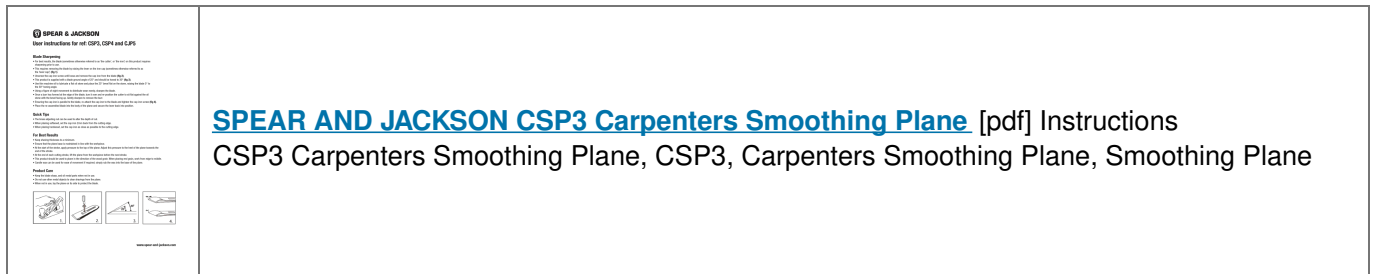

References

- [!\[\]\(13b6bdd0ca077c333d50231f1443cb1d_img.jpg\) Spear and Jackson | Garden & Hand Tools](#)