



Speakerbus iD808 Support Hub Stand Instructions

[Home](#) » [Speakerbus](#) » Speakerbus iD808 Support Hub Stand Instructions 

Contents

- [1 Speakerbus iD808 Support Hub Stand](#)
- [2 Product Information: Speakerbus iD808 Stand](#)
- [3 Product Usage Instructions:](#)
- [4 Extending Legs](#)
- [5 Collapsing Legs](#)
- [6 Documents / Resources](#)
- [7 Related Posts](#)



Speakerbus iD808 Support Hub Stand



Product Information: Speakerbus iD808 Stand

The Speakerbus iD808 Stand is a portable stand designed to hold the Speakerbus iD808 unit. It allows for easy positioning and adjustment of the unit for optimal usage.

Product Usage Instructions:

Extending Legs

1. Take the stand out of the box.
2. Unfold the legs to the desired position.
3. Ensure both legs are adjusted to the same height.

Collapsing Legs

1. If you need to position the unit behind a keyboard, follow this step. Un-click the leg lifters behind each leg and unfold them until they click into the latch. Ensure both leg lifters are adjusted to the same height.
2. Pull the leg outwards until it unlocks.
3. Collapse the leg to its folded position.

Note: The product model is STA808/R2, and these instructions were last updated in September 2021.

Extending Legs

1. Take item out of box.

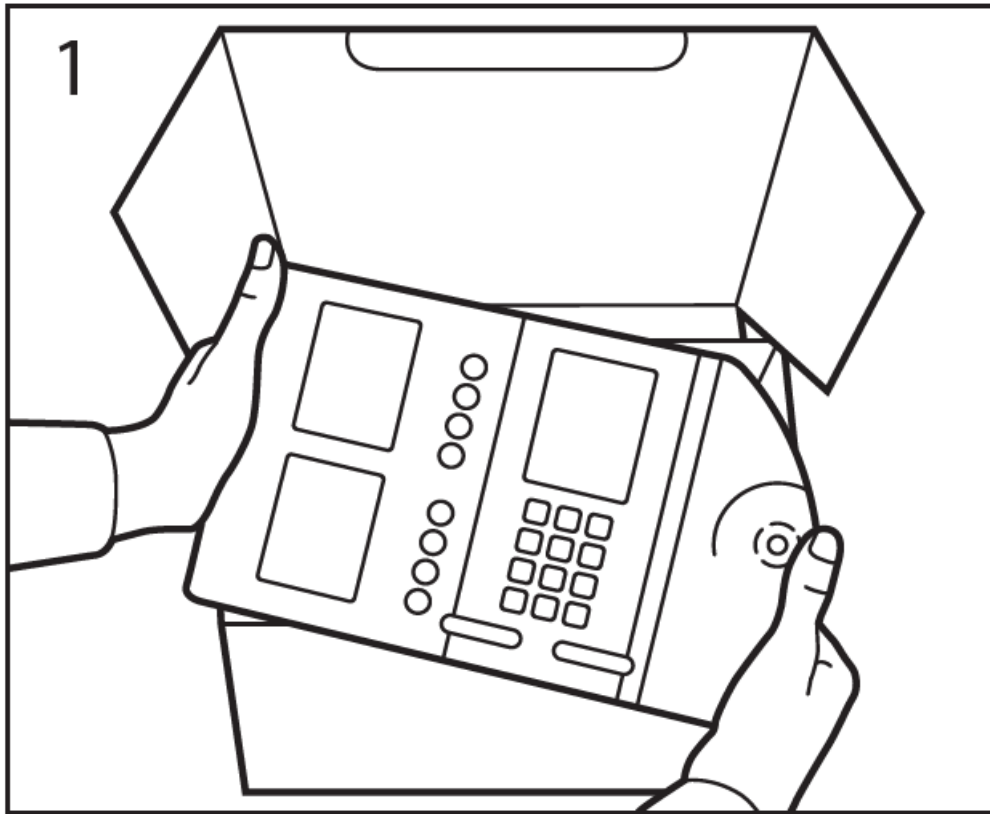

2. Un-fold legs to desired position. Ensure both legs are adjusted to the same height.

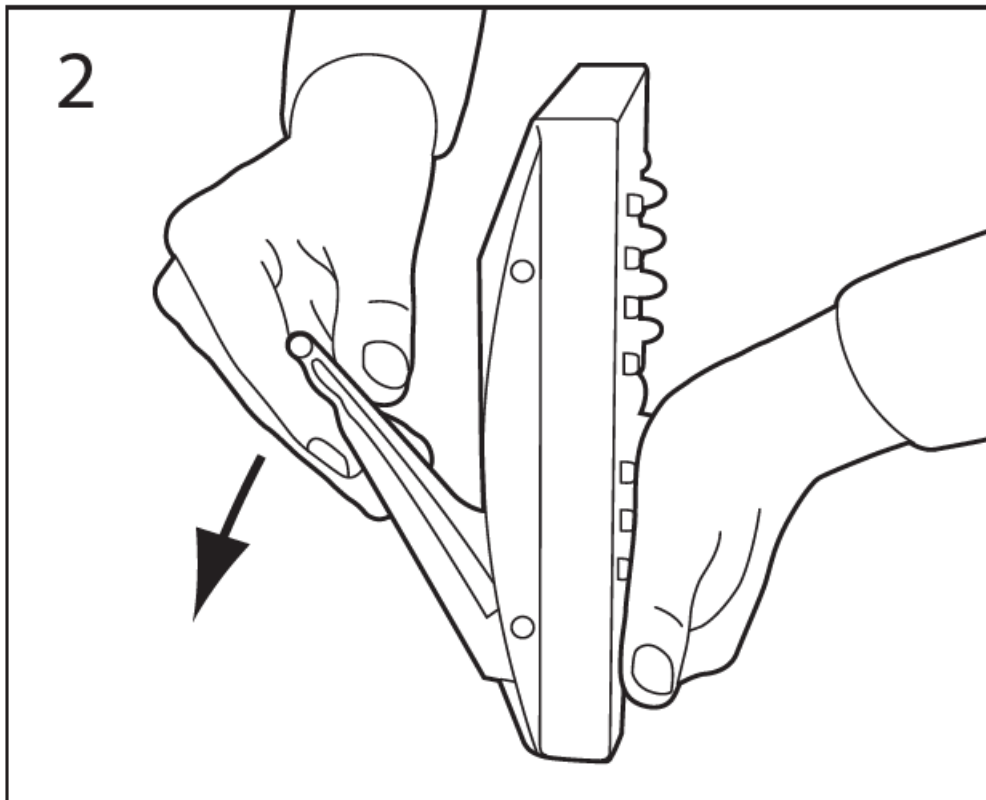

3. Please follow this step if you require the unit to be positioned behind a keyboard. Un-click leg lifters behind leg, and un-fold them until they click in latch. Ensure both leg lifters are adjusted to the same height.

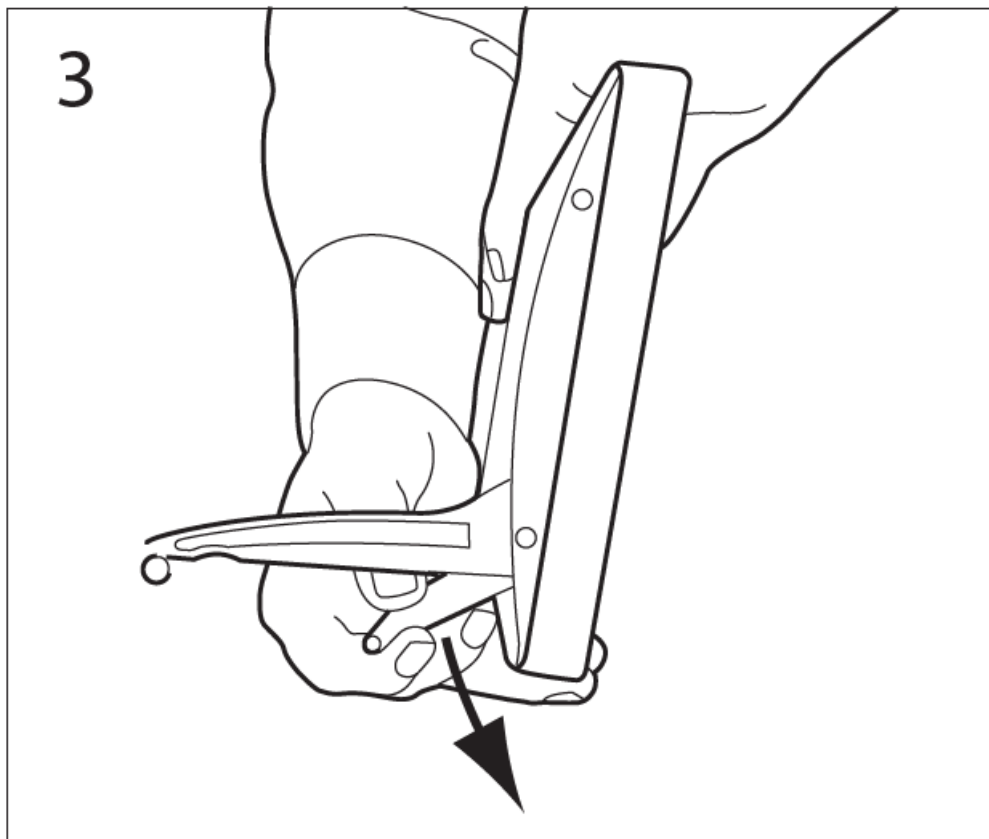

Collapsing Legs

1. Pull leg outwards until it un-locks.

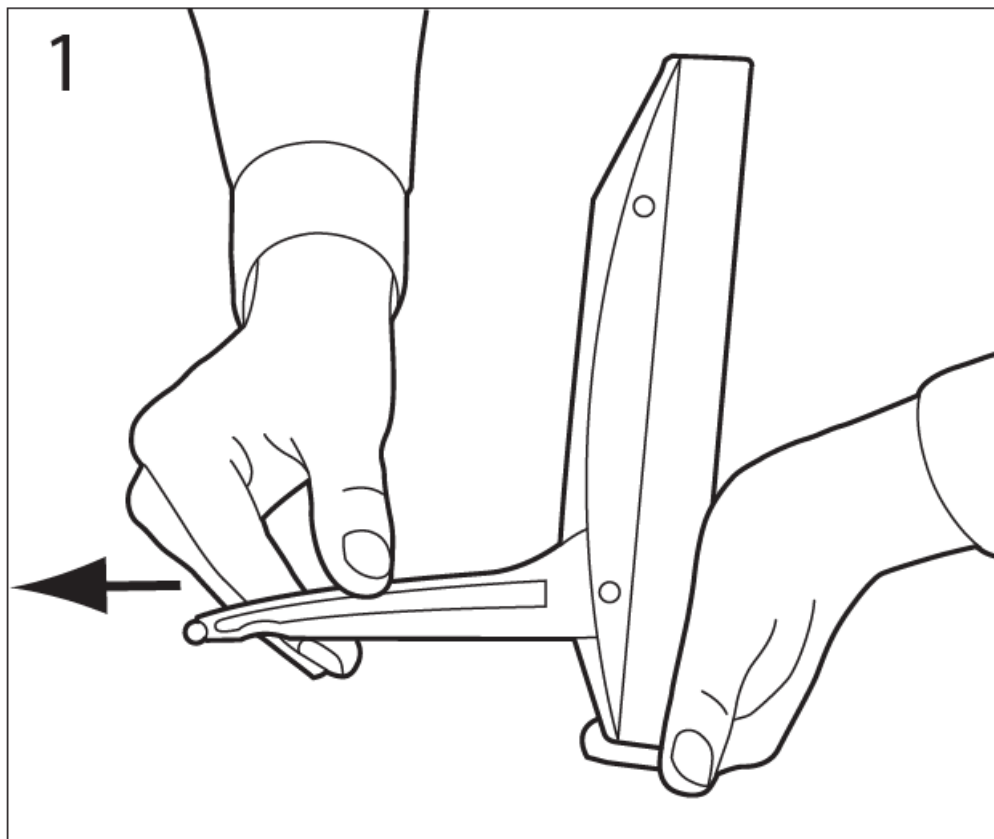

2. Collapse leg to folded position.

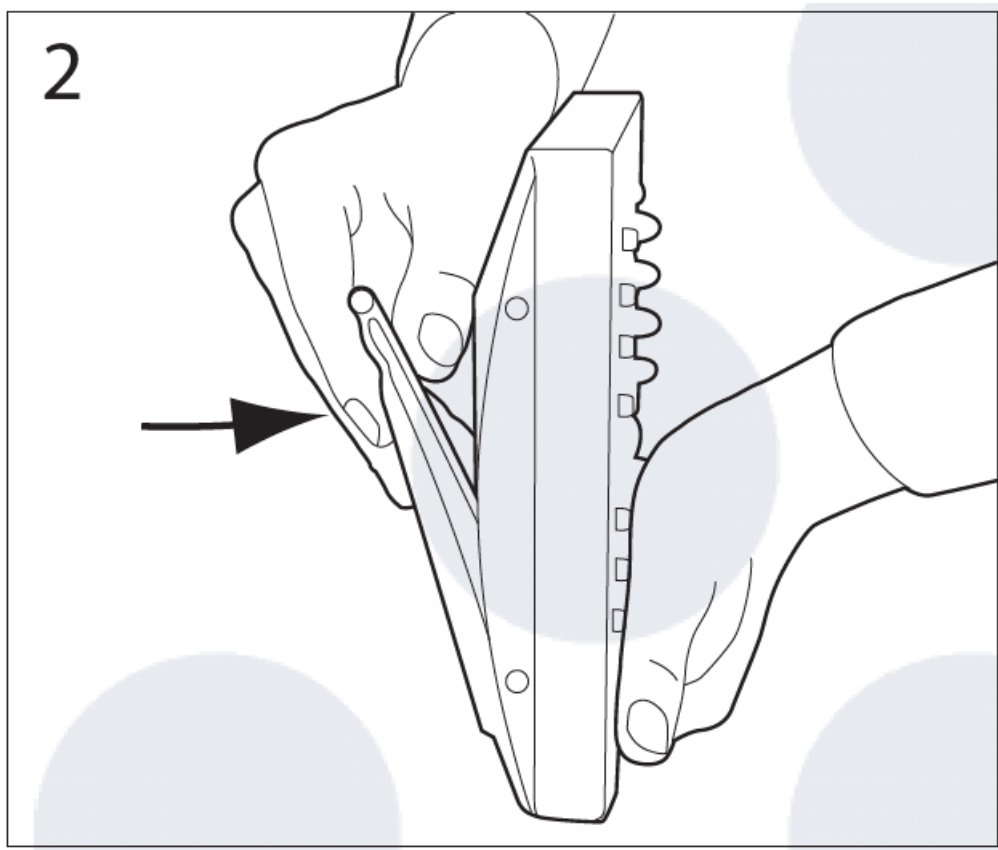

STA808/R2, Sept 2021

Documents / Resources

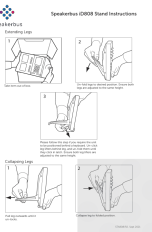
	<p>Speakerbus iD808 Support Hub Stand [pdf] Instructions iD808 Support Hub Stand, iD808, Support Hub Stand, Hub Stand</p>
---	---