

SP
CONNECT
MAN211
Phone
Case
Xtreme



SP CONNECT MAN211 Phone Case Xtreme Instruction Manual

[Home](#) » [SP CONNECT](#) » SP CONNECT MAN211 Phone Case Xtreme Instruction Manual 

Contents

- [1 SP CONNECT MAN211 Phone Case Xtreme](#)
- [2 Product Usage Instructions](#)
- [3 INSTALLATION CHECKLIST](#)
- [4 HOW TO USE](#)
- [5 Documents / Resources](#)
 - [5.1 References](#)
- [6 Related Posts](#)



SP CONNECT MAN211 Phone Case Xtreme



Product Specifications:

- Product Name: Phone Case XTREME
- Languages: EN / DE / FR / ES

Product Usage Instructions

Installation Checklist:

1. Ensure all joints are tightly closed.
2. Before exposure, make sure all joints are sealed.

Everyday Use Checklist:

Avoid contact with harsh chemicals including soap, detergents, and chlorine.

INSTALLATION CHECKLIST

- Test housing for water resistance before first use with phone.
- Ensure all ports and seams tightly sealed.

EVERYDAY USE CHECKLIST

- After major drops inspect case for any damage and ensure all seams are sealed.
- Perform water test without phone at regular intervals, after major impacts and before major water exposure.
- Ensure all seals and o-ring are free of dust, fibers and debris before closing case.
- Rinse case thoroughly with fresh water after exposure to chemicals including soap, detergents, and chlorine.

HOW TO USE

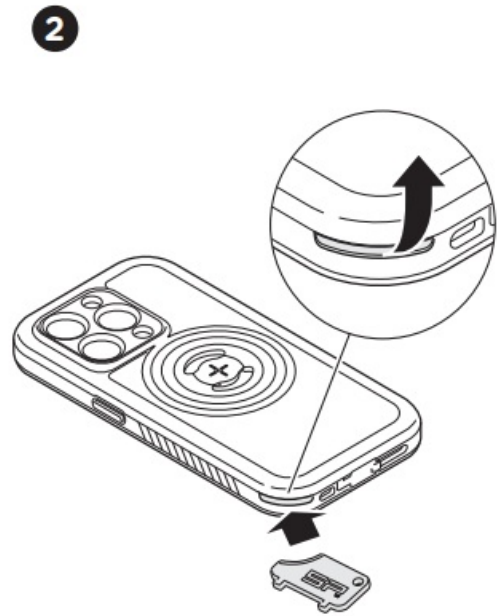
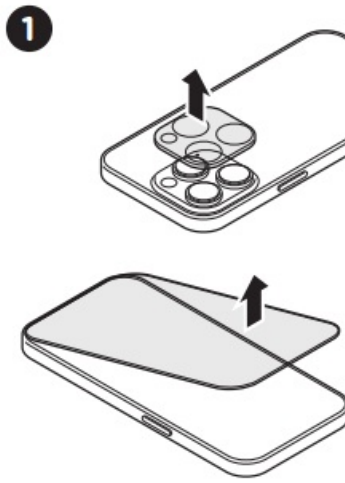

Remove any Screen & Camera Lens Protector

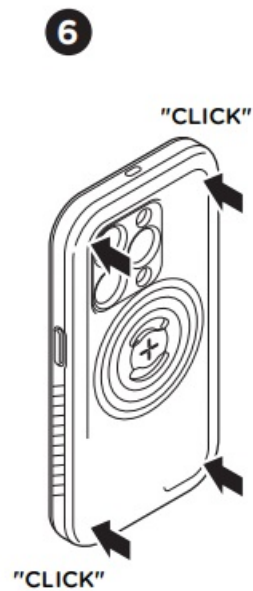
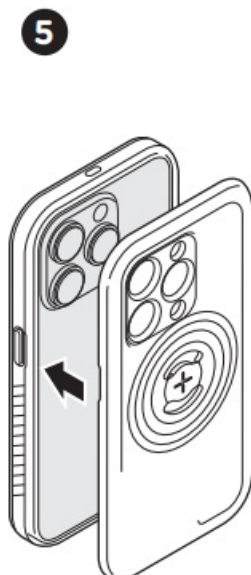

Close all seals

7



8



WARNING

9

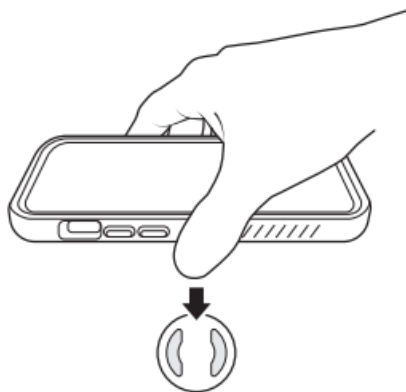

10

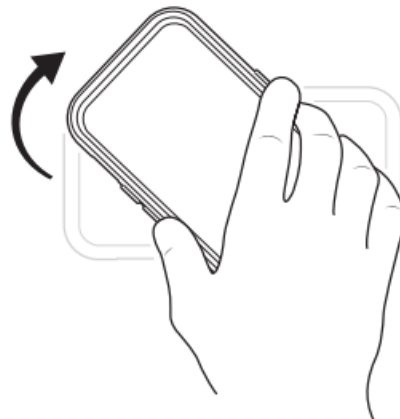

11



12

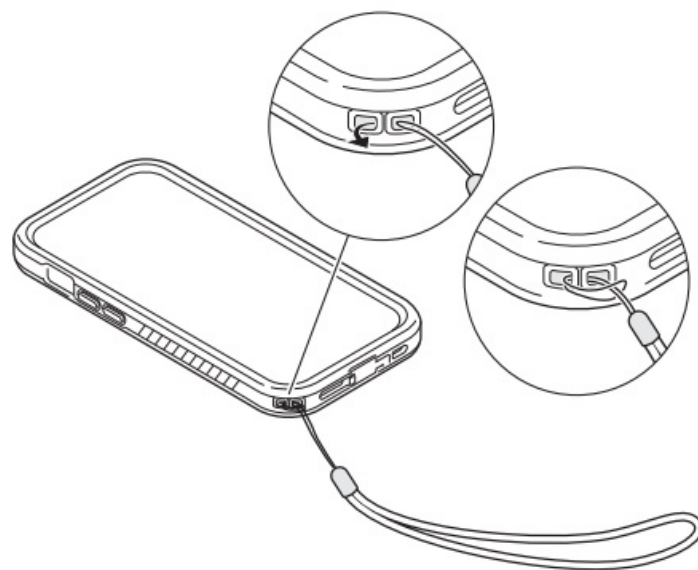
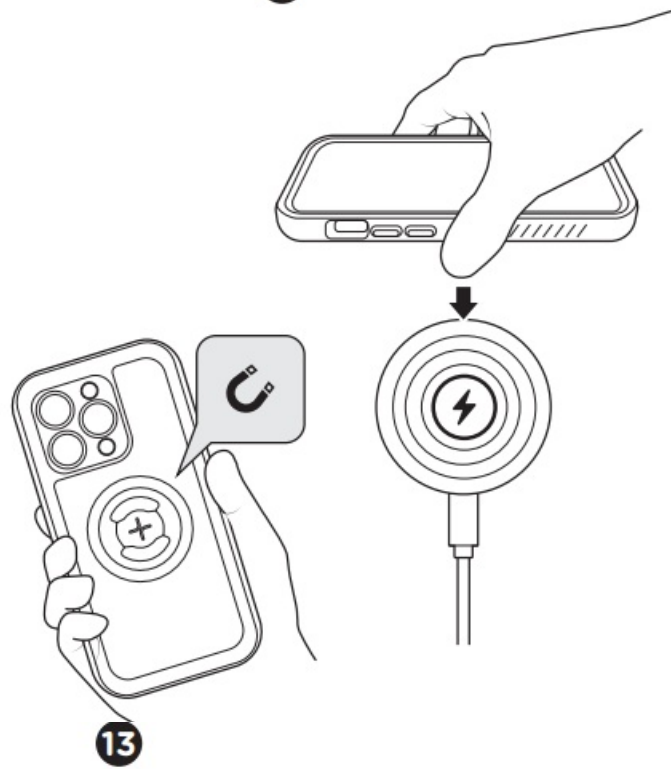

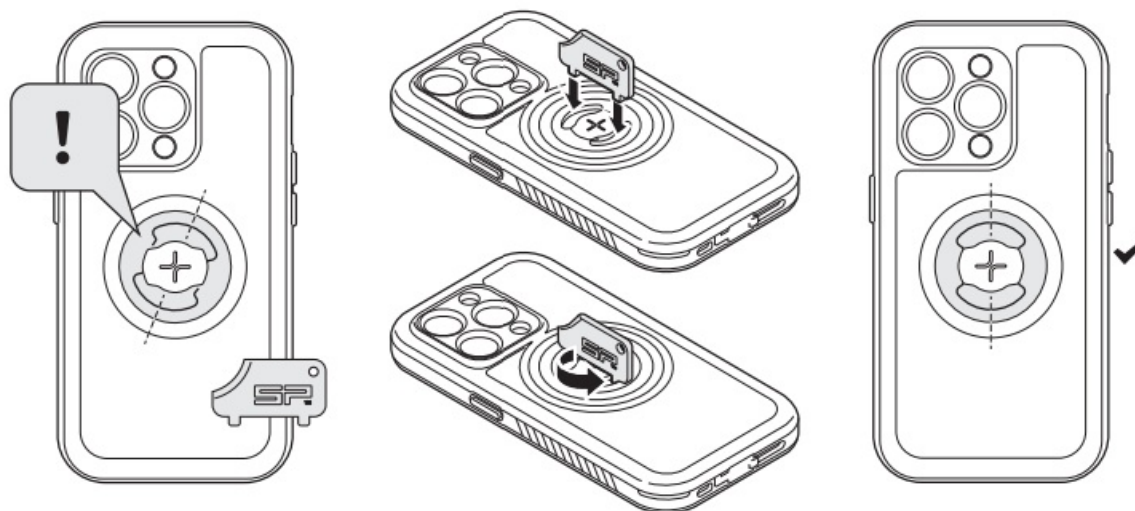

FAQ (Frequently Asked Questions):

Q: How do I properly install the Phone Case XTREME?

A: Follow the installation checklist provided in the manual to ensure all joints are tightly closed and sealed before use.

Q: Can the Phone Case XTREME withstand exposure to chlorine?

A: It is advised to avoid contact with chlorine and other harsh chemicals to maintain the integrity of the case.

Q: In which languages is the user manual available?

A: The user manual is available in English (EN), German (DE), French (FR), and Spanish (ES).

Documents / Resources

	<p>SP CONNECT MAN211 Phone Case Xtreme [pdf] Instruction Manual SPC, ESPCD9470-52899, MAN211, MAN211 Phone Case Xtreme, MAN211, Phone Case Xtreme, Case Xtreme, Xtreme</p>
---	--

References

- [User Manual](#)

[Manuals+](#), [Privacy Policy](#)

This website is an independent publication and is neither affiliated with nor endorsed by any of the trademark owners. The "Bluetooth®" word mark and logos are registered trademarks owned by Bluetooth SIG, Inc. The "Wi-Fi®" word mark and logos are registered trademarks owned by the Wi-Fi Alliance. Any use of these marks on this website does not imply any affiliation with or endorsement.