



SP CONNECT Charging Module Instruction Manual

[Home](#) » [SP CONNECT](#) » SP CONNECT Charging Module Instruction Manual 

Contents

- [1 SP CONNECT Charging Module](#)
- [2 Product Information](#)
- [3 Product Usage Instructions](#)
- [4 Technical Specifications](#)
- [5 Setup Tips for Outdoor Navigation](#)
- [6 FCC Statement](#)
- [7 Documents / Resources](#)
- [8 Related Posts](#)



SP CONNECT Charging Module



Product Information

- Input: QC 2.0/3.0
- Wireless Output: Max 15W
- Recommended Operating Temperature: IP65
- Power Consumption: Charge power is variable and depends on power source, phone model, temperature, etc.
- Standby Power Consumption: 8-20 mA
- FCC Compliance: This device complies with Part 15 of the FCC Rules.
- Radiation Exposure: This equipment complies with FCC radiation exposure limits set forth for an uncontrolled environment.

Product Usage Instructions

To use the charging module, please follow these instructions:

1. Connect the provided 12V DC cable (part number #52809) or the 6V DC cable (part number #52810) to the input of the charging module.

1



2. Ensure that the charging module is placed in an outdoor environment with a recommended operating temperature range.

2

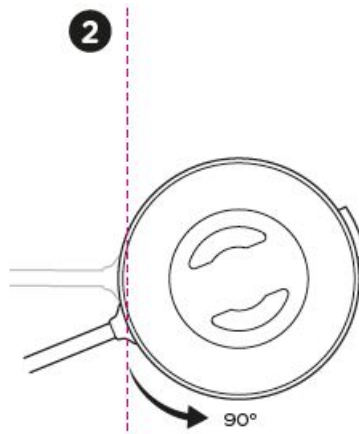

3. Place your phone on the wireless charging pad of the charging module.

3

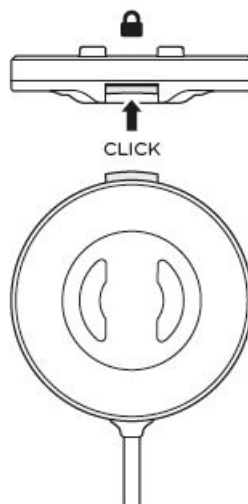

4. Make sure there is a minimum distance of 20cm between the radiator (charging module) and your body to comply with FCC radiation exposure limits.

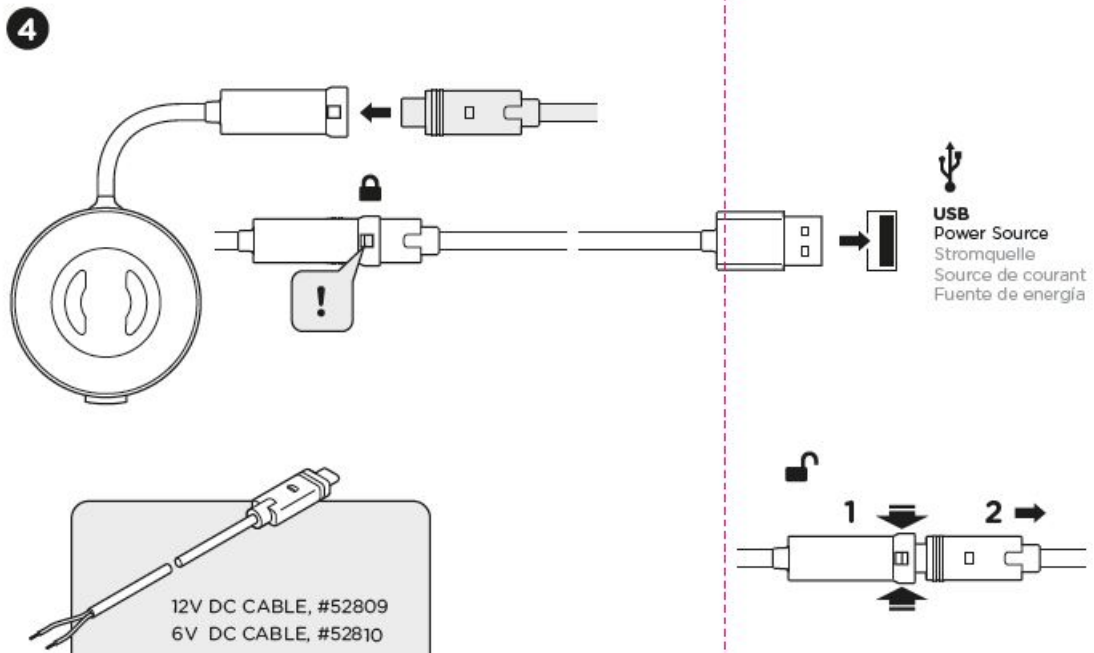

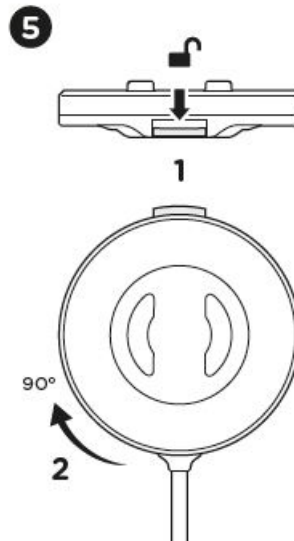

5. The charge power will vary depending on factors such as the power source, phone model, and temperature. Please wait for the phone to start charging.

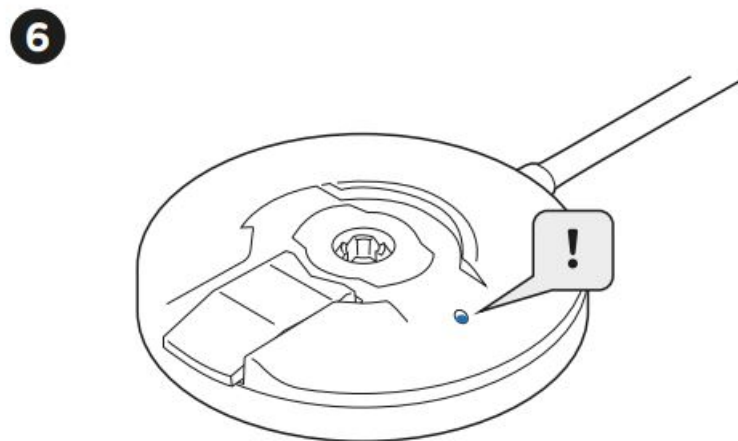

6. If any error occurs, indicated by a red flashing light, refer to the error codes mentioned in the user manual for troubleshooting steps.



RED 	Ready
BLUE 	Charging
RED FLASH 	Error

Note: The equipment has been tested and found to comply with FCC rules. However, there is no guarantee that interference will not occur in a particular installation. If interference is experienced, try the following measures:

- Try turning the equipment off and on again.
- Ensure the equipment is installed and used according to the provided instructions.
- If interference persists, consult the user manual for further guidance or contact customer support.

Technical Specifications

Input	USB-C: USB-PD USB-A: 5V/2A • 5V/3A QC 2.0/3.0
Wireless Output	Max 15W <i>Charge power is variable and depends on power source, phone model, temperature, etc.</i>
Recommended Operating Temperature	-10—40° C <i>Charge performance will drop above ~40° C</i>
Power Consumption	8—20 mA (Standby)

IP65 RATED: No ingress of dust; complete protection against contact (dust tight). Water projected by a nozzle (6.3 mm) against enclosure from any direction shall have no harmful effects. Minimum operating temperature: 0°C / 32°F

ATTENTION!

- Cut off power supply when not in
- Avoid use in a humid or high temperature environment if
- Don't hit, disassemble or re-assemble the product – this may lead to
- For waterproof connection use compatible SP Connect™ cables
- High Temperatures can reduce charge efficiency.

Smartphone power consumption can exceed charge power. Setup phone appropriately

Setup Tips for Outdoor Navigation

- Outdoor navigation at high temperature reduces charge efficiency.
- Use adaptive screen brightness, consider using night mode, switch off screen occasionally.
- Use locally stored maps to avoid data traffic and power consumption.
- Turn off data traffic if not needed.
- Turn off unnecessary apps running in the background.
- Turn off Wi-Fi antenna while you are moving.

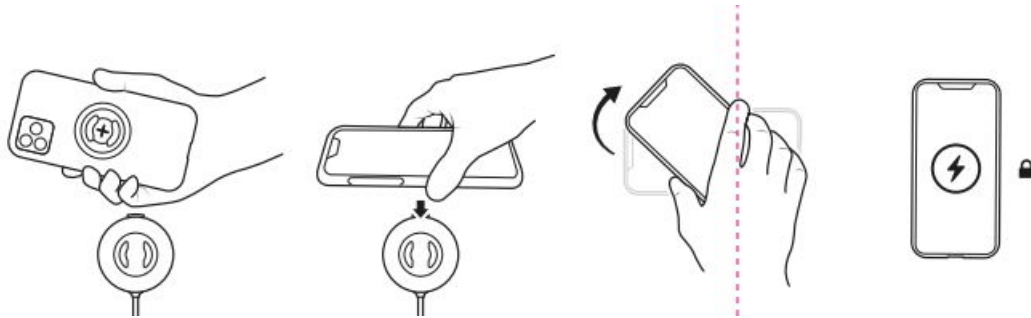

FCC Statement

1. This device complies with Part 15 of the FCC Rules. Operation is subject to the following two conditions:
 - This device may not cause harmful interference, and
 - This device must accept any interference received, including interference that may cause undesired operation.
2. Changes or modifications not expressly approved by the party responsible for compliance could void the user's authority to operate the equipment.

NOTE: This equipment has been tested and found to comply with the limits for a Class B digital device, pursuant to Part 15 of the FCC Rules. These limits are designed to provide reasonable protection against harmful interference in a residential installation.

This equipment generates uses and can radiate radio frequency energy and, if not installed and used in accordance with the instructions, may cause harmful interference to radio communications. However, there is no guarantee that interference will not occur in a particular installation. If this equipment does cause harmful interference to radio or television reception, which can be determined by turning the equipment on and off, the user is encouraged to try to correct the interference by one or more of the following measures:

- Reorient or relocate the receiving
- Increase the separation between the equipment and
- Connect the equipment into an outlet on a circuit different from that to which the receiver is
- Consult the dealer or an experienced radio/TV technician for

FCC Radiation Exposure Statement

This equipment complies with FCC radiation exposure limits set forth for an uncontrolled environment. This equioment should be installed and operated with minimum distance 20cm between the radiator & your body.

Documents / Resources

	SP CONNECT Charging Module [pdf] Instruction Manual MAN138_ChargingModule_90x90, Charging Module, Module
---	---

Manuals+