



SOYAL 721APP App for Android Instruction Manual

[Home](#) » [SOYAL](#) » SOYAL 721APP App for Android Instruction Manual 

SOYAL 721APP App for Android Instruction Manual



Application 3 : SOYAL 721 APP / 727 APP

SOYAL 721 APP Function : The user can use mobile phone to control SOYAL controller reader via Ethernet, 721 APP support to remote open the door lock, monitor and display the controller status of arming, disarm, alarm on mobile phone. Now the APP can be downloaded on Google store for Android system.

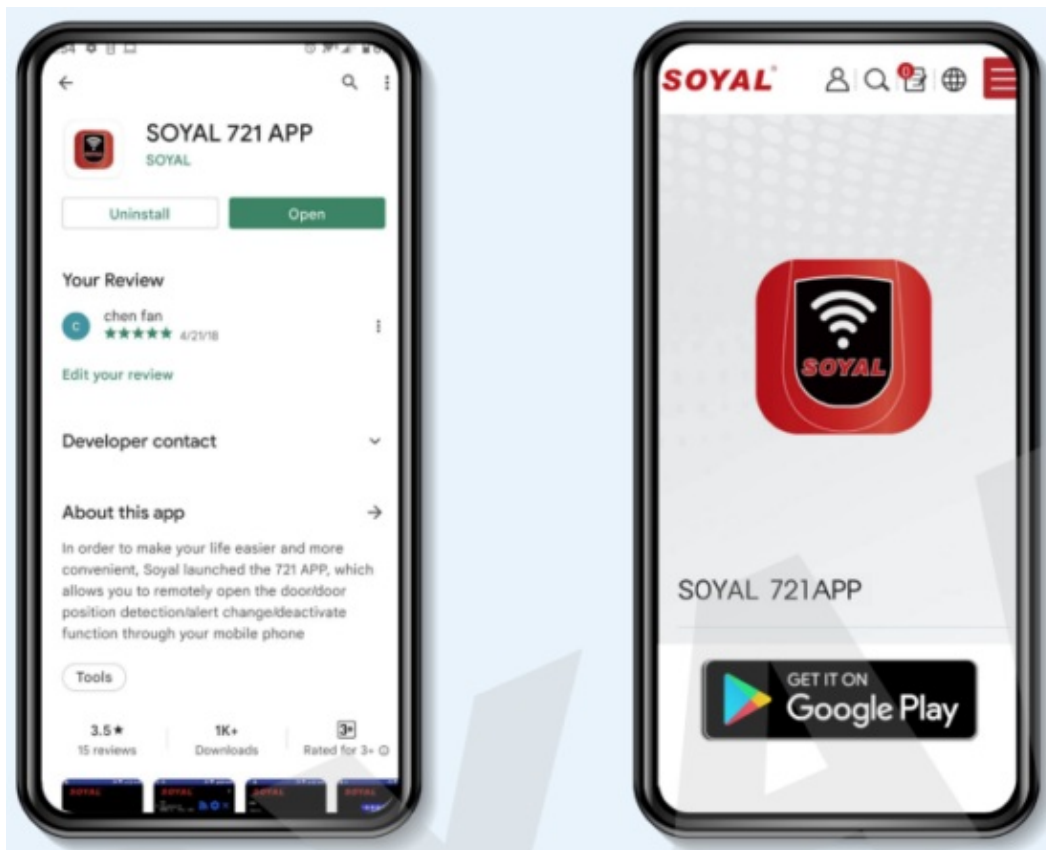

Contents

- [1 APP Setting Procedures](#)
- [2 APP Setting Procedures](#)
- [3 Documents / Resources](#)
- [4 Related Posts](#)

APP Setting Procedures

Step 1: Install 721 APP and then open it

Step Step 2. Enter Account and Password (Both default account and default password is admin)

- Account admin (default account)
- Password admin (default password)

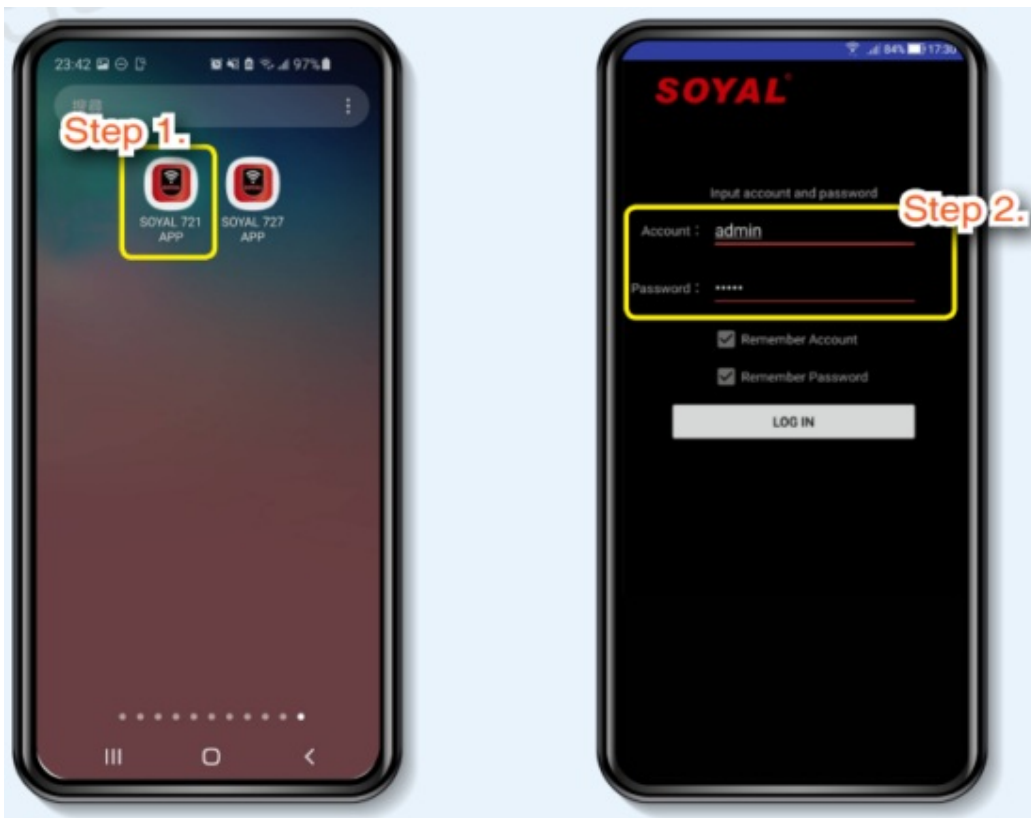

Step 3. Click “Add” to set up controller connection

Step 4. Enter name / IP Address /communication/ Port Number /Noe ID, click “Add” button

Step 5. Click the blue button  to connect the controller



Step 6. Enter 721 APP function page

6-1 Display Door open/ close status

6-2 Display Door Relay output status

6-3 Touch Arming button, the device will enter Arming Mode. Touch Disarm button, exit arming mode.

6-4 Slide the first button to right, the function is to open the door lock based on the setting of Door Relay time and the door lock will be automatically closed after the setting door time is end.

6-5 Slide the middle button to right, the door lock will keep unlock

6-6, Till to Slide the bottom button to right, the door lock will be lock again.



Step 7

Change login account and password

7-1 Click the symbol in the upper right corner

7-2 Click Settings in the upper right corner

7-3 Select [Change Account]/[Change Password] to enter new Account and new Password.



More Details :

Video : <https://www.youtube.com/watch?v=YRm9nGUA1II>

SOYAL 727 APP Function: SOYAL network Digital I/O Module support to monitor DI/DO status and remote control DO output; AR-727-CM-I0 is built-in 8 DI and 4 DO (built-in one Relay on the first DOO point) that can be

used in monitoring door sensor status, high/low water level detection, push button and other status detection, as well as switch, flashing buzzer, electric lock and other equipment on / off control.

Now the APP can be downloaded on Google store for Android system or download from SOYAL official website.

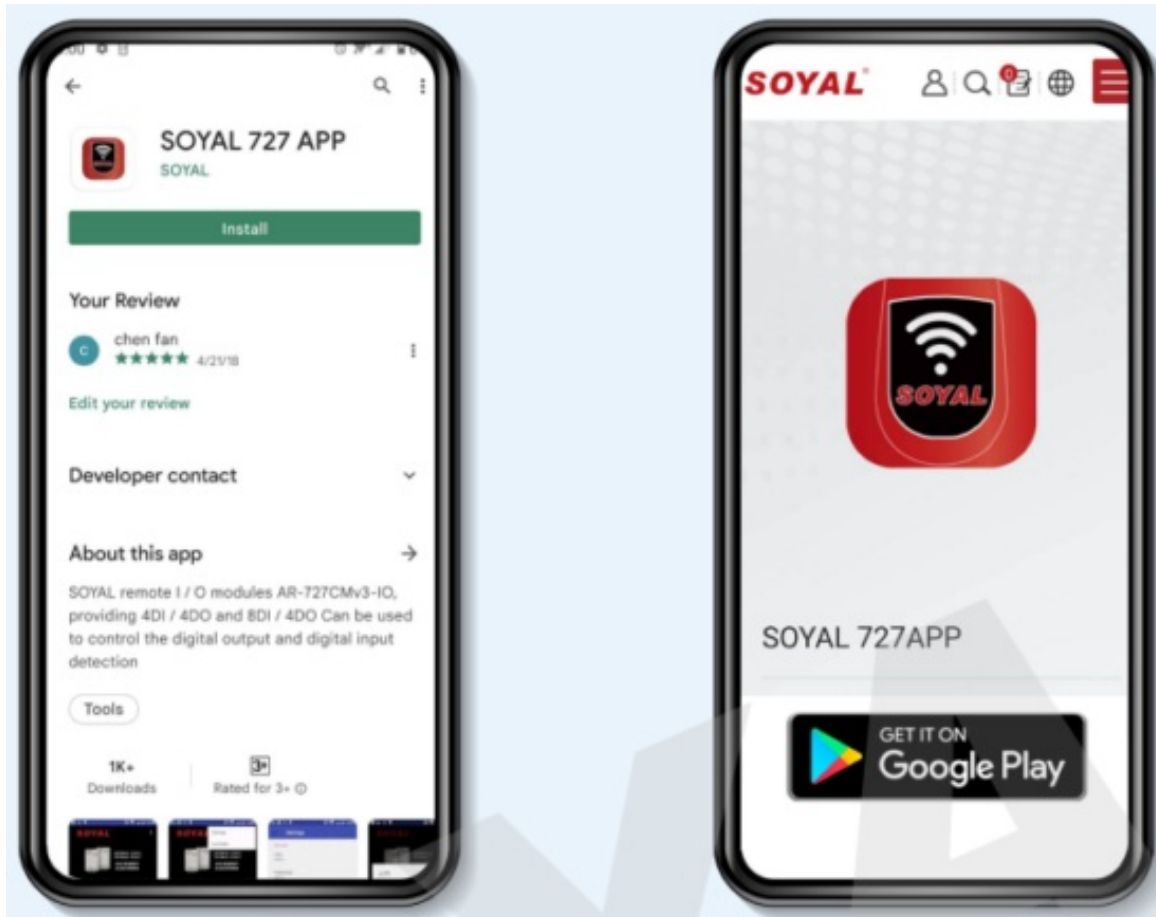

APP Setting Procedures

Step 1. Install 721 APP and then open it

Step 2. Click Settings in the upper right corner

Step 3. Set the following information: account (User) / Password / IP Address / Port Number/ Change Device Name / DI_O-D17 / DO_O-D0_3.

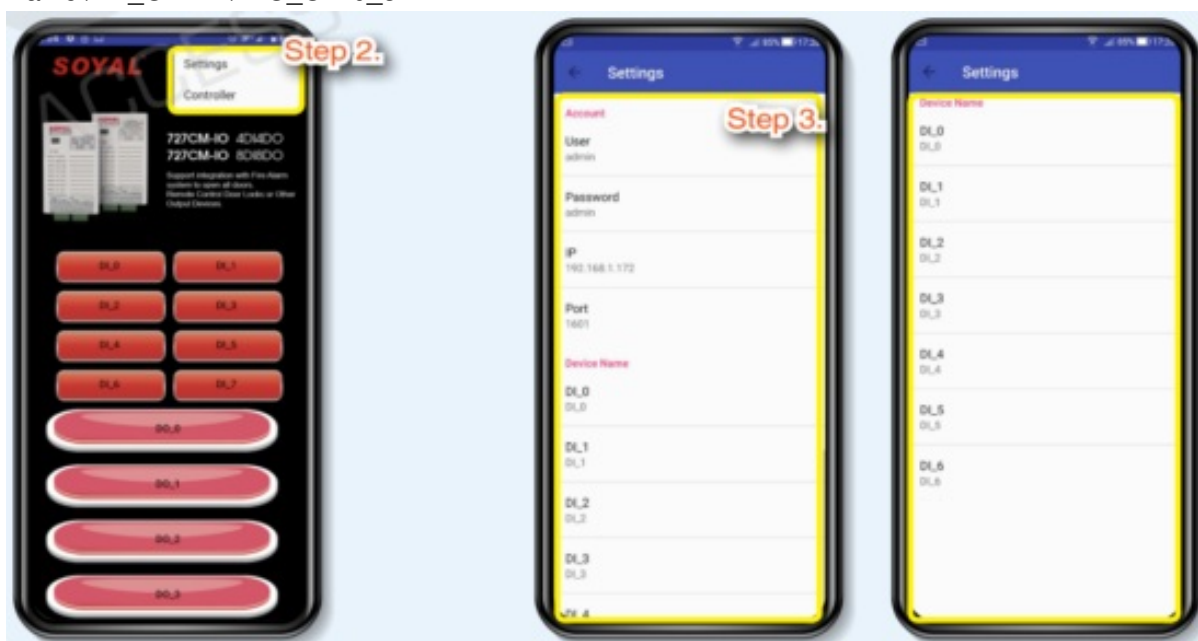

Step 4. Enter 727 APP function operation page

4-1 Real-time DI status display

4-2 Real-time DO output control; enter output seconds and slide the button to right (the range of seconds is 0.1-600 seconds)



More Details :

Video : <https://www.youtube.com/watch?v=8hMFq9SqVkM>

Documents / Resources

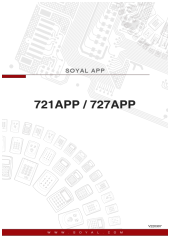
	<p>SOYAL 721APP App for Android [pdf] Instruction Manual 721APP, 727APP, App for Android</p>
-----------------------------------------------------------------------------------	------------------------------------------------------------------------------------------------------------------