



Soundcore Space Q45 User Manual

[Home](#) » [Soundcore](#) » Soundcore Space Q45 User Manual 

Contents

- 1 Soundcore Space Q45 User Manual
- 2 APP
- 3 WEARING
- 4 CHARGING
- 5 POWERING ON & PAIRING
- 6 MULTIPOINT CONNECTION
- 7 MANUAL PAIRING
- 8 BUTTON CONTROLS
- 9 NOISE CANCELLATION
- 10 TRANSPARENCY
- 11 RESET
 - 11.1 LED LIGHT GUIDE
- 12 FIRMWARE UPDATE
- 13 SPECS

soundcore

Soundcore Space Q45 User Manual



APP

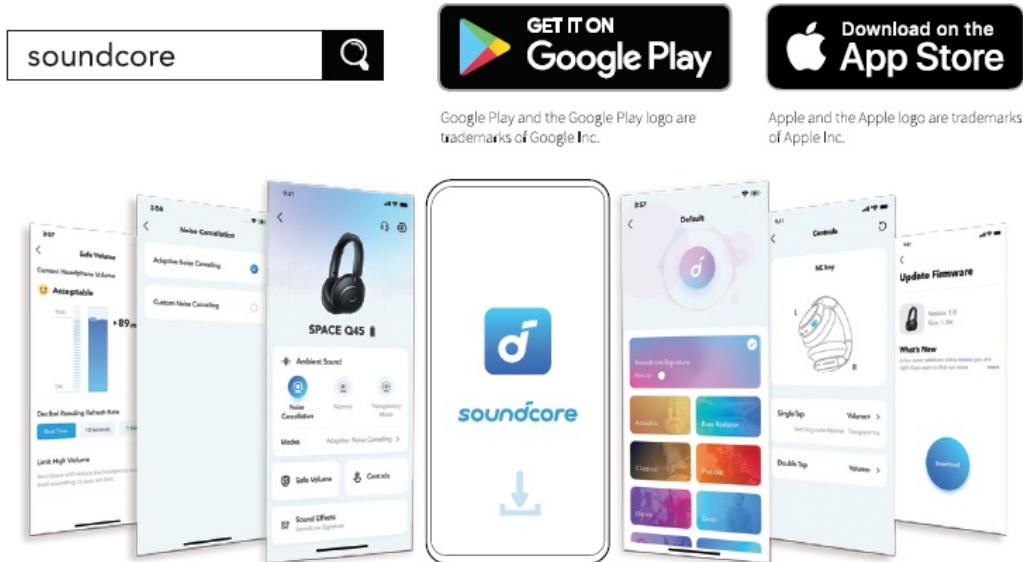

Download the soundcore app to customize ambient sound, adjust EQ settings, update firmware, and explore more.

If your headphones cannot connect with the soundcore app, update it to the latest version in your mobile app store.

WEARING

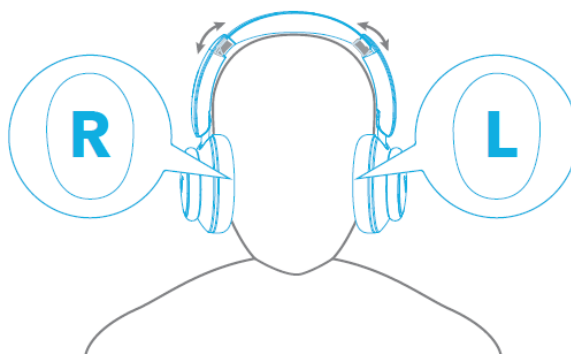

Wear the headphones with the “L” logo on your left ear and “R” logo on your right ear. Adjust the length of the headband for a comfortable fit.

CHARGING

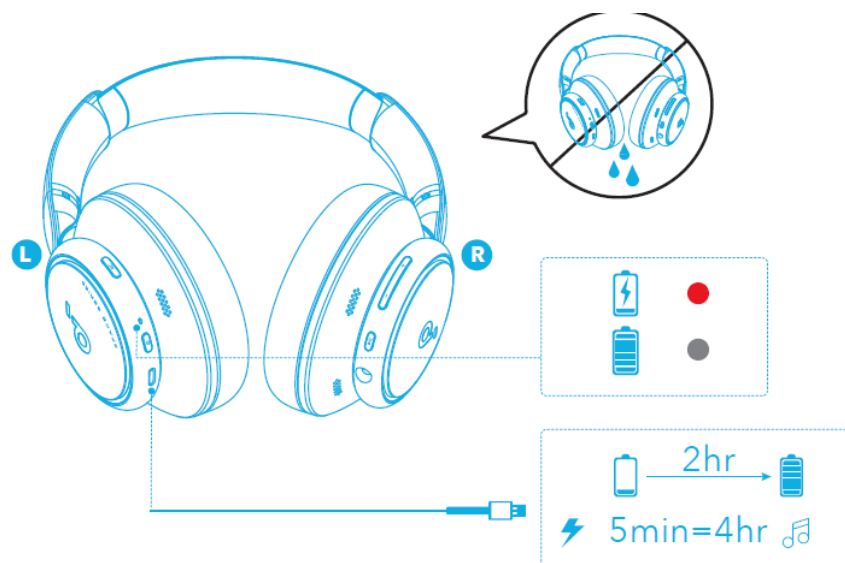

Fully dry off the USB port before charging.
Do not turn on your headphones while charging.
Use a certified USB-C charging cable and charger to prevent any damage.

POWERING ON & PAIRING

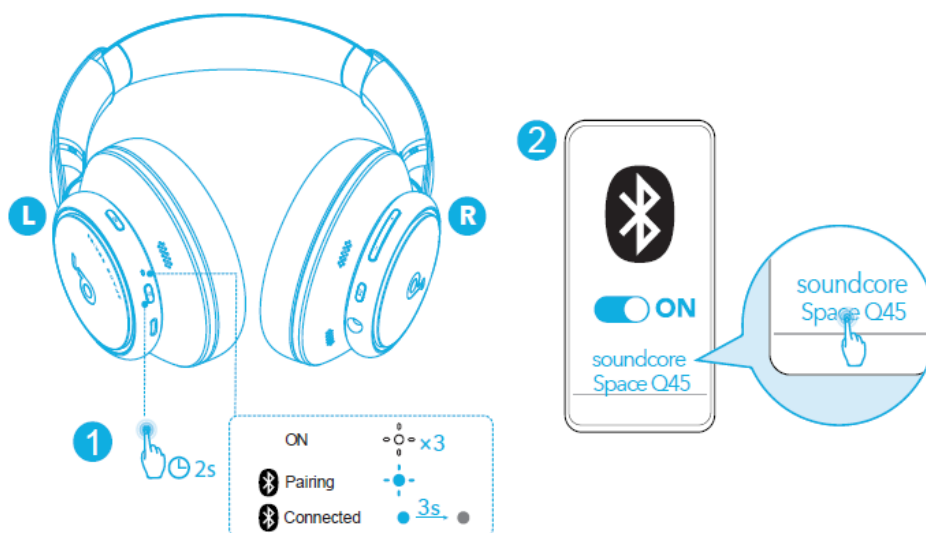

Press and hold the power button for 2 seconds to turn on. The headphones will automatically enter Bluetooth pairing mode when connecting for the first time.
Select “soundcore Space Q45” on your device’s Bluetooth list to connect.

MULTIPOINT CONNECTION

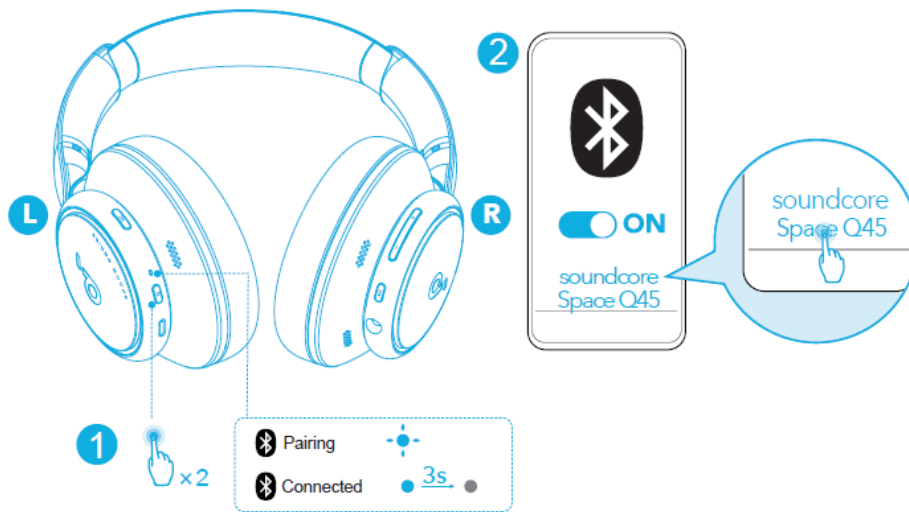

The headphones can connect with two devices at the same time. When already connected to one device, press the power button twice to pair with another device.

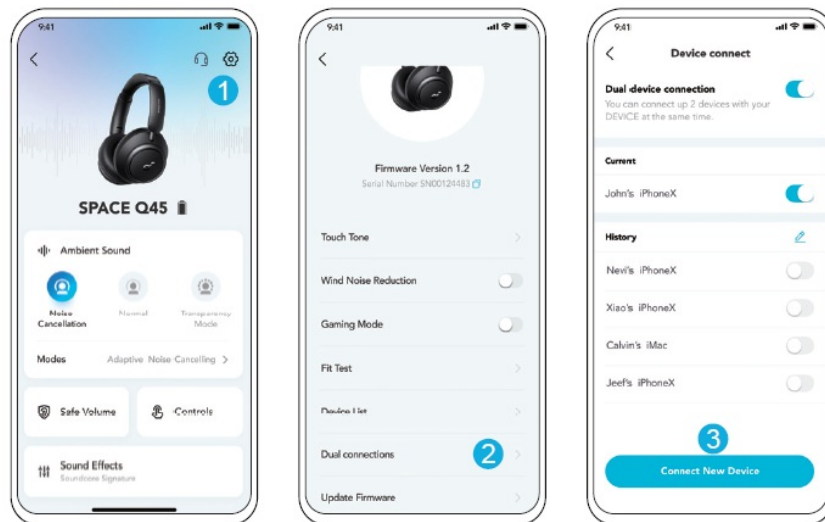

In the soundcore app, go to settings and select Dual Connections > Connect New Device.

MANUAL PAIRING

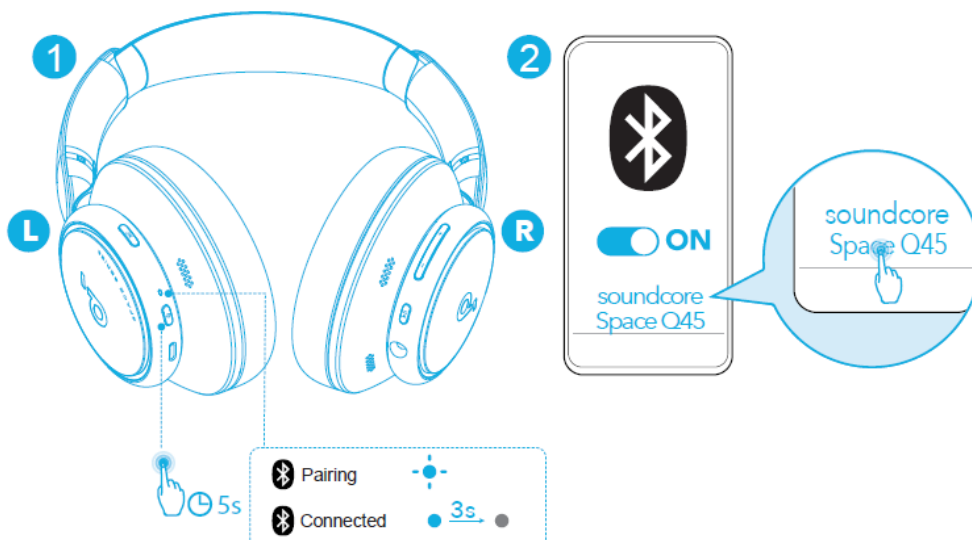







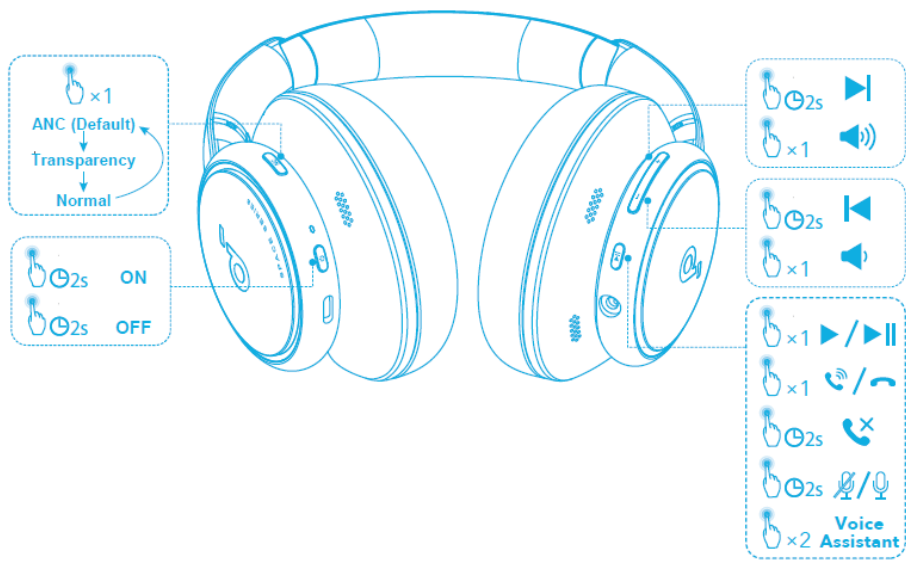

To manually enter Bluetooth pairing mode when the headphones are off, press and hold the power button for 5

seconds until the LED flashes blue.

BUTTON CONTROLS

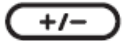

	Switch ambient sound modes (ANC /Transparency /Normal)		Press once
	Power on / off		Press and hold for 2 seconds

	Play / Pause		Press once
	Next track		Press and hold for 2 seconds
	Previous track		Press and hold for 2 seconds
	Volume up / down		Press once
	Answer / End a call		Press once
	Reject a call		Press and hold for 2 seconds
	Mute / Restore the microphone		Press and hold for 2 seconds
	Activate voice assistant software		Press twice

NOISE CANCELLATION

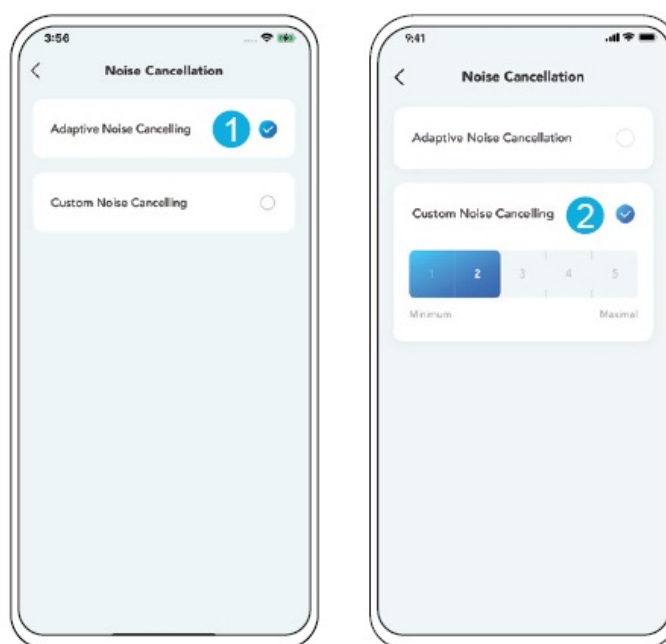

To reduce ambient noise, switch to noise cancellation (default) via NC button and customize in the soundcore app.

- Adaptive Noise Cancelling: Adjust the level of noise cancellation automatically for various scenarios.
- Custom Noise Cancelling: Set the level of noise cancellation manually.

TRANSPARENCY

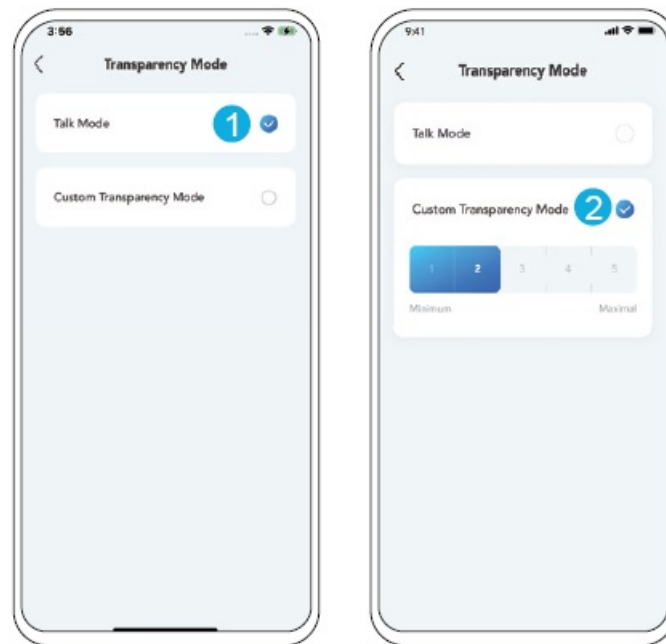

To stay aware of your surroundings while listening to music, switch to transparency via NC button and customize in the soundcore app.

- **Talk Mode:** Voices stand out more clearly from other ambient sounds.
- Custom Transparency Mode: Set the level of transparency manually.

LDAC

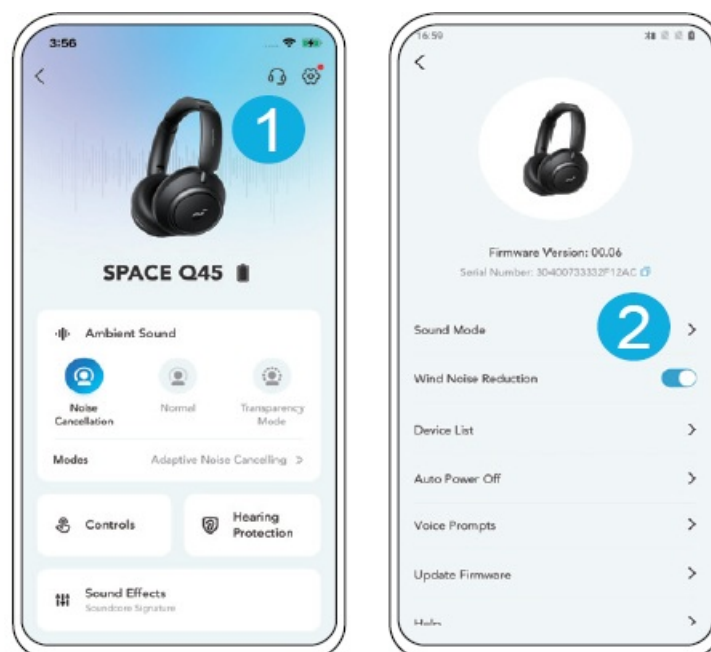

- Use devices powered by Android 8.0 or later to experience LDAC quality sound.
- LDAC provides higher quality sound, increases power consumption, and reduces playtime.

- Enable LDAC in a low-interference environment to ensure a stable Bluetooth connection.

1. Go to settings in the soundcore app.
2. Click on “Sound Mode”.

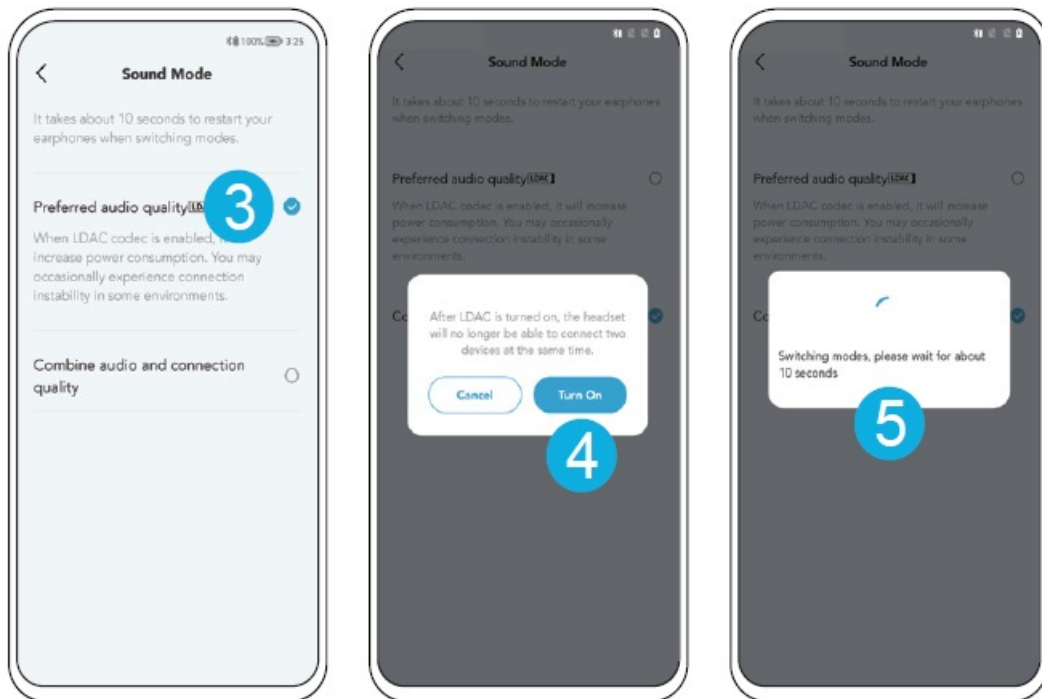

3. Select “Preferred audio quality” to switch to LDAC codec.
4. You will be notified that the headphones do not support LDAC when connected to two devices. Select “Turn on” to continue.
5. It takes about 10 seconds to switch audio codecs. You may be requested to update the headphones’ firmware if available.

WIRED LISTENING

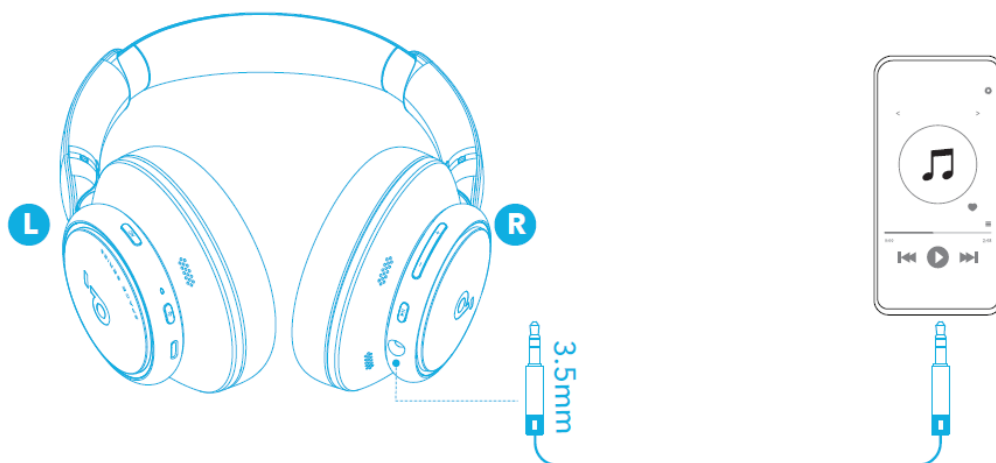

Play audio on an external device by plugging in a 3.5mm AUX cable. Wired listening will turn off Bluetooth mode automatically.

RESET

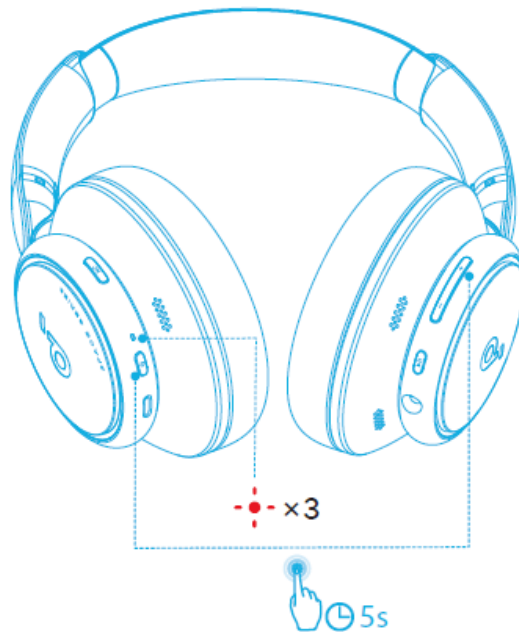

You might need to reset your headphones if you experience connectivity or function issues. Delete the pairing history from your Bluetooth device first. Press the power and volume up buttons simultaneously for 5 seconds until the LED flashes red three times.

LED LIGHT GUIDE

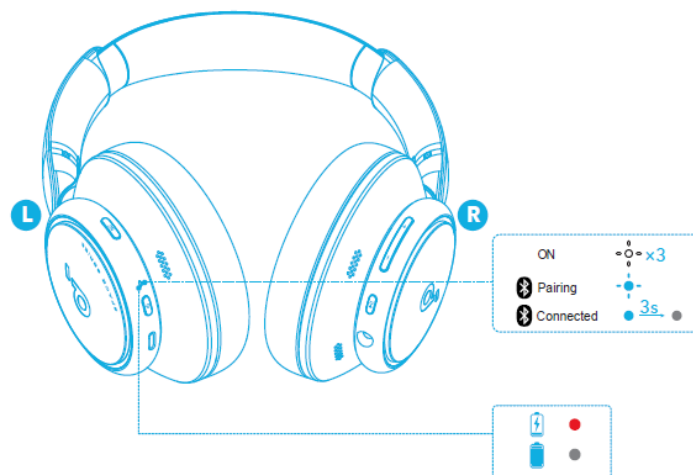

- Steady red
- Steady blue
- ⬢ Flashing white
- ⬢ Flashing blue
- Light off

FIRMWARE UPDATE

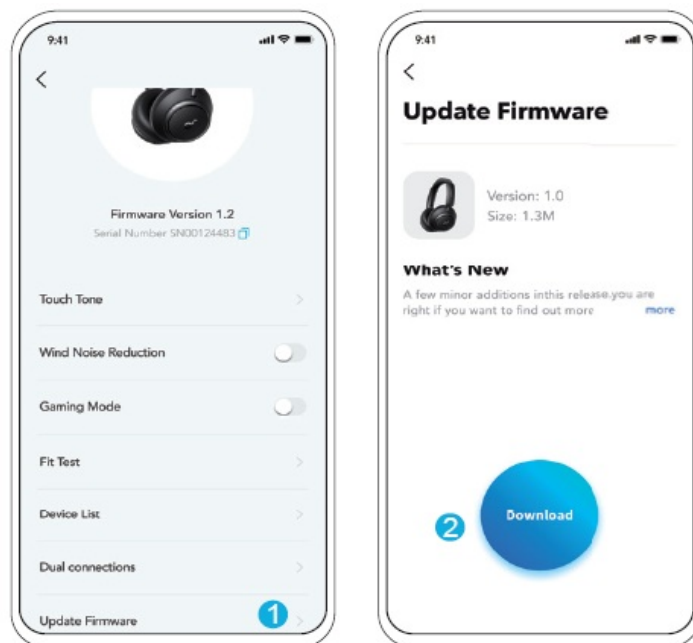

You will be informed once the new version of firmware is detected when you connect the headphones with the app.
Ensure the headphones are powered on and connected to a device until the firmware update is complete. During the update, avoid any usage and ensure stable access to the internet.

SPECS

Specifications are subject to change without notice.

Input	5 V 0.7 A
Rated output power	2.2 mW
Battery capacity	750 mAh
Charging time	2 hours
Playtime (with ANC off)	Up to 65 hours
Playtime (with ANC on)	Up to 50 hours
Driver size	40 mm
Frequency response	20 Hz – 40 kHz
Impedance	16
Bluetooth version	5.3
Bluetooth range	15 m / 49 ft

Download PDF: [Soundcore Space Q45 User Manual](#)