



## SoundCore Portable Speaker A3102 User Manual

[Home](#) » [Soundcore](#) » SoundCore Portable Speaker A3102 User Manual 

### Contents

- [1 SoundCore Portable Speaker A3102](#)
- [2 What's Included](#)
- [3 At a Glance](#)
- [4 Using Your SoundCore](#)
  - [4.1 1. Turn on / off](#)
  - [4.2 2. Charge your SoundCore](#)
  - [4.3 3. Pair with your device](#)
  - [4.4 1. Connect via AUX](#)
- [5 Controls](#)
  - [5.1 MUSIC CONTROL](#)
  - [5.2 CALL](#)
- [6 Specifications](#)
- [7 Attention](#)
- [8 FCC Statement](#)
- [9 RF Warning Statement](#)
- [10 BLUETOOTH:](#)
- [11 Declaration of Conformity](#)
- [12 Customer Service](#)
- [13 DOWNLOAD](#)
- [14 Related Posts](#)

**SoundCore Portable Speaker A3102**



## USER MANUAL

Product Number A 3102 رقم المنتج  
Bluetooth Speaker  
51005001172 V05

### What's Included



× 1



× 1

### At a Glance

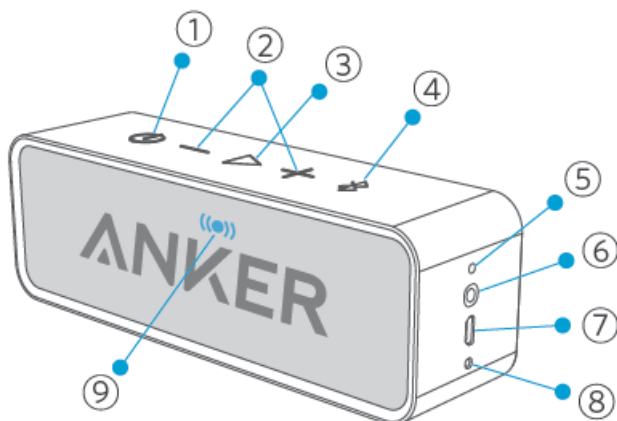

1. Power button
2. Volume buttons
3. Play/Pause button
4. Bluetooth pairing button
5. Battery indicator
6. 3.5mm Aux input
7. Micro USB charging port
8. Microphone
9. Status indicator

## Using Your SoundCore

### 1. Turn on / off



SoundCore will automatically turn off after 10 minutes if no device is connected

### 2. Charge your SoundCore

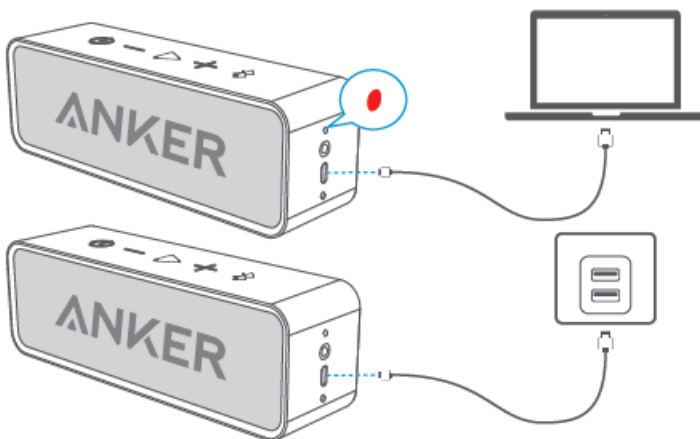

**Flashing red:** Low power



**Steady red:** Charging



**Off:** Fully charged

Use the included USB cable to charge your SoundCore and make sure it is fully charged before first use.

### 3. Pair with your device

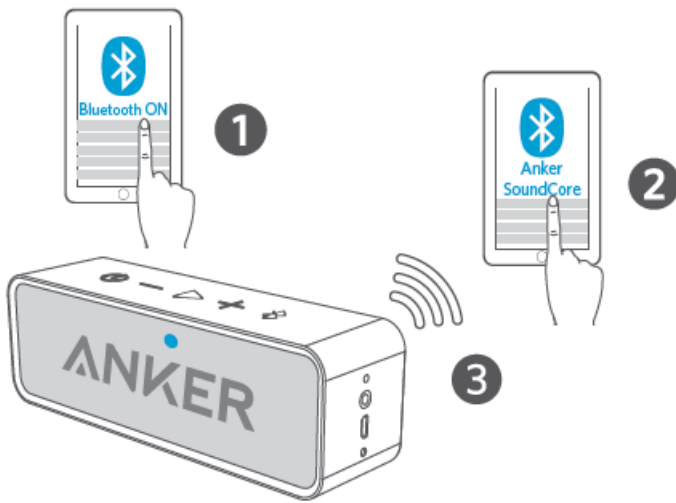

### Un-pair connected device and re-enter pairing mode



**Rapidly flashing blue:** Pairing mode



**Steady blue:** Connected to a device



**NOTE:** When turned on, SoundCore will automatically connect to the last connected device if available. If not, SoundCore will enter pairing mode.

**WARNING:** Having connection problems? Remove SoundCore from your device's Bluetooth history, ensure it's less than 3 feet away then try pairing again.

### 1. Connect via AUX

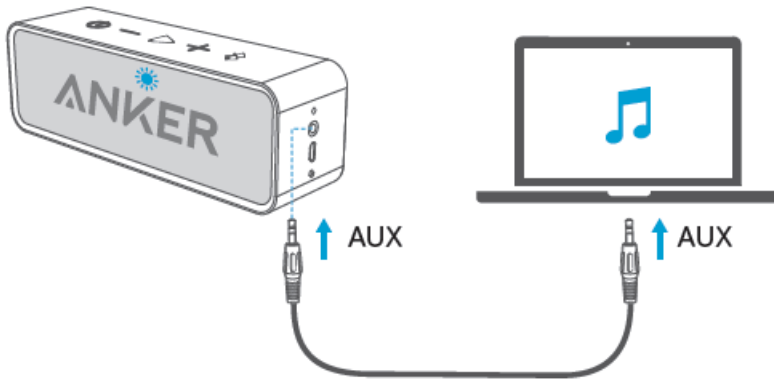

\* SoundLine AUX cable sold separately

**Rapidly flashing blue:** AUX mode



When using AUX mode, control audio playback via the connected device.

## Controls

### MUSIC CONTROL

#### Play / pause



#### Skip forward

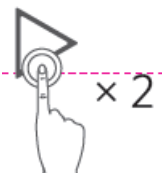

#### Volume up / down

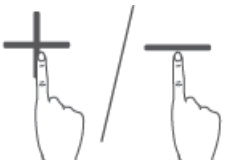

#### CALL

## Answer / End call



## Reject call

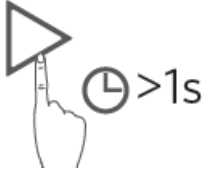

## Put current call on hold and answer incoming call

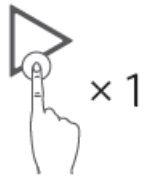

## Switch between held call and active call



## Specifications

Input	5 V 1 A
Audio output	3 W × 2
Charging time	5 – 6 hours
Play time (varies by volume level and content)	24 hours
Size	165 × 45 × 54 mm; 6.5 × 1.8 × 2.1 in
Weight	365 g / 12.9 oz
Range	20 m / 66 ft

## Attention

- Use original or certified cables
- Don't expose to liquids

- Don't disassemble
- Avoid dropping
- Avoid extreme temperatures

## FCC Statement

This device complies with Part 15 of the FCC Rules. Operation is subject to the following two conditions: (1) This device may not cause harmful interference, and (2) this device must accept any interference received, including interference that may cause undesired operation.

**Warning:** Changes or modifications not expressly approved by the party responsible for compliance could void the user's authority to operate the equipment.

**Note:** This equipment has been tested and found to comply with the limits for a Class B digital device, pursuant to Part 15 of the FCC Rules. These limits are designed to provide reasonable protection against harmful interference in a residential installation.

This equipment generates uses and can radiate radio frequency energy and, if not installed and used in accordance with the instructions, may cause harmful interference to radio communications. However, there is no guarantee that interference will not occur in a particular installation. If this equipment does cause harmful interference to radio or television reception, which can be determined by turning the equipment off and on, the user is encouraged to try to correct the interference by one or more of the following measures: (1) Reorient or relocate the receiving antenna.

(2) Increase the separation between the equipment and receiver.

(3) Connect the equipment into an outlet on a circuit different from that to which the receiver is connected. (4) Consult the dealer or an experienced radio / TV technician for help.

## RF Warning Statement

The device has been evaluated to meet general RF exposure requirements. The device can be used in portable exposure conditions without restriction.

The following importer is the responsible party

**Company Name:** Fantasia Trading LLC

**Address:** 5350 Ontario Mills Pkwy, Suite 100, Ontario, CA 91764

Telephone: +1 (800) 988 7973

## BLUETOOTH:

The Bluetooth® word mark and logos are registered trademarks owned by the Bluetooth SIG, Inc. and any use of such marks by Anker Innovations Limited is under license. Other trademarks and trade names are those of their respective owners.

This product complies with the radio interference requirements of the European Community.

CAUTION RISK OF EXPLOSION IF BATTERY IS REPLACED BY AN INCORRECT TYPE. DISPOSE OF USED BATTERIES ACCORDING TO THE INSTRUCTIONS.

## Declaration of Conformity

Hereby, Anker Innovations Limited declares that the product type A3102 is in compliance with Directive 2014/53/EU. The full text of the EU declaration of conformity is available at the following internet address:

[www.anker.com](http://www.anker.com)

**Maximum output power:** 3.06dBm

**Frequency band:** 2.4G band(2.4000GHz-2.4835GHz)

### **Anker Innovations Limited**

Room 1318-19, Hollywood Plaza, 610 Nathan Road, Mongkok, Kowloon, Hong Kong

### **Anker Innovations Deutschland GmbH**

Georg-Muche-Strasse 3, 80807 Munich, Germany

This product complies with the radio interference requirements of the United Kingdom

### **Declaration of Conformity**

Hereby, Anker Innovations Limited declares that the product type A3102 is in compliance with Radio Equipment Regulations 2017. The full text of the UK declaration of conformity is available at the following internet address:

<https://www.anker.com/>

### **Customer Service**

support@anker.com

suporte@ankeroficial.com.br

support.mea@soundcore.com (For Middle East and Africa Only)

support@anker.com ( )

+44 (0) 1604 936200 (UK) Mon-Fri 6:00 – 11:00 (GMT)

+49 (0) 69 9579 7960 (DE) Mon-Fri 6:00 – 11:00

03 4455 7823 ( ) – 9:00 – 17:00

+86 400 0550 036 ( ) 9:00 – 17:30

+82-2-6464-7088 (■■) ■~■ 9:00 – 17:30

+971 42463266 (Middle East & Africa) Sun-Thu 9:00 – 17:30 (GMT+4)

+971 8000320817 (UAE) Sun-Thu 9:00 – 17:30 (GMT+4)

+966 8008500030 (KSA) Sun-Thu 8:00 – 16:30 (GMT+3)

+965 22069086 (Kuwait) Sun-Thu 8:00 – 16:30 (GMT+3)

+20 8000000826 (Egypt) Sun-Thu 7:00 – 15:30 (GMT+2))

4003-0957 (Capitais e regiões metropolitanas) ou 0800 888

0957 (Demais localidades)

Seg-Sex 8:00-18:00 (BR)

**For FAQs and more information, please visit:**



[www.ankeroficial.com.br](http://www.ankeroficial.com.br)

[www.anker.com](http://www.anker.com)

[anker.com/support](http://anker.com/support)

---



## DOWNLOAD

SoundCore Portable Speaker A3102 User Manual – [[Download PDF](#)]

A3102 Soundcore Declaration of Conformity – [[Download PDF](#)]

---

[Manuals+](#)