



## SoundCore Mini Portable Speaker A3101 User Manual

[Home](#) » [Soundcore](#) » SoundCore Mini Portable Speaker A3101 User Manual 

### Contents

- [1 SoundCore Mini Portable Speaker A3101](#)
- [2 Safety instructions](#)
- [3 What's Included](#)
- [4 At a Glance](#)
- [5 Using Your SoundCore](#)
  - [5.1 1. Turn on / off](#)
  - [5.2 2. Select mode](#)
  - [5.3 3. Charge your SoundCore](#)
- [6 Specifications](#)
- [7 FCC Statement](#)
- [8 RF Warning Statement](#)
- [9 Declaration of Conformity](#)
- [10 Customer Service](#)
- [11 DOWNLOAD](#)
- [12 Related Posts](#)

**SoundCore Mini Portable Speaker A3101**



## USER MANUAL

### Safety instructions

1. Avoid dropping.
2. Do not disassemble.
3. Do not submerge in water.
4. Avoid extreme temperatures.
5. Do not use the device outdoors during thunderstorms.
6. Use original or certified cables.
7. Do not use any corrosive cleaner/oil to clean.
8. Do not expose batteries to high heat as direct sun light, fire and Etc.

### What's Included

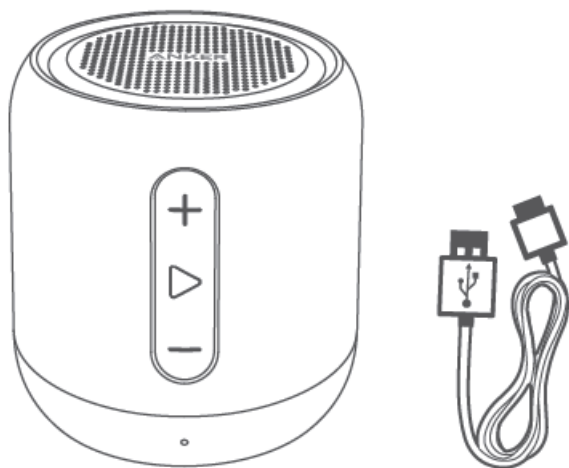

## At a Glance

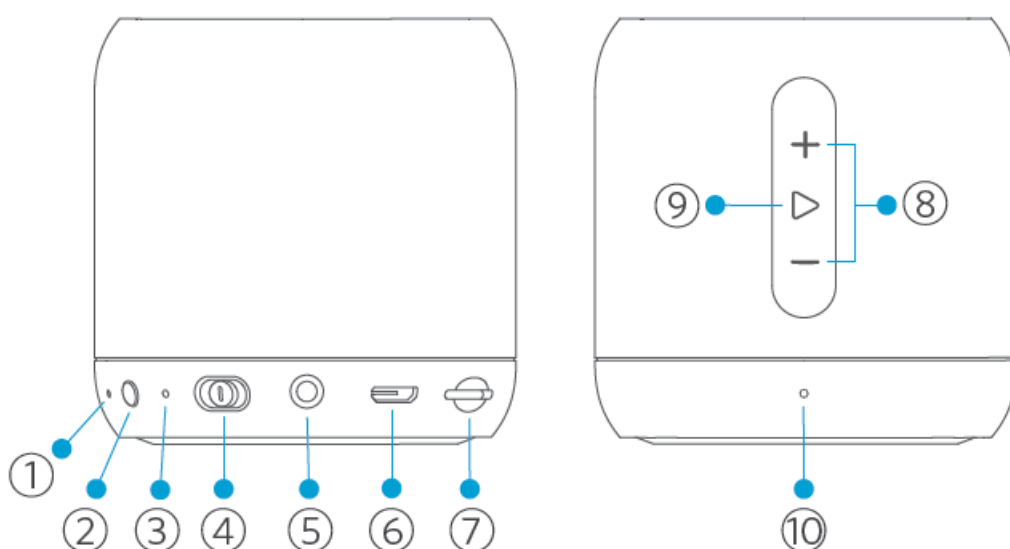

1. Microphone
2. Mode button
3. Battery indicator
4. Power switch
5. 3.5mm Aux input
6. Micro USB charging port
7. SD card slot
8. Volume buttons
9. Multi-function button
10. Status indicator

## Using Your SoundCore

### 1. Turn on / off

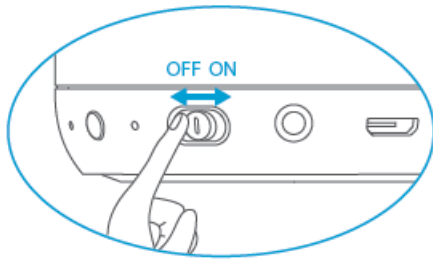

## 2. Select mode

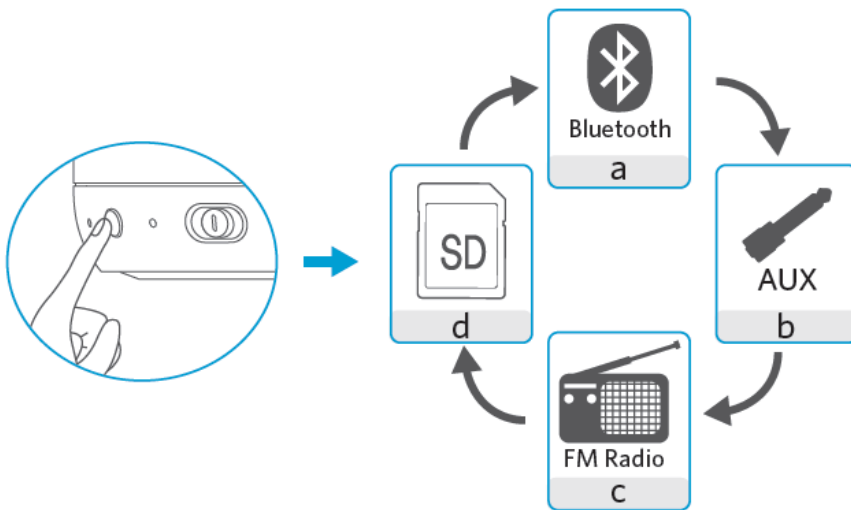

**WARNING:** Plugging in an audio cable or inserting an SD card will automatically switch to Aux or SD card mode.

### a. Bluetooth mode

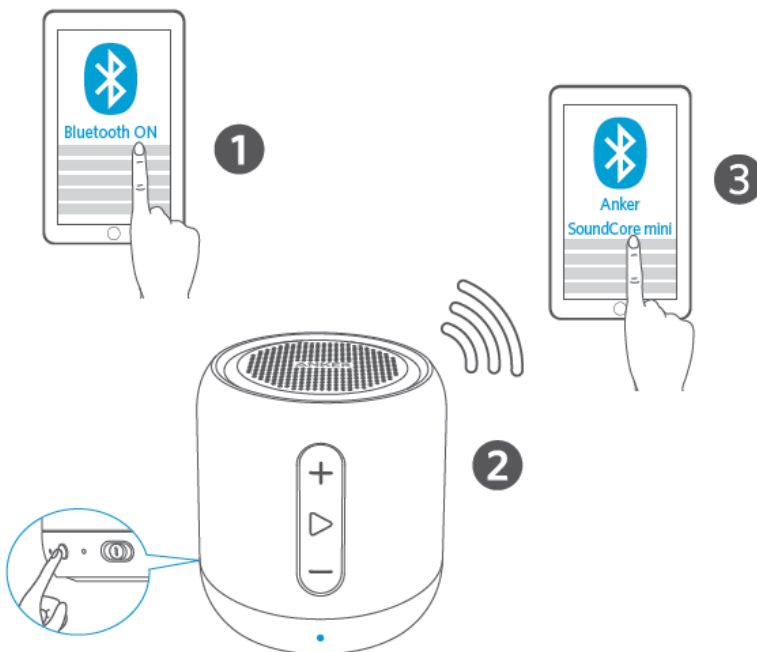

**Rapidly flashing blue:** Pairing mode



**Steady blue:** Connected to a device



**Play / pause**



**Answer / end call**

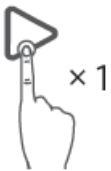

**Activate Siri / other voice control software**



**Volume up / down**

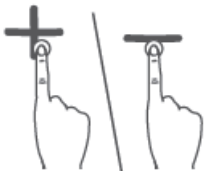

**Next track**



**Previous track**



#### **WARNING:**

- When turned on, SoundCore will automatically connect to the last connected device if available. If not, SoundCore will enter pairing mode.
- To pair a different device, first disable Bluetooth on the connected device or press the Mode button for 3 seconds to re-enter pairing mode. Then repeat the pairing steps.
- Having connection problems? Remove SoundCore from your device's Bluetooth history, ensure it's less than 3 feet away then try pairing again.

#### **b. AUX-In mode**

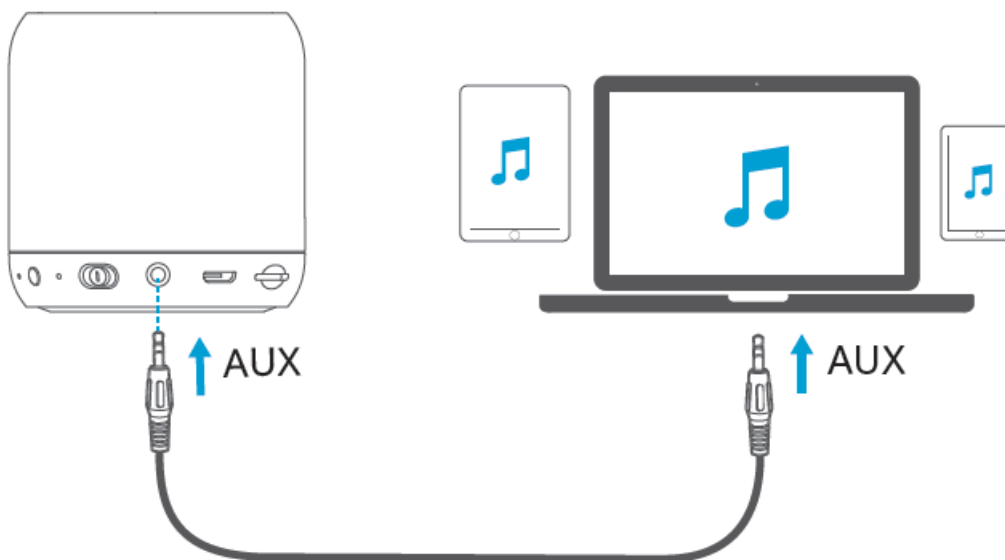

\* SoundLine AUX cable sold separately

**Steady white:** AUX mode



**WARNING:** When using AUX mode, control audio playback via the connected device

#### **c. SD card mode**

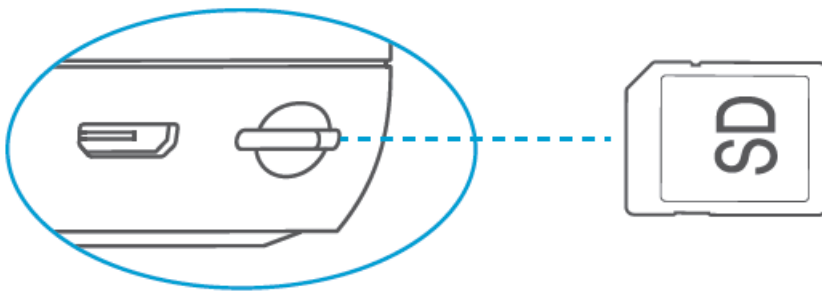

**Play / pause**



**Volume up / down**

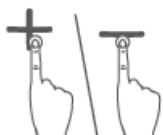

**Next track**



**Previous track**



\* Support a class 4 or above micro SD card, up to 32GB.

\* Supported audio formats: MP3

**d. FM radio mode**

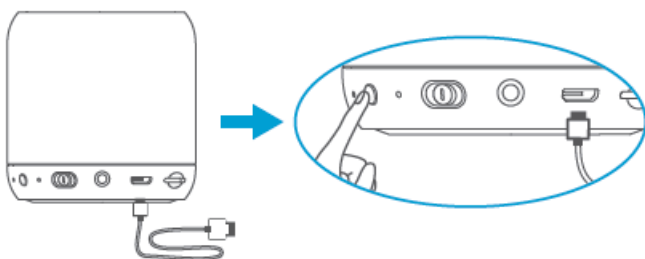

**WARNING:** The provided Micro USB cable acts as an antenna, to ensure the best reception insert cable before use.

### Play / pause



### Scanning



### Volume up / down

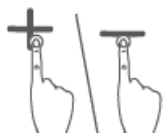

### Next station



### Previous station



### 3. Charge your SoundCore



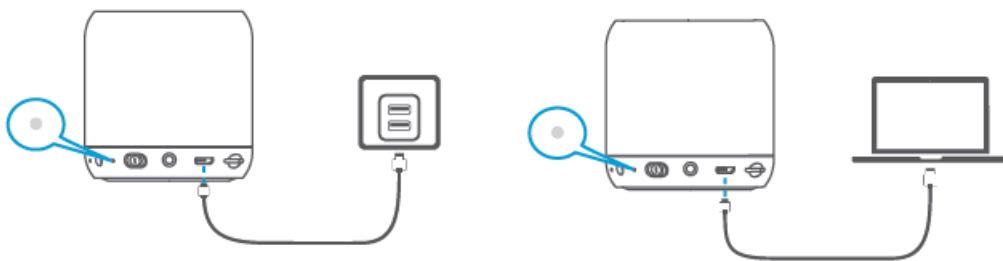

**Flashing white:** Low power



**Steady white:** Charging



**Off:** Fully charged



**WARNING:** Use the included USB cable to charge your SoundCore and make sure it is fully charged before first use.

**Specifications**

Input:	5 V 1 A
Audio output:	5 W
Battery capacity:	1800 mAh
Charging time:	2 – 3 hours
Playtime (varies by volume level and music content):	15 hours
Size:	67 × 67 × 67 mm 2.6 × 2.6 × 2.6 in
Weight (without packaging):	215 g / 7.6 oz
Bluetooth version:	V4.2
Bluetooth range:	20 m / 66 ft

**FCC Statement**

This device complies with Part 15 of the FCC Rules. Operation is subject to the following two conditions: (1) This device may not cause harmful interference, and (2) this device must accept any interference received, including interference that may cause undesired operation.

**Warning:** Changes or modifications not expressly approved by the party responsible for compliance could void the user's authority to operate the equipment.

**Note:** This equipment has been tested and found to comply with the limits for a Class B digital device, pursuant to Part 15 of the FCC Rules.

These limits are designed to provide reasonable protection against harmful interference in a residential installation.

This equipment generates uses and can radiate radio frequency energy and, if not installed and used in accordance with the instructions, may cause harmful interference to radio communications. However, there is no guarantee that interference will not occur in a particular installation. If this equipment does cause harmful interference to radio or television reception, which can be determined by turning the equipment off and on, the user is encouraged to try to correct the interference by one or more of the following measures:

1. Reorient or relocate the receiving antenna.
2. Increase the separation between the equipment and receiver.
3. Connect the equipment into an outlet on a circuit different from that to which the receiver is connected.
4. Consult the dealer or an experienced radio / TV technician for help.

The following importer is the responsible party

**Company Name:** Fantasia Trading LLC

**Address:** 5350 Ontario Mills Pkwy, Suite 100, Ontario, CA 91764 Telephone: +1 (800) 988 7973

## **RF Warning Statement**

The device has been evaluated to meet general RF exposure requirements. The device can be used in portable exposure conditions without restriction.

Este equipamento não tem direito à proteção contra interferência prejudicial e não pode causar interferência em sistemas devidamente autorizados.

## **Trademark**

The **Bluetooth®** word mark and logos are registered trademarks owned by the Bluetooth SIG, Inc. and any use of such marks by Anker Innovations Limited is under license.

Other trademarks and trade names are those of their respective owners.

## **CE**

This product complies with the radio interference requirements of the European Community.

CAUTION RISK OF EXPLOSION IF BATTERY IS REPLACED BY AN INCORRECT TYPE. DISPOSE OF USED BATTERIES ACCORDING TO THE INSTRUCTIONS

## **Declaration of Conformity**

Hereby, Anker Innovations Limited declares that the product type A3101 is in compliance with Directive 2014/53/EU. The full text of the EU declaration of conformity is available at the following internet address:

[www.anker.com](http://www.anker.com)

**Maximum output power:** 1.5dBm

**Frequency band:** 2.4G band(2.402GHz-2.480GHz)

#### **Anker Innovations Limited**

Room 1318-19, Hollywood Plaza, 610 Nathan Road, Mongkok, Kowloon, Hong Kong

#### **Anker Innovations Deutschland GmbH**

Georg-Muche-Strasse 3, 80807 Munich, Germany

#### **UK CA**

This product complies with the radio interference requirements of the United Kingdom

#### **Declaration of Conformity**

Hereby, Anker Innovations Limited declares that the product type A3101 is in compliance with Radio Equipment Regulations 2017. The full text of the UK declaration of conformity is available at the following internet address:

<https://www.anker.com>

This symbol means the product must not be discarded as household waste, and should be delivered to an appropriate collection facility for recycling. Follow local rules and never dispose of the product and rechargeable batteries with normal household waste. Correct disposal of old products and rechargeable batteries helps prevent negative consequences for the environment and human health.

#### **Anker Innovations Limited**

Room 1318-19, Hollywood Plaza, 610 Nathan Road, Mongkok, Kowloon, Hong Kong

Anker Innovations Deutschland GmbH

Georg-Muche-Strasse 3, 80807 Munich, Germany

#### **ANKER TECHNOLOGY (UK) LTD**

Suite B, Fairgate House, 205 Kings Road, Tyseley, Birmingham, B11 2AA, United Kingdom

#### **IC NOTICE TO CANADIAN USERS**

This device contains licence-exempt transmitter(s)/receiver(s) that comply with Innovation, Science and Economic Development Canada's licence-exempt RSS(s). Operation is subject to the following two conditions:

- (1) This device may not cause interference.
- (2) This device must accept any interference, including interference that may cause undesired operation of the device.

#### **Customer Service**

support@anker.com

suporte@ankeroficial.com.br

support.mea@soundcore.com (For Middle East and Africa Only)

support@anker.com ( )

+1 (800) 988 7973 (US) Mon-Fri 6:00 – 17:00 (PT)

+44 (0) 1604 936200 (UK) Mon-Fri 6:00 – 11:00 (GMT)

+49 (0) 69 9579 7960 (DE) Mon-Fri 6:00 – 11:00

03 4455 7823 ( ) – 9:00 – 17:00

+86 400 0550 036 ( ) 9:00 – 17:30

+82-02-1670-7098 (■■■) ■~■ 10:00 – 17:00

+971 42463266 (Middle East & Africa) Sun-Thu 9:00 – 17:30 (GMT+4)  
+971 8000320817 (UAE) Sun-Thu 9:00 – 17:30 (GMT+4)  
+966 8008500030 (KSA) Sun-Thu 8:00 – 16:30 (GMT+3)  
+965 22069086 (Kuwait) Sun-Thu 8:00 – 16:30 (GMT+3)  
+20 8000000826 (Egypt) Sun-Thu 7:00 – 15:30 (GMT+2))  
4003-0957 (Capitais e regiões metropolitanas) ou 0800 888  
0957 (Demais localidades) Seg-Sex 8:00-18:00 (BR)

---

## DOWNLOAD

SoundCore Mini Portable Speaker A3101 User Manual – [[Download PDF](#)]

A3101 Soundcore Mini Declaration of Conformity – [[Download PDF](#)]

---